

EURO-PRO
select 

PROFESSIONAL PORTABLE STEAMER™

Hand Held Steam Cleaner

OWNER'S MANUAL

Model SC500

120V., 60Hz., 1600 Watts

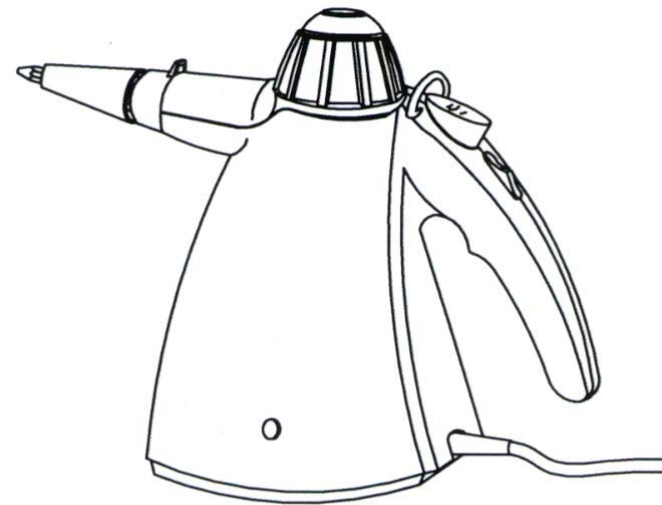

For information or assistance:

EURO-PRO Operating LLC

94 Main Mill Street, Door 16

Plattsburgh, NY 12901

Tel.: 800-798-7398

IMPORTANT SAFETY INSTRUCTIONS

When using your **Professional Portable Steamer**, basic safety precautions should always be observed, including the following:

1. Read all instructions before using your Professional Portable Steamer.
2. Use the system only for its intended use.
3. To protect against a risk of electric shock, do not immerse any part of the system in water or other liquids.
4. Never yank cord to disconnect from outlet; instead, grasp plug and pull to disconnect.
5. **Do not** allow cord to touch hot surfaces. Let the system cool completely before putting away or before opening the water tank (removing the safety cap) . Wrap power cord loosely around your system when storing.
6. Always disconnect system from electrical outlet when filling or emptying water tank and when not in use.
7. **Do not** operate the system with a damaged cord or plug, or if the appliance or any other part of the system has been dropped or damaged. To avoid the risk of electric shock, do not disassemble or attempt to repair the Professional Portable Steamer. Return the system to **EURO-PRO Operating LLC** (see warranty) for examination and repair. Incorrect re-assembly or repair can cause a risk of electrical shock or injury to persons when the Professional Portable Steamer is used.
8. Close supervision is necessary for any appliance being used by or near children. Do not leave the system unattended while connected.
9. Burns can occur from touching hot metal parts, hot water or steam. **Do not** turn upside down as there may be hot water in the unit. Never direct steam at any person. The steam is very hot and can cause burns.
10. **Do not** operate in the presence of explosive and/or flammable fumes.
11. This appliance is intended only for household use. Follow all user instructions in this manual.
12. Never use any chemicals or substance other than tap water in the machine. Use of chemicals may damage the machine. Use of chemicals will automatically void your warranty.

To reduce the risk of fire, electric shock, or injury:

- **Do not** leave the Professional Portable Steamer plugged in when unattended. Unplug the electrical cord when not in use and before servicing or refilling water tank.
- **Do not** allow to be used as a toy. Close attention is necessary when used by or near children, pets or plants.
- Use only as described in this manual. Use only manufacturer's recommended accessories.
- **Do not** pull cord, use cord as a handle, close a door on cord, or pull cord around sharp edges or corners. Keep cord away from heated surfaces.
- **Do not** use extension cords or outlets with inadequate current carrying capacity.
- **Do not** unplug by pulling on cord. To unplug, grasp the plug, not the cord.
- **Do not** handle plug or steam cleaner with wet hands or operate without shoes.
- **Do not** put any objects into openings. Do not use with any opening blocked.
- Store your appliance indoors in a cool, dry area.
- Keep your work area well lit.
- **When in use, never turn the appliance over or on its side. Never direct steam towards people, animals or plants.**
- **Do not** immerse the steam cleaner into water or other liquids. Always unplug the power cord from the electrical socket when filling the steam cleaner.
- **Do NOT add cleaning solutions, scented perfumes, oils or any other chemicals to the water used in this appliance as this may damage the unit or make it unsafe for use.** Use regular tap water or distilled/purified water if the tap water in your area is very hard.

Model SC500



1 YEAR LIMITED WARRANTY

EURO-PRO Operating LLC warrants this product to be free from defects in material and workmanship for a period of one (1) year from the date of purchase when utilized for normal household use by the original purchaser only. The attached Warranty Registration Card must be filled out and returned within 10 days of purchase. This is essential for your Warranty to be effective should any problem arise with this product.

Should any defect covered by the terms of the limited warranty be discovered within one year, **EURO-PRO Operating LLC** will repair or replace any defective part provided the unit is returned by the original purchaser, freight prepaid, to **EURO-PRO Operating LLC**, 94 Main Mill Street, Door 16, Plattsburgh, NY 12901. Proof of purchase date and \$9.95 for handling and return packing/shipping charges must be included.*

The liability of **EURO-PRO Operating LLC** is limited solely to the cost of the replacement parts or the complete unit at our option. LABOUR CHARGES ARE NOT INCLUDED.

This warranty does not cover normal wear of parts and does not apply to any unit that has been tampered with or used for commercial purposes. This Limited Warranty does not cover damage caused by misuse, negligent handling, or damage due to faulty packaging or mishandling in transit (by any common carrier).

This warranty is extended to the original purchaser of the unit and excludes all other legal and/or conventional warranties. The responsibility of **EURO-PRO Operating LLC**, if any, is limited to the specific obligations expressly assumed by it under the terms of the limited warranty. In no event is **EURO-PRO Operating LLC** liable for incidental or consequential damages of any nature whatsoever. Some States do not permit the exclusion or limitation of incidental or consequential damages, so the above may not apply to you.

This warranty gives you specific legal rights which vary from state to state.

PURCHASER _____

DATE OF PURCHASE _____

*important: Carefully pack item to avoid damage in shipping. Be sure to attach tag to item before packing with your name, complete address and phone number with note giving purchase information, model number and what you believe is the problem with item. We recommend you insure the package (as damage in shipping is not covered by your warranty). Mark the outside of your package "ATTENTION CUSTOMER SERVICE". **We are constantly striving to improve our products, therefore the specifications contained herein are subject to change without notice.**



OWNERSHIP REGISTRATION CARD

Please complete and return within ten (10) days of purchase. The registration will enable us to contact you in the event a product defect is discovered. By returning this card you acknowledge to have read and understood the instructions for use, and warnings set forth in the accompanying instructions.

RETURN TO: **EURO-PRO Operating LLC**, 94 Main Mill Street, Door 16, Plattsburgh, NY 12901

PURCHASER:

ADDRESS:

CITY: STATE:

DATE OF PURCHASE: MODEL: **SC500**

NAME AND ADDRESS OF DEALER:

SAVE THESE INSTRUCTIONS

For Household Use Only

CARE & MAINTENANCE

CAUTION: This appliance must be unplugged from the electrical outlet and allowed to cool down before performing any cleaning or maintenance tasks on the unit.

- Let the appliance cool down completely before cleaning or storing.
- Depress the trigger before opening the safety cap in order to release any residual pressure in the boiler.
- Empty all water from the water tank after each use.
- Store in a dry, cool place.
- A periodic rinse of your steam cleaner will free it from deposits. This is recommended every 10-15 tankfills to free up any scale deposits. Fill the boiler with water and shake vigorously. Tilt the cleaner upside down to empty the boiler of water and any scale deposits.

Cleaning the Nozzles:

Your steamer should not normally require cleaning, however, should you notice a marked decrease in steam output it may be necessary to remove mineral deposit build-up from the nozzle orifice. First ensure that there is water in the tank. If tank is empty, fill with water, (we recommend using purified or demineralized water), then re-start unit noting whether steam output is normal. If steam output is still low, follow these cleaning instructions:

1. Unplug steam cleaner from wall outlet.
2. Depress trigger to release any residual pressure in the boiler.
3. Use a small diameter stiff metal wire such as a straightened metal paperclip and carefully insert the end of the wire into the nozzle orifice. See illustrations below.
4. Move wire back and forth several times to remove any deposits.
5. Reconnect appliance to power outlet, switch on and note steam output.
6. If steam performance does not improve, repeat steps #1 through #4.

Paperclip

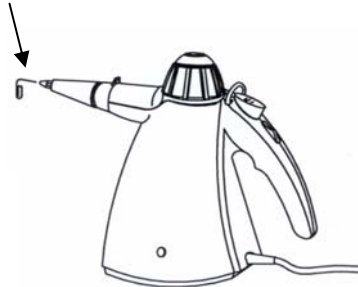

ADDITIONAL IMPORTANT SAFEGUARDS cont.

1. To avoid circuit overload, **do not** operate another appliance on the same socket (circuit)
2. If an extension cord is absolutely necessary, a 15 ampere 14 gage cord should be used. Cords rated for less amperage may overheat. Care should be taken to arrange cord so that it cannot be pulled or tripped over.
3. **Do not** leave unattended when the system is connected to a power supply/electrical outlet.

SAVE THESE INSTRUCTIONS FOR HOUSEHOLD USE ONLY

WARNING: This appliance is equipped with a grounded-type 3-wire cord (3-prong plug). This plug will only fit into an electrical outlet made for a 3-prong plug. This is a safety feature. If the plug should fail to fit the outlet, contact an electrician to replace the outlet. Do not attempt to defeat the safety purpose of the grounding pin, part of the 3-prong plug.

GETTING TO KNOW YOUR PROFESSIONAL PORTABLE STEAMER

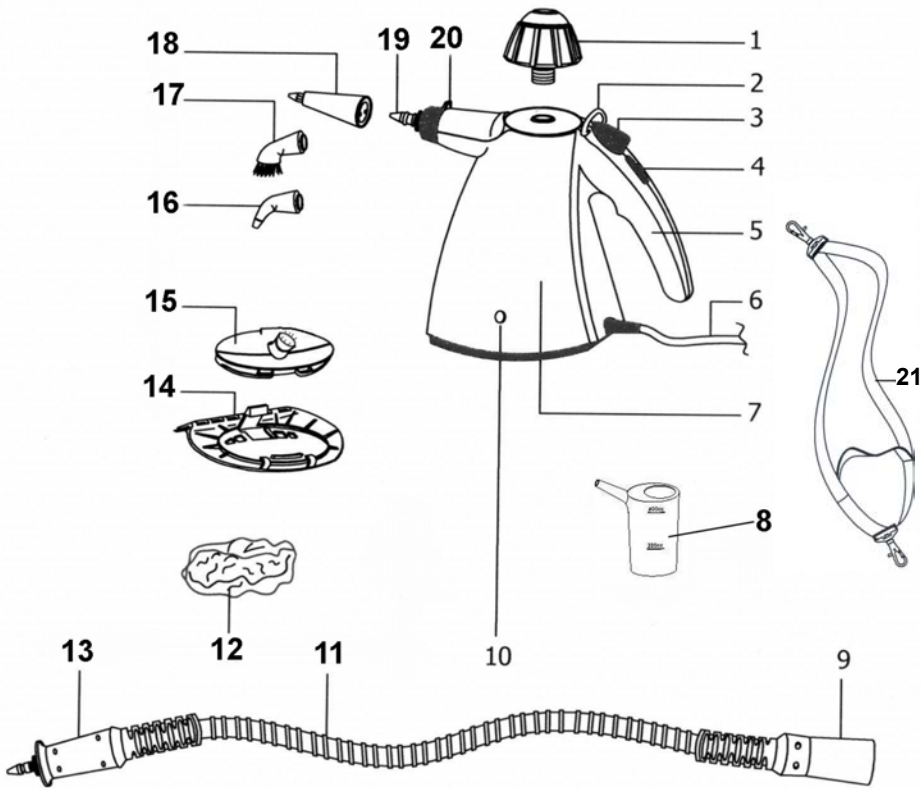

- | | |
|---------------------------|------------------------------|
| 1. Safety Cap | 11. Hose |
| 2. Shoulder Strap Hook | 12. Cleaning Bonnet |
| 3. Locking Trigger Button | 13. Hose/Accessory Connector |
| 4. Trigger Release | 14. Window Squeegee |
| 5. Handle | 15. Garment Diffuser Head |
| 6. Power Cord | 16. Angle Adapter |
| 7. Main Unit | 17. Detail Brush (2) |
| 8. Filling Flask | 18. Concentrator Nozzle (2) |
| 9. Hose/Unit Connector | 19. Nozzle |
| 10. Indicator Light | 20. Shoulder Strap Loop |
| | 21. Shoulder Strap |

Technical Specifications

Voltage:	120V., 60Hz.
Power:	1600 Watts
Water Capacity:	20 U.S. Fl. Oz.(600 c.c.)

USAGE SUGGESTIONS FOR PROFESSIONAL PORTABLE STEAMER

Window, Glass Surfaces and Mirrors

Use the window squeegee. Work with the steam on using top to bottom movements. Use the squeegee with the steam to clear the water from the glass. To do this without leaving streaks, use lateral movements from the top to the bottom of the surface.

Fiberglass or Stainless Steel Surfaces

Use the detail brush. Slowly move the brush over the surface to be cleaned. The steam will emulsify the dirt and grease on the surface. Follow behind with a 100% cotton towel to remove excess moisture and residue.

Tip: An old idea for polishing stainless steel is to wipe it down with seltzer soda water after it is cleaned.

Soap Scum

Soap scum dissolves almost immediately under a combination of heat and moisture. Rinse the surface with a small amount of water afterwards.

Note: Soap scum sometimes will develop a hard surface from waterborne minerals. If this is the case, use the detail brush to break up this surface - or spray or wipe first with lemon, vinegar or seltzer soda water to soften the minerals.

Moving too slowly can dry out the soap scum and cause it to granulate on the surface. The surface will have a gritty feel. If this happens, apply vapor to the surface with the detail brush again and re-clean.

Bathroom Areas

To clean the bathtub or shower area, use the detail brush for grout, shower door tracks, hard to get areas and heavily soiled areas. The window squeegee will be the most efficient way to clean the rest of the area. Allow plenty of time for the heat to penetrate the surface. This is especially helpful in the shower area if there is tile or grout.

To clean sanitary fixtures, use concentrator nozzle with or without detail brush.

To clean the sink and faucets, use detail brush.

Blinds

Use the detail brush to clean blinds. Move the brush over the surface, allowing enough time for the vapor to penetrate. Work quickly on PVC blinds. Test for color fastness on fabric blinds before using.

Refrigerator - Use the concentrator nozzle alone to blow away dirt in the ice machine and on door seals. The vapor will not dry out or crack the seals as chemicals often do. Can openers and other kitchen equipment can be easily cleaned with the detail brush on the concentrator nozzle to get into all the nooks and crannies.

To clean **microwaves** or **other small appliances** use the detail brush for small areas.

Note: When cleaning small electrical appliances always unplug them from outlet before cleaning.

Clothing

A steam cleaning system is excellent for removing wrinkles from fabrics. Simply "vaporize" the surface from a distance (12"-16") The dry steam removes wrinkles without leaving the fabric wet like ordinary fabric steamers do.

Upholstery

Use the garment diffuser head with the cleaning bonnet. Use fast, light strokes, avoid getting the fabric wet. Be patient with stubborn spots; work on a spot gently for no more than a minute at a time, then wait five minutes for the area to dry and repeat. Use circular movements or back-and-forth and side-to-side movements to get all sides of surface fibers. Finish with a brushing in one direction that will give the fabric a uniform appearance.

Caution: Always determine the color-fastness of any fabric - especially with reds or blues - by taking a clean, moist, warm towel and gently rubbing a small area as far down on the back or other out of the way place on the furniture as possible. If color comes off on the towel, you may need to have the piece dry cleaned.

OPERATING INSTRUCTIONS cont.

Cleaning Bonnet

The cleaning bonnet is used with the garment diffuser head. Just slip it over the attachment. This can be used to clean upholstery.

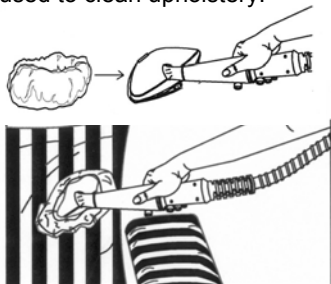

Attaching the Hose

To attach the hose to the concentrator nozzle, align the two guide pins inside the hose/unit connector with the guide pin slots on the nozzle. Push the hose in and turn clockwise 90° to lock the hose in place. See illustration below.

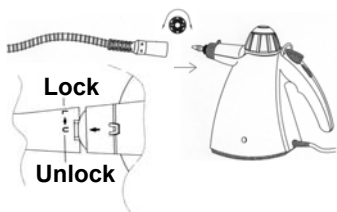

To attach the concentrator nozzle to the hose, align the two guide pins inside the concentrator nozzle with the guide pin slots on the hose/accessory connector. Push the concentrator nozzle in and turn clockwise to lock it on to the hose. See illustration below.

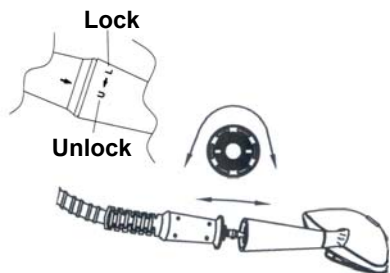

You can only attach the accessories to the hose using the concentrator nozzle. i.e. angle adapter, detail brush, window squeegee, etc.

Tips On How To Use Your Steam Cleaner

Water

- Use tap water for all your cleaning needs.
- However, if you live in an area with hard water, use demineralized/distilled water when steaming light colored fabrics to eliminate the possibility of hard water stains.

IMPORTANT: Do **NOT** add cleaning solutions, scented perfumes, oils or any other chemicals to the water used in this appliance. **Use tap water or distilled/purified water if the tap water in your area is very hard.**

Efficient Work

- For vertical surfaces, wipe always from the top down, in this way the dirty water will not soil surfaces already cleaned.
- Avoid changing brushes back and forth while cleaning. Start with the smallest brush to clean tight spots and corners first.
- Wipe dirt as soon as possible, otherwise it will dry and re-adhere to the surface.

Hints

The Professional Portable Steamer has many uses many of which will not be mentioned in this owner's manual. This is meant only to give you a general idea of what can be achieved with the unit. However, the ways in which to use the units and the brushes are in most cases universal. It is most helpful to always have the micro fiber cloth or a terry cloth towel or paper towel ready to use for removal of moisture and residue. 100% white cotton towels work best. You can clean the brushes with your steam cleaner. When cleaning the detail brush, use a pair of pliers to hold the brush or place in the basket of your dishwasher.

Note: Wipe immediately before the cleaned area dries. When cleaning the oven, use the detail brush to clean around the elements, drip trays, cracks, crevices, and hard to reach areas.

FEATURES

Your **Hand Held Steam Cleaner** utilizes pressurized steam to remove tough grease, dirt and grime. Steam is nature's purest and most powerful cleaner for safely cleaning all hard surfaces in your home without harsh chemicals, thus being perfectly ecological. The appliance has various attachments so that it can be used for many purposes such as:

1. Clean upholstery, sealed grout, bathroom/kitchen tile, stovetops.
2. Easy to clean difficult to reach areas with the angle adapter or concentrator such as faucets, etc.
3. Ideal for windows, mirrors, glass doors, etc.
4. Clean fabrics, window coverings, pillows, bedding etc.
5. Clean hard surface areas such as counters, sinks, shower door tracks, etc.

WARNING: Your Hand Held Steam Cleaner is designed to clean hard surfaces and upholstery that will withstand high heat. Do not use on soft plastics, unsealed wood and cold glass. On surfaces that have been treated with wax or some no wax floors, the sheen may be removed by the heat and steam action. Do not use on unsealed wood. This could cause the wood grain to rise. It is therefore recommended to test an isolated area of the surface to be cleaned before proceeding.

CAUTION: Do not plug in the machine during filling. Use a grounded receptacle. Use only a heavy duty extension cord rated for 15 amps - Do not use an ordinary extension cord.

IMPORTANT: Do **NOT** add cleaning solutions, scented perfumes, oils or any other chemicals to the water used in this appliance. **Use regular water or distilled/purified water if the tap water in your area is very hard.**

How To Assemble & Use

IMPORTANT: Always insure that the unit is “UNPLUGGED” from the wall receptacle prior to initial filling or re-filling the water tank. **Never attempt to fill this unit under a water tap, always use the filling flask provided.** Failure to follow these steps will cause the water tank to overflow and may pose an electrical safety hazard.

- Step 1: Before filling the steam cleaner, make sure that the unit is NOT plugged in.
- Step 2: Turn Safety Cap counter clockwise until removed.
- Step 3: Add 20 fl. oz (600 cc) of water using the filling flask provided. **Do not overfill.** Replace Safety Cap by turning clockwise - press down firmly to tighten. Heating time is approximately 6 minutes. Filling the boiler with hot water will shorten heat up time.
- Step 4: Plug the unit into a standard 120 volt wall receptacle. The power “On” light (Red) will light up.
- Step 5: Allow approximately 3-5 minutes for water vapor to reach its working temperature and pressure. When unit is ready for use the red light will change to Green.
- Step 6: At the start, some water will come out from the nozzle. This is normal.

NOTE: Disconnect steam cleaner from wall outlet before refilling. It is time to refill your steam cleaner when there is no more steam coming out of the nozzle. Because the water tank is pressurized, use caution when opening to refill. Depress the trigger button while you unscrew the safety cap counterclockwise. Always let unit cool for 5 minutes before refilling the unit with water.

CAUTION: When refilling the appliance while it is still hot, the first drops of water might bubble up.

Using the Locking Trigger Button

The steam cleaner has a locking trigger button. As you push down on the trigger you will get more steam. The trigger will lock when you have pushed it all the way. To unlock the trigger, just press down on the trigger release and the trigger will pop up, stopping the flow of steam.

Refilling With Water

- Step 1: Disconnect electrical power cord from wall outlet.
- Step 2: Press trigger button until all pressure has been released. Carefully unscrew safety cap.
- Step 3: Allow the unit to cool for approximately 5 minutes before refilling with water.
- Step 4: Slowly pour water using the filling flask into the boiler. **DO NOT Fill Under a faucet, use the filling flask provided. DO NOT OVERFILL. Always leave approximately 2 1/2 inches between the top of the unit and the water level.**
- Step 5: Release the locking trigger.
- Step 6: Screw safety cap back on the appliance and plug appliance back into wall outlet. Steam will start to be produced as before.

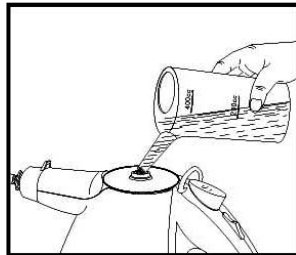

WARNING: This appliance is under pressure. After every use, press trigger button until all pressure has been released before removing safety cap. Either concentrator nozzle or hose must be connected in order for the trigger to operate. Allow unit to cool for three (3) minutes before refilling.

ATTACHMENTS

Concentrator Nozzle

To attach the concentrator nozzle to the nozzle of the unit, align the pins on the concentrator nozzle with the slots on the appliance. (See illustration.) Push the attachment onto the nozzle until it stops against the appliance body. Turn in a clockwise direction 90°. The attachment is now locked into position.

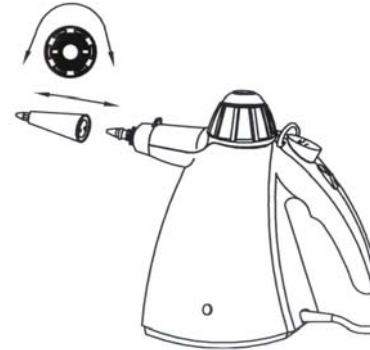

Small Detail Brush / Angle Adapter

Both the angle adapter and the small detail brushes can only be used directly on the concentrator nozzle. When using with the concentrator nozzle, push the attachment onto the end of the concentrator nozzle.

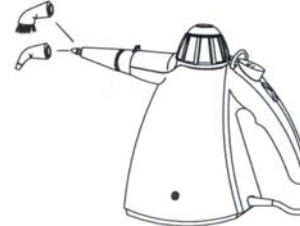

Garment Diffuser Head

You can use the garment head diffuser with the hose or alone on the unit itself. To attach, align the pins on the garment head diffuser with the slots on the appliance.



Window Squeegee

CAUTION: When cleaning windows, always avoid any sudden changes in temperature to prevent glass breakage or cracks.

To attach the window squeegee to the garment diffuser head, place the two hinges at the back of the window squeegee (see illustration) into the two open tabs that are at the back of the garment diffuser head. Swing the window squeegee up against the bottom of the garment diffuser head until the locking tab engages.

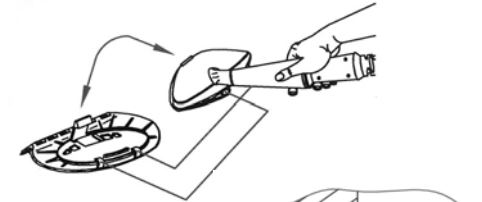

To remove the window squeegee from the garment diffuser head, just push your thumb against the locking tab on the window squeegee.

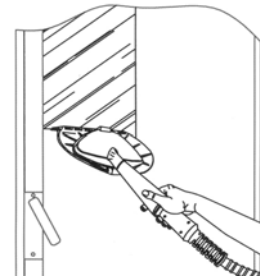

Attaching the Shoulder Strap

Using the detachable shoulder strap allows for greater freedom of movement when both hands are needed for various cleaning tasks. To attach the shoulder strap to the steam cleaner, simply snap the shoulder strap hooks onto the connecting rings on the unit body. When using the steam cleaner with the shoulder strap, avoid rocking or tilting the unit excessively as this may cause water to enter the hose and be discharged along with the steam.

