

**USER'S  
INSTRUCTION**

# **7" TFT LCD COLOR REAR VIEW SYSTEM**

**MODEL# TFT7001**

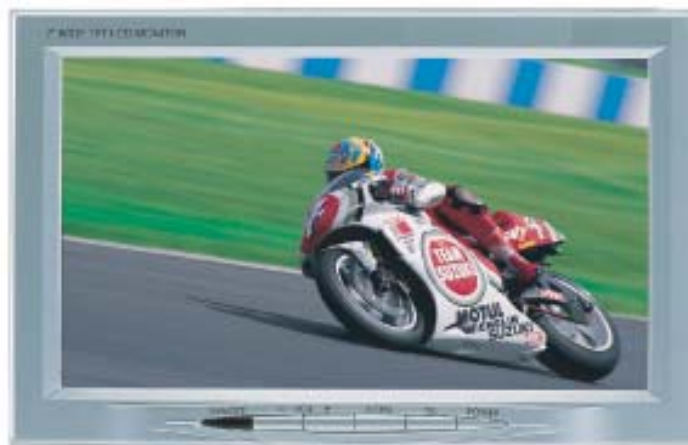

Copyright © 2006 Clover Electronics U.S.A. All Rights Reserved.

## Contents

•	Instructions .....	3
1.	Front Panel of the Monitor .....	4
2.	Remote Control .....	4
3.	SETUP Menu .....	5
	3-1 Picture .....	5
	3-2 Function .....	5
4.	Installation .....	6
	4.1 Installation of the Camera .....	6
	4.2 Specification .....	7
•	LIMITED 2 YEAR WARRANTY .....	8
•	HOW TO OBTAIN FACTORY SERVICE .....	8

## Important safety precautions

- Do not watch and operate the monitor while driving. It may cause a car accident because of the distraction.
- Do not install the monitor on a place where obstruct the driver's viewing or near and airbag device.
- Prevent any foreign objects or liquid from entering into the product. In case of that, turn the power off immediately, and contact an authorized dealer to inspect and test the product.
- Place the product away from direct sunlight or hot sources.
- To reduce the risk of fire or electric shock, do not expose this product to rain or moisture.
- Refer servicing to qualified personnel only.
- Do not change or modify this product, the warranty terms will be voided.

## Features

- 7" TFT LCD Wide Screen
- Water proof & Rugged Steel Construction
- High resolution
- Switch-able Normal/Mirror image
- 2 camera inputs
- 1 Audio input
- Adjustable mounting bracket
- Operating temperature -12°F to 120°F
- On Screen Display (OSD)
- IR Remote Controller

## 1. Front Panel of the Monitor

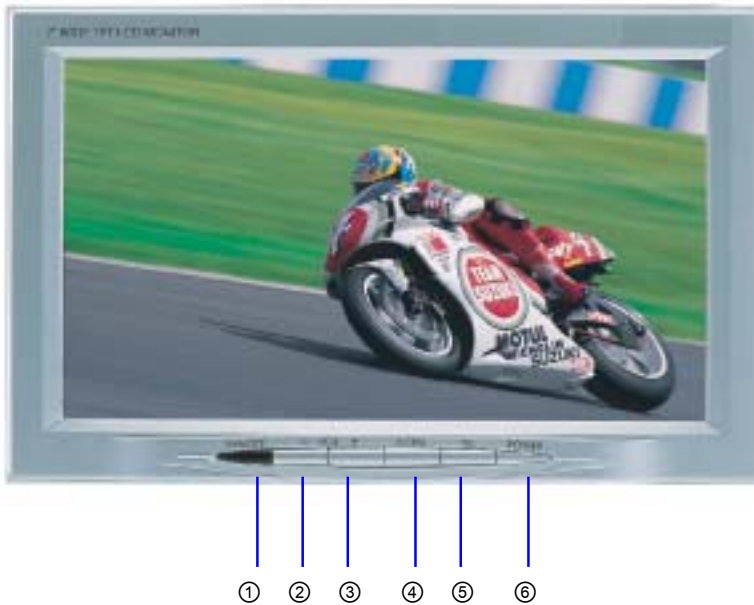

- ① Receiver for Remote Controller
- ② ▼ Button: Press to change menu values
- ③ ▲ Button: Press to change menu values
- ④ SEL Button: Press to navigate the menu items
- ⑤ MENU Button: Press to display the OSD Menu (PICTURE-FUNCTION-PICTURE)
- ⑥ Power On/Off Switch

## 2. Remote Controller

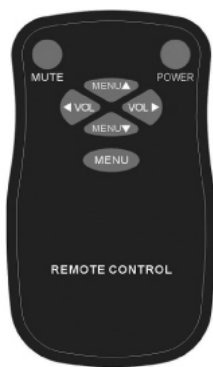



- ① MUTE Button: Press to temporarily cut off the sound
- ② POWER Button: Power On/Off
- ③ MENU Button: Press to display the OSD menu (PICTURE-FUNCTION-PICTURE)
- ④ VOL ◀▶ Button: Press to change menu values
- ⑤ MENU ▼▲ Button: Press to navigate the menu items

### 3. SETUP Menu

#### 3-1 PICTURE

Press the Menu button to go into the PICTURE Setup menu.

PICTURE	
<b>BRIGHTNESS</b>	<b>50</b>
<b>CONTRAST</b>	<b>50</b>
<b>SHARPNESS</b>	<b>50</b>
<b>COLOR</b>	<b>50</b>
<b>TINT</b>	<b>50</b>
<b>UD FLIP</b>	
<b>LR FLIP</b>	
<b>AV1</b>	<b>NTSC M</b>

#### ■ PICTURE OSD

1. BRIGHTNESS: To adjust the brightness
2. CONTRAST: To adjust the contrast
3. SHARPNESS: To adjust the color
4. COLOR: To adjust the color
5. TINT : To adjust the Tint
6. UD FLIP : Normal or Upside-down image
7. LR FLIP : Normal or Mirror image

**MENU Button** : To display the setup menu

**SEL Button** : To navigate the menu items

**VOL◀▶ Buttons** : To change setup values

#### 3-2 FUNCTION

Press the Menu button twice to go into the SELECT Setup menu.

SELECT	
<b>INPUT</b>	<b>AV1</b>
<b>SYSTEM</b>	<b>NTSC M</b>
<b>DISPLAY MODE</b>	<b>WIDE</b>
<b>AV1</b>	<b>NTSC M</b>

#### ■ SELECT OSD

1. INPUT : Select Video input (Video 1 or 2)
2. SYSTEM : Select System Type (NTSC/PAL/SECOM)
3. DISPLAY MODE : WIDE / NORMAL / ZOOM

- MENU Button : To display setup menu
- SEL Button : To navigate the menu items
- VOL◀▶ Buttons : To change setup values

## 4. INSTALLATION

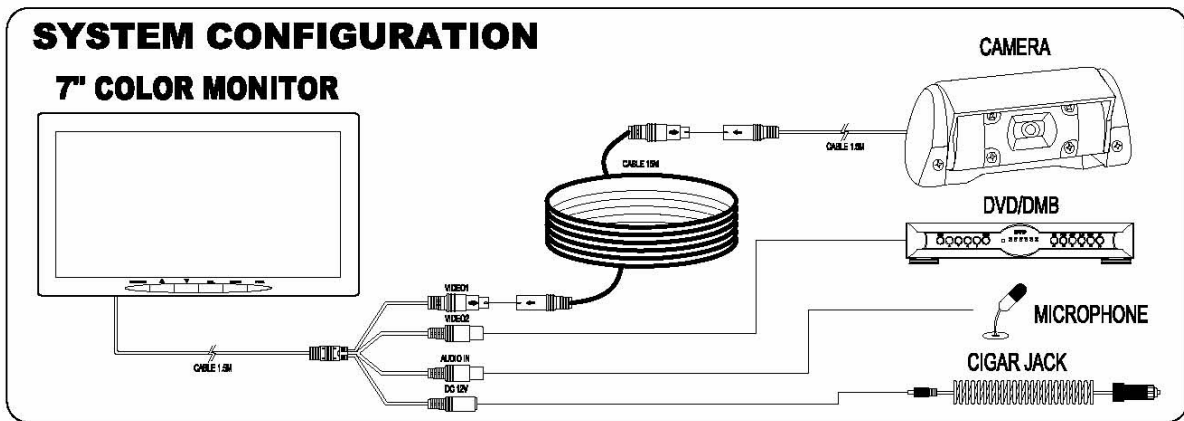

### 4-1. Installation of the Camera

※ HOW TO DISASSEMBLE A CAMERA ※

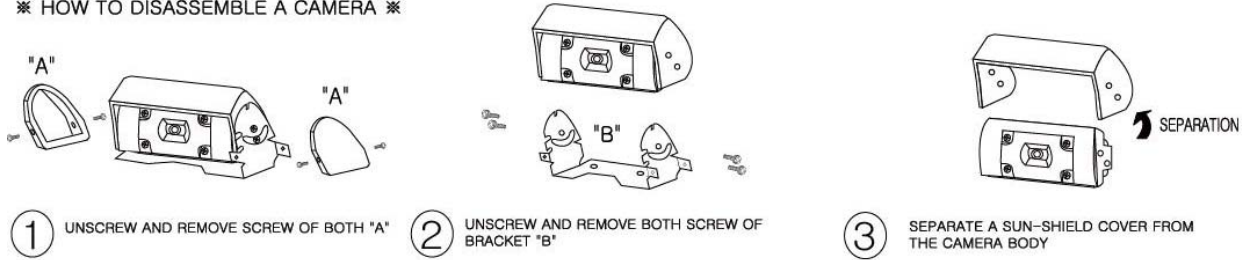

※ HOW TO ASSEMBLE A CAMERA ※

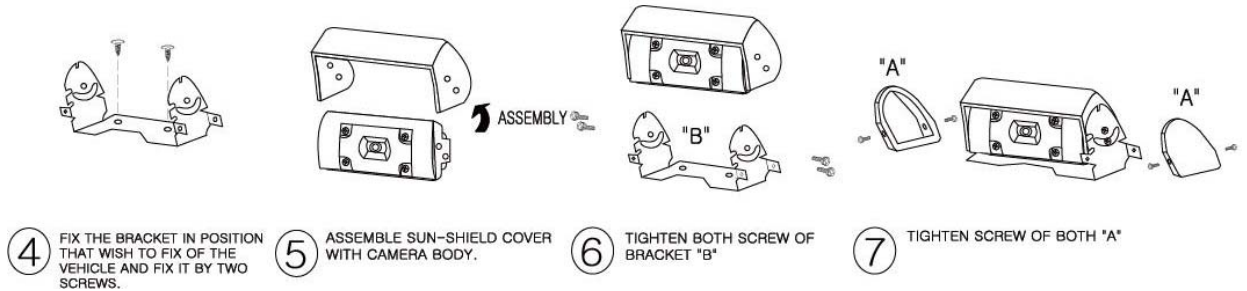

## 4-2. Specifications

### SPECIFICATIONS

MODEL	7" TFT LCD MONITOR
Display Type	7 Inch TFT LCD COLOR DISPLAY
Scanning Line	1440(W) × 234(V)
Pixel Pitch	0.108(H) × 0.376(V)mm <sup>2</sup>
Luminance	300cd/m <sup>2</sup>
Viewing Angle	+45 ~ -65°(V) / +65 ~ -65°(H)
Current Consumption	8W
Features	2 × VIDEO INPUT 1 × BACK VIEW CAMERA(VIDEO2) 1 × DC 12.5V INPUT
Power Source	DC 12V
System	NTSC
Operating Temp	-10°C ~ 50°C
Storage Temp	-20°C ~ 60°C
Dimension	195mm(W) × 127mm(H) × 23mm(D)
Net Weight	550g

MODEL	CAMERA
Image Sensor	1/3" COLOR REAR VIEW CAMERA
Resolution	380 TV Lines
Power Supply	DC 12V 200mA
Operational Temperature	-10 Deg ~+50 Deg C RH 95% Max
Lens	2.9mm 110 Deg
Minimum Illumination	1 Lux
S/N Ration	46dB
Electronic Shutter Time	1/50 ~ 1/6,000
Video Output	1.0Vp-p 75 Ohm Composite
Dimension	90mm(W) × 39mm(D) × 43mm(D)
Weight	130g

**Specifications are subject to change without notice.**

### **System Includes**

- 1- 7" TFT LCD Monitor
- 1- Color CCD camera
- 1- 45" Cable
- 1- Remote controller
- 2- Batteries
- 1- Instruction manual
- 1- Warranty registration card

### **Optional Accessories**

TFT7000	7" TFT LCD monitor
RE600	Color CCD camera

### **LIMITED 2YEAR WARRANTY**

This warranty gives the original purchaser specific legal rights and you may also have other rights, which vary from state to state. If our products do not function because of any defect in material or workmanship, we will repair free for 2 year on parts and labor from the date of original purchase. This warranty does not cover modification, abuse, incidental or consequential damages unless the state of owner's residence



specially prohibits limitations on incidental or consequential damages.

## **HOW TO OBTAIN FACTORY SERVICE**

1. Original purchaser must fill out a warranty card and mail to factory with model number, serial number and the date of purchase.
2. We will repair or replace, and return to owner the system under this limited warranty.
3. Please pack the system carefully and securely using the original packing materials, and send it prepaid and insured to: **13073 E. 166<sup>th</sup> St. Cerritos, CA 90703**.
4. Please include a check for \$30.00 to cover the cost of return postage and handling. If the system is returned within the warranty period, please include a proof of purchase. If the system is out of warranty, you will receive an estimate of the repair cost for your approval before repair work will be started.