

Quick Start Guide

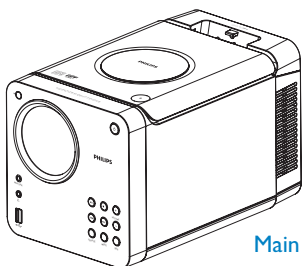

Main unit



1 x MP3 link cable



Remote Control

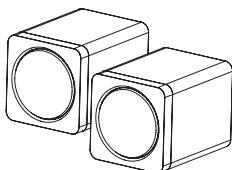

2 x Loudspeaker boxes



User Manual



Quick Start Guide

PHILIPS

A Connect

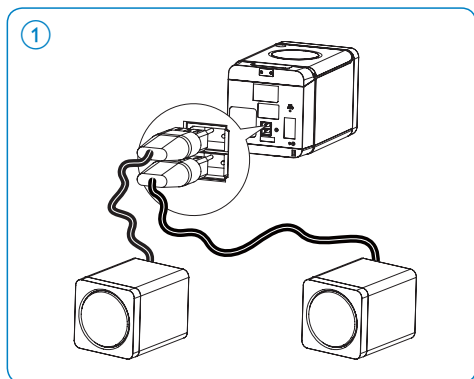

- 1 Fully insert the plugs from the speakers into the speaker sockets on the main unit.

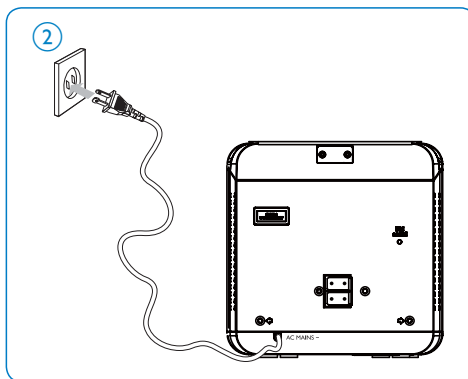

- 1 Connect the power plug to the wall outlet.

B Play discs

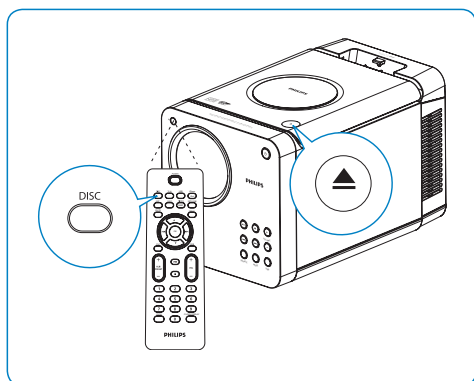

- 1 Press **DISC** on the remote control to select the disc source.
 - 2 Press **▲** on the top panel of the unit.
 - 3 Place a disc onto the tray and press **▲** again.
 - ↳ Ensure that the label side faces upwards.
 - ↳ Play starts automatically.
- If play does not start, press **◀◀▶▶** to select a track and then press **▶||**.

C Play from USB

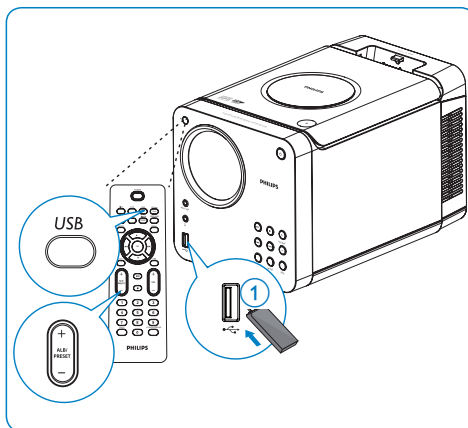

- 1 Insert the USB plug of a USB device into the **USB** socket on the main unit.
- 2 Press **USB** to select the USB source.
- 3 Press **ALB/PRESET+/-** to select a folder.
- 4 Press **◀◀▶▶** to select a file.
- 5 Press **▶||** to start play.

D Play from iPod/iPhone

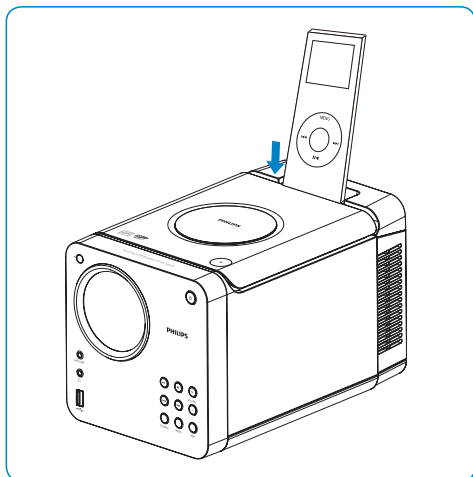

- 1 Place the iPod/iPhone in the dock.
 ↳ The main unit switches to iPod/iPhone mode automatically and start playback.

E Listen to radio

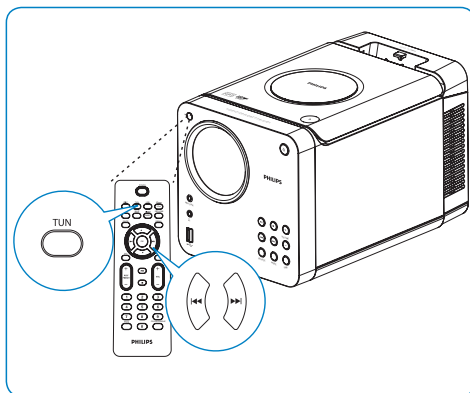

- 1 Press **TUN** to select FM.
- 2 Press and hold **FM/AM** for more than 2 seconds.
- 3 Repeat step 2 to tune to more stations.
 - To tune to a weak station, press **FM/AM** repeatedly until you find optimal reception.

F Set clock

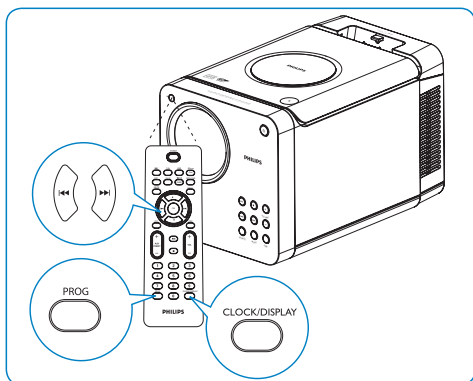

- 1 Press and hold **CLOCK/DISPLAY** to activate the clock setting mode.
- 2 Press **PROG** repeatedly to select 12 hour or 24 hour format.
- 3 Press **CLOCK/DISPLAY** to confirm.
- 4 Press **FM/AM** to set the hour.
- 5 Press **CLOCK/DISPLAY** to confirm.
- 6 Press **FM/AM** to set the minute.
- 7 Press **CLOCK/DISPLAY** to confirm.



© 2010 Koninklijke Philips Electronics N.V.
All rights reserved.

