

# IMPORTANT SAFETY INSTRUCTIONS

When using electrical appliances, especially when children are present, basic safety precautions should always be followed, including the following:

## READ ALL INSTRUCTIONS BEFORE USING

## KEEP AWAY FROM WATER

**DANGER** — Any appliance is electrically live even when the switch is off.

- To reduce the risk of death by electric shock:
1. Always “unplug it” immediately after using.
  2. Do not use while bathing, or in a shower.
  3. Do not place or store appliance where it can fall or be pulled into a tub or sink.
  4. Do not place in, or drop into, water or other liquid.
  5. If an appliance falls into water, “unplug it” immediately. **Do not reach into the water.**

**WARNING** — To reduce the risk of burns, electrocution, fire, or injury to persons:

1. **This appliance should never be left unattended when plugged in.** Do not pull, twist, or wrap line cord around appliance.
2. Close supervision is necessary when this appliance is used by, on, or near children or individuals with certain disabilities.
3. Use this appliance only for its intended use as

- described in this manual. Do not use attachments not recommended by the manufacturer.
4. **Never operate this appliance if it has a damaged cord or plug, if it is not working properly, or if it has been dropped, damaged, or dropped into water. Return the appliance to an authorized service center for examination and repair.**
  5. Keep the cord away from heated surfaces.
  6. Never use while sleeping.
  7. Never drop or insert any object into any opening or hose.
  8. Do not use outdoors or operate where aerosol (spray) products are being used or where oxygen is being administered.
  9. Do not use an extension cord with this appliance.
  10. This unit is hot when in use. Do not let heated surfaces touch eyes and bare skin.
  11. Do not touch hot surfaces of the appliance. Use handles or knobs.
  12. Do not place the heated unit directly on any surface while it is hot or plugged in.
  13. Never block the air openings of the appliance or place it on a soft surface, such as a bed or couch, where the air openings may be blocked. Keep the air openings free of lint, hair, and the like.

## SAVE THESE INSTRUCTIONS OPERATING

# INSTRUCTIONS

This curling appliance is intended for household use. Use on Alternating Current (60 hertz) only. Standard curling appliances are designed to operate at 120 volts AC.

This appliance has a polarized plug (one blade is wider than the other). As a safety feature this plug will fit in a polarized outlet only one way. If the plug does not fit fully in the outlet, reverse the plug. If it still does not fit, contact a qualified electrician. Do not attempt to defeat this safety feature.

## GENERAL INSTRUCTIONS

- Before using **Shiny Styles™ Iron**:
1. Place unit on a firm surface for safety.
  2. Select and change plates before heating unit. **NEVER CHANGE PLATES WHEN HOT!!!** To change plates, simply hold the side button down as you slide the plates off the unit (diagram 1). Replace desired plates by aligning the grooves on the bottom of the plate with the unit. The plate should click into place and be flush with the unit.
  3. Plug unit in, allowing 20 - 25 minutes for optimum heat.
  4. Use **Shiny Styles™ Iron** on dry hair. You can use mousse, gel and other hair preparations before or after using **Shiny Styles™ Iron** to achieve the look you desire.

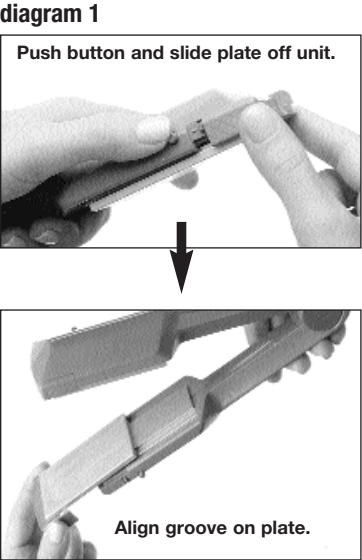

- STYLING WITH Shiny Styles™ Iron**
1. **Deep wave plates:** Deep wave plates can be used on the entire head or on small sections of hair. **Shiny Styles™ Iron** works well on wavy hair, giving it a more uniform glamorous look, and on straight hair, giving it body and texture. Take one small section of hair at a time, place it between plates, and gently press the plates shut. Always work from the roots toward the end of the hair. Keep plates closed for 5 - 10 seconds. Release that section of hair and reposition the styler so that the next crimp falls in line with the first.

2. **Straight plates:** The straightener is designed to smooth unwanted curl or frizz, to shape and straighten your hair in the latest stunning styles. Take one small section of hair at a time. Pull the hair downward and hold taut. Starting at the root, run the straightener down the hair in one smooth movement. Keep the strands of hair smooth while you work, to avoid ridges.

- Removable combs:** Your straightening iron includes two removable comb attachments. The natural boar and nylon bristle comb will help to provide tension and guide your hair as you use the straightening iron. To remove or attach the comb, turn unit off and allow unit to cool. Hold unit firmly with one hand; with your other hand, slide comb away from the iron. When replacing the comb, align the comb with the slot on the side of the iron and slide comb into position. Make sure the comb securely locks into position.
3. **Micro crimp plates:** Similar to the deep wave plate, the micro crimp plate can be used on the entire head or on small sections of hair, to

- give it volume and texture.
4. **Star imprint plate:** First choose a spot where you'd like to 'print' a star on your hair. A strand near your face, or a pair — one on each side of your face — or a strand of hair directly in the back is a good spot, but use your imagination. One star imprint makes a good 'shining impression', but if you have hair long enough, several looks great. Close the iron over the strand of hair to be imprinted, hold for about 5-10 seconds and release. Add a little gel or mousse to the strand before or after you 'print' and the impression will last longer. Spray helps too.

**Combinations:** Mix and match shiny strands with micro crimp strands and/or stars. Experiment with different styles, using only one plate or a combination of different plates.

## GET TO KNOW YOUR IRON

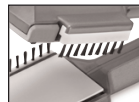

Removable natural boar & nylon bristle brush attachment



1. Straight Plate 2. Deep Wave Plate  
3. Star Plate 4. Micro Crimp Plate

## USER MAINTENANCE

Your styling iron is virtually maintenance-free. No lubrication is needed. If cleaning becomes necessary, disconnect the unit from the power source and wipe exterior with a damp cloth. If any abnormal condition occurs, unplug the unit, allow it to cool, and return it to an authorized service representative only. No repairs should be attempted by the consumer.

### CAUTION

**NEVER** allow the power supply cord to be pulled, twisted, or severely bent. **Never** wrap the cord tightly around the iron. Damage will occur at the high flex point of entry into the iron, causing it to rupture and short. Inspect the cord frequently for damage. **Stop use immediately if damage is visible or unit stops or operates intermittently.**

### STORAGE

When not in use, your iron is easy to store. Allow unit to cool, then simply put back in the box and store out of reach of children in a safe, dry location. Do not jerk or strain cord at plug connections.

**WARNING:  
IF YOU THINK  
THE POWER IS OFF  
WHEN THE SWITCH  
IS OFF,  
YOU'RE WRONG.**

### KEEP AWAY FROM WATER

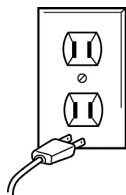

Everyone knows that electricity and water are a dangerous combination. But did you know that an electric appliance is still electrically live even if the switch is off? If the plug is in, the power is on. So when you are not using your appliances, keep them unplugged.

### ALWAYS UNPLUG SMALL APPLIANCES

A Public Service Ad from the Association of Home Appliance Manufacturers and Underwriters Laboratories, Inc.

## LIMITED ONE YEAR WARRANTY

Conair will repair or replace your appliance, at our option, for twelve months from the date of purchase if the appliance is defective in workmanship or materials.

To obtain service under this warranty, return the defective product to the service center nearest you, together with your sales slip and \$3.00 for postage and handling. California residents need only provide proof of purchase and should call 1-800-3CONAIR for shipping instructions.

**This warranty excludes all incidental or consequential damages. Some states do not allow the exclusion or limitation of these damages, so these exclusions may not apply to you. All applicable implied warranties, including the implied warranty of merchantability and fitness for a particular purpose, given to you by law are hereby limited in duration to this warranty.**

This warranty gives you specific legal rights, and you may also have other rights which vary from state to state.

For out of warranty service: Please bring or send defective unit with sales slip to the nearest service center listed below.

### SERVICE CENTERS:

#### CONAIR CORPORATION

Service Department  
150 Milford Road  
East Windsor, NJ 08520

#### CONAIR CORPORATION

Service Department  
7475 N. Glen Harbor Blvd.  
Glendale, AZ 85307

©2003 CONAIR CORPORATION

150 Milford, Road, East Windsor, NJ 08520  
7475 N. Glen Harbor Blvd., Glendale, AZ, 85307  
www.conair.com  
03PC2209

  
**Shiny Styles™**  
4 in 1 shiny straight waver



Instruction/Styling  
Guide

Model CS9ACS

IB-4941