

[Quick Start Guide]



Purchasers of OEM products should consult with the OEM for support.

Please feel free to contact your QLogic approved reseller or QLogic Technical Support at any phase of integration for assistance. QLogic Technical Support can be reached by the following methods:

Web

<http://support.qlogic.com>

E-mail

support@qlogic.com

The QLogic knowledge database contains troubleshooting information for the QLogic host bus adapters. Access the data base from the QLogic Support Web page, <http://support.qlogic.com>. Use the Support Center search engine to look for specific troubleshooting information.

Products Affected

Product Name	Part Number
QLA4050	IS0710404
QLA4050C	IS0710407
QLA4052C	IS0710407
QLA4060C	IX4010402
QLA4062C	IX4010402

Quick Start Guide

Installation Instructions

This Quick Start Guide describes how to install and configure your new QLogic host bus adapter in four simple steps:

- Step 1. Verify the package contents.
- Step 2. Install the adapter hardware.
- Step 3. Install the adapter driver.
- Step 4. Install the SANsurfer iSCSI HBA Manager application.



Keep the host bus adapter in the antistatic bag until installation. The host bus adapter contains parts that can be damaged by electrostatic discharge (ESD). Before handling the host bus adapter, use standard methods to discharge static electricity. Place the host bus adapter on the bag when examining it. Retain the bag for future use.

Step 1. Verify the Package Contents

The QLogic host bus adapter is shipped with the following items:

- QLogic adapter
- Low-profile bracket (not available in all models)



Step 2. Install the Adapter Hardware

NOTE: When installing the QLogic host bus adapter and driver in a Solaris system that does not already have QLogic adapters or drivers installed, please install the QLogic Solaris driver before you install the QLogic adapter hardware. This allows Solaris to correctly bind the QLogic Solaris driver to the QLogic adapter. Failure to do so will require an additional system reboot after the driver is loaded.

To install the adapter hardware, you need to open the computer and locate the appropriate bus slot. If necessary, consult your computer system manual for instructions to remove the computer cover.

Follow these steps to install the adapter hardware:

1. Power off the computer and all attached devices such as monitors, printers, and external components.
2. Disconnect the power cable.
3. Remove the computer cover and find an empty bus slot.
4. Pull out the slot cover (if any) by removing the screw or releasing the lever.
5. Install the low-profile bracket (if required).
6. Grasp the adapter by the top edge and seat it firmly into the slot (see [Figure 1](#)).
7. Refasten the adapter's retaining bracket using the existing screw or lever.
8. Close the computer cover.
9. Plug in the power cable and turn on the computer.

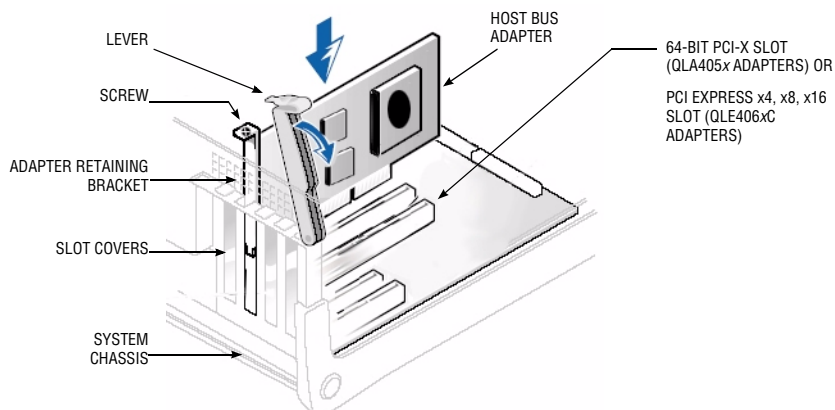

Figure 1. Illustration of Server Motherboard and Slots

Step 3. Install the Adapter Driver

To install the adapter drivers:

1. Go to the QLogic Driver Downloads/Documentation page at <http://driverdownloads.qlogic.com>.
2. Click **QLogic Products**.
3. From the table at the bottom of the page, select **iSCSI Adapters**, the appropriate adapter model, and your operating system, and then click **Go**. The product download page opens.
4. On the download page under **Drivers**, select the appropriate driver and download it to your system.
5. Follow the instructions in the driver readme file for installing the downloaded driver.

Step 4. Install the SANsurfer iSCSI HBA Manager Application

To install the SANsurfer iSCSI HBA Manager application:

1. Go to the QLogic Driver Downloads/Documentation page at <http://driverdownloads.qlogic.com>.
2. Click **QLogic Products**.
3. From the table at the bottom of the page, select **iSCSI Adapters**, the appropriate adapter model, and your operating system, and then click **Go**. The product download page opens.
4. On the download page under **Management Tools**, select **SANsurfer iSCSI HBA Manager** and download it to your system.
5. Follow the instructions in the iSCSI HBA Manager readme file for installing the downloaded software.

Additional Resources

- To obtain the most current drivers, management applications, user instructions, and documentation, please visit the QLogic Web site at <http://driverdownloads.qlogic.com> and download the latest versions.
- For descriptions and procedures related to SANsurfer iSCSI HBA Manager, use the built-in help system.
- The following section contains additional information about the QLogic adapter, including the LED scheme, warranty, and laser safety certification information.

Adapter LEDs

Table 1. QLogic QLA4050 Host Bus Adapter LED Scheme

Green LED	Activity
On	Link established

Table 2. QLogic QLA4050C/4052C and QLE4060C/4062C Host Bus Adapter LED Scheme

Green LED	Activity
On	Link established
Flashing	Receive/transmit activity

Warranty

For warranty details, please check the QLogic Web site at <http://www.qlogic.com/Support/Pages/Warranty.aspx>.

Laser Safety

FDA Notice

This product complies with DHHS Rules 21CFR Chapter I, Subchapter J. This product has been designed and manufactured according to IEC60825-1 on the safety label of laser product.

Class 1 Laser Product
Appareil laser de classe 1
Produkt der Laser Klasse 1
Luokan 1 Laserlaitte

Caution—Class 1 laser radiation when open
Do not view directly with optical instruments

Attention—Radiation laser de classe 1
Ne pas regarder directement avec des instruments optiques

Vorsicht—Laserstrahlung der Klasse 1 bei geöffneter Abdeckung
Direktes Ansehen mit optischen Instrumenten vermeiden

Varoitus—Luokan 1 lasersäteilyä, kun laite on auki
Älä katso suoraan laitteeseen käyttämällä optisia instrumenttejä

CLASS I LASER

Agency Certification
QLogic Adapters

The following sections contain a summary of EMC/EMI test specifications performed on the QLogic host bus adapters to comply with radiated emission, radiated immunity, and product safety standards:

EMI and EMC Requirements

FCC Part 15 compliance: Class B

FCC compliance information statement: This device complies with Part 15 of the FCC Rules. Operation is subject to the following two conditions: (1) this device may not cause harmful interference, and (2) this device must accept any interference received, including interference that may cause undesired operation.

ICES-003 compliance: Class B

This Class B digital apparatus complies with Canadian ICES-003.
Cet appareil numérique de la classe B est conforme à la norme NMB-003 du Canada.

CE Mark 89/336/EEC EMC Directive compliance:

EN55022:1998/CISPR22:1997—Class B
EN55024:1998

- Immunity Standards
IEC61000-4-2 : ESD
IEC61000-4-3 : RF Electro Magnetic Field
IEC61000-4-4 : Fast Transient/Burst
IEC61000-4-5 : Fast Surge Common/ Differential
IEC61000-4-6 : RF Conducted Susceptibility
IEC61000-4-8 : Power Frequency Magnetic Filed
IEC61000-4-11 : Voltage Dips and Interrupt
IEC61000-3-2 : Harmonic Current Emission
IEC61000-3-3 : Voltage Fluctuation and Flicker

VCCI compliance: Class B

AS/NZS CISPR22 compliance: Class B

CNS 13438 compliance: Class B

MIC compliance: Class B

- Korea MIC Class B Certified



Product Name/Model	iSCSI host bus adapter
Certification holder	QLogic Corporation
Manufactured date	Refer to date code listed on product
Manufacturer/Country of origin	QLogic Corporation/USA

B class equipment (Household purpose info/telecommunications equipment)	As this equipment has undergone EMC registration for household purpose, this product can be used in any area including residential area.
--	--

- Korean Language Format— Class B

B급 기기 (가정용 정보통신기기)

이 기기는 가정용으로 전자파적합등록을 한 기기로서
주거지역에서는 물론 모든지역에서 사용할 수 있습니다.

Product Safety Compliance

UL, cUL product safety compliance:

UL60950

CSA C22.2 No.60950

Class 1 Laser Product per DHHS 21CFR (J)

Complies with 21 CFR 1040.10 and 1040.11

Use only with listed ITE or equivalent.

73/23/ECC low voltage directive:

TUV:

-EN60950-1:2001

-EN60825-1

-EN60825-2

© 2005–2011 QLogic Corporation. QLogic, the QLogic logo, and SANsurfer are trademarks or registered trademarks of QLogic Corporation. All other brands and product names are trademarks or registered trademarks of their respective owners. Information supplied by QLogic is believed to be accurate and reliable. QLogic Corporation assumes no responsibility for any errors in this brochure. QLogic Corporation reserves the right, without notice, to make changes in product design or specifications



Corporate Headquarters

QLogic Corporation
26650 Aliso Viejo Parkway
Aliso Viejo, CA 92656
949.389.6000 www.qlogic.com

International Offices

UK | Ireland | Germany | France
India | Japan | China
Hong Kong | Singapore | Taiwan



IS0054501-00 E