



INSTALLATION INSTRUCTIONS FOR PART 95-7951

APPLICATIONS
CHEVROLET
Aveo 2004-2006
Aveo Hatchback-2007
SUZUKI
Forenza 2004-2008
Reno 2005-2008
Verona 2004-2007
PONTIAC
G3 Hatchback-2007

95-7951

KIT FEATURES

- Double DIN Radio Provision
- Stacked ISO Mount Units Provision



KIT COMPONENTS

A) Double DIN Trim Plate • B) Double DIN Brackets

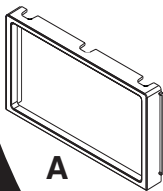

A

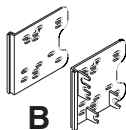

B

WIRING AND ANTENNA CONNECTIONS
(Sold Separately)

Wiring Harness:

- 70-2105 - GM harness 2006-up
- 70-8405 - GM/Suzuki/Daewoo harness 1999-up

Antenna Adapter:

- 40-CR10 - Chrysler antenna adapter 2002-up

TOOLS REQUIRED:

Small Flat Blade Screwdriver/ Panel Removal Tool

- Phillips Screwdriver



1-800-221-0932



www.metraonline.com

© COPYRIGHT 2004-2009 METRA ELECTRONICS CORPORATION



TABLE OF CONTENTS

Dash Disassembly

- Chevrolet Aveo Hatchback 2007.....1**
- Chevrolet Aveo 2004-20061**
- Suzuki Forenza 2004-2008 / Suzuki Reno 2005-20082**
- Suzuki Verona 2004-20073**
- Pontiac G3 Hatchback 20071**

Kit Assembly

- Double DIN Mount Radio Provision4**
- Stacked ISO Mount Units Provision 5**

***Note:**

Refer also to the instructions included with the aftermarket radio.



KNOWLEDGE IS POWER

Enhance your installation and fabrication skills by enrolling in the most recognized and respected mobile electronics school in our industry. Log onto www.installerinstitute.com or call 800-354-6782 for more information and take steps toward a better tomorrow.

CHEVROLET AVEO 2004-2006
CHEVROLET AVEO HATCHBACK 2007
PONTIAC G3 HATCHBACK 2007

- 1** Disconnect the negative battery terminal to prevent an accidental short circuit.
- 2** Unclip and remove the trim panels from both sides of radio/climate controls. (Figure A)
- 3** Remove (4) Phillips screws securing the radio. Unplug and remove radio. (Figure B)

Continue to kit assembly.

A

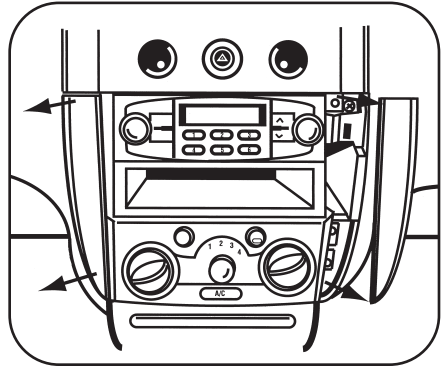

B

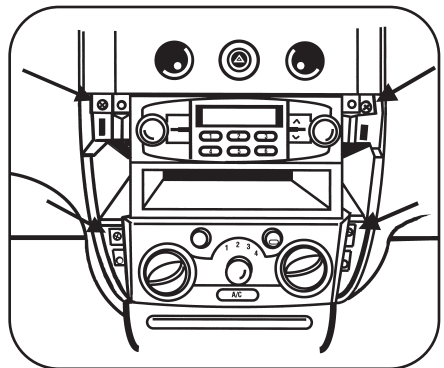

SUZUKI FORENZA 2004-2008 SUZUKI RENO 2005-2008

- 1 Disconnect the negative battery terminal to prevent an accidental short circuit.
- 2 Disconnect air selector cable on driver's side of center console behind dash above accelerator pedal. (Figure A & B)
- 3 Open glove box and remove (5) Phillips screws ((3) on top and (2) on bottom) then remove entire glove box.
- 4 Disconnect temperature selector cable on passenger side of center console behind glove box. (Figure C)
- 5 Unsnap and remove entire panel surrounding radio. **NOTE:** The clips holding radio panel to dash are very strong. (Figure D)
- 6 Remove (4) 10 MM bolts securing radio. Unplug and remove radio. (Figure E)

Continue to kit assembly.

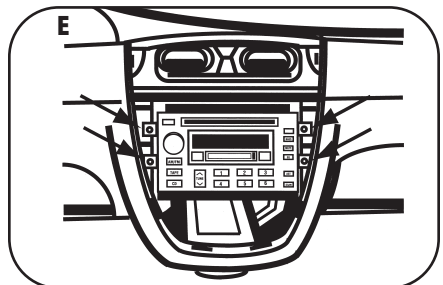
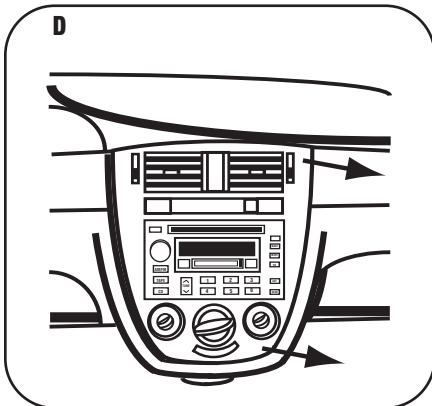
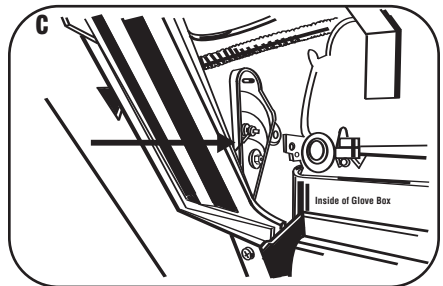
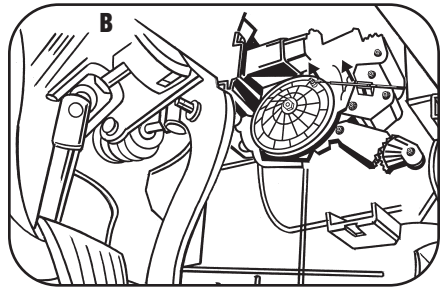
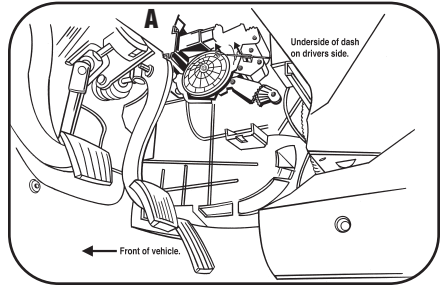

SUZUKI VERONA 2004-2007

- 1 Disconnect the negative battery terminal to prevent an accidental short circuit.
- 2 Unclip and remove the trim panel surrounding the radio. (Figure A)
- 3 Remove (4) Phillips screws from radio. Unplug and remove radio. (Figure B)

Continue to kit assembly.

A

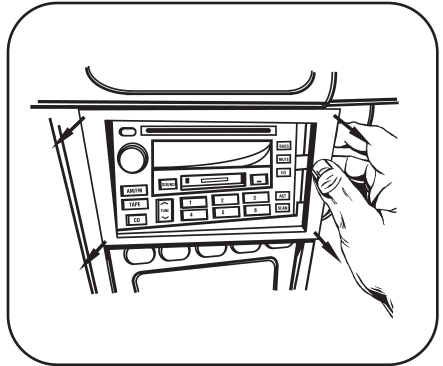

B

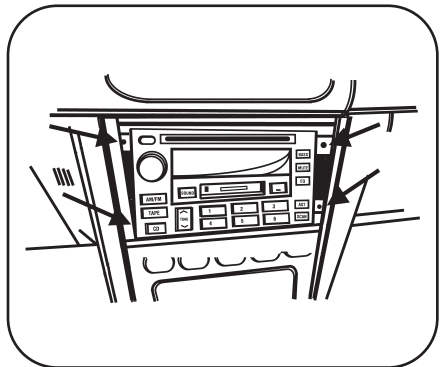

DOUBLE DIN MOUNT RADIO PROVISION

**Note: Refer also to the instructions included with the aftermarket radio.*

NOTE: For the **Chevrolet Aveo 2004-06**, **Chevrolet Aveo Hatchback 2007**, **Pontiac G3 Hatchback 2007** and **Suzuki Verona 2004-07**, cut and remove front lower mounting tabs from the Double DIN trim plate (**Figure A**). For the **Suzuki Forenza 2004-07** and the **Suzuki Reno 2005-07**, cut the rear lower mounting tabs (**Figure B**).

NOTE: The **Verona 2004-2007** sub dash will need to be trimmed slightly for proper fit. Refer to illustration. (**Figure C,D**)

- 1 Snap the Double DIN brackets to the outside edge of the Double DIN trim plate. (**Figure E**)
- 2 Slide the Double DIN radio into the bracket/trim plate assembly and secure the radio to the assembly using the screws supplied with the radio. (**Figure F**)

Continue to final assembly.

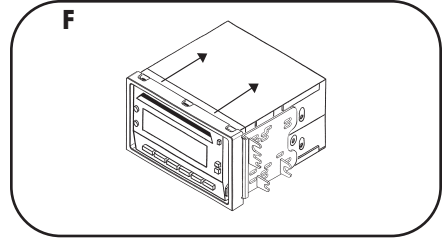
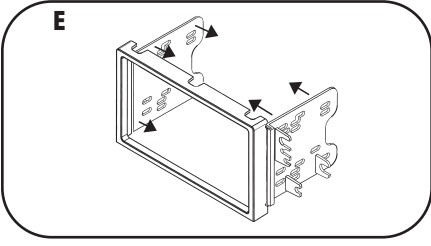
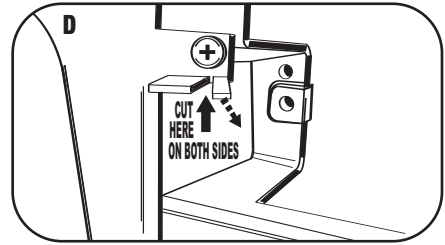
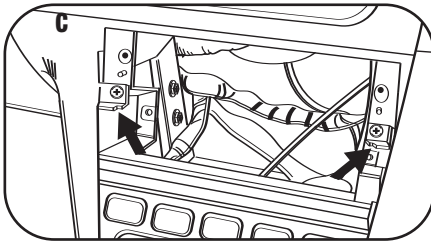
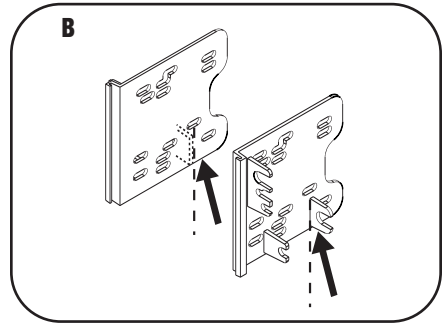
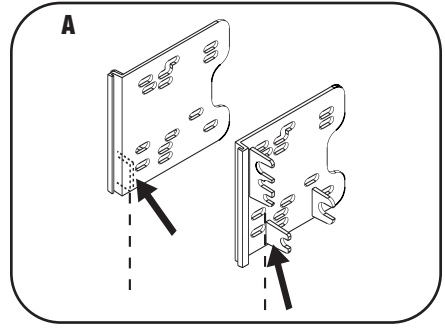

STACKED ISO MOUNT UNITS PROVISION

**Note: Refer also to the instructions included with the aftermarket radio.*

NOTE: For the **Chevrolet Aveo 2004-06**, **Chevrolet Aveo Hatchback 2007**, **Pontiac G3 Hatchback 2007** and **Suzuki Verona 2004-07**, cut and remove front lower mounting tabs from the Double DIN trim plate (**Figure A**). For the **Suzuki Forenza 2004-07** and the **Suzuki Reno 2005-07**, cut the rear lower mounting tabs (**Figure B**).

NOTE: The **Verona 2004-2007** sub dash will need to be trimmed slightly for proper fit. Refer to illustration.

(**Figure C,D**)

- 1 Snap the Double DIN brackets to the outside edge of the Double DIN trim plate. (**Figure E**)
- 2 Slide the stacked ISO units into the bracket/trim plate assembly and secure the units to the assembly using the screws supplied with the units.e (**Figure F**)

Continue to final assembly.

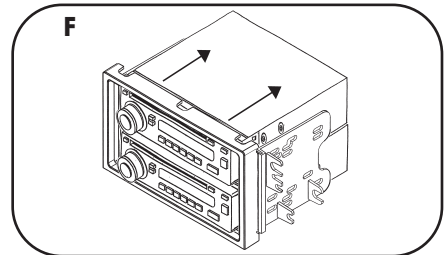
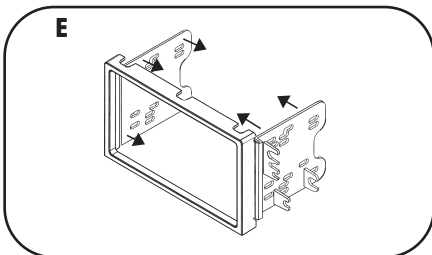
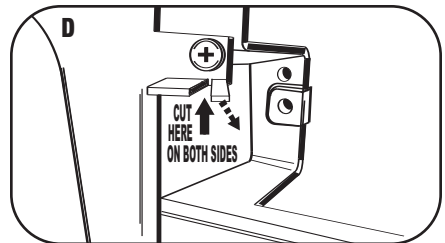
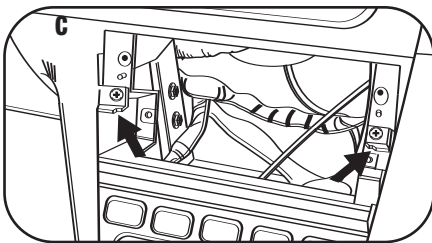
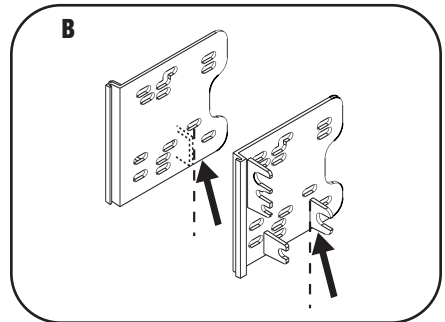
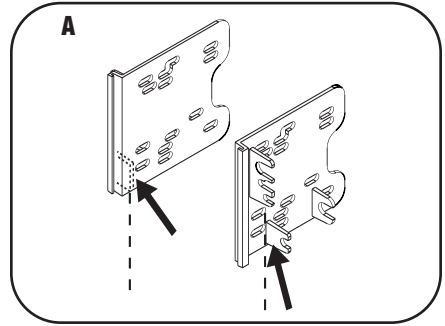



FINAL ASSEMBLY

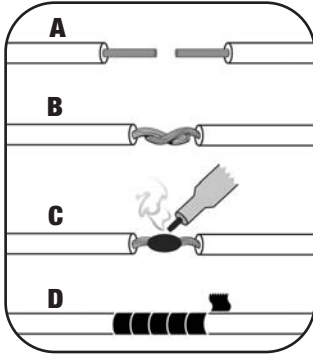

(A) Strip wire ends back 1/2"

B) Twist ends together

C) Solder

D) Tape

- 1 Locate the factory wiring harness in the dash. Metra recommends using the proper mating adapter and making connections as shown. (Isolate and individually tape off the ends of any unused wires to prevent electrical short circuit.)
- 2 Re-connect the negative battery terminal and test the unit for proper operation.
- 3 Reassemble radio and dash assemblies in reverse order of disassembly.

FINAL WIRING CONNECTIONS

Make wiring connections using the EIA color code chart shown below and the instructions included with the head unit. Metra recommends making connections as shown below; Strip, Splice, Solder, Tape. Isolate and individually tape off ends of any unused wires to prevent electrical short circuit.

METRA / EIA WIRING CODE

12V Ignition / Acc.	Red	Right Front (+)	Gray
12V Batt / Memory	Yellow	Right Front (-)	Gray/ Black
Ground	Black*	Left Front (+)	White
Power Antenna	Blue	Left Front (-)	White / Black
Amp Turn-On	Blue / White	Right Rear (+)	Violet
Amp Ground	Black / White	Right Rear (-)	Violet / Black
Illumination	Orange	Left Rear (+)	Green
Dimmer	Orange / White	Left Rear (-)	Green / Black

*NOTE: When a Black wire is not present, ground radio to vehicle chassis.

All colors may not be present on all leads due to manufacturer's specifications.



1-800-221-0932



www.metraonline.com