

KENWOOD

MICRO HI-FI COMPONENT SYSTEM

HM-353V

INSTRUCTION MANUAL

KENWOOD CORPORATION



2 Before applying power

 **Caution : Read this page carefully to ensure safe operation.**

Units are designed for operation as follows.

..... AC 110-120 / 220-240 V switchable

AC voltage selection

The AC voltage selector switches on the rear panel are set to the voltage that prevails in the area to which the unit is shipped. Before connecting the power cord to your AC outlet, make sure that the setting positions of these switches match your line voltage. If not, they must be set to your voltage in accordance with the following direction.

AC voltage selector switches

Move switch lever to match your line voltage with a small screwdriver or other pointed tool.

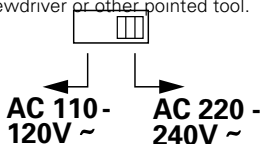

Note:

Our warranty does not cover damage caused by excessive line voltage due to improper setting of the AC voltage selector switch.

Safety precautions

WARNING : TO PREVENT FIRE OR ELECTRIC SHOCK, DO NOT EXPOSE THIS APPLIANCE TO RAIN OR MOISTURE.



CAUTION
RISK OF ELECTRIC SHOCK
DO NOT OPEN



CAUTION: TO REDUCE THE RISK OF ELECTRIC SHOCK, DO NOT REMOVE COVER (OR BACK). NO USER-SERVICEABLE PARTS INSIDE. REFER SERVICING TO QUALIFIED SERVICE PERSONNEL.



THE LIGHTNING FLASH WITH ARROWHEAD SYMBOL, WITHIN AN EQUILATERAL TRIANGLE, IS INTENDED TO ALERT THE USER TO THE PRESENCE OF UNINSULATED "DANGEROUS VOLTAGE" WITHIN THE PRODUCT'S ENCLOSURE THAT MAY BE OF SUFFICIENT MAGNITUDE TO CONSTITUTE A RISK OF ELECTRIC SHOCK TO PERSONS.



THE EXCLAMATION POINT WITHIN AN EQUILATERAL TRIANGLE IS INTENDED TO ALERT THE USER TO THE PRESENCE OF IMPORTANT OPERATING AND MAINTENANCE (SERVICING) INSTRUCTIONS IN THE LITERATURE ACCOMPANYING THE APPLIANCE.

The marking of products using lasers (Except for some areas)

**CLASS 1
LASER PRODUCT**

CAUTION
INVISIBLE LASER RADIATION
WHEN OPEN. AVOID EXPOSURE
TO BEAM.

The marking is located on the rear panel and says this product has been classified as Class 1. It means that there is no danger of hazardous radiation outside the product

Inside this laser product, a laser diode(s) exceeding Class 1 laser radiation is/are contained as alerted by the internal caution label shown above. To avoid exposure to laser beams, do not open the cover.

Special features

This unit can play back CD-DA (CD, CD-R), VIDEO CD and MP3 file.

Playback capability of CD-R discs

This unit can play back music data recorded in CD-R (Compact Disc Recordable) as well as audio CD (CD-DA). However, some CD-R discs may not be playable on this CD player. Also note that a CD-R disc which has not been finalized cannot be played back.

Playback capability of MP3 files

This unit can play back disc media containing MP3 files. However, some disc media may not be playable on this CD player. Also note that a disc medium the MP3 session in which has not been closed or a non-finalized disc medium cannot be played back.

Playback capability of normal VIDEO CD

This unit can play back conventional Version 2.0 VIDEO CDs(VCD).

Convenient recording features (for TAPE)

Versatile recording features are provided, allowing the user to select desired one for each purpose.

- **One-touch recording :**

Pressing a single key starts recording of all tracks or a single track in a CD (CD-DA, the audio of VIDEO CD with PBC OFF).

- **Program recording :**

Your favorite tracks can be recorded in any desired order. (CD-DA, the audio of VIDEO CD with PBC OFF)

Versatile timer features

- **O.T.T. (Operate easy To use Timer) :**

This timer setting is executed only for an hour (and for once) when the set start time comes.

- **Timer playback, timer recording :**

Two timer programs (PROG.1, PROG.2) are available for timer playback (AI timer playback) or timer recording. (With the AI timer playback, the playback volume increases gradually after the start of timer playback.)

- **Sleep timer :**

This timer turns the unit off automatically when the set time has elapsed. It is convenient for example for falling asleep while listening to music in the night time, etc.

Unpacking

Unpack the unit carefully and make sure that all the accessories are present.

If any accessories are missing, or if the unit is damaged or fails to operate, notify your dealer immediately. If the unit was shipped to you directly, notify your shipper immediately. Kenwood recommends that you retain the original carton and packing materials in case you need to move or ship the unit in the future.

Keep this manual handy for future reference.

Accessories

Please confirm that the following accessories are present.

Remote control unit (1)

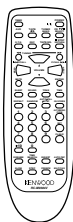

AM loop antenna (1)

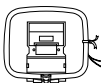

FM indoor antenna (1)



Video Cord (1)



Batteries (R6/AA) (2)



AC plug adaptor (1)



Use to adapt the plug on the power cord to the shape of the wall outlet. (Accessory only for regions where use is necessary.)

In regard to demonstration

This unit is equipped with a demonstration function (only display). The demonstration consists of sequential change of display and indicators showing the operations, but the audio itself does not change. The demonstration function can be cancelled as follows.

"DEMO OFF" (To cancel demonstration):

Press the **set/demo** key during demonstration.

set / demo



"DEMO ON" (To execute demonstration):



After turning power ON, press and hold the **set/demo** key (for more than 2 seconds).

- This operates automatically when a power failure has occurred or the plug of the power cable has been pulled while the power was ON.

Contents

Caution : Read the pages marked  carefully to ensure safe operation.

Preparation section

 Before applying power	2
 Safety precautions	2
Special features	3
System connection	6
Connection of the System Accessories	6
Connection of Other Accessories (Commercially Available Parts)	8
Controls and indicators	9
Display	9
Main unit	10
Operation of remote control unit	12
Before playing a disc	14
Discs which can be played with this unit	14

Basic section

Basic use method	16
Playback of CD-DA (CD, CD-R), MP3 file and the audio of VIDEO CD	18
Playback of TAPE	21
Receiving broadcast station	23
Collective presetting of stations (Auto preset)	24
Channel space setting	24
Tuning a non-preset radio station (Auto tuning, Manual tuning)	25
One-by-one presetting (Manual preset)	25
Recording on TAPE	26

Application section

Various CD (CD-DA, VIDEO CD and MP3 file) playback features	28
Listening to the desired sequence (PGM)	28
Repeated playback (REPEAT)	30
Playing tracks in a random order (RANDOM)	31
Convenient recording methods	32
One-touch edit recording (CD → TAPE)	33
Program recording (CD → TAPE)	34
Playback of MP3 file	35
Important notes on the MP3 file	35
Playback of MP3 file (selecting MP3 file playback)	36
Playback of VIDEO CD	37
Playing back a VIDEO CD using the menu	37
Using the Digest functions	41
Listening to an AUX input source	43
Clock adjustment	44
Timer operation	45
Sleep timer (SLEEP)	45
Setting the O.T.T. timer	46
Setting an everyday timer program (PROG. TIMER)	48

Knowledge sections

Important Items	51
Maintenance	51
Reference	51
In case of difficulty	53
Specifications	56

Connection of the System Accessories

This figure shows the method of connection between the main unit and provided accessories.

CAUTION Note on Connection

Connect the components as shown in the diagram.
Only plug the power cord into a power outlet once connections are completed.

Installation of speakers and positioning of TV

1. The magnet in the speaker may cause color irregularity on the TV. Place the speaker farther away from the TV set.
2. Color irregularities on the TV screen may also be produced depending on the method how the speakers are installed. When color irregularities are observed after the speaker installation, first turn the TV off, wait for 15 to 30 minutes and turn it on again: The interference may be improved by the self-demagnetizing function of the TV. If the color irregularities still remain, install the speakers more apart from the TV.
3. Due to induction by the electromagnetic waves produced by a TV, the speakers may produce sound even when the stereo unit is turned off. In this case also, install the speakers more apart from the TV.

CAUTION

Be sure to adhere to the following, or proper ventilation will be blocked causing damage or fire hazard.

- Do not place any objects impairing heat radiation onto the top of the unit.
- Leave a space around the unit (from the largest outside dimension including projection) equal or greater than, shown below.

Top panel : 50 cm

Back panel : 10 cm

AM loop antenna

The supplied antenna is for indoor use. Place it as far as possible from the main system, TV set, speaker cords and power cord, and set it to a direction which provides the best reception.

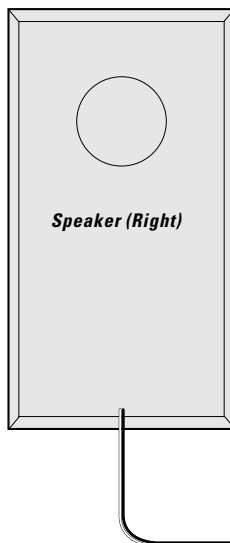
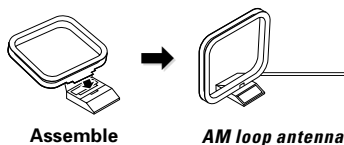

- Never short-circuit the "+" and "-" speaker cords.
- If the "+" and "-" polarity are inverted, the sound will be unnatural with unclear positioning of musical instruments, etc.
- Be sure to insert all connection cords securely. If their connections are imperfect, the sound may not be produced or noise may interfere.
- Before plugging or unplugging a connection cord, be sure to unplug the power cord from the wall AC outlet. If connection cords are plugged or unplugged with the power cord left plugged in, malfunction or damage may result.

Malfunction of microcomputer

If operation is not possible or erroneous display appears even though all connections have been made properly, reset the microcomputer referring to "In case of difficulty". — 53

FM indoor antenna

The accessory antenna is for temporary indoor use only. For stable signal reception we recommend using an outdoor antenna. Remove the indoor antenna if you connect one outdoors.

- ❶ Connect the antenna to the antenna terminal.
- ❷ Locate the position providing good reception condition.
- ❸ Fix the antenna.

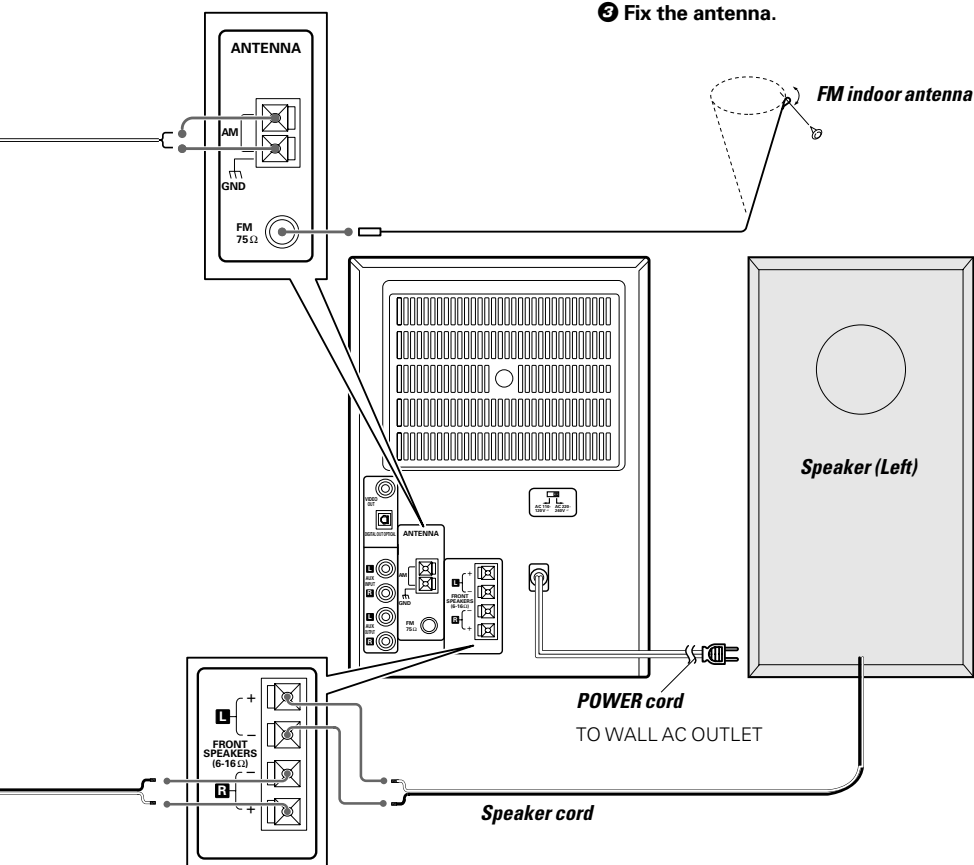

How to connect speaker cords to the main unit

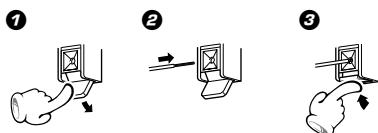

How to connect AM antenna cord to the main unit

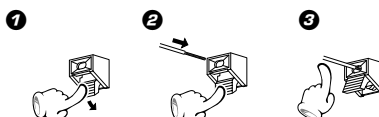

Connection of Other Accessories (Commercially Available Parts)

CAUTION Note on Connection

Connect the components as shown in the diagram. Only plug the power cord into a power outlet once connections are completed.

* DIGITAL OUT OPTICAL jack

The DIGITAL OUT OPTICAL jack outputs the CD signal.

The CD signal can be recorded in digital format by connecting a recorder to the DIGITAL IN OPTICAL jack.

FM outdoor antenna

Lead the 75Ω coaxial cable connected to the FM outdoor antenna into the room and connect it to the FM 75Ω terminal. Please remove the indoor antenna after an outdoor antenna has been installed.

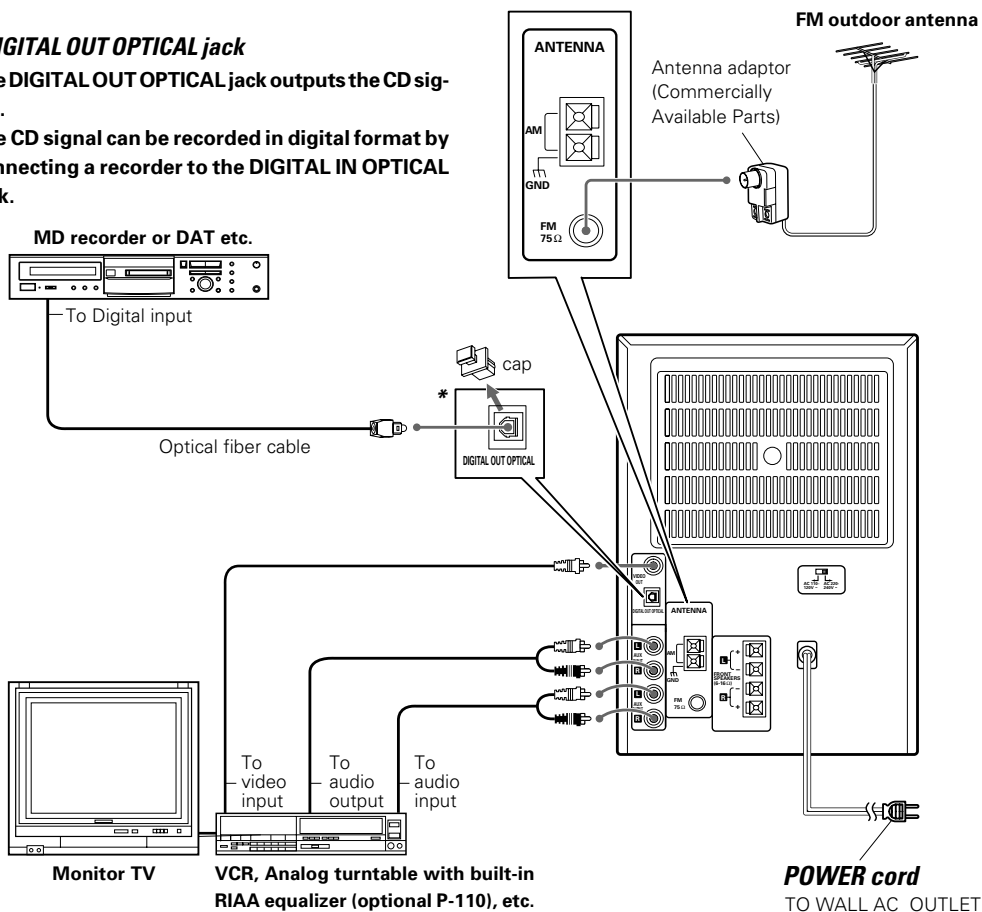

- In case an associated system component is connected, also read the instruction manual of the component.
- Be sure to insert all connection cords securely. If their connections are imperfect, the sound may not be produced or noise may interfere.
- Before plugging or unplugging a connection cord, be sure to unplug the power cord from the wall AC outlet. If connection cords are plugged or unplugged with the power cord left plugged in, malfunction or damage may result.

Display

The displays given in this manual are approximations only. They may differ from what actually appears on the display.

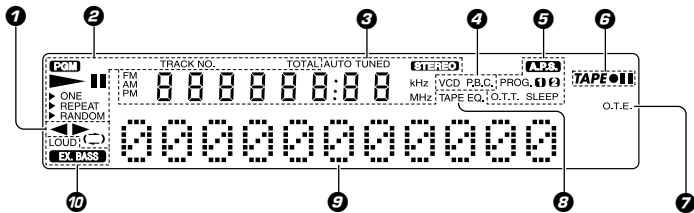

- 1 Tape-related indicators

2 CD-DA (CD, CD-R), VIDEO CD and MP3 file-related indicators

3 Numeric information display/tuner-related indicators

4 VIDEO CD player-related indicators

5 Timer-related indicators
- 6 Tape record/record-pause indicators

7 O.T.E. (One-Touch Edit) indicator

8 TAPE EQ. indicator

9 Character information display (Dot display)

10 EX.BASS indicator, LOUD indicator

In the present text, both ordinary music CDs and recorded CDs (CD-R) are referred to as "CD-DA". (The display also shows "CD-DA" for these disc media.)

AUTO POWER SAVE function (Main unit operation only)

When the unit is ON and the unit is left for 30 minutes with CD and TAPE not operating, the unit is switched off automatically by this function. This is convenient when you forgot to switch off the unit. This function can be activated or deactivated by the following operation.

- 1 Select "A.P.S. SET?".
- 2 Select "A.P.S. ON" or "A.P.S. OFF".

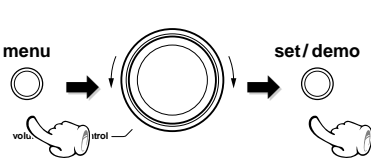

(Press the set/demo key while the "?" mark is blinking.)

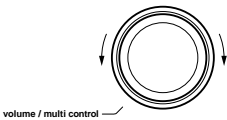

- 3 Set it.
- set/demo

- When the TUNER or AUX input is selected, A.P.S. operates only when the volume is set to zero or when MUTE is on.

Main unit

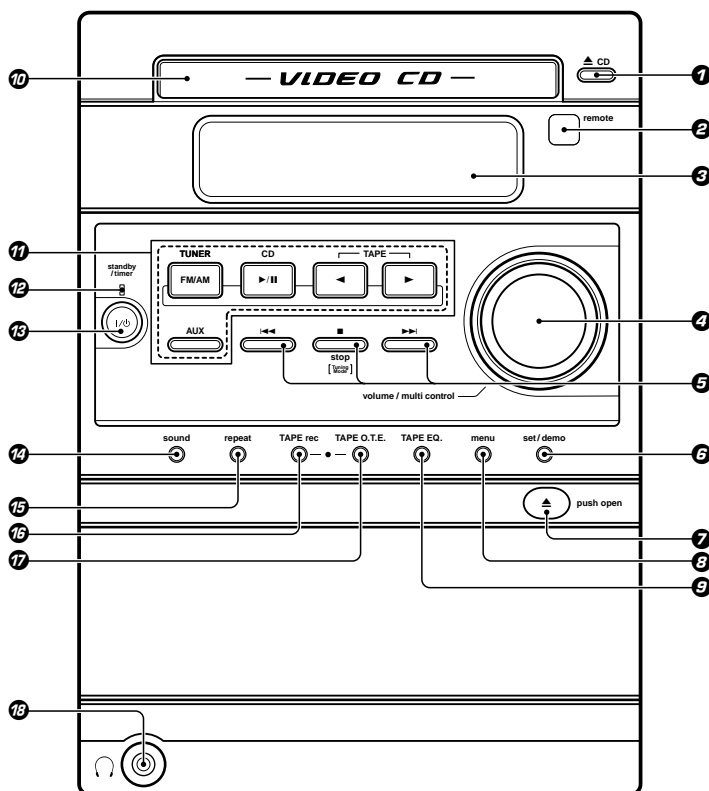

1 ▲ CD key

Press to open or close the disc tray.

→ 18

2 Remote sensor

→ 13

3 Display panel

* 4 volume/multi control knob

→ 11 → 16

Normally, this is used for volume adjustment.

5 ◀◀ and ▶▶ keys

CD-DA, VIDEO CD and MP3 file :

→ 19

Used to skip tracks.

Used to switch the VIDEO CD screen.

TAPE :

→ 22

Used to fast forward or rewind tape.

TUNER :

→ 23

Used to receive a preset radio station and tuning.

■ stop / Tuning Mode key

CD-DA, VIDEO CD, MP3 file and TAPE : → 19 → 22

Press to stop a disc or tape operation.

Press to stop recording.

During VIDEO CD (with PBC ON) and MP3 file operating, press to return to the higher layer of the hierarchy.

TUNER :

Press to switch between the AUTO (auto tuning, stereo reception) and MONO (manual tuning, manual reception) modes.

On standby mode:

→ 44

Press to display the clock.

About the one-touch operation function

This unit incorporates the one-touch operation function for the user's convenience.

With this function, pressing any key enclosed in while the unit is in standby mode immediately start playback (or reception).

6 set/demo key

Press to set or enter an item selected with the **volume/multi control** knob.

This key is also used for switching demonstration on/off. → 4

7 Cassette holder

→ 21

To load or eject a cassette tape, press the area marked **▲ push open** on the cassette holder to open it.

8 menu key

→ 11 → 44

Press to switch the function of the **volume/multi control** knob to the menu select mode.

This key is also used when setting the time of the day.

9 TAPE EQ. key

→ 22

Press to turn the tape equalizer on.

10 Disc tray

→ 18

Press the **▲ CD** key to open or close disc tray.

11 Basic operation keys**TUNER FM/AM key**

→ 23

Press to select the TUNER input.

This key is also used to select the received broadcast band.

CD ►/II key

→ 18

Press to select the CD input and start playback. Pressing this key during CD-DA, VIDEO CD and MP3 file playback initiates pause.

During VIDEO CD (with PBC ON) and MP3 file operating, press to advance to the lower layer of the hierarchy.

TAPE ◀▶ keys

→ 21

Press to select the TAPE (cassette deck) input and start playback of a tape. Pressing this key during tape playback switches the tape transport direction.

AUX key

→ 43

Press to reproduce the external source component connected to the AUX (analog auxiliary input) jacks.

Pressing this key while the unit is off turns it on at the same time as selecting the AUX input.

12 standby/timer indicator

Lights up when the unit is set to the Standby mode of power.

Red : Ordinary standby.

Green : Timer standby.

Off : The unit is On.

13 I/⏻ key

→ 16

Press to set the unit to On or Standby.

14 sound key

→ 17

Press to switch the sound effect to EX.BASS or LOUD.

15 repeat key

→ 30

Press for setting repeated playback.

16 TAPE rec key

→ 27

Press to start tape recording. Pressing this key during recording initiates record-pause after leaving a no-sound blank of about 4 seconds.

17 TAPE O.T.E. key

→ 33

Press to start recording CD-DA and VIDEO CD (with PBC OFF) onto a tape with one-touch operation. Pressing this key during CD-DA and VIDEO CD (with PBC OFF) playback records only the track being played onto tape. Pressing it during CD-DA and VIDEO CD (with PBC OFF) stop records all tracks onto tape.

18 Headphone jack

→ 17

Connect headphones with a stereo mini-plug (optionally available).

*** About the volume/multi control knob (Main unit operation only)**

After pressing the menu key to select the menu select mode, turn the volume/multi control knob to select the desired menu item.

To set or enter the setting of the menu item, press the set/demo key.

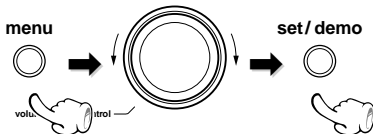

- The function of the control knob returns to the normal mode when it has not been operated for 20 seconds.

Turning the knob switches the display contents.

→ "TAPE RVS. ?" → 22

→ "AUTO PRESET" → 24

(Only when the TUNER input is selected)

→ "AUX INPUT ?" → 43

(Only when the AUX input is selected)

→ "A.P.S. SET ?" → 9

→ "TIMER SET ?" → 46 → 48

Standby mode

While the standby indicator is lit, a small amount of power is supplied to the system to back up the memory. This is called standby mode. Under the condition, the system can be turned ON by the remote control unit.

Operation of remote control unit

The keys on the remote control unit with the same names as on the main unit have the same function as the keys on the main unit.

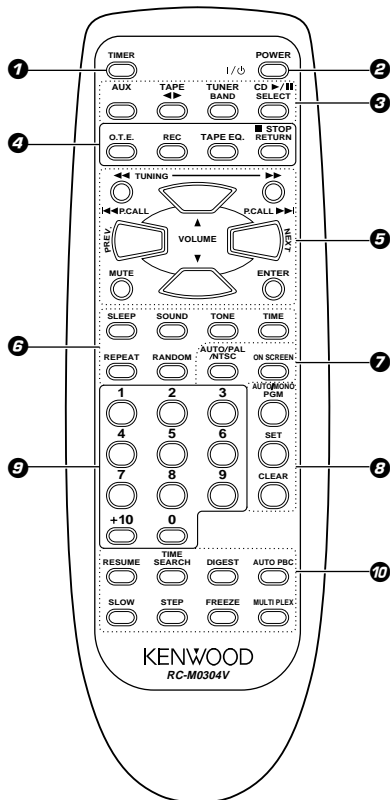

Infrared ray system
Model : RC-M0304V

1 TIMER key → [47] → [50]

Used to select the timer.

2 POWER (I/φ) key → [16]

The system is switched ON and OFF (standby).

3 AUX key

Press to listen to the input source connected to AUX (analog external).

TAPE ◀▶ key → [21]

Press to select the TAPE input and play a tape.

Press during playback to change the tape transport direction.

TUNER BAND key

The received broadcasting band is switched.

Press to select the TUNER input.

CD ▶/II key → [18]

Press to select the CD input and start CD-DA, VIDEO CD and MP3 file playback and to it pause temporarily.

SELECT key → [36] → [38]

During VIDEO CD (with PBC ON) and MP3 file operating, press to advance to the lower layer of the hierarchy.

4 O.T.E. key → [33] → [34]

This key is used for recording of CD-DA and VIDEO CD (with PBC OFF) onto tape with a one-touch operation.

REC key

Press to start recording.

TAPE EQ. key → [22]

Press to turn the tape equalizer on.

■ STOP key → [19] → [22] → [27] → [44]

During CD-DA, VIDEO CD, MP3 file and TAPE playback :

Press to stop playback.

During TAPE recording :

Press to stop recording.

Press in power standby mode to display the clock.

RETURN key → [36] → [38]

During VIDEO CD (with PBC ON) and MP3 file operating :

Press to return to the higher layer of the hierarchy.

5 ◀◀TUNING▶▶ key → [19] → [22] → [25] → [36] → [39]

During CD-DA, VIDEO CD, MP3 file and TAPE playback :

Press to fast forward or backward the played audio.

During MP3 file operating in stop mode :

Press to select the desired folder or file.

During TUNER reception :

Press to select a radio station.

◀◀P.CALL▶▶ key → [19] → [22] → [23]

During CD-DA, VIDEO CD and MP3 file playback :

Press to skip tracks in the forward or backward direction.

During TAPE playback :

Press to fast forward or backward the played audio.

During TUNER reception :

Used to select a preset station.

PREV. , NEXT key → [37]

Used to switch the VIDEO CD screen.

VOLUME control key → [16] → [17]

Press to adjust the listening volume or tone.

MUTE key → [17]

This is used to suppress the sound temporarily.

ENTER key → [25]

This is used to enter the preset station memory in the tuner.

6 SLEEP key → [45]

This is used to set the sleep timer.

SOUND key

→ 17

Used for switching the EX.BASS play and LOUDNESS play.

TONE key

→ 17

This is used to adjust the tone.

TIME key

→ 20

Press to switch the time information displayed during CD-DA and VIDEO CD (with PBC OFF) playback.

REPEAT key

→ 30

This is used for repeated playback.

RANDOM key

→ 31

Playback of the CD-DA and VIDEO CD (with PBC OFF) tracks in random order.

7 AUTO/PAL/NTSC key

→ 15

Press to switch the video output signal format.

ON SCREEN key

→ 14

Used to select the information to be displayed on the TV screen.

9 AUTO/MONO key

→ 25

During tuner reception, press to switch the tuning mode of the tuner.

PGM key

→ 28

When CD input is selected :

This is used to program the track sequence.

SET key

→ 28

In program playback of CD-DA and VIDEO CD (with PBC OFF), press to enter the selected track number in memory.

Press to set or enter an item selected with the **volume/multi control** knob.

CLEAR key

→ 29

The programmed track sequence is cleared.

9 Numeric key

→ 19 → 25 → 40 → 41

These are used to select CD-DA, VIDEO CD tracks and MP3 file and as preset

10 Keys connected with the VIDEO CD**RESUME key**

→ 40

Used for to resume VIDEO CD and CD-DA playback from the location where playback was last stopped.

TIME SEARCH key

→ 40

Used to jump to a specific location on a VIDEO CD and CD-DA.

DIGEST key

→ 41

Used for the Digest functions to scan a disc of a VIDEO CD and CD-DA.

AUTO PBC key

→ 18 → 37

Press to activate/deactivate the playback control (PBC) functions of a VIDEO CD.

SLOW key

→ 39

Used for slow-motion playback of a VIDEO CD.

STEP key

→ 39

Used to advance the picture of a VIDEO CD frame by frame.

FREEZE key

→ 39

Used to freeze the image of a VIDEO CD.

MULTI PLEX key

→ 39

Used to change the audio output channel of a VIDEO CD and MP3 files.

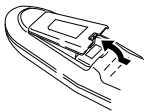
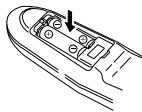
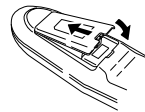
Loading batteries**1 Remove the cover.****2 Insert batteries.****3 Close the cover.**

- Insert two R6 ("AA"-size) batteries following the polarity indications.

Operation

After plugging the power cord of this unit, press the **POWER (I / ⏻)** key of the remote control unit to turn the system ON. When the system is turned ON, press the key of the function to be operated.

- When pressing more than one remote control keys successively, press the keys securely by leaving an interval of 1 second or more between keys.

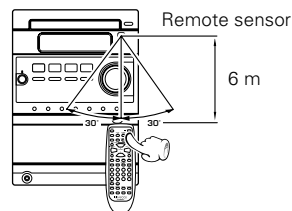
Operating range (approx.)

- The provided batteries are intended for use in operation checking, and their service life may be short.
- When the remote controllable distance becomes short, replace both of the batteries with new ones.
- If direct sunlight or the light of a high-frequency fluorescent lamp (inverter type, etc.) is incident to the remote sensor, malfunction may occur. In such a case, change the installation position to avoid malfunction.

Discs which can be played with this unit

This unit can play CD-DA (8cm, 12cm), VCD, finalized CD-R, disc media of MP3 files on which have been finalized or containing a closed session, and the audio part of CD-G/CD-EG (CD graphics) discs and CDV discs.

- This unit is suitable for the NTSC/PAL method.
- Discs indicated for use with other television systems (SECAM) cannot be used with this unit.

CD-R

The CD-R records digital data of music CD or other source without compression so it can be played back at equivalent high quality to commercially marketed CDs.

- This unit cannot play back a CD-R which has not been finalized.
- This unit cannot play other data than audio signal data, such as data signal in a CD-ROM. When a disc containing various data, for example a CD Graphic or CD-TEXT is loaded in the unit, the unit cannot play other data than the audio signal data.

In addition to the above, this unit may also be incapable of playing certain CD-R discs depending on the recording characteristics of recording equipment (including the pickup), properties of the CD-R in use, its recording condition and so on.

MP3 files

- Check to ascertain that MP3 files can be played back correctly on the personal computer in use prior to saving them onto the media.
- Check to ensure that the saved file can be played back normally.
- MP3 files on which the session has not be closed or finalized can not be played back with this unit.
- There are cases where playback is not possible when MP3 files and music CD information (CD-DA) are saved on the same media.

Explanation of terms

VIDEO CD

This is a CD with recorded moving images. By compressing the video information to 1/120 and the audio information to 1/6, recording of up to 74 min is possible on discs with the same 12 cm diameter as general audio CDs.

Two types of discs are being marketed (without PBC) for simple playback and (with PBC) with menus and special playback (playback control). This unit can be used for playback of VIDEO CDs of both types.

Character indications on the TV screen

To constantly display character information on the TV screen, select "OSD ON".

Remote control unit only



Each press of the key alternates the setting.

- ① "OSD ON"Displays executed operation, track number and time.
- ② "OSD OFF" Only displays executed operation.

Key error display

 If a wrong key is pressed when operating the unit, a hand mark is displayed at the top left corner of the TV monitor screen.

Switching AUTO/PAL/NTSC

The TV screen display and disc signal formats can be classified roughly into two types (NTSC, PAL) depending on the countries and regions. Therefore, it is necessary to set the NTSC/PAL switch of this unit according to the TV format (country or region) and disc.

- ❶ Check the display format of your TV.
 - ❷ Press the key to scroll the current TV format display.
- To change the TV format, press the key again while the TV format display is being scrolled.

Remote control unit only



- The screen display may be disturbed during switching. This is not a malfunction.

TV formats of major countries

TV format	Countries, regions
PAL	China, North Korea, UK, Germany, Australia, New Zealand, Kuwait, Singapore, etc.
NTSC	Japan, Taiwan, Korea, USA, Canada, Mexico, Philippines, Chile, etc.

Each press of the key cyclically changes the setting.

- ❶ "AUTO" Switches automatically (Factory setting)
- ❷ "PAL" PAL format
- ❸ "NTSC" NTSC format

AUTO

Screen display examples of various TV formats

When your TV is switchable between NTSC/PAL

Try play a disc. If the picture is black and white or as shown on the right, stop playback and switch the screen display formats of this unit and the TV to another format. This will improve the played picture quality.

NTSC

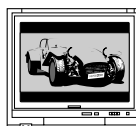

PAL



When your TV is compatible only with the PAL format

With certain VIDEO CDs, the playback picture may have black spaces above and below it (as shown on the right). This is because the disc has been recorded in the NTSC format. The screen may be somewhat hard to see but this is not malfunction.

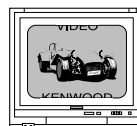

When your TV is compatible only with the NTSC format

With certain VIDEO CDs, the playback picture may be cut above and below it (as shown on the right). This is because the disc has been recorded in the PAL format. The screen may be somewhat hard to see but this is not malfunction.

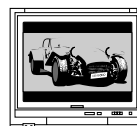

The system is switched ON and STANDBY

Muting the sound temporarily

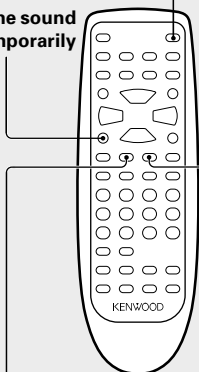

Bass and treble compensation

Tone adjustment

Bass and treble compensation

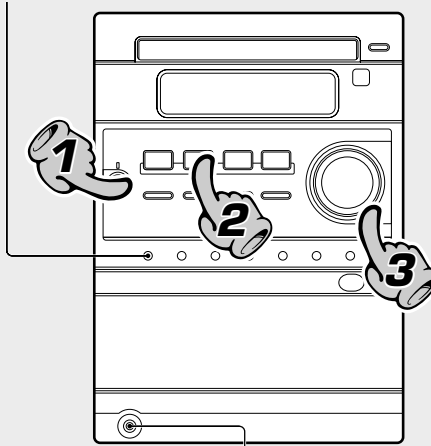

Listening through headphones

1. Set the Power I / ⏻ key to ON.

Pressing the Power I / ⏻ key when the unit is ON turns it off (Standby mode of power).

- Pressing the **TUNER FM/AM**, **CD ▶/II**, **TAPE ◀▶** or **AUX** key also turns power on and starts playback (reception) of the corresponding input. (One-touch operation)
- When the CD or TAPE input is selected while the corresponding disc or tape has been loaded, it immediately starts to play.



Example:
To select the CD input



2. Selecting the desired input.

CD (CD-DA, VIDEO CD and MP3 file) → 18 → 35 → 37

TAPE → 21

TUNER (Broadcasts) → 23

AUX (External input) [Adjusting the AUX input level → 43]

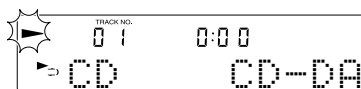

When CD (CD-DA) has been selected.

- Pressing the **TUNER FM/AM**, **CD ▶/II**, **TAPE ◀▶** or **AUX** key selects the corresponding input.

3. Volume adjustment.

- The display shows a reference value.

▶ VOLUME 12 Volume display

The volume decreases

The volume increases

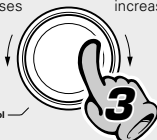

volume / multi control

Listening through headphones

Insert the headphone plug into the headphone jack.



- Headphones with a stereo mini plug can be connected.
- The sounds from all speakers are cut off.

Muting the sound temporarily

Remote control unit only



- Press again to resume the original volume.
- This is also cancelled when the volume is changed.

Bass and treble compensation



Each press switches the modes as follows.

- ① **"EX.BASS" lights.**
The lowest and highest frequencies are enhanced regardless of the current volume level.
- ② **"LOUD" (Loudness) lights.**
The lowest and highest frequencies are enhanced according to the current volume level. (Effective during low-volume listening.)
- ③ **Both indicators off.**
Cancelled.

- Adjusting the tone while the "LOUD" or "EX.BASS" indicator is lit turns it off and cancels the sound enhancement mode.

Tone adjustment

Remote control unit only

The lowest and highest frequency bands can be adjusted independently.

① Select the frequency band.



Each press switches the operation.

- ① **"BASS" (low frequency) adjustment**
BASS 0
- ② **"TREBLE" (high frequency) adjustment**
TREBLE 0
- ③ **Normal mode**

(Go to step ② within 20 seconds.)

② Adjust.

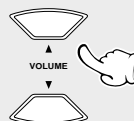

(To adjust the other frequency band, repeat steps ① and ② for it.)

- The levels of both "BASS" and "TREBLE" can be adjusted in 2 steps in the range between -8 and +8.
- Adjusting the tone while the "LOUD" or "EX.BASS" indicator is lit turns it off and cancels the sound enhancement mode.

This section describes you how to play CD-DA and the audio of VIDEO CD from the first track and MP3 file of the order in which it was written.

For details on VIDEO CD menu playback, see "Playback of VIDEO CD". - 37 ~ 42

For details on selecting MP3 file playback, see "Playback of MP3 file". - 35 ~ 36

When a disc is placed into the CD player in advance, the unit will be switched on automatically by pressing the CD ►/II key, and playback will start.

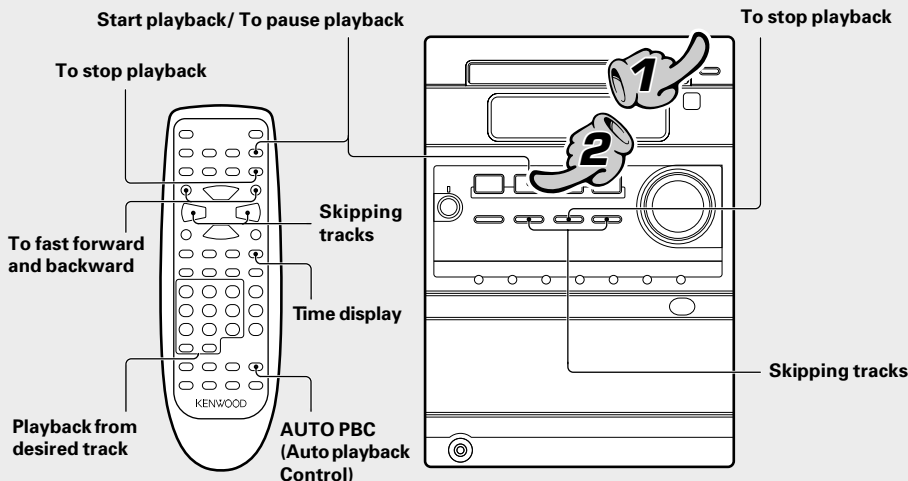

1. Load a disc.

The label side must be on top.



A non-finalized CD-R and MP3 files cannot be played back.

- ❶ Press the ▲ CD key.
- ❷ Place a disc.
- ❸ Press the ▲ CD key.

- Do not touch the played side of disc.
- Be sure to place a disc horizontally. Placing it with an inclination will result in malfunction.
- This unit may not be able to play back certain CD-R discs depending on the recording equipment or discs. See "Notes on playback of CD-R". - 20

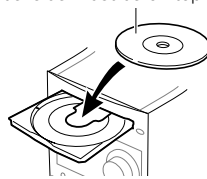

2. Start playback.

Play display Track No. being played

- After a few seconds, play starts from track No.1.



Elapsed time of track being played

For a VIDEO CD with PBC, check that the "PBC" indicator is not lit. If the "PBC" indicator is lit, select "PBC OFF" as follows:

- ❶ Keep the ■ STOP key depressed for more than 2 seconds.
- ❷ Press the AUTO PBC key so that the "PBC" indicator goes off.
- ❸ Press the CD ►/II key to start playback.

For a disc other than VIDEO CDs with PBC, "PBC OFF" is automatically selected.



When playing a MP3 file, press the CD ►/II key repeatedly until "►" (play indicator) is displayed.

Start playback/ To pause playback

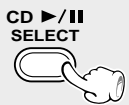

- Each press pauses and plays the CD alternately.

To stop playback



To fast forward and backward

Remote control unit only

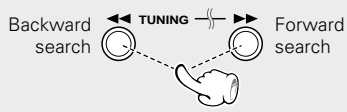

- When the ◀◀ or ▶▶ key is pressed during CD playback or in pause mode, search begins. There are four search speeds. With each press of the key for the current search direction, the next higher speed is selected. → 39
- To resume normal playback, press the CD ►/II key of the CD player.

Skipping tracks

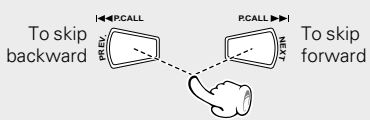

- The track in the direction of the key pressed is skipped, and the selected track will be played from the beginning.
- When the ◀◀ key is pressed once during playback, the previous track will be played.
- Tracks can be skipped by pressing the ◀◀ or ▶▶ key even when the CD is in stop mode. In this case, playback starts automatically from the point reached by skipping. (In playback of MP3 files, this operation is not available.)

Playback from desired track

Remote control unit only

Select the desired track No.

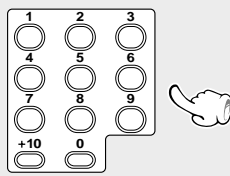

Press the numeric keys as shown below....

- To select track No. 23 :+10 x 2, 3
- To select track No. 40 :+10 x 4, 0

Eject the CD

Main unit only

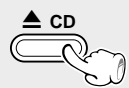

- The disc tray will open. (Pressing the key again closes the disc tray.)

Notes on playback of CD-R

This unit cannot play back the following types of CD-R discs.

- This unit cannot play back a CD-R which has not been finalized.
- This unit cannot play other data than audio signal data, such as data signal in a CD-ROM. When a disc containing various data, for example a CD Graphic or CD-TEXT is loaded in the unit, the unit cannot play other data than the audio signal data.

In addition to the above, this unit may also be incapable of playing certain CD-R discs depending on the recording characteristics of recording equipment (including the pickup), properties of the CD-R in use, its recording condition and so on.

Time display for the CD-DA and VIDEO CD player

Each press of the **TIME** key of the remote control unit switches the displayed time information.



- During program playback, only the elapsed time of the track being played is displayed.
- During playback of a VIDEO CD incorporating PBC with PBC ON and MP3 files, the display can not be changed.

① Elapsed time of track being played

TRACK NO.	
01	1:23

② Remaining time of track being played

TRACK NO.	
01	- 2:37

③ Remaining time on entire disc

TRACK NO.	TOTAL
01	- 36:15

If you load a tape in the cassette deck in advance while the power is off. Pressing the TAPE ◀▶ key turns power on automatically and starts the tape playback.

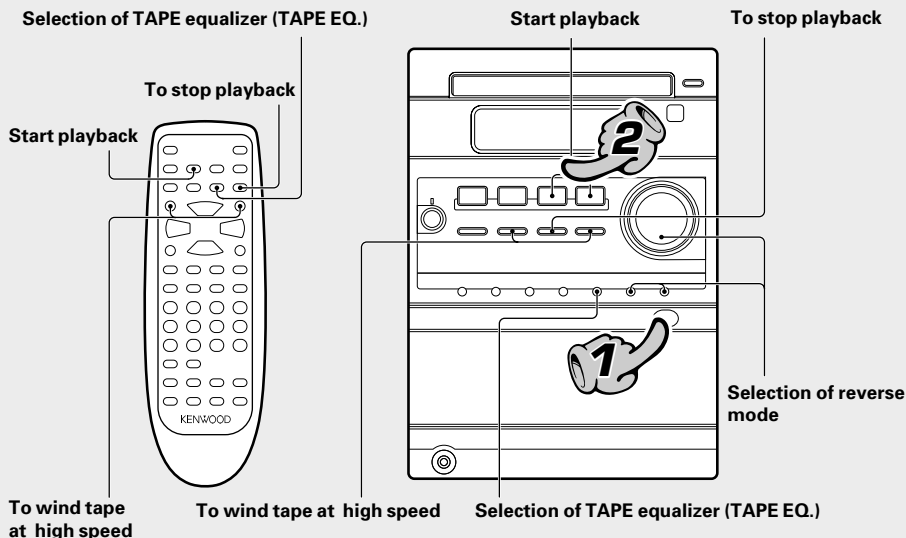

1. Load a cassette tape.

- ① Press the area marked ▲ push open to open the cassette holder.
- ② Insert a tape.
- ③ Press the area marked ▲ push open to close the cassette holder.

Do not use a cassette with more than 90-minute recording time, for the tape used in such a cassette is very thin and tends to cause problem such as entanglement around the pinch roller or could be easily cut off.

- The tape deck of the unit can play Normal (Type I), High (Type II) and Metal (Type IV) tapes.
- Remove tape slack before loading.

2. Start playback.

Press the TAPE ◀▶ key of the desired direction.

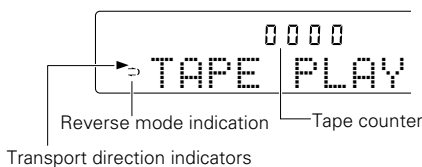
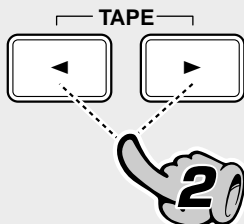

Transport direction indicators:

Indicates the tape transport direction during playback or recording by lighting of ◀ or ▶. This direction is the direction stored in memory when the tape was last stopped.

To stop playback

■ STOP
RETURN



Selection of reverse mode

Main unit only

① Select "TAPE RVS. ?".

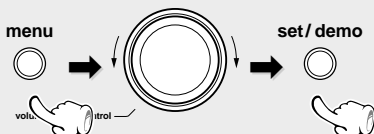

(Press the set/demo key while the "?" mark is blinking)

② Select.



① "⇐": (ONE-WAY)

Only one side is played back (recorded), and then the tape stops.

② "⇐⇐": (REVERSE)

Both sides are played back (recorded), and then the tape stops. (When the playback direction is "⇐", however, the tape stops after one side has been played (recorded)).

③ "⇐⇐⇐": (ENDLESS)

Both sides are played back endlessly. (The tape stops after recording onto both sides. When the playback direction is "⇐", however, the tape stops after one side has been played).

(The initial setting is "⇐⇐"(REVERSE))

③ Set it.

set / demo



To wind tape at high speed

To fast wind in
direction ◀

To fast wind in
direction ▶

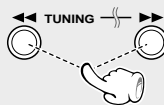

- Press the ■ STOP key to stop fast winding.
- The same operation is also available with the ◀◀ and ▶▶ keys on the main unit.

Selection of TAPE equalizer (TAPE EQ.)

When playing a tape prerecorded with Noise Reduction system (such as the DOLBY NR) ON, be sure to set the "TAPE EQ." ON for playback.

TAPE EQ. Lit when "TAPE EQ." is ON



Each press switches the modes as follows.

- ① "TAPE EQ." ON
(TAPE equalizer is used)
- ② "TAPE EQ." OFF
(TAPE equalizer is not used)

- Select the "TAPE EQ." ON mode according to the recording condition of the tape.

A tip for use of the tape counter

The tape counter is set to "0000" when a cassette tape is loaded. By writing down the counter reading in case you want to interrupt recording (playback) in the middle of the tape, the memo will be helpful as a reference for locating the same position when continuing the recording (playback) the next time. The tape counter figure decrements during recording or playback of the back side (while the ◀ tape transport indicator is lit). To set the tape counter to "0000", open the cassette holder once. Then the counter will be reset.

Up to 30 radio stations can be preset in memory.
When the TUNER FM/AM key is pressed, the unit will automatically be switched on and reception status will be reached.

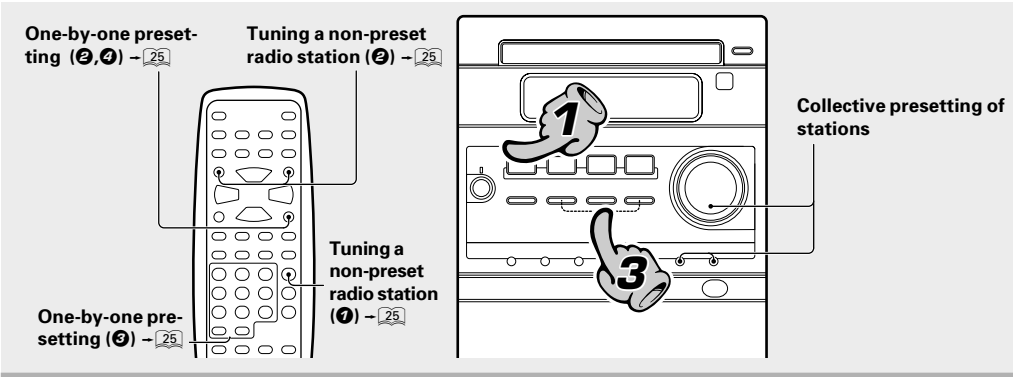

1. Select the tuner input.

Each press of the TUNER FM/AM key switches the band as follows.

FM
AM

2. Preset a radio station in memory.

Collective presetting of stations (auto preset) - [24]

Follow the procedure in "Collective presetting of stations (auto preset)" to preset automatically the tunable radio stations in your area.

- Once stations are stored by auto presetting, the present procedure is not required from the next time, unless you move of house or re-execute presetting of all tunable stations.

One-by-one presetting (Manual preset) - [25]

A station can also be tuned even when it is not preset. For details, read "Tuning a non-preset radio station (Auto tuning, Manual tuning)".

3. Tuning (Preset Call)

- If radio stations have already been stored with auto preset or manual preset, select a station using the ◀◀, ▶▶ key. Each press of the same key switches the preset stations in sequence.

Lights during stereo reception

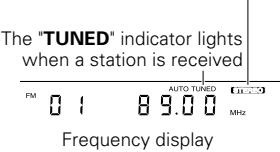

When ▶▶ is pressed : 1→2→3 ... 28→29→30→1...
When ◀◀ is pressed : 30→29→28 3→2→1→30.....

- When a key is held depressed, preset stations will be skipped at an interval of about 0.5 second.
- To select a preset station from the remote, use the ◀◀ P.CALL ▶▶ key or numeric keys.
- Preset stations can be called using the number key on the remote control.

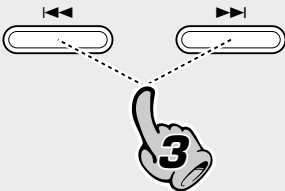

Collective presetting of stations (Auto preset)

Main unit only

➊ Receive a broadcast.

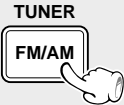

➋ Select "AUTO PRESET".

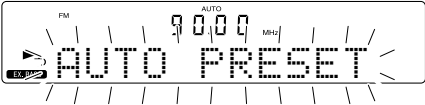
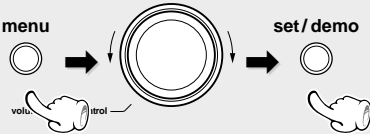

- A maximum of 30 stations of the band presently being received will be preset.
- When there are many stations and the intended station has not been preset, please also use "One-by-one pre-setting (Manual preset)".

Channel space setting

The space between radio channels has been set to the one that prevails in the area to which the system is shipped. However, if the current channel space setting does not match the setting in the area where the system is to be used, for instance when you move from area 1 or area 2 shown in the following table or vice versa, proper reception of AM/FM broadcasts cannot be expected. In this case, change the channel space setting in accordance with your area by referring to the following table.

Main unit only

➊ Turn power on.

➋ While holding TUNER FM/AM key pressed, turn the volume/multi control knob to select "FM 50 kHz" or "FM 100 kHz".



➌ Set it.



Each press switches the space frequency alternately.

➊ "FM 50 kHz" (FM 50 kHz, AM 9 kHz)



➋ "FM 100 kHz" (FM 100 kHz, AM 10 kHz)



	Area	CHANNEL Space Frequency
➊	USA, Canada and South American countries	FM: 100 kHz AM: 10 kHz
➋	Other countries	FM: 50 kHz AM: 9 kHz

Tuning a non-preset radio station (Auto tuning, Manual tuning)

Remote control unit only

Select the tuning mode according to the radio wave receiving condition.

When the receiving condition is good: **AUTO mode**

When it is poor due to weak radio waves: **MANUAL mode**

① Select the AUTO or MANUAL mode.



- The same operation is also available with the **■ STOP [Tuning Mode]** key on the main unit.

② Tune a station.

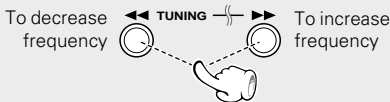

- In **MANUAL** mode, FM stations are received in monaural.

Each press alternates the mode.

- ① **"AUTO"** : Stereo reception ("AUTO" lit)
- ② **"MANUAL"** : Monaural reception ("AUTO" not lit)

- Normally, use the **AUTO** (Auto tuning, stereo reception) mode.

In AUTO mode :

The next preset station can be received automatically each time the **TUNING UP/DOWN** (◀◀ or ▶▶) key is pressed.

In MANUAL mode :

Press the **TUNING UP/DOWN** (◀◀ or ▶▶) key repeatedly until the desired station is received. The desired station can also be received by holding the **TUNING UP/DOWN** (◀◀ or ▶▶) key depressed until its frequency is displayed.

One-by-one presetting (Manual preset)

Remote control unit only

① Perform the procedure in "Tuning a non-preset radio station (Auto tuning, Manual tuning)" to receive the station to be preset.

② Press the ENTER key during reception.



(Proceed to step ③ while "MEMORY" is lit.)

③ Select one of the preset numbers from 1 to 30.

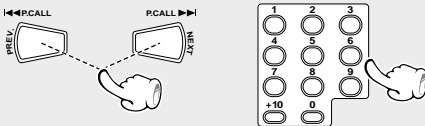

④ Press the ENTER key again.



(Repeat steps ①, ②, ③ and ④ to preset other stations)



"MEMORY" lights (for approx. 20 sec.)

- A maximum of 30 stations of the band presently being received will be preset.

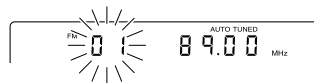

- If several stations are preset under the same number, the previous memory is replaced with the latest memory contents.

The tape deck of the unit can record signals only on Normal (Type I) and High (Type II) tapes. It cannot record on Metal (Type IV) tapes.

Stop the recording

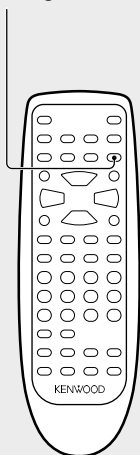

Stop the recording

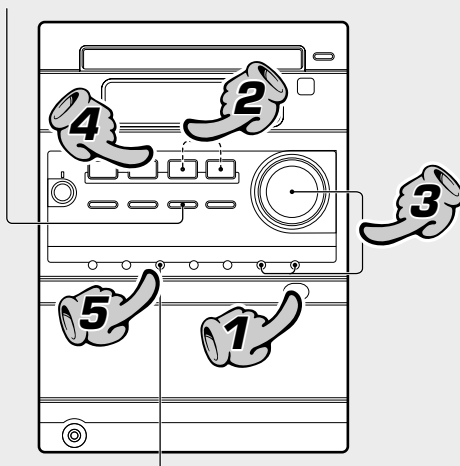

Start recording/ Pause the recording

1. Load a tape in deck.

- ① Press the area marked to open the cassette holder.
- ② Insert a tape.
- ③ Press the area marked to close the cassette holder.

Do not use a cassette with more than 90-minute recording time, for the tape used in such a cassette is very thin and tends to cause problem such as entanglement around the pinch roller or could be easily cut off.

- Remove tape slack before loading.

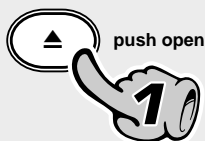

2. Select the tape transport direction.

To reverse the transport direction :

- ① Press the TAPE key corresponding to the desired direction.
- ② Press the STOP key to stop playback.

- When recording is started, the tape is transported in the direction selected in this step.

Check the tape transport direction indicator. 21

- Search the position you want to start recording in advance.

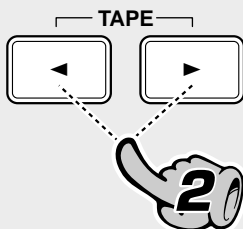

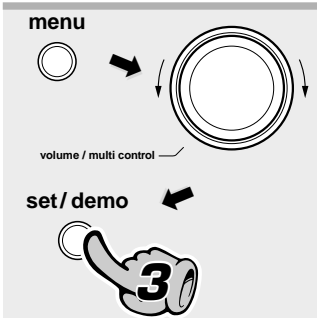

3. Set the recording condition.

Select the reverse mode. - [22]

- Check the tape transport direction before starting recording. If it is set to the reverse direction, only one side of tape can be recorded regardless of the reverse mode setting made here.
- The tape equalizer is defeated during recording.

Select an input source other than "TAPE"

Example:
To select the CD input



4. Select the source to be recorded.

CD (CD-DA, VIDEO CD with PBC OFF and MP3 file) [For PBC OFF → [18]]

TUNER (Broadcasts)

AUX (External input) [Adjusting the AUX input level → [43]]

- If a CD has already been loaded, it starts to play now. Press the ■ STOP key to stop it.



The character information display shows the recording input source.



5. Start recording.

- 1 Press the TAPE rec key.
- 2 Play (or tune) the input source to be recorded.

- Recording stops automatically when the tape side (s) to be recorded have been fully recorded.

Pause the recording

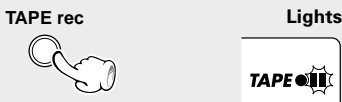

- Press the **TAPE rec** key during recording. It stops after leaving a non-recorded blank of 4 seconds. (Press the key again to resume recording.)

Stop the recording

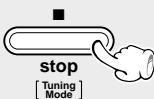

Points in CD recording (CD-DA and VIDEO CD with PBC OFF only)

When recording CD tracks onto a tape, if you leave the cassette deck in record-pause mode beforehand, the cassette deck recording can be started at the CD starts to be played.

- 1 Put the CD player in pause mode.
- 2 Select the track to be recorded with the skip (◀, ▶) keys. (The CD player pauses at the beginning of the selected track.)
- 3 Put the cassette deck in Record-pause mode. (Press TAPE rec key twice)
- 4 Start playing the CD. (Recording starts)

- To stop recording, press the ■ STOP key.

Symbols **CD-DA** **VIDEO CD** **MP3 file** in the text indicate the disc media that can be played back.

Listening to the desired sequence (PGM) **CD-DA** **VIDEO CD (with PBC OFF)**

Use the following procedure to program desired tracks in a desired order. (up to 32 tracks)

A non-finalized CD-R cannot be played back.

Select the CD input.

1 Let the "PGM" indicator light.

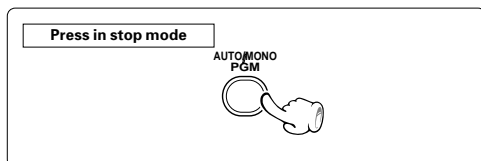

2 Select track numbers in the order you want to play them.

① Select the track.

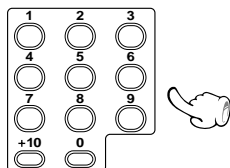

(Go to step ② within 4 seconds.)

Selection of tracks Program position of the track to be selected next.

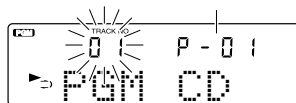

Press the numeric keys as shown below....

To select track No. 23 : +10 x 2, 3

To select track No. 40 : +10 x 4, 0

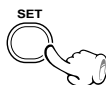

② Confirm the selection.

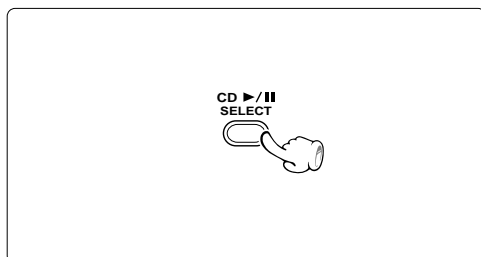

(To select more than one track, repeat steps ① and ② for each track.)

3 Start playback.

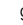

- A track can also be selected using the  or  key.
- Up to 32 tracks can be programmed. When "FULL" is displayed, no more tracks can be programmed.
- If you made a mistake, press the **CLEAR** key and enter the track No. again.
- When a track No. is entered, the track will be added to the end of the existing program.
- When the total time of CD program is 256 minutes or more, the time display shows "— : — : —".

- Tracks will be played in the order they were programmed (following the program numbers).
- When the /  key is pressed during play, the program will jump to the preceding or the following track respectively.

To clear the entire program

Press in stop mode

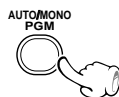

Goes off



The program mode is cancelled when the unit is turned off or the programmed disc is ejected. The set program is cleared entirely at this time.

Repeated playback (REPEAT)

You can repeatedly listen to a favorite track or disc.

A non-finalized CD-R and MP3 files cannot be played back.

Select the CD input.

Setup for repeating a single track **CD-DA** VIDEO CD (with PBC OFF → [18]) **MP3 file**

❶ Confirm that the "PGM" indicator is not lit.



❷ Play the track to be repeated.



When playing a MP3 file, press the **CD ►/II** key repeatedly until "►" (play indicator) is displayed.

❸ Select "ONE REPEAT".



- If the "PGM" indicator is lit, turn it off by pressing the **PGM** key in stop mode to cancel the program mode.

Confirm that this is not lit.



Each press switches the repeat mode.

- ① "ONE REPEAT"
- ② "REPEAT"
- ③ Off.... Repeat deactivated

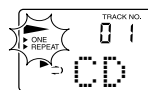

Setup for repeating all tracks in a disc **CD-DA** VIDEO CD (with PBC OFF → [18]) **MP3 file**

❶ Confirm that the "PGM" indicator is not lit.



❷ Select "REPEAT".



❸ Start playback.



When playing a MP3 file, press the **CD ►/II** key repeatedly until "►" (play indicator) is displayed.

- If the "PGM" indicator is lit, turn it off by pressing the **PGM** key in stop mode to cancel the program mode.

Confirm that this is not lit.



Each press switches the repeat mode.

- ① "ONE REPEAT"
- ② "REPEAT"
- ③ Off.... Repeat deactivated

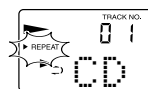

Setup for repeating selected tracks

CD-DA VIDEO CD (with PBC OFF - [18])

① Program the track sequence according to steps ① to ② of "Listening to the desired sequence (program playback)". → [28]

② Select "REPEAT".



③ Start playback.



Each press switches the repeat mode.

- ① "ONE REPEAT"
- ② "REPEAT"
- ③ Off.... Repeat deactivated



- All selected tracks will be repeated.

To stop repeated playback

Press the REPEAT key repeatedly until the repeat mode is switched off.

- The "REPEAT" indicator turns off and playback according to the current CD player mode.

Playing tracks in a random order (RANDOM)

CD-DA VIDEO CD (with PBC OFF - [18])

As the titles each time are selected randomly, the music can be enjoyed without getting tired of it.

A non-finalized CD-R cannot be played back.

Select the CD input.

① Confirm that the "PGM" indicator is not lit.



② Press the RANDOM key.



③ Start playback.



- If the "PGM" indicator is lit, turn it off by pressing the PGM key in stop mode to cancel the program mode.

Each press switches the modes as follows.

- ① "RANDOM" on (Random playback)
- ② "RANDOM" off (Normal playback)

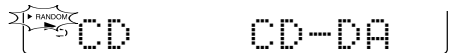

- Playback stops after each title has been played once.
- The random playback can also be repeated by pressing the REPEAT key.

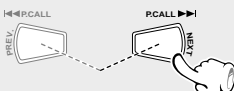
To select another track in the middle of playing one**To cancel random playback**

Press in stop mode

Press so that the "RANDOM" indicator is turned off.



- The "RANDOM" indicator goes off and the playback in order of the tracks starts from the track being played.

This unit provides the following recording features in addition to normal recording. Select the appropriate method according to the purpose of recording.

The tape deck of the unit can record signals only on Normal (Type I) and High (Type II) tapes. It cannot record on Metal (Type IV) tapes.

To record CD with a simplified method (**CD-DA** **VIDEO CD (with PBC OFF → [18])** → TAPE) → [33]

All-track recording

Records all tracks in a CD onto a tape.

Single-track recording

Records only one CD track being played onto a tape.
(This is convenient for recording of desired tracks from a disc being heard for the first time.)

To record desired CD tracks by reordering them (**CD-DA** **VIDEO CD (with PBC OFF → [18])** → TAPE) → [34]

Program recording

Recording of programmed tracks in the programmed order.
(Convenient for recording only the desired CD tracks in the desired order.)



With recording onto tape, the track will be interrupted for the part of the guide tape at the tape reversal, where recording is not possible. Please use single-side recording if this is to be avoided.

One-touch edit recording (CD-DA VIDEO CD (with PBC OFF → 18) → TAPE)

Records all tracks in a CD with a simple operation. (All-track recording)

Records a single CD track being played from the beginning. (Single-track recording)

The tape deck of the unit can record signals only on Normal (Type I) and High (Type II) tapes. It cannot record on Metal (Type IV) tapes.

Be sure to put the cassette deck in stop mode.

1 Make preparation for recording.

- ① Perform steps 1 to 3 of the procedure in "Recording on TAPE". — 26
- ② Ensure that the "PGM" and "RANDOM" indicators are not lit.
- ③ Insert disc in the CD player.

- If the "PGM" indicator is lit, turn it off by pressing the **PGM** key in stop mode to cancel the program mode.
- If the "RANDOM" indicator is lit, turn it off by pressing the **RANDOM** key to cancel the random play mode.

2 Check the current play mode of the CD player.

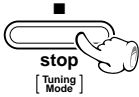
All-track recording	Single-track recording
<p>If it is in play mode, stop it.</p> 	<p>Select the desired CD track and play it.</p> <ul style="list-style-type: none"> ● When step ② is performed in the middle of CD playback, the current track will be recorded from the beginning. <p>(To record other tracks, repeat steps ② and ③ for each track)</p>

3 Start recording.

TAPE O.T.E.



If you are operating the remote, the same effect as step ③ can be obtained by simply pressing the O.T.E. key to start recording.

- When either playback or recording stops, the other operation is stopped automatically.

To interrupt a recording

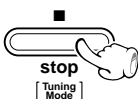

(Recording and playback will be stopped)

At the end of the recording

Cassette deck : Stop is executed after an unrecorded portion of about 4 sec. has been produced.

Program recording ([CD-DA] VIDEO CD (with PBC OFF - [18]) →TAPE)

Desired CD tracks can be programmed in the desired sequence and recorded onto a tape.

The tape deck of the unit can record signals only on Normal (Type I) and High (Type II) tapes. It cannot record on Metal (Type IV) tapes.

Be sure to put the cassette deck in stop mode.

1 Make preparation for recording.

- ① Select the CD input.
- ② Ensure that the "RANDOM" indicators are not lit.
- ③ Perform steps 1 to 3 of the procedure in "Recording on TAPE". - [26]
- ④ Insert disc in the CD player.

- If the "RANDOM" indicator is lit, turn it off by pressing the **RANDOM** key to cancel the random play mode.

2 Program the desired sequence of CD tracks.

Perform steps ① and ② of the procedure in "Listening to the desired sequence (Program playback)". - [28]

- When the **PGM** key is pressed to cancel the edited contents, the entire editing contents will be erased. - [29]
- Tracks programmed beyond the available tape recording time will be interrupted in the middle.

3 Start recording.

TAPE O.T.E.



If you are operating the remote, the same effect as step ③ can be obtained by simply pressing the O.T.E. key to start recording.

- Recording starts from the first track in the program and ends after having recorded the entire programmed tracks.
- Recording stops automatically when the program playback of CD has completed.
- When either playback or recording stops, the other operation is stopped automatically.

To interrupt a recording

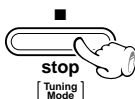

(Recording and playback will be stopped)

At the end of the recording

Cassette deck : Stop is executed after an unrecorded portion of about 4 sec. has been produced.

This unit can play MP3 file.

Please refer to the "Important notes on the MP3 file" below before playback of MP3 file.

What is MP3?

MP3 is the abbreviation of "MPEG1 Audio Layer 3". MPEG Audio is a compression specification that compresses the audio portion only. This audio compression method is used in DVD or Video CD, etc. The audio data has been compressed into about 1/10.

Important notes on the MP3 file

Acceptable medium

- CD-RW is not acceptable. Also for CD-R disc, it may not be played according to the type of the disc.
- The medium formats acceptable to this unit are ISO 9660. (The maximum total number of directories which can be recognized by this unit is 512 and the total number of files is 1957.)
- When entering file and folder names, use alphanumeric characters only.
- This unit recognized and plays only MP3 file which have the MP3 filename extension (.MP3).

Settings for your MP3 encoder and CD writer

- When you use your MP3 encoder to compress audio data to an MP3 file, set the transfer bit rate of the encoder to fixed 128 kbps (Constant Bit Rate).
- Sampling frequency is 44.1 kHz.
- When you use your CD writer to record MP3 file, check Disc at Once.

Sequence of playing MP3 files

MP3 files will be played in the sequence that the writing software had recorded. Therefore, it may be different between the sequence that you want to record and the sequence of playing. For some writing software, input "01" ~ "99", for example, before the file names in the sequence of playing and then record into a CD-R, etc, sometimes you may setup the sequence of playing.

Writing files onto a medium

When a medium containing MP3 data is loaded, the unit checks all the files on the medium. If the medium contains a lot of folders or non-MP3 file, therefore, it takes a long time until the unit starts playing MP3 file. In addition, it may take time for the unit to move to the next MP3 file or a file search or folder search may not be performed smoothly. You should not write non-MP3 file or unneeded folders along with MP3 file on the medium.



Kenwood is not responsible for playability of MP3 in any case due to recording condition such as PC performance, writing software, media ability or etc.

Playback of MP3 file (selecting MP3 file playback)

Selects the files to be played back directly regardless of the order in which it was written.

To play back files in the order they were recorded, see "Playback of CD-DA (CD, CD-R), MP3 file and the audio of VIDEO CD". → 18

It may take time for the file search depending on the number of files and the state of the folder hierarchy. PGM playback and RANDOM playback does not function during MP3 file playback.

A disc medium containing a non-closed session or a non-finalized disc medium cannot be played back.

Connect the related equipment under reference to "Connection of Other Accessories" → 8
Please operate while looking at TV screen. (The display of the unit does not show the file and folder names.)
Before operating, set the NTSC/PAL switch of this unit according to the TV format (country or region) and disc. → 15

1 Make preparation for the playing.

- ① Select the CD input.
- ② Insert disc in the CD player.

- Folder names (up to 12 folders) are displayed on the TV screen.
- File name are displayed with 8 characters.

Menu is displayed on the screen.

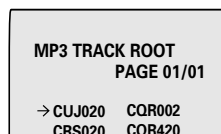

folder or file names

2 Select the required file.

- ① Press the ◀◀ or ▶▶ key on the remote control unit to select the MP3 folder or file in the same layer.

▶▶ key : Moves the next folder or file in the same layer.

◀◀ key : Moves the previous folder or file in the same layer.

- If there are more than 13 folders / files in the disc, press the ▶▶ key repeatedly until the display will be switched.

Example of a medium's folder / files hierarchy

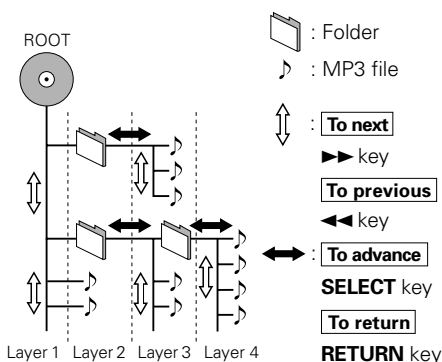

When a folder is selected in ①

Simply selecting a folder can play no file. Go to the next hierarchy level and select the desired file.

- ② Move to the layer.

SELECT key : Advances to the lower layer.

RETURN key : Returns to the higher layer.



- Files in the next folder will be played back when no files exist in the selected folder.

- ③ Press the ◀◀ or ▶▶ key to select the required file, and press the CD ▶/II key, playback starts.

- The files after the selected file will be played back in the sequence in which they were recorded.

When a file is selected in ①

- ② Press the CD ▶/II to start playback.



- The files after the selected file will be played back in the sequence in which they were recorded.

Playing back a VIDEO CD using the menu

With a disc incorporating PBC, a menu is displayed on the TV screen so that you can select the desired tracks to be played with simple interactive operations.

Before operating, set the NTSC/PAL switch of this unit according to the TV format (country or region) and disc. → 15

Key error display



If a wrong key is pressed when operating the unit, a hand mark is displayed at the top left corner of the TV monitor screen.



When PBC is ON and a VIDEO CD (with PBC) is played, the playback control functions, including the menu display, operate automatically. A conventional music CD or VIDEO CD without PBC can be played normally even when the "PBC" indicator is lit.

Select the CD input.

Press in stop mode

1 Confirm that the "PGM" indicator is not lit.



2 Select "PBC ON".



3 Press the CD ►/II key.

4 Select items on the menu display.

To select menu items (scenes):

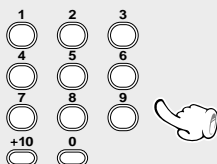

To change the display:

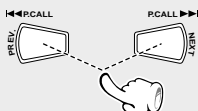

- If the "PGM" indicator is lit, press the **PGM** key to turn it off.

Confirm that this is not lit.



Each press alternates the mode.

PBC ON
PBC OFF



The menu display, the operation method, and the operation key depend the disc being played. For details, refer to the instructions enclosed with your disc.

Press the numeric key as shown below....

To select track No. 5 : **5**

To select track No. 17 : **+10 7**

- When several menus (scenes) can be selected in each level, pressing the **PREV.** or **NEXT** key switches the display.
- To operate a menu with a hierarchical structure, see "When the menu has a hierarchical structure". → 38
- A VIDEO CD requires a little time for screen switching, etc. after key operation.

Returning to the menu display



Ending the menu playback



Keep the **STOP** key depressed for more than 2 seconds.

Operation key and display examples for VIDEO CD playback

Software jacket indication	▶	⏏	◀◀	▶▶
KENWOOD operation key	SELECT	RETURN	PREV.	NEXT

- The jacket indications depend on the software and may differ from the above examples.

When the menu has a hierarchical structure

When items are selected on the menu display during playback of a VIDEO CD (with PBC), another menu with more detailed choices may be displayed. A number of menus may be connected in this way in steps, and this is called a hierarchical structure. The desired scene can be reached by repeated item selection on the menu display.

Example of a hierarchical structure

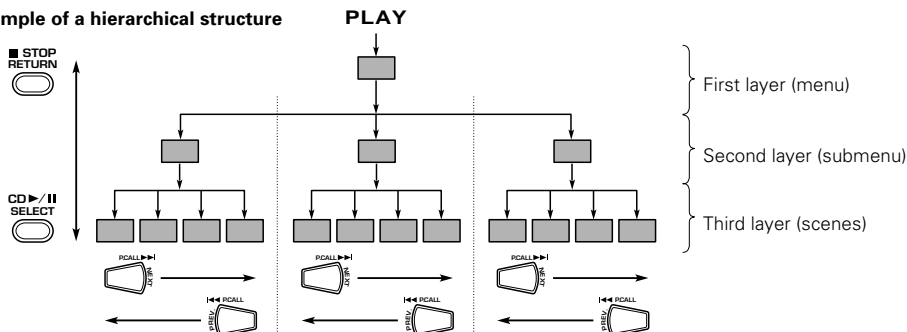

To advance

When an item is selected on the menu display using the **SELECT** key or the numeric key, you advance to the next lower menu layer. When the advance destination is the "scene" to be played, the contents will be played.



To return

Each time the **RETURN** key is pressed, you return to the next higher layer of the hierarchy.



Slow-motion playback

To play a VIDEO CD in slow motion, press the **SLOW** key during playback.



Each press of the **SLOW** key changes the speed.

① **Slow 1** → ② **Slow 2** → ③ **Slow 3**

- No sound is obtained during slow-motion playback.
- To resume normal playback press the **CD ►/II** key of the CD player.

Single-frame playback

To play a VIDEO CD frame by frame, press the **STEP** key during playback.



- Each press of the **STEP** key advances the picture by one frame.
- No sound is obtained during single-frame playback.
- To resume normal playback, press the **CD ►/II** key of the CD player.

Freezing only the image

When the **FREEZE** key is pressed during playback of a VIDEO CD, only the image is frozen while the audio continues to be played. The freeze function is cancelled and return to the normal playback image automatically when the corresponding menu (scene) is changed.



- To force the image freeze to be cancelled, press the **FREEZE** key or **CD ►/II** key.

Forward and backward search

To quickly advance or reverse the playback picture of a VIDEO CD, press the **◀◀** or **▶▶** key during playback.

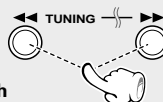

Backward search

Forward search

During forward search

Each press of the **▶▶** key changes the search speed.

① **FF** ×1 → ② **FF** ×2 → ③ **FF** ×3 → ④ **FF** ×4

During backward search

Each press of the **◀◀** key changes the search speed.

① **FB** ×1 → ② **FB** ×2 → ③ **FB** ×3 → ④ **FB** ×4

- No sound is obtained during forward or backward search.
- To resume normal playback, press the **CD ►/II** key of the CD player.
- The setting contents are displayed on the display section and the TV screen.

Switching the audio output

When playing a disc and MP3 files with multiple audio channels (such as Karaoke discs or bilingual discs), you can select the desired audio.



Each press changes the setting cyclically.

- ① **STEREO** Normal playback
- ② **MONO - L** Left channel only
- ③ **MONO - R** Right channel only

- The setting contents are displayed on the display section and the TV screen.

Time search function

To jump to a specific location of the track being played, specify the time of that location.

- Stop VIDEO CD menu playback if in progress.
- Cancel "PGM" in advance.

① Play the desired track and press the TIME SEARCH key.



② When "Go to --:--" is displayed, specify the time.

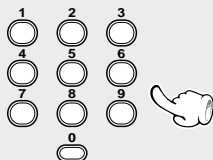

Press the numeric key as shown below....

To specify 3 minutes 30 seconds:

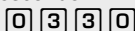

To specify 15 minutes 25 seconds:

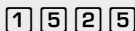

- When key input is completed, playback starts at the disc position specified by the time.

Resume function

To resume playback from the location where playback was last stopped, press the RESUME key.

- Cancel "PGM" in advance.

① Stop playback.



If the "PBC" indicator is not lit, press the ■STOP key once.

If the "PBC" indicator is lit, keep the ■STOP key depressed for more than 2 seconds.

"PBC" is deactivated when you press the ■STOP key during PBC menu playback.

The resume function may not precisely work after stopping playback of a VIDEO CD with PBC.

② Press the RESUME key.



- When the input selection or disc is changed or the power is turned off, memory is cleared and the resume function becomes invalid.

Using the Digest functions

INTRO SCAN

Plays the first ten seconds of each track of a CD-DA or VIDEO CD in turn.

DISC SCAN (disc digest)

The first images of nine tracks of a VIDEO CD are displayed as 9 mini screens at a time on the TV screen.

TRACK SCAN (track digest)

A single track of a VIDEO CD is divided into 9 parts and the first image of each part is displayed as one of 9 mini screens.

Select the CD input.

1 Press the STOP key.



- To stop playback during VIDEO CD playback, keep the  STOP key depressed for more than 2 seconds.

2 Select the desired Digest function.

① Display the menu.



The Digest menu is displayed on the screen.

- | | |
|----------|---------|
| 1. INTRO | 2. DISC |
| 3. TRACK | 4. EXIT |

② Select the desired function with a numeric key (1 to 4).

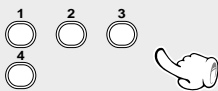

1. INTRO SCAN
2. DISC SCAN (disc digest)
3. TRACK SCAN (track digest)
4. EXIT: To exit this screen.

- The selected Digest function is executed.
- The menu items "2. DISC" and "3. TRACK" can be selected only for VIDEO CD playback.

3 Select the desired track number.

In INTRO SCAN

Pressing the numeric key for the desired track resumes normal playback mode, and playback of the selected track begins.

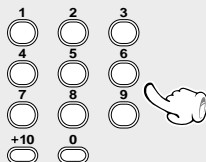

In DISC SCAN

Pressing the numeric key for the desired track number displayed on the screen resumes normal playback mode, and playback of the selected track begins.

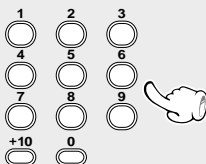

In TRACK SCAN

Pressing the numeric key for the desired scene number displayed on the screen resumes normal playback mode, and playback begins from the selected scene.

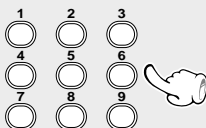

1	2	3
8	9	4
7	6	5

- To view the succeeding tracks (when there are ten or more tracks) on the mini screens, press the **NEXT** key while mini screens are displayed. To return to the previous group, press the **PREV.** key.
 - When you press the **■STOP** key while mini screens are displayed, the mini screens are cleared, and the CD player enters the stop mode.
-

1	2	3
8	9	4
7	6	5

- To view the next track on the mini screens, press the **NEXT** key while mini screens are displayed. To display the previous track, press the **PREV.** key.
- When you press the **■STOP** key while mini screens are displayed, the mini screens are cleared, and the CD player enters the stop mode.

1 Select AUX (external input).

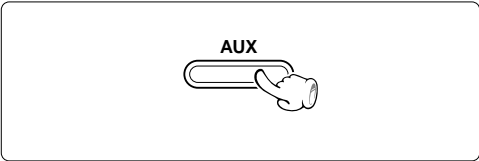

2 Play the connected equipment.

3 Adjust the volume.

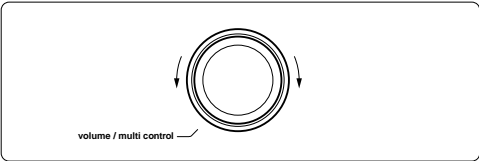

Adjusting the AUX Input Level

This adjusts the input level for the external equipment (video deck etc.) connected to the AUX input terminal. Adjust so that the volume of the AUX input source sounds at an equivalent level to the CD. (Main unit operation only)

1 Press the AUX key.

2 Select "AUX INPUT ?".

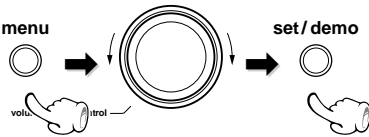

(Press the set/demo key while the "?" mark is blinking.)

3 Adjust the input level.

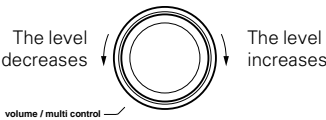

4 Set it.



Turning the knob switches the display contents.

- "TAPE RVS. ?"
- "AUX INPUT ?"
(Only when the AUX input is selected)
- "A.P.S. SET ?"
- "TIMER SET ?"

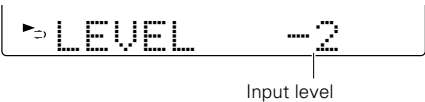

- Adjustment is possible over the range from - 5 to + 2.
- Adjusting the input level control also varies the recording level from the input source connected to the AUX input jacks.

As the clock is not only used to show the time of the day but is also used in timer operations, be sure to set the clock in advance.

1 Activate the clock adjustment mode.

Press and hold for more than 2 sec, when the power is ON.

menu



- The time display starts to blink.

2 Enter the figure of hour.

1 Enter the figure of hour.

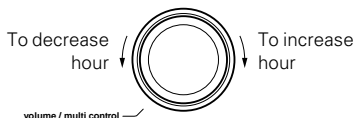

2 Set it.

set / demo



Example: Adjustment to 8:07



- Press the **set/demo** key. The hour is entered and the minute display starts to blink.

3 Enter the figure of minute.

1 Enter the figure of minute.

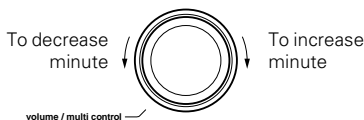

2 Set it.

set / demo



Example: Adjustment to 8:07



- If you make a mistake, restart from the beginning.
- When the time of day has been set by pressing the **set/demo** key, the display shows "COMPLETE!".
- After a power failure or the power cord has been unplugged then plugged in again, it is required to set the time again.
- When the **STOP** key is pressed while the power is in the standby mode, the time of the day will be displayed for 5 seconds.

Sleep timer (SLEEP)

The unit is turned OFF automatically after the specified period has elapsed.

Operate easy To use Timer (O.T.T.) → 46

Playback of the selected input source starts at the specified time, and the unit is switched off after one hour. This timer operates only once directly after setting.

Timer playback, timer recording (PROG.1, PROG.2) → 48

Playback of the selected input source or recording of the TUNER or AUX input starts at the specified time.

AI timer playback (PROG.1, PROG.2) → 48

When timer playback starts, the volume level increases gradually until a certain level is reached.

Sleep timer (SLEEP)

Set the number of minutes after which the unit is to be turned OFF.

Connect the related equipment under reference to "System connection" → 6 ~ 8

Remote control unit only

Set the time.



- The unit is turned OFF automatically after the set time has elapsed.
- Each press increases the timer period by 10 minutes. The sleep timer can be set up to 90 minutes.

10 → 20 → 30 70 → 80 → 90 → Cancel → 10 → 20
.....

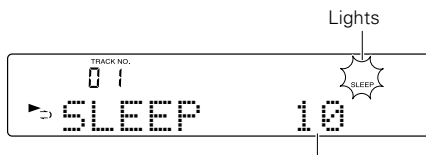

Duration for sleep timer

- Press the **SLEEP** key while the sleep timer is activated to check the remaining time.

To cancel

Turn the unit OFF or press the SLEEP key until the sleep time is cancelled.

Setting the O.T.T. timer

Timer playback which occurs only once and only for an hour can be programmed by simply setting the start time. The timer playback reproduces the source selected at the last time the unit is turned off at the last set volume. The O.T.T. timer is not possible with VIDEO CD and MP3 files.

Adjust the clock before setting the timer → 44

Connect the related equipment under reference to "System connection" → 6 ~ 8

1 Select the O.T.T. timer.

① Select "TIMER SET ?".

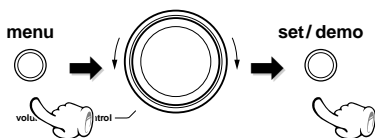

(Press the set/demo key while the "?" mark is blinking.)

② Select "O.T.T. SET ?".

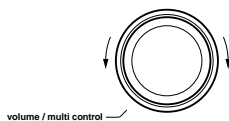

③ Set it.



(Press during display of the program contents.)

Turning the knob switches the display contents.

"TAPE RVS. ?"

"AUTO PRESET"

(Only when the TUNER input is selected)

"AUX INPUT ?"

(Only when the AUX input is selected)

"A.P.S. SET ?"

"TIMER SET ?"

Turning the knob switches the display contents.

① "O. T. T. SET ?"

② "PROG. 1 SET ?"

③ "PROG. 2 SET ?"



- The previously set contents are displayed. (If you do not want to change them, simply press the **set/demo** key.)
- When a timer setting has already been made in the selected timer, the setting will be overwritten by the new setting.

2 Set the time at which you want to start playback or reception (On time).

1 Adjust the time.

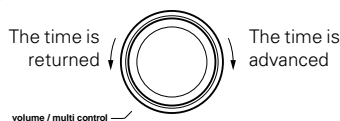

2 Set it.

set / demo

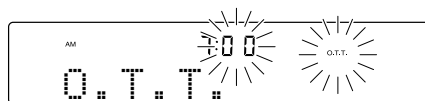

- The ON time can be set in steps of 5 minutes.
- If you make a mistake, press the **menu** key and restart from step 1.



To check or modify the reservation contents, restart the timer reservation from the beginning.

3 Reserve the timer operation.

Remote control unit only



Each press switches the timer as follows.

- ① "O.T.T."
- ② "PROG. 1"
- ③ "PROG. 2"
- ④ "PROG. 1 2"
- ⑤ Extinguished

- Press the remote's **TIMER** key repeatedly until "O.T.T." lights up.
- To cancel the timer reservation after it has been activated, press the **TIMER** key while the unit is ON so that all of the timer-related indicators are turned off. (The setting made above is still left in memory.)
- When the O.T.T. timer is set while the PROG.1 or PROG.2 timer has been set, the reservation by the PROG.1 or PROG.2 timer is canceled.

4 Put the unit in standby mode.



- When the unit enters the Standby mode, the **standby/timer** indicator lights in green.
- If there is a power failure or the power cord is unplugged after the timer reservation has been activated, the **standby/timer** indicator blinks in green. In this case, the clock setting should be restarted from the beginning.

Setting an everyday timer program (PROG. TIMER)

In each of PROG.1 and PROG.2, the timer data including the operating period and played contents can be set and selected to be activated or not as required. The PROG. timer is not possible with VIDEO CD and MP3 files.

A non-finalized CD-R cannot be played back.

Adjust the clock before setting the timer → 44

Connect the related equipment under reference to "System connection" → 6 ~ 8

1 Make preparations for the play (recording).

To listen to CD	To listen to tape	For recording
Insert a disc. (CD-DA only) Program playback is not possible.	Set a tape into.	Make preparations for recording. → 26
To listen to radio	Playing the auxiliary input source	
The station should be preset prior. → 24	Make timer setting of the component connected to the AUX input jacks.	

- Two timer settings can be reserved independently in two programs PROG.1 and PROG.2.
- Please make reservations with an interval of at least one minute, so that the operation times of PROG. 1 and PROG. 2 do not overlap.

2 Select the timer number.

① Select "TIMER SET ?".

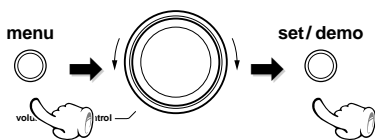

(Press the set/demo key while the "?" mark is blinking.)

② Select "PROG. 1 SET ?" or "PROG. 2 SET ?".

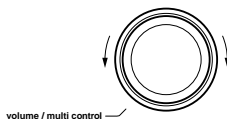

③ Set it.



(Press during display of the program contents.)

Turning the knob switches the display contents.

"TAPE RVS. ?"

"AUTO PRESET"

(Only when the TUNER input is selected)

"AUX INPUT ?"

(Only when the AUX input is selected)

"A.P.S. SET ?"

"TIMER SET ?"

Turning the knob switches the display contents.

① "O. T. T. SET ?"

② "PROG. 1 SET ?"

③ "PROG. 2 SET ?"

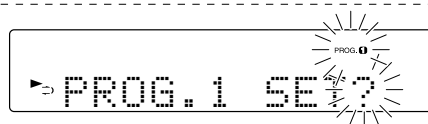

- The previously set contents are displayed. (If you do not want to change them, simply press the **set/demo** key.)
- When a timer setting has already been made in the selected timer, the setting will be overwritten by the new setting.

Continued on next page

3 Set the ON time then the OFF time.

1 Adjust the time.

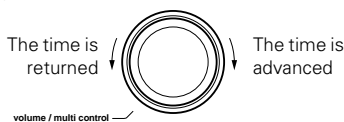

2 Set it.

set / demo

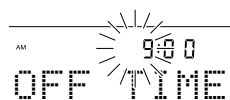
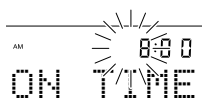

- For each of the ON time and OFF time, enter the figure of "hour" by performing steps 1 and 2 then enter the figure of "minute" in the same manner.
- If you make a mistake, press the **menu** key and restart from step 2.

4 Make the desired reservation.

For timer playback or AI timer playback

1 Select the mode.

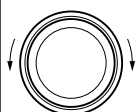

(1) Select "PLAY" or "AI PLAY".

- ① "PLAY"
(Timer play)
- ② "REC"
- ③ "AI PLAY"

(Timer play with gradually increasing volume)



set / demo



(2) Set it.

2 Select the input source.

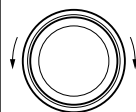

(1) Select the source to be played.

- ① "TUNER"
(Broadcasts)
- ② "CD"
- ③ "TAPE"
- ④ "AUX"

(External input / video, etc.)



set / demo



(2) Set it.

Continued on next page

For timer recording

1 Select the mode.

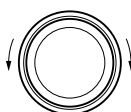

(1) Select "REC".

- ① "PLAY"
- ② "REC"
- ③ "AI PLAY"



set / demo



(2) Set it.

2 Select the input source.

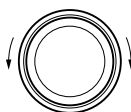

(1) Select what is to be recorded.

- ① "TUNER"
(Broadcasts)
- ② "AUX"
(External input / video, etc.)



set / demo



(2) Set it.

Continued on next page

- ③ Select the broadcast station (only when TUNER is selected above).

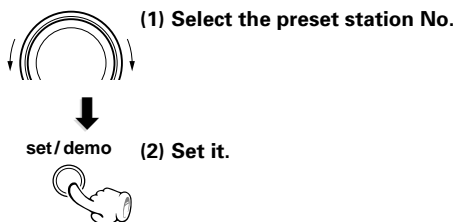

- When the timer setting is completed by pressing the **set/demo** key, "**COMPLETE !**" is displayed.
- When "**PLAY**" is selected, the timer playback will start at the volume setting used at the moment the unit is set to the Standby mode.

- ③ Select the broadcast station (only when TUNER is selected above).

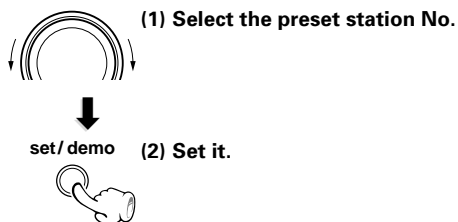

- When the timer setting is completed by pressing the **set/demo** key, "**COMPLETE !**" is displayed.
- The sound is muted during timer recording. If you want to monitor the recorded sound, turn the **volume/multi control** knob (or press the **VOLUME** key on the remote) to adjust the volume.



To check or modify the reservation contents, restart the timer reservation from the beginning.

5 Reserve the timer operation.



6 Put the unit in standby mode.



Each press switches the timer as follows.

- ① "O.T.T."
- ② "PROG. 1"
- ③ "PROG. 2"
- ④ "PROG. 1 2"
- ⑤ Extinguished

- Press the **TIMER** key on the remote repeatedly until "**PROG. 1**", "**PROG. 2**" or "**PROG. 1 2**" lights.
- To cancel timer reservation after it has been activated, press the **TIMER** key while the unit is on so that all of the timer-related indicators are turned off. (The setting made above is still left in memory.)

- When the unit enters the Standby mode, the **standby/timer** indicator lights in green.
- If there is a power failure or the power cord is unplugged after the timer reservation has been activated, the **standby/timer** indicator blinks in green. In this case, the clock setting should be restarted from the beginning.

Maintenance

Cleaning the head section

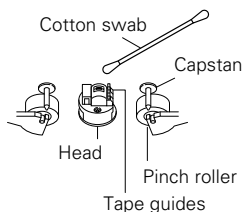

Cleaning the heads and peripheral components

For maintaining the best condition of the deck and for longer service life, always keep the heads, capstan and pinch roller clean. To clean them, perform the following:

1. Open the cassette holder.
2. Using a cotton swab dipped in alcohol, clean the head, capstan and pinch roller carefully.

Demagnetizing the head

When the recording / playback head is magnetized, the sound quality will deteriorate. In such a case, demagnetize the head using a commercially available demagnetizer (head eraser).



There are precisely aligned parts around the heads, including the tape guides.

When cleaning, pay special attention so as not to apply shock to them.

Maintenance of the unit

When the front panel or case becomes dirty, wipe with a soft, dry cloth. Do not use thinner, benzene, alcohol, etc. for these agents may cause discoloration.

In regard to contact cleaner

Do not use contact cleaners because it could cause a malfunction. Be specially careful not to use contact cleaners containing oil, for they may deform the plastic component.

Reference

Caution on condensation

Condensation (of dew) may occur inside the unit when there is a great difference in temperature between this unit and the outside.

This unit may not function properly if condensation occurs. In this case, leave the unit for a few hours and restart the operation after the condensation has dried up. Be specially cautious against condensation in a following circumstance:

When this unit is carried from a place to another across a large difference in temperature, when the humidity in the room where this unit is installed increases, etc.

Note related to transportation and movement

Before transporting or moving this unit, carry out the following operations.

- ① Remove the CD from the unit.
- ② Press the CD ►/II key.

CD NO DISC

- ③ Wait for some time and verify that the display becomes as shown in the figure.
- ④ Wait a few seconds and turn the unit OFF.

Memory backup function

Stored contents which are cleared immediately when power plug is unplugged from power outlet :

Clock display

Stored contents which are cleared in at least a day after power plug is unplugged from power outlet :

Amplifier section

"on/standby" status (ON or STANDBY), Last input selection, Volume control value, Tone control levels, AUX input level, Setting auto power save

Tuner section

Receiving band, Frequency, Preset stations, Auto/mono setting

CD player unit

Video format setting (AUTO/NTSC/PAL)

Cassette deck section

Transport direction, Tape EQ., Reverse mode

Clock timer

Timer setting contents

Disc handling precautions

Handling

Hold the discs so that you do not touch the playing surface.

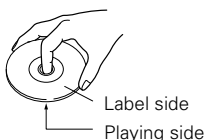

Do not attach paper or tape to either the playing side or the label side of the discs.

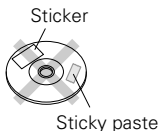

Cleaning

If there fingerprint marks or foreign matter found on the disc, lightly wipe the disc with a soft cotton cloth (or similar) from the center of the disc outwards in a radial manner.



Storage

When a disc is not to be played for a long period of time, remove it from the player and store it in its case.

Never play a cracked or warped disc

During playback, the disc rotates at high speed in the player. Therefore, to avoid danger, never use a cracked or deformed disc or a disc repaired with tape or adhesive agent. Please do not use discs which are not round because they may cause a malfunction.

Disc accessories

The disc accessories (stabilizer, protection sheet, protection ring, etc.) which are marketed for improving the sound quality or protecting discs as well as the disc cleaner should not be used with this system because they may cause malfunction.

Discs which can be played with this unit

CD (12 cm, 8 cm), VCD, CD-R, disc media of MP3 files, and the audio part of CDV, CD-G, CD-EG and CD-EXTRA. Use discs that comply with the IEC standard, for example a disc carrying the  marking on the label surface.

For the CD-R discs, see 'Notes on playback of CD-R' → 

Notes on cassette tape

Safety tab (accidental erasure prevention tab)

After an important recording has been finished, break the safety tab, to prevent the recorded contents from being erased or recorded on accidentally.

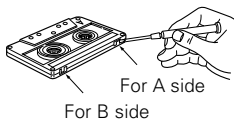

To store cassette tapes

Do not store the tapes in a place which is subject to direct sunlight, or near equipment that generates heat. Keep the cassette tapes away from any magnetic field.

To re-record

Apply tape only to the position where the tab has been removed.

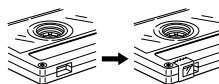

When there is slack in the tape

In such a case, insert a pencil into the reel hole and wind the reel hub to remove the slack.

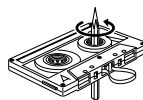

1. Longer tape than 90 minutes cassette tape

Do not use a cassette with more than 90-minute recording time, for the tape used in such a cassette is very thin and tends to cause problem such as entanglement around the pinch roller or could be easily cut off.

2. Endless tapes

Do not use an endless tape, as this could damage the mechanism of the unit.

WARNING NOTICE:

In most cases it is an infringement of copyright to make copies of tapes or discs without the permission of the copyright owners. Anyone wishing to copy commercially available tapes or disc should contact the mechanical copyright protection society limited or the performing rights society limited.

What seems to be a malfunction is not always so. Before calling for service, check the following table according to the symptom of your trouble.

Operation to reset

The microcomputer may fall into malfunction (impossibility to operate, erroneous display, etc.) when the power cord is unplugged while unit is ON or due to an external factor. In this case, execute the following procedure to reset the microcomputer and return it to normal condition.

- Please note that resetting the microcomputer clears the contents stored in and it returns to condition when it left the factory.

Unplug the power cord from the power outlet then, while holding the Power I/⏻ key depressed, plug the power cord again.



Amplifier section/Speakers

Symptom	Remedy
Sound is not produced.	<ul style="list-style-type: none">● Connect properly referring to "System connections". → 6● Adjust to an required volume.● Switch MUTE OFF. → 17● Unplug the headphone plug.
The "standby/timer" indicator blinks in red and no sound output.	<ul style="list-style-type: none">● A speaker cord is short-circuited. Turn power off and re-connect the speaker cord.
The "standby/timer" indicator blinks in amber.	<ul style="list-style-type: none">● Adjust the present time again. → 44
No sound from the headphones.	<ul style="list-style-type: none">● Insert correctly. → 17● Adjust to a required volume. → 16
Sound is not produced from the left or right speakers.	<ul style="list-style-type: none">● Connect properly referring to "System connections". → 6
The clock display blinks without changing the figures.	<ul style="list-style-type: none">● Adjust the present time again. → 44
Timer operation is not possible.	<ul style="list-style-type: none">● Adjust the present time referring to "Clock adjustment". → 44● Set the timer ON time and OFF time. → 49● Press the TIMER key to set up the execution. → 47 → 50



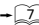
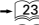
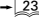
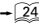
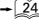

Remote control unit

Symptom	Remedy
Remote control operation is not possible.	<ul style="list-style-type: none">● Replace with new batteries. → 13● Operate the unit inside the remote controllable range. → 13

Tuner section

Symptom	Remedy
Radio stations cannot be received.	<ul style="list-style-type: none"> ● Connect antennas. →  ● Select a band. →  ● Tune to the frequency of the desired station. → 
Noise interferes.	<ul style="list-style-type: none"> ● Install the outdoor antenna in an apart position from the road. ● Switch the suspected electric appliance OFF. ● Install the TV or the system at an increased distance between them.
A station has been preset but it cannot be received by pressing the P.CALL key.	<ul style="list-style-type: none"> ● Preset stations with tunable frequencies. →  ● Preset stations again. → 

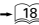
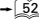
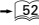
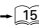
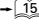
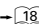
CD player section

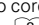
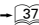
Symptom	Remedy
A CD is placed in the player but it cannot be played.	<ul style="list-style-type: none"> ● Place the disc properly, with the label side facing upward. ● Clean the disc referring to "Disc handling precautions". →  ● Refer to "Caution on condensation" and remove the condensation by evaporation. →  ● A non-finalized CD-R cannot be played back.
Sound is not produced.	<ul style="list-style-type: none"> ● Press the CD ►/II key. →  ● Clean the disc referring to "Disc handling precautions". → 
Sound skips.	<ul style="list-style-type: none"> ● Clean the disc referring to "Disc handling precautions". →  ● Install the unit in a place not subject to vibrations.
The upper and lower parts of the playback picture of a VIDEO CD are missing or blackened.	<ul style="list-style-type: none"> ● Select the correct video format. →  ● Check the video format of the VIDEO CD or the monitor. → 
Picture is not produced.	<ul style="list-style-type: none"> ● Replace by a VIDEO CD disc. ● Press the CD ►/II key. →  ● Operate the TV correctly. Refer to "Connection of other accessories (Commercially available parts)" and connect the video cord correctly. →  ● Clean the disc referring to "Disc handling precautions". →  ● Try another disc.
Menu playback is not possible.	<ul style="list-style-type: none"> ● Menu playback is not possible for a disc without PBC. ● Press the AUTO PBC key on the remote control unit to select "PBC ON". → 

Some CD-R discs may not be playable on this unit even if it has been finalized.

Cassette deck section

Symptom	Remedy
Sound cannot be produced by pressing the play key.	<ul style="list-style-type: none"> ● Clean the head referring to "Maintenance". → 51 ● The tape is wound too tight due to irregular winding. ● Play a recorded tape.
No operation occurs even when an operation key is pressed.	<ul style="list-style-type: none"> ● Press operation keys in more than a few seconds after closing the cassette holder. → 21 ● Change the tape transport direction or reverse the tape insertion orientation. → 21
The cassette holder cannot be opened by pressing "▲ push open".	<ul style="list-style-type: none"> ● Press in stop mode. ● Reset the microcomputer. → 53
Sound is harsh or high frequencies are not reproduced.	<ul style="list-style-type: none"> ● Clean the head referring to "Maintenance". → 51 ● Try another tape.
Sound is distorted.	<ul style="list-style-type: none"> ● The recording level is not set properly (when the AUX input is recorded). Adjust the AUX input level. → 43
Noise is noticeable.	<ul style="list-style-type: none"> ● Demagnetize the head referring to "Maintenance". → 51 ● Install the system at a distance from other electric appliances and TV. ● Set the TAPE EQ. to on. → 22
Sound vibrates.	<ul style="list-style-type: none"> ● Clean the head referring to "Maintenance". → 51 ● Wind the tape again by fast forwarding, rewinding or playing from an end to the other. → 21 → 22
Recording cannot be started by pressing the record key.	<ul style="list-style-type: none"> ● Use a cassette with an unbroken recording protect tab or block the hole. → 52 ● Close the holder completely. → 21 ● Set the input selector to the source to be recorded. → 27 ● Change the tape transport direction or reverse the tape insertion orientation. → 21

Displayed messages and actions to be taken against them

Displayed Message	Meaning
PGM FULL	<ul style="list-style-type: none"> ● An attempt is made to select a 33rd track during programming of CD.
PGM Mode	<ul style="list-style-type: none"> ● An attempt is made to start random playback in the program mode. Exit from the program mode before random playback. → 29
RANDOM Mode	<ul style="list-style-type: none"> ● An attempt is made to perform TAPE O.T.E. recording while the unit is in the CD random play mode. Exit from the random play mode. → 31
NO Disc	<ul style="list-style-type: none"> ● No disc is loaded. ● The loaded CD-R disc has not been finalized.
ERROR	<ul style="list-style-type: none"> ● The disc is abnormal (causing a trouble such as impossibility of reading). Replace it with a normal disc.
NOT AUDIO	<ul style="list-style-type: none"> ● The disc or the signal recoded in it is incompatible with this unit. This is not mal-function of this unit.
no FILE	<ul style="list-style-type: none"> ● The disc does not contain MP3 files. Replace it with a disc containing files that can be played back with this unit.
unknown	<ul style="list-style-type: none"> ● The disc is of the type that cannot be played back with this unit.

Main unit**[Amplifier section]**

Rated output power during STEREO operation
(1 kHz, 10% T.H.D., at 6 Ω) 30 W + 30 W

(For Singapore)

Rated output power during STEREO operation
(1 kHz, 10% T.H.D., at 6 Ω) 25 W + 25 W

Frequency response

AUX 50 Hz~50 kHz (0 dB ~ -3dB)

[Tuner section]**FM tuner section**

Tuning frequency range 87.5 MHz ~ 108 MHz

AM (MW) tuner section

Tuning frequency range

9 kHz step 531 kHz ~ 1,602 kHz

10 kHz step 530 kHz ~ 1,610 kHz

[CD player section]

Laser Semiconductor laser

D/A Conversion 1 Bit

Over sampling 8 fs (352.8 kHz)

Laser wave length 760 to 800 nm

Laser power class Class 1 (IEC)

Digital output (Optical) - 15 dBm ~ - 21 dBm
(Wave length 660 nm)

Video Output format NTSC/PAL

Video Output level 1 Vp-p (75 Ω)

[Cassette deck section]

Track 4-track, 2-channel stereo

Recording system AC bias system
(Frequency: 105 kHz)

Heads

Playback/ recording head 1

Erasing head 1

Motor 1

Wow and flutter 0.2 % (W.R.M.S.)

Fast winding time Approx. 110 seconds
(C-60 tape)

[General]

Power consumption 90 W

(For Singapore)

Power consumption 80 W

Dimensions W : 180 mm

H : 255 mm

D : 317 mm

Weight (net) 5.5 kg

Speakers

Enclosure Bass-reflex type, magnetically shielded

Speaker configuration

Woofer 120 mm, cone type

Tweeter 25 mm, dome type

Impedance 6 Ω

Maximum input level 30 W

Dimensions W : 150 mm

H : 255 mm

D : 215 mm

Weight (net) 2.3 kg (1 piece)



KENWOOD follows a policy of continuous advancements in development. For this reason specifications may be changed without notice.

- Sufficient performance may not be exhibited at extremely cold locations (where water freezes).

KENWOOD

For your records

Record the serial number, found on the back of the unit, in the spaces designated on the warranty card, and in the space provided below. Refer to the model and serial numbers whenever you call upon your dealer for information or service on this product.

Model _____ Serial Number _____