

210 CA1

8" Access 1 coaxial

- Adjustable aluminum inverted dome tweeter
- All weather woven glass fiber cone
- 100mm (4") magnet



Frequency Response / Impedance

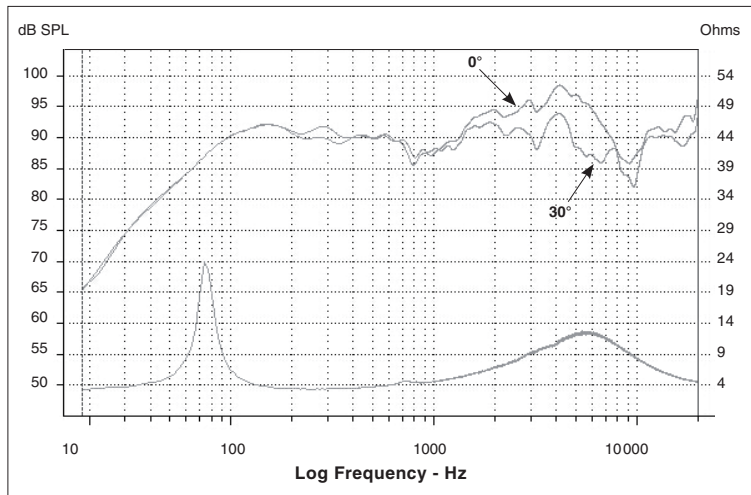

Mechanical Drawing

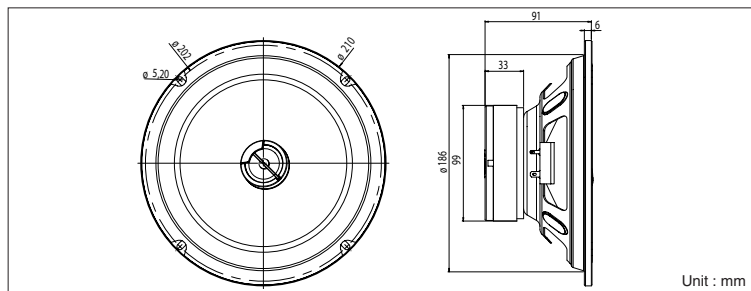

©Focal-JMlab - AS05026/2

Focal® is a trademark of Focal-JMlab® - BP 374 - 108, rue de l'Avenir - 42353 La Talaudière cedex France - Tél. [33] 04 77 43 57 00 - Fax [33] 04 77 37 65 87 - www.focal-fr.com - SCAZ070503/3

Specifications

Nominal power	80 W	
Maximum power	160 W	
Sensitivity	93 dB	
Cone	Braided glass fiber®	
Surround	Butyl	
Nom. impedance	4 ohms	
DC resistance	3.31 ohms	
VC diameter	30 mm	1-3/16 in
VC height	12,5 mm	1/2 in
Former	Kapton®	
Layers	2	
Wire	Copper	
Inductance		
Xmax	2.5 mm	1/16 in
Magnet d x h	100 x 20 mm	4x13/16 in
Magnet weight	0.56 kg	1.23 lb
Flux density	1.1 T	
Gap height	5 mm	1/8 in
Net weight	1.55 kg	3.42 lb

Parameters

Fs	49.32 Hz
Vas	27.56 l
Qts	0.52
Qes	0.59
Qms	4.13
Re	3.31 ohms
Sd	226.98 cm² 35.20 in
Cas	4.27E-07 m²/N
Mas	24.4 kg/m⁴
Ras	830.67 ohms.ac
Cms	4.32E-04 m/N
Mms	24.08 g
Rms	1.807 kg/s
Ces	575.20 mF
Les	18.10 mH
Res	22.98 ohms
Bl	6.45 N/A
SPL	89.3 dB/W/m

Suggested application

Load	V (l)	Fb (Hz)	F-3 (Hz)	Ql
Sealed	30	-	67	0,9
Sealed	-	-	-	-
Sealed	-	-	-	-

