



# MODEL T26900

## 52" 10-DRAWER TOOL CHEST

### INSTRUCTIONS

For questions or help with this product contact Tech Support at (570) 546-9663 or techsupport@grizzly.com

## Introduction

The Model T26900 10-Drawer Tool Chest (see **Figure 1**) comes fully assembled except for two side handles. Follow instructions below for assembly, operation, and maintenance.



**Figure 1.** Model T26900.

## ! WARNING

- To reduce risk of crushing injuries from tool chest tipping over on you:
  - Do not stand on tool chest or in drawers.
  - Only open one drawer at a time.
  - Only move or transport tool chest with all drawers closed and locked.
- Do not exceed weight capacities:
  - Max individual drawer weight limit is 50 lbs.
  - Max tool chest weight limit (including contents) is 400 lbs.
- Do not allow children to have unsupervised access to tool chest.

## Inventory

Description	Qty
A. Tool Box w/Drawers.....	1
B. Keys.....	2
C. Side Handles.....	2
D. Hex Bolts M8-1.25 x 16 .....	4

## Assembly

1. Place chest on flat, level surface capable of supporting weight when fully loaded.
2. Attach each side handle using two M8-1.25 x 16 hex bolts (see **Figure 2**).

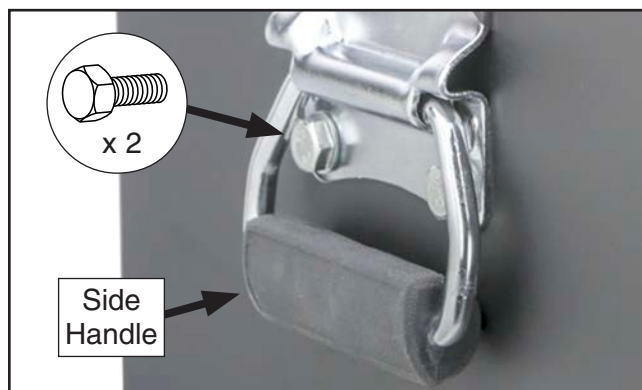

**Figure 2.** Side handle installed.

## Locking & Unlocking Chest

To lock chest, close all drawers and top, then lock top with key.

To unlock chest, unlock top with key, then open top first to access drawers.

## Removing & Installing Drawers

The drawers can be removed and re-installed if an object inside causes them to not close fully.

### To remove and install drawers:

1. Open top.
2. Fully extend drawer and remove contents.
3. Push left locking tab down and hold, then pull right locking tab up and hold (see **Figure 3**).

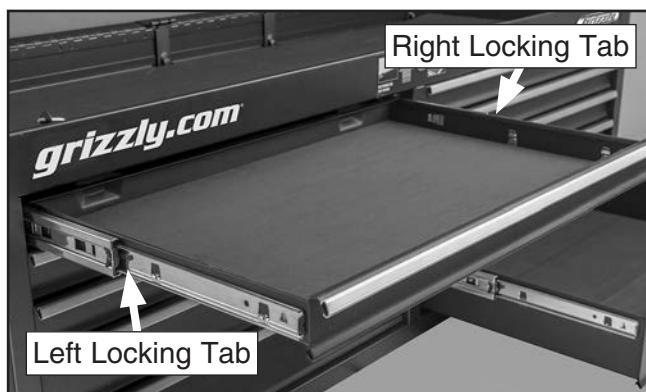

**Figure 3.** Location of drawer locking tabs.

4. Pull drawer out.
5. Apply a thin layer of dry lubricant to drawer slides.
6. To re-install, insert drawer runners into slides and push drawer in until it stops. The locking tabs will automatically snap into place to secure the drawer in the slides.

## Maintenance

- Use soft, clean cloth, and standard cleaning solution to remove grease, dirt, or oil. Do not use solvents or flammable cleaning liquids.
- Lubricate drawer slides as needed with dry lubricant.
- Use graphite to lubricate lock annually.



# T26900 Parts Breakdown and List

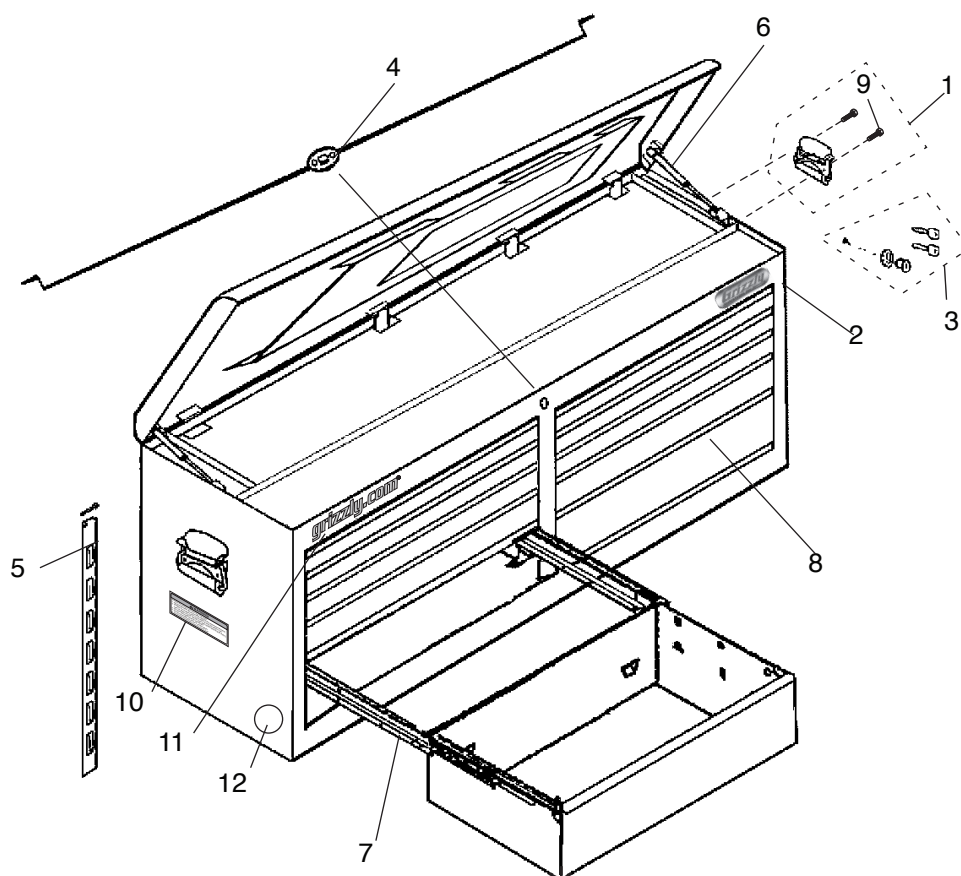

REF	PART #	DESCRIPTION
1	PT26900001	SIDE HANDLE SET W/HARDWARE
2	PT26900002	GRIZZLY NAMEPLATE-MINI
3	PT26900003	LOCK SET W/2 KEYS
4	PT26900004	ACTUATOR ASSEMBLY
5	PT26900005	LOCKING BAR AND PIN
6	PT26900006	LID LIFT SET
7	PT26900007	DRAWER SLIDE SET
8	PT26900008	DRAWER TRIM 23-3/4"
9	PT26900009	HEX BOLT M8-1.25 X 16
10	PT26900010	WARNING LABEL FOR TOOLBOXES
11	PT26900011	GRIZZLY.COM GOLD LOGO
12	PT26900012	BLACK TOUCH-UP PAINT

**Please Note:** We do our best to stock replacement parts whenever possible, but we cannot guarantee that all parts shown here are available for purchase. Call (800) 523-4777 or visit our online parts store at [www.grizzly.com](http://www.grizzly.com) to check for availability.





Buy Direct and Save with Grizzly® – Trusted, Proven and a Great Value!  
~Since 1983~

*Visit Our Website Today For  
Current Specials!*

**ORDER  
24 HOURS A DAY!  
1-800-523-4777**

