

2002 SONY MOBILE PRODUCT GUIDE



- 80W max input power (20W RMS)
- 4 x 6" Polypropylene Woofer
- 1" Polycarbonate Tweeter
- Custom-fit dash speaker

XS-4624 **Coaxial 2 Way Speaker**

SPECIFICATIONS

Speaker	Coaxial 2-way: Woofer 9.5 × 15.3 cm (4 × 6 in.), polypropylene cone type Tweeter 2.5 cm (1 in.), balanced dome type
Maximum input power	80 watts
Rated input power	20 watts
Impedance	4 ohms
Sensitivity	88 dB/W/m
Frequency response	45 - 25,000 Hz
Mass	Approx. 530 g (1 lb 3 oz.) per speaker

PARTS LIST

Part No.	Description
1-544-808-11	SPEAKER (L) (9.5cmX15.3cm)
1-544-808-21	SPEAKER (R) (9.5cmX15.3cm)
3-229-410-11	MANUAL, INSTRUCTION (ENGLISH, FRENCH)
1-574-318-41	CORD, SPEAKER (R-CH) (GRAY)
1-574-318-71	CORD, SPEAKER (L-CH) (WHITE)
A-3254-779-A	SCREW ASSY (x8)

**XS-4624
Coaxial 2 Way Speaker**

Dimensions

Unit: mm (in.)

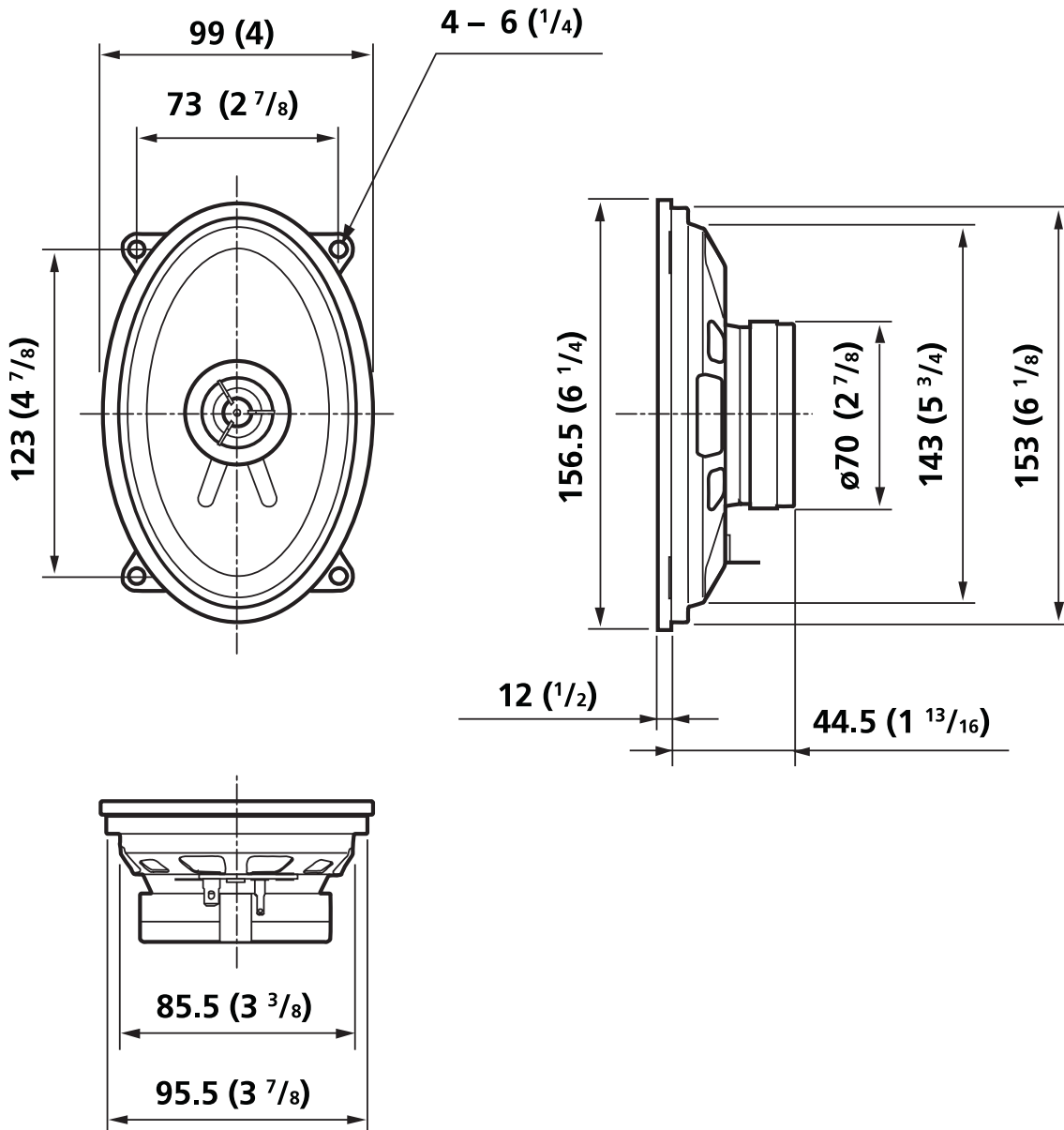

Mounting depth (recommend) 50 (2)