



PRO OPTIC

4X4 FILTER KIT MANUAL

Precise Tools for
Creative Exposures

INSTALLATION INSTRUCTIONS

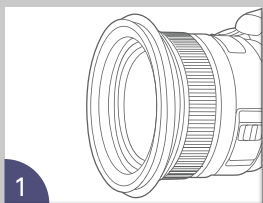

Attach the appropriate adapter ring to the threads on your lens. Tighten firmly.

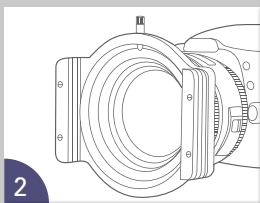

Align the bottom of the filter holder and slide it into the adapter ring.

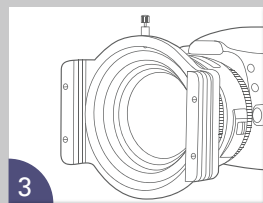

Lift the locking pin and completely install the filter holder onto the adapter ring.

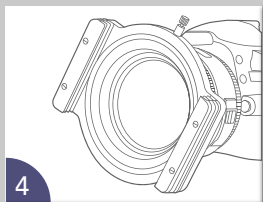

The filter holder should be able to smoothly rotate around the diameter of the adapter ring.

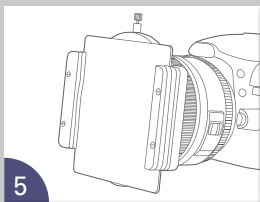

Slide in the desired filters. Adjust height and angle for perfect exposure.

NOTES:

- The included filter holder will hold 100mm filters (2mm thick). For other sizes please use clips.
- Due to the materials used, rotating the filter holder may result in a squeaking or sliding noise. This is not a defect.
- You can use this accessory to hold 2 filters simultaneously. Please purchase additional adapters if you require more.

