

KENWOOD

ENGLISH

HM-437MP

FRANÇAIS

COMPACT Hi-Fi COMPONENT SYSTEM

INSTRUCTION MANUAL

DEUTSCH

NEDERLANDS

ITALIANO

ESPAÑOL



KENWOOD CORPORATION

B60-5521-08 00 © (E) 1988 0404

Before applying power

⚠ Caution : Read this page carefully to ensure safe operation.

Units are designed for operation as follows.

Europe AC 230 V only

ENGLISH

The marking of products using lasers





**CLASS 1 LASER PRODUCT
LASER KLASSE 1
APPAREIL A LASER DE CLASSE 1
LUOKAN 1 LASERLAITE
KLASS 1 LASERAPPARAT**

The marking this product has been classified as Class 1. It means that there is no danger of hazardous radiation outside the product.

Location: Bottom

Safety precautions

WARNING : TO PREVENT FIRE OR ELECTRIC SHOCK, DO NOT EXPOSE THIS APPLIANCE TO RAIN OR MOISTURE.

	CAUTION RISK OF ELECTRIC SHOCK DO NOT OPEN		CAUTION: TO REDUCE THE RISK OF ELECTRIC SHOCK, DO NOT REMOVE COVER (OR BACK). NO USER-SERVICEABLE PARTS INSIDE. REFER SERVICING TO QUALIFIED SERVICE PERSONNEL.
	THE LIGHTNING FLASH WITH ARROWHEAD SYMBOL, WITHIN AN EQUILATERAL TRIANGLE, IS INTENDED TO ALERT THE USER TO THE PRESENCE OF UNINSULATED "DANGEROUS VOLTAGE" WITHIN THE PRODUCT'S ENCLOSURE THAT MAY BE OF SUFFICIENT MAGNITUDE TO CONSTITUTE A RISK OF ELECTRIC SHOCK TO PERSONS.		
	THE EXCLAMATION POINT WITHIN AN EQUILATERAL TRIANGLE IS INTENDED TO ALERT THE USER TO THE PRESENCE OF IMPORTANT OPERATING AND MAINTENANCE (SERVICING) INSTRUCTIONS IN THE LITERATURE ACCOMPANYING THE APPLIANCE.		

Unpacking

Unpack the unit carefully and make sure that all accessories are present.

Antenna terminal cover	(1)
Screw for antenna terminal cover	(1)
AM loop antenna	(1)
Remote control unit	(1)
Batteries(R6/AA)	(2)

If any accessories are missing, or if the unit is damaged or fails to operate, notify your dealer immediately. If your unit was shipped to you directly, notify your shipper immediately. KENWOOD recommend that you retain the original carton and packing materials in case you need to move or ship the unit in the future.

Keep this manual handy for future reference.

Discs for playback

This system can playback all digital audio CD, finalized digital audio CD-Recordable (CDR) discs and finalized digital audio CD-Rewritable(CDRW) discs. This system can also playback CD-DA format digital audio CD.

Support following MP3-CD formats:

- ISO 9660 format - Max. 20 characters.
- Max. file number plus album is 896.
- Max. nested directory is 8 levels.
- The max. ALB number is 256 including root ALB (directory).
- The max. MP3 program file number is 60.
- This player can play mixed mode disc:
MP3+CDDA can only play the MP3 files in the first block.
- Supported VBR bit-rate.
- Supported sampling frequencies for MP3 disc: 32kHz, 44.1kHz, 48kHz.
- Supported bit-rates of MP3 disc are: 32, 64, 96, 128, 192, 256 (kbps).

Following formats can't be supported

- The files like *.AAC, *.DLF, *.M3U, *.PLS.
- Chinese name.
- The non-session closed discs.
- The discs recorded under UDF format.

Contents

Caution : Read the pages marked  carefully to ensure safe operation.

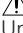
 Before applying power	2
 Safety precautions	2
Unpacking	3
Discs for playback	3
Preparing the remote control	4
Connections	4
Names and functions of parts	5
Remote control unit	5
Main unit	6
Basic function	8
Demonstration mode	8
Switching the system on	8
Switching the system to standby mode	8
Volume control	8
Sound control	8
Headphones	8
Using the CD/MP3-CD	9
Loading a disc	9
Playing a normal disc	9
Selecting a desired track/passage	9
Selecting a desired album/file (For MP3-CD only)	9
Programming tracks	10
Programming files (For MP3-CD only)	10
Random	11
Repeat	11
Intro scan	12
Using the RDS/DISPLAY button	12
Using the radio	12
Tuning in radio stations	12
Storing preset	12
Tuning to a preset radio station	13
Using RDS (Radio Data System)	13
Using the RDS/DISPLAY button	13
Tuning by Program Type (PTY search)	13
Using the cassette	14
Playing a cassette tape	14
Recording on a cassette tape	14
Clock/timer operation	16
View clock	16
Clock setting	16
Timer setting	16
To activate/deactivate the timer	17
Sleep timer setting	17
General information	18
Maintenance	18
In case of difficulty	19
Specifications	20

Before applying power

Preparing the remote control

Insert batteries type R6/LR6 ("AA" size) into the remote control.

Operation

When the **standby** indicator is lit, the power turns ON when you press the **POWER** ⏻ button on the remote control. When the power comes on, press the button you want to operate.

Notes:

- The supplied batteries may have shorter lives than ordinary batteries due to use during operation checks.
- When the remote-controllable distance gets shorter than before, replace both batteries with new ones.
- Placing the remote sensor in direct sunlight, or in direct light from a high frequency fluorescent lamp may cause a malfunction.
In such a case, change the location of the system installation to prevent malfunction.

Connections

Connecting the AM antenna

Set up the AM loop antenna, and then connect it.

Speakers connection

- Connect the right speaker to terminal marked "R", with the red wire to + and the black wire to -.
- Connect the left speaker to terminal marked "L", with the red wire to + and the black wire to -.
- Clip the stripped portion of the speaker wire as shown.

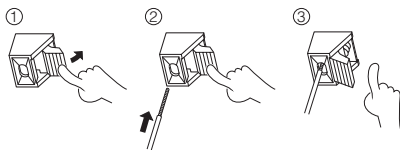

Notes:

- For the FM antenna : Adjust the position of the FM antenna for the best reception.
- For optimal sound performance, it is recommended to use the supplied speakers.
- Do not connect more than one speaker to any one pair of +/- speaker terminal.

CAUTION

Be sure to adhere to the following, or proper ventilation will be blocked causing damage or fire hazard.

- Do not place any objects impairing heat radiation onto the top of the unit.
- Leave some space around the unit (from the largest outside dimension including projection) equal to or greater than, shown below.

Top panel : 50 cm

Back panel : 10 cm

CAUTION

- Place the unit where the AC power cord can be easily unplugged.
- The power in this unit will not be completely cut off from the AC wall outlet when the power switch is turned OFF. To cut off the power completely, unplug the AC power cord from the AC wall outlet.

Names and functions of parts

Remote control unit

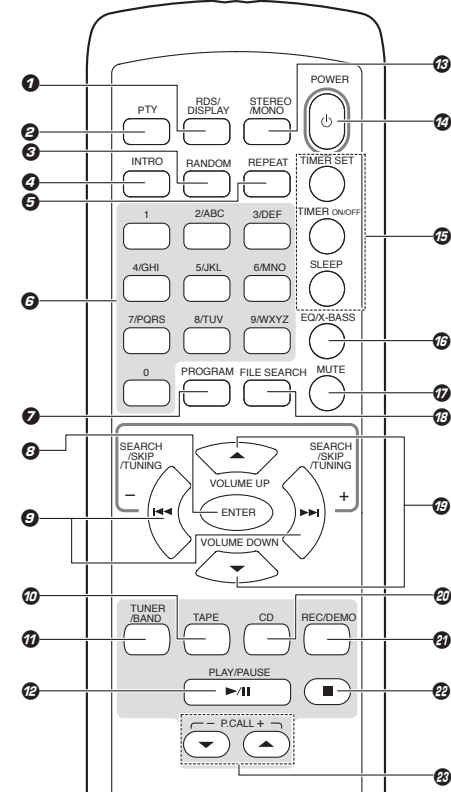

- 1 RDS/DISPLAY button**
To change the display for RDS; to view the current status of the system; to change the time display for CD; to change the information display for MP3-CD.
- 2 PTY button**
To carry out PTY search. (the Europe only)
- 3 RANDOM button**
To carry out random playback for CD.
- 4 INTRO button**
To play first several seconds for each track of CD.
- 5 REPEAT button**
To repeat one track or all tracks for CD.
- 6 digit (0 ~ 9/WXYZ) buttons**
To select a track number for CD; to select a preset radio station for TUNER; to enter file names in file search mode for MP3-CD.
- 7 PROGRAM button**
To program disc tracks for CD; to program preset radio stations for TUNER; to set or reset clock for clock; to set or reset timer for timer.

- 8 ENTER button**
To confirm the selection in file search mode for MP3-CD.
- 9 SEARCH/SKIP/TUNING +/- >>>/<<< buttons**
To search forward/backward to next/previous track for CD; to skip tracks for CD; to search forward/backward or to skip to the next/previous album for MP3; to fast forward or rewind a tape; to tune to higher/lower radio frequency or search radio stations for TUNER; to set the hour and minutes for clock; to set timer function for timer.
- 10 TAPE button**
To select TAPE input or turn the system on to TAPE input.
- 11 TUNER/BAND button**
To select TUNER input or turn the system on to TUNER input. When in TUNER input, press the select the waveband: FM or AM.
- 12 PLAY/PAUSE >/|| button**
To start or interrupt playback for CD.
To start playback for TAPE.
- 13 STEREO/MONO button**
To switch between stereo mode and mono mode (on FM band only) for TUNER.
- 14 POWER ⏻ button**
To switch the system on or to standby mode.
- 15 Clock and timer related buttons**
TIMER SET button to view the clock or set the clock.
TIMER ON/OFF button to switch the timer on/off.
SLEEP button to select the sleep time.
- 16 EQ/X-BASS button**
To select the desired sound effect: POP, CLASSIC, ROCK, JAZZ or FLAT; to switch on/off X-BASS mode.
- 17 MUTE button**
To interrupt and resume sound reproduction.
- 18 FILE SEARCH button**
To select a desired file in an MP3 disc.
- 19 VOLUME UP/DOWN $\blacktriangle/$$\blacktriangledown$ buttons**
To increase or decrease the volume.
- 20 CD button**
To select CD input or turn the system on to CD input.
- 21 REC/DEMO button**
To record from TUNER or CD to a cassette tape. To activate/deactivate the demonstration in STANDBY or power on mode.
- 22 \blacksquare button**
To stop playback for CD or TAPE; to stop programming for CD.
- 23 P.CALL +/- $\blacktriangle/$$\blacktriangledown$ buttons**
To select a preset radio stations for TUNER.

Main unit

ENGLISH

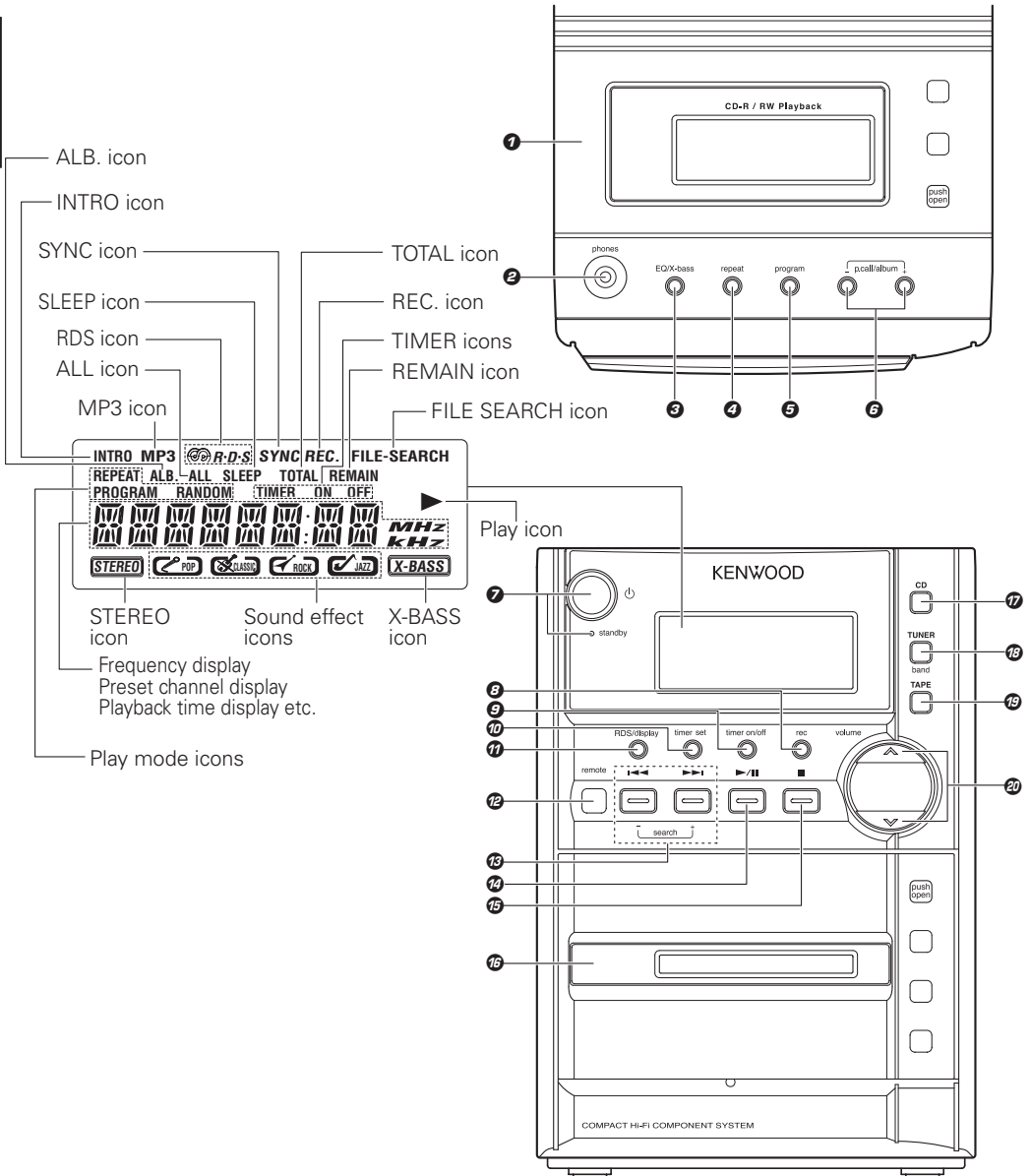

- ❶ CD compartment
- ❷ **phones** jack
- ❸ **EQ/X-bass** button
To select the desired sound effect: POP, CLASSIC, ROCK, JAZZ or FLAT; to switch on/off X-BASS mode.
- ❹ **repeat** button
To repeat one track or all tracks for CD.
- ❺ **program** button
To program disc tracks for CD; to program preset radio stations for TUNER; to set or reset clock for clock; to set or reset timer for timer.
- ❻ **p.call/album +/-** buttons
To select a preset radio stations for TUNER; to select an album of MP3.
- ❼ **⏻** button
To turn the system on or to standby mode.
standby indicator
- ❽ **rec** button
To record from TUNER or CD to a cassette tape; to activate/deactivate the demonstration in STANDBY or power on mode.
- ❾ **timer on/off** button
To switch the timer on/off.
- ❿ **timer set** button
To view the clock or set the clock.
- ⓫ **RDS/display** button
To change the display for RDS; to view the current status of the system; to change the time display for CD; to change the information display for MP3-CD.
- ⓬ Remote sensor
- ⓭ **search +/- >>> / <<<** buttons
To search forward/backward to next/previous track for CD; to skip tracks for CD; to search forward/backward or to skip to the next/previous album for MP3; to fast forward or rewind a tape; to tune to higher/lower radio frequency or search radio stations for TUNER; to set the hour and minutes for clock; to set timer function for timer.
- ⓮ **> / ||** button
To start or interrupt playback for CD.
To start playback for TAPE.
- ⓯ **■** button
To stop playback for CD or TAPE.
To stop programming for CD.
- ⓰ **Cassette tape** compartment
- ⓱ **CD** button
To select CD input or turn the system on to CD input.
- ⓲ **TUNER/band** button
To select TUNER input or turn the system on to TUNER input. When in TUNER input, press the select the waveband: FM or AM.
- ⓳ **TAPE** button
To select TAPE input or turn the system on to TAPE input.
- ⓴ **VOLUME ▲/▼** buttons
To increase or decrease the volume.

Standby mode

While the standby indicator is lit, a small amount of power is supplied to the system to back up the memory. This is called standby mode. Under the condition, the system can be turned ON by the remote control unit.

Basic function

Demonstration mode

The system is equipped with a demonstration function (only display). The demonstration consists of sequential change of display and indicators showing the operations, but the audio itself does not change. The demonstration function can be cancelled as follows.

To deactivate the demonstration

Press and hold **rec** button (**REC/DEMO** button on the remote control) for more than 0.8 seconds during demonstration.

To activate the demonstration

After turning the power on, press and hold **rec** button (**REC/DEMO** button on the remote control) for more than 0.8 seconds.

Note:

The demonstration operates automatically when a power failure has occurred, or the plug of the power cable has been pulled out while the power was on.

Switching the system on

Press **⏻** button on the unit or **POWER** **⏻** button on the remote control; or **CD**, **TUNER/band** (**TUNER/BAND** on the remote control), or **TAPE** button.

The **standby** led will go out.

- The system will switch to the last selected source or the selected source.

Switching the system to standby mode

Press **⏻** button on the unit or **POWER** **⏻** button on the remote control.

- The clock will be displayed.

Volume control

Press **volume ▲** button on the unit (**VOLUME UP** **▲** button on the remote control) to increase, or press **volume ▼** button on the unit (**VOLUME DOWN** **▼** button on the remote control) to decrease the volume level.

“VOL XX” will be displayed. “VOL XX” denotes the volume level.

The volume can be adjusted in 32 steps from minimum to maximum.

To switch off the volume temporarily

Press **MUTE** button on the remote control.

Playback will continue without sound only system speaker output and the icon “MUTE” appears on the display.

To restore the volume, press **MUTE** button on the remote control again or adjust the volume.

Sound control EQ/X-BASS

The sound control system feature enables you to enjoy special sound effects that have preset equalizer settings, providing the best music reproduction.

Press EQ/X-BASS button

To select the desired sound effect: POP, CLASSIC, ROCK, JAZZ or FLAT.

To switch the X-BASS on/off

Press and hold the **EQ/X-bass** button on the unit (**EQ/X-BASS** button on the remote control).

If X-BASS is switched on, “BASS ON” will appear then disappear on the display and the icon “X-BASS” will appear on the display. If X-BASS is switched off, “BASS OFF” will appear then disappear on the display and the icon “X-BASS” will disappear.

Note:

EQ and X-BASS functions are not applied to the recording sound.

Headphones

To listen to your stereo with headphones (not included), use the 3.5 mm **phones** jack on the top of the unit.

Using the CD/MP3-CD

Loading a disc

- 1 Press **CD** button to select CD/MP3 mode.
- 2 Press the area marked **push open** to open the CD door.
- 3 Place a CD/MP3 into the tray with the label facing up.
- 4 Close the CD door.

The total playtime and total number of tracks will appear in the display.

- 5 To remove the CD, press the area marked **push open**, grasp the CD by its edges, and carefully pull it out.

For MP3-CD only

Load a MP3 format music disc on the disc tray.

- The total album number and total file number will appear on the display.

Notes:

- To ensure good system performance; wait until the unit completely reads the disc before proceeding.
- If the CD compartment is not loaded with a CD/MP3-CD or the CD/MP3-CD is unreadable, the message "NO PLAY" will be blinking.
- For MP3-CD, the disc reading time may exceed 10 seconds due to the large number of songs compiled into one disc.
- For MP3-CD, "A" on the display represents ALBUM.
- For MP3-CD, the total album number on the display indicates the number of all the albums recorded in the MP3-CD.

Playing a normal disc

- 1 Press **▶/||** button (**▶/|| PLAY/PAUSE** button on the remote control) to start playback.

The track number and elapsed playing time of the current track appear on the display.

To interrupt playback, press **▶/||** button (**▶/|| PLAY/PAUSE** button on the remote control).

The playing time will start flashing.

To resume playback press **▶/||** button (**▶/|| PLAY/PAUSE** button on the remote control) again.

- 2 To stop playback, press **■** button.

Selecting a desired track/passage

To select a desired track

Press **◀◀** or **▶▶** button (**◀◀** or **▶▶ SEARCH/SKIP/TUNING** button on the remote control) repeatedly until the desired track appears on the display.

- If playback is stopped, press **▶/||** button (**▶/|| PLAY/PAUSE** button on the remote control) to start playback.
- The digit buttons (0~9) on the remote control can also be used to select a track.

Press the digit buttons as shown below:

To select track 2 : **2** and **ENTER**

To select track 23 : **2**, **3** and **ENTER**

To select track 120 (MP3-CD only) : **1**, **2** and **0**

To search for a particular passage during playback

Press and hold **◀◀** or **▶▶** button (**◀◀** or **▶▶ SEARCH/SKIP/TUNING** button on the remote control) and released it when the desired passage is located for CD.

Selecting a desired album/file (For MP3-CD only)

To select a desired album

Press **p.call/album +** or **-** button on the unit until the desired album number appears on the display.

- "Axxx xxx" will appear on the display. "Axxx" indicates album number and "xxx" indicates the file number.

To select a desired file

Press **◀◀** or **▶▶** button (**◀◀** or **▶▶ SEARCH/SKIP/TUNING** button on the remote control) repeatedly until the desired file from the current album appears on the display.

- "Axxx xxx" will appear on the display. "Axxx" indicates album number and "xxx" indicates the file number.
- The digit buttons (0~9) on the remote control can also be used to select a file.

continued to next page

To search a desired file by file name

- 1 Press **FILE SEARCH** button on the remote control.
- 2 Press the digit buttons to enter the first character of the file name you wish to search and press **ENTER** button.
Repeat this procedure to enter the rest of the file name.
- 3 Press **FILE SEARCH** button on the remote control.

The icon "FILE SEARCH" will appear on the display.

If the unit finds an appropriate file, the file name will be scrolled on the display.

If there is no appropriate file, "NO FILE" will be appeared.

- 4 Press **▶/||** button (**▶/|| PLAY/PAUSE** button on the remote control) to start playback.

Programming tracks

Programming tracks of a disc is possible when playback is stopped. Up to 60 tracks can be stored in the memory in any order.

- 1 In stop mode, press **program** button on the unit (**PROGRAM** button on the remote control) to enter program setting.

The icon "PROGRAM" and "-- P-01" will appear on the display. "--" indicates track number of the CD and "P-01" indicates program number.

- 2 Press **◀◀** or **▶▶** button (**◀◀** or **▶▶ SEARCH/SKIP/TUNING** button on the remote control) to select the desired track.

The digit buttons (0~9) on the remote control can also be used to select tracks.

The icon "PROGRAM" and program number will start flashing.

- 3 Press **program** button on the unit (**PROGRAM** button on the remote control) to store the selected track.

The track number returns to "--" and the next program number will appear on the display.

- 4 Repeat steps 2 to 3 to select and store other desired tracks in this way.

The icon "PROGRAM" will appear on the display and "FULL" will start flashing if you attempt to program more than 60 tracks.

Press **program** button on the unit (**PROGRAM** button on the remote control) in stop mode to review the program sequence.

- 5 Press **▶/||** button (**▶/|| PLAY/PAUSE** button on the remote control) to play the programmed tracks.

If you press **repeat** button on the unit (**REPEAT** button on the remote control) during programmed playback, the current track or all programmed tracks will be played repeatedly. The icon "REPEAT" or "REPEAT ALL" and the icon "PROGRAM" will appear on the display.

- 6 Press **■** button once to stop program playback or twice to clear the program.

The icon "PROGRAM" will disappear from the display.

Programming files (For MP3-CD only)

Programming files of a disc is possible when playback is stopped. Up to 60 files can be stored in the memory in any order.

- 1 In stop mode, press **program** button on the unit (**PROGRAM** button on the remote control) to enter program setting.

The icon "PROGRAM" and "--- P-01" will appear on the display. "---" indicates file number of the MP3-CD and "P-01" indicates program number.

- 2** Press **p.call/album +** or **-** button to select the desired album and press **⏮** or **⏭** button (**⏮** or **⏭** **SEARCH/SKIP/TUNING** button on the remote control) to select the desired file.

The digit buttons (0~9) on the remote control can also be used to select files.

The icon "PROGRAM" and program number will start flashing.

- 3** Press **program** button on the unit (**PROGRAM** button on the remote control) to store the selected file.

The file number returns to "----" and the next program number will appear on the display.

- 4** Repeat steps **2** to **3** to select and store other desired files in this way.

The icon "PROGRAM" will appear on the display and "FULL" will start flashing if you attempt to program more than 60 files.

Press **program** button on the unit (**PROGRAM** button on the remote control) in stop mode to review the program sequence.

- 5** Press **▶/||** button (**▶/|| PLAY/PAUSE** button on the remote control) to play the programmed files.

If you press **repeat** button on the unit (**REPEAT** button on the remote control) during programmed playback, the current file or all programmed files will be played repeatedly. The icon "REPEAT" or "REPEAT ALL" and the icon "PROGRAM" will appear on the display.

- 6** Press **■** button once to stop program playback or twice to clear the program.

The icon "PROGRAM" will disappear from the display.

Notes:

- The program is automatically cleared as soon as the CD door is opened.
- The function of program setting is disabling in PLAY/PAUSE mode.

Random

You can play all the tracks in random order.

- 1** During playing, pause or stop mode, press **RANDOM** button on the remote control to enable random play mode.

The icon "RANDOM" will appear on the display.

- 2** To exit random mode, press **RANDOM** button again. The icon "RANDOM" will disappear from the display.

Note:

If the program function enabled, and the repeat function is set on, will disable the random play mode.

Repeat

You can play the current track or the whole disc repeatedly.

To repeat all the tracks/files

Press **repeat** button on the unit (**REPEAT** button on the remote control) once in play or pause mode. The icon "REPEAT ALL" will appear on the display.

- All tracks/files will be repeated continuously.
- To cancel repeat play, repress **repeat** button on the unit (**REPEAT** button on the remote control) twice for a normal CD and 3 times for a MP3-CD .

To repeat a single track/file

Press **repeat** button on the unit (**REPEAT** button on the remote control) twice for a normal CD and 3 times for a MP3-CD in play or pause mode. The icon "REPEAT" will appear on the display.

- To cancel repeat play, repress **repeat** button on the unit (**REPEAT** button on the remote control) once.

Using the CD/MP3-CD

To repeat one album (For MP3-CD only)

Press **repeat** button (**REPEAT** button on the remote control) twice in play or pause mode.

The icon "REPEAT ALB." will appear on the display.

- To cancel repeat play, repress **repeat** button on the unit (**REPEAT** button on the remote control) twice.

Note:

In program mode, you can only select repeat one or repeat all function.

Intro scan

This function let you listen to the first 10 seconds of each track throughout the disc.

Press **INTRO** button on the remote control to start scanning, and the icon "INTRO" will appear on the display.

To stop the intro scan

Press **INTRO** button on the remote control again. The unit enters normal play mode and starts playing from where you stop the scanning.

Using the RDS/DISPLAY button

Pressing **RDS/display** button on the unit (**RDS/DISPLAY** on the remote control) shows various display information of the disc, such as time information of the current track or a whole disc, program number during program play, file and artist name during MP3 mode, and etc.

Using the radio

Tuning in radio stations

1 Press **TUNER/band** button (**TUNER/BAND** button on the remote control) to select TUNER mode.

The current radio frequency will be displayed.

2 Press **TUNER/band** button (**TUNER/BAND** button on the remote control) to select the desired waveband: FM or AM.

3 Press and hold **◀◀** or **▶▶** button (**◀◀** or **▶▶** **SEARCH/SKIP/TUNING** button on the remote control).

Repeat this procedure until the desired station is reached.

To tune to a weak station briefly press **◀◀** or **▶▶** button (**◀◀** or **▶▶** **SEARCH/SKIP/TUNING** button on the remote control) repeatedly until the display shows the desired frequency or when the best reception has been obtained.

Storing preset

You can store up to 20 for FM and 20 for AM radio stations in the memory. When a preset radio stations selected. The preset number appears on the display.

1 Press **TUNER/band** button (**TUNER/BAND** button on the remote control) to select TUNER mode.

2 Press **TUNER/band** button (**TUNER/BAND** button on the remote control) to select the desired waveband: FM or AM.

3 Press **◀◀** or **▶▶** button (**◀◀** or **▶▶** **SEARCH/SKIP/TUNING** button on the remote control) to tune to the desired frequency.

4 Press **program** button (**PROGRAM** button on the remote control) so that "--" will start flashing.

5 If you wish to store the radio station to another preset number, **p.call/album +** button (**P. CALL +** button on the remote control) or **p.call/album -** button (**P. CALL -** button on the remote control) to select the desired preset number.

- 5** Press **program** button (**PROGRAM** button on the remote control) again to store the radio station.
Repeat steps **3** to **5** to store other preset radio stations.

Note:

During program, if no button is pressed within 20 seconds, the system will exit program mode automatically.

Tuning to a preset radio station

Press **p.call/album +** button (**P. CALL +** button on the remote control) or **p.call/album -** button (**P. CALL -** button on the remote control) or digit buttons (0~9) on the remote control to select the desired preset number.

- The preset number and radio frequency will appear on the display.

STEREO/MONO

Press the **STEREO/MONO** button on the remote control to select mono or stereo mode.

- When stereo mode is selected, the icon "STEREO" will appear on the display (if current station is FM stereo).

Note:

You are able to select stereo or mono mode in FM band only.

Using RDS (Radio Data System)

RDS is a system that transmits useful information (in the form of digital data) for FM broadcasts along with the broadcast signal. Tuners and receivers designed for RDS reception can extract the information from the broadcast signal for use with various functions, such as automatic display of the station name.

RDS functions:

PTY (Program Type Identification) Search
Automatically tunes to a station that is currently broadcasting the specified program type (genre).

PS (Program Service Name) Display:

Automatically displays the station name transmitted by the RDS station.

Radio Text function:

Displays the radio text data transmitted by some RDS stations when you press **RDS/display** button on the unit (**RDS/DISPLAY** button on the remote control). There is "NO TEXT" display if no text data is transmitted.

- The icon "R-D-S" appears on the display when an RDS broadcast (signal) is received.

Note:

Some functions and function names may differ in certain countries and areas.

Using the RDS/DISPLAY button

While receiving a RDS station, pressing **RDS/display** button on the unit (**RDS/DISPLAY** button on the remote control) changes the contents of the display.

Every time the button is pressed, the display changes in a following order :

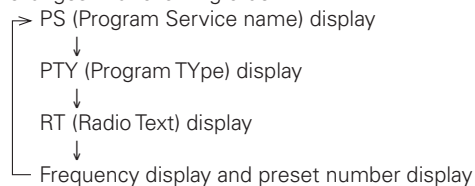

Tuning by Program Type (PTY search)

This function lets you set the tuner to automatically search for stations which are currently broadcasting the type of program (genre) you want to listen to.

- Press **TUNER/band** button (**TUNER/BAND** button on the remote control) to TUNER mode.
- Press **TUNER/band** button (**TUNER/BAND** button on the remote control) to select FM.
- Press **PTY** button on the remote control.

If the current station is with RDS, the program type of the station is displayed.

continued to next page

Using the radio

- Press **PTY** button on the remote control to select your desired program type.

Program type table

Program Type Name	Display
News	NEWS
Current Affairs	AFFAIRS
Information	INFO
Sport	SPORT
Education	EDUCATE
Drama	DRAMA
Culture	CULTURE
Science	SCIENCE
Varied Speech	VARIED
Pop Music	POP M
Rock Music	ROCK M
Easy Music	EASY M
Light Classical Music	LIGHT M
Serious Classical Music	CLASSICS
Other Music	OTHER M
Weather	WEATHER
Finance	FINANCE
Children's Program	CHILDREN
Social Affairs	SOCIAL
Religion	RELIGION
Phone In	PHONE IN
Travel	TRAVEL
Leisure	LEISURE
Jazz Music	JAZZ
Country Music	COUNTRY
National Music	NATION M
Oldies Music	OLDIES
Folk Music	FOLK M
Documentary	DOCUMENT

- Press **I◀◀** or **▶▶I** button (**I◀◀** or **▶▶I** **SEARCH/SKIP/TUNING** button on the remote control) to start searching.

Notes:

- Under certain receiving conditions, it may take more than 1 minute to complete the search.
- If the desired program type cannot be found, "NO MATCH" is displayed, then after several seconds the display returns to the original display.

Using the cassette

Playing a cassette tape

- Press **TAPE** button to TAPE.
- Press the area marked **push open** to open the cassette compartment door.
- Insert cassette tape into the compartment with the open edge facing down.
- Close the door securely.
- Press **I◀◀** or **▶▶I** button (**I◀◀** or **▶▶I** **SEARCH/SKIP/TUNING** button on the remote control) to move tape to the desired starting point.
- Press **▶/||** button (**▶/||** **PLAY/PAUSE** button on the remote control) to begin playing the tape.
- Press **volume** buttons (**VOLUME UP** or **DOWN** button on the remote control) and press **EQ/X-bass** button (**EQ/X-BASS** on the remote control) to desired listening level.

Recording on a cassette tape

You can record from the radio or the CD player. For best recording, use a normal bias tape (Type 1 only).

Recording from the radio

- Insert a cassette tape into the tape compartment and close door.
- Press **TUNER/band** button (**TUNER/BAND** button on the remote control) to TUNER and select a radio station.
- Press **rec** button (**REC/DEMO** button on the remote control) to set the unit into recording standby mode.

The icon "REC." appears on the display.

- Press **▶/||** button (**▶/||** **PLAY/PAUSE** button on the remote control) to begin recording.
- Press **■** button to end recording.
- To turn off radio, press **TAPE** button to TAPE.

Radio recording tip

- To temporarily pause the recording, press **rec** button (**REC/DEMO** button on the remote control). Press ►/|| button (►/|| **PLAY/PAUSE** button on the remote control) to resume recording.

Recording from a CD/MP3-CD

- 1 Insert a blank cassette tape into the tape deck.
- 2 Press **CD** button to CD.
- 3 Insert a CD/MP3-CD and make sure that the unit is in stop mode.
- 4 Press ◀◀ or ▶▶ button (◀◀ or ▶▶ **SEARCH/SKIP/TUNING** button on the remote control) to select the first track you want to record.
- 5 Press **rec** button (**REC/DEMO** button on the remote control) to set the unit into recording standby mode.

The icon "REC." appears on the display.

- 6 Press ►/|| button (►/|| **PLAY/PAUSE** button on the remote control) to begin recording.

Press **rec** button (**REC/DEMO** button on the remote control) to interrupt recording. Press ►/|| button (►/|| **PLAY/PAUSE** button on the remote control) to resume recording.

- 7 Press ■ button to end recording.

Notes:

- To ensure good system performance, wait until the unit completely reads the disc before recording.
- During recording, it is not possible to listen to another source.

Program recording from a CD/MP3-CD

Desired CD tracks/MP3 files can be programmed in the desired sequence and recorded onto a tape.

- 1 Insert a blank cassette tape into the tape deck.
- 2 Press **CD** button to CD.
- 3 Insert a CD/MP3-CD and make sure that the unit is in stop mode.

- 4 Program the desired sequence of CD tracks/MP3 files.

See page 10 for programming procedure.

- 5 Press **rec** button (**REC/DEMO** button on the remote control) to set the unit into recording standby mode.

The icon "REC." appears on the display.

- 6 Press ►/|| button (►/|| **PLAY/PAUSE** button on the remote control) to begin recording.

- 7 Press ■ button to end recording.

Clock/timer operation

View clock

The clock (if it is set) will be shown in standby mode.

To view the clock in any source mode (CD, TUNER or TAPE), press **timer set** button (**TIMER SET** button on the remote control). The clock will be displayed.

If the clock has not been set, "0:00" will start flashing.

Clock setting

Before carrying out the clock setting, ensure that the system is in standby mode.

- 1 Press **program** button (**PROGRAM** button on the remote control) to enter the hour setting mode.

The hour indication will start flashing.

- 2 Press **I◀◀** or **▶▶I** button (**I◀◀** or **▶▶I** **SEARCH/SKIP/TUNING** button on the remote control) to set the hours.

- 3 Press **program** button (**PROGRAM** button on the remote control) to enter the minute setting mode.

The minute indication will start flashing.

- 4 Press **I◀◀** or **▶▶I** button (**I◀◀** or **▶▶I** **SEARCH/SKIP/TUNING** button on the remote control) to set the minutes.

- 5 Press **program** button (**PROGRAM** button on the remote control) to store the setting.

The clock will start working.

To exit without storing the setting, turn on the system.

Notes:

- The clock setting will be erased when the power cord is disconnected or a power failure occurred.
- The clock can be set in either 12 or 24-hour mode. To change the mode: When the system is in standby mode, press **TUNER/band** button while pressing **▶/II PLAY/PAUSE** button.

Timer setting

The system can switch on to CD, TUNER or TAPE mode automatically at a preset time, serving as an alarm to wake you up.

The timer recording of radio programs onto a cassette tape is also possible.

Important!

Before setting the timer, ensure that the clock is set correctly.

When setting the timer (playback or recording) for TUNER, be sure to select the station you wish to tune in beforehand.

- 1 Turn the system on.

- 2 Press **timer set** button (**TIMER SET** button on the remote control) twice to enter timer setting mode.

The icon "TIMER ON" will start flashing on the display.

- 3 Press **program** button (**PROGRAM** button on the remote control).

The hour indication will start flashing.

- 4 Set the time to start playback. Press **I◀◀** or **▶▶I** button (**I◀◀** or **▶▶I** **SEARCH/SKIP/TUNING** button on the remote control) to set timer start hours and press **program** button (**PROGRAM** button on the remote control) to store the setting. Repeat the same procedure to set the minutes.

- 5 Press **timer set** button (**TIMER SET** button on the remote control).

The icon "TIMER OFF" will start flashing.

- 6 Repeat the step 3 and 4 to set the time to stop the timer (off time).

- 7 Press **timer set** button (**TIMER SET** button on the remote control).

The icon "TIMER" will flash and the source display will appear.

8 Press **program** button (**PROGRAM** button on the remote control).

9 Press **SEARCH/SKIP/TUNING** button (**SEARCH/SKIP/TUNING** button on the remote control) to select the desired source and press **program** button (**PROGRAM** button on the remote control) to store the setting.

The source switches as follows :
 "CD" → "TUNER" → "TAPE" → "REC TU"
 (recording tuner)

10 Press **timer set** button (**TIMER SET** button on the remote control).

The icon "TIMER" will flash and the volume display will appear.

11 Press **program** button (**PROGRAM** button on the remote control).

12 Press **SEARCH/SKIP/TUNING** button (**SEARCH/SKIP/TUNING** button on the remote control) to set volume level and press **program** button (**PROGRAM** button on the remote control) to store the setting.

13 Press **timer set** button (**TIMER SET** button on the remote control).

14 Press **timer on/off** button (**TIMER ON/OFF** button on the remote control) to activate timer mode.

The icon "TIMER" changes from flashing to steadily lit.
 The timer is now set.

15 Switch the system to standby mode.

When reached the preset timer, the selected source will play or switch to standby mode if the timer has been activated.

To activate / deactivate the timer

Press **timer on/off** button (**TIMER ON/OFF** button on the remote control). If activated, the icon "TIMER" will appear on the display.

Notes:

- The timer off will not be activated if the starting and stopping time are the same.
- If the selected source ("CD", "TAPE" or "REC TU") is not available when preset timer is reached, TUNER will be selected automatically.
- During timer setting, if no button is press within 7 seconds, the system will exit timer setting mode automatically.

Sleep timer setting

If the sleep timer is activated, the system will switch to standby mode after the selected time has expired.

Each press of the **SLEEP** button on the remote control decreases the timer period by 10 minutes. The sleep timer can be set up to 90 minutes.

The display will change to sleep time display and change as follows:

90 min - 80 min - 70 min - 60 min - 50 min - 40 min - 30 min - 20 min - 10 min - OFF - 90 min - 80 min...

The icon "SLEEP" will appear on the display.

While sleep mode is in active:

To deactivate the sleep timer

Press **SLEEP** button on the remote control or press the **power** button to turn the power off.

Note:

If timer off and the sleep off are all activated, the system will switch to standby mode by the earlier timer set.

General information

Maintenance

Cleaning the cabinet

- Use a soft cloth slightly moistened with a mild detergent solution. Do not use a solution containing alcohol, spirits, ammonia or abrasive.

Cleaning discs

- When a disc becomes dirty, clean it with a cleaning cloth, wipe the disc from the center out. Do not wipe in circular motion.
- Do not use solvents such as benzene, thinner commercially available cleaners, or antistatic spray intended for analogue records.

Cleaning the heads and tape path

- To ensure good recording and playback quality, clean the heads, the capstans and pressure rollers after every 50 hours of tape operation.
- Use a cotton swab slightly moistened with cleaning fluid.
- You also can clean the heads by playing a cleaning tape once.

Caution on condensation

Condensation (of dew) may occur inside the unit when there is a great difference in temperature between this unit and the outside. This unit may not function properly if condensation occurs. In this case, leave the unit for a few hours and restart the operation after the condensation has dried up.

Be specially cautious against condensation in the following circumstances:

When this unit is carried from one place to another across a large difference in temperature, when the humidity in the room where this unit is installed increases, etc.

Warning notice

In most cases it is an infringement of copyright to make copies of tapes or discs without the permission of the copyright owners. Anyone wishing to copy commercially available tapes or disc should contact the mechanical copyright protection society limited or the performing rights society limited.

In case of difficulty

Resetting the Microcomputer

The microcomputer may malfunction (unit cannot be operated, or shows an erroneous display) if the power cord is unplugged while the power is ON, or due to some other external factor. If this happens, execute the following procedure to reset the microcomputer and return the unit to its normal operating condition.

Plug in the AC power cord to the wall outlet, and within 5 seconds, press and hold down the ■ button and press CD button.

- Please note that resetting the microcomputer will clear the contents of the memory and return the unit to the state it was in when it left the factory.

Check that following guide for problem resolution.

General

No sound.

- ➔ Plug in AC cord securely.
- ➔ Set the VOLUME control to proper sound level.
- ➔ Make sure the source is set to the source you wish to operate.
- ➔ Pull out the headphones plug from the headphones jack.

The left and right sound outputs are reverse.

- ➔ Check the speaker connections and location.

The system displays features automatically.

- ➔ Switch off the demo operation.

CD player operation

"NO DISC" is displayed.

- ➔ Insert a disc correctly (label side up).
- ➔ Clean the disc.
- ➔ Use a new or readable disc.
- ➔ Wait until the moisture condensation at the lens has cleared.
- ➔ Plug in AC cord securely.

Radio reception

Noise in radio.

- ➔ Tune to a correct frequency.
- ➔ Adjust the direction of the FM antenna.
- ➔ AM antenna is built in; rotate the system to face a new direction.
- ➔ Increase the distance between the system and TV or VCR.

Cassette deck operation

Cannot record.

- ➔ Replace the tape or cover tabs with adhesive tape.
- ➔ Clean the head.
- ➔ Use only NORMAL (IEC I) tape.
- ➔ Do not use a cassette with more than 90-minute recording time, for the tape used in such a cassette is very thin and tends to cause problem such as entanglement around the pinch roller or could be easily cut off.

Timer / Clock

The timer is not working.

- ➔ Set the correct clock.
- ➔ Press the TIMER ON/OFF button to switch on the timer.
- ➔ Switch the system to standby mode.

The timer/clock is erased.

- ➔ Power has been interrupted or power cord has been disconnected. Set it again.

Remote control

Does not function properly.

- ➔ Replace the batteries.
- ➔ Remove the obstacles.
- ➔ Move closer to the system when using the remote control and make sure that you are pointing at unit's remote sensor.

Specifications

Main unit

Amplifier section

Rate output power 5 W + 5 W (1 kHz, 10% T.H.D., at 4 Ω)
X-BASS +7 dB (60 Hz)

Tuner section

FM tuner section
Tuning frequency range 87.5 MHz ~ 108 MHz
AM tuner section
Tuning frequency range 531 kHz ~ 1,602 kHz

CD player section

Laser Semiconductor laser
Over sampling 8 fs (352.8 kHz)
Laser wave length 760 ~ 800 nm
Laser power class Class 1 (IEC)
D/A conversion 1 Bit

Cassette deck section

Track 4-track, 2-channel stereo

General

Power consumption 25 W
Dimensions W : 145mm (5-11/16")
..... H : 210 mm (8-1/4")
..... D : 227 mm (8-15/16")
Weight (net) 2.8 kg (6.2 lb)

Speakers

Enclosure Bass-reflex type
Speaker configuration
Woofer 100 mm, cone type
Impedance 4 Ω
Maximum input level 5 W
Dimensions W : 130 mm (5-1/8")
..... H : 208 mm (8-3/16")
..... D : 161 mm (6-5/16")
Weight (net) 1.2 kg (2.7 lb) (1 piece)

Notes:

- KENWOOD follows a policy of continuous advancements in development. For this reason specifications may be changed without notice.
- Sufficient performance may not be exhibited at extremely cold locations (where water freezes).

KENWOOD

For your records

Record the serial number, found on the back of the unit, in the spaces designated on the warranty card, and in the space provided below. Refer to the model and serial numbers whenever you call upon your dealer for information or service on this product.

Model _____ Serial Number _____