

**2,000,000 POWER SERIES™  
SPOTLIGHT**  
**CORDED · CORDLESS · RECHARGEABLE**

**IF YOU SHOULD EXPERIENCE A PROBLEM WITH YOUR  
PURCHASE CALL TOLL FREE 866-584-5504. IN MOST  
CASES A SERVICE REPRESENTATIVE CAN RESOLVE  
YOUR PROBLEM OVER THE PHONE.**

**KEY INFORMATION YOU SHOULD KNOW:**

- **REPLACEABLE 12V BATTERY**
- **PORTABLE, CORDLESS, RECHARGEABLE**
- **ULTRA BRIGHT AREA LIGHT**
- **HIGH INTENSITY QUARTZ BEAM**
- **BUILT-IN UTILITY WORK STAND**



**BEFORE RETURNING THIS PRODUCT FOR ANY REASON,  
PLEASE CALL TOLL FREE 866-584-5504**

**USER'S MANUAL &  
WARRANTY INFORMATION**

THIS MANUAL CONTAINS IMPORTANT INFORMATION REGARDING SAFETY,  
OPERATION, MAINTENANCE AND STORAGE OF THIS PRODUCT. READ  
CAREFULLY BEFORE USE, AND RETAIN FOR FUTURE REFERENCE.

**4140 S.W. 30th Ave., Ft. Lauderdale, FL 33312 U.S.  
Toll Free: 866-584-5504**

NOTE: This unit is shipped in a partially charged state. Initial charge time is approximately 20-25 hours, 18 hours thereafter.

## **IMPORTANT SAFETY INSTRUCTIONS**

**WARNINGS:** Contains non-spillable, sealed, lead-acid battery. Battery must be recycled or disposed of properly. For battery disposal information call toll-free 877-288-7722.

**DO NOT** dispose of batteries in fire, as this may result in an explosion.  
**DO NOT** open battery or short circuit, as this may cause the battery to leak or get hot, causing personal injury.

Please read Instruction Manual completely for all safety and warning instructions.

**WARNINGS: USE ONLY WITH CHARGERS PROVIDED WITH UNIT.**

### **DURING AC RECHARGE OR DC RECHARGE:**

- a) Never turn on while AC charging.
- b) After recharge – disconnect cord and wait 5 minutes before use.

### **DO NOT OVERCHARGE:**

- a) AC recharge 18 hours.
- b) DC recharge 5 hours maximum.

1. Do not substitute power cords or adapters. Only recharge with supplied AC and DC recharge adapters. Recharge adapters for this unit supply 12 volts DC. Do not recharge with adapters other than the ones supplied with this unit.
2. Do not submerge in water. This unit is not waterproof - it is weather resistant.
3. Do not overcharge battery.
4. Do not operate spotlight while AC recharging. This will prevent battery recharge and overheat the charging adapter.
5. Lens gets very hot when spotlight is operating. Do not touch lens - keep children away from spotlight. This is not a toy!
6. Keep combustibles away from spotlight lens - extreme heat can cause fires.
7. Keep sharp objects away from glass lens - it is breakable.
8. Do not drop or throw spotlight, it contains glass and a sealed lead acid battery.
9. Dispose of unusable batteries in a responsible manner (see battery disposal section).
10. Make sure cords are protected from damage during recharge.
11. Do not crush, cut, pull or expose recharge adapter cords to extreme heat.
12. Keep recharge cords away from sharp edges. Position recharge cords so they do not become entangled or become a safety hazard.

## **1. INTRODUCTION**

Congratulations on purchasing the Vector 2,000,000 Power Series Spotlight, an advanced design combination spotlight and area light. It instantly converts use from a powerful spotlight to a soft, long-lasting area light. It uses a powerful, proven-technology, rechargeable, non-spillable, sealed, lead-acid battery that allows for years of dependable use, recharge after recharge. The spotlight was designed from the ground up to be the most versatile and practical light for travel, camping, picnicking, tailgate parties and boating. This spotlight gives you the kind of light you need, when and where you need it.

Two recharge adapters are supplied with the spotlight. It is rechargeable from either a 12 volt DC accessory outlet, or from any 120 volt 60 Hz AC outlet. This permits recharge flexibility for use around home, business or in the field. 12 volt DC power is available from most vehicles, boats, jump starters and portable battery packs. Vector has a variety of portable power products that would make ideal companions.

## **2. FEATURES**

- High-intensity, ultra-white, 100-watt halogen bulb
- Corded/cordless, powerful Quartz Halogen Spotlight for use whenever and wherever you need light
- Provides up to 20 minutes of continuous light (when fully charged)
- Includes built-in area light located in grip
- Corded - plug into any 12 volt DC accessory outlet for extended use and charging
- Built-in utility work stand for garage, work bench and roadside repairs
- Take anywhere - use cordless or plug into 12 volt DC outlet
- Replace 12 volt, 3 amp, sealed, non spillable battery
- Powerful, prefocused, replaceable quartz halogen bulb in spotlight
- Recharge from home or vehicle (AC and DC adapters included)

## **3. LOCATION DIAGRAM**



**FIGURE 1**

## **4. OPERATION**

A two-position switch (spotlight on/off) controls the operation of the main beam. The area light is controlled by a two-position button (area light on/off) is located on the side of the unit. The spotlight can be continuously lit for up to 20 minutes on a full battery charge. The area light can be lit for up to 12 hours on a full battery charge.

Figure 1 shows locations of the AC and DC charging ports, spotlight ON/OFF trigger, area light ON/OFF button, LED charging indicators, work stand/carry handle and trigger lock switch.

## **5. RECHARGING**

AC and DC recharge requires use of these supplied recharge adapters. Do not charge spotlight using any other adapters (see Figures 2 and 3).

**SAVE THESE INSTRUCTIONS**

## 5.1 AC RECHARGE

### During Recharge:

- Never turn on while charging.
- Make sure the AC power source is 120 volts, 60 Hz.
- After recharge – disconnect cord and wait 5 minutes before use.

## 5.2 CHARGING INDICATORS

Unit includes charging indicator LED's that display battery level of charge any time during operation or storage by simply turning ON the area light. LED's will light under the following conditions:

- Automatically during AC recharge.
- During area light operation.

During AC recharge green LED will blink when charging is complete. Wait 5 minutes after disconnecting charger to operate unit.

**FIGURE 2 - AC CHARGER**



**WARNING:** Use the supplied AC recharge adapter; do not substitute. AC recharging requires the use of the included AC charger/adapter that supplies 12 volts DC.

- Connect the AC charger to an AC power source.
- Plug the adapter's barrel connector into the AC recharge port located near the handle.
- Recharge for 18 hours maximum.
- After recharge, disconnect the barrel connector from the recharge port and store the adapter.

## 5.3 DC RECHARGE

- Maximum charge - 5 hours
- After recharge – disconnect cord and wait 5 minutes before use.

**FIGURE 3 - DC CHARGER**



Make sure the DC source (jump starter, battery pack, vehicle accessory socket, etc) is 12 volt DC. The DC source should be able to supply at least 10 amps at 12 volt DC.

**WARNING:** Use the supplied DC recharge adapter, do not substitute.

DC recharge requires the use of the supplied DC recharge adapter.

- Connect the DC recharge adapter's DC plug to a 12 volt DC source.
- Plug the adapter's connector into the recharge port located on the back of the unit.
- Recharge for 5 hours maximum.
- After recharge, disconnect the barrel connector from the recharge port and store the adapter.

## 6. PERIODIC MAINTENANCE

All batteries lose charge over time, especially when they are warm. AC recharge is recommended every two months, when not in frequent use. Use the AC recharger and charge for the recommended time. If the unit gets dirty gently clean the outer surface of the spotlight unit with a soft cloth moistened with a mild solution of water and detergent. Periodically inspect the condition of recharge adapters, connectors, and wires. Replace any components that may have become worn or broken.

## 7. PARTS REPLACEMENT

Three parts are replaceable by users. The quartz halogen bulb and sealed lead acid battery are proprietary and are available through Vector Products, Inc.. A substitute 12 volt H3 100 watt bulb may be used instead of a Vector bulb. These can also be purchased from popular automotive parts suppliers nationwide. The DC charging adapter fuse is replaceable. Contact Vector Products, Inc.'s Technical Support Department for replacement parts and any additional information that you may need. They may be reached toll free 866-584-5504.

### 7.1 DC PLUG FUSE REPLACEMENT

The fuse in the DC plug protects the charging circuit of the DC recharge adapter. If there is no slight warming of the DC plug during recharge, you should suspect that 12 volts DC is not powering the plug or the fuse is opened.

To replace the fuse:

- Unscrew the end cap of the DC plug (counterclockwise).
- Remove spring center contact and fuse.
- Check fuse with a continuity checker.
- If blown, locate replacement fuse with same type and rating.
- Replace the fuse, spring, contact and end cap.
- Screw end cap clockwise until it is finger tight-**do not over-tighten**.
- Check for proper operation of DC charging adapter.

### 7.2 SPOTLIGHT BULB REPLACEMENT

To replace the H3 type 12 volt bulb, you will need a small Phillips-head type screwdriver and a replacement bulb.

**FIGURE 4 - LENS ASSEMBLY**

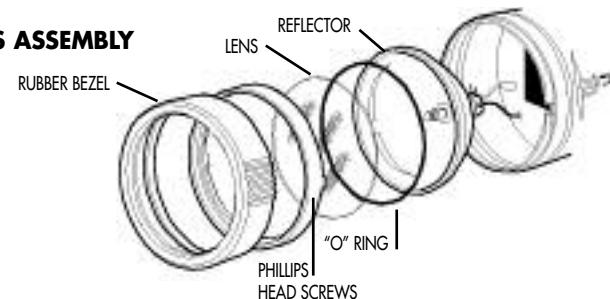

**FIGURE 5 - BULB ASSEMBLY**

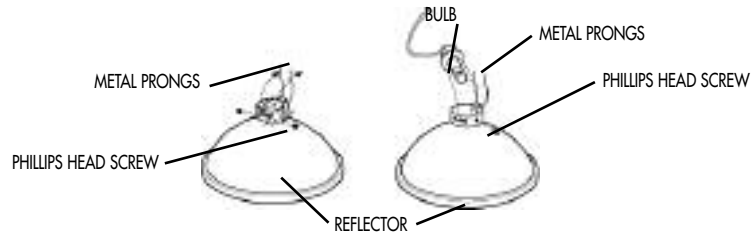

Bulb life can be shortened by installing a bulb with dirt or fingerprints on it. During installation, avoid touching the glass part of the bulb (see Figure 4 and 5 for details).

1. Disconnect the unit from charging adapter.
2. Pull off the rubber bezel to reveal two small Phillips-head screws.
3. Using the screwdriver, remove (counterclockwise) the two screws. Set them aside.
4. Lift off the retaining ring, glass, and rubber ring and set them aside.
5. Carefully remove the reflector and bulb assembly.
6. Disconnect the bulb wire from the red power wire and set the burned out bulb aside.
7. Unsnap the hairpin retaining wires from the reflector's flange.
8. Using the screwdriver, loosen the retaining screw to remove the bulb from the reflector (no need to completely remove this screw).
9. Lift out the bulb and the attached wire.
10. Insert the replacement bulb into the reflector's flange.
11. Put back and secure the hairpin retaining wires.
12. Connect the bulb power wire to the red power wire.
13. Tighten the retaining screw on the flange.
14. Place the reflector in position in the body of the spotlight.
15. Replace the rubber "O" ring in the groove around the perimeter of the reflector.
16. Replace glass and retaining ring so that the screw holes are aligned.
17. Secure retaining ring with two screws.
18. Replace rubber bezel.
19. Operate switch to ensure proper operation of spotlight.

### 7.3 REPLACING THE BATTERY PACK

The sealed lead acid battery has a life of several years, if recharged promptly after each use. When a fully charged battery only provides about ten minutes or less of spotlight operation, it should be replaced with a new one. To replace the battery, you will need a narrow shaft Phillips-head screwdriver and a replacement battery. The battery pack can be replaced by doing the following:

1. Complete the bulb replacement steps through step 4, to remove the reflector assembly.
2. Remove all the Phillips-head screws (counterclockwise) that fasten the two halves of the housing body.
3. Separate the two body halves and carefully pop out the handle.

**WARNING:** DO NOT ALLOW BARE WIRES OR CONNECTORS TO CONTACT EACH OTHER; DANGEROUS SPARKING CAN OCCUR.

4. Note polarity of battery. Note which color wire is on which terminal.
5. Disconnect the wires from the battery and set the battery aside.
6. Connect the replacement battery, making sure the correct color wires are on the new battery terminals. Make sure the polarity of battery is correct.

**WARNING:** Incorrectly connected wires will damage the battery and recharge adapter, double check battery polarity before reassembly.

**CAUTION:** Incorrectly connected wires will allow the spotlight to operate normally, however, when recharge adapters are connected, there will be damage to the battery and recharge adapters. Double check battery polarity before reassembly!

7. Replace handle, in one half of the housing body. Make sure wires and connectors do not touch.
8. Place other half of housing body into position and replace screws (clockwise). Do not overtighten.
9. Follow steps 13 through 19 for bulb replacement to reassemble reflector, rubber "O" ring, glass, retaining ring and rubber bezel. Charge the new battery using AC recharge adapter for a minimum of 20-25 hours initially, then 18 hours thereafter.

### SAFE BATTERY DISPOSAL

Contains a maintenance-free, sealed, non-spillable, lead acid battery, which must be disposed of properly. Recycling is required, contact your local authority for information. Failure to comply with local, state and federal regulations can result in fines or imprisonment.

### BATTERY DISPOSAL WARNING

- Do not dispose of the battery in fire as this may result in an explosion
- Before disposing of the battery, protect exposed terminals with heavy-duty electrical tape to prevent shorting (shorting can result in injury or fire)
- Do not expose battery to fire or intense heat as it may explode
- For more information on recycling this battery, call toll-free 877-288-7722



### 8. SPECIFICATIONS

Spotlight Bulb ..... 12 volt, H3 series, 100 watt quartz halogen  
Battery ..... Maintenance free, sealed lead acid, 12 volt

## **1 YEAR LIMITED WARRANTY PROGRAM**

This limited warranty program is the only one that applies to this product, and it sets forth all the responsibilities of Vector Products, Inc., regarding this product. There is no other warranty, other than described herein.

This Vector Products, Inc. product is warranted, to the original purchaser only, to be free of defects in materials and workmanship for one year from the date of purchase without additional charge. The warranty does not extend to subsequent purchasers or users. Vector Products, Inc. will not be responsible for any amount of damage in excess of the retail purchase price of the product under any circumstances. Incidental and consequential damages are specifically excluded from coverage under this warranty.

This product is not intended for commercial use. This warranty does not apply to accessories or damage to units from misuse or incorrect installation. Misuse includes wiring or connecting to improper polarity power sources.

**RETURN/REPAIR POLICY:** Defective products, other than accessories, may be returned postage prepaid to Vector Products, Inc.. Any defective product, other than accessories, that is returned to Vector Products, Inc. within 30 days of the date of purchase will be replaced free of charge. If such a product is returned more than 30 days but less than one year from the purchase date, Vector Products, Inc. will repair the unit or, at its option, replace it free of charge.

If the unit is repaired new or reconditioned replacement parts may be used at Vector Products, Inc.'s option. A unit may be replaced with a new or reconditioned unit of the same or comparable design. The repaired or replaced unit will then be warranted under the terms of the remainder of the warranty period. The customer is responsible for the shipping charges on all returned items after 30 days. During the warranty period, Vector Products, Inc. will be responsible for the return shipping charges.

**LIMITATIONS:** This warranty does not cover accessories, bulbs, fuses and batteries, defects resulting from normal wear and tear (including chips, scratches, abrasions, discoloration or fading due to usage or exposure to sunlight), accidents, damage during shipping to our service facility, alterations, unauthorized use or repair, neglect, misuse, abuse, failure to follow instructions for care and maintenance, fire, flood and Acts of God.

If your problem is not covered by this warranty, call our Technical Support Department 954-584-4446 or toll free 866-584-5504 for general repair information and charges if applicable. You may also contact us through our website [www.vectormfg.com](http://www.vectormfg.com).

**STATE LAW RIGHTS:** This warranty gives you specific legal rights. Some states do not allow limitations on how long an implied warranty lasts or the exclusion or limitation of incidental or consequential damages, so the exclusions or limitations stated herein may not apply. This warranty gives the purchaser specific legal rights; other rights, which vary from state to state, may apply.

**TO REQUEST WARRANTY SERVICE FOR THIS PRODUCT:** Contact Vector Products, Inc. Technical Support by telephone, fax or mail. We suggest that you keep the original packaging in case you need to ship the unit. When returning a product, include your name, address, phone number, dated sales receipt (or copy) and a description of the reason for return and product serial number. After repairing or replacing the unit, we will make every effort to return it to you within four weeks.

**WARRANTY ACTIVATION:** Please complete Warranty Activation Card and mail to Vector Products, Inc.. Enter "VEC141" as Model and "2,000,000 Power Series" as Product Type. All Vector Products, Inc. products must be registered within 30 days of purchase to activate this warranty. Mail the completed registration card, along with a copy of the original sales receipt to:

**ATTN.: CUSTOMER SERVICE / VECTOR PRODUCTS, INC.  
4140 S.W. 30TH AVE., FT. LAUDERDALE, FL 33312 U.S.  
• TOLL FREE: 866-584-5504 • FAX: 954-584-5556.**

**YOU MAY ALSO CONTACT US AT OUR WEBSITE [WWW.VECTORMFG.COM](http://WWW.VECTORMFG.COM).**

**WARRANTY IS NON-TRANSFERABLE AND NON-REFUNDABLE.  
DS070406**