

Through Hole Couple Inductor

TDHCB Type

Features

- RoHS compliant.
- Low profile, SMD type.
- High current.
- Magnetic shielded.
- High energy storage and low DCR.
- Provided with embossed carrier tape packing.
- Ideal for power source circuits, DC-DC converter, DC-AC inverters inductor applications.
- In addition to the standard versions shown here, customized inductors are available to meet your exact requirements.

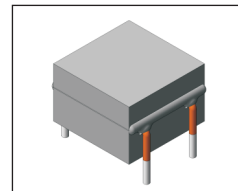

Mechanical Dimension :

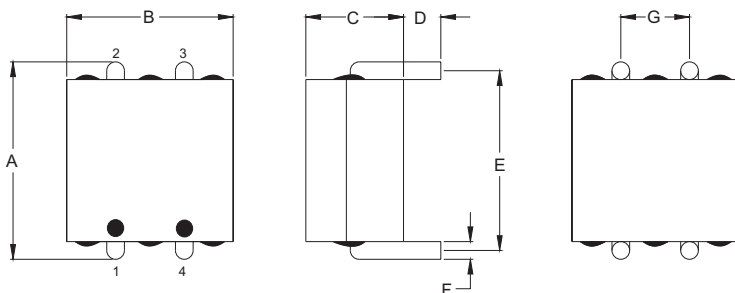

UNIT : mm

| SERIES | A | B | C | D | E | R | G |
|------------|-----------|-----------|----------|-----------|------------|-----|------|
| TDHCB1385B | 14.5 Max. | 13.5 Max. | 8.5 Max. | 3.5 ± 0.5 | 13.0 ± 0.5 | 1.0 | 4.80 |
| TDHCB1590B | 17.5 Max. | 14.0 Max. | 9.0 Max. | 2.5 ± 0.5 | 15.5 ± 0.5 | 1.0 | 5.05 |

Electrical Characteristics : At 25°C: 100KHz, 1V

| PART NO. | L ¹ (nH) | L @ Isat1 (nH) | 2 * Lk ² (nH) | DCR (mΩ) MAX | Isat ³ (A _{dc}) |
|----------------|------------------------|-------------------|-----------------------------|-----------------|---|
| TDHCB1385B-0R3 | 300±20% | 240±20% | 200±20% | 0.47±20% | 60 |
| TDHCB1590B-R45 | 450±20% | 360±20% | 300±20% | 0.54±20% | 55 |

1. L is the inductance of each phase (1-2 @ 4,3 open or 4-3 @ 1,2 open) @100KHz, 1V, 25°C.
2. 2*Lk is two times of leakage inductance (1-4 @ 2,3 short)
3. Isat1 is the DC current which cause the L drop to L @ Isat1.
4. Operating temperature : -40°C to 125°C (including self-temperature rise).



DELTA ELECTRONICS, INC.

(TAOYUAN PLANT CPBG) 252, SAN YING ROAD, KUEISAN INDUSTRIAL ZONE, TAOYUAN SHIEN, 333, TAIWAN, R.O.C.

TEL: 886-3-3591968; FAX: 886-3-3591991

<http://www.deltaww.com>