

ENERGIZER 223

Photo

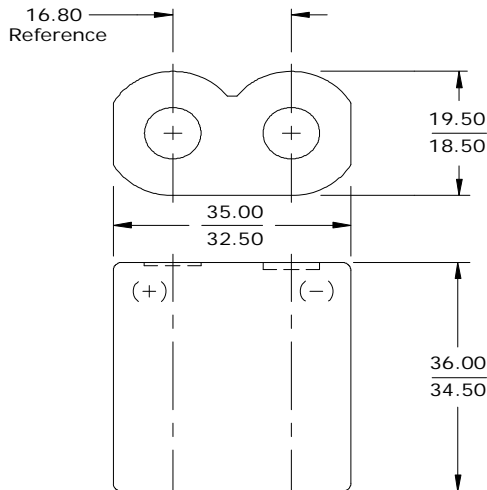

Industry Standard Dimensions (millimeters)



This battery contains a Positive Temperature Coefficient (PTC) safety device to limit current during short circuit conditions.

Specifications

Classification:	"Lithium Photo"
Chemical System:	Lithium / Manganese Dioxide (Li/MnO ₂)
Designation:	IEC-CR-P2
Nominal Voltage:	6.0 Volts
Storage Temp:	-40°C to 60°C
Operating Temp:	-40°C to 60°C
Typical Capacity:	1500 mAh (to 4.0 volts) (rated at 200 ohms at 21°C)
Typical Weight:	37 grams
Typical Volume:	24 cubic centimeters
Max Discharge:	1500 mA continuous (3500 mA pulse)
Max Rev Charge:	2 microampere
Typical Li Content:	1.15 grams
Shipping:	For complete details, please reference: Global (except US): Special Provision A45 of the International Air Transport Association Dangerous Goods Regulations

Typical Discharge Characteristics

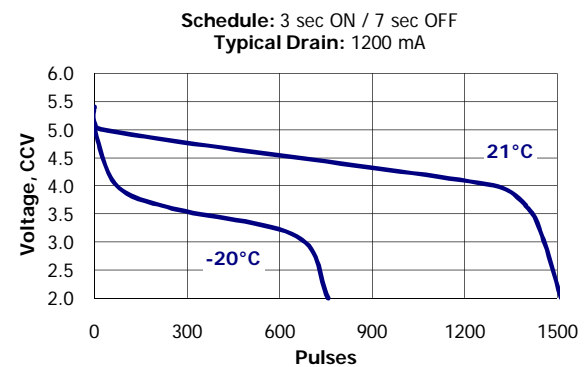
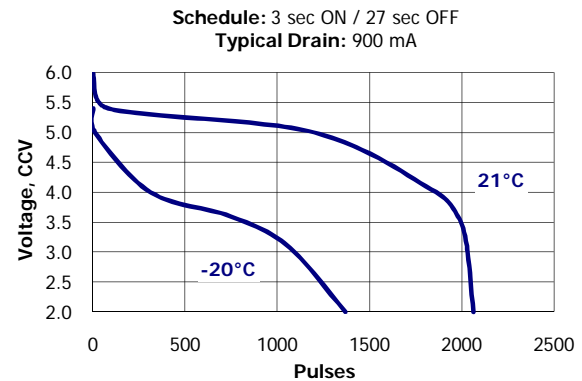

Simulated Application Tests

Typical Performance at 21°C

Schedule (time)	Drain (mA)	Load (ohms)	Cutoff Voltage		
			4.0V (hours)	3.1V (pulses)	2.0V (pulses)
Continuous	---	200	58	---	---
Continuous	1000	---	1.2	---	---
3 sec ON 7 sec OFF	1200	---	---	---	1500
3 sec ON 27 sec OFF	900	---	---	2000	---

Important Notice

This datasheet contains typical information specific to products manufactured at the time of its publication.
©Energizer Holdings, Inc. - Contents herein do not constitute a warranty.