

MINOLTA

# *VECTIS* 300

**E** INSTRUCTION MANUAL



Thank you for purchasing the Minolta Vectis 300. The Vectis 300 is an easy to operate lens shutter camera from Minolta's line of Advanced Photo System™ cameras. Your camera features drop-in loading, a 24 - 70mm zoom lens, and a wide focus frame. The sleek and compact design gives the Vectis 300 a sophisticated appearance suitable for any occasion. This manual is designed to help you understand the operation of your camera and its functions. Please familiarize yourself with the names of the controls and their locations on the camera, then read this manual thoroughly.

\* Advanced Photo System™ is a trademark of the five system developing companies.

## Advantages of the Advanced Photo System

### **New print formats...**

Classic C print, wider H print, and panorama P print formats are available with Advanced Photo System cameras.



### **Easier to load...**

Advanced Photo System cameras use the new IX240 type film. This new film features drop-in-loading to make loading your camera simple, the first time, every time. Indicators on the cassette tell you and your camera if the film is unexposed, partially exposed, exposed, or processed.

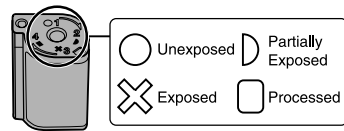

### **New processing...**

In addition to returning your prints in the format you selected, certified photofinishers will return your Advanced Photo System film in its original cassette with an index print. To order reprints, simply choose the images you want from the index print. No more searching through negatives to find the right frame.

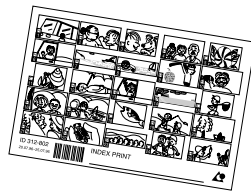

# TABLE OF CONTENTS

|                                   |    |
|-----------------------------------|----|
| FOR PROPER AND SAFE USE.....      | 4  |
| NAMES OF PARTS.....               | 6  |
| QUICK OPERATION.....              | 10 |
| <b>BASIC OPERATION</b>            |    |
| Attaching The Strap.....          | 13 |
| Installing The Battery.....       | 14 |
| Checking The Battery Power .....  | 15 |
| Loading Film.....                 | 16 |
| Full-Auto Operation .....         | 21 |
| For Closer Subjects.....          | 24 |
| Special Focusing Situations ..... | 26 |
| Focus Hold .....                  | 28 |
| Rewinding the Film.....           | 30 |
| Processing.....                   | 32 |

|  |    |
|--|----|
| <b>USING THE BUILT-IN FLASH</b>        | 33 |
| Flash Lamp.....                        | 34 |
| Flash Range .....                      | 35 |
| Selecting the Flash Mode.....          | 36 |
| Red-eye Reduction.....                 | 37 |
| Manual Fill-flash .....                | 38 |
| Flash Cancel .....                     | 39 |
| Night Portrait .....                   | 40 |
| <b>ADDITIONAL FEATURES</b>             |    |
| Date Imprinting .....                  | 42 |
| Title Imprinting .....                 | 48 |
| Self-timer .....                       | 56 |
| Remote Control (Sold Separately) ..... | 58 |
| <b>APPENDIX</b>                        |    |
| Lab Services.....                      | 64 |
| Caring For Your Camera .....           | 66 |
| Technical Details .....                | 72 |

## FOR PROPER AND SAFE USE

Read and understand all warnings and cautions before using this product.



Batteries may become hot or explode due to improper use.

- Use only the batteries specified in this instruction manual.
- Do not install the batteries with the polarity (+/–) reversed.
- Do not subject batteries to fire or high temperatures.
- Do not attempt to recharge, short, or disassemble.
- Tape over lithium battery contacts before disposal. Follow local codes for battery disposal.

Use caution, accidents may occur when using this product near young children.

Keep batteries or things that could be swallowed away from young children. Contact a doctor immediately if an object is swallowed.

Immediately remove the batteries and discontinue use if...

- the camera is dropped or subjected to an impact in which the interior is exposed.
- the product emits a strange smell, heat, or smoke.

The lens retracts when the camera is turned off or Auto Power Off is activated. Touching the lens barrel while it is retracting may cause injury.

Do not disassemble. Electric shock may occur if a high voltage circuit inside the camera is touched. Take your camera to a Minolta Service Facility when repairs are required.

# NAMES OF PARTS

## Camera Body

\* - Do not touch

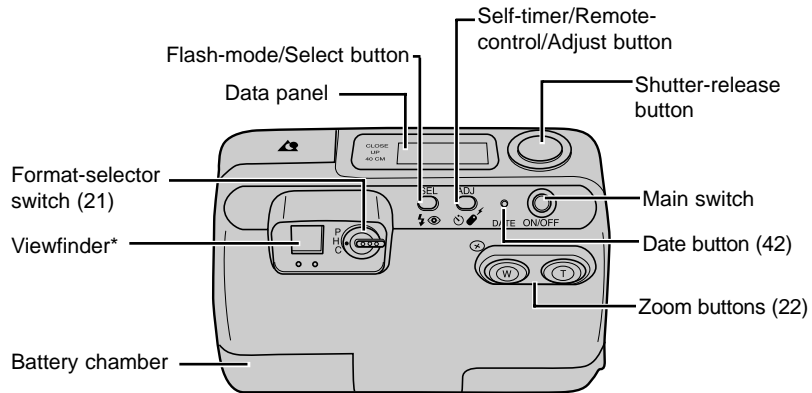
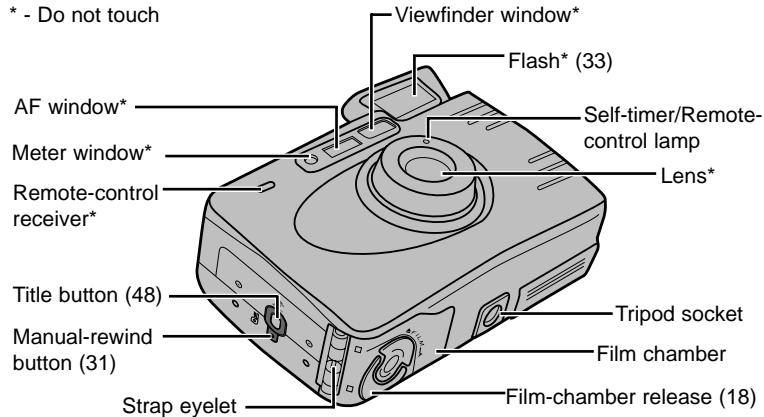

For information on specific parts, refer to the page numbers shown in parenthesis.

# NAMES OF PARTS - CONT'D

## Data Panel

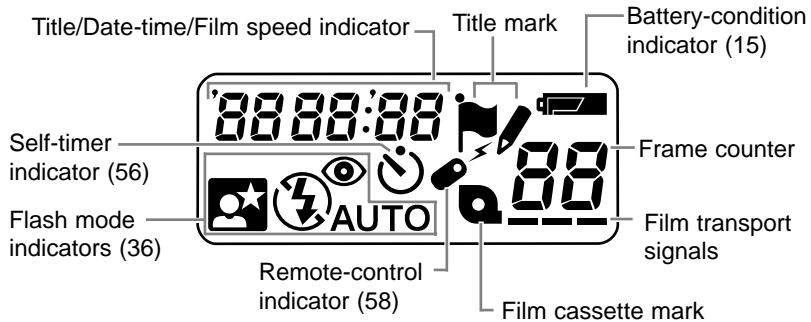

- Only the necessary indicators will appear in the data panel.

## Viewfinder

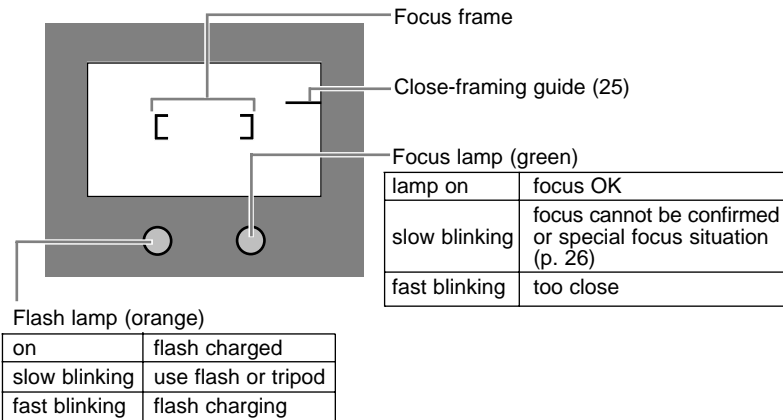

# QUICK OPERATION

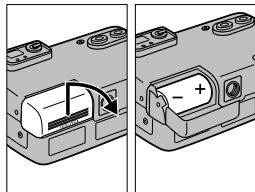

**1. Insert the battery (p. 14).**

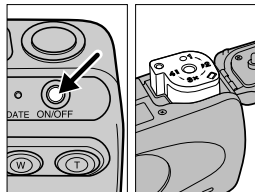

**2. Turn the camera on, then insert the film (p. 16).**

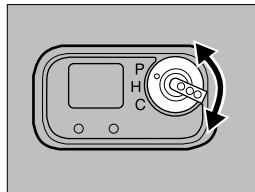

**3. Select the print format (p. 21).**

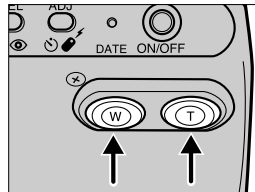
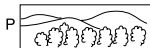

**4. Frame the subject as desired (p. 22).**



**5. Center your subject in the focus frame (pp. 22-23).**

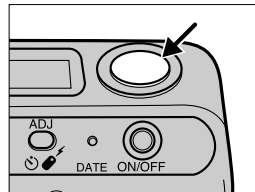

**6. Press the shutter-release button all the way down to take the picture (p. 23).**

## BASIC OPERATION

## ATTACHING THE STRAP

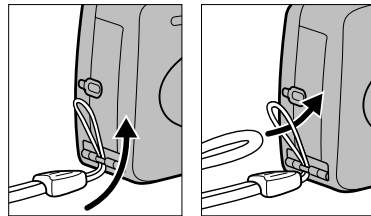

**Attach the strap as shown.**

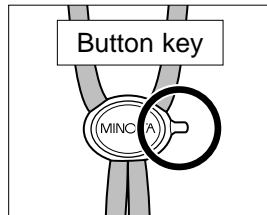

- A button key is included on the strap for pressing the Date button and Manual-rewind button.



## INSTALLING THE BATTERY

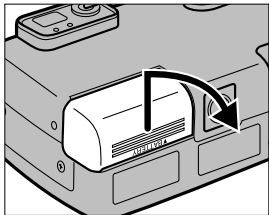

Your camera uses one 3-volt CR-2 lithium battery to supply power for all camera operations.

**1. Open the battery chamber as shown.**

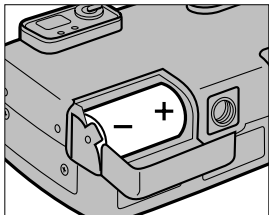

**2. Insert the battery into the chamber as indicated by the + and - marks.**

**3. Close the battery chamber.**

- After installing a new battery, reset the date and time (p. 44).

## CHECKING THE BATTERY POWER

Each time the main switch is turned on, a symbol will appear in the data panel to indicate the power status of the battery.

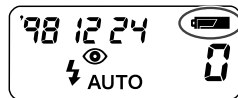

**Power is sufficient for all camera operations.**

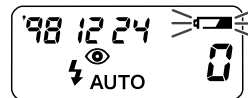

**Power is sufficient, but the battery will have to be replaced soon.**

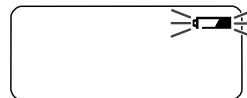

**Replace the battery. The shutter will lock until the battery is replaced.**

- If no display appears, replace the battery or check that it is inserted correctly.
- To save power, your camera will shut down and retract the lens if it is not operated for more than eight minutes. Press the main switch to restore power.
- Do not obstruct the lens while it is retracting.

## LOADING FILM

Your camera uses IX240 type film designed for use in Advanced Photo System cameras.

- Your camera's automatic transport system loads the film, sets the film speed, and advances the film after each exposure.
- After loading, the film chamber cannot be opened until rewind has been initiated.
- DEP, Double Exposure Prevention, prevents the camera from accepting exposed film.
- This camera will only load film with the ● mark current.

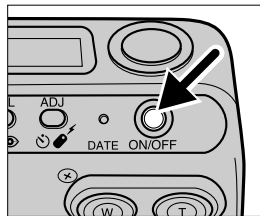

### Visual Exposure Indicators

- The current VEI has a white indicator behind it.

| VEI | MEANING           |
|-----|-------------------|
| ○   | UNEXPOSED         |
| ∩   | PARTIALLY EXPOSED |
| ×   | EXPOSED           |
| □   | PROCESSED         |

#### 1. Press the main switch to turn the camera on.

- Film can be loaded when the camera is on or off.
- If film is loaded with the camera off, all indicators in the data panel will disappear after the number of frames remaining is displayed.

## LOADING FILM - CONT'D

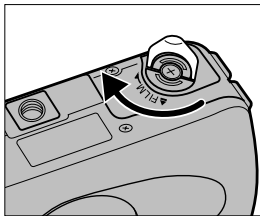

2. Turn the camera upside down, then turn the film-chamber release in the direction indicated. The film-chamber door will open partway.

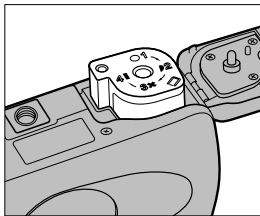

3. Open the film-chamber door and insert the cassette into the film chamber.

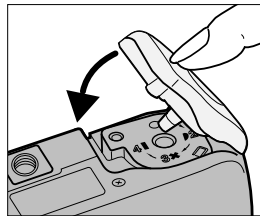

4. Press the film-chamber door closed until it clicks.

- The camera will display the cassette mark and the film's ISO in the data panel, then advance the film to the first frame. The frame counter will display the number of frames remaining on the roll.
- Do not load film without an operational battery in the camera.
- **Do not hold or turn the release when closing the door.** If the release is turned, the film will not load properly; the cassette's VEI indicator will change to  $\otimes$  and the film cannot be used.



## LOADING FILM - CONT'D



If 0 and the film transport signals blink in the data panel, turn the film chamber release, open the chamber, then remove the film.

- If the film's current VEI is **X**, insert a new roll of film.
- If a partially exposed roll of film was loaded into this camera, the VEI has been changed from **D** to **X**.
- If a processed roll of film was loaded into this camera, the VEI has been changed from **■** to **X**.
- If the film's current VEI is **●**, remove the film, remove and reinsert the battery, then reload the film. If the film will not load, contact the nearest authorized Minolta Service Facility.

## FULL-AUTO OPERATION

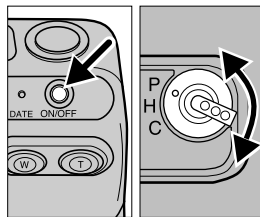

**1. Press the main switch to turn the camera on.**

- The camera is set for fully-automatic operation and the flash will fire automatically when necessary.

**2. Select the print format. The viewfinder will change to match your selection.**

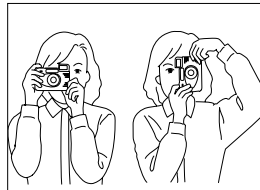

Hold the camera steady, making sure your fingers do not cover the flash. If you are taking a vertically framed picture, turn the camera so the flash is on top.

## FULL-AUTO OPERATION - CONT'D

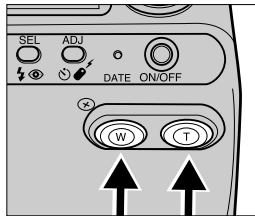

- 3. Looking through the viewfinder, frame the subject as desired.  
Press the W zoom button to zoom out.  
Press the T zoom button to zoom in.**



- 4. Center your subject in the focus frame, then press the shutter-release button partway down.**

- In low-light conditions, the AF illuminator (flash) will fire to determine focus distance (unless  $\text{AF OFF}$  is selected).
- If the orange flash lamp blinks quickly, the flash is not charged.
- Press the shutter-release button with a slow steady squeeze - never a quick jab.

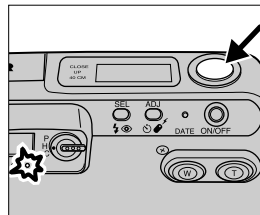

- 5. When the green focus lamp glows, press the shutter-release button all-the-way down to take the picture.**
- Turn the camera off after use.
  - Do not hold or obstruct the lens barrel.

## FOR CLOSER SUBJECTS

The green focus-lamp will blink rapidly and the shutter will lock when you are closer than the focus distance indicated below.

| Focal Length   | 24mm                      | 70mm                      |                           |
|----------------|---------------------------|---------------------------|---------------------------|
| Print Format   | All                       | C or H                    | P                         |
| Focus Distance | 0.4m - ∞<br>(1.3 ft. - ∞) | 0.4m - ∞<br>(1.3 ft. - ∞) | 0.8m - ∞<br>(2.6 ft. - ∞) |

- If the camera can not determine the focus distance, the green focus-lamp will blink slowly and the picture may not be in focus.

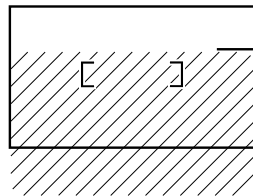

When your subject is closer than 1m (3.3 ft.) (1.7m (5.6 ft.) in Panorama format), compose your picture within the close-framing guide using focus hold if necessary (see p. 28).

Correct

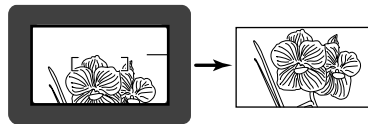

Not Correct

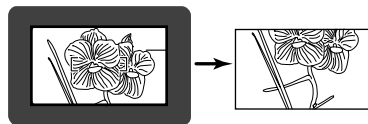

## SPECIAL FOCUSING SITUATIONS

Some scenes or subjects, like the examples below, are difficult for the autofocus system to lock on to. When the focus will not lock, focus hold (p. 28) on another object the same distance from you as your main subject, recompose, then press the shutter-release button all-the-way down to take the picture.

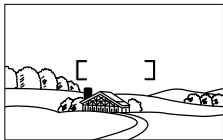

When a very bright or low contrast area fills the focus frame.

The green focus lamp will blink slowly to warn you that focus may not be accurate.



When your subject is near a very bright object or area.

The green focus lamp may glow, but the focus may not be accurate.

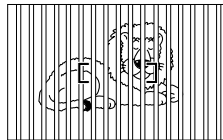

When two subjects overlap in the focus frame.

The green focus lamp may glow, but the focus may not be accurate.

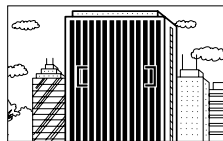

When a subject composed of alternating light and dark lines fills the focus frame.

The green focus lamp will blink slowly to warn you that focus may not be accurate.

## FOCUS HOLD



Subjects outside the focus frame may not be in focus. Use focus hold to ensure accurate focusing.



**1. Center your subject in the focus frame.**

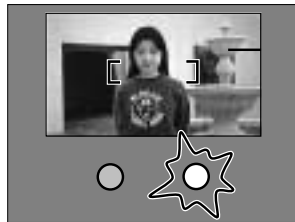

**2. Press and hold the shutter-release button partway down until the green focus lamp glows.**

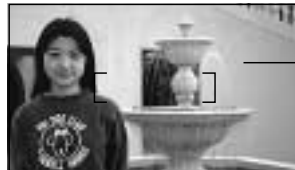

**3. Without lifting your finger, recompose the picture and press the shutter-release button all-the-way down to take the picture.**

- Lift your finger from the shutter-release button to cancel focus hold.



## REWINDING THE FILM

Your camera automatically rewinds the film into the cassette after the last exposure.



### 1. Wait for the film to completely rewind into the cassette.

- The frame counter will count down during rewind.
- 0 will appear in the frame counter and  will blink when the film is rewind.

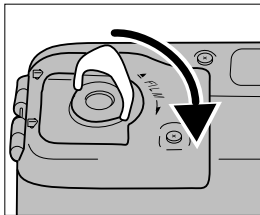

### 2. Turn the camera upside-down and turn the film-chamber release to open the film-chamber.

### 3. Open the film-chamber and remove the film.

- The film's VEI indicator will be .

- Do not open the film chamber until the motor stops, 0 appears and  blinks in the data panel.

## MANUAL REWIND

Use manual rewind to rewind the film before the roll is finished.

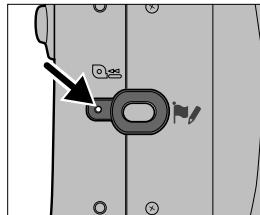

### 1. Gently press the manual rewind button using the button key.

### 2. Follow steps 1- 3 from automatic rewind.



For best results, take your film to a Certified Advanced Photo System photofinisher displaying this symbol (see p. 64).

## USING THE BUILT-IN FLASH

When you turn the camera on, the built-in flash is set to autoflash or autoflash with red-eye reduction, whichever mode was used last. The flash will fire automatically when necessary.

## FLASH LAMP

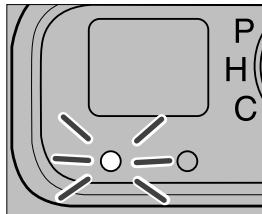

With the shutter-release button pressed partway down:





- If the orange flash lamp blinks rapidly, the flash is charging. Wait until it glows steadily, then take the picture.
- If the orange flash lamp blinks slowly, your scene is too dark for a hand-held picture. Use the flash or place your camera on a tripod.

## FLASH RANGE

The range of the built-in flash depends on the film speed and the focal length you are using. To ensure proper exposure, make sure your subject is positioned within the flash range.

|                      | Film speed<br>ISO 100          | Film speed<br>ISO 200          | Film speed<br>ISO 400          |
|----------------------|--------------------------------|--------------------------------|--------------------------------|
| Focal length<br>24mm | 0.4 – 3.1m<br>(1.3 – 10.2 ft.) | 0.4 – 4.4m<br>(1.3 – 14.4 ft.) | 0.4 – 6.2m<br>(1.3 – 20.3 ft.) |
| Focal length<br>70mm | 0.4 – 1.8m<br>(1.3 – 5.9 ft.)  | 0.4 – 2.6m<br>(1.3 – 8.5 ft.)  | 0.4 – 3.7m<br>(1.3 – 12.1 ft.) |

## SELECTING THE FLASH MODE

Besides autoflash mode , autoflash with red-eye reduction , manual fill-flash , night portrait , or flash cancel  can be selected.

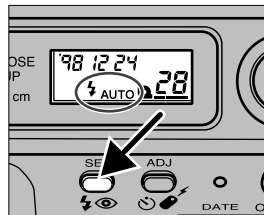

**Press the flash mode button until the desired indicator appears in the data panel.**

- Flash modes remain selected after the picture is taken.

## RED-EYE REDUCTION

Use the built-in flash's red-eye reduction mode to reduce the red-eye effect when photographing people or animals at night or in low light situations. The flash will fire a few short bursts before the main flash burst to reduce the red-eye effect.

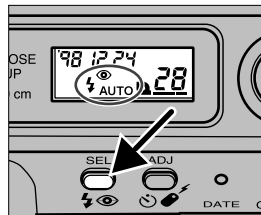

**Press the flash mode button until  appears in the data panel.**

- Warn your subject that the flash will fire a few short bursts just before the picture is taken.
- The flash mode remains selected after you take the picture.

## MANUAL FILL-FLASH

The flash will fire when the shutter is released regardless of lighting. Use manual fill flash to reduce harsh shadows on your subject's face.

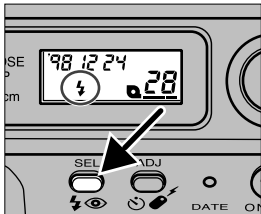

**Press the flash mode button until ⚡ appears in the data panel.**

- The flash mode remains selected after you take the picture.

## FLASH CANCEL

Use flash cancel when you are photographing twilight scenes, night scenes, distant subjects that are beyond the flash range, or you want to capture the ambiance of existing light.

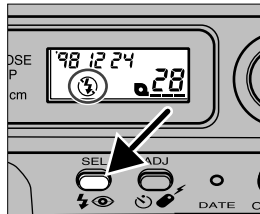



**Press the flash mode button until ⚡/ appears in the data panel.**

- Shutter speeds may be slow when the flash is cancelled. Use of a tripod is recommended.
- The flash mode remains selected after you take the picture.

## NIGHT PORTRAIT

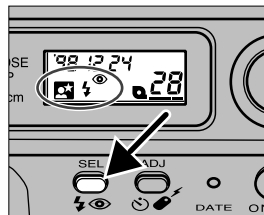
In night portrait mode, the camera balances the flash and existing light exposure so you can take beautiful pictures of people at sunset or at night. The flash is set to manual fill-flash with red-eye reduction.



**Press the flash mode button until  appears in the data panel.**

- The shutter speed may be slow. Use of a tripod is recommended.
- The flash mode remains selected after you take the picture.

## ADDITIONAL FEATURES

## DATE IMPRINTING

Your camera records date and time information on the film's magnetic strip that certified photofinishers can imprint in the front and back of your photographs.

- Some labs can not imprint date and/or time information on the front of your photographs. See your photofinisher for a full description of available services.

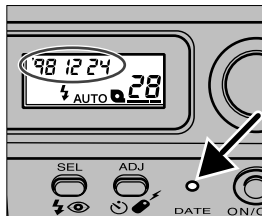

**Before taking the picture:**

**Using the button key, press the date button until the data panel displays the format you want to see on the print.**

The sequence is as follows:

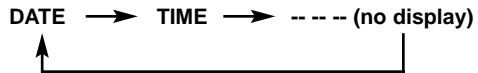

- When -- -- -- is displayed in the data panel, no data will be printed on the front of the print, but the date and time of exposure will be imprinted on the back of the print.
- If the date-time indicator is blinking, date/time information will not be imprinted. The date/time information needs to be reset.

## DATE IMPRINTING - Setting the Date and Time

- This camera has a quartz clock and automatic calendar through the year 2029.

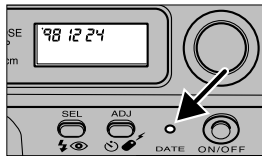

**1. Turn the camera off, then press the date button with the button key to display the date.**

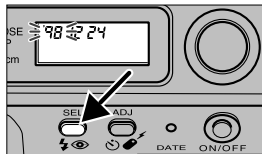

**2. Press the select button until the item you want to adjust blinks.**

- Each press of the select button causes the next item to blink. The sequence is:

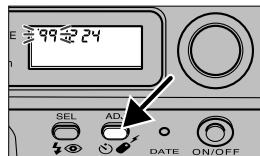
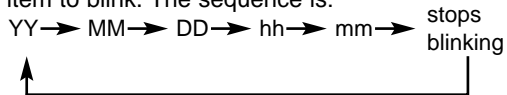

**3. Press the adjust button to change the blinking item.**

- Press and hold the adjust button to change the value rapidly.

**4. Repeat steps 2 and 3 until all items in the date and time display are correct.**



**5. Press the select button until all items stop blinking to set the updated information.**



## DATE IMPRINTING - Changing the Format



1. Press the main switch to turn the camera off.
2. Press the date button to display the date.



3. Press and hold the select button until all items in the date display blink.

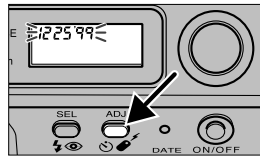

4. Press the adjust button to change the display format.

- The format sequences as follows:  
`Y M D → M D`Y → D M`Y
- 

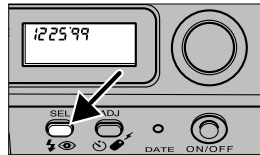

5. Press the select button until all items stop blinking to set the updated information.

## TITLE IMPRINTING

Three titles from the title list can be preset for use while taking pictures. Any one of the three preselected titles can be selected before the picture is taken. When selected, the title will be recorded on the film's magnetic data strip. At certified Advanced Photo System labs, the selected title will be printed on the back of the print.

Some labs may not be able to print the titles in all of the available languages. See your photofinisher for details.



Titles are displayed in the data panel as a title code. Please refer to the Title List sheet for the titles available with this camera.

## TITLE IMPRINTING - Preselecting Titles

Three title codes have been set into memory. You can change one or all three title codes at any time.

**1. Press the main switch to turn the camera off.**

**2. Select the code for the title you want from the title list.**

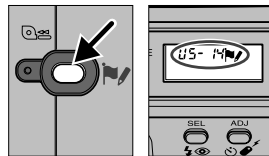

**3. Press the title button to display the title code you want to change.**

## TITLE IMPRINTING - Preselecting Titles

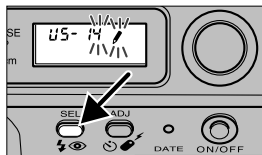

**4. Press the select button, the last digit of the title code number will blink.**

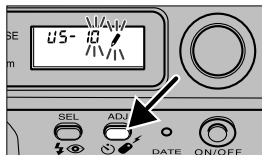

**5. Press the adjust button to change its value.**

- Press and hold the adjust button to change the value rapidly.

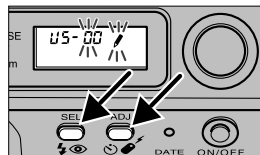

**6. Press the select button to make the next digit blink, change its value using the adjust button.**

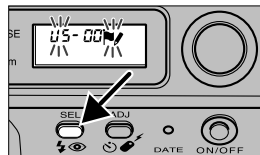

**7. Press the select button to make the language code blink.**

## TITLE IMPRINTING - Preselecting Titles

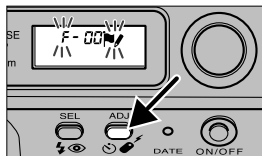

**8. Press the adjust button to change the language code.**

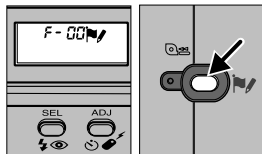

**9. When the title information is correct, press the title button.**

## TITLE IMPRINTING - Frame Title



**With the camera on and before taking the picture:**

**1. Press the title button to display the code for the title you want.**

- Each press of the title button changes the title code to the next selection.

**2. Take the picture. The magnetic data is written and the selection is cancelled for the next frame.**

## TITLE IMPRINTING - Filmstrip Title

An additional title for the entire roll of film can be selected. Both the filmstrip title and the frame title will be printed on the back of the print.



**After the film has been rewound and  blinks in the data panel:**



**1. With the camera on, press the title button to display the desired filmstrip title.**

- Each press of the title button changes the title code to the next selection.

**2. Press the shutter release button all-the-way down to set the title.**

- The camera advances to write the data on the film's leader, then rewinds the film.

**3. When  blinks in the data panel again, turn the film-chamber release and remove the film.**

- Set the filmstrip title before removing the film.
- ✎ Once a filmstrip title is set, it can not be changed or cancelled using the camera.

## SELF-TIMER

The self-timer delays release of the shutter for approximately 10 seconds after you press the shutter release button.

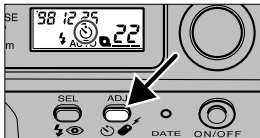

**1. Place the camera on a tripod, then press the self-timer button until ☺ appears in the data panel.**



**2. Center your subject in the focus frame.**

**3. Press the shutter-release button all-the-way down.**

- ☺ will blink in the data panel during countdown.
- The self-timer lamp will blink slowly. Just before the shutter is released, the self-timer lamp will blink rapidly, then glow.
- To cancel the self-timer, press the self-timer button or turn the camera off.
- The self-timer is automatically cancelled after the shutter releases.
- Do not press the shutter-release button while standing in front of the camera.

## REMOTE CONTROL (Sold Separately)

The IR Remote Control RC-3 (not included) allows remote camera operation from up to 5m (16.4 ft.) away.

- The remote control may not operate with backlit subjects or under fluorescent light.
- To save power, the camera automatically shuts down if the remote control is not operated for more than eight minutes.
- Remote control mode will remain selected after the picture is taken.

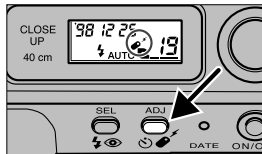

- 1. Place the camera on a tripod, then press the remote-control button until  appears in the data panel.**

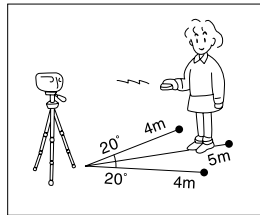

- 2. Compose your picture.**

- 3. Point the remote toward the front of the camera and press  or 2s.**

- Release (): the remote-control lamp will blink once before the picture is taken.  
Delay (2s): the remote-control lamp will blink several times before the picture is taken.

### FOCUS HOLD IN REMOTE CONTROL MODE

1. Set the camera to remote control mode.

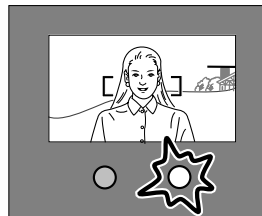

2. Center your subject in the focus frame, then press the shutter-release button partway down until the green focus lamp glows.

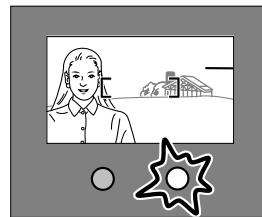

3. Lift your finger from the shutter-release button, then recompose the picture.

4. Point the remote toward the front of the camera and press **•** or **2s**.

- The focus will remain locked until the focus is reset, remote-control mode is cancelled, or the camera is turned off.



### **CHANGING THE BATTERY**

---

The remote control uses a 3V lithium battery (CR2032). When pressing the remote-control buttons does not release the shutter, the battery must be replaced. (The supplied battery should be sufficient for approximately ten years of operation).

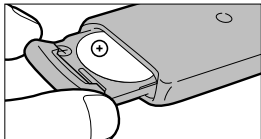

**1. Pull out the battery chamber and remove the old battery.**

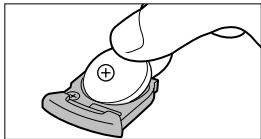

**2. Insert a new battery into the battery chamber with its plus side up.**

**3. Slide the battery chamber back into the remote control.**

APPENDIX



To receive the best possible prints, take your film to a photolab displaying the Certified Advanced Photo System logo. Photofinishers displaying this logo have been certified according to Advanced Photo System guidelines.

Certified photolabs will be able to provide the following five services.

### 1. **CHP - Print Format**

Your film will be printed according to the format set when the picture was taken.

### 2. **Date and Title Imprinting**

The date, time, and selected title are printed on the back of the picture in the chosen format.

### 3. **PQI - Print Quality Improvement**

The lab will compensate (or not compensate) printing according to the data recorded on the magnetic data strips.

### 4. **Film is returned in the cassette.**

To keep the film dust free and aid in organization, film is returned in its original film cassette. The VEI will be set to  to prevent accidental loading.

### 5. **Index Print**

An index print showing a numbered image of each frame is included with your returned order.

### **Reprints**

Images are always captured in the H format (High-Vision). You can select any of the three formats when ordering reprints.

### **CLEANING**

---

- Keep the AF and AE windows clean or the focus and/or exposure may not be accurate.
- If the camera body is dirty, gently wipe it clean with a soft, clean, dry cloth.
- To clean the lens surface, first brush away any dust or sand then, if necessary, moisten a lens tissue with lens cleaning fluid and gently wipe the lens in a circular motion, starting from the center.
- Never place lens fluid directly on the lens.
- Never touch the lens surface with your fingers.
- Never use alcohol or solvents to clean the camera.

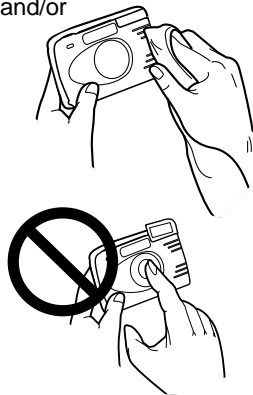

### **STORAGE**

---

When storing the camera for extended periods, please follow these guidelines:

- Store the camera in a cool, dry, well-ventilated area away from dust and chemicals. For very long periods, place the camera in an airtight container with a silica gel drying agent.
- Before using after prolonged storage, always check the camera's operation to make sure it is functioning properly.

### **QUESTIONS AND SERVICE**

- If you have questions about your camera, contact your local camera dealer or write to the Minolta distributor in your area.
- If the camera is damaged or the rewind motor does not operate, do not open the film chamber or forcefully remove the cassette. Contact an authorized Minolta Service Facility.
- Before shipping your camera for repair, please contact an authorized Minolta Service Facility for details.

### **BEFORE IMPORTANT EVENTS**

- Check camera operation carefully or take test photographs.
- Minolta is not responsible for any loss which may occur due to an equipment malfunction.

### **FILM CASSETTE WARNING**

The film used in Advanced Photo System cameras stores some data magnetically. Do not place the cassette on or near anything that creates a magnetic field, such as a television or stereo speakers.

### **CAMERA ERROR**

If all the indicators in the data panel blink, or the data panel is blank and the camera will not function with a fresh battery, remove and reinsert the battery. If normal operation does not resume, or the camera malfunctions repeatedly, contact an authorized Minolta Service Facility.

### OPERATING TEMPERATURE AND CONDITIONS

- This camera is designed for use from -10 to 40 °C (14 to 104 °F).
- Never leave your camera where it may be subjected to extreme temperatures such as in the glove compartment of a car.
- At colder temperatures, the data panel response time will be slow. At higher temperatures, the display will temporarily darken, but will restore when the temperature normalizes.



- Never subject the camera to extreme humidity.
- To prevent condensation from forming, place the camera in a sealed plastic bag when bringing it from the cold exterior into a warm building. Allow it to come to room temperature before removing it from the bag.
- When photographing in cold weather, it is recommended that you keep the camera and spare batteries inside your coat to keep them warm when you are not shooting. Cold batteries will regain some of their charge when they warm up.

## TECHNICAL DETAILS

|                                  |  |
|----------------------------------|--|
| <b>Camera Type:</b>              | IX240 Lens Shutter Camera  |
| <b>Lens:</b>                     | 24-70mm f/5.7 - 9.8 lens (approx. equivalent to 30-87.5mm in 35mm format); 4 element/4 group construction  |
| <b>Focusing Range:</b>           | C/H: Wide 0.4m - $\infty$ (1.3 ft. - $\infty$ )<br>Tele 0.4m - $\infty$ (1.3 ft. - $\infty$ )<br>P: Wide 0.4m - $\infty$ (1.3 ft. - $\infty$ )<br>Tele 0.8m - $\infty$ (2.6 ft. - $\infty$ ) |
| <b>Film Speed Setting:</b>       | Automatic setting for DX coded films<br>ISO 25-3200  |
| <b>Metering Range (ISO 200):</b> | Ev 4.0 - 17  |
| <b>Flash Range (ISO 200):</b>    | Wide: 0.4 - 4.4m (1.3- 14.4 ft.)<br>Tele: 0.4 - 2.6m (1.3 - 8.5 ft.)   |
| <b>Shutter Speed Range:</b>      | 8 - 1/500 sec.   |
| <b>Aperture Range</b>            | f/5.7 - f/22   |

|                    |   |
|--------------------|---|
| <b>Battery:</b>    | One CR-2 3V Lithium battery<br>Battery-condition indication: 3-stage indication<br>Battery performance: approx. 10 rolls based on Minolta's standard test method using 25 exposure rolls with the flash for 50% of the exposures. |
| <b>Viewfinder:</b> | Magnification: 0.35X - 0.91X<br>Field of View (H format): 85% (for subject at 3m)<br>Eyepoint: 21.4mm from the viewfinder   |
| <b>Dimensions:</b> | 97 x 62 x 32 mm<br>(3.8 x 2.4 x 1.3 in.)  |
| <b>Weight:</b>     | 215g (7.58 oz.) without battery   |

- Specifications are based on the latest information available at the time of printing and are subject to change without notice.

This device complies with Part 15 of the FCC Rules. Operation is subject to the following two conditions: (1) This device may not cause harmful interference, and (2) this device must accept any interference received, including interference that may cause undesired operation. Changes or modifications not approved by the party responsible for compliance could void the user's authority to operate the equipment. This equipment has been tested and found to comply with the limits for a Class B digital device, pursuant to Part 15 of the FCC Rules. These limits are designed to provide reasonable protection against harmful interference in a residential installation. This equipment generates, uses and can radiate radio frequency energy and, if not installed and used in accordance with the instructions, may cause harmful interference to radio communications. However, there is no guarantee that interference will not occur in a particular installation. If this equipment does cause harmful interference to radio or television reception, which can be determined by

turning the equipment off and on, the user is encouraged to try to correct the interference by one or more of the following measures:

- Reorient or relocate the receiving antenna.
- Increase the separation between the equipment and the receiver.
- Connect the equipment to an outlet on a circuit different from that to which the receiver is connected.
- Consult the dealer or an experienced radio/TV technician for help.

This Class B digital apparatus meets all requirements of the Canadian Interference-Causing Equipment Regulations.

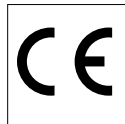

This mark on the bottom of your camera is there to inform you that this camera meets the requirements of the EU (European Union) concerning interference causing equipment regulations. CE stands for Conformité Européenne (European Conformity).

## NOTES

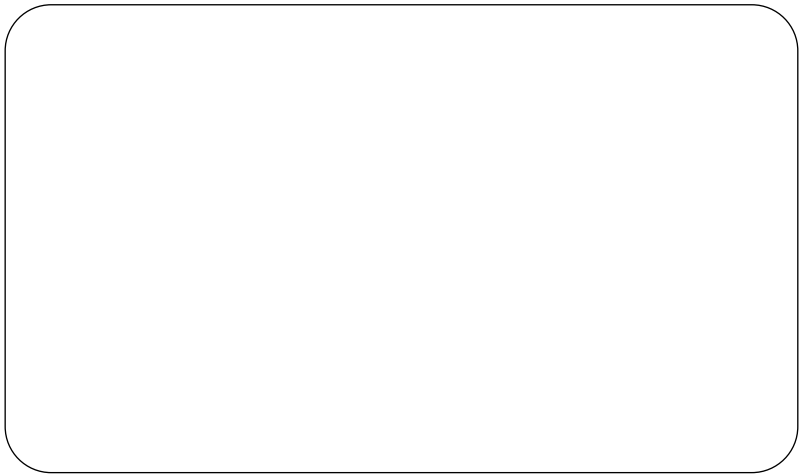

## NOTES

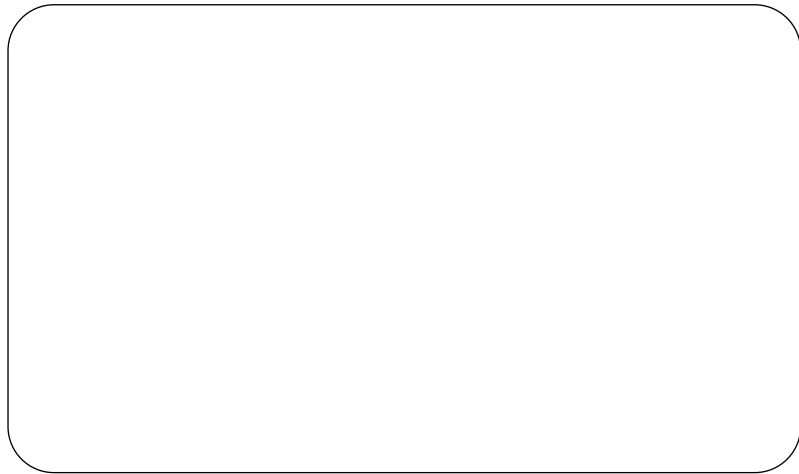



**Minolta Co., Ltd.**

**3-13, 2-Chome, Azuchi-Machi, Chuo-Ku, Osaka 541-8556, Japan**

**Minolta GmbH**

Kurt-Fischer-Strasse 50, D-22923 Ahrensburg, Germany

**Minolta France S.A.**

365 Route de Saint-Germain, F-78420 Carrieres-Sur-Seine, France

**Minolta (UK) Limited**

Rooksley Park, Precedent Drive, Rooksley, Milton Keynes, MK13 8HF, England

**Minolta Austria Ges. m.b.H.**

Amalienstrasse 59-61, A-1131 Wien, Austria

**Minolta Camera Benelux B.V.**

Zonnebaan 39, P.O. Box 6000, NL-3600 HA Maarssen, The Netherlands

**Belgium Branch**

Prins Boundewijnlaan 1, B-2550 Kontich, Belgium

**Minolta (Schweiz) AG**

Riedstrasse 6, CH-8953 Dietikon, Switzerland

**Minolta Svenska AB**

P.O.Box 9058, Albygatan 114, S-17109 Solna, Sweden

**Finland Branch**

Niittykatu 6 PL 37, SF-02201 Espoo, Finland

**Minolta Portugal Limitada**

Av. do Brasil 33-A, P-1700 Lisboa, Portugal

**Minolta Corporation**

**Head Office**

101 Williams Drive, Ramsey, New Jersey 07446, U.S.A.

**Los Angeles Branch**

11150 Hope Street Cypress, CA 90630, U.S.A.

**Minolta Canada Inc.**

**Head Office**

369 Britannia Road East, Mississauga, Ontario L4Z 2H5, Canada

**Vancouver Branch**

230-3771 Jacombs Road, Richmond, B.C. V6V 2L9, Canada

**Minolta Hong Kong Limited**

Room 208, 2/F, Eastern Center, 1065 King's Road, Quarry Bay, Hong Kong, China

**Minolta Singapore (Pte) Ltd.**

10, Teban Gardens Crescent, Singapore 608923

**Shanghai Minolta Optical**

**Products Co., Ltd.**

368 Minolta Road, Songjiang, Shanghai, China

9222-2212-31 MM-C909

©1998 Minolta Co., Ltd. under the Berne Convention and  
Universal Copyright Convention

Printed in Malaysia