

## RANGE COMPOSITION

A range of hoods exploiting the "inductive emission" principle. Untreated air is introduced inside to partly compensate for that removed. This results in better drawing of fumes towards the filter surface and reduced air-treatment costs. The range consists of hoods with 6 different lengths (2000, 2400, 2800, 3200, 3600 and 4000 mm) and 2200 mm deep.



# SUPERTREDIL - S line - 2200mm

**304 AISI CENTRAL HOODS** **ZANUSSI**  
PROFESSIONAL

## FUNCTIONAL AND CONSTRUCTION FEATURES

- ◆ Constructed entirely in 304 AISI stainless steel.
- ◆ Two separate air circuits (extraction and intake) to reduce the quantity of treated air released in the environment.
- ◆ Rear exhaust with filters and front air intake through a narrow slot sized to obtain the correct induction effect.
- ◆ Perforated panel inside the intake circuit to guarantee a perfect and uniform air distribution.
- ◆ Completely insulated intake area to avoid external condensation.
- ◆ Labyrinth filters in 304 AISI stainless steel easily removable for cleaning. Labyrinth filters guarantee constant filtration to avoid clogging and protect against fire.
- ◆ Perimetral gutter with drain hole to transfer grease into a 304 AISI container.
- ◆ External panels with upturned edges to avoid injuries.
- ◆ The outlet holes are sized in order to minimize drops in pressure.
- ◆ Pressure gauging for perfect calibration.
- ◆ Built-in lighting with protective screen.
- ◆ Available, as optional accessory, an air intake Plenum, which is insulated to avoid condensation.
- ◆ Heating and air conditioning costs reduced up to 60%.

TECHNICAL DATA						
CHARACTERISTICS	MODELS					
	STCF2220 641266	STCF2224 641267	STCF2228 641268	STCF2232 641269	STCF2236 641270	STCF2240 641271
External dimensions - mm						
width	2000	2400	2800	3200	3600	4000
depth	2200	2200	2200	2200	2200	2200
height	500	500	500	500	500	500
Air Capacity - mc/h	5600	6700	7800	8900	10000	11100
Net weight - kg.	172	198	224	250	276	302

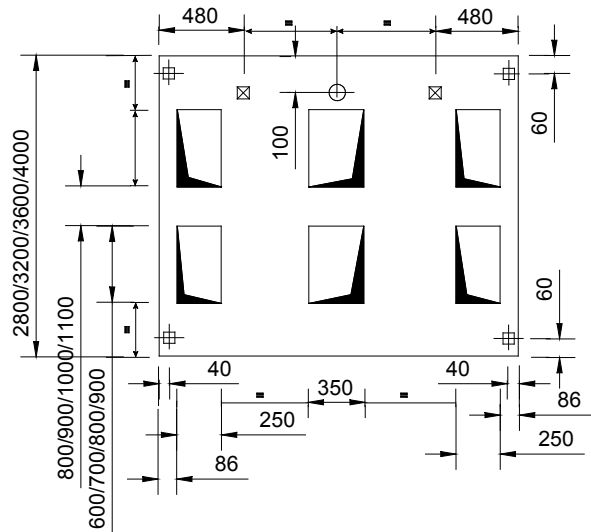
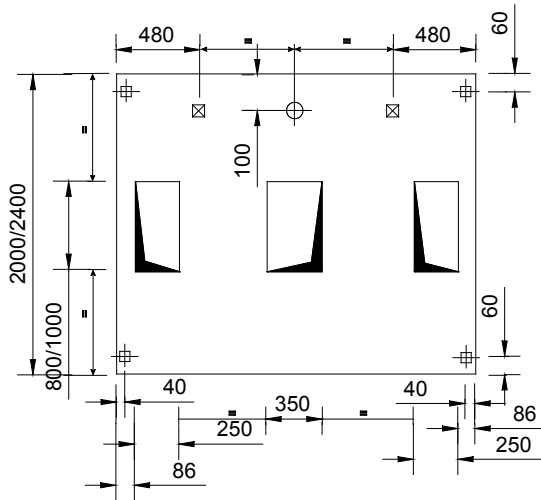
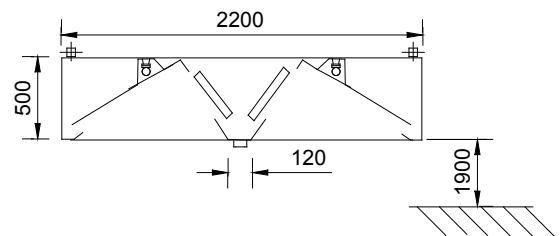
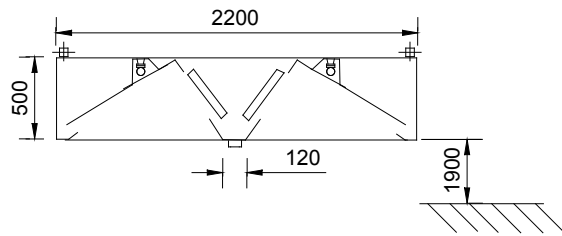

**LEGEND**

	STCF2220 641266	STCF2224 641267	STCF2228 641268	STCF2232 641269	STCF2236 641270	STCF2240 641271
I - Electrical connection	220 V, 1N, 50/60	220 V, 1N, 50/60	220 V, 1N, 50/60	220 V, 1N, 50/60	220 V, 1N, 50/60	220 V, 1N, 50/60

**OPTIONAL ACCESSORIES**

ACCESSORIES	MODELS					
	STCF2220 641266	STCF2224 641267	STCF2228 641268	STCF2232 641269	STCF2236 641270	STCF2240 641271
EXTRACTION PLENUM FOR HOOD 2400 MM		640138				
EXTRACTION PLENUM FOR HOOD 2800 MM			640139			
EXTRACTION PLENUM FOR HOOD 3200 MM				640140		
EXTRACTION PLENUM FOR HOOD 3600 MM					640141	
EXTRACTION PLENUM FOR HOOD 4000 MM						640142
EXTRACTION PLENUM FOR MODUL.HOOD 2400 MM		640143				
EXTRACTION PLENUM FOR MODUL.HOOD 2800 MM			640144			
EXTRACTION PLENUM FOR MODUL.HOOD 3200 MM				640145		
EXTRACTION PLENUM FOR MODUL.HOOD 3600 MM					640259	
EXTRACTION PLENUM FOR MODUL.HOOD 4000 MM						640264
GALVAN. AIR INLET PLENUM FOR HOOD 2400MM		640374				
GALVAN. AIR INLET PLENUM FOR HOOD 2800MM			640375			
GALVAN. AIR INLET PLENUM FOR HOOD 3200MM				640376		
GALVAN. AIR INLET PLENUM FOR HOOD 3600MM					640377	
GALVAN. AIR INLET PLENUM FOR HOOD 4000MM						640378



www.zanussiprofessional.com