

Urban Advantage® Stroller Safety, Assembly & Operating Instructions

Model #UA105



Go-Go Babyz Corporation

EXPRESS LIMITED WARRANTY

Go-Go Babyz Corporation (“Go-Go Babyz”) warrants this product to be free from defects in materials and workmanship for a period of one year from the date of purchase. Go-Go Babyz will repair or replace, at its sole option, the defective product within that one-year time period.

If you have a problem with your Go-Go Babyz product or are not satisfied with it, please contact Go-Go Babyz Customer Service at 1.888.686.2552.

This express limited warranty does not cover:

- (1) Pick-up, delivery, or freight charges.
- (2) Corrosion caused by improper storage or failure to reasonably protect the product from salt water and adverse conditions.
- (3) Deterioration due to lack of maintenance and cleaning as specified in the product instructions.

Go-Go Babyz SHALL NOT BE LIABLE FOR ANY INCIDENTAL OR CONSEQUENTIAL DAMAGES ARISING FROM BREACH OF ANY EXPRESS OR IMPLIED WARRANTY ON THIS PRODUCT. ANY IMPLIED WARRANTY, INCLUDING IMPLIED WARRANTIES OF MERCHANTABILITY AND FITNESS FOR A PARTICULAR PURPOSE, IS LIMITED TO THE DURATION OF THE EXPRESS, LIMITED WARRANTY (ONE-YEAR FROM THE DATE OF PURCHASE).

Under no circumstance shall any liability of Go-Go Babyz under this Express Limited Warranty, or otherwise, exceed the price of the defective product or parts.

Note: Some states do not allow the exclusion or limitation on incidental or consequential damages, so the above limitation may not apply to you. Some states do not allow limitations on how long an implied warranty lasts, so the above limitation may not apply to you.

This Express Limited Warranty gives you specific legal rights, and you may have other rights, which vary from state to state.

CONTACT GO-GO BABYZ' CUSTOMER SERVICE FOR INFORMATION AND ALL RETURNS:

Go-Go Babyz Returns
7011 Realm Drive, Suite A5
San Jose, CA 95119
408.360.0653

Table of Contents

Before Assembly 4

Assembling the Urban Advantage 5

How to Properly Use the Urban Advantage..... 10

Using the Urban Advantage as a Travel System 13

Safety 14

FAQs 16

Troubleshooting 18

Care and Maintenance 20

Before Assembling

PLEASE READ THOROUGHLY PRIOR TO ASSEMBLING THE URBAN ADVANTAGE.

REPORT SHIPPING DAMAGE IMMEDIATELY. IF YOUR STROLLER WAS DELIVERED AND THE BOX APPEARS DAMAGED, PLEASE INSPECT IT AND REPORT ANY DAMAGE TO GO-GO BABYZ BEFORE THROWING AWAY YOUR BOX. GO-GO BABYZ WILL FILE A CLAIM DIRECTLY WITH UPS OR OTHER FREIGHT CARRIER AND WILL REPLACE THE STROLLER AT NO EXTRA COST. PLEASE CALL A GO-GO BABYZ CUSTOMER REPRESENTATIVE AT 888.686.2552.

CUSTOMER SERVICE AT GO-GO BABYZ CAN USUALLY RESOLVE ANY PROBLEM OR ANSWER ANY QUESTION YOU HAVE WITH ONE PHONE CALL. PLEASE CALL US AT 888-686-2552 IF YOU HAVE ANY PROBLEMS WITH THE STROLLER.



GENERAL INSTRUCTIONS
FOR ASSEMBLING THE
URBAN ADVANTAGE
STROLLER.



BEFORE ASSEMBLING YOUR STROLLER, PLEASE TAKE A FEW MINUTES TO READ THE SAFETY WARNINGS AND OPERATING INSTRUCTIONS.

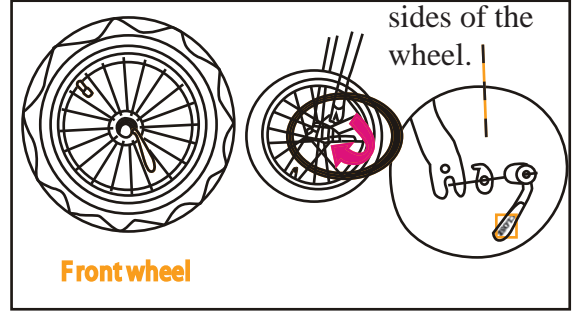
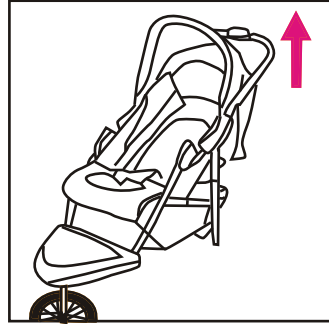

1. Release locking latch. Unfold the stroller. Make sure both sides of the frame lock into place. Remove foam packing tubes from rear axle/brake.

2. Lean the stroller backwards with the front forks pointing up. Assemble the front wheel as shown. Make sure safety pins are placed in matching holes in frame on both sides of the yoke. Tighten the lever on the axle until it is very close to contacting the fork then close the lever.

⚠ WARNING: FRONT WHEEL COULD COME OFF AND INJURY COULD RESULT IF SAFETY PINS ARE NOT ASSEMBLED PROPERLY.

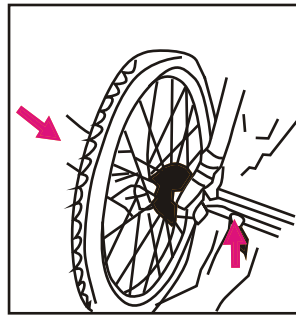
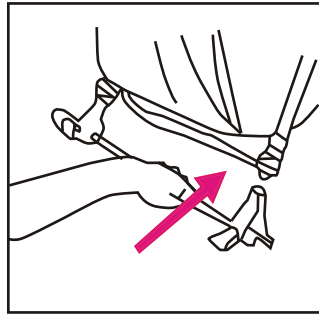

3. Remove foam packing tubes from rear leg tubes on the frame. Attach rear axle assembly onto rear leg tubes by inserting the left side a little bit and then inserting the right hand side. Press both of them together until the spring loaded buttons click into place.

4. Remove plastic packing tubes from the rear wheel axle. Slide wheel onto axle and push until you hear a click. Make sure it is properly secure. Push down on spring Clip if necessary.

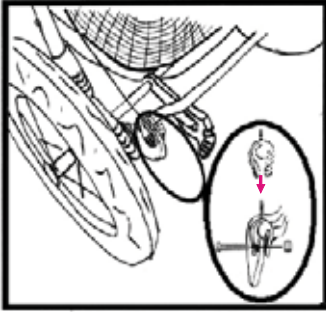

5. Line up holes in mounting bracket of the brake cable, with hole in the post of the brake bar. Insert bolt and tighten nut. Make sure arrow on cable bracket is pointing up.

6. Test brake and kickstand. Kickstand should have approximately 1" of clearance and be vertical. See instructions to adjust kickstand or call Go-Go Babyz for assistance if necessary.



7. Place parent tray onto metal tubing above the canopy.

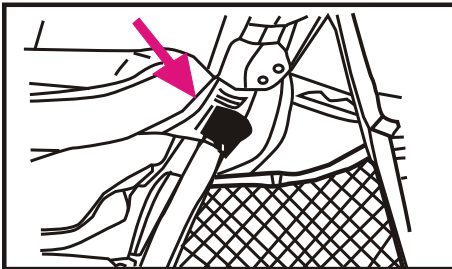

8. Place the front, child tray, onto the metal tubing between the foot rest and the center locking mechanism.

How to Properly Use the Urban Advantage Stroller

1. TO OPEN STROLLER

Step 1: Release Locking Latch. (figure A)

Step 2: Unfold by pulling up to the handle. Make sure both sides lock into place. (figure B) When locked in place, a small amount of movement between the two locking pieces is normal, but there should not be any open area between the two pieces, as shown in figure B.



Figure A

2. TO SECURE CHILD IN STROLLER

Step 1: Lock brake-activated kickstand to keep stroller from rolling by stepping on the brake bar until it locks into place. (figure C)

Step 2: Place child in stroller.

Step 3: Hook shoulder straps to waist belt.

Step 4: To secure, snap each side of waist belt into buckle. (figure D)

Step 5: For proper fit, adjust shoulder straps and waistband as shown. (figure E)



Figure B



Figure C

⚠️ WARNING: AVOID SERIOUS INJURY FROM FALLING OR SLIDING OUT, ALWAYS USE RESTRAINT SYSTEM.

3. TO RECLINE SEAT AND/OR ADJUST FOOT RETAINER

⚠️ WARNING: WHEN STROLLER IS USED IN THE RECLINED POSITION, ALL STRAPS SHOULD BE RE-ADJUSTED TO FIT CHILD SNUGLY.

⚠️ WARNING: CHILD MAY SLIP INTO LEG OPENING AND STRANGLE. NEVER USE IN RECLINED POSITION UNLESS FOOT RETAINER IS IN UPRIGHT POSITION.



Figure D



Figure E

How to Properly Use the Urban Advantage Stroller

TO RECLINE SEAT:

Pull bar on back of seatback and recline to one of the three positions and release. (figure 1)

TO RAISE SEAT:

Pull bar on back of reclining seat back and raise seatback to the upright position.

NOTE: The 4th position is higher up on the support bar than the other positions. The best way to raise the seat is by reaching from the inside of the stroller and pulling the seatback forward. It may be necessary to pull fabric out of the way of the side plastic pieces to reach the fourth (most upright) position.

TO RAISE FOOTREST:

Pull up on the bottom part of the footrest.

TO LOWER FOOTREST:

Push both buttons on the sides of the footrest together and lower the bar. (figure 2)

4. TO OPERATE BRAKE-ACTIVATED KICKSTAND

⚠ WARNING: ALWAYS USE COMBINATION BRAKE & KICKSTAND WHEN STROLLER IS PARKED.

⚠ WARNING: TO AVOID INJURY, ALWAYS KEEP CHILD AWAY FROM SPRING ACTIVATED KICKSTAND. A CHILD'S SMALL FINGERS OR HAND COULD GET CAUGHT BETWEEN KICKSTAND AND FRAME

TO LOCK BRAKE AND KICKSTAND:

Push one-touch braking bar down at any location with your foot. (figure 3)

NOTE: Significant foot-force must be used to lower the kickstand and lock it in place. This is normal.

TO UNLOCK BRAKE AND KICKSTAND:

Release the braking bar by pushing on the locking mechanism with your toe and then lifting the braking bar up with your foot. (figure 4 & 5)



Figure 1



Figure 2



Figure 3



Figure 4



Figure 5

How to Properly Use the Urban Advantage Stroller

6. TO ADJUST THE KICKSTAND

⚠ WARNING: IF THE CABLE IS NOT ADJUSTED PROPERLY OR THE KICKSTAND IS BENT OR BROKEN THE STABILITY OF THE STROLLER IN THE PARKED POSITION IS DIMINISHED. IN ALL EVENTS, NO CHILD SHOULD EVER BE LEFT UNATTENDED IN ANY STROLLER.

Turning the nut connected to the brake cable clockwise reduces the amount of force required to extend the kickstand. Turning the nut counter-clockwise increases the tension on the cable and adjusts the forward lean of the legs. (figure A)

The legs of the kickstand must be vertical when the unit is parked in order to be effective. Adjust the nut to keep legs in vertical position with the least amount of force required. The cable will require re-adjusting over time as parts wear.

The cable can also be adjusted in front if necessary by loosening the nuts, pulling the cable tight and retightening the nuts.

There should approximately 1/2" to 1" clearance between the bottom of the kickstand and the ground. This provides clearance when stroller is loaded and for activating.

6. OPTIONS FOR USING THE CHILD TRAY

NOTE: Some parents may prefer not to install the child tray on the stroller as this option may allow easier accessibility to the child. (figure B & C)

Ex: Diaper changing or feeding. The child tray may be easily attached and removed by pulling off or snapping on each side to the frame of the stroller (just below the center lock on the frame and above the foot rest)

7. OPTIONS FOR USING THE SWIVEL WHEEL LOCK

TO LOCK FRONT SWIVEL: Adjust front wheel so that wheel is straight and lock is forward. Push lock to right. (figure D)

TO UNLOCK FRONT SWIVEL: Push lock to left.

NOTE: On rough surfaces, lock the wheel to keep straight. On smooth surfaces, unlock to allow the wheel to swivel.



Figure A



Figure B



Figure C



Figure D

8. REAR WHEELS

WHEELS: Before first use, and periodically thereafter, test wheels by pulling on them. Failure to secure wheels may result in injury to your child. If wheel pulls off, push wheel onto axle again until click is heard. If no click is heard, check position of metal clip. The U-shaped, spring loaded metal clip on the hub of the wheel holds the wheel in place and should always be in the position shown unless you are purposely trying to remove the wheel. (figure 1).



Figure 1

TO REMOVE THE WHEEL: Push in metal clip and pull wheel off.

9. TIRES

TIRES: The tires provided are long lasting, composite rubber tires that never need air.

10. WRIST STRAP

The wrist strap helps you gain control over your stroller. Secure the wrist strap to the top handle and make sure wrist strap is around your wrist whenever your child is in the stroller.

How to Properly Use the Urban Advantage Stroller

6. TO FOLD THE URBAN ADVANTAGE

Step 1: Unlock the brakes, raise the kickstand and unlock the swivel wheel.

Step 2: Close canopy.

Step 3: Push red button to left with thumb to unlock position (figure A) then squeeze large red lever on the handle to fold stroller (figure B).

Step 4: Push stroller down to fold. It is recommended to take a step forward and let the stroller collapse down. This can be easily done with one hand and walking forward.

Step 5: Engage locking latch (on the right side).

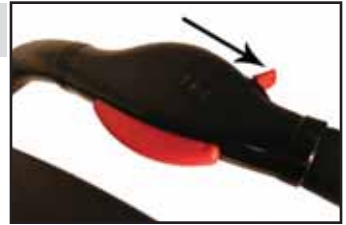

Figure A



Figure B



Figure C

Using the Urban Advantage as a Travel System

The Urban Advantage may be used as a travel system.

You may use most of the infant car seats on the market with the stroller as a travel system. We recommend the Graco Snug Ride and the Britax Companion infant car seats because of the secure fit with the Urban Advantage. We do not recommend the Evenflo or Compass infant seats with the Urban Advantage.

We have an extension strap that connects to the waist belt of the 5-point harness. It goes over the top of the infant car seats for added safety. It is located in the basket area.



To Use an Infant Car Seat with the Urban Advantage, please follow the instructions below.

Step 1: Begin by releasing the shoulder strap from both sides of the lap-belt on the 5-point harness.

Step 2: Extend both sides of the lap-belt as far as you can.

Step 3: Simply connect one end of the extension strap to the lap-belt of the 5-point harness on the Urban Advantage.

Step 4: Set the infant seat in the stroller with the child tray attached, Your child should be facing you in the car seat with the bottom front of your infant car seat base resting on the child tray

Step 5: Wrap the extensions strap over the infant seat and connect to the other side of the lap-belt.

Step 6: Tighten the extension strap as needed.



DO NOT USE the Urban Advantage™ until you read and understand these instructions. Your child's safety depends on you reading and following these instructions.

 **WARNING: NEVER LEAVE CHILD UNATTENDED. AVOID SERIOUS INJURY FROM FALLING OR SLIDING OUT. ALWAYS USE 5-POINT HARNESS.**

By far, the most common injury reported for carriages and strollers resulted when a child fell or climbed out of a stroller because the restraint system was not being used. Please observe this safety warning at all times and be sure to follow the instructions on how to properly secure your child in the stroller.

 **WARNING: TO AVOID INJURY, ALWAYS USE THE BRAKE ACTIVATED KICKSTAND WHEN STROLLER IS PARKED.**

Ensure that the combination brake & kickstand is on when loading and unloading children. We designed the brake-activated kickstand because we had the unfortunate experience of accidentally knocking over a similar stroller when it was parked in our kitchen. The brake is absolutely necessary to use when parked and the kickstand provides added stability. Please use it whenever the stroller is parked or you are not holding the handle.

 **WARNING: TO AVOID INJURY, KEEP CHILD AWAY FROM SPRING ACTIVATED KICKSTAND.**

The kickstand is spring activated and the legs spring up under force. The motion could injure a child if spring mechanism was activated with a child nearby. Also, a child could pinch or lacerate their fingers if they got caught between the kickstand leg and the stroller frame. IT IS NOT A TOY! Please keep child away from the kickstand at all times.

 **WARNING: THIS IS NOT A JOGGING STROLLER. POWER WALKING IS OK, BUT DO NOT USE** this product while running, jogging, in-line skating or participating in other athletic activities.

 **WARNING: CHILD MAY SLIP INTO LEG OPENING AND STRANGLE. NEVER USE IN RECLINED POSITION UNLESS FOOT RETAINER IS IN UPRIGHT POSITION.**

The U.S. Consumer Product Safety Commission (CPSC) warns that babies can die if they are left unattended to sleep in strollers. They may slip feet first through the leg opening, and become entrapped by the head between the seat and hand rest bar, or child tray. When used in the reclined position, please be sure to re-adjust the restraint system securely AND raise the "foot retainer" as shown in the instructions.

 **WARNING: NO PARCEL BAGS OR RACKS ARE PROVIDED WITH THE PRODUCT.**

 **WARNING: STROLLER MAY BECOME UNSTABLE IF ANY PARCEL BAGS OR RACKS, NOT APPROVED BY THE MANUFACTURER, ARE USED.**

 **WARNING: STROLLER WILL BECOME UNSTABLE IF THE RECOMMENDED LOAD IS EXCEEDED.**

 **WARNING: CARE MUST BE TAKEN WHEN FOLDING AND UNFOLDING THE PRODUCT, TO PREVENT FINGER ENTRAPMENT.**

 **WARNING: ONLY USE STROLLER WITH A CHILD LESS THAN 40 POUNDS AND LESS THAN 40" TALL.**

 **WARNING: STROLLER COULD TIP OVER AND CAUSE INJURY TO YOUR CHILD IF THE KICKSTAND IS NOT IN PLACE WHENEVER THE STROLLER IS PARKED.**

- Never use stroller on stairways or escalators.
- Do not use near an open fire or exposed flame.
- To avoid burns to your child, never put hot liquids in any trays or pockets.
- The stroller is designed to roll. The wrist strap helps you keep control.
- Do not place parcels or accessory items on the stroller canopy or handle.
- Do not put more than 3 pounds (1.362kg) in the parent tray or rear pockets.
- Do not put more than 10 pounds in the bottom storage basket.
- Do not use bottom storage basket as a child carrier.

At what age can a baby be placed in the Urban Advantage? Is it safe for infants?

The stroller seat is designed to recline into an almost horizontal position, and the footrest can be angled up so that a baby can lie safely in the stroller. The 5-point harness is short enough to fit around a baby. However, we do not recommend using the stroller with an infant younger than 6 weeks-old or placing an infant in the stroller while running, jogging, roller blading, roller-skating, or similar activities. The main concern is the baby's neck muscles and head control, and the size and development of the baby. Because each baby develops differently, you and your doctor should make final decisions.

How far can the seat back be raised? What type of mechanism is used to adjust the seat?

The stroller has a four-position reclining seat back, adjusting from nearly horizontal to almost vertical. It is adjusted with a bar. However, when using the most vertical position, you may need to re-position some of the canopy fabric out of the way. A useful alternative technique for the vertical position is to pull forward on the seat rest from the inside of the stroller, and lock it into position.

Do you have a car seat that fits in the stroller?

You may use most of the infant car seats on the market with the stroller as a travel system. We recommend the Graco Snug Ride and the Britax Companion infant car seats because of the secure fit with the Urban Advantage. We have an extension strap that connects to the 5-point harness. It goes over the top of the infant car seats for added safety. It is located in the basket below the seat.

Do you have a rain cover for the Urban Advantage?

Yes, you can order it on-line if your dealer doesn't have one available.

Can I wash the fabric?

The seat fabric is easy to remove and may be washed on a gentle cycle.

Is the Urban Advantage a lightweight or heavyweight stroller?

The Urban Advantage is a medium weight stroller, it weights 27 pounds. The general range is 22 to 35 pounds. The Urban Advantage has an iron frame. It is strong and sturdy. We chose a heavier frame for its durability. In addition, all the amenities on the stroller contribute to the weight. The child tray and the parent tray each weigh 1 pound, the basket weighs almost two pounds and the pneumatic tires weigh over a pound each.

What should I do if I need a part for my Go-Go Babyz product?

Please visit our web site for spare parts or call us at 888.686.2552.

Can I jog with the Urban Advantage Stroller?

The Urban Advantage is not a "jogging" stroller. However, it is perfect for the fast walker or that long walk in the neighborhood. You can decide if you like the front wheel locked or unlocked depending upon where you walk.

Can you attach a ride along to the stroller?

At this time, we do not recommend any ride along accessories for the Urban Advantage.

What is the child weight limit on the stroller?

The weight limit for a child in the Urban Advantage is 40 lbs.

Why should I register my product?

By registering your product, Go-Go Babyz will automatically notify you regarding issues related to this product. In other words, this is the only way we can contact you in the future for any unforeseen product recalls. This is VERY IMPORTANT for the safety of your child!

We will keep the product name and date of your purchase on file for referencing your warranty information.

My stroller seems to pull and lean to one side.

If your stroller is leaning to one side, please make sure the axle is completely inserted and “snapped” into each side of the stroller frame. Make sure the safety pins on both sides of the front wheel are properly installed in matching holes in the frame.

The brake-bar on the Urban Advantage stroller seems tight. Is this normal?

Yes, the kickstand comes down and is locked into place when you step on the brake-bar. This takes some additional force. It is normal and will take less force after some use. There is an adjusting-screw on the cable near the brake-bar. Turning the adjusting-screw clockwise reduces the amount of force required to extend the kickstand. Adjust the screw for the least amount of tension that still allows the kickstand legs to remain in the vertical position.

The cable can also be adjusted in the front by loosening the locking nuts, pulling cable forward and retightening the nuts.

Should the kickstand touch the ground?

No. The kickstand should be about ½ inch above the ground when assembled correctly. This leaves room for varying weight of children and eliminated any scraping on the ground when being activated or deactivated.

My child is very tall for his age, and the top flap bothers him. Can we remove it?

The flap is a safety precaution for use with infants when the seat back is in the horizontal position. You can simply fold over the flap when the seat back is in the upper positions. If you are sure the stroller will not be used with an infant, you can remove it entirely with scissors. However, be sure you remove only the flap and do not cut the threads below.

I cannot lock my stroller in the collapsed position.

If the hook is at all bent out, it does not stay securely connected and will pop open. Our suggestion is to push the hook in toward the stroller a little (it is not difficult to bend the metal). The best way to do that would be to swivel the hook so it is away from the frame and then push it in.

My stroller arrived and there is no strap for the infant seat?

The strap is included in the diaper basket along with the Operating Manual and air pump.

After the first hour of use, the stroller should be checked to ensure that it was assembled correctly and that all parts and fasteners are secure. Make sure the front wheel is tight on the fork, the 2 safety pins on both sides of the front wheel are properly installed in matching holes of the stroller frame, and the lever is closed tightly. Pull horizontally on the rear wheels to ensure the locking mechanism is in place. Check that rear axle is secure. Check that the parent tray and child tray are secure.

Periodically check for worn parts, loose screws, torn materials, or loose stitching.

Replace any damaged parts immediately.

Clean metal parts with a damp cloth and wipe dry.

Brush off loose dirt after each use.

Clean vinyl with mild soap and water solution then air dry.

Remove seat cushion to wash on gently cycle.

When using dryer, make sure the setting is set to delicate.

Do not store unit outside exposed to rain or extreme sunlight.

Do not place heavy items on top of stroller when storing it.

Thank you!

Thank you for your recent order. We wish you many happy travels with your new Urban Advantage® Stroller!

Our goal for Go-Go Babyz is to offer innovative, high quality and safe products to make life easier when you and your baby are “on the go.”

We welcome suggestions and comments. Go-Go Babyz is dedicated to making our current products and features easier to use. Please send ideas for new features, products or general feedback to us at info@gogobabyz.com.

In addition, we have created a photo gallery on our web site for families, like us, using Go-Go Babyz products. Please feel free to email or mail us any photos of you and your children using our products and we would be happy to share them on our Family Photo Gallery page.

Thank you again for your purchase. We appreciate your business.

Sincerely,

The Go-Go Babyz Family

Toll Free: 888.686.2552

www.gogobabyz.com

