

# JVC

## DIGITAL VIDEO CAMERA

# GR-D790U

For Accessories:

<http://www.jvc.co.jp/english/accessory/>

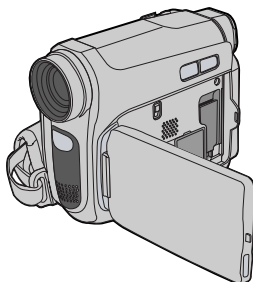

Mini **DV** NTSC



*MultiMediaCard*

**Dear Customer,**

Thank you for purchasing this digital video camera. Before use, please read the safety information and precautions contained in the pages 3 – 5 to ensure safe use of this product.

**ENGLISH**

**GETTING STARTED 7**

**RECORDING & PLAYBACK 18**

**DIGITAL STILL CAMERA  
(D.S.C.) RECORDING &  
PLAYBACK 26**

**ADVANCED FEATURES 31**

**REFERENCES 46**

**TERMS 52**

**For Customer Use:**

Enter below the Model No. and Serial No. which is located on the bottom of the camcorder. Retain this information for future reference.

**Model No.** \_\_\_\_\_

**Serial No.** \_\_\_\_\_

To deactivate the demonstration, set "DEMO MODE" to "OFF".  
(☞ pg. 31, 34)

**ENGLISH**

## INSTRUCTIONS

LYT1643-001A

## Major Features of this Camcorder

### Wipe/Fader Effects

You can use the Wipe/Fader Effects to make pro-style scene transitions.

(☞ pg. 40)

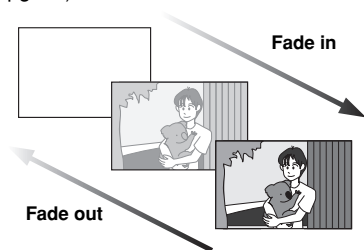

### Program AE, Effects and Shutter Effects

For example, "SPORTS" mode allows fast-moving images to be captured one frame at a time, for vivid, stable slow-motion.

(☞ pg. 41)



### LED Light

You can brighten the subject in the dark place with the LED Light.

(☞ pg. 36)

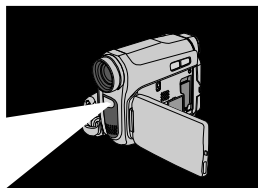

### Backlight Compensation

Simply pressing the  button brightens the image darkened by backlight. (☞ pg. 39)

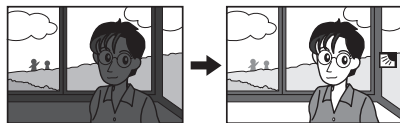

### Data Battery

You can check the battery status by simply pressing the **DATA** button. (☞ pg. 14)

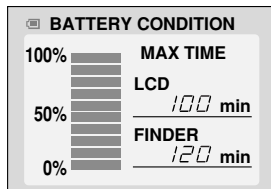

### Live Slow

You can record and play back precious or hard-to-see moments at a slow speed. The sound is recorded and played back in real time. (☞ pg. 36)

### Auto Button

You can change the recording mode between manual setting to the standard mode setting of the camcorder by pressing the **AUTO** button. (☞ pg. 20)

### Dual Rec.

You can capture and view still images without disturbing the recording in progress. (☞ pg. 20)

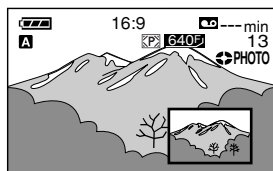

## Read This First!

- **Before recording important video, be sure to make a trial recording.**

Play back your trial recording to make sure the video and audio have been recorded properly.

- **We recommend cleaning your video heads before use.**

If you haven't used your camcorder for awhile, the heads may be dirty. We recommend periodically cleaning the video heads with a cleaning cassette (optional).



- **Be sure to store your cassette tapes and camcorder in the proper environment.**

Video heads can become dirty more easily if your cassette tapes and camcorder are stored in a dusty area. Cassette tapes should be removed from the camcorder and stored in cassette cases. Store the camcorder in a bag or other container.

- **Use SP (Standard) mode for important video recordings.**

LP (Long Play) mode lets you record 50% more video than SP (Standard) mode, but you may experience mosaic-like noise during playback depending on the tape characteristics and the usage environment.

So, for important recordings, we recommend using SP mode.

- **For safety and reliability.**

It is recommended only genuine JVC batteries and accessories are used in this camcorder.

- **This product includes patented and other proprietary technology and will operate only with JVC Data Battery. Use the JVC BN-VF808U/VF815U/VF823U battery packs.**

Using generic non-JVC batteries can cause damage to the internal charging circuitry.

- **This camcorder is designed exclusively for the digital video cassette, SD Memory Card and MultiMediaCard. Only cassettes marked "Mini DV" and memory cards marked "SD" or "MultiMediaCard" can be used with this unit.**

- **SDHC Memory Card cannot be used with this camcorder.**

- **Remember that this camcorder is not compatible with other digital video formats.**

- **It is recommended that you use JVC brand cassette tapes.**

Your camcorder is compatible with all brands of commercially available cassette tapes complying with the MiniDV standard, but JVC brand cassette tapes are designed and optimized to maximize the performance of your camcorder.

- **Remember that this camcorder is intended for private consumer use only.**

Any commercial use without proper permission is prohibited. (Even if you record an event such as a show, performance or exhibition for personal enjoyment, it is strongly recommended that you obtain permission beforehand.)

- **DO NOT** leave the unit

- in place of over 50°C (122°F)
- in place where humidity is extremely low (below 35%) or extremely high (80%).
- in direct sunlight.
- in a closed car in summer.
- near a heater.

- **The LCD monitor is made with high-precision technology. However, black spots or bright spots of light (red, green or blue) may appear constantly on the LCD monitor. These spots are not recorded on the tape. This is not due to any defect of the unit. (Effective dots: more than 99.99%)**

- **Do not leave the battery pack attached when the camcorder is not in use and check the unit regularly whether it is working or not.**

Also read "CAUTIONS" on pages 48 – 50.

- Microsoft® and Windows® are either registered trademarks or trademarks of Microsoft Corporation in the United States and/or other countries.
- Macintosh is a registered trademark of Apple Computer, Inc.
- QuickTime is a registered trademark of Apple Computer, Inc.

## SAFETY PRECAUTIONS

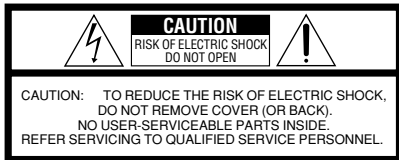

The lightning flash with arrowhead symbol, within an equilateral triangle, is intended to alert the user to the presence of uninsulated "dangerous voltage" within the product's enclosure that may be of sufficient magnitude to constitute a risk of electric shock to persons.



The exclamation point within an equilateral triangle is intended to alert the user to the presence of important operating and maintenance (servicing) instructions in the literature accompanying the appliance.

**WARNING: TO PREVENT FIRE OR SHOCK HAZARD, DO NOT EXPOSE THIS UNIT TO RAIN OR MOISTURE.**

### CAUTIONS:

- This camcorder is designed to be used with NTSC-type color television signals. It cannot be used for playback with a television of a different standard. However, live recording and LCD monitor/viewfinder playback are possible anywhere.
- This product includes patented and other proprietary technology and will operate only with JVC Data Battery. Use the JVC BN-VF808U/VF815U/VF823U battery packs and, to recharge them or to supply power to the camcorder from an AC outlet, use the provided multi-voltage AC Adapter. (An appropriate conversion adapter may be necessary to accommodate different designs of AC outlets in different countries.)

This product contains a CR Coin Cell Lithium Battery which contains Perchlorate Material - special handling may apply.  
See [www.dtsc.ca.gov/hazardouswaste/perchlorate](http://www.dtsc.ca.gov/hazardouswaste/perchlorate)

### Caution on Replaceable lithium battery

The battery used in this device may present a fire or chemical burn hazard if mistreated. Do not recharge, disassemble, heat above 100°C (212°F) or incinerate.

Replace battery with Panasonic (Matsushita Electric), Sanyo, Sony or Maxell CR2025. Danger of explosion or Risk of fire if the battery is incorrectly replaced.

- Dispose of used battery promptly.
- Keep away from children.
- Do not disassemble and do not dispose of in fire.

### NOTES:

- The rating plate (serial number plate) and safety caution are on the bottom and/or the back of the main unit.
- The rating information and safety caution of the AC Adapter are on its upper and lower sides.

When the equipment is installed in a cabinet or on a shelf, make sure that it has sufficient space on all sides to allow for ventilation (10 cm (3-15/16") or more on both sides, on top and at the rear).

Do not block the ventilation holes.

(If the ventilation holes are blocked by a newspaper, or cloth etc. the heat may not be able to get out.)

No naked flame sources, such as lighted candles, should be placed on the apparatus.

When discarding batteries, environmental problems must be considered and the local rules or laws governing the disposal of these batteries must be followed strictly.

The apparatus shall not be exposed to dripping or splashing.

Do not use this equipment in a bathroom or places with water.

Also do not place any containers filled with water or liquids (such as cosmetics or medicines, flower vases, potted plants, cups etc.) on top of this unit.

(If water or liquid is allowed to enter this equipment, fire or electric shock may be caused.)

Do not point the lens or the viewfinder directly into the sun. This can cause eye injuries, as well as lead to the malfunctioning of internal circuitry. There is also a risk of fire or electric shock.

### CAUTION!

The following notes concern possible physical damage to the camcorder and to the user.

When carrying, be sure to always securely attach and use the provided strap. Carrying or holding the camcorder by the viewfinder and/or the LCD monitor can result in dropping the unit, or in a malfunction.

Take care not to get your finger caught in the cassette holder cover. Do not let children operate the camcorder, as they are particularly susceptible to this type of injury.

Do not use a tripod on unsteady or unlevel surfaces. It could tip over, causing serious damage to the camcorder.

### CAUTION!

Connecting cables (Audio/Video, S-Video, etc.) to the camcorder and leaving it on top of the TV is not recommended, as tripping on the cables will cause the camcorder to fall, resulting in damage.

## IMPORTANT SAFETY INSTRUCTIONS

1. Read these instructions.
2. Keep these instructions.
3. Heed all warnings.
4. Follow all instructions.
5. Do not use this apparatus near water.
6. Clean only with dry cloth.
7. Do not block any ventilation openings. Install in accordance with the manufacturer's instructions.
8. Do not install near any heat sources such as radiators, heat registers, stoves, or other apparatus (including amplifiers) that produce heat.
9. Only use attachments/accessories specified by the manufacturer.
10. Use only with the cart, stand, tripod, bracket, or table specified by the manufacturer, or sold with the apparatus. When a cart is used, use caution when moving the cart/apparatus combination to avoid injury from tip-over.
11. Unplug this apparatus during lightning storms or when unused for long periods of time.
12. Refer all servicing to qualified service personnel. Servicing is required when the apparatus has been damaged in any way, such as power-supply cord or plug is damaged, liquid has been spilled or objects have fallen into the apparatus, the apparatus has been exposed to rain or moisture, does not operate normally, or has been dropped.



## Cleaning The Camcorder

Before cleaning, turn off the camcorder and remove the battery pack and AC Adapter.

### To clean the exterior

Wipe gently with a soft cloth. Put the cloth in diluted mild soap and wring it well to wipe off heavy dirt. Then wipe again with a dry cloth.

### To clean the LCD monitor

Wipe gently with a soft cloth. Be careful not to damage the monitor. Close the LCD monitor.

### To clean the lens

Blow it with a blower brush, then wipe gently with lens cleaning paper.

### To clean the viewfinder lens

Remove dust from the viewfinder using a blower brush.

### NOTES:

- Avoid using strong cleaning agents such as benzine or alcohol.
- Cleaning should be done only after the battery pack has been removed or other power units have been disconnected.
- Mold may form if the lens is left dirty.
- When using a cleaner or chemically treated cloth refer to the cautions of each product.
- To clean the viewfinder, please consult your nearest JVC dealer.

### USE CLEANING CASSETTE

Appears if dirt is detected on the heads during recording. Use an optional cleaning cassette (▶ pg. 3).

<b>GETTING STARTED</b> .....	<b>7</b>	<b>ADVANCED FEATURES</b> .....	<b>31</b>
Regarding This Manual .....	7	<b>MENUS FOR DETAILED ADJUSTMENT</b> .....	<b>31</b>
Provided Accessories .....	7	Changing The Menu Settings.....	31
Index .....	8	Recording Menus .....	32
Grip Adjustment.....	12	Playback Menus.....	35
Power .....	13	<b>FEATURES FOR RECORDING</b> .....	<b>36</b>
Language Settings.....	14	LED Light .....	36
Date/Time Settings .....	15	Live Slow .....	36
Viewfinder Adjustment.....	15	Snapshot (Record Still Image On Tape) .....	37
Brightness Adjustment Of The Display.....	15	Manual Focus.....	37
Tripod Mounting.....	15	Exposure Control .....	38
Loading/Unloading A Cassette .....	16	Iris Lock.....	38
Loading/Unloading A Memory Card .....	17	Backlight Compensation .....	39
16:9 Wide Mode .....	17	Spot Exposure Control .....	39
<b>RECORDING &amp; PLAYBACK</b> .....	<b>18</b>	White Balance Adjustment.....	39
<b>VIDEO RECORDING</b> .....	<b>18</b>	Manual White Balance Adjustment .....	40
Basic Recording .....	18	Wipe Or Fader Effects.....	40
Tape Remaining Time .....	18	Program AE, Effects And Shutter Effects....	41
Quick Review.....	18	Dubbing Still Images Recorded On A Tape To A Memory Card.....	42
Zooming.....	19	<b>EDITING</b> .....	<b>42</b>
Journalistic Shooting .....	19	Dubbing To A VCR.....	42
Interface Shooting .....	19	Dubbing To Or From A Video Unit Equipped With A DV Connector (Digital Dubbing) ..	43
Time Code.....	20	Connection To A Personal Computer .....	44
Recording From The Middle Of A Tape.....	20	Audio Dubbing.....	45
Dual Rec .....	20	Insert Editing .....	45
Auto/Manual Mode .....	20	<b>REFERENCES</b> .....	<b>46</b>
<b>VIDEO PLAYBACK</b> .....	<b>21</b>	<b>TROUBLESHOOTING</b> .....	<b>46</b>
Normal Playback .....	21	<b>CAUTIONS</b> .....	<b>48</b>
Still Playback.....	21	<b>SPECIFICATIONS</b> .....	<b>51</b>
Variable Shuttle Search.....	22	<b>TERMS</b> .....	<b>52</b>
Blank Search .....	22		
Playback Snapshot.....	22		
Connections To A TV Or VCR.....	23		
Playback Using The Remote Control .....	24		
<b>D.S.C. RECORDING</b> .....	<b>26</b>		
Basic Shooting (D.S.C. Snapshot) .....	26		
<b>D.S.C. PLAYBACK</b> .....	<b>27</b>		
Normal Playback Of Images.....	27		
Auto Playback Of Images .....	27		
Index Playback Of Files.....	27		
Removing On-Screen Display .....	27		
<b>ADDITIONAL FEATURES FOR D.S.C.</b> .....	<b>28</b>		
Resetting The File Name.....	28		
Protecting Files.....	28		
Deleting Files.....	29		
Setting Print Information (DPOF Setting)* ..	29		
Initializing A Memory Card.....	30		

## Regarding This Manual

### Control Lever

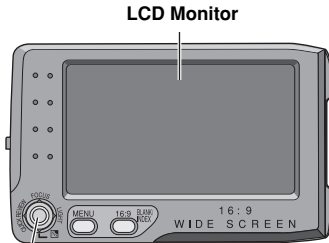

Control lever

There are two kinds of operation using the control lever: moving the lever towards up/down/left/right, or pressing down the lever. They are described and illustrated as shown below.

1) Move the control lever up/down/left/right (▲/▼/◀/▶) to select:



Operation	To select
▲	▶/   FOCUS Move the control lever up.
▼	■ □ Move the control lever down.
▶	▶▶ LIGHT Move the control lever right.
◀	◀◀ QUICK REVIEW Move the control lever left.

2) Press down the control lever to select **SET**:



## Provided Accessories

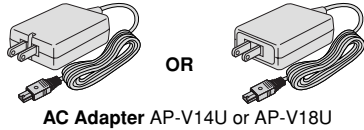

AC Adapter AP-V14U or AP-V18U



Battery Pack  
BN-VF808U

Audio/Video Cable  
(ø3.5 mini-plug to RCA plug)

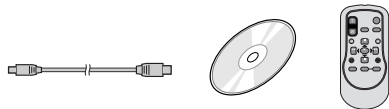

USB Cable

CD-ROM

Remote Control Unit  
RM-V740U



Lithium Battery  
CR2025\*  
(for remote control unit)



Shoulder Strap  
(☞ pg. 12)



Lens Cap  
(☞ pg. 12)

\* A lithium battery is pre-installed in the Remote Control Unit at time of shipment (with insulation sheet). To use the Remote Control Unit, remove the insulation sheet.

### NOTES:

- In order to maintain optimum performance of the camcorder, provided cables may be equipped with one or more core filter. If a cable has only one core filter, the end that is closest to the filter should be connected to the camcorder.
- Make sure to use the provided cables for connections. Do not use any other cables.

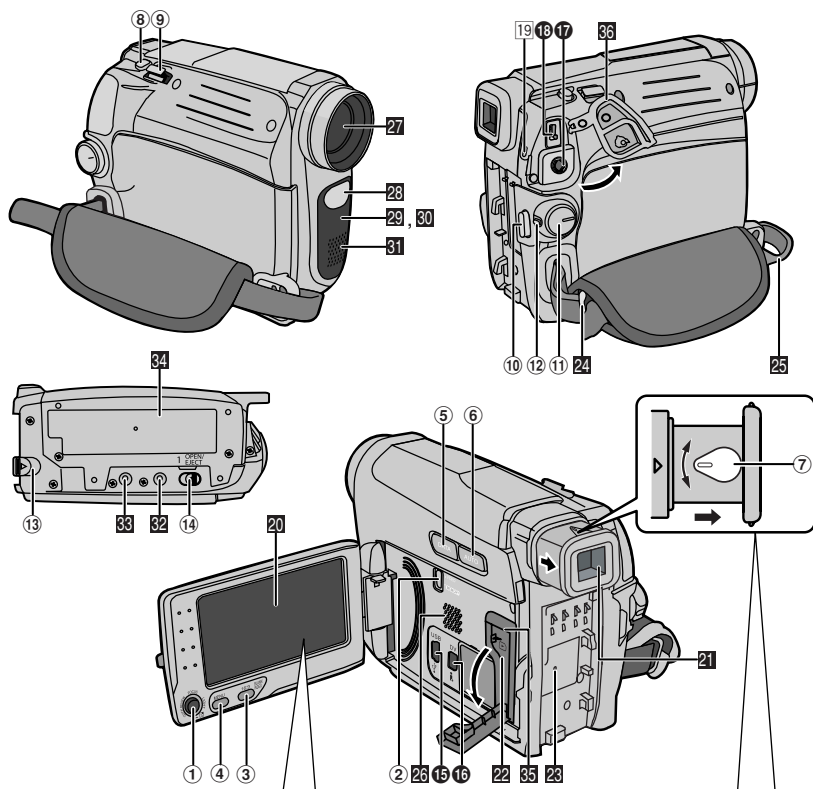
**Index****How to open the LCD monitor**

Pull on the end (A) of the LCD monitor.

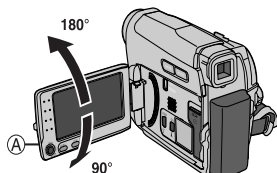

The LCD monitor can rotate 270°.

**Power-linked operation**

When the power switch is set to "REC", you can also turn the camcorder on/off by opening/closing the LCD monitor or pulling out/pushing in the viewfinder.

**NOTES:**

- The image will not appear simultaneously on the LCD monitor and the viewfinder. When the viewfinder is pulled out while the LCD monitor is opened, you can select which one to use. Set "PRIORITY" to the desired mode in SYSTEM Menu. (→ pg. 34)
- Colored bright spots may appear all over the LCD monitor or the viewfinder. However, this is not a malfunction.



## Controls

- ① < : Left/Rewind (◀◀) (☞ pg. 21)/  
Quick Review [QUICK REVIEW] (☞ pg. 18)  
> : Right/Fast-Forward (▶▶) (☞ pg. 21)/  
LED Light [LIGHT] (☞ pg. 36)  
^ : Up/Play/Pause (▶/||) (☞ pg. 21)/  
Manual Focus [FOCUS] (☞ pg. 37)  
v : Down/Stop (■) (☞ pg. 21)/  
Backlight Compensation [BLC] (☞ pg. 39)/  
Spot Exposure (☞ pg. 39)  
Press down : SET
- ② VIDEO/MEMORY Switch
- ③ 16:9 Wide Screen Button [16:9] (☞ pg. 17)  
Blank Search [BLANK] (☞ pg. 22)  
Index Button [INDEX] (☞ pg. 27)
- ④ Menu Button [MENU] (☞ pg. 31)
- ⑤ Data Battery Button [DATA] (☞ pg. 14)
- ⑥ Auto Button [AUTO] (☞ pg. 20)
- ⑦ Diopter Adjustment Control (☞ pg. 15)
- ⑧ Snapshot Button [SNAPSHOT]  
(☞ pg. 26, 33, 37)  
Live Slow Button [SLOW] (☞ pg. 33, 36)
- ⑨ Power Zoom Lever [T/W] (☞ pg. 19)  
Speaker Volume Control [VOL. +, -]  
(☞ pg. 21)
- ⑩ Recording Start/Stop Button [START/STOP]  
(☞ pg. 18)
- ⑪ Power Switch [REC, PLAY, OFF]
- ⑫ Lock Button
- ⑬ Battery Release Button [BATT.] (☞ pg. 13)
- ⑭ Cassette Open/Eject Switch [OPEN/EJECT]  
(☞ pg. 16)

## Connectors

- ⑮ USB (Universal Serial Bus) Connector  
(☞ pg. 44)
- ⑯ Digital Video Connector [DV IN/OUT]  
(i.LINK\*) (☞ pg. 43, 44)
- \* i.LINK refers to the IEEE1394-1995 industry specification and extensions thereof. The  logo is used for products compliant with the i.LINK standard.

The connectors are located beneath the covers.

- ⑰ Audio/Video Output Connector [AV]  
(☞ pg. 23, 42)
- ⑱ DC Input Connector [DC] (☞ pg. 13)

## Indicators

- ⑲ POWER/CHARGE Lamp (☞ pg. 13)

## Other Parts

- ⑳ LCD Monitor (☞ pg. 8)
- ㉑ Viewfinder (☞ pg. 15)
- ㉒ Card Cover [☞] (☞ pg. 17)
- ㉓ Battery Pack Mount (☞ pg. 13)
- ㉔ Shoulder Strap Eyelet (☞ pg. 12)
- ㉕ Grip Strap (☞ pg. 12)
- ㉖ Speaker (☞ pg. 21)
- ㉗ Lens
- ㉘ LED Light (☞ pg. 36)
- ㉙ Camera Sensor  
(Be careful not to cover this area, a sensor necessary for shooting is built-in here.)
- ㉚ Remote Sensor (☞ pg. 24, 25)
- ㉛ Stereo Microphone
- ㉜ Stud Hole (☞ pg. 15)
- ㉝ Tripod Mounting Socket (☞ pg. 15)
- ㉞ Cassette Holder Cover (☞ pg. 16)
- ㉟ Memory Card Slot
- ㊱ Connector Cover

### Power Switch Position

#### REC:

To perform recording on the tape or in the memory card.

#### OFF:

To switch off the camcorder.

#### PLAY:

- To play back a recording on the tape.
- To display a still image stored in the memory card or to transfer a still image stored in the memory card to a PC.

### VIDEO/MEMORY Switch Position

#### VIDEO:

To record on a tape or play back a tape.

#### MEMORY:

To record in a memory card or access data stored in a memory card.

## LCD Monitor/Viewfinder Indications

### During Video Recording Only

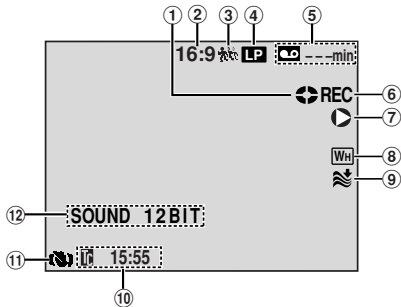

- ① Tape Running Indicator  
(Rotates while tape is running.)
- ② Selected Wide Mode Indicator (⇨ pg. 17)  
(only 16:9 indicator is displayed)
- ③ Live Slow Indicator (⇨ pg. 36)
- ④ Recording Speed Mode (SP/LP) (⇨ pg. 33)  
(only LP indicator is displayed)
- ⑤ Tape Remaining Time (⇨ pg. 18)
- ⑥ REC: (Appears during recording.)  
(⇨ pg. 18)  
SLOW: (Appears when using Live Slow.)  
(⇨ pg. 36)
- ⑦ c : Insert (⇨ pg. 45)  
IIc : Insert Pause
- ⑧ Selected Wipe/Fader Effect Indicator  
(⇨ pg. 40)
- ⑨ Wind Cut Indicator (⇨ pg. 33)
- ⑩ Time Code (⇨ pg. 34)
- ⑪ Digital Image Stabilizer ("DIS") (⇨ pg. 32)  
(only DIS indicator is displayed)
- ⑫ SOUND 12BIT/16BIT: Sound Mode  
Indicator (⇨ pg. 33) (Appears for approx. 5  
seconds after turning on the camcorder.)

### During Both Video And D.S.C. Recording

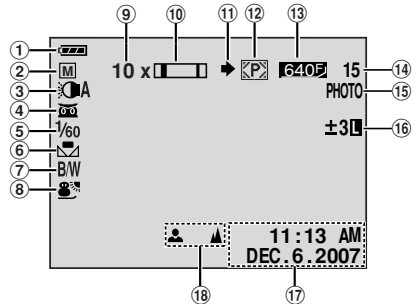

- ① Battery Remaining Power Indicator
- ② Operation Mode (⇨ pg. 20)  
A : Auto Mode  
M : Manual Mode
- ③ LED Light Indicator (⇨ pg. 36)
- ④ Night Alive Indicator (⇨ pg. 41)  
A : Gain Up Mode (⇨ pg. 33)
- ⑤ Shutter Speed (⇨ pg. 41)
- ⑥ White Balance Indicator (⇨ pg. 39)
- ⑦ Selected Effect Indicator (⇨ pg. 41)
- ⑧ Selected Program AE Indicator (⇨ pg. 41)
- ⑨ Approximate Zoom Ratio (⇨ pg. 19)
- ⑩ Zoom Indicator (⇨ pg. 19)
- ⑪ Shooting Icon  
(Appears and blinks during shooting.)
- ⑫ Card Icon (⇨ pg. 26)  
P : Appears during shooting.  
M : Blinks in white when a memory card is  
not loaded.
- ⑬ Image Size/Picture Quality: 640P 640 x 480 F  
640S (FINE) and 640 x 480 S 640S  
(STANDARD) (in order of quality) (⇨ pg. 33)
- ⑭ Remaining Number Of Shots (⇨ pg. 26)  
(Displays the approximate remaining  
number of shots that can be stored during  
D.S.C. recording.)
- ⑮ PHOTO: (Appears when taking Snapshot.)  
(⇨ pg. 26, 37)
- ⑯ Spot Exposure Control Indicator  
(⇨ pg. 39)  
P : Backlight Compensation Indicator  
(⇨ pg. 39)  
±: Exposure Adjustment Indicator  
(⇨ pg. 38)  
I : Iris Lock Indicator (⇨ pg. 38)
- ⑰ Date/Time (⇨ pg. 15)
- ⑱ Manual Focus Adjustment Indicator  
(⇨ pg. 37)

## During Video Playback

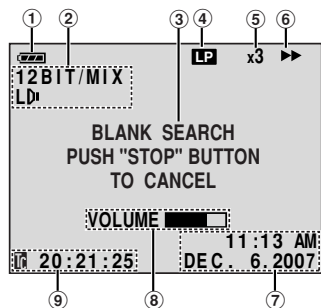

- ① Battery Remaining Power Indicator
- ② Sound L/R Indicator (⇄ pg. 35)
- ③ Blank Search Indicator (⇄ pg. 22)
- ④ Tape Speed (SP/LP) (⇄ pg. 35)  
(only LP indicator is displayed)
- ⑤ Variable Search Speed Indicator: x-10, x-3, x3 and x10 (⇄ pg. 22)
- ⑥ ▶: Playback
  - ▶▶: Fast-Forward/Shuttle Search
  - ◀◀: Rewind/Shuttle Search
  - ||: Pause
  - || ▶: Forward Frame-By-Frame Playback/Slow-Motion
  - ◀ ||: Reverse Frame-By-Frame Playback/Slow-Motion
  - ⊕: Audio Dubbing
  - || ⊕: Audio Dubbing Pause
- ⑦ Date/Time (⇄ pg. 35)
- ⑧ VOLUME: Volume Level Indicator (⇄ pg. 21)
- ⑨ Time Code (⇄ pg. 35)

## During D.S.C. Playback

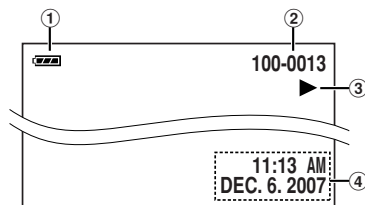

- ① Battery Remaining Power Indicator
- ② Folder/File Number
- ③ Operation Mode Indicator
- ④ Date/Time

## How To Attach The Lens Cap

To protect the lens, attach the provided lens cap to the camcorder as shown in the illustration.

### NOTE:

To confirm the lens cap is on correctly make sure the cap is flush to the camcorder.

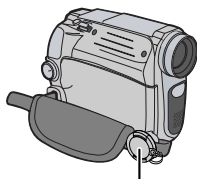

Place here during shooting.

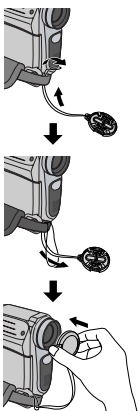

## Grip Adjustment

Open the pad and make grip adjustments.

- Before making the adjustment, remove any security tags that may be attached to the velcro.

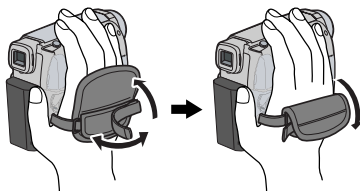

## How To Attach The Shoulder Strap

**1** Peel off the pad and thread the end of the strap through the eyelet.

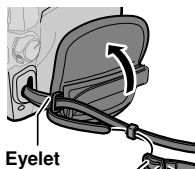

**2** Thread the strap through the buckle, adjust its length, and use the strap guide to fix it in place.

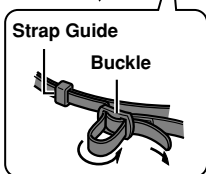

**3** Position the buckle near the eyelet and reattach the pad.

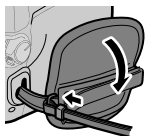

## Power

### Charging The Battery Pack

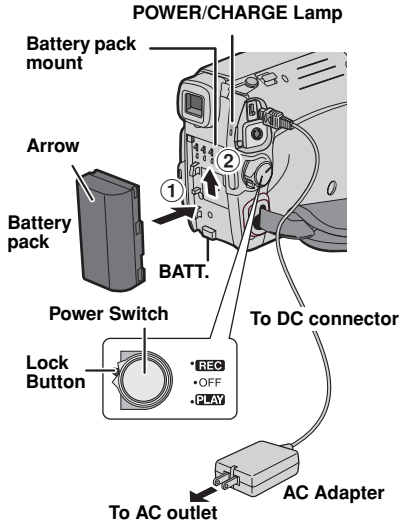

- 1** Set the Power Switch to "OFF".
- 2** With the arrow on the battery pack pointing upward, push the battery pack slightly against the battery pack mount **1**.
- 3** Slide up the battery pack until it locks in place **2**.
- 4** Plug the AC Adapter into an AC outlet.
- 5** Connect the AC Adapter to the camcorder.
  - The POWER/CHARGE lamp on the camcorder blinks to indicate charging has started.
  - When the POWER/CHARGE lamp goes out, charging is finished. Unplug the AC Adapter from the AC outlet. Disconnect the AC Adapter from the camcorder.

#### To detach the battery pack

Slide the battery pack downward while pressing **BATT.** to detach it.

Battery pack	Charging time
BN-VF808U*	Approx. 1 hr. 30 min.
BN-VF815U	Approx. 2 hrs. 40 min.
BN-VF823U	Approx. 3 hrs. 50 min.

\* Provided

#### NOTES:

- If the protective cap is attached to the battery pack, remove it first.
- During charging, the camcorder cannot be operated.
- Charging is not possible if the wrong type of battery is used.
- When charging the battery pack for the first time or after a long storage period, the POWER/CHARGE lamp may not light. In this case, remove the battery pack from the camcorder, then try charging again.
- If a fully charged battery pack is attached to the unit, POWER/CHARGE lamp will blink for approx. 10 seconds before it turns off.
- If the battery operation time remains extremely short even after having been fully charged, the battery is worn out and needs to be replaced. Please purchase a new one.
- Since the AC Adapter processes electricity internally, it becomes warm during use. Be sure to use it only in well-ventilated areas.
- After 5 minutes have elapsed in Record-Standby mode with the cassette inserted and no operation is performed, the camcorder will automatically turn off its power supplied from the AC adapter. In this case, the battery charge starts if the battery is attached to the camcorder.

#### About Batteries

**DANGER!** Do not attempt to take the batteries apart, or expose them to flame or excessive heat, as it may cause a fire or explosion.

**WARNING!** Do not allow the battery or its terminals to come in contact with metals, as this can result in a short circuit and possibly start a fire.

#### To restore the accuracy of the battery power indicator

If the battery power indication differs from the actual operating time, fully charge the battery, and then run it down. However this method may not work if the battery was used for a long period of time under extremely high/low temperature condition or charged too many times.

## 14 EN GETTING STARTED

### Using The Battery Pack

Perform steps **2 – 3** in “Charging The Battery Pack” (☞ pg. 13).

#### Maximum continuous recording time

Battery pack	LCD monitor on	Viewfinder on
BN-VF808U*	1 hr. 50 min.	2 hrs. 15 min.
BN-VF815U	3 hrs. 40 min.	4 hrs. 30 min.
BN-VF823U	5 hrs. 30 min.	6 hrs. 45 min.

\* Provided

#### NOTES:

- Recording time is reduced significantly under the following conditions:
  - Zoom or Record-Standby mode is engaged repeatedly.
  - The LCD monitor is used repeatedly.
  - The playback mode is engaged repeatedly.
  - The LED Light is used.
- Before extended use, it is recommended that you prepare enough battery packs to cover 3 times the planned shooting time.

#### ATTENTION:

Before detaching the power source, make sure that the camcorder's power is turned off. Failure to do so can result in a camcorder malfunction.

### Data Battery System

You can check the remaining battery power and the recordable time.

When the battery is attached, press **DATA**.

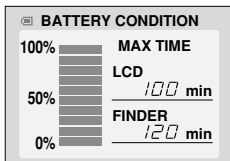

- When the Power Switch is set to “OFF”, it is displayed for approx. 3 seconds if the button is pressed and released quickly, and for approx. 15 seconds if the button is pressed and held for several seconds.
- When the Power Switch is set to “PLAY” or “REC”, press **DATA** again to return to the normal screen.
- Data battery status cannot be displayed during playback or while recording is in progress.

- If “COMMUNICATION ERROR” appears instead of the battery status even though you tried to press **DATA** several times, there may be a problem with your battery. In such a case, consult your nearest JVC dealer.

### Using AC Power

Perform step **4 – 5** in “Charging The Battery Pack” (☞ pg. 13).

#### NOTE:

The provided AC Adapter features automatic voltage selection in the AC range from 110 V to 240 V.

#### INFORMATION:

The following explanations in this manual suppose the use of LCD monitor in your operation. If you want to use the viewfinder, close the LCD monitor and pull out the viewfinder fully.

### Language Settings

The language on the display can be changed. (☞ pg. 34)

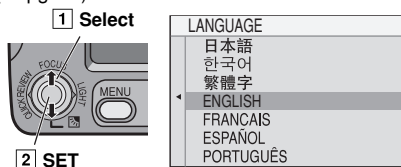

- Open the LCD monitor fully.
- Set the Power Switch to “REC” or “PLAY” while pressing down the Lock Button located on the switch.
  - If set to “REC”, the recording mode should be set to “**M**” (☞ pg. 20).
- Press **MENU**.
- Select “SYSTEM”, press **SET** or **>**.
- Select “LANGUAGE”, press **SET** or **>**.
- Select the desired language, press **SET** or **>**.
- Press **MENU**.

Press **<** whenever you want to return to the previous menu screen.

## Date/Time Settings

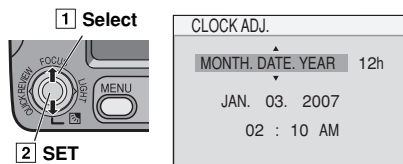

The date/time is recorded onto the tape at all times, but its display can be turned on or off.

(☞ pg. 34, 35)

Perform steps **1 – 3** in “Language Settings” (☞ pg. 14).

- 1** Select “DISPLAY”, press **SET** or **>**.
- 2** Select “CLOCK ADJ.”, press **SET** or **>**.
- 3** Select the desired date display format, press **SET** or **>**.
  - Repeat this step to input time display format (Select from “24h” or “12h”), month, date, year, hour and minutes.
- 4** Press **MENU**.

Press **<** whenever you want to return to the previous menu screen/setting.

## Viewfinder Adjustment

- 1** Set the Power Switch to “REC” while pressing down the Lock Button located on the switch.
- 2** Make sure the LCD monitor is closed and locked. Pull out the viewfinder fully.
- 3** Turn the Diopter Adjustment Control until the indications in the viewfinder are clearly focused.

Example:

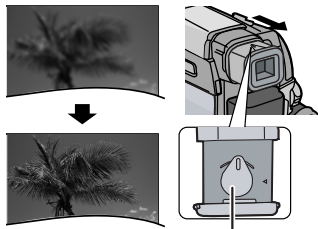

Diopter Adjustment Control

### CAUTION:

When retracting the viewfinder, take care not to pinch your fingers.

## Brightness Adjustment Of The Display

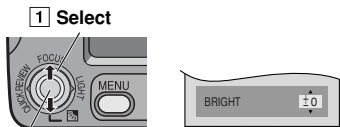

**2** SET

Perform steps **1 – 3** in “Language Settings” (☞ pg. 14).

- To adjust the brightness of the viewfinder, pull out the viewfinder fully and set “PRIORITY” to “FINDER” (☞ pg. 34).

- 1** Select “DISPLAY”, press **SET** or **>**.
- 2** Select “BRIGHT”, press **SET** or **>**.
- 3** Select the appropriate brightness, press **SET** or **>**.
- 4** Press **MENU**.

Press **<** whenever you want to return to the previous menu screen.

## Tripod Mounting

To attach the camcorder to a tripod, align the direction stud and screw to the mounting socket and stud hole on the camcorder. Then tighten the screw clockwise.

- Some tripods are not equipped with studs.

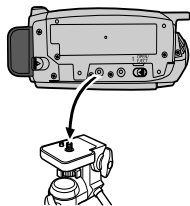

## Loading/Unloading A Cassette

The camcorder needs to be powered up to load or eject a cassette.

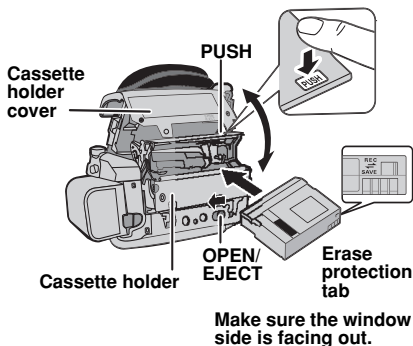

**1** Slide and hold **OPEN/EJECT** in the direction of the arrow, then pull the cassette holder cover open until it locks. The cassette holder opens automatically.

- Do not touch internal components.

**2** Insert or remove a tape and press “**PUSH**” to close the cassette holder.

- Be sure to press only the section labeled “**PUSH**” to close the cassette holder; touching other parts may cause your finger to get caught in the cassette holder, resulting in injury or product damage.
- Once the cassette holder is closed, it recedes automatically. Wait until it recedes completely before closing the cassette holder cover.
- When the battery pack’s charge is low, you may not be able to close the cassette holder cover. Do not apply force. Replace the battery pack with a fully charged one or use AC power before continuing.

**3** Close the cassette holder cover firmly until it locks into place.

### NOTES:

- If you wait a few seconds and the cassette holder does not open, close the cassette holder cover and try again. If the cassette holder still does not open, turn the camcorder off then on again.
- If the tape does not load properly, open the cassette holder cover fully and remove the cassette. A few minutes later, insert it again.

- When the camcorder is suddenly moved from a cold place to a warm environment, wait a short time before opening the cassette holder cover.



- Appears if a tape is loaded while the Power Switch is set to “**REC**”.
- Blinks when no tape is loaded.

### TAPE!

Appears if a tape is not loaded when the Recording Start/Stop Button or **SNAPSHOT** Button is pressed while the Power Switch is set to “**REC**” and the **VIDEO/MEMORY** Switch is set to “**VIDEO**”.

### CHECK TAPE’S ERASE PROTECTION TAB

Appears when the erase protection tab is set to “**SAVE**” while the Power Switch is set to “**REC**” and the **VIDEO/MEMORY** Switch is set to “**VIDEO**”. (☞ pg. 18)



## Loading/Unloading A Memory Card

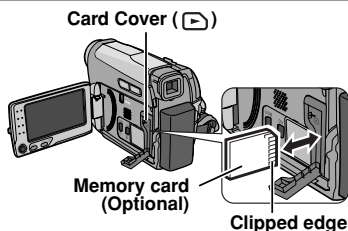

- 1 Make sure the camcorder's power is off.
- 2 Open the card cover (▶).
- 3 **To load a memory card**, firmly insert it with its clipped edge first.  
**To unload a memory card**, push it once. After the memory card comes out of the camcorder, pull it out.
  - Do not touch the terminal on the reverse side of the label.
- 4 Close the card cover.

### NOTES:

- Some brands of memory cards are not compatible with this camcorder. Before purchasing a memory card, consult its manufacturer or dealer.
- Before using a new memory card, it is necessary to format the card. (▶ pg. 30)

### PLEASE FORMAT

Appears when there is a problem with a memory card and its memory is corrupt, or it has not been initialized. Initialize the memory card. (▶ pg. 30)

### CARD ERROR!

Appears when the camcorder does not recognize the loaded memory card. Remove the memory card once and insert it again. Repeat these procedures until no indication appears. If the indication still appears, the memory card is corrupted.

## 16:9 Wide Mode

You can record videos at 4:3 size and 16:9 size. By default, the camera is set to record videos at the 16:9 size.

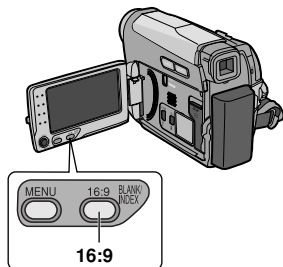

- 1 Set the Power Switch to "REC".
- 2 Set the **VIDEO/MEMORY** Switch to "VIDEO". Each press **16:9** switches the screen size.

On the LCD monitor:

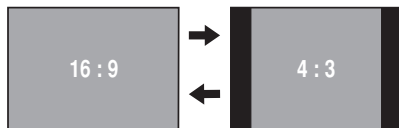

On the viewfinder:

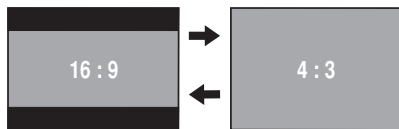

### NOTE:

If you record videos in 16:9 size, the image may appear to be slightly vertically stretched when playing back on TV with the 4:3 screen. (▶ pg. 34, 35)

## Basic Recording

### NOTE:

Before continuing, perform the procedures listed below:

- Power (☞ pg. 13)
- Loading A Cassette (☞ pg. 16)
- Remove the lens cap. (☞ pg. 12)
- Open the LCD monitor fully.
- Select videos at 4:3 size or 16:9 (wide) size. (☞ pg. 17)

### VIDEO/MEMORY

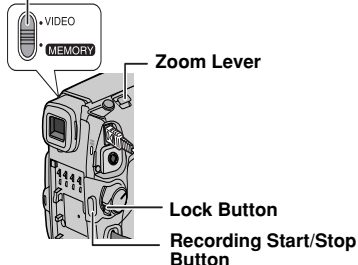

- 1 Set the **VIDEO/MEMORY** Switch to "VIDEO".
- 2 Set the Power Switch to "REC" while pressing down the Lock Button located on the switch.
- 3 Press **START/STOP** button to start recording. "REC" appears on the display while recording is in progress. To stop recording Press **START/STOP** again.

### Approximate recording time

Tape	Recording mode	
	SP	LP
30 min.	30 min.	45 min.
60 min.	60 min.	90 min.
80 min.	80 min.	120 min.

### NOTES:

- If the Record-Standby mode continues for 5 minutes and no operation is performed, the camcorder's power shuts off automatically. To turn the camcorder on again, push back and pull out the viewfinder again or close and re-open the LCD monitor.

- When a blank portion is left between recorded scenes on the tape, the time code is interrupted and errors may occur when editing the tape. To avoid this, refer to "Recording From The Middle Of A Tape" (☞ pg. 20).
- To record in LP (Long Play) mode, ☞ pg. 33.

### Tape Remaining Time

Approximate tape remaining time appears on the display. "--- min" means the camcorder is calculating the remaining time. When the remaining time reaches 2 minutes, the indication starts blinking.

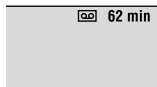

- The time required to calculate and display the remaining tape length, and the accuracy of the calculation, may vary according to the type of tape used.

### Quick Review

Enables to check the end of the last recording.

- 1) Press **QUICK REVIEW** during the Recording-Standby mode.
  - 2) Tape is rewound for about several seconds and played back automatically, then pauses in the Recording-Standby mode for the next shot.
- Distortion may occur at start of playback. This is normal.
  - Slide the Power Zoom lever repeatedly to change the sound setting to on/off.



## Zooming

### While recording

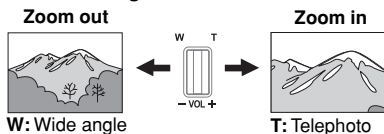

**W:** Wide angle

**T:** Telephoto

- You can zoom in up to 34X by using the optical zoom.
- Zoom magnification over 34X is done through digital image processing, and is therefore called digital zoom. Digital zooming is possible up to 900X. Set [ZOOM] to [68X] or [900X]. (☞ pg. 32)

### Optical zoom (up to 34X)



**Digital zoom (up to 900X)**

### NOTES:

- Macro shooting is possible as close as approx. 5 cm (2") to the subject when the zoom lever is set all the way to W.
- When you zoom into a subject close to the lens, the camera may automatically zoom out depending on the distance to the subject. In this case, set "TELE MACRO" to "ON". (☞ pg. 32)

## Journalistic Shooting

In some situations, different shooting angles may provide more dramatic results. Hold the camcorder in the desired position and tilt the LCD monitor in the most convenient direction. It can rotate 270° (90° downward, 180° upward).

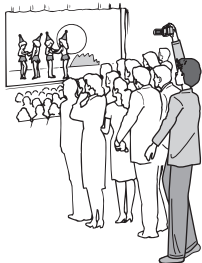

## Interface Shooting

The person you shoot can view himself/herself in the LCD monitor, and you can even shoot yourself while viewing your own image in the LCD monitor.



1) Open the LCD monitor and tilt it upward to 180° so that it faces forward.

Then, pull out the viewfinder fully.

2) Point the lens toward the subject (yourself when self-recording) and start recording.



- During Interface Shooting, the monitor image appears inverted as it would when viewing a mirror. However, the actual recorded image does not appear inverted.

• If the Quick Review (☞ pg. 18) is executed during the interface shooting, the LCD monitor will be turned off. In such a case, check the playback picture in the viewfinder.

- To check the playback picture in the LCD monitor, close the viewfinder.

## Time Code

During recording, a time code is recorded on the tape. This code is to confirm the location of the recorded scene on the tape during playback.

### Display

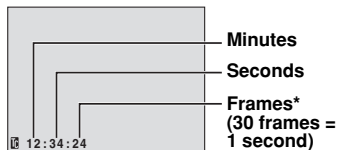

\* Frames are not displayed during recording.

If recording starts from a blank portion, the time code begins counting from "00:00:00" (minute:second:frame). If recording starts from the end of a previously recorded scene, the time code continues from the last time code number. If during recording a blank portion is left partway through the tape, the time code is interrupted. When recording is resumed, the time code starts counting up again from "00:00:00". This means the camcorder may record the same time codes as those existing in a previously recorded scene. To prevent this, perform Recording From The Middle Of A Tape (pg. 20) in the following cases;

- When shooting again after playing back a recorded tape.
- When power shuts off during shooting.
- When a tape is removed and re-inserted during shooting.
- When shooting using a partially recorded tape.
- When shooting on a blank portion located partway through the tape.
- When shooting again after shooting a scene then opening/closing the cassette holder cover.

## NOTES:

- The time code cannot be reset.
- During fast-forwarding and rewinding, the time code indication does not move smoothly.
- The time code is displayed only when "TIME CODE" is set to "ON". (pg. 34)

## Recording From The Middle Of A Tape

- 1) Play back a tape or use Blank Search (pg. 22) to find the spot at which you want to start recording, then engage the Still Playback mode. (pg. 21)
- 2) Set the Power Switch to "REC" while pressing down the Lock Button located on the switch, then start recording.

## Dual Rec.

You can capture still images without disturbing the recording in progress. Press **SNAPSHOT**. A sub screen will be displayed for approx. 6 seconds to show you the snapshot image.

- The Still image is saved into the memory card while video is recorded onto the cassette tape.
- "REC SELECT" must be set to "▶ **M** (CARD)" only.

## Auto/Manual Mode

Press **AUTO** button repeatedly to switch to auto/manual recording mode. When manual mode is selected, the indicator "**M**" appears on the LCD monitor.

### Auto Mode : **A**

You can record using no special effects or manual adjustments.

### Manual Mode : **M**

Manual recording is possible by setting various functions.

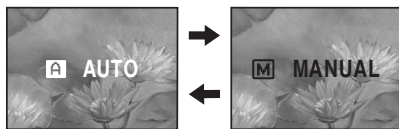

## Normal Playback

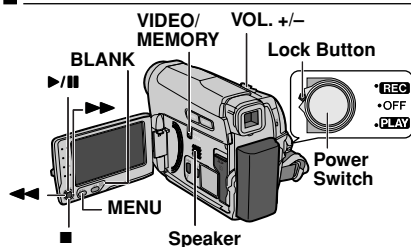

- 1 Load a cassette. (☞ pg. 16)
- 2 Set the **VIDEO/MEMORY** Switch to "VIDEO".
- 3 Set the Power Switch to "PLAY" while pressing down the Lock Button located on the switch.

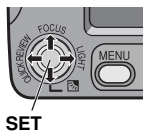
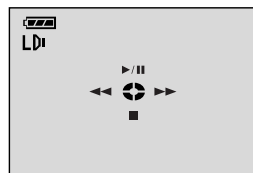

- The above screen (referring to the control lever (☞ pg. 7)) will be displayed for approx. 3 seconds on the LCD Monitor.

Operation	To select
▶/	Move the control lever up.
■	Move the control lever down.
▶▶	Move the control lever right.
◀◀	Move the control lever left.

- 4 To start playback, press ▶/||.
  - 5 To stop playback, press ■.
- During Stop mode, press ◀◀ to rewind, or ▶▶ to fast-forward the tape.
  - Press **SET** to display the guide operation screen.

### To control the speaker volume

Slide the Power Zoom Lever (**VOL. +/-**) towards "+" to turn up the volume, or towards "-" to turn down the volume.

## NOTES:

- The playback picture can be viewed in the LCD monitor, viewfinder or on a connected TV. (☞ pg. 23)
- If Stop mode continues for 5 minutes when power is supplied from a battery, the camcorder shuts off automatically. To turn the camcorder on again, push back and pull out the viewfinder again or close and re-open the LCD monitor.
- When a cable is connected to the AV connector, the sound is not heard from the speaker.

## HDV

Appears when pictures recorded in the HDV format are detected. The pictures in the HDV format cannot be played back with this camcorder.

## Still Playback

Pauses during video playback.

- 1) Press ▶/|| during playback.
  - 2) To resume normal playback, press ▶/|| again.
- If still playback continues for more than about 3 minutes, the camcorder's Stop mode is automatically engaged.

## Variable Shuttle Search

Allows variable-speed search in either direction during video playback.

1) During playback, press ►► once or twice for forward search, or ◀◀ once or twice for reverse search.

◀◀		►►	
x-10	x-3	x3	x10

2) To resume normal playback, press ►/II.

● During playback, press and hold ►► or ◀◀.

The search continues as long as you hold the button. Once you release the button, normal playback resumes.

● A slight mosaic effect appears on the display during Shuttle Search. This is not a malfunction.

### ATTENTION:

During Shuttle Search, parts of the picture may not be clearly visible, particularly on the left side of the screen.



During Shuttle Search, parts of the picture may not be clearly visible across the screen.



## Blank Search

Helps you find where you should start recording in the middle of a tape to avoid time code interruption. (☞ pg. 20)

1 Perform steps 1 – 3 in “Normal Playback” (☞ pg. 21).

2 Press **BLANK**.

● The “BLANK SEARCH” indication appears and the camcorder automatically starts reverse or forward search, then stops at the spot which is about 3 seconds of tape before the beginning of the detected blank portion.

● To cancel Blank Search, press ■ or **BLANK**.

### NOTES:

● Before starting Blank Search, if the current position is at a blank portion, the camcorder searches in the reverse direction. If the current position is at a recorded portion, the camcorder searches in the forward direction.

● If the beginning or end of the tape is reached during Blank Search, the camcorder stops automatically.

● A blank portion which is shorter than 5 seconds of tape may not be detected.

● The detected blank portion may be located between recorded scenes. Before you start recording, make sure there is no recorded scene after the blank portion.

## Playback Snapshot

This camcorder allows you to take snapshots during video playback.

Press **SNAPSHOT**.

## Connections To A TV Or VCR

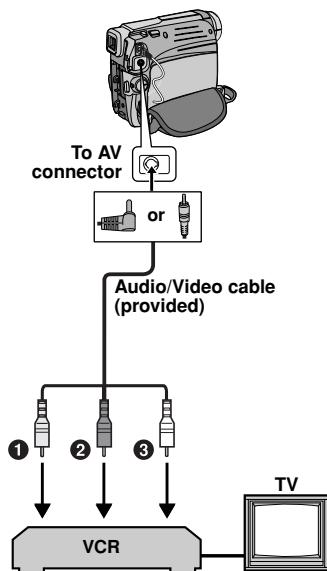

① Yellow to VIDEO IN (Connect when your TV/VCR has only A/V input connectors.)

② Red to AUDIO R IN\*

③ White to AUDIO L IN\*

\* Not required for watching still images only.

1 Make sure all units are turned off.

2 Connect the camcorder to a TV or VCR as shown in the illustration.

If using a VCR, go to step 3.

If not, go to step 4.

3 Connect the VCR output to the TV input, referring to your VCR's instruction manual.

4 Turn on the camcorder, the VCR and the TV.

5 Set the VCR to its AUX input mode, and set the TV to its VIDEO mode.

6 Start playback on the camcorder.

(☞ pg. 21)

- Please set "16:9 OUTPUT" of Playback Menu so that the image may suit your TV (16:9 TV or 4:3 TV). (☞ pg. 34, 35)

### To choose whether or not the following displays appear on the connected TV

• Date/Time

Set "DATE/TIME" to "ON" or "OFF" (☞ pg. 35).

Or, press **DISPLAY** on the remote control to turn on/off the date indication.

• Time Code

Set "TIME CODE" to "ON" or "OFF" (☞ pg. 35).

- Indications other than date/time and time code  
Set "ON SCREEN" to "OFF", "LCD" or "LCD/TV" (☞ pg. 35).

### NOTES:

- It is recommended to use the AC Adapter as the power supply instead of the battery pack. (☞ pg. 13)
- To monitor the picture and sound from the camcorder without inserting a tape or memory card, set the camcorder's Power Switch to "REC", then set your TV to the appropriate input mode.
- Make sure you adjust the TV sound volume to its minimum level to avoid a sudden burst of sound when the camcorder is turned on.

## Playback Using The Remote Control

A battery is included inside the remote control at the time of purchase.

Remove the insulation sheet before use.

### Installing The Battery

The remote control uses one lithium battery (CR2025).

Pull out the battery holder by pressing the lock tab.

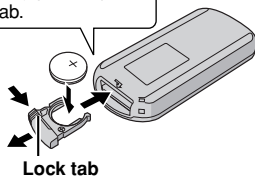

### Beam Effective Area (indoor use)

When using the remote control, be sure to point it at the remote sensor. The transmitted beam's approximate effective distance for indoor use is 5m (16ft).

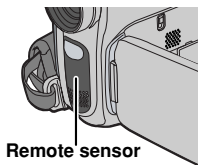

#### NOTE:

The transmitted beam may not be effective or may cause incorrect operation when the remote sensor is directly exposed to sunlight or powerful lighting.

### Buttons And Functions

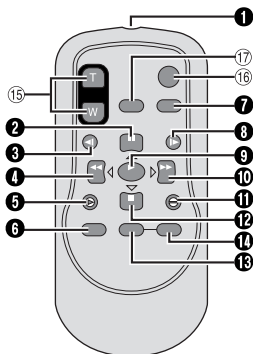

#### 1 Infrared beam transmitting window

The following buttons are available only when the camcorder's Power Switch is set to "PLAY".

- 2 PAUSE Button
- Up Button (⇨ pg. 25)
- 3 SLOW Rewind Button (⇨ pg. 25)
- 4 REW Button
- Left Button (⇨ pg. 25)
- 5 INSERT Button (⇨ pg. 45)
- 6 SHIFT Button (⇨ pg. 25)
- 7 DISPLAY Button (⇨ pg. 23, 42)
- 8 SLOW Forward Button (⇨ pg. 25)
- 9 PLAY Button
- 10 FF Button
- Right Button (⇨ pg. 25)
- 11 A. DUB Button (⇨ pg. 45)
- 12 STOP Button
- Down Button (⇨ pg. 25)
- 13 EFFECT Button (⇨ pg. 25)
- 14 EFFECT ON/OFF Button (⇨ pg. 25)

The following buttons are available when the camcorder's Power Switch is set to "REC".

- 15 Zoom (T/W) Buttons
- Zoom in/out (⇨ pg. 19, 25)
- (Also available with the Power Switch set to "PLAY")
- 16 START/STOP Button
- Functions the same as the Recording Start/Stop Button on the camcorder.
- 17 S.SHOT Button
- Functions the same as **SNAPSHOT** on the camcorder.
- (Also available with the Power Switch set to "PLAY")



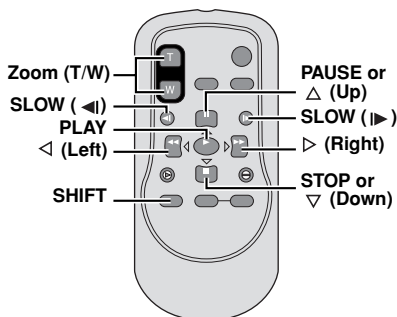

## Slow-Motion Playback

During normal video playback, press **SLOW** (◀ or ▶) more than approx. 2 seconds.

- After approx. 10 minutes, normal playback resumes.
- To pause Slow-Motion playback, press **PAUSE** (PAUSE).
- To return back to normal playback, press **PLAY** (▶).

### NOTES:

- You can also engage Slow-Motion Playback from Still Playback by pressing **SLOW** (◀ or ▶) more than approx. 2 seconds.
- After **SLOW** (◀ or ▶) is pressed and held, the still image may be displayed for a few seconds, followed by a blue screen for a few seconds. This is not a malfunction.
- During Slow-Motion Playback, there will be disturbances in video and the picture may seem unstable, especially with steady images. This is not a malfunction.

## Frame-By-Frame Playback

During normal or still playback, press **SLOW** (▶) repeatedly for forward or **SLOW** (◀) repeatedly for reverse. Each time **SLOW** (◀ or ▶) is pressed, the frame is played back.

## Playback Zoom

Magnifies the recorded image up to 27X at any time during video playback and D.S.C. playback.

1) Press **PLAY** (▶) to start video playback. Or perform normal playback of images.

2) At the point you want to zoom in, press the Zoom Button (T).

- To zoom out, press the Zoom Button (W).

3) You can move the image on the screen around to find a particular portion of the picture. While holding down **SHIFT**, press ◀ (Left), ▶ (Right), Δ (Up) and ∇ (Down).

- To end zoom, press and hold **W** until magnification returns to normal. Or, press **STOP** (■) and then press **PLAY** (▶) during video playback.
- To end zoom during D.S.C. playback, press **PLAY** (▶).

### NOTES:

- Zoom can also be used during slow-motion and still playback.
- Due to digital image processing, the quality of the image may suffer.

## Playback Special Effects

Allows you to add creative effects to the video playback image.

 **SEPIA** (⇨ pg. 41).

**B/W MONOTONE** (⇨ pg. 41).

 **CLASSIC** (⇨ pg. 41).

 **STROBE** (⇨ pg. 41).

1) To start **EFFECT ON/OFF** playback, press **PLAY** (▶).

2) Press **EFFECT**.

The **PLAYBACK EFFECT** Select Menu appears.  
3) Press **EFFECT** repeatedly to move the highlight bar to the desired effect.

- The selected function is activated and after 2 seconds the menu disappears.
- To deactivate the selected effect, press **EFFECT ON/OFF**. To reactivate the selected effect press **EFFECT ON/OFF** again.
- To change the selected effect, repeat from step 2 above.

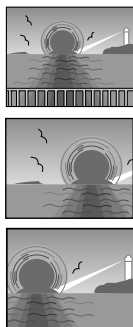

## Basic Shooting (D.S.C. Snapshot)

You can use your camcorder as a Digital Still Camera for taking snapshots. Still images are stored in the memory card.

### NOTE:

Before continuing, perform the procedures listed below:

- Power (⇨ pg. 13)
- Loading a Memory Card (⇨ pg. 17)
- Remove the lens cap.
- Open the LCD monitor fully. (⇨ pg. 8)

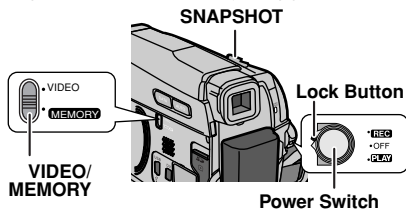

**1** Set the **VIDEO/MEMORY** Switch to "MEMORY".

**2** Set the Power Switch to "REC" while pressing down the Lock Button located on the switch.

- To change the Picture Quality, ⇨ pg. 31, 33.

**3** Press **SNAPSHOT**. The "PHOTO" indication appears while the snapshot is being taken.

- To delete unwanted still images, refer to "Deleting Files" (⇨ pg. 29).
- When you do not want to hear the shutter sound, set "MELODY" to "OFF" (⇨ pg. 34).

### NOTE:

If shooting is not performed for approx. 5 minutes when the Power Switch is set to "REC" and power is supplied from the battery pack, the camcorder shuts off automatically to save power. To perform shooting again, push back and pull out the viewfinder again or close and re-open the LCD monitor.

### CHECK CARD'S WRITE PROTECTION SWITCH

Appears when you attempt to shoot digital still images when the write protection tab on the SD Memory Card is set to the "LOCK" position.

### MEMORY CARD!

Appears if there is no memory card loaded when the SNAPSHOT Button is pressed.

### Approximate Number of Storable Images

- The number increases or decreases depending on the Picture Quality/Image Size, etc.

Image Size/Picture Quality	SD Memory Card			
	8 MB	16 MB	32 MB	64 MB
640 x 480/FINE	47	95	205	425
640 x 480/STANDARD	160	295	625	1285

Image Size/Picture Quality	MultiMediaCard		
	8 MB	16 MB	32 MB
640 x 480/FINE	55	105	215
640 x 480/STANDARD	190	320	645

## Normal Playback Of Images

Images shot with the camcorder are automatically numbered, then stored in numerical order in the memory card. You can view the stored images, one at a time, much like flipping through a photo album.

### VIDEO/MEMORY

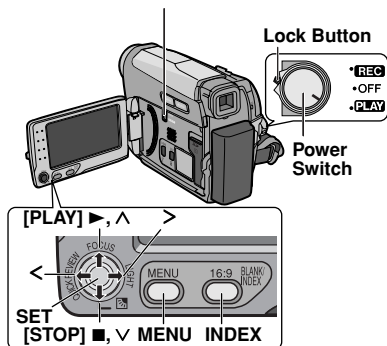

- 1 Load a memory card. (☞ pg. 17)
- 2 Set the **VIDEO/MEMORY** Switch to "MEMORY".
- 3 Set the Power Switch to "PLAY" while pressing down the Lock Button located on the switch.
  - A stored image is displayed.
- 4 Press < to display the previous file. Press > to display the next file.

### NOTE:

Images shot and stored on the card with another device with resolutions other than "640 x 480" will be displayed as thumbnails only. These thumbnail images cannot be transferred to a PC.

## Playback Zoom

Available only with the remote control. (☞ pg. 25)

## NO IMAGES STORED

Appears if there are no image files stored in the memory card when you attempt memory card playback.

## ?

Appears when playing back a file that is not compatible with DCF or a file with a size that is not compatible with this camcorder.

## Auto Playback Of Images

You can run through all the images stored in memory card automatically.

- 1 Perform steps **1 – 3** in "Normal Playback Of Images" (☞ pg. 27).
- 2 Press ▶/|| to start Auto Playback.
  - If you press < during Auto Playback, files are displayed in descending order.
  - If you press > during Auto Playback, files are displayed in ascending order.
- 3 To end Auto Playback, press ■.

## Index Playback Of Files

You can view several different files stored in the memory card at a time. This browsing capability makes it easy to locate a particular file you want.

- 1 Perform steps **1 – 3** in "Normal Playback Of Images" (☞ pg. 27).
- 2 Press **INDEX**. The Index Screen appears.
- 3 Press ∨, ∧, < or > to move the frame to the desired file.
- 4 Press **SET**. The selected file is displayed.

Selected file



Index number

## Removing On-Screen Display

- 1 Perform steps **1 – 3** in "Normal Playback Of Images" (☞ pg. 27).
- 2 Press **MENU**.
- 3 Select "ON SCREEN", press **SET** or >. The ON SCREEN menu appears.
  - Press < whenever you want to return to the previous menu screen.
- 4 Select "OFF", press **SET** or >.
- 5 Press **MENU**.
  - The operation mode indicator, folder/file number, date/time and battery remaining power indicator, disappear.
  - To display the indicators again, select "ON".

1 Select



2 SET

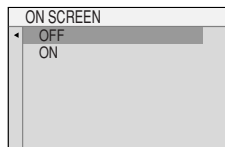

## Resetting The File Name

By resetting the file name, a new folder will be made. The new files you are going to make will be stored in the new folder. It is convenient to separate the new files from previously made files.

**1** Perform steps **1** – **3** in “Normal Playback Of Images” (pg. 27).

**2** Press **MENU**.

**3** Select “NO.RESET”, press **SET** or **>**. The NO. RESET screen appears.

**4** Select “EXECUTE”, press **SET**. The new folder (such as “101JVCGR”) will be made and the file name of the next shot starts from DVC00001.

### NOTE:

If the file name reaches DVC09999, a new folder (such as “101JVCGR”) will be made and the file name will start again from DVC00001.

**1** Select



**2** SET

**6** Select “EXECUTE”, press **SET**.

- To cancel protection, select “RETURN”.
- Repeat steps **5** and **6** for all files you want to protect.

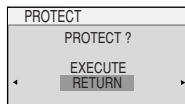

**To protect all files stored in the memory card**

**4** Select “PROT.ALL”, press **SET** or **>**. The PROTECT screen appears.

**5** Select “EXECUTE”, press **SET**.

- To cancel protection, select “RETURN”.

### NOTE:

If the “” mark appears, the currently displayed file is protected.

## To Remove Protection

Before doing the following, perform steps **1** – **3** in “Protecting Files”.

**To remove protection from the currently displayed file**

**4** Select “CURRENT”, press **SET** or **>**. The PROTECT screen appears.

**5** Press **<** or **>** to select the desired file.

**6** Select “EXECUTE”, press **SET**.

- To cancel selection, select “RETURN”.
- Repeat steps **5** and **6** for all files you want to remove protection.

**To remove protection from all files stored in the memory card**

**4** Select “CANC.ALL”, press **SET** or **>**. The PROTECT screen appears.

**5** Select “EXECUTE”, press **SET**.

- To cancel selection, select “RETURN”.

## Protecting Files

The Protect mode helps prevent the accidental erasure of files.

**1** Perform steps **1** – **3** in “Normal Playback Of Images” (pg. 27).

**2** Press **MENU**.

**3** Select “PROTECT”, press **SET** or **>**. The PROTECT menu appears.

- Press **<** whenever you want to return to the previous menu screen.

**To protect the currently displayed file**

**4** Select “CURRENT”, press **SET** or **>**. The PROTECT screen appears.

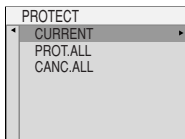

**5** Press **<** or **>** to select the desired file.



Select

## Deleting Files

Previously stored files can be deleted either one at a time or all at once.

**1** Perform steps **1** – **3** in “Normal Playback Of Images” (☞ pg. 27).

**2** Press **MENU**.

**3** Select “DELETE”, press **SET** or **>**. The DELETE Menu appears.

- Press **<** whenever you want to return to the previous menu screen.

**1** Select



**2** SET

To delete the currently displayed file

**4** Select “CURRENT”, press **SET** or **>**. The DELETE screen appears.

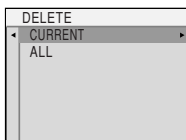

**5** Press **<** or **>** to select the desired file.



Select

**6** Select “EXECUTE”, press **SET**.

- To cancel deletion, select “RETURN”.
- Repeat steps **5** and **6** for all files you want to delete.

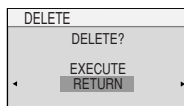

### NOTE:

If the “” mark appears, the selected file is protected and cannot be deleted.

To delete all files stored in the memory card

**4** Select “ALL”, press **SET** or **>**. The DELETE screen appears.

**5** Select “EXECUTE”, press **SET**.

- To cancel deletion, select “RETURN”.

### NOTES:

- Protected files (☞ pg. 28) cannot be deleted. To delete them, remove protection first.
- Once files are deleted, they cannot be restored. Check files before deleting.

## Setting Print Information (DPOF Setting)\*

This camcorder is compatible with the DPOF (Digital Print Order Format) standard in order to support future systems such as automatic printing.

- \* Up to a maximum limit of 999 stored files in the memory card.

### To Print All Still Images (One Print For Each)

**1** Perform steps **1** – **3** in “Normal Playback Of Images” (☞ pg. 27).

**2** Press **MENU**.

**1** Select



**2** SET

**3** Select “DPOF”, press **SET** or **>**. The DPOF Menu appears.

- Press **<** whenever you want to return to the previous menu screen.

**4** Select “ALL 1”, press **SET** or **>**. The DPOF screen appears.

**5** Select “EXECUTE”, press **SET**.

- To cancel selection, select “RETURN”.

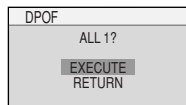
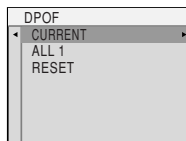

## To Print By Selecting Still Images And Number Of Prints

**1** Perform steps **1 – 3** in “To Print All Still Images (One Print For Each)” (☞ pg. 29).

**2** Select “CURRENT”, press **SET** or **>**. The DPOF screen appears.

**3** Press **<** or **>** to select the desired file.



Select

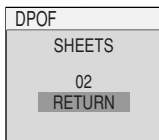

**4** Press **∨** or **∧** to select the number indication (00), and press **SET**.

**5** Select the number of prints by pressing **∧** to increase the number, or **∨** to decrease the number, and press **SET**.

**1** Select



**2** SET

- Repeat steps **3** through **5** for the desired number of prints.

- The number of prints can be set up to 15.

- To correct the number of prints, select the image again and change the number.

**6** Select “RETURN”, press **SET**. The “SAVE?” appears.

- If you did not change any settings in step **3** through **5**, the DPOF Menu reappears.

**7** Select “EXECUTE”, press **SET**.

- To cancel selection, select “CANCEL”.

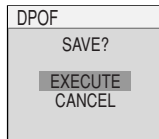
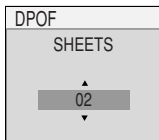

## To Reset The Number Of Prints

**1** Perform steps **1 – 3** in “To Print All Still Images (One Print For Each)” (☞ pg. 29).

**2** Select “RESET”, press **SET** or **>**. The DPOF screen appears.

**3** Select “EXECUTE”, press **SET**.

- To cancel selection, select “RETURN”.

- The number of prints is reset to 0 for all still images.

### CAUTION:

While performing the above, never disconnect power, as this may cause the memory card to be corrupted.

### NOTE:

When the image is printed from the printer, a black bar appears at the bottom of the screen. This is not a malfunction. By recording with “DIS” de-activated (☞ pg. 32) this can be avoided.

## Initializing A Memory Card

You can initialize a memory card any time. After initializing, all files and data stored in the memory card, including those which have been protected, are cleared.

**1** Perform steps **1 – 3** in “Normal Playback Of Images” (☞ pg. 27).

**2** Press **MENU**.

**3** Select “FORMAT”, press **SET** or **>**. The FORMAT screen appears.

- Press **<** whenever you want to return to the previous menu screen.

**4** Select “EXECUTE”, press **SET**. The memory card is initialized.

- When initialization is finished, “NO IMAGES STORED” appears.

- To cancel initialization, select “RETURN”.

**1** Select



**2** SET

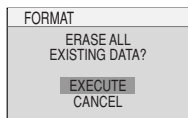

## Changing The Menu Settings

This camcorder is equipped with an easy-to-use, on-screen menu system that simplifies many of the more detailed camcorder settings. (☞ pg. 31 – 35)

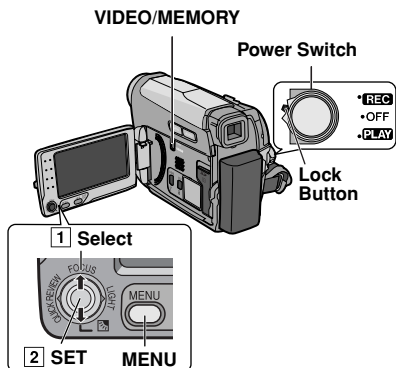

### 1 For Video and D.S.C. Recording Menus:

- Set the VIDEO/MEMORY Switch to “VIDEO” or “MEMORY”.
- Set the Power Switch to “REC” while pressing down the Lock Button located on the switch.
- Set the recording mode to “**M**”. (☞ pg. 20)

### For Video Playback Menu:

- Set the VIDEO/MEMORY Switch to “VIDEO”.
- Set the Power Switch to “PLAY” while pressing down the Lock Button located on the switch.
- For D.S.C. Playback Menu, refer to “D.S.C. PLAYBACK” (☞ pg. 27).

2 Open the LCD monitor fully. (☞ pg. 8)

3 Press **MENU**. The Menu Screen appears.

Screen for Video and D.S.C. Recording Menu

Screen for Video Playback Menu

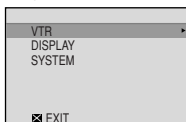
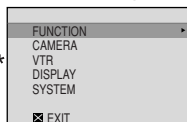

\* Video Recording Menu only

4 Select the desired function, press **SET** or **>**. The selected function menu appears.

Example: FUNCTION menu.

Current Setting

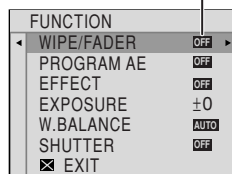

5 Select the desired selection, press **SET** or **>**.

Example: WIPE/FADER menu.

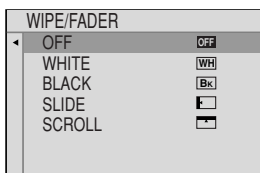

6 Select the desired setting, press **SET** or **>**. Selection is completed.

7 Press **MENU**. The Menu Screen closes.

- Press **<** whenever you want to cancel or return to the previous menu screen.
- Repeat the procedure if you wish to set other function menus.

In the following pages, [ ] refers to Factory preset settings.

## Recording Menus

### FUNCTION

- The following menu settings can be changed only when the Power Switch is set to "REC".
- Each setting (except "EFFECT" and "SHUTTER") which is set in Video Recording Menu is also applied in the D.S.C. Recording Menu.

#### WIPE/FADER\*

(☞ pg. 40), "Wipe or Fader Effects"

\* Available only when the **VIDEO/MEMORY** Switch is set to "VIDEO".

#### PROGRAM AE

(☞ pg. 41), "Program AE, Effects And Shutter Effects"

#### EFFECT

(☞ pg. 41), "Program AE, Effects And Shutter Effects"

#### EXPOSURE

(☞ pg. 38), "Exposure Control"

#### W. BALANCE

(☞ pg. 39), "White Balance Adjustment"

#### SHUTTER

(☞ pg. 41), "Program AE, Effects And Shutter Effects"

## CAMERA

The following menu settings can be changed only when the Power Switch is set to "REC".

#### ZOOM\*

**[34X]**: When set to "34X" while using digital zoom, the zoom magnification will reset to 34X since digital zoom will be disengaged.

**68X\***: Allows you to use the Digital Zoom. By digitally processing and magnifying images, zooming is possible from 34X (the optical zoom limit), to a maximum of 68X digital magnification.

**900X\***: Allows you to use the Digital Zoom. By digitally processing and magnifying images, zooming is possible from 34X (the optical zoom limit), to a maximum of 900X digital magnification.

\* Available only when the **VIDEO/MEMORY** Switch is set to "VIDEO".

#### TELE MACRO

**[OFF]**: Disables the function.

**ON**: When the distance to the subject is less than 1 m (3.3 ft), set "TELE MACRO" to "ON". You can shoot a subject as large as possible at a distance of approx. 40 cm (1.4 ft). Depending on the zoom position, the lens may go out of focus.

#### DIS\*

**OFF** (☞): Disables the function. (DIS disable icon appears.)

**[ON]**: To compensate for unstable images caused by camera-shake, particularly at high magnification.

#### NOTES:

- Accurate stabilization may not be possible if hand shake is excessive, or depending on the shooting condition.
- Switch off this mode when recording with the camcorder on a tripod.
- DIS cannot be activated when "NIGHT" in "PROGRAM AE" or "STROBE" in "EFFECT" is selected, or when **LIGHT** is set to on, or when **SNAPSHOT** is pressed.

\* Available only when the **VIDEO/MEMORY** Switch is set to "VIDEO".



**GAIN UP**

**OFF:** Allows you to shoot dark scenes with no picture brightness adjustment.

**[AGC]:** The overall appearance may be grainy, but the image is bright.

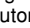
**AUTO A:** The shutter speed is automatically adjusted. Shooting a subject in low or poor lighting at slow shutter speed provides a brighter image than in the AGC mode, but the subject's movements are not smooth or natural. The overall appearance may be grainy. While the shutter speed is being automatically adjusted, "A" is displayed.

**WIND CUT\***

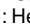
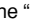

**[OFF]:** Disengages the function.

**ON :** Helps cut down on noise created by wind. The "" indicator appears. The quality of the sound will change. This is normal.

\* Available only when the **VIDEO/MEMORY** Switch is set to "VIDEO".

**IMAGE SIZE\***

**[640 x 480 F] / 640 x 480 S**

The Image Size mode can be selected to best match your needs. Two Picture Quality modes are available: FINE () and STANDARD () (in order of quality).

**NOTE:**

The number of storable images depends on the selected picture quality as well as the composition of the subjects in the images and the type of memory card being used. (➡ pg. 26)

\* Available only when the **VIDEO/MEMORY** Switch is set to "MEMORY".

**VTR**

Available only when the **VIDEO/MEMORY** Switch is set to "VIDEO".

**REC MODE**

**[SP]\*:** To record in the SP (Standard Play) mode

**LP:** Long Play—more economical, providing 1.5 times the recording time.

\* SP indicator does not appear on the screen.

**NOTES:**

- Audio Dubbing (➡ pg. 45) and Insert Editing (➡ pg. 45) are possible on tapes recorded in the SP mode.
- If the recording mode is switched, the playback picture will be blurred at the switching point.
- During playback of a tape recorded on another camcorder, blocks of noise may appear or there may be momentary pauses in the sound.

**SOUND MODE**

**[12BIT]:** Enables video recording of stereo sound on four separate channels, and is recommended for use when performing Audio Dubbing. (Equivalent to the 32 kHz mode of previous models)

**16BIT:** Enables video recording of stereo sound on two separate channels. (Equivalent to the 48 kHz mode of previous models)

**SNAP/SLOW**

**[SNAP ]:** Snapshot mode

**SLOW :** Live Slow mode

For details on the procedure, refer to "Live Slow" (➡ pg. 36) and "Snapshot (Record Still Image On Tape)" (➡ pg. 37).

**REC SELECT**

➡  (TAPE): When Snapshot recording is performed with the **VIDEO/MEMORY** Switch set to "VIDEO", still images are recorded only onto the tape.

➡  (TAPE/CARD): When Snapshot recording is performed with the **VIDEO/MEMORY** Switch set to "VIDEO", still images are recorded not only onto the tape but also in the memory card (640 x 480 pixels).

[➡ ] (CARD): When Snapshot recording is performed with the **VIDEO/MEMORY** Switch Set to "VIDEO", still images are recorded into the Memory Card only. Select this setting to perform Dual Rec.. (➡ pg. 20)

**DISPLAY**

The "DISPLAY" settings (except "CLOCK ADJ.", "16:9 OUTPUT" and "BRIGHT") are effective only for shooting.

**ON SCREEN**

**LCD:** Keeps the camcorder's display (except the date, time and time code) from appearing on the connected TV screen.

**[LCD/TV]:** Makes the camcorder's display appear on screen when the camcorder is connected to a TV.

**DATE/TIME**

**[OFF]:** The date/time does not appear.

**ON:** The date/time is always displayed.

● The date indication can also be turned on/off by pressing the **DISPLAY** Button on the remote control. (☞ pg. 23, 42)

**CLOCK ADJ.**

☞ pg. 15, "Date/Time Settings"

**TIME CODE\***

**[OFF]:** Time code is not displayed.

**ON:** Time code is displayed on the camcorder and on the connected TV. Frame numbers are not displayed during recording. (☞ pg. 20)

\* Available only when the **VIDEO/MEMORY** Switch is set to "VIDEO".

**16:9 OUTPUT**

To enable your tv to display images in 16:9 wide mode, set the tv screen size correctly.

**4:3 TV:** For TV with an aspect ratio of 4:3.

**[16:9 TV]:** For TV with an aspect ratio of 16:9.

**BRIGHT**

☞ pg. 15, "Brightness Adjustment Of The Display"

**SYSTEM**

The "SYSTEM" functions which are set when the Power Switch is set to "REC" are also applied when the Power Switch is set to "PLAY".

**LANGUAGE**

日本語 / 한국어 / 繁體字 / **[ENGLISH]** /

**FRANCAIS / ESPAÑOL / PORTUGUÊS**

The language setting can be changed.

(☞ pg. 14)

**MELODY**

**OFF:** Even though not heard while shooting, shutter sound is recorded on the tape.

**[ON]:** A melody sounds when any operation is performed. It also activates the shutter sound effect. (☞ pg. 26, 37)

**REMOTE**

**OFF:** Disables the remote control operations.

**[ON]:** Enables the remote control operations.

**PRIORITY**

**[LCD]:** The image is displayed on the LCD monitor when the viewfinder is pulled out while the LCD monitor is opened.

**FINDER:** The image is displayed in the viewfinder when the viewfinder is pulled out while the LCD monitor is opened.

**DEMO MODE**

**OFF:** Automatic demonstration will not take place.

**[ON]:** Demonstrates certain functions such as Wipe/Fader and Effects, etc., and can be used to confirm how these functions operate.

Demonstration starts in the following cases:

- When the Menu Screen is closed after "DEMO MODE" is turned "ON".
- With "DEMO MODE" set to "ON", if there is no operation for about 3 minutes after the Power Switch is set to "REC".
- Performing any operation during the demonstration stops the demonstration temporarily. If no operation is performed for more than 3 minutes after that, the demonstration will resume.

**NOTES:**

- If a cassette is in the camcorder, the demonstration cannot be turned on.
- "DEMO MODE" remains "ON" even if the camcorder power is turned off.

**CAM RESET**

**[CANCEL]:** Does not reset all settings to the factory-preset.

**EXECUTE:** Resets all settings to the factory-preset.

## Playback Menus

### VTR

The settings below are effective only for video playback except "REC MODE" and "SNAP/SLOW". The parameters (except "SOUND L/R", "[T] → [M] COPY" and "NARRATION" settings) are the same as in the description on page 33.

#### SOUND L/R and NARRATION

During tape playback, the camcorder detects the sound mode in which the recording was made, and plays the sound back. Select the sound to accompany your playback picture.

#### REC MODE [SP]\* / LP

Allows you to set the video recording mode (SP or LP) depending on your preference. It is recommended you use "REC MODE" in VIDEO Menu when using this camcorder as a recorder during dubbing. (pg. 42, 43)

\* SP indicator does not appear on the screen.

#### NARRATION

[OFF]: Original sound is output on both "L" and "R" channels in stereo.

ON: Dubbed sound is output on both "L" and "R" channels in stereo. (pg. 45).

MIX: Original and dubbed sounds are combined and output in stereo on both "L" and "R" channels.

#### SNAP/SLOW

pg. 33, "SNAP/SLOW".

#### [T] → [M] COPY

[OFF]: When the SNAPSHOT button is pressed during tape playback, the playback image pauses and normal playback will resume after approximately 6 seconds. (The still image is not recorded.)

ON: Enables dubbing of images recorded on a tape to a memory card. (pg. 42).

#### SOUND L/R

[STEREO 

SOUND L 

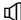
SOUND R 

### DISPLAY

Each setting (except "OFF" in "ON SCREEN", "DATE/TIME" and "TIME CODE") is linked with "DISPLAY", which appears when the Power Switch is set to "REC".

The parameters (except "OFF" in "ON SCREEN" setting) are the same as in the description on pg. 34.

#### ON SCREEN OFF / [LCD] / LCD/TV

When set to "OFF", the camcorder's display disappears.

#### DATE/TIME [OFF] / ON

#### CLOCK ADJ.

pg. 15, "Date/Time Settings"

#### TIME CODE [OFF] / ON

pg. 20, "Time Code"

#### 16:9 OUTPUT 4:3 TV / [16:9 TV]

pg. 34, "16:9 OUTPUT"

#### BRIGHT

pg. 15, "Brightness Adjustment Of The Display"

### SYSTEM

Each setting (except "DEMO MODE") is linked with "SYSTEM", which appears when the Power Switch is set to "REC".

The parameters are the same as in the description on page 34.

## LED Light

LED Light can be used to brighten the subject in the dark place during video recording or D.S.C. shooting.



LIGHT

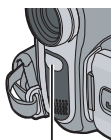

LED Light

**1** Press **LIGHT** repeatedly to change the setting.

- The light is on always. (☞ appears.)
- The light turns on automatically when dark. (☞ **A** appears.)
- No display Turns off the light.

**2** Press the Recording Start/Stop Button to start video recording or **SNAPSHOT** to shoot a still image.

### NOTES:

- Be careful not to point the LED Light directly to eyes.
- If the light does not reach the subject when the LED Light setting is "ON", the Night-Alive function will be activated, and makes it possible to shoot the subject brighter.
- Since subjects are shot at a reduced shutter speed when the LED Light setting is "ON", they will appear slightly blurred.

## Live Slow

This feature is useful for recording or playing back precious or hard-to-see moments at a slow speed. Sound is recorded and played back in real time.

**1** Set the **VIDEO/MEMORY** Switch to "VIDEO".

**2** Set the Power Switch to "REC" or "PLAY".  
● If set to "REC", the recording mode should be set to "**M**". (☞ pg. 20)

**3** Set "SNAP/SLOW" to "SLOW". (☞ pg. 33)  
The Live Slow indicator "" appears.

**4** Press **SLOW** during recording or playback.  
● The moving pictures are divided into four frames. They are recorded or played back for 1.5 seconds, and then normal recording or playback resumes.

### NOTES:

- This feature is effective when the recording mode selection is set to both "**A**" or "**M**".
- Live Slow cannot be used when the 16:9 Wide mode is selected.

## Snapshot (Record Still Image On Tape)

This feature lets you record still images that look like photographs onto a tape.

- 1 Set the **VIDEO/MEMORY** Switch to "VIDEO".
- 2 Set the Power Switch to "REC".
- 3 Set the recording mode to "M". (☞ pg. 20)
- 4 Set "REC SELECT" to "▶ [M] ▶" or "▶ [M]". (☞ pg. 31, 33)
- 5 Set "SNAP/SLOW" to "SNAP". (☞ pg. 33)
- 6 Press **SNAPSHOT**.
  - The "PHOTO" indication appears and a still image will be recorded for approx. 5 seconds, then the camcorder re-enters the Record-Standby mode.
  - You can perform Snapshot also during recording. A still image will be recorded for approx. 5 seconds, then the normal recording resumes.
  - Snapshot is effective when the recording mode selection is set to both "A" or "M".
  - If the image taken by snapshot is too dark or too bright, select [ ] (☞ pg. 39) or "SPOTLIGHT" (☞ pg. 41).

## Motor Drive Mode

Keeping **SNAPSHOT** pressed in step 6 provides an effect similar to serial photography. (Interval between still images: approx. 1 second)

- The Motor Drive mode is disabled when "REC SELECT" is set to "▶ [M] ▶" or "▶ [M]". (☞ pg. 33)

## Manual Focus

The camcorder's Full Range AF system offers continuous shooting ability from close-up (as close as approx. 5 cm (2") to the subject) to infinity.

However, correct focus may not be obtained depending on the shooting condition. In this case, use the manual focus mode.

- 1 Set the Power Switch to "REC".

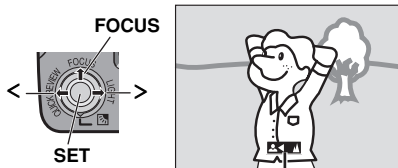

Manual focus indicator

- 2 Set the recording mode to "M". (☞ pg. 20)
- 3 Press **FOCUS**. The manual focus indicator appears.
- 4 Press < or > to focus on a subject.
  - When the focus level cannot be adjusted any further or closer, "▲" or "▶" will blink.
- 5 Press **SET**. Focus adjustment is complete.

### To reset to Auto Focus

Press **FOCUS** twice.

### Manual focus is recommended in situations listed below.

- When two subjects overlap in the same scene.
- When illumination is low.\*
- When the subject has no contrast (difference in brightness and darkness), such as a flat, one-color wall, or a clear, blue sky.\*
- When a dark object is barely visible in the LCD monitor or the viewfinder.\*
- When the scene contains minute patterns or identical patterns that are regularly repeated.
- When the scene is affected by sunbeams or light reflecting off the surface of a body of water.
- When shooting a scene with a high-contrast background.

\* The following low-contrast warnings appear blinking: ▲, ◀, ▶ and ♀.

## Exposure Control

Manual exposure control is recommended in the following situations:

- When shooting using reverse lighting or when the background is too bright.
- When shooting on a reflective natural background such as at the beach or when skiing.
- When the background is overly dark or the subject is bright.

**1** Select



**2** SET

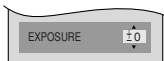

- 1 Open the LCD monitor fully.
- 2 Set the Power Switch to "REC".
- 3 Set the recording mode to "M". (☞ pg. 20)
- 4 Press **MENU**.
- 5 Select "FUNCTION", press **SET** or >.
- 6 Select "EXPOSURE", press **SET** or >.
- 7 Select the appropriate exposure, press **SET** or >.
  - To brighten the image, press  $\wedge$ . To darken the image, press  $\vee$ . (maximum +/-6)
- 8 Press **MENU**.

### NOTES:

- If the adjustment does not cause any visible change in brightness, set "GAIN UP" to "AUTO". (☞ pg. 31, 33)
- You cannot use the manual exposure control at the same time when "PROGRAM AE" is set to "SPOTLIGHT" or "SNOW" (☞ pg. 41), or with the backlight compensation.

## Iris Lock

Like the pupil of the human eye, the iris contracts in well-lit environments to keep too much light from entering, and dilates in dim environments to allow in more light.

Use this function in the following situations:

- When shooting a moving subject.
- When the distance to the subject changes (so its size in the LCD monitor or the viewfinder changes), such as when the subject is backing away.
- When shooting on a reflective natural background such as at the beach or when skiing.
- When shooting objects under a spotlight.
- When zooming.

**1** Perform steps **1 - 6** in "Exposure Control" (☞ pg. 38)

**2** Adjust zoom so that the subject fills the LCD monitor or the viewfinder, then press and hold **SET** or > for over 2 seconds. The "I" indication appears.

**3** Press **SET** or >. The iris is locked.



**4** Press **MENU**.

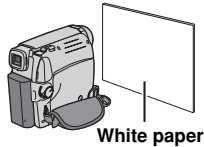

## Manual White Balance Adjustment

Adjust the white balance manually when shooting under various types of lighting.

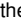

- 1** Set the Power Switch to "REC".
- 2** Set the recording mode to "M". (☞ pg. 20)
- 3** Hold a sheet of plain white paper in front of the subject. Adjust zoom or position yourself so that the white paper fills the screen.
- 4** Select "MWB" in "W. BALANCE" menu (☞ pg. 32), then press and hold **SET** or **>** until  begins blinking.
  - When the setting is completed,  stops blinking.
- 5** Press **SET** or **>** to engage the setting.
- 6** Press **MENU**. The Menu Screen closes and the Manual White Balance indicator  is displayed.

### NOTES:

- In step **3**, it may be difficult to focus on the white paper. In such a case, adjust focus manually. (☞ pg. 37)
- Because the color temperature is different depending on the light source, use this function for a more natural result.
- Once you adjust white balance manually, the setting is retained even if the power is turned off or the battery removed.
- White Balance cannot be activated simultaneously with "TWILIGHT" in "PROGRAM AE" (☞ pg. 41).
- White Balance cannot be activated if the "SEPIA" or "MONOTONE" mode is activated.

## Wipe Or Fader Effects

These effects let you make pro-style scene transitions. Use them to spice up the transition from one scene to the next.

Wipe or Fader works when video recording is started or stopped.

- 1** Set the **VIDEO/MEMORY** Switch to "VIDEO".
- 2** Set the Power Switch to "REC".
- 3** Set the recording mode to "M". (☞ pg. 20)
- 4** Set "WIPE/FADER" in "FUNCTION" Menu. (☞ pg. 32)
- 5** Press the Recording Start/Stop Button to activate the Fade-in/out or Wipe-in/out.

### NOTE:

You can extend the length of a Wipe or Fader by pressing and holding the Recording Start/Stop Button.

## WIPE/FADER

**OFF:** Disables the function. (Factory-preset)

**WHITE** : Fade in or out with a white screen.

**BLACK** : Fade in or out with a black screen.

**SLIDE** : Wipe in from right to left, or wipe out from left to right.

**SCROLL** : The scene wipes in from the bottom to the top of a black screen, or wipes out from top to bottom, leaving a black screen.



## Program AE, Effects And Shutter Effects

- 1 Set the Power Switch to "REC".
  - 2 Set the recording mode to "M". (☞ pg. 20)
  - 3 Set "EFFECT", "PROGRAM AE" or "SHUTTER" in "FUNCTION" Menu. (☞ pg. 32)
- The selected effect will be shown for approx. 2 seconds before the camcorder returns to the menu screen.

### NOTES:

- Shutter Effects cannot be used during "NIGHT".
- When a subject is too bright or reflective, a vertical streak may appear (smear phenomenon). Smear phenomenon tends to occur when "SPORTS" or any mode of "SHUTTER 1/500 – 1/4000" is selected.

## PROGRAM AE

**OFF:** Disables the function. (Factory-preset)

### SPORTS

**(Variable Shutter Speed: 1/250 – 1/4000):** This setting allows fast-moving images to be captured one frame at a time, for vivid, stable slow-motion playback. The faster the shutter speed, the darker the picture becomes. Use the shutter function under good lighting conditions.

**SNOW **: Compensates for subjects that may otherwise appear too dark when shooting in extremely bright surroundings such as in the snow.

**SPOTLIGHT **: Compensates for subjects that may otherwise appear too bright when shooting under extremely strong direct lighting such as spotlights.

**TWILIGHT **: Makes evening scenes look more natural. White Balance (☞ pg. 39) is automatically set to "AUTO". When Twilight is chosen, the camcorder automatically adjusts the focus from approx. 10 m (32 ft) to infinity. From less than 10 m, adjust the focus manually.

**NIGHT **: Makes dark subjects or areas even brighter than they would be under good natural lighting. Although the recorded image is not grainy, it may look as if it is strobing due to the slow shutter speed.

During Night-Alive, it may be difficult to bring the camcorder into focus. To prevent this, use of a tripod is recommended.

## EFFECT

**OFF:** Disables the function. (Factory-preset)

**SEPIA **: Recorded scenes have a brownish tint like old photos.

**MONOTONE B/W**: Like classic black and white films, your footage is shot in B/W.

**CLASSIC\* **: Gives recorded scenes a strobe effect.

**STROBE\* **: Your recording looks like a series of consecutive snapshots.

**MIRROR\* **: Creates a mirror image on the left half of the screen, juxtaposed to the normal image on the other half.

\* Not available for still image recording.

## SHUTTER

**OFF:** Disables the function. (Factory-preset)

**1/60 SHUTTER 1/60:** The shutter speed is fixed at 1/60th of a second. Black bands that usually appear when shooting a TV screen become narrower.

**1/100 SHUTTER 1/100:** The shutter speed is fixed at 1/100th of a second. The flickering that occurs when shooting under a fluorescent light or mercury-vapour lamp is reduced.

**SHUTTER 1/500/SHUTTER 1/4000\*:** (Refer to PROGRAM AE - **SPORTS ** mode.)

\* Not available for still image recording.

## Dubbing Still Images Recorded On A Tape To A Memory Card

Still images can be dubbed from a tape to a memory card.

- 1** Load a cassette. (☞ pg. 16)
- 2** Load a memory card. (☞ pg. 17)
- 3** Set "SNAP/SLOW" to the desired mode. (except "SLOW", ☞ pg. 33, 35)
- 4** Set the **VIDEO/MEMORY** Switch to "VIDEO".
- 5** Set the Power Switch to "PLAY" while pressing down the Lock Button located on the switch.
- 6** Set "[T] → [M] COPY" to "ON". (☞ pg. 35)
- 7** Press ►/II to start playback.
- 8** At the point you want to dub, press ►/II again to engage Still Playback.
- 9** To dub the image, press **SNAPSHOT**.
  - The "▶ [P]" indication appears during dubbing.

### NOTE:

To use Playback Special effects with a video image you wish to dub, perform up to step **9** using the remote control. (☞ pg. 24)

## Dubbing To A VCR

To use this camcorder as a player

- 1** Following the illustration, ☞ pg. 23, "Connections To A TV Or VCR", connect the camcorder and the VCR's input connectors.
- 2** Perform steps **1 - 6** (☞ pg. 23)
- 3** At the point you want to start dubbing, start recording on the VCR. (Refer to the VCR's instruction manual.)
- 4** To stop dubbing, stop recording on the VCR, then stop playback on the camcorder.

### NOTES:

- It is recommended to use the **AC Adapter as the power supply instead of the battery pack.** (☞ pg. 13)
- To choose whether or not the following displays appear on the connected TV
  - Date/time
    - Set "DATE/TIME" to "ON" or "OFF" (☞ pg. 35). Or, press **DISPLAY** on the remote control to turn on/off the date indication.
  - Time code
    - Set "TIME CODE" to "OFF" or "ON" (☞ pg. 35).
  - Indications other than date/time and time code
    - Set "ON SCREEN" to "OFF", "LCD" or "LCD/TV" (☞ pg. 35).

## Dubbing To Or From A Video Unit Equipped With A DV Connector (Digital Dubbing)

It is also possible to copy recorded scenes from the camcorder onto another video unit equipped with a DV connector. Since a digital signal is sent, there is little, if any, image or sound deterioration.

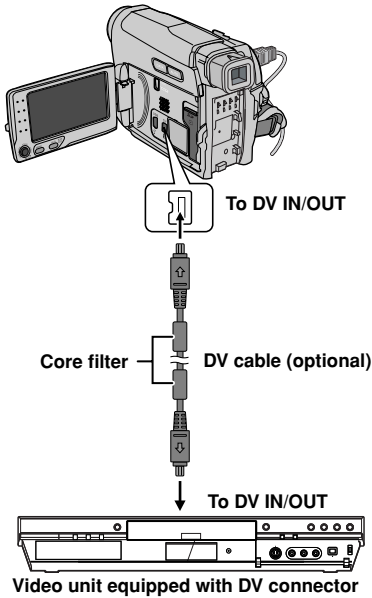

### To use this camcorder as a player

- 1 Make sure all units are turned off.
- 2 Connect this camcorder to a video unit equipped with a DV input connector using a DV cable as shown in the illustration.
- 3 Start playback on the camcorder. (☞ pg. 21)
- 4 At the point you want to start dubbing, start recording on the video unit. (Refer to the video unit's instruction manual.)
- 5 To stop dubbing, stop recording on the video unit, then stop playback on this camcorder.

### NOTES:

- It is recommended to use the AC Adapter as the power supply instead of the battery pack. (☞ pg. 13)
- If a blank portion or disturbed image is played back on the player during dubbing, the dubbing may stop so that an unusual image is not dubbed.
- Even though the DV cable is connected correctly, sometimes the image may not appear in step 4. If this occurs, turn off the power and make connections again.
- If "Playback Zoom" (☞ pg. 25) or "Playback Special Effects" (☞ pg. 25) is attempted or **SNAPSHOT** is pressed during playback, only the original playback image recorded on the tape is output from the DV IN/OUT connector.
- When using a DV cable, be sure to use the optional JVC VC-VDV204U or VC-VDV206U DV cable.

### To use this camcorder as a recorder

- 1 Make sure all units are turned off.
- 2 Connect this camcorder to a video unit equipped with a DV output connector using a DV cable as shown in the illustration.
- 3 Set the camcorder's Power Switch to "PLAY".
- 4 Set "REC MODE" to "SP" or "LP". (☞ pg. 35)
- 5 Start playback on the player.
- 6 Press the Recording Start/Stop Button to engage the Record-Pause mode.
  - The "DV IN" indication appears on the screen.
- 7 At the point you want to start dubbing, press the Recording Start/Stop Button to start dubbing. The ⏪ indication rotates.
- 8 Press the Recording Start/Stop Button again to stop dubbing. The ⏪ indication stops rotating.
- 9 Press ■ to return to the normal playback mode.

### NOTE:

Digital Dubbing is performed in the sound mode recorded on the original tape, regardless of the current "SOUND MODE" setting. (☞ pg. 33)

### COPY PROTECTED

Appears if dubbing of copyguarded signals is attempted while this camcorder is being used as a recorder.

## Connection To A Personal Computer

### [A] Using USB cable

OR

### [B] Using DV cable

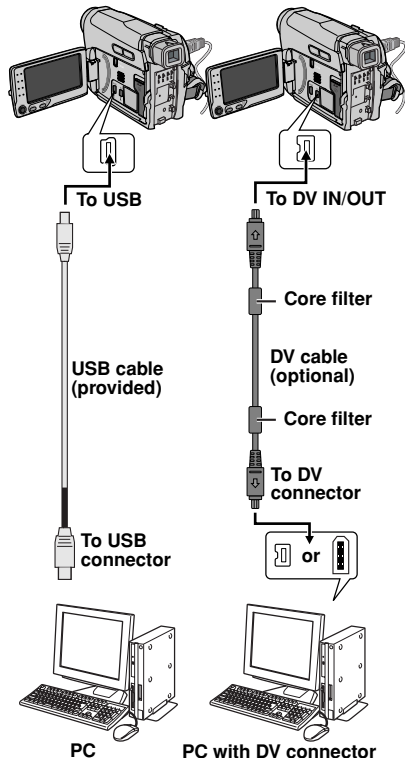

When connecting the camcorder to a PC using a DV cable, make sure to follow the procedure below. Connecting the cable incorrectly may cause malfunctions to the camcorder and/or the PC.

- Connect the DV cable first to the PC, and then to the camcorder.
- Connect the DV cable (plugs) correctly according to the shape of the DV connector.

### [A] Using USB cable

It is possible to transfer still images stored on a memory card to a PC.

### [B] Using DV cable

It is also possible to transfer still/moving images to a PC with a DV connector by using the provided software, software equipped with the PC or commercially available software. If you are using a Windows® XP, you can use Windows® Messenger to conduct video conferences over the Internet, using a camcorder. For details, refer to the help for the Windows® Messenger.

#### NOTES:

- Refer to "SOFTWARE INSTALLATION AND USB CONNECTION GUIDE" for the bundled software and drivers.
- It is recommended to use the AC Adapter as the power supply instead of the battery pack. (☞ pg. 13)
- Never connect the USB cable and the DV cable simultaneously to the camcorder. Connect only the cable you wish to use to the camcorder.
- When using a DV cable, be sure to use the optional JVC VC-VDV206U or VC-VDV204U DV cable depending on the type of DV connector (4 or 6 pins) on the PC.
- If the PC connected to the camcorder via the USB cable is not powered, the camcorder does not enter the USB mode.
- The date/time information cannot be captured into the PC.
- Refer to the instruction manuals of the PC and Software.
- The still images can also be transferred to a PC with a DV connector-equipped capture board.
- The system may not work properly depending on the PC or capture board you are using.
- If, after connecting a DV cable to the camcorder and it doesn't work, restart the camcorder.

"USB" and/or " ↔ " appears on the LCD monitor while the PC is accessing data in the camcorder or the camcorder is transferring a file to the PC.

**NEVER disconnect the USB cable while " ↔ " is displayed on the LCD monitor since this can result in product damage.**

## Audio Dubbing

The audio track can be customized only when recorded in the 12-BIT and SP modes.

(☞ pg. 33)

- Use the provided remote control.

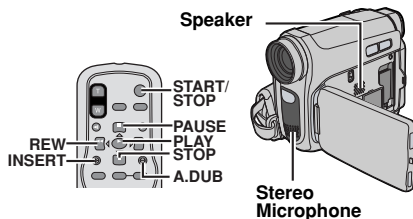

**1** Play back the tape to locate the point where editing will start, then press **PAUSE (II)**.

**2** While holding **A. DUB (⊖)** on the remote control, press **PAUSE (II)**. The "II ⊖" indicator appears.

**3** Press **PLAY (▶)**, then begin "narrating". Speak into the microphone.

- To pause dubbing, press **PAUSE (II)**.

**4** To end Audio Dubbing, press **PAUSE (II)**, then **STOP (■)**.

### To hear the dubbed sound during playback

Set "NARRATION" to "ON" or "MIX"

(☞ pg. 35).

### NOTES:

- Sound is not heard from the speaker during Audio Dubbing.
- When editing onto a tape that was recorded at 12-BIT, the old and new soundtracks are recorded separately.
- If feedback or howling occurs during TV playback, move the camcorder's microphone away from the TV, or turn down the TV's volume.

## Insert Editing

You can record a new scene into a previously recorded tape, replacing a section of the original recording with minimal picture distortion at the in and out points. The original audio remains unchanged.

- Use the provided remote control.

### NOTES:

- Before performing the following steps, make sure that "TIME CODE" for "DISPLAY" in both Recording and Playback Menu is set to "ON". (☞ pg. 34, 35)
- Insert Editing is not possible on a tape recorded in the LP mode or on a blank portion of a tape.

**1** Play back the tape, locate the Edit-Out point and press **PAUSE (II)**. Confirm the time code at this point. (☞ pg. 20)

**2** Press **REW (◀◀)** until the Edit-In point is located, then press **PAUSE (II)**.

**3** Press and hold **INSERT (⊕)** on the remote control, then press **PAUSE (II)**. The "II ⊕" indicator and the Time Code (min.:sec.) appear and the camcorder enters Insert-Pause mode.

**4** Press **START/STOP** to begin editing.

- Confirm the insert at the time code you checked in step **1**.

- To pause editing, press **START/STOP**. Press it again to resume editing.

**5** To end Insert Editing, press **START/STOP**, then **STOP (■)** on the remote control.

### NOTES:

- Program AE, Effects and Shutter Effects (☞ pg. 41) can be used to spice up the scenes being edited during Insert Editing.
- During Insert Editing, the date and time information changes.
- If you perform Insert Editing onto a blank space on the tape, the audio and video may be disrupted. Make sure you only edit recorded areas.
- During Insert Editing, when the tape moves to scenes recorded in the LP mode or a blank portion, Insert Editing stops.

## 46 EN TROUBLESHOOTING

If, after following the steps in the chart below, the problem still exists, please consult your nearest JVC dealer.

### No power is supplied.

- The power is not connected properly.  
→ Connect the AC Adapter securely. (☞ pg. 13)
- The battery pack is not attached firmly.  
→ Detach the battery pack once again and re-attach it firmly. (☞ pg. 14)
- The battery is dead.  
→ Replace the dead battery with a fully charged one. (☞ pg. 13)

### Recording cannot be performed.

- The tape's erase protection tab is set to "SAVE".  
→ Set the tape's erase protection tab to "REC". (☞ pg. 16)
- "TAPE END" appears.  
→ Replace with new cassette. (☞ pg. 16)
- The cassette holder cover is open.  
→ Close the cassette holder cover.

### When shooting a subject illuminated by bright light, vertical lines appear.

This is not a malfunction.

### When the screen is under direct sunlight during shooting, the screen becomes red or black for an instant.

This is not a malfunction

### The LCD monitor or viewfinder indications blink.

- Effects function that cannot be used together are selected at the same time.  
→ Re-read the sections covering Effects. (☞ pg. 32)

### The tape is moving, but there is no picture.

- Your TV has AV input terminals, but is not set to its VIDEO mode.  
→ Set the TV to the mode or channel appropriate for video playback. (☞ pg. 23)
- The cassette holder cover is open.  
→ Close the cassette holder cover. (☞ pg. 16)

### Blocks of noise appear during playback, or there is no playback picture and the screen becomes blue.

Clean the video heads with an optional cleaning cassette. (☞ pg. 5)

### The focus does not adjust automatically.

- Focus is set to the Manual mode.  
→ Set Focus to the Auto mode. (☞ pg. 37)
- The lens is dirty or covered with condensation.  
→ Clean the lens and check the focus again. (☞ pg. 37)

### The color of Snapshot looks strange.

- The light source or the subject does not include white. Or there are various different light sources behind the subject.  
→ Find a white subject and compose your shot so that it also appears in the frame. (☞ pg. 37, 40)

### The POWER/CHARGE lamp on the camcorder does not light during charging.

- Charging is difficult in places subject to extremely high/low temperatures.  
→ To protect the battery, it is recommended to charge it in places with a temperature of 10°C to 35°C (50°F to 95°F). (☞ pg. 48)
- The battery pack is not attached firmly.  
→ Detach the battery pack once again and re-attach it firmly. (☞ pg. 13)

### The image looks like the shutter speeds is too slow.

- When shooting in the dark, the unit becomes highly sensitive to light when "GAIN UP" is set to "AUTO".  
→ If you want the lighting to look more natural, set "GAIN UP" to "AGC" or "OFF". (☞ pg. 33)

### Images on the LCD monitor appear dark or whitish.

- In places subject to low temperature, images become dark due to the characteristics of the LCD monitor. This is not a malfunction.  
→ Adjust the brightness and angle of the LCD monitor. (☞ pg. 8, 15)
- When the LCD monitor's fluorescent light reaches the end of its service life, images on the LCD monitor become dark.  
→ Consult your nearest JVC dealer.

### Picture does not appear on the LCD monitor.

- The viewfinder is pulled out and "PRIORITY" is set to "FINDER".  
→ Push the viewfinder back in or set "PRIORITY" to "LCD". (☞ pg. 8, 34)
- The LCD monitor's brightness setting is too dark.  
→ Adjust the brightness of the LCD monitor. (☞ pg. 15)

→ If the monitor is tilted upward 180 degrees, open the monitor fully. (☞ pg. 8)

### Aspect ratio is strange

If the aspect ratio of the video you are playing is strange, change the setting in "16:9 OUTPUT". (☞ pg. 34, 35)



### The remote control does not work.

- "REMOTE" is set to "OFF".
- Set "REMOTE" to "ON". (☞ pg. 34)
- The remote control does not point at the remote sensor.
- Point at the remote sensor. (☞ pg. 24)
- The remote control batteries are exhausted.
- Replace the batteries with fresh ones. (☞ pg. 24)



Displays the battery remaining power.

### Remaining power level



High

Exhausted

As the battery power comes close to nil, the battery remaining power indicator blinks. When the battery power is exhausted, power turns off automatically.

### TAPE END

Appears when the tape ends during recording or playback.

### LENS CAP

Appears for 5 seconds after power is turned on if the lens cap is attached or when it is dark.

### A. DUB ERROR!

<CANNOT DUB ON A LP RECORDED TAPE>  
<CANNOT DUB ON A 16BIT RECORDING>  
<CHECK TAPE'S ERASE PROTECTION TAB>

- Appears if Audio Dubbing is attempted on a blank portion of a tape. (☞ pg. 45)
- Appears if Audio Dubbing is attempted on a tape recorded in the LP mode. (☞ pg. 45)
- Appears if Audio Dubbing is attempted on a tape recorded in 16-BIT audio. (☞ pg. 45)

- Appears if **A. DUB** (⊖) on the remote control is pressed when the erase protection tab is set to "SAVE". (☞ pg. 45)

### INSERT ERROR!

<CANNOT EDIT ON A LP RECORDED TAPE>  
<CHECK TAPE'S ERASE PROTECTION TAB>  
<CANNOT EDIT ON A BLANK PORTION>

- Appears if Insert Editing is attempted on a tape recorded in the LP mode. (☞ pg. 45)
- Appears if **INSERT** (⊕) on the remote control is pressed when the erase protection tab is set to "SAVE". (☞ pg. 45)
- Appears if Insert Editing is attempted on a blank portion of a tape. (☞ pg. 45)

### MEMORY IS FULL

Appears when the memory card's memory is full and shooting is not possible.

### SET DATE/TIME!

- Appears when the date/time is not set. (☞ pg. 15).
- The built-in clock battery has run out and the previously set date/time has been erased.
- Consult your nearest JVC dealer for replacement.

### UNIT IN SAFEGUARD MODE REMOVE AND REATTACH BATTERY OR DC PLUG

Error indications 01, 02 or 06.

Remedy: Remove and reattach the power supply or battery.

### UNIT IN SAFEGUARD MODE EJECT AND REINSERT TAPE

Error indications 03 or 04.

Remedy: Eject the cassette and reinsert.

In the above 2 error indications, the camcorder turns off automatically. Eject the cassette once and re-insert it, then check if the indication clears. When it does, you can resume using the camcorder. If the indication remains, consult your nearest JVC dealer.

## AC Adapter

### When using the AC Adapter in areas other than the USA

The provided AC Adapter features automatic voltage selection in the AC range from 110 V to 240 V.

### USING HOUSEHOLD AC PLUG ADAPTER

In case of connecting the unit's power cord to an AC wall outlet other than American National Standard C73 series type use an AC plug adapter, called a "Siemens Plug", as shown. For this AC plug adapter, consult your nearest JVC dealer.

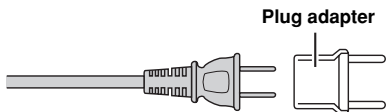

## Battery Packs

The supplied battery pack is a lithium-ion battery. Before using the supplied battery pack or an optional battery pack, be sure to read the following cautions:

- **To avoid hazards**
  - ...do not burn.
  - ...do not short-circuit the terminals. When transporting, make sure the provided battery cap is attached to the battery. If the battery cap is misplaced, carry the battery in a plastic bag.
  - ...do not modify or disassemble.
  - ...do not expose the battery to temperatures exceeding 60°C (140°F), as this may cause the battery to overheat, explode or catch fire.
  - ...use only specified chargers.
- **To prevent damage and prolong service life**
  - ...do not subject to unnecessary shock.
  - ...charge in an environment where temperatures are within the tolerances shown in the chart below. This is a chemical reaction type battery — cooler temperatures impede chemical reaction, while warmer temperatures can prevent complete charging.
  - ...store in a cool, dry place. Extended exposure to high temperatures will increase natural discharge and shorten service life.
  - ...fully charge and then fully discharge the battery every 6 months when storing the battery pack over a long period time.
  - ...remove from charger or powered unit when not in use, as some machines use current even when switched off.

Terminals

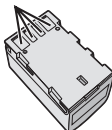

### The Benefits Of Lithium-Ion Batteries

Lithium-ion battery packs are small but have a large power capacity. However, when one is exposed to cold temperatures (below 10°C/50°F), its usage time becomes shorter and it may cease to function. If this happens, place the battery pack in your pocket or other warm, protected place for a short time, then re-attach it to the camcorder.

### NOTES:

- It is normal for the battery pack to be warm after charging, or after use.
- Temperature Range Specifications**
  - Charging: 10°C to 35°C (50°F to 95°F)
  - Operation: 0°C to 40°C (32°F to 104°F)
  - Storage: -20°C to 50°C (-4°F to 122°F)
- The lower the temperature, the longer recharging takes.
- Charging times are for a fully discharged battery pack.

## Cassettes

To properly use and store your cassettes, be sure to read the following cautions:

- **During use**
  - ...make sure the cassette bears the Mini DV mark.
  - ...be aware that recording onto prerecorded tapes automatically erases the previously recorded video and audio signals.
  - ...make sure the cassette is positioned properly when inserting.
  - ...do not load and unload the cassette repeatedly without allowing the tape to run at all. This slackens the tape and can result in damage.
  - ...do not open the front tape cover. This exposes the tape to fingerprints and dust.
- **Store cassettes**
  - ...away from heaters or other heat sources.
  - ...out of direct sunlight.
  - ...where they won't be subject to unnecessary shock or vibration.
  - ...where they won't be exposed to strong magnetic fields (such as those generated by motors, transformers or magnets).
  - ...vertically, in their original cases.



## Memory Cards

To properly use and store your memory cards, be sure to read the following cautions:

- **During use**

...make sure the memory card bears the SD or MultiMediaCard mark.

...make sure the memory card is positioned properly when inserting.

- **While the memory card is being accessed (during recording, playback, deletion, initialization, etc.)**

...never unload the memory card and never turn off the camcorder.

- **Store memory cards**

...away from heaters or other heat sources.

...out of direct sunlight.

...where they won't be subject to unnecessary shock or vibration.

...where they won't be exposed to strong magnetic fields (such as those generated by motors, transformers or magnets).

## LCD Monitor

- **To prevent damage to the LCD monitor, DO NOT**

...push it strongly or apply any shocks.

...place the camcorder with the LCD monitor on the bottom.

- **To prolong service life**

...avoid rubbing it with coarse cloth.

- **Be aware of the following phenomena for LCD monitor use. These are not malfunctions**

... While using the camcorder, the surface around the LCD monitor and/or the back of the LCD monitor may heat up.

... If you leave power on for a long time, the surface around the LCD monitor becomes hot.

## Main Unit

- **For safety, DO NOT**

...open the camcorder's chassis.

...disassemble or modify the unit.

...short-circuit the terminals of the battery pack.

Keep it away from metallic objects when not in use.

...avoid inflammables, water or metallic objects to enter the unit.

...remove the battery pack or disconnect the power supply while the power is on.

...leave the battery pack attached when the camcorder is not in use.

- **Avoid using the unit**

...in places subject to excessive humidity or dust.

...in places subject to soot or steam such as near a cooking stove.

...in places subject to excessive shock or vibration.

...near a television set.

...near appliances generating strong magnetic or electric fields (speakers, broadcasting antennas, etc.).

...in places subject to extremely high (over 40°C or 104°F) or extremely low (under 0°C or 32°F) temperatures.

- **DO NOT leave the unit**

...in places of over 50°C (122°F).

...in places where humidity is extremely low (below 35%) or extremely high (above 80%).

...in direct sunlight.

...in a closed car in summer.

...near a heater.

- **To protect the unit, DO NOT**

...allow it to become wet.

...drop the unit or strike it against hard objects.

...subject it to shock or excessive vibration during transportation.

...keep the lens directed at extremely bright objects for long periods.

...expose the lens and viewfinder's lens to direct sunlight.

...carry it by holding the LCD monitor or the viewfinder.

...swing it excessively when using the hand strap or the grip.

...swing the soft camera case excessively when the camcorder is inside it.

- **Dirty heads can cause the following problems:**



... No picture during playback.

...Blocks of noise appear during playback.

...During recording or playback, the Head Clog Warning indicator "X" appears.

...Recording cannot be performed properly.

In such cases, use an optional cleaning cassette. Insert it and play back. If the cassette is used more than once consecutively, damage to the video heads may result. After the camcorder plays back for about 20 seconds, it stops automatically. Also refer to the cleaning cassette's instructions.

If, after using the cleaning cassette, the problems still exist, consult your nearest JVC dealer.

## 50 EN CAUTIONS

Mechanical moving parts used to move the video heads and video tape tend to become dirty and worn out over time. In order to maintain a clear picture at all times, periodic check-ups are recommended after using the unit for about 1,000 hours. For periodic check-ups please consult your nearest JVC dealer.

### How To Handle A CD-ROM

- Take care not to soil or scratch the mirror surface (opposite to the printed surface). Do not write anything or put a sticker on either the front or back surface. If the CD-ROM gets dirty, gently wipe it with a soft cloth outward from the center hole.
- Do not use conventional disc cleaners or cleaning spray.
- Do not bend the CD-ROM or touch its mirror surface.
- Do not store your CD-ROM in a dusty, hot or humid environment. Keep it away from direct sunlight.

#### About moisture condensation

- You have observed that pouring a cold liquid into a glass will cause drops of water to form on the glass' outer surface. This same phenomenon occurs on the head drum of a camcorder when it is moved from a cool place to a warm place, after heating a cold room, under extremely humid conditions or in a place directly subjected to the cool air from an air conditioner.
- Moisture on the head drum can cause severe damage to the video tape, and can lead to internal damage to the camcorder itself.

#### CONDENSATION, OPERATION PAUSED PLEASE WAIT

Appears if condensation occurs. When this indication is displayed, wait more than 1 hour until condensation disappears.

#### Serious malfunctioning

If malfunctioning occurs, stop using the unit immediately and consult your local JVC dealer.

The camcorder is a microcomputer-controlled device. External noise and interference (from a TV, a radio, etc.) might prevent it from functioning properly. In such cases, first disconnect its power supply unit (battery pack, AC Adapter, etc.) and wait a few minutes and then re-connect it and proceed as usual from the beginning.

#### Declaration of Conformity

Model Number : GR-D790U  
Trade Name : JVC  
Responsible party : JVC AMERICAS  
CORP.  
Address : 1700 Valley Road  
Wayne, N. J. 07470

Telephone Number : 973-317-5000

This device complies with Part 15 of FCC Rules. Operation is subject to the following two conditions: (1) This device may not cause harmful interference, and (2) this device must accept any interference received, including interference that may cause undesired operation.

Changes or modifications not approved by JVC could void the user's authority to operate the equipment. This equipment has been tested and found to comply with the limits for a Class B digital device, pursuant to Part 15 of the FCC Rules. These limits are designed to provide reasonable protection against harmful interference in a residential installation. This equipment generates, uses, and can radiate radio frequency energy and, if not installed and used in accordance with the instructions, may cause harmful interference to radio communications. However, there is no guarantee that interference will not occur in a particular installation. If this equipment does cause harmful interference to radio or television reception, which can be determined by turning the equipment off and on, the user is encouraged to try to correct the interference by one or more of the following measures:

Reorient or relocate the receiving antenna.  
Increase the separation between the equipment and receiver.

Connect the equipment into an outlet on a circuit different from that to which the receiver is connected.

Consult the dealer or an experienced radio/TV technician for help.

This Class B digital apparatus complies with Canadian ICES-003.

Cet appareil numérique de la classe B est conforme à la norme NMB-003 du Canada.

## Camcorder

## For General

## Power supply

DC 11 V (Using AC Adapter)  
DC 7.2 V (Using battery pack)

## Power consumption

Approx. 2.2 W (2.3 W\*) (LCD monitor off, viewfinder on)

Approx. 2.7 W (2.8 W\*) (LCD monitor on, viewfinder off)

Approx. 7.5 W (Maximum; when charging the battery pack)

\* Using LED Light

## Dimensions (W x H x D)

61 mm x 94 mm x 114 mm (2-3/8" x 3-11/16" x 4-1/2") (with the LCD monitor closed and the viewfinder pushed back in)

## Weight

Approx. 410 g (0.90 lbs) (without battery, cassette and lens cap)

Approx. 480 g (1.06 lbs) (incl. battery, cassette and lens cap)

## Operating temperature

0°C to 40°C (32°F to 104°F)

## Operating humidity

35% to 80%

## Storage temperature

-20°C to 50°C (-4°F to 122°F)

## Pickup

1/6" CCD

## Lens

F 2.0, f = 2.3 mm to 78.2 mm, 34:1 power zoom lens

## Filter diameter

ø27 mm

## LCD monitor

2.7" diagonally measured, LCD panel/TFT active matrix system

## Viewfinder

Electronic viewfinder with 0.33" color LCD

## Speaker

Monaural

## LED Light

Effective distance: 1.5 m (5 ft)

## For Digital Video Camera

## Format

DV format (SD mode)

## Signal format

NTSC standard

## Recording/Playback format

Video: Digital component recording

Audio: PCM digital recording, 32 kHz 4-channel (12-BIT), 48 kHz 2-channel (16-BIT)

## Cassette

Mini DV cassette

## Tape speed

SP: 18.8 mm/s, LP: 12.5 mm/s

## Maximum recording time (using 80 min. cassette)

SP: 80 min., LP: 120 min.

## For Digital Still Camera

## Storage media

SD Memory Card/MultiMediaCard

## Compression system

JPEG (compatible)

## File size

Still image:

640 x 480 pixels

## Picture quality

2 modes (FINE/STANDARD)

## Approximate number of storable images

☞ pg. 26

## For Connectors

## AV

Video output: 1.0 V (p-p), 75 Ω, analog

Audio output: 300 mV (rms), 1 kΩ, analog, stereo

## DV

Input/output: 4-pin, IEEE1394 compliant

## USB

Mini USB-B type, USB 1.1 compliant

## AC Adapter

## Power requirement

AC 110 V to 240 V~, 50 Hz/60 Hz

## Output

DC 11 V ---, 1 A

Specifications shown are for SP mode unless otherwise indicated. E & O.E. Design and specifications subject to change without notice.

- A**  
 AC Adapter .....14  
 Audio Dubbing .....45  
 Auto/Manual Mode .....20
- B**  
 Backlight Compensation 39  
 Battery Pack .....13, 14, 48  
 Blank Search .....22  
 Bright .....15, 34, 35
- C**  
 Cam Reset .....34  
 Changing The Menu  
   Settings .....31 – 35  
 Charging The Battery Pack  
   .....13  
 Clock Adj. ....15, 34, 35  
 Connection To A Personal  
   Computer .....44  
 Connections To A TV Or  
   VCR .....23  
 Control Level .....7
- D**  
 Data Battery .....14  
 Date/Time Settings .....15  
 Deleting Files .....29  
 Demonstration Mode ....34  
 Digital Image Stabilization  
   (DIS) .....32  
 Digital Still Camera .....26  
 DPOF Setting (Digital Print  
   Order Format) ...29, 30  
 Dual Cam .....20  
 Dubbing .....41, 43
- E**  
 Effects .....41  
 Exposure Control .....38
- G**  
 Gain Up .....33
- I**  
 Image Size .....33  
 Index Playback .....27  
 Initializing A Memory Card  
   .....30
- Insert Editing ..... 45  
 Interface Shooting ..... 19  
 Iris Lock ..... 38
- J**  
 Journalistic Shooting .... 19
- L**  
 Language ..... 14, 34  
 LCD Monitor and Viewfinder  
   ..... 8, 15
- LED Light ..... 36  
 Live Slow ..... 36  
 Loading A Cassette ..... 16  
 Loading A Memory Card 17
- M**  
 Manual Focus ..... 37  
 Melody ..... 34  
 Memory Card ..... 17, 49  
 Motor Drive Mode ..... 37
- N**  
 Narration ..... 35  
 Night Alive ..... 41
- O**  
 On Screen ..... 34, 35
- P**  
 Playback Sound ..... 35  
 Playback Special Effects 25  
 Power-linked operation ... 8  
 Priority ..... 34  
 Program AE ..... 41  
 Protecting Files ..... 28
- Q**  
 Quick Review ..... 18
- R**  
 Rec Mode ..... 33, 35  
 Recording Capacity  
   Memory Card ..... 26  
   Tape ..... 18  
 Recording Media Selection  
   ..... 33  
 Remote Control ..... 24, 34  
 Resetting The File Name 28
- S**  
 Shutter Effects .....41  
 Slow-Motion Playback ...25  
 Snapshot Mode .33, 35, 37  
 Sound L/R .....35  
 Sound Mode .....33, 35  
 Speaker Volume .....21  
 Specifications .....51  
 Spot Exposure Control ...39
- T**  
 Tape Speed (REC MODE)  
   .....33, 35  
 Tele Macro .....32  
 Telephoto Setting .....32  
 Time Code .....20, 34, 35  
 Tripod Mounting .....15  
 Troubleshooting .....46, 47
- V**  
 Video/Memory Switch .....9
- W**  
 White Balance .....39  
 Wind Cut .....33  
 Wipe Or Fader Effects ...40
- Z**  
 Zooming .....19, 25, 32  
 16:9 Output .....34, 35

# JVC