

JVC

English

PORTABLE AUDIO SYSTEM

RA-P31B/RA-P30W

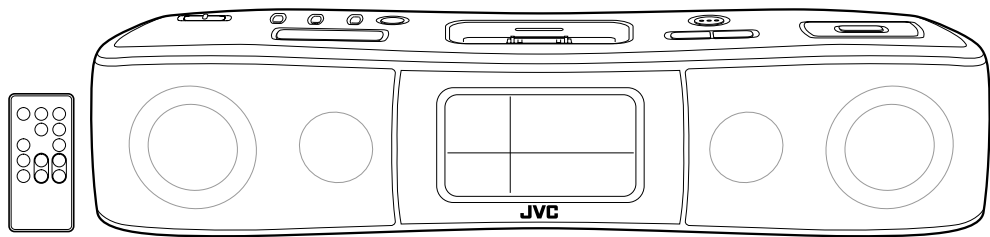

JVC

INSTRUCTIONS

LVT1848-019A [UW]

EN

©2008 Victor Company of Japan, Limited

0508KMMCREBET

Warnings, Cautions and Others

Thank you for purchasing a JVC product. Please read all instructions carefully before operation, to ensure your complete understanding and to obtain the best possible performance from the unit.

CAUTION
To reduce the risk of electrical shocks, fire, etc.:
1 Do not remove screws, covers or cabinet.
2 Do not expose this appliance to rain or moisture.

CAUTION— ⚡/I switch!
Disconnect the mains plug to shut the power off completely. When installing the apparatus ensure that the plus is easily accessible. The switch in any position does not disconnect the mains line.

Rating label is placed on the exterior of the bottom.

CAUTION
• Do not block the ventilation openings or holes. (If the ventilation openings or holes are blocked by a newspaper or cloth, etc., the heat may not be able to get out.)
• Do not place any naked flame sources, such as lighted candles, on the pparatus.
• When discarding batteries, environmental problems must be considered and local rules or laws governing the disposal of these batteries must be followed strictly.
• Do not expose this apparatus to rain, moisture, dripping or splashing and that no objects filled with liquids, such as vases, shall be placed on the apparatus.

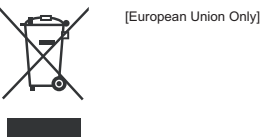
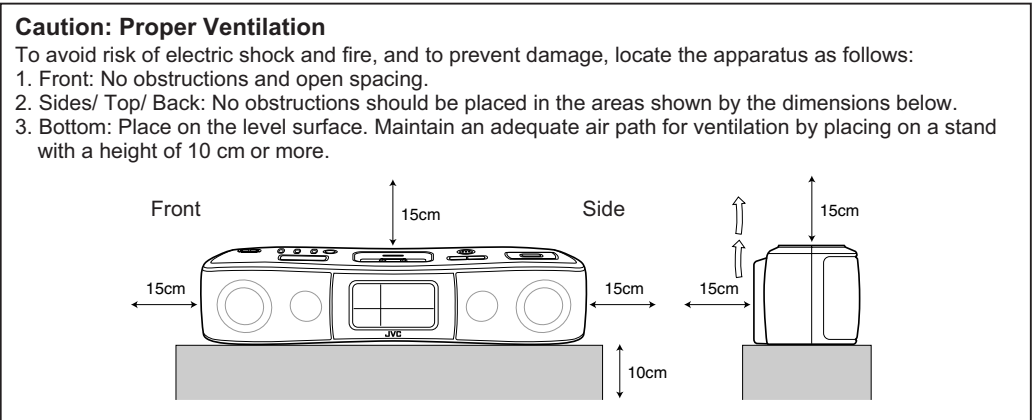

Getting Started

● Supplied Accessories

After unpacking, check to be sure that you have all the following items.

- Remote control
 - AC adapter
 - CR2025 (x2) lithium coin batteries
- One is loaded on the remote control at the factory.
AC plug adapter

● Prepare the Remote Control

- When you use the remote control for the first time, pull out the insulation sheet.

Replacing the Battery in the Remote Control

- Insert the battery into the remote control by matching the polarity (+ and –) correctly.

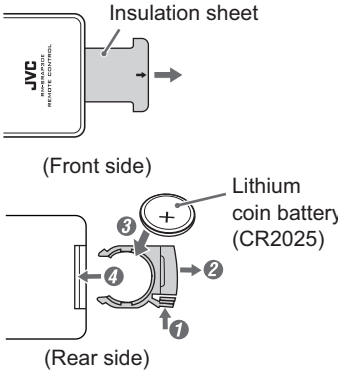

Warning

- Store the battery in a place where children cannot reach. If a child accidentally swallows the battery, consult a doctor immediately.
- Do not recharge, short, disassemble or heat the battery or dispose of it in a fire. Doing any of these things may cause the battery to give off heat, crack, or start a fire.
- Do not leave the battery with other metallic materials. Doing this may cause the battery to give off heat, crack, or start a fire.
- When throwing away or saving the battery, wrap it in tape and insulate; otherwise, the battery may start to give off heat, crack, or start a fire.
- Do not poke the battery with tweezers or similar tools. Doing this may cause the battery to give off heat, crack, or start a fire.
- Dispose of battery in the proper manner, according to federal, state, and local regulations.
- The batteries (battery pack or batteries installed) shall not be exposed to excessive heat source such as sunshine, fire or the like.

CAUTION:
Danger of explosion if battery is incorrectly replaced.
Replace only with the same or equivalent type.

● Preparation of the Unit

◆ Loading batteries for the Unit (The battery power supply)

Insert three batteries to each compartment (six batteries total). Be sure to match the poles (+/-) correctly. While the AC adapter is connected to the wall outlet, the unit works without batteries.

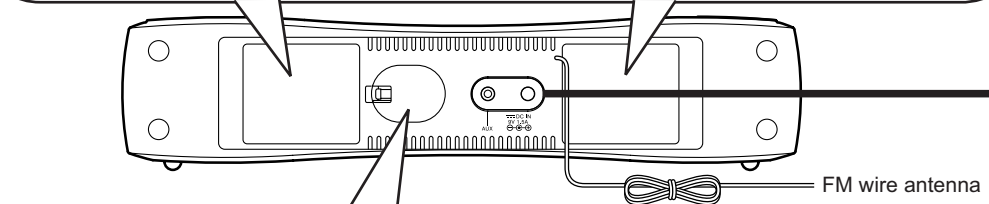
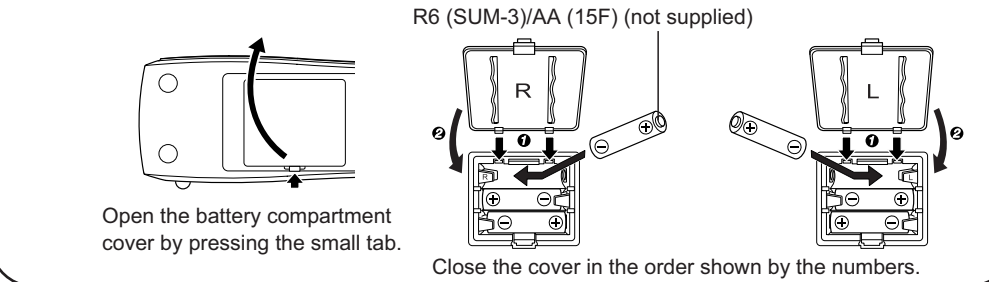

◆ Loading batteries for the Clock

Be sure to match the poles (+/-) correctly.

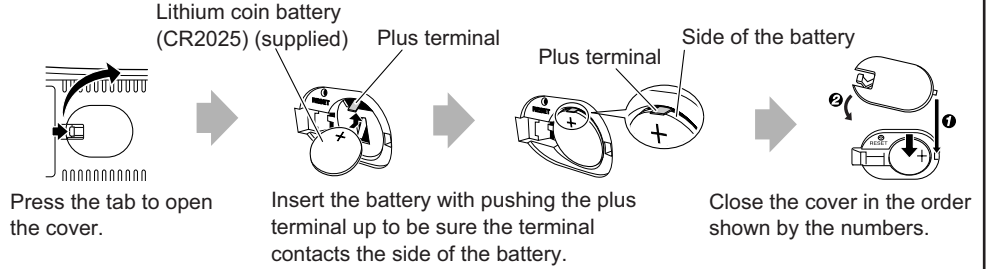

Time to change the battery
As the battery is running out, the display indication dims or the alarm may beep at the time the alarm is not set at. Replace the battery in such cases.

◆ Connecting the AC adapter

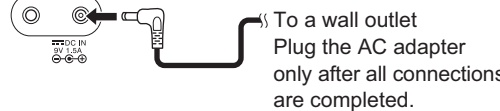

AC adapter (supplied)
RA-P31B: AA-R9032 / RA-P30W: AA-R9029

CAUTION:
To avoid risk of fire, and to prevent damage.
• Do not use AC adapters except for the supplied AC adapter.
• Do not use the supplied AC adapter for other equipment.

Basic and Common Operations

Press	Functions
	• Light the display screen for 5 seconds when the power is turned off. • Temporarily stop the alarm sound when the alarm is ringing (SNOOZE). (see "To stop the alarm sound")

Press	Functions
	Turns on or off the power

When the power is turned off at volume level "15" or higher, the unit automatically sets the volume level to "14" the next time it is turned on.

Press	Functions
	Adjust the volume level from 00 to a maximum of 20. -: Turn down the volume. +: Turn up the volume.

Press	Functions
	• Switch on/off the backlight when the button is held down. • Switch FM stereo/monaural when FM is selected.
	(see "Playing back from iPod" and "Listening to FM Broadcasts")

Press	Functions
	Select a source iPod → FM → AUX

See "How to set the time and use the alarm"

Remote control sensor

Press	Functions
	• Switch on/off the SURROUND. You can enjoy music with spatial and deep sound in this mode. (The mode is not effective when the monaural is selected.)
	• While the clock or the alarm time are set, return to the previous item. See "How to set the time and use the alarm"

Press	Functions
	ALARM 1
	ALARM 2
	Off: current time / On: alarm time
	Off: alarm off / On: alarm on / Blinking: alarm sounding (When "TIMER PLAY" is set)
	Blinks while snoozing (the alarm is paused)
	Lighting when the sleep mode is selected.

Press	Functions
	Switch on/off the backlight when the button is held down.
	(see "Playing back from iPod" and "Listening to FM Broadcasts")

Press	Functions
	Select a source iPod → FM → AUX

Press	Functions
	Switch on/off the SURROUND. You can enjoy music with spatial and deep sound in this mode. (The mode is not effective when the monaural is selected.)
	While the clock or the alarm time are set, return to the previous item. See "How to set the time and use the alarm"

Press	Functions
	ALARM 1
	ALARM 2
	Off: current time / On: alarm time
	Off: alarm off / On: alarm on / Blinking: alarm sounding (When "TIMER PLAY" is set)
	Blinks while snoozing (the alarm is paused)
	Lighting when the sleep mode is selected.

Press	Functions
	Switch on/off the backlight when the button is held down.
	(see "Playing back from iPod" and "Listening to FM Broadcasts")

Press	Functions
	Select a source iPod → FM → AUX

Press	Functions
	Switch on/off the SURROUND. You can enjoy music with spatial and deep sound in this mode. (The mode is not effective when the monaural is selected.)
	While the clock or the alarm time are set, return to the previous item. See "How to set the time and use the alarm"

Press	Functions
	ALARM 1
	ALARM 2
	Off: current time / On: alarm time
	Off: alarm off / On: alarm on / Blinking: alarm sounding (When "TIMER PLAY" is set)
	Blinks while snoozing (the alarm is paused)
	Lighting when the sleep mode is selected.

Press	Functions
	Switch on/off the backlight when the button is held down.
	(see "Playing back from iPod" and "Listening to FM Broadcasts")

Press	Functions
	Select a source iPod → FM → AUX

Press	Functions
	Switch on/off the SURROUND. You can enjoy music with spatial and deep sound in this mode. (The mode is not effective when the monaural is selected.)
	While the clock or the alarm time are set, return to the previous item. See "How to set the time and use the alarm"

Press	Functions
	ALARM 1
	ALARM 2
	Off: current time / On: alarm time
	Off: alarm off / On: alarm on / Blinking: alarm sounding (When "TIMER PLAY" is set)
	Blinks while snoozing (the alarm is paused)
	Lighting when the sleep mode is selected.

Press	Functions
	Switch on/off the backlight when the button is held down.
	(see "Playing back from iPod" and "Listening to FM Broadcasts")

Press	Functions
	Select a source iPod → FM → AUX

Press	Functions
	Switch on/off the SURROUND. You can enjoy music with spatial and deep sound in this mode. (The mode is not effective when the monaural is selected.)
	While the clock or the alarm time are set, return to the previous item. See "How to set the time and use the alarm"

Press	Functions
	ALARM 1
	ALARM 2
	Off: current time / On: alarm time
	Off: alarm off / On: alarm on / Blinking: alarm sounding (When "TIMER PLAY" is set)
	Blinks while snoozing (the alarm is paused)
	Lighting when the sleep mode is selected.

Press	Functions
	Switch on/off the backlight when the button is held down.
	(see "Playing back from iPod" and "Listening to FM Broadcasts")

Press	Functions
	Select a source iPod → FM → AUX

Press	Functions
	Switch on/off the SURROUND. You can enjoy music with spatial and deep sound in this mode. (The mode is not effective when the monaural is selected.)
	While the clock or the alarm time are set, return to the previous item. See "How to set the time and use the alarm"

Press	Functions
	ALARM 1
	ALARM 2
	Off: current time / On: alarm time
	Off: alarm off / On: alarm on / Blinking: alarm sounding (When "TIMER PLAY" is set)
	Blinks while snoozing (the alarm is paused)
	Lighting when the sleep mode is selected.

Press	Functions
	Switch on/off the backlight when the button is held down.
	(see "Playing back from iPod" and "Listening to FM Broadcasts")

Press	Functions
	Select a source iPod → FM → AUX

Press	Functions
	Switch on/off the SURROUND. You can enjoy music with spatial and deep sound in this mode. (The mode is not effective when the monaural is selected.)
	While the clock or the alarm time are set, return to the previous item. See "How to set the time and use the alarm"

Press	Functions
	ALARM 1
	ALARM 2
	Off: current time / On: alarm time
	Off: alarm off / On: alarm on / Blinking: alarm sounding (When "TIMER PLAY" is set)
	Blinks while snoozing (the alarm is paused)
	Lighting when the sleep mode is selected.

Press	Functions
	Switch on/off the backlight when the button is held down.
	(see "Playing back from iPod" and "Listening to FM Broadcasts")

Press	Functions
	Select a source iPod → FM → AUX

Press	Functions
	Switch on/off the SURROUND. You can enjoy music with spatial and deep sound in this mode. (The mode is not effective when the monaural is selected.)
	While the clock or the alarm time are set, return to the previous item. See "How to set the time and use the alarm"

Press	Functions
	ALARM 1
	ALARM 2
	Off: current time / On: alarm time
	Off: alarm off / On: alarm on / Blinking: alarm sounding (When "TIMER PLAY" is set)
	Blinks while snoozing (the alarm is paused)
	Lighting when the sleep mode is selected.

Press	Functions
	Switch on/off the backlight when the button is held down.
	(see "Playing back from iPod" and "Listening to FM Broadcasts")

Press	Functions
	Select a source iPod → FM → AUX

Press	Functions
	Switch on/off the SURROUND. You can enjoy music with spatial and deep sound in this mode. (The mode is not effective when the monaural is selected.)
	While the clock or the alarm time are set, return to the previous item. See "How to set the time and use the alarm"

Press	Functions
	ALARM 1
	ALARM 2
	Off: current time / On: alarm time
	Off: alarm off / On: alarm on / Blinking: alarm sounding (When "TIMER PLAY" is set)
	Blinks while snoozing (the alarm is paused)
	Lighting when the sleep mode is selected.

Press	Functions
	Switch on/off the backlight when the button is held down.
	(see "Playing back from iPod" and "Listening to FM Broadcasts")

Press	Functions
	Select a source iPod → FM → AUX

Press	Functions
	Switch on/off the SURROUND. You can enjoy music with spatial and deep sound in this mode. (The mode is not effective when the monaural is selected.)
	While the clock or the alarm time are set, return to the previous item. See "How to set the time and use the alarm"

Press	Functions
	ALARM 1
	ALARM 2
	Off: current time / On: alarm time
	Off: alarm off / On: alarm on / Blinking: alarm sounding (When "TIMER PLAY" is set)
	Blinks while snoozing (the alarm is paused)
	Lighting when the sleep mode is selected.

Press	Functions
	Switch on/off the backlight when the button is held down.
	(see "Playing back from iPod" and "Listening to FM Broadcasts")

Press	Functions
	Select a source iPod → FM → AUX

Press	Functions
	Switch on/off the SURROUND. You can enjoy music with spatial and deep sound in this mode. (The mode is not effective when the monaural is selected.)
	While the clock or the alarm time are set, return to the previous item. See "How to set the time and use the alarm"

Press	Functions
	ALARM 1
	ALARM 2
	Off: current time / On: alarm time
	Off: alarm off / On: alarm on / Blinking: alarm sounding (When "TIMER PLAY" is set)
	Blinks while snoozing (the alarm is paused)
	Lighting when the sleep mode is selected.

Press	Functions
	Switch on/off the backlight when the button is held down.
	(see "Playing back from iPod" and "Listening to FM Broadcasts")

Press	Functions
	Select a source iPod → FM → AUX

Press	Functions
	Switch on/off the SURROUND. You can enjoy music with spatial and deep sound in this mode. (The mode is not effective when the monaural is selected.)
	While the clock or the alarm time are set, return to the previous item. See "How to set the time and use the alarm"

Press	Functions
	ALARM 1
	ALARM 2
	Off: current time / On: alarm time
	Off: alarm off / On: alarm on / Blinking: alarm sounding (When "TIMER PLAY" is set)
	Blinks while snoozing (the alarm is paused)
	Lighting when the sleep mode is selected.

Press	Functions
	Switch on/off the backlight when the button is held down.
	(see "Playing back from iPod" and "Listening to FM Broadcasts")

Press	Functions
	Select a source iPod → FM → AUX

Press	Functions
	Switch on/off the SURROUND. You can enjoy music with spatial and deep sound in this mode. (The mode is not effective when the monaural is selected.)
	While the clock or the alarm time are set, return to the previous item. See "How to set the time and use the alarm"

Press	Functions
	ALARM 1
	ALARM 2
	Off: current time / On: alarm time
	Off: alarm off / On: alarm on / Blinking: alarm sounding (When "TIMER PLAY" is set)
	Blinks while snoozing (the alarm is paused)
	Lighting when the sleep mode is selected.

Press	Functions
	Switch on/off the backlight when the button is held down.
	(see "Playing back from iPod" and "Listening to FM Broadcasts")

Press	Functions
	Select a source iPod → FM → AUX

Press	Functions
	Switch on/off the SURROUND. You can enjoy music with spatial and deep sound in this mode. (The mode is not effective when the monaural is selected.)
	While the clock or the alarm time are set, return to the previous item. See "How to set the time and use the alarm"

Press	Functions
	ALARM 1
	ALARM 2
	Off: current time / On: alarm time
	Off: alarm off / On: alarm on / Blinking: alarm sounding (When "TIMER PLAY" is set)
	Blinks while snoozing (the alarm is paused)
	Lighting when the sleep mode is selected.

Press	Functions
	Switch on/off the backlight when the button is held down.
	(see "Playing back from iPod" and "Listening to FM Broadcasts")

Press	Functions
	Select a source iPod → FM → AUX

Press	Functions
	Switch on/off the SURROUND. You can enjoy music with spatial and deep sound in this mode. (The mode is not effective when the monaural is selected.)
	While the clock or the alarm time are set, return to the previous item. See "How to set the time and use the alarm"

Press	Functions
	ALARM 1
	ALARM 2
	Off: current time / On: alarm time
	Off: alarm off / On: alarm on / Blinking: alarm sounding (When "TIMER PLAY" is set)
	Blinks while snoozing (the alarm is paused)
	Lighting when the sleep mode is selected.

Press	Functions
	Switch on/off the backlight when the button is held down.
	(see "Playing back from iPod" and "Listening to FM Broadcasts")

Press	Functions
	Select a source iPod → FM → AUX

Press	Functions
	Switch on/off the SURROUND. You can enjoy music with spatial and deep sound in this mode. (The mode is not effective when the monaural is selected.)
	While the clock or the alarm time are set, return to the previous item. See "How to set the time and use the alarm"

Press	Functions
	ALARM 1
	ALARM 2
	Off: current time / On: alarm time
	Off: alarm off / On: alarm on / Blinking: alarm sounding (When "TIMER PLAY" is set)
	Blinks while snoozing (the alarm is paused)
	Lighting when the sleep mode is selected.

Press	Functions
	Switch on/off the backlight when the button is held down.
	(see "Playing back from iPod" and "Listening to FM Broadcasts")

Press	Functions
	Select a source iPod → FM → AUX

Press	Functions
	Switch on/off the SURROUND. You can enjoy music with spatial and deep sound in this mode. (The mode is not effective when the monaural is selected.)
	While the clock or the alarm time are set, return to the previous item. See "How to set the time and use the alarm"

Press	Functions
	ALARM 1
	ALARM 2
	Off: current time / On: alarm time
	Off: alarm off / On: alarm on / Blinking: alarm sounding (When "TIMER PLAY" is set)
	Blinks while snoozing (the alarm is paused)
	Lighting when the sleep mode is selected.

Press	Functions
	Switch on/off the backlight when the button is held down.
	(see "Playing back from iPod" and "Listening to FM Broadcasts")

Press	Functions
	Select a source iPod → FM → AUX

Press	Functions
	Switch on/off the SURROUND. You can enjoy music with spatial and deep sound in this mode. (The mode is not effective when the monaural is selected.)
	While the clock or the alarm time are set, return to the previous item. See "How to set the time and use the alarm"

Press	Functions
	ALARM 1
	ALARM 2
	Off: current time / On: alarm time
	Off: alarm off / On: alarm on / Blinking: alarm sounding (When "TIMER PLAY" is set)
	Blinks while snoozing (the alarm is paused)
	Lighting when the sleep mode is selected.

Press	Functions

Operating on the Remote Control

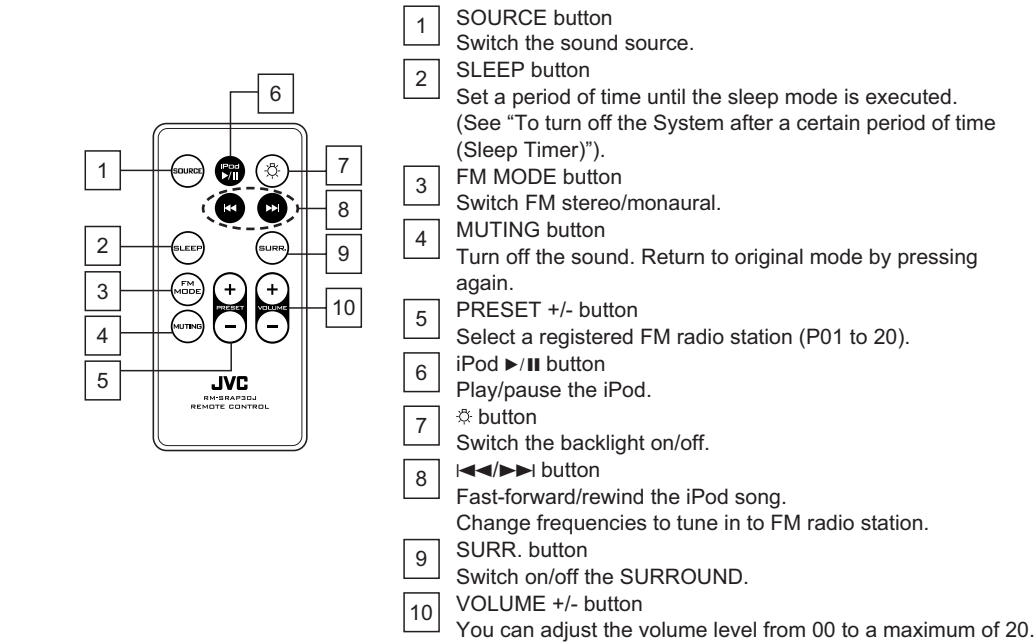

NOTES

- Point the remote control at the remote control sensor on the front panel.
- The remote control sensor is designed to receive signals from up to approximately 7 m distance when the remote control is pointed directly. If the remote control is pointed with an angle, the distance may become shorter.

To turn off the System after a certain period of time (Sleep Timer)

- 1 Press the SLEEP button repeatedly to specify the time (in minutes) as follows:

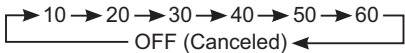

- 2 Wait until the set time goes off.

- To check the time remaining before the shut-off time, press SLEEP button once.
If you press the button repeatedly, you can change the shut-off time.
- After the system is turned off with the Sleep Timer, you cannot operate any button other than the SNOOZE/ LIGHT button. To operate the system as usual, press ⏻ to turn off the power and then turn on the power again.

NOTES

- Sleep Timer and "ALARM-TIMER PLAY" cannot be selected at the same time. If "TIMER PLAY" is selected, Sleep Timer will be cancelled.
- Sleep Timer and "ALARM-BUZZER" can be selected at the same time.

How to set the time and use the alarm

Switch/Press	Functions
	Switch the alarm on/off. OFF: turn off the alarm (BUZZER/ TIMER PLAY). BUZZER: alarm on (buzzer sound) TIMER PLAY: alarm on (iPod/FM radio)
	• Change the time to the alarm time while the current time is displayed. • Switch between "ALARM 1" and "ALARM 2" while the alarm time is displayed. • Press and hold this button to select the current time/alarm time setting mode.
	Change the values for the time setting.
	• Return to the previous item.

Setting the Clock

- 1 Press and hold the SET button. → The year display starts flashing.
- 2 While flashing, set each item with the DOWN/UP buttons.
- 3 Press the SET button.
 - When the SET button is pressed, the flashing items will change in the following order.

Year → Month → Day → 12/24-hour time → Hour → Min. → time display

- The time is set when switching to time display from Minutes.

NOTES

- The time can be set both when the power is on and off.
- To modify the setting, start again from step 1.

Setting the alarm (ALARM-BUZZER)

- 1 Press the SET button to select "ALARM 1" or "ALARM 2". → The selected icon starts lighting.
- 2 Press and hold the SET button. → "ON" or "OFF" and starts flashing.
- 3 Use the DOWN/UP button to select "ON" and press the SET button. → starts lighting and the time display starts flashing.
 - When "OFF" is selected, goes off and the alarm setting is disabled. The display returns to the current time.
 - To separate "ALARM 1" and "ALARM 2", set to on/off for each.
- 4 While flashing, set each item with the DOWN/UP button.
 - When the SET button is pressed, the flashing items will change in the following order.

Hour → Min. → TIMER PLAY time (10 to 30) → time display

- It is not necessary to set the "TIMER PLAY" time at this point.

Listening to FM Broadcasts

Press		Functions
Unit	Remote control	
FM MODE/		Switch FM stereo/monaural. When there is too much static in an FM stereo broadcast, you can reduce the static by switching to monaural reception. Press again to switch back to stereo reception. If the broadcast is not FM stereo, the sound becomes monaural, even if FM stereo is selected.
	—	• Switch channel display / frequency display. Channel display is automatically switched to frequency display after approx. 3 seconds. <div><div>STEREO FM 87.50 MHz</div><div>STEREO FM P01</div><div>Frequency display</div><div>Channel display</div></div> <ul style="list-style-type: none">• To register a channel, press and hold this button. (see "Presetting Stations")
		Select a channel from P01 to P20. (The unit button can be used when channel display is selected.)
		Change frequencies to tune in to FM radio station. (The unit button can be used when frequency display is selected.) <ul style="list-style-type: none">• Press and hold to search broadcast stations automatically. The search is finished when the signal is received. Press again while searching to quit search.

Listening to FM radio

Stretch out the wire antenna located on the rear of the unit before using.

- 1 Turn the Unit power on.
- 2 Select "FM" with the SOURCE button.
- 3 Select a station with the ◀◀/▶▶ button.

Presetting Stations

- 1 Select "FM" with the SOURCE button, and switch to channel display with ►/■ button.
- 2 Use the ◀◀/▶▶ button to select the channel number (P01 to P20) to be registered.
- 3 Press and hold the ►/■ button. → The channel number starts flashing.

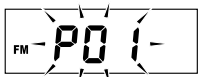

- 4 Use the ◀◀/▶▶ button to select the frequency (87.50 MHz to 108.00 MHz) of the station that you wish to register.
- 5 Press the ►/■ button → The selected frequency will be registered.



- To confirm registration, select the registered channel number (P01 to P20), and press ►/■ button to display frequency.

Playing back from iPod

Setting the iPod on the unit

- 1 Insert the Dock adapter supplied with the iPod to the unit.
If the Dock adapter was not supplied with your iPod, purchase the Dock adapter from Apple Inc.
For details, visit the Apple's website.
<<http://www.apple.com>>

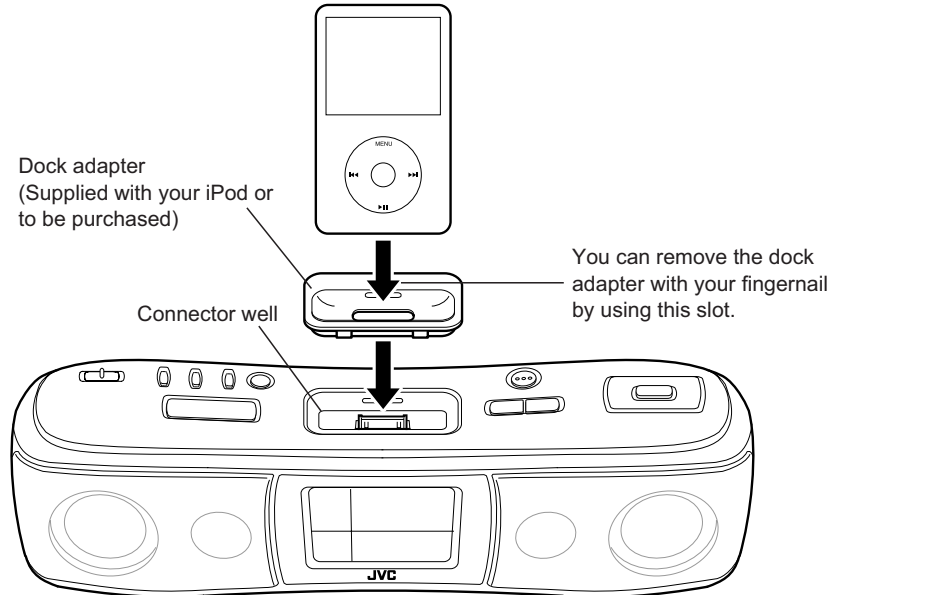

- 2 Connect the iPod to the connector plug of the unit.
 - The connector plug is protected with a cover when it is first purchased. Please remove the cover before operating the unit.
 - When the iPod is not connected, insert the terminal cover. This prevents dust from entering and possibly damaging the unit.
 - Always set volume to the minimum level when connecting or disconnecting iPod.
 - When you connect your iPod to the unit, make sure you insert it all the way.
 - When disconnecting the iPod, make sure that the System is turned off.

● iPod Compatibility Chart

iPod touch 8GB/16GB
iPod classic 80GB/160GB
iPod video (5th Generation) 30GB/60GB/80GB
iPod photo (4th Generation) 20GB/30GB/40GB/60GB
iPod nano (3rd Generation) 4GB/8GB
iPod nano (2nd Generation) 2GB/4GB/8GB
iPod nano 1GB/2GB/4GB
iPod mini (2nd Generation) 4GB/6GB
iPod mini 4GB

Playing back from other equipment

Connecting other equipment

Connect an external device to the AUX jack on the rear of the unit using a stereo mini plug cord (not supplied).

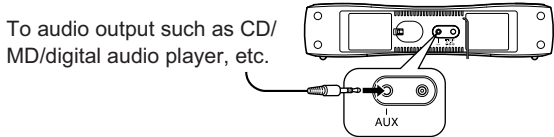

NOTE

- Always set volume to the minimum level when connecting or disconnecting the other equipment.

Troubleshooting

If you are having a problem with your System, check this list for a possible solution before calling for service.

In These Cases	Check the following points
Power does not come on.	• AC adapter is not inserted securely. Plug in securely. • The batteries are exhausted.
No longer works. Cannot set the iPod.	Press the RESET button (see "Resetting the unit"). <ul style="list-style-type: none">• Is the Dock adapter properly mounted on the unit? Make sure to mount the Dock adapter properly.
Cannot operate iPod.	<ul style="list-style-type: none">• Is the iPod firmly connected to the connector plug of the unit?• Is the iPod properly functioning? Test the iPod functions in stand alone condition.
iPod cannot be charged.	<ul style="list-style-type: none">• Is the iPod firmly connected to the connector plug of the unit?• Is the AC adapter connected? The iPod cannot be charged while the Unit is operated on batteries.
Hard to listen to broadcasts because of noise.	The FM antenna is not properly extended and positioned.
Unable to operate the System from the remote control.	<ul style="list-style-type: none">• The path between the remote control and the remote sensor on the System is blocked.• The batteries are exhausted.
When the volume level is manually set higher than "08", the unit automatically lowers the level to "08".	The unit's battery runs low (The "----" (Low battery) appears on the display). Replace the batteries with new ones.

● Resetting the unit

- If "Troubleshooting" does not eliminate malfunctioning (failure to operate or display properly, etc.), press the RESET button on the rear of the unit with something having a sharp point, while the unit is turned on. After pressing RESET button, unplug the AC adapter and wait a while before plugging it again.
- When using RESET button, make sure the lithium coin battery is loaded.
 - While resetting the unit, the clock is also reset. Adjust the clock after resetting the unit.

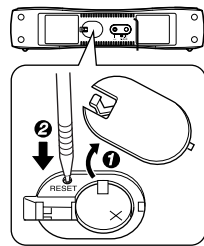

Listening to the iPod

- 1 Connect the iPod to the unit.
- 2 Turn the unit power on.
- 3 Select "iPod" with the SOURCE button.
When iPod is selected as sound source, it automatically starts playback.

Press		Functions
Unit	Remote control	
		Playback/Pause Press and hold this button to switch the iPod to sleep mode.
		Next song / fast forward (press and hold)
		Previous song (Press this button during playback to jump back to the beginning of the track.) / fast rewind (press and hold)

Charging the iPod

- The iPod is charged while it is set on the unit when the Unit power is on.
- Connect the AC adapter to the Unit. The iPod battery is not charged while the Unit is operated on the battery power supply.
 - The iPod is charged regardless of the sound source selected on the Unit.
 - See the iPod instruction manual about charging times.

NOTES

- This unit can only play the iPod audio.
You can use the iPod video function and hear the audio but cannot play the video.
- Do not carry the System with iPod connected. You might drop it down or it might cause damages to the connector part.
- Do not touch or hit the iPod terminal pins or the connector pins directly. It might cause damages to the connector part.
- If the iPod does not play correctly, please update your iPod software to the latest version. - For details about updating your iPod, check on the Apple web site <<http://www.apple.com>>.
- iPod is a trademark of Apple Inc., registered in the U.S. and other countries.
- JVC is not responsible for any loss of or damage to iPod that might result from the use of this product.
- Sound distortion may occur when playing back audio sources with high recording levels. When distortion occurs, it is recommended to turn off the equalizer of the iPod. For information on operating the iPod, see the iPod instruction manual.
- If you do not turn on the power of this unit and only connect the iPod to this unit, power may be supplied to the iPod.

Listening to external devices

- 1 Turn the unit power on.
- 2 Select "AUX" with the SOURCE button.
- 3 Start playback on the external device.
- 4 Adjust the volume.

Specifications

Model	RA-P31B/RA-P30W	
Type	Portable audio system	
Amplifier	Power Output	4 W x 2 1 kHz 10 % THD, 6 Ω
Input Sensitivity/ Impedance	AUX Input	250 mV/47 kΩ
Tuner	Band	FM
	Tuning Range	87.50 MHz - 108.00 MHz
	Frequency Step	100 kHz
	Preset Stations	20
Speaker	1 way full range, diameter 50 mm x 2	
Input Terminal	External DC IN (for AC adapter)	
	AUX IN (mini jack)	
iPod connector	Output Power : DC 5 V ≐ 500 mA	
Power Source	DC 9 V ≐ 1.5 A (EXTERNAL DC IN)	
	DC 9 V ≐ (SIZE R6, AA BATTERY OR EQUIVALENT x 6) DC 3 V ≐ (CR2025, for the clock)	
AC adapter	Input : AC 110-240 V~, 50/60 Hz 0.5A	
	Output : DC 9 V ≐ 1.5 A	
Dimensions (W x H x D)	(W) 322 mm x (H) 72 mm x (D) 85 mm	
Weight (Without batteries)	0.7 kg	
Accessory	See Supplied Accessories	

Specifications and appearance are subject to change without prior notice.