



**Instruction Manual**  
Video Camera Housing for  
SONY® HDR-FX1 & HVR-Z1

Before operating the unit, please read this manual carefully. Keep it for future reference.

**PHENOM FXZ1**

Marine housing for the Sony HDR-FX1 & HVR-Z1

Amphibico launches its all new, full-featured PHENOM FXZ1 HDV marine housing. Following in the same highly innovative footsteps as the Amphibico VH1000 and subsequent world-renowned underwater video housings, the new PHENOM FXZ1 will be just that.....PHENOMENAL!!

This full featured housing will provide access to all key camcorder functions to depths of 330 feet (100 meters). Amphibico's high quality full zoom-through 94° optics will complement the package.

**FEATURES**

- o 14 Electronic push button controls
- o 6 Mechanical controls
- o Power On/Off
- o Record/Standby
- o Variable speed ZOOM T/W
- o True manual focus (Electronic gear driven)
- o "One Push" manual white balance
- o Shutter speed adjustment
- o Iris (Auto / Manual), full control
- o Gain adjustment
- o Access to the camcorder ND filters
- o Effects
- o Screen Display
- o Dual Video Signals
- o Switch able audio Channels
- o Access to the camcorder's menu
- o Toggle between Manual and Auto Focus
- o VCR functions: Play, Stop, Rewind, Fast Forward, Pause
- o Index marker with index search functions
- o Flashing Green Tally Light when Recording
- o Infrared interface for accessory remote carry handle
- o Fire Wire capability for direct download
- o Electronic Moisture Sensor Alarm
- o Remote On/Off light switches

<b>Unpacking Your Housing.....</b>	<b>3</b>
<b>Housing Features and Controls.....</b>	<b>4-5</b>
<b>Preparing the Camera &amp; Housing.....</b>	<b>6-10</b>
Opening the housing.....	6
Removing the saddle.....	6
Setting the camcorder.....	6
Setting the saddle.....	7
Installing the saddle.....	7
Connecting the saddle.....	7
Placing the camcorder.....	8
Closing the housing.....	8
Adjusting the IRIS and MENU knobs.....	9
Viewfinder eyepiece adjustment.....	9
Replacing the bayonet lens.....	9
Installing accessories.....	10
Water Entry.....	10
<b>Housing Camera &amp; Operations.....</b>	<b>11-15</b>
Power ON/OFF.....	11
Power save.....	11
Mode settings.....	11
Zooming.....	12
Focusing.....	12
White balance.....	13
Light buttons.....	13
Effects.....	14
Review.....	14
Index marker.....	14
Back light.....	14
Display.....	14
Menu.....	15
Iris adjustment knob.....	15
ND filter knob.....	15
Gain.....	15
Shutter.....	15
<b>Maintenance.....</b>	<b>16</b>
Servicing O-rings.....	16
<b>Specifications.....</b>	<b>17</b>
<b>Optional Accessories.....</b>	<b>18</b>
<b>General Shooting Tips.....</b>	<b>19</b>
<b>Warranty.....</b>	<b>20</b>

Before unpacking your housing kit, inspect the shipping box as well as all contents for damage during shipping. If damage has occurred, please contact the shipping company immediately.

Every Amphibico Housing is pressure tested prior to shipping. However, damage may have occurred during shipping. It is strongly recommended to test dive the housing once without camcorder installed to insure the housing is water tight.

This instruction manual assumes that the user is already familiar with the SONY® HDR-FX1 and HVR-Z1 camcorders. If not, please read instruction manuals thoroughly before beginning to use the housing.

Your PHENOM FXZ1 camcorder housing comes to you as follows:

- |  |   |
|--|---|
| A) Marine Housing  | G) Carry Handle                                       |
| B) 94° wide Angle bayonet mounted lens   | H) Allen Key 5/32" (for carry handle)                 |
| C) Removable / lockable camcorder saddle<br>(shipped in its position inside the housing) | I) Allen Key 1/16" (for lead ballasts)                |
| D) Front & rear neoprene covers for the lens and viewfinder                              | J) Allen Key 5/64" (for menu navigation & Iris wheel) |
| E) O-ring kit with container of silicone grease  |   |
| F) Instruction manual and warranty card  |   |

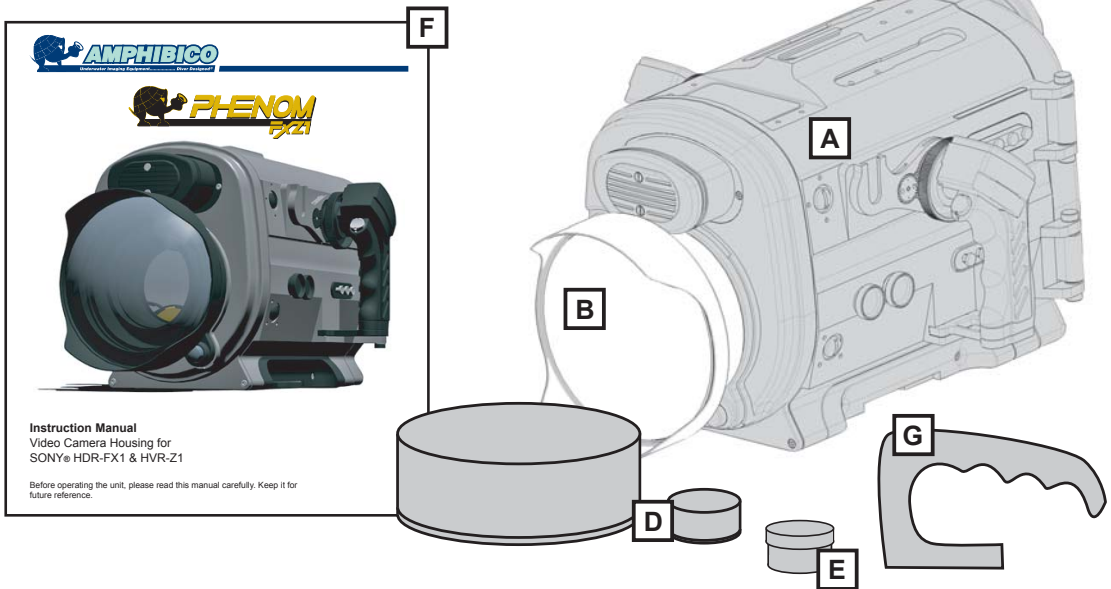

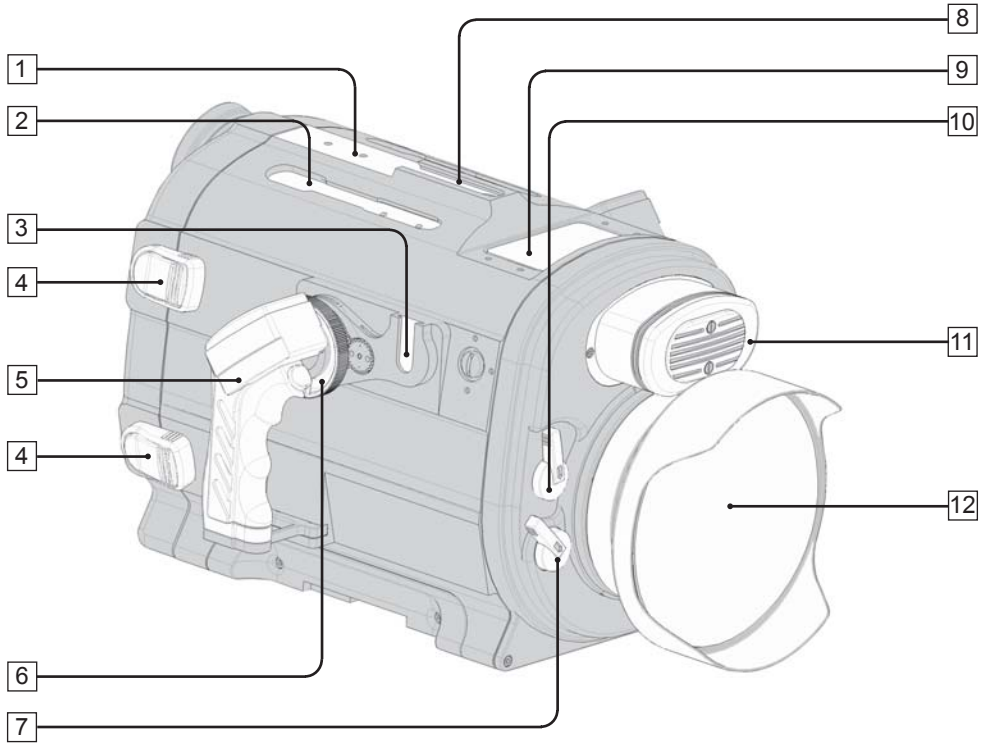

- |   |                              |    |                                    |
|---|------------------------------|----|------------------------------------|
| 1 | Accessory Mounting Holes     | 7  | Color Correction Flip Filter Lever |
| 2 | Accessory Mounting Top Rail  | 8  | Carry Handle Mounting Rail         |
| 3 | Accessory Mounting Side Rail | 9  | LCD Display Window                 |
| 4 | Safety Latch                 | 10 | Spare Flip Filter Lever            |
| 5 | Right Electronic Grip        | 11 | Dual Hydrophone                    |
| 6 | Zoom Wheel                   | 12 | Bayonet Mount Wide Angle Lens Port |

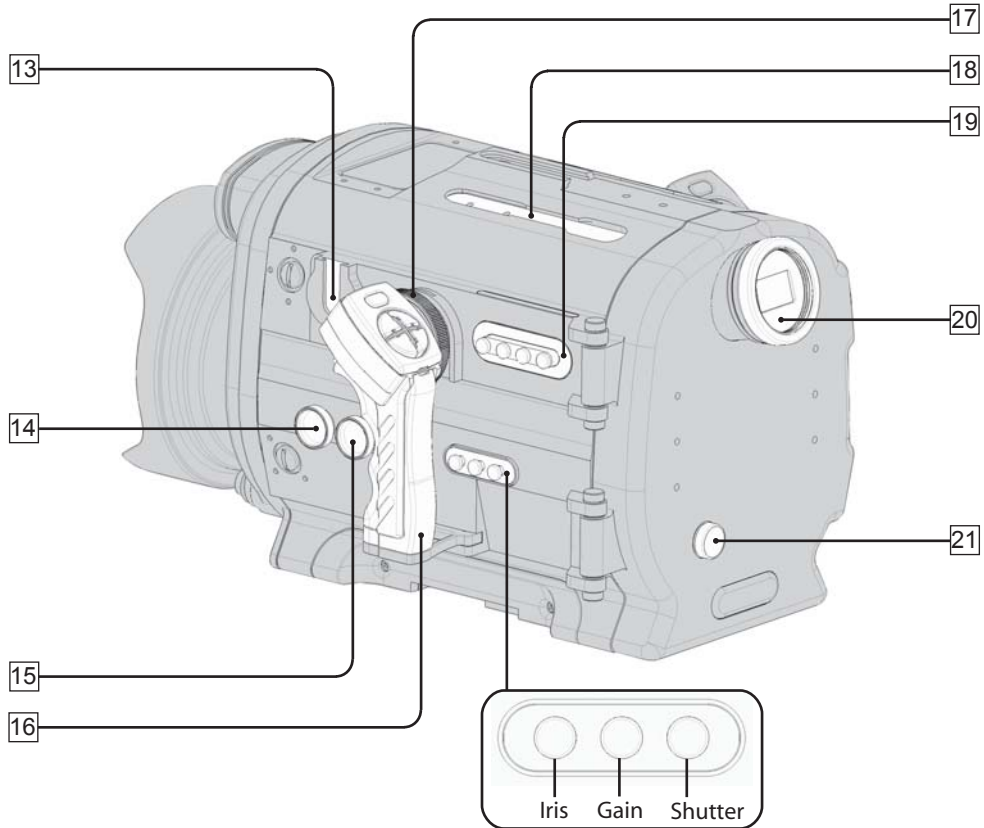

13 Accessory Mounting Side Rail

14 Iris Adjustment Knob

15 Camcorder ND Filter Knob

16 Left Electronic Grip

17 Focus Wheel

18 Accessory Mounting Top Rail

19 Control Panel

20 Viewfinder

21 Menu Navigation Wheel

**OPENING THE HOUSING**

Sit the housing on a flat surface. Press and rotate both safety latches counterclockwise simultaneously until the rear door opens.

**REMOVING THE SADDLE**

1. Rotate the saddle locking handle towards the right until it reaches the end. This will disengage the saddle connector.
2. Use the handle to pull the saddle completely out of the housing.

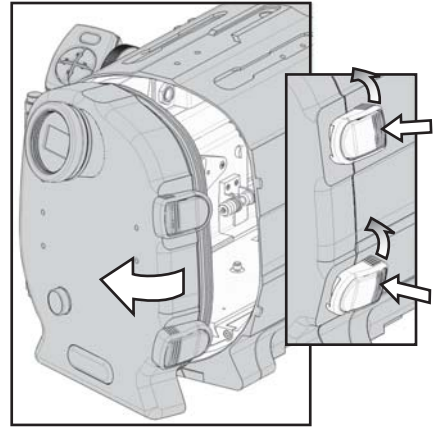
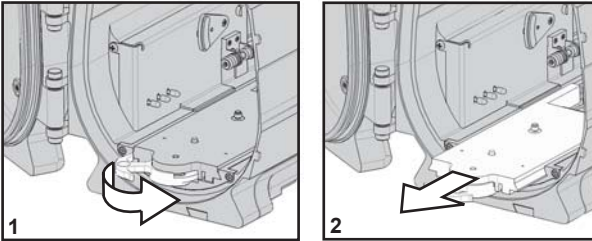

**SETTING THE CAMCORDER**

1. Remove the eyecup and magnifier element. Rotate the viewfinder for it to line up with the housing's own magnifier element.
2. Rotate and flip the LCD panel to restore it back to the original position with the LCD screen facing out.
3. Put a fully charged battery in the camcorder.
4. Place a recordable tape into the camcorder.
5. Set the AUTO LOCK switch to the center position.
6. Set the ZOOM switch to LEVER/REMOTE position.
7. Rotate the zoom ring so its knob is pointing upwards.

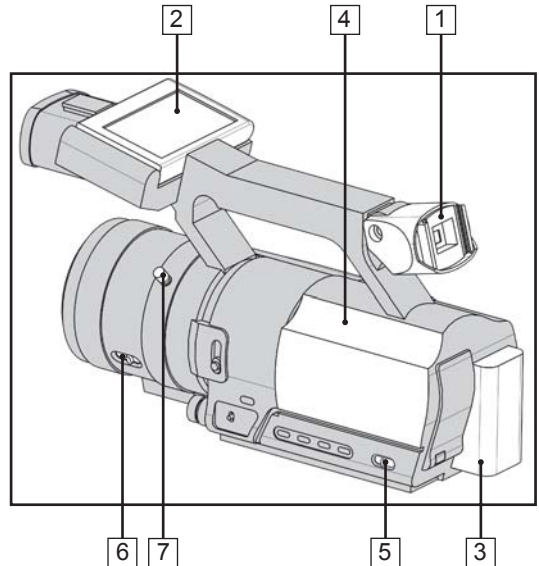

**NOTE:** You will have to remove the external MIC support holder in order to fit the HVR-Z1 camcorder into the housing.

1. Open support holder to expose the mounting screws.
2. Unscrew both screws and remove support holder.
3. Replace screws into there mounting holes for safe keeping.

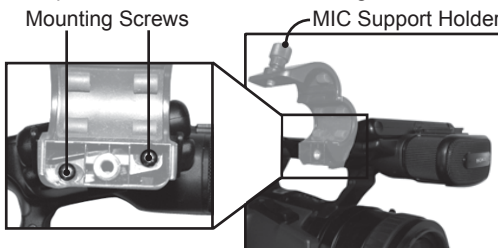

## SETTING THE SADDLE

### AUDIO

Factory settings for the audio on the PHENOM have both channels set to HYD (Hydrophone). Switching audio settings to EXT permits you to use external audio equipment when connected to the PHENOM bulkhead connectors (optional).

### ZOOM

The range on the zoom wheel (p.12) can be adjusted on the saddle. Set the ZOOM to FULL if you want to zoom through the entire camcorder's range (wide to telephoto). MED only allows you to zoom from wide to mid-telephoto.

## INSTALLING THE SADDLE

Place the saddle under camcorder with its handle pointing the back of the camcorder. Align the thumb screw's saddle and guide pin with the camcorder's tripod mounting holes. Hand tighten the thumb screw to secure the saddle to the camcorder.

## CONNECTING THE SADDLE

**LANC:** Connect the cable from the rear of the saddle to the camcorder's LANC jack.

**VIDEO:** Connect the video cable (yellow band) terminated with a 3.5mm plug to the camcorder's A/V jack. The other video cable is connected to the S VIDEO connector.

**AUDIO (HDR-FX1):** Connect the audio cable from the front of the saddle to the camcorder's MIC jack.

**AUDIO (HVR-Z1):** Connect the adapter plug (supplied) to the camcorder's INPUT 1 MIC jack. Connect the audio cable from the front of the saddle to adapter plug.

**NOTE:** It is important to route all cables as shown in the diagram. This will prevent any damages to the cables when inserting the saddle into the housing.

Settings

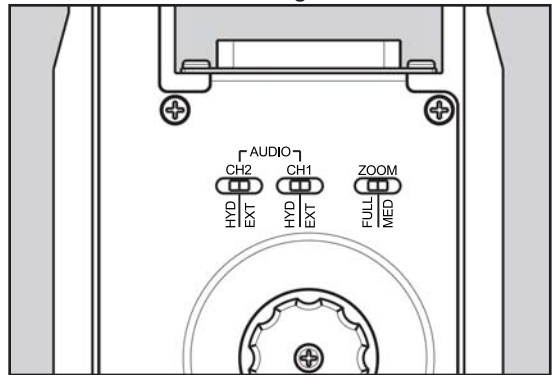

Installing

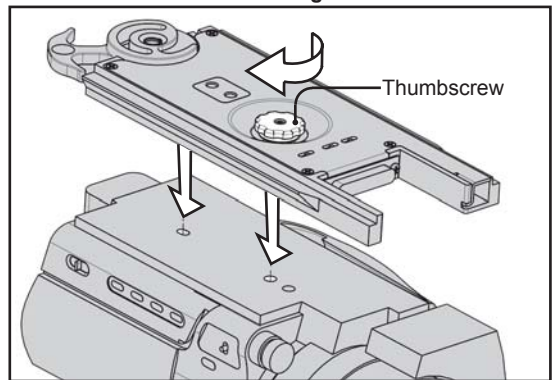

Connecting the HDR-FX1

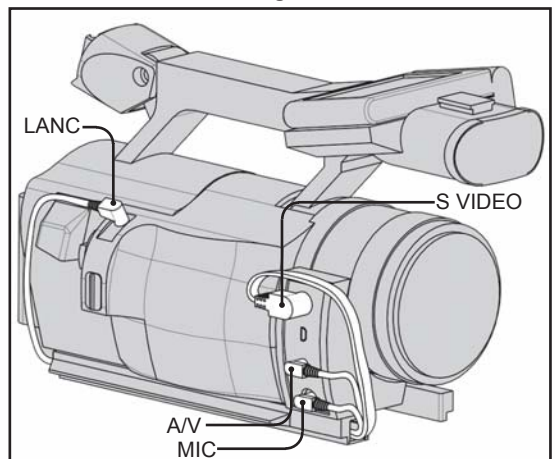

Connecting the HVR-Z1

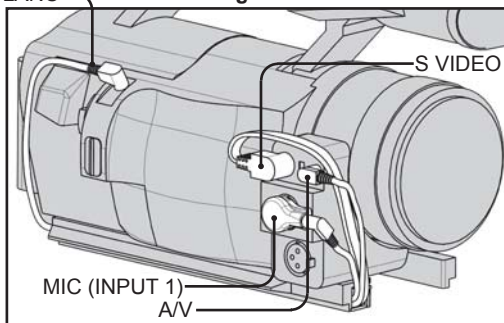



### PLACING THE CAMCORDER INTO THE HOUSING

By now the camcorder is set, installed to the saddle and ready to be placed inside the housing.

1. Line up the camcorder and saddle with the docking tray found inside the housing.
2. Begin to insert the camcorder by placing the front of the saddle over the docking tray. This will allow you to better locate the rails on the docking tray.
3. Slide the camcorder all the way until the saddle connector makes contact with the docking tray connector.
4. Rotate the handle on the saddle to secure the camcorder into the housing. This will also guaranty a perfect connection for the saddle connector.
5. Set the power switch on the camcorder to CAMERA.

NOTE: It is essential for the camcorder to be turned ON in order for the housing electronic features to work properly.

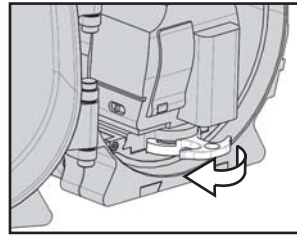
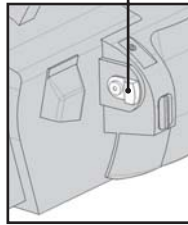
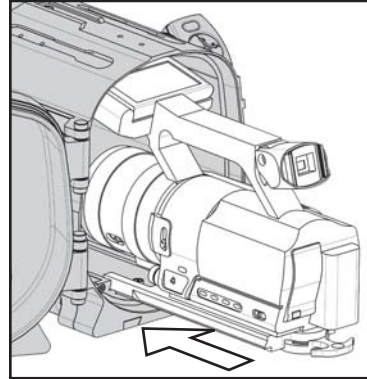

### CLOSING THE HOUSING

1. While the housing is open, inspect the two o-rings and the sealing surface for dirt and debris. If necessary, clean them with a lint free tissue. Make sure that the two o-rings and the sealing surface are clean. Then apply a small amount of lubricant (supplied) to the o-rings.

**NOTE:** If you have to change your o-rings, make sure you are using the o-rings provided with the package. Using different o-rings than those in the o-ring kit may cause the housing to leak and result in damage.

2. Make sure that the LANC cable doesn't block the sealing surface. If that cable gets pinched, the system might be intermittent or not functioning at all. Close the rear door until the latches begin to engage.
3. Make sure the o-rings are well placed before locking the latch. Turn the latch clockwise until a positive click is felt.

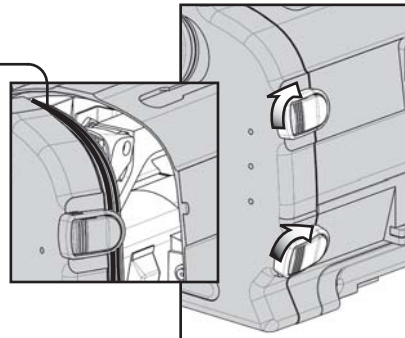

**ADJUSTING THE IRIS AND MENU KNOBS**

Both the IRIS and MENU knobs are factory adjusted. However these knobs may need to be adjusted because camcorders do tend to vary in size. Therefore, it is recommended to try out these two knobs after the initial camcorder insertion (p.8). Difficulty in operating either the IRIS or the MENU knob could indicate that adjustments are required on the knobs.

**To make the adjustments**

1. Remove the camcorder from the housing.
2. Using the supplied allen key, loosen the set screw of either the IRIS or MENU knob mechanism as illustrated. This will release the o-ring friction plate and allow you to adjust it by turning it CW or CCW for more or less friction on the camcorder. Once the adjustment is made, re-tighten the set screw.
3. Replace the camcorder into the housing and try the knobs once again for proper operation. Repeat procedure if necessary.

IRIS knob mechanism

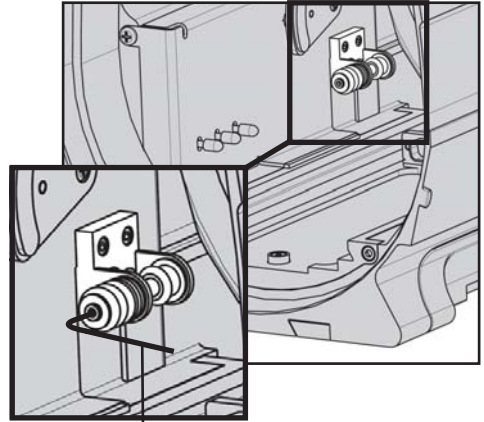

Allen Key (supplied)

MENU knob mechanism

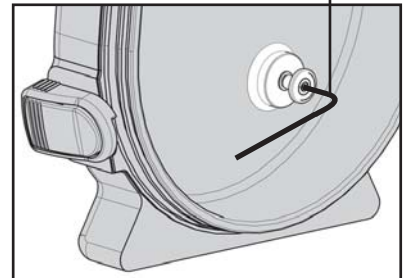

**VIEWFINDER EYEPIECE**

The viewfinder eyepiece located on the rear of the housing may also need adjustment. To adjust, simply turn the inside ring on the viewfinder CW or CCW to achieve perfect focus with the camcorder viewfinder. Tighten the locking ring up against the viewfinder body to lock the eyepiece in place once adjusted.

Locking Ring

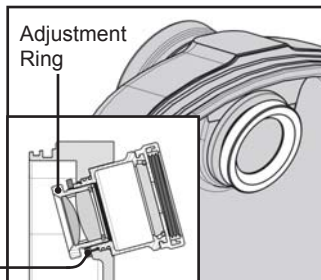

**REPLACING THE BAYONET LENS**

The PHENOM is provided with a wide angle bayonet mounted lens. In order to protect the optics, covers are provided with the lens.

1. To remove the lens, push and hold the button on the lower right of the front bulkhead and then turn counter clockwise until the lugs are free from the bayonet ring. Pull gently on the lens to release it.
2. Remove the covers from the replacement lens. Place them in a clean and dry environment to avoid any damage. Make sure the seals on the bottom part of the lens are clean and free from dust and debris.
3. Put a small amount of lubricant on the o-ring seals and the sealing surface of the housing.
4. Line up the bayonet lug marked by a hole with the printed dot on the front bulkhead of the housing. Push the lens all the way until it sits on the bayonet ring and turn clockwise. You will hear a positive click and the lens will lock into place.

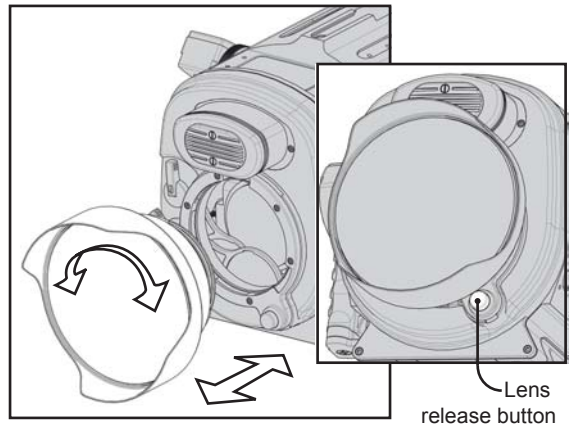

Lens release button

**INSTALLING ACCESSORIES**

The PHENOM has been equipped with mounting holes and railing systems to accommodate for a variety of accessories. Locations for a few of these accessories have been designated for your convenience. However, these locations can be used for other accessories. Some accessories like the monitor or video lights require to be connected to the housing. Accessory connector ports (one on the right side and two on the left side) are available for this purpose.

**Achieving neutral buoyancy and balance**

Adding accessories to the housing may make it heavier or off balance in the water. Removable ballasts have been added to the bottom of the housing for this purpose.

**To make the necessary weight adjustments.**

1. Submerge the housing with the added accessories into the water so you get an idea of what and where to remove weight.
2. Using the allen key supplied, start removing or relocating the ballasts from the right or the left channels as illustrated.

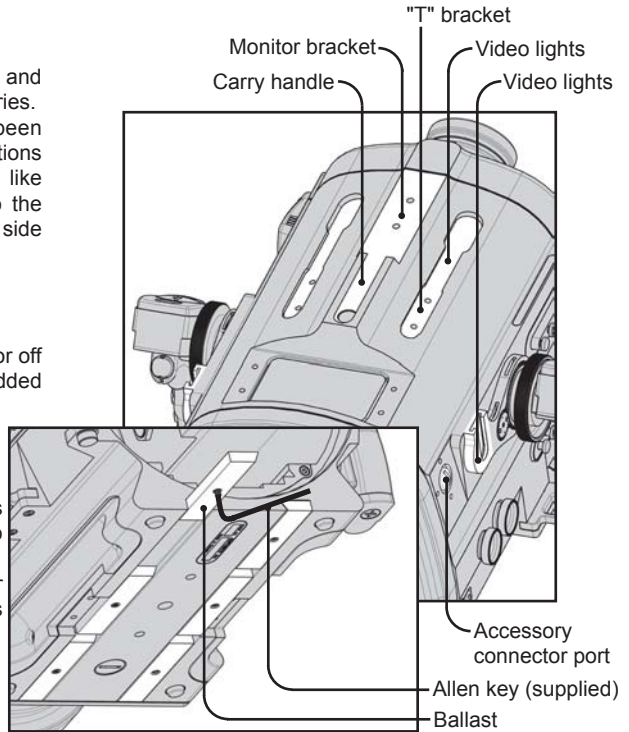

**WATER ENTRY**

1. Always turn housing to its ON position before entering water. To turn it ON, use the right grip trigger button. This is confirmed by the CAM. indicator light turning on steady green. The camcorder viewfinder will also turn ON. Doing step 1 will activate the built-in moisture alarm sensor located in the bottom of the housing.

**IMPORTANT**

**All indicator lights will start flashing RED if water leakage occurs inside the housing. Remove from water as soon as possible, take the camcorder out of the housing and inspect all seals and the inside of the housing. ALWAYS REMEMBER DIVER SAFETY FIRST.**

2. Lower the housing just below the water surface in level position and hold for one minute to confirm there is no leakage in the housing.

Never leap into the water while holding the housing. Always have the housing handed to you or lowered down once you are in the water.

3. Point the lens of the housing upwards and shake off any air bubbles. It may also be necessary to gently wipe the lens with your finger to remove bubbles.

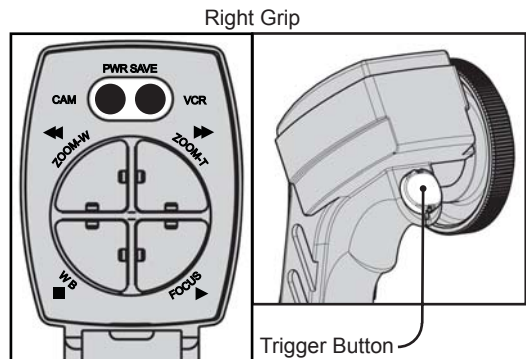

The PHENOM offers a large range of functions both electronic and mechanical. This chapter will explain to you in detail all of these functions.

## POWER ON

The camcorder should be powered ON by default after inserting it into the housing. In the event that it's not, the trigger button on the right grip will activate the camcorder. Simply press on it once and the CAM indicator light will turn on steady green and the rear viewfinder will also be turned on to confirm the power ON of the camcorder.

## POWER OFF

To power off the camcorder during a dive will allow you to save on battery energy. To do so, find the power OFF switch on the menu panel and hold it for at least 2 seconds.

## POWER SAVE

(All LED indicators are on steady green)

When the camcorder is left in Record/Standby for more than 5 minutes, it will exit this mode to prevent tape wear and battery loss. In Power Save mode, you have two choices:

1. To set it back to Record/Standby mode: Press on the left grip trigger button (shift key) together with the right grip trigger button.
2. To start recording immediately: Simply press on the right trigger button. Note that it will take longer to start recording.

## MODE SETTINGS

There are two mode settings on the housing. One mode setting is for the CAMERA operation (CAM MODE) and the other is the VCR operation (VCR MODE) of the camcorder. You can change mode settings, once the housing is activated, by pressing on the MODE switch located on the control panel.

## CAM MODE

The housing will set itself to record/standby mode (CAM indicator LED is steady green) when initially turned ON. To record a scene, simply press on the right grip trigger button. The CAM indicator LED will flash green when recording. Pressing it again will bring it back to record/standby mode.

## VCR MODE

In VCR mode, all playback functions on both grips become available. The CAM indicator LED turns off and the VCR indicator LED turns on steady green in this mode.

### Left Grip

- ◀◀ : Index-Rewind
- ▶▶ : Index-Forward
- SM : Search Mode
- ES : End Search

### Right Grip

- ◀ : Rewind
- ▶ : Fast-Forward
- : Stop
- ▶ : Play

Trigger B. : Pause

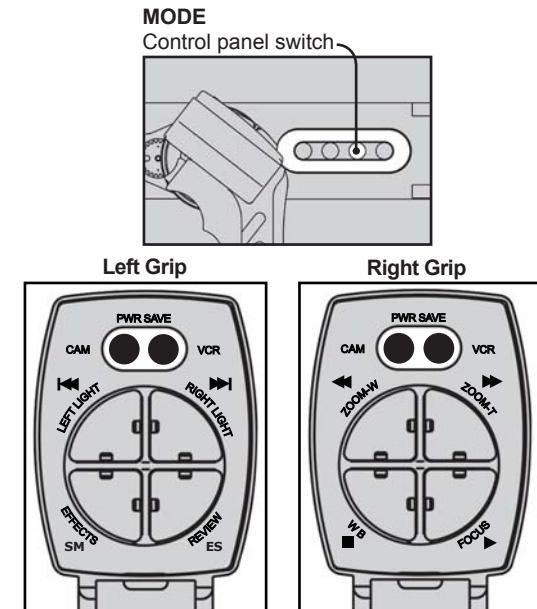
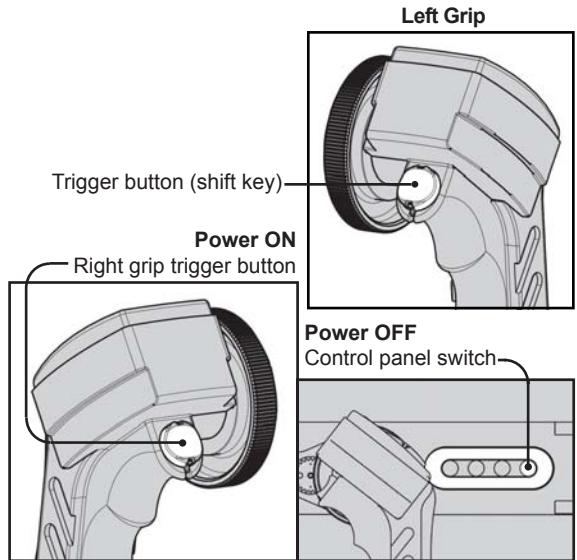

## ZOOMING

On the PHENOM, zooming is achieved either with the zoom wheel or the right grip's ZOOM-W and ZOOM-T buttons.

### Zoom Wheel

The zoom wheel enables you to vary the zoom speed.

### ZOOM-W and ZOOM-T

Located on the right grip, the ZOOM-W and ZOOM-T buttons enables you to zoom through with a constant speed. Pressing on ZOOM-W will widen the zoom while pressing on ZOOM-T will result in the opposite being telephoto.

**Slower Zoom Speed:** If so desired, the zoom speed may be reduced. Simply hold down the left grip trigger button (shift key) while pressing on the ZOOM-W or ZOOM-T buttons.

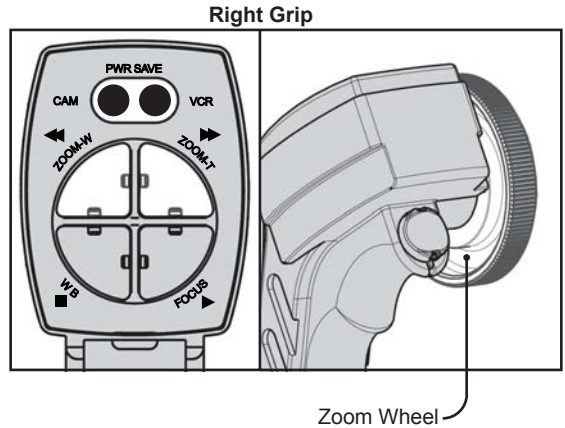

## FOCUSING

The camcorder focus on the PHENOM can be set to either auto or manual focus. To toggle from auto to manual focus, hold down the left grip trigger button (shift key) while pressing on the right grip FOCUS button.

### Manual Focus

In manual focus, you can:

1. Use the focus wheel to fine adjust the focus.
2. Use the right grip FOCUS button (by holding it down) to temporarily auto focus. Letting go will return to manual focus.

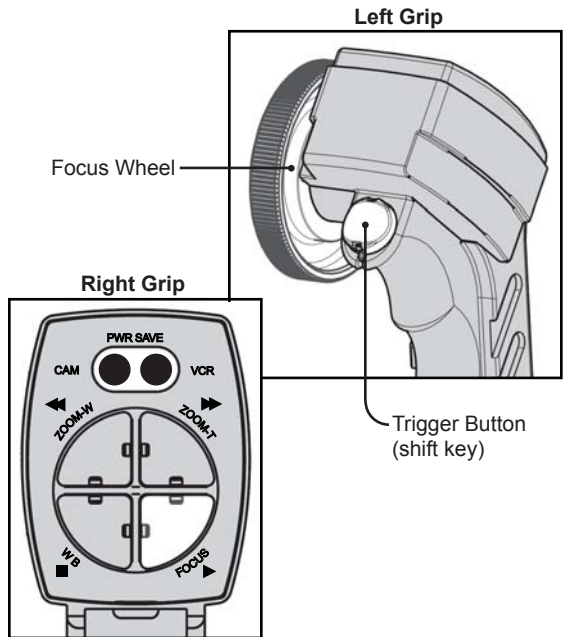

### Zoom and Focus Wheel functionality

Both the zoom and focus wheel operate in the same fashion. The wheels are spring loaded and maintain a zero (non active) position when not in use. Applying a little movement on the wheel in either directions will result in a slow speed. Increasing the movement on the wheel will accelerate the speed.

## WHITE BALANCE

The capability to white balance underwater plays an important role in achieving good quality footage. This is why the PHENOM offers electronic "One Push" white balance.

### It is important to activate the white balance on start up.

Since the initial "One Push" white balance on the housing takes approximately 20 seconds to adjust itself, it is recommended to activate it on start up. Pressing on the WB button located on the right grip will activate this feature. You will notice that the LED indicators on both grips toggle green from left to right during the adjustment interval. Subsequent use will only take 2 to 3 seconds.

### Reset White Balance

Pressing on the left grip trigger button (shift key) together with the WB button on the right grip will reset the white balance to its original setting prior to the initial "One Push" white balance performed on the housing.

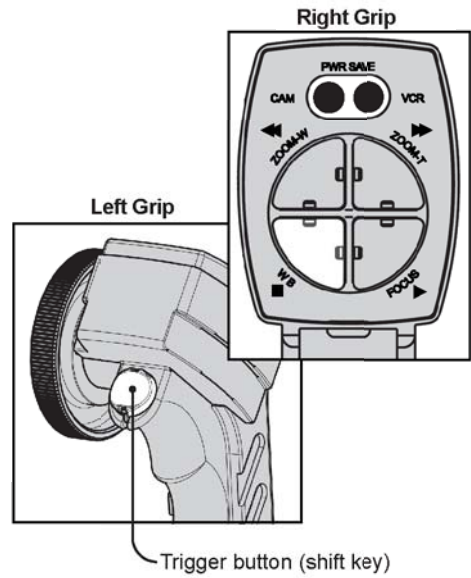

## LEFT AND RIGHT LIGHT BUTTONS

When equipped with the AMPHIBICO's Discovery II arc lights, the left and right light buttons located on the left grip will turn ON and OFF the video lights mounted on the housing via an infrared connection between the housing and the power pack (see illustration).

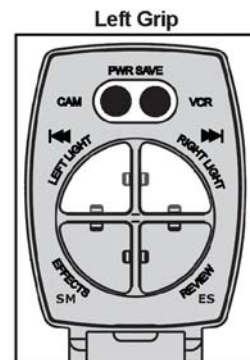

## EFFECTS

The HDR-FX1 & HVR-Z1 camcorders do not support this feature at the present moment.

## REVIEW

The REVIEW button located on the left grip allows you to review the last few seconds of the most recently recorded scene while in record/standby mode.

## INDEX MARKER

The index marker function included in the Phenom allows you to make an index for a scene. Pressing on the left grip trigger button (shift key) together with the REVIEW button will record an index signal.

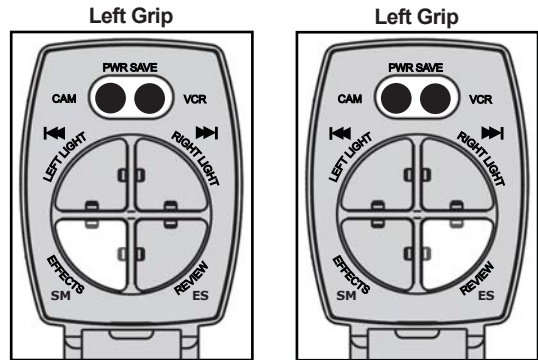

Left Grip

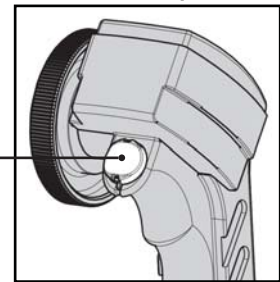

Trigger button (shift key)

## BACKLIT

Control panel switch

## BACK LIGHT

The BACKLIT button located on the control panel lets you turn ON or OFF the camcorder's back light function.

## DISPLAY Toggle

This function allows you to display ON or OFF the camcorder's information in the viewfinder while recording or in playback mode. To access this function, simply press on the left grip trigger button (shift key) together with the MODE button on the control panel.

## DISPLAY Mode

In playback mode (VCR), you can either have the date/time displayed or the camera settings displayed in the viewfinder. Press on the left grip trigger button (shift key) together with the MENU button on the control panel to switch back & forth.

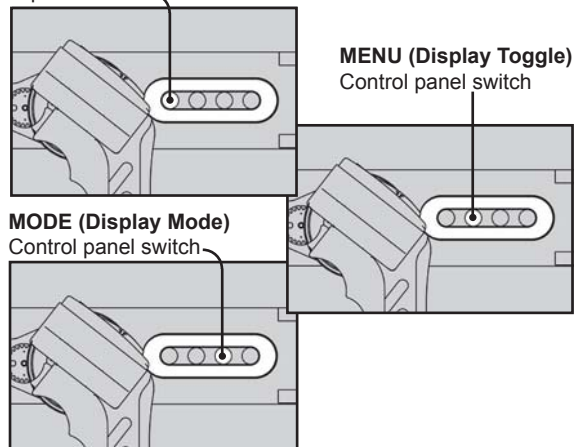

## MENU (Display Toggle)

Control panel switch

## MODE (Display Mode)

Control panel switch

## MENU

Press on the MENU button located on the control panel to access the camcorder's menu. Once activated, you can navigate through the menu by rotating the menu navigation wheel located at the rear of the housing. Depressing this wheel will allow you to enter sub menus and make menu changes. Press on the MENU button once again to exit.

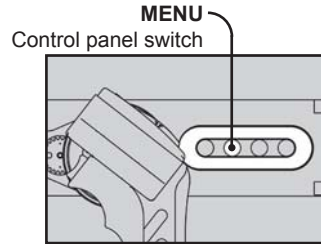

## IRIS ADJUSTMENT KNOB

You must first make sure that the iris is set to manual. The current aperture value (f) will be displayed in the viewfinder if the iris is set to manual. If not, press on the Iris button located on the panel behind the left grip. This will set the iris to manual, rotating the Iris knob CW or CCW will make the aperture value of the camcorder change.

## ND FILTER KNOB

Use the ND filter knob to change from no ND filter to ND filter 1 or ND filter 2. The following procedure describes how to use this feature.

### To increase the filter number:

Rotate the knob all the way CW without depressing it. Depress the knob and rotate CCW while looking through the viewfinder. Stop and let go of the knob when you have reached the desired setting.

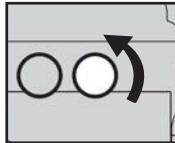

### To decrease the filter number:

Rotate the knob all the way CCW without depressing it. Depress the knob and rotate CW while looking through the viewfinder. Stop and let go of the knob when you have reached the desired setting.

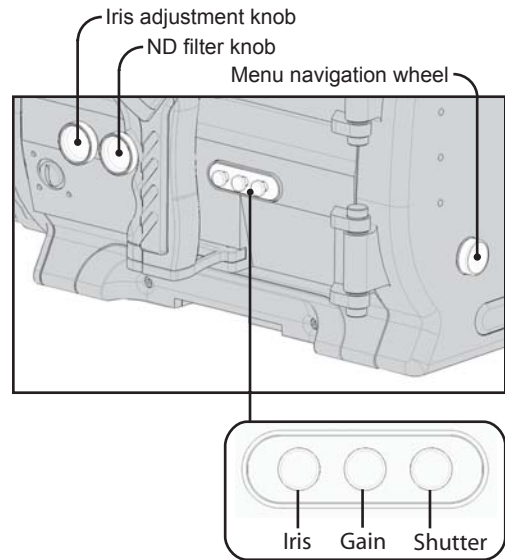
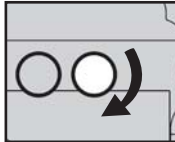

## GAIN

You can set the camcorder to one of its preset gain levels (H,M,L) by simply pressing on the Gain button located on the panel behind the left grip. Once activated, you can change its value in the gain setup sub menu via the menu button and menu navigation wheel.

## SHUTTER

Pressing on the Shutter button located on the panel behind the left grip allows you to manually adjust and fix the shutter speed. Once depressed, use the menu navigation wheel to adjust and fix the shutter speed. Pressing on the Shutter button once again will return it to automatic adjustment.



**WARNING: DO NOT leave the housing exposed to direct sunshine, as extreme heat condition can be detrimental to certain of its components.**

1. Keep housing and o-rings away from direct sunlight. Always store unit when possible away from direct sunlight as this can dry out and crack o-rings in the housing. Ultraviolet rays can damage plastics, paint and o-rings.
2. Always rinse or soak closed housing in fresh water for 10 to 15 minutes after every use. Reach into freshwater and operate all controls to clear salt water. Do not use solvents to clean unit. If preferred, use mild detergent and clean fresh water.
3. Fasteners that are removable should occasionally have the threads lubricated with silicon grease.
4. Rinse clean and remove water spots from external filters and lens surface after every dive or water spots may build up and become impossible to remove. Dry gently with a soft, lint-free cloth.
5. Inspect housing's rear door main o-ring seals (double seals) before every dive. Make sure that there are no cracks or misalignment in the o-ring channel and that no debris is caught on the o-rings.

### **SERVICING O-RINGS**

1. O-rings and sealing surface should be lightly lubricated with silicon lubricant on a regular basis. This is not necessary after every dive; every tenth dive during regular heavy use is sufficient. This should always be done before storing the housing and before a first dive after taking the housing out of storage.
2. It is important never to use a sharp instrument when removing an o-ring as this may cause damage to the o-ring or the o-ring groove. A hairpin or a credit card works well.
3. The removed o-ring should be examined for damage. Check to make sure that the o-ring is free from nicks and cuts and that it retains its original round profile. O-rings that appear to be damaged should be discarded immediately and replaced with new o-rings.
4. Rinse the o-ring with freshwater and dry it with a clean lint free cloth.
5. Clean the o-ring grooves (where the o-rings sit) with a Q-tip. Be sure to remove any lint the Q-tip may leave behind. Inspect the groove for damage.
6. Wipe the part of the housing that the o-ring seals against with a clean lint free cloth.
7. Re-grease the o-rings with a thin layer of silicon grease until it appears to be smooth and shiny. Do not over grease it - use just enough grease so that the o-ring will pull smoothly through your fingers. Excessive amounts will only attract dirt to the o-ring.
8. Replace o-rings in their proper position on the lens assembly and on the main door seal.

**PHENOM**

Marine housing for the Sony HDR-FX1 & HVR-Z1

- Marine grade aluminum Construction
- Fully anodized with a hard coat of polyurethane paint and a clear coat
- All hardware is marine grade brass and stainless steel
- Optics: Marine bayonet mounted lens system, 0.68X rectilinear fully coated amphibious conversion lens.  
Full zoom-through capability, 94° field of view underwater and vacuum-sealed for maximum anti-fog protection
- Dual Internal Flip filters with a Blue Water and Neutral Density filters installed
- Sensitive Dual Hydrophones to pick up high frequency sounds, such as whales and dolphins
- 2.5 x Magnified viewfinder with adjustable diopter control
- 3 Auxiliary ports

Weight of unit :

- On land 36 lbs. (16.3kg) fully loaded w/camera NP970 battery, lens and lead ballasts.
- In seawater the Phenom is perfectly balanced and neutral buoyancy

Dimensions :

- Length 18.3" (465mm)
- Width 13.6" (345mm)
- Height 10.1" (257mm)
- Measurements includes lens and grips

Operating depth :

- Each unit is pressure tested to 330ft (100m)

**The PHENOM offers an array of accessories and they are as follows:**

- Large carry case with casters and handle
- Optics
  - 
  - +2 Diopter
- Lights
  - 35/50 Watt "HID" Technology Arc Light with aluminum Extension Arm
  - 10 Watt Arc Light "HID Technology" with mounting arm
- 3.5" TFT LCD High Performance Color Monitor
- Filters
  - UR PRO Green Water 67mm Filter
  - ND Graduating 67mm Filter
- WB/Color chart slate
  - 7" x 11" slate
  - 11" x 17" slate. Offered with an optional branding to personalise your slate

1. Best results will be obtained with natural light if the sun is directly overhead during calm water periods.
2. Placing the sun behind your shoulder during shooting will produce the best colors.
3. Wide angle is the preferred focus setting for best results with subject, as close as possible to the housing. This will reduce the water column and the amount of particles between subject and lens.
4. Zooming during shooting is not recommended unless absolutely necessary as telephoto will magnify particles. Swimming toward subject is a much more visually pleasing filming method.
5. Use image stabilizer if available on your camera when filming macro to minimize camera movement during high magnification. Image stabilizer is not as critical while using wide angle and will use battery power unnecessarily.
6. Buoyancy control is one of the most important aspects of underwater videography and diving in general. Avoid disturbing bottom silt and contacting delicate reef structures. Work on controlling your breathing and your buoyancy. Your video will be much more visually appealing. You are trying to make yourself a steady shooting platform. The less movement you make, the better your video will be. Work on attaining a comfort zone underwater. The more comfortable you are underwater, the more controlled your breathing will be and the steadier your video will be.
7. In low light situations, add light with optional Amphibico video lights for brighter and more vibrant colors. As light level falls so does color saturation. Lights will also provide necessary fill during daylight shooting. If this technique is used, filtration of light using a color correction filter will be necessary for accurate color rendition.

All Amphibico products are guaranteed against defects in material or workmanship for one full year from the date of purchase for consumer use. These same products when used commercially will carry a 90-day warranty. No statutory warranty applies. Cameras housed in Amphibico housings are not covered under this warranty and ANY WATER DAMAGE SUSTAINED DUE TO INSTALLATION ERROR OR FOR ANY OTHER REASON IS NOT THE RESPONSIBILITY OF AMPHIBICO INC. Therefore the appropriate insurance should be maintained by the user.

Subject to the terms and conditions specified hereunder, Amphibico Inc. agrees to correct, either by repair or by replacement, any defect in material or workmanship which develops within one year after delivery of the product to the original purchaser.

Repair or replacement is provided in the event that investigation and factory inspection by Amphibico Inc. discloses that such a defect has developed under normal and proper use. No warranty is granted concerning components, accessories, or devices not manufactured by Amphibico Inc.

AMPHIBICO INC. SHALL BE RELEASED FROM ALL OBLIGATIONS UNDER ITS WARRANTY IN THE EVENT REPAIRS OR MODIFICATIONS ARE MADE BY PERSONNEL OTHER THAN ITS OWN OR AUTHORISED (IN WRITING) SERVICE PERSONNEL.

Amphibico Inc., in its continued commitment to provide excellence in the field of underwater imaging, reserves the right to change specifications at any time, without notice and without incurring any obligations to incorporate new features in equipment previously sold.

#### **CONDITIONS**

**Registration condition:** The attached (warranty) card must be mailed to Amphibico Inc. within fourteen (14) days after retail purchase.

**Repairs:** The unit must be returned freight prepaid to Amphibico Inc. The returned documents must show Serial N0. and be marked " CANADIAN GOODS RETURNED." No returns will be accepted without Amphibico Inc return authorisation number.