



WARNING

**IMPORTANT! KEEP INSTRUCTIONS FOR
FUTURE REFERENCE.**

IMPORTANT!



DANGER

To prevent electric shock, do not immerse in water; wipe clean with damp cloth. Do not expose the product to rain or moisture. Do not place objects filled with liquids on or near the product.



WARNING

To prevent strangulation with power cord, never place transmitter within reach of child.



CAUTION

This product cannot replace responsible adult supervision.

IMPORTANT!

- For proper setup and use, please read these instructions.
- Please keep this instruction sheet for future reference, as it contains important information.
- Transmitter operates on AC current. Receiver operates on AC current (use enclosed AC adaptor) or 3.6V, 750mAh NiMH rechargeable battery pack (included).
- Adult setup is required.
- **Before first-time use**, charge the rechargeable batteries for 4 hours.
- This product is not intended to be used as a medical monitor and its use should not replace adult supervision.
- Test sound reception of receiver before first-time use and whenever you change location of the transmitter.
- To prevent entanglement:
 - Never place transmitter in a cot or playpen. Keep transmitter and receiver out of baby's reach.
 - Never use extension cords with the AC adaptor.
- **Adults Note:** Periodically examine the transmitter and the AC adaptor for damage to the cord, housing or other parts that may result in the risk of fire, electric shock or injury. If the transmitter or AC adaptor is damaged, do not use monitor (if transmitter is damaged) or AC adaptor. Use batteries as the power source in the receiver.
- Never use transmitter or receiver near water (i.e. bathtub, sink, wet basement, etc.).
- Always use the transmitter and receiver where there is adequate ventilation. To prevent overheating, keep the transmitter, receiver and battery pack away from heat sources such as radiators, heat registers, direct sunlight, stoves, amplifiers, fire, excessive heat or other appliances which produce heat.
- Do not connect the transmitter or receiver (if AC adaptor is used) to more than the recommended number of power supplies.
- The AC adaptor is not a toy.
- Disconnect the AC adaptor from the receiver before cleaning.
- Fisher-Price® does not recommend the use of two monitors in one house.
- Always remember that you are using public airwaves when using your monitor. Conversations, even from rooms near your transmitter, may broadcast to other nursery monitors, radios, cordless telephones or scanners outside your home. To protect the privacy of your home, always turn off the transmitter when not in use.
- If this product begins to operate erratically, you may need to reset the electronics. Slide the power/volume dial off and then back on.
- Carrier Frequency: 2.4 GHz
- Product features and decoration may vary from photos.

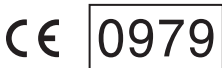

Hereby Mattel declares that the product is in compliance with the essential requirements and other relevant provisions of European Council Directives 99/5/EC, 89/336/EEC. Suitable for the U.K.



Great Britain: Vanwall Business Park, Maidenhead SL6 4UB. Helpline: 01628 500303.
www.service.mattel.com/uk.

Asia: Mattel East Asia Ltd, Room 1106, South Tower, World Finance Centre, Harbour City, Tsimshatsui, HK, China.

Malaysia: Diimport & Diedarkan Oleh: Mattel SEA Ptd Ltd. (993532-P) Lot 13.5, 13th Floor, Menara Lien Hoe, Persiaran Tropicana Golf Country Resort, 47410 PJ. Tel: +603-3341 9052.

Fisher Price, Inc., a subsidiary of Mattel, Inc., East Aurora, NY 14052 U.S.A.
©2009 Mattel, Inc. All Rights Reserved. © and ™ designate U.S. trademarks of Mattel, Inc.

Features

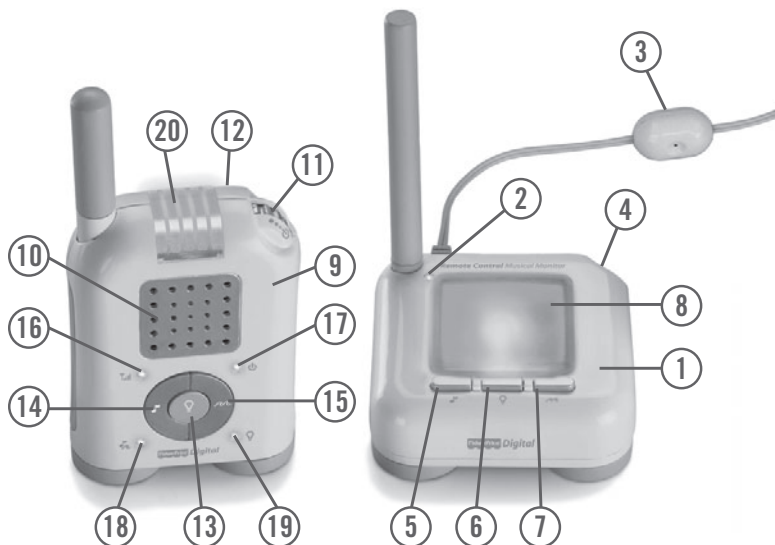

- | | |
|----------------------|------------------------------|
| ① Transmitter | ⑪ Power/Volume Dial |
| ② Power L.E.D. | ⑫ Clip (on back of receiver) |
| ③ Microphone | ⑬ Night Light Button |
| ④ Power/Volume Dial | ⑭ Music Button |
| ⑤ Music Button | ⑮ Sounds Button |
| ⑥ Night Light Button | ⑯ Signal L.E.D. |
| ⑦ Sounds Button | ⑰ Power/Battery L.E.D. |
| ⑧ Night Light | ⑱ Music/Sounds L.E.D. |
| ⑨ Receiver | ⑲ Night Light L.E.D. |
| ⑩ Speaker | ⑳ Sound Lights |

Charging the Battery (Inside the Receiver)

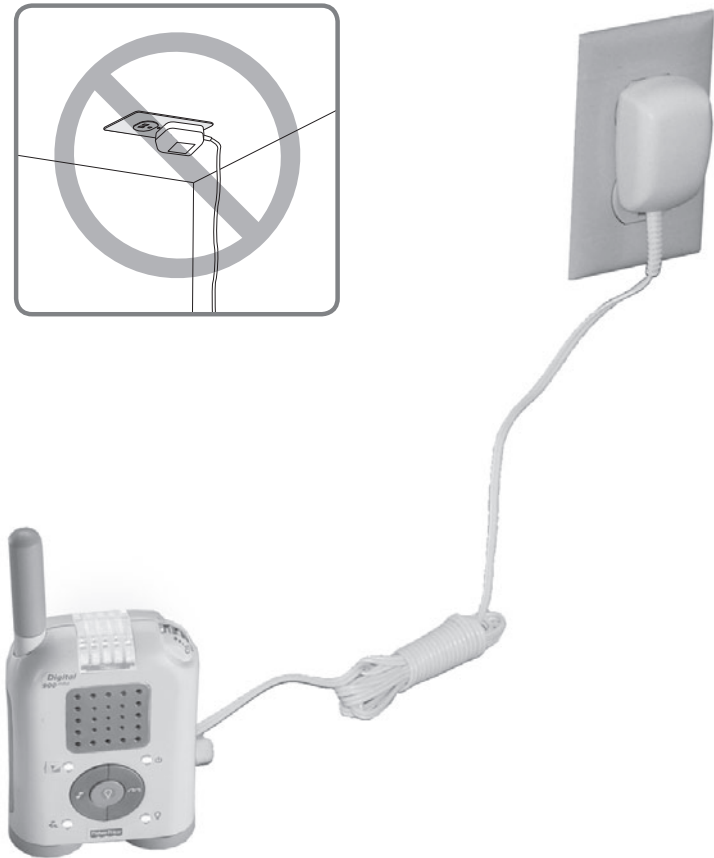
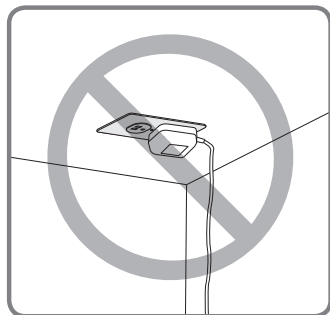

IMPORTANT! Fully charge the receiver (with battery pack inside) for **four hours before first-time use.**

- Fit the AC adaptor pin into the DC input jack on the receiver.
- Plug the AC adaptor into a standard wall outlet.

Notes: If power flow to the wall outlet is controlled by a switch, make sure the switch is “ON”. Use the AC adaptor only in a wall outlet. Do not plug the AC adaptor into a ceiling outlet.

Replacing the Battery



If you need to replace your NiMH rechargeable battery pack, please contact Fisher-Price® Consumer Relations.

- Locate the battery compartment door on the back of the receiver.
- Loosen the screws in the battery compartment door with a Phillips screwdriver. Remove the battery compartment door.
- Remove the exhausted battery pack and dispose of it properly.
- Plug the new rechargeable battery pack into the receiver's battery connector. Then, insert the battery pack in the battery compartment.
- Replace the battery compartment door and tighten the screws with a Phillips screwdriver. Do not over-tighten.



- Protect the environment by not disposing of this product with household waste (2002/96/EC). Check your local authority for recycling advice and facilities (Europe only).

Battery Safety Information

In exceptional circumstances, batteries may leak fluids that can cause a chemical burn injury or ruin your product. To avoid battery leakage:

- If replacing the battery pack, insert it as indicated inside the battery compartment.
- Always remove an exhausted battery pack from the product. Dispose of the battery pack safely. Do not dispose of product in a fire. The battery pack inside may explode or leak. Contact Fisher-Price® Consumer Relations to purchase a battery pack.
- Never short-circuit the battery pack terminals.
- Use only batteries of the same type, as recommended.

Testing Sound Reception

Test transmitter transmission and receiver reception each time you change location of use.



- Place the transmitter in the room where you intend to use it.
- Turn the power/volume dial to the on position. The power L.E.D. lights.
- Turn on a radio.

Testing Sound Reception

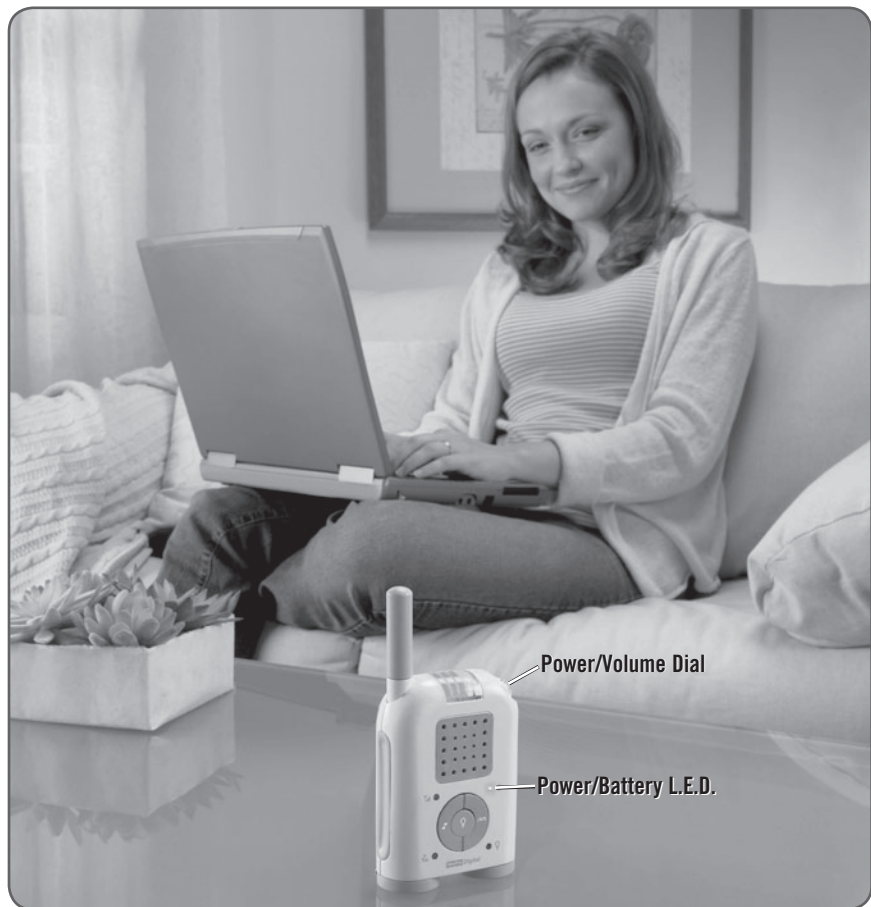

- Place the receiver in the room where you intend to use it.
- Turn the power/volume dial to turn the power ON. The power/battery L.E.D. lights.
- Adjust the receiver location for best reception.

Hint: If the battery power is low, the power/battery L.E.D. will flash and you will hear a tone that will repeat approximately once every minute. Fit the AC adaptor pin into the DC input jack on the receiver, and plug the AC adaptor into a standard wall outlet.

Testing Sound Reception



- When sound is picked up by the receiver, the sound lights turn on.
 - One or two lights indicate quieter sounds.
 - Three or more lights indicate louder sounds.

Setup and Use

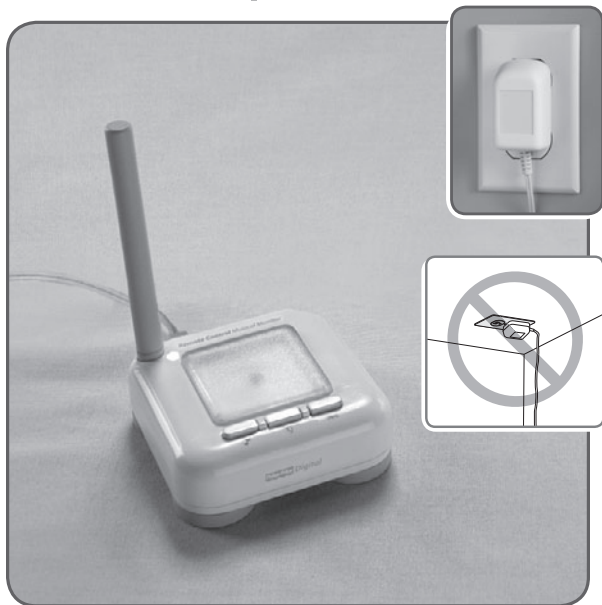

- Place the transmitter in the same room with child.

Note: The microphone is located on the power cord. **Do not place the transmitter microphone within reach of your child or in front of the transmitter.** For best results, allow the cord to extend behind the transmitter.

- Unwrap and fully extend the power cord for best transmission. Plug the power cord into a standard wall outlet.
- Use the power cord only in a wall outlet. Do not plug power cord into a ceiling outlet.
- Turn the power/volume dial to turn the power ON. The power L.E.D. lights.
- Turn on music, sounds or the night light for baby (see page 13).

Setup and Use



- Place the receiver where you can see and hear it.
- Unwrap and fully extend the AC adaptor cord for best reception. Insert the AC adaptor pin into the DC input jack on the receiver and plug into a standard wall outlet.

Note: To use battery power, unplug the AC adaptor from the wall outlet and remove the AC adaptor pin from the receiver.

- Turn the power/volume dial to turn power ON. Adjust the volume as needed.
- Use the receiver as a remote to turn on music, sounds or the night light in baby's room (see page 13).

Setup and Use



Music, Sounds and Night Light Use

Press any of the buttons on the transmitter or the receiver.

- 🎵 Press to turn on lullaby songs in baby's room. Press again to turn off the music.
- 🌊 Press to play nature sounds in baby's room. Press again to turn off the sounds.
- 💡 Press to turn on a soft, glowing light in baby's room. Press again to turn off the night light.

Receiver L.E.D. Indicators

- 🔋 A steady light indicates receiver power is on. A flashing light along with a tone indicates battery power is weak. Connect the AC adaptor to the receiver and plug into a standard wall outlet.
- 📶 A steady light indicates the receiver is receiving signal from the transmitter. A flashing light along with a tone indicates the receiver is out of range. The range is up to 244 meters (800 feet) in permitting conditions.
- 🎵 Indicates music or sounds on the transmitter are ON.
- 💡 Indicates the night light on the transmitter is ON.

Setup and Use



- The receiver can be used to stay in touch with baby around your house or yard.

Hint: The receiver's range is up to 244 meters (800 feet) away from the transmitter. The range L.E.D.  will flash and you will hear a tone when the receiver is out of range.

Problems & Solutions

Problem	Solution
Receiver signal L.E.D. flashes	Receiver is out of range of transmitter. Move receiver closer to transmitter. Note: Range varies depending on surrounding conditions such as noise levels, physical obstructions and signal interference. Under optimal conditions, the range is up to 244 meters.
	Transmitter power is off. Turn transmitter power on.
	Loose power cord connection and transmitter power is off. Check transmitter power cord plug-to-outlet connection.
	No power to wall outlet and transmitter power is off. Make sure light switch that controls power flow to wall outlet is on.
	Power is off because circuit breaker for room is off. Make sure house fuses and circuit breakers are on.
Receiver power/battery L.E.D. does not light	Receiver power is off. Turn receiver power on.
	Batteries in receiver are weak or dead. Use AC adaptor as power source and to charge the battery.
	Power is off because circuit breaker for room is off. Make sure house fuses and circuit breakers are on.
	No power to wall outlet and power is off. Make sure light switch that controls power flow to wall outlet is on.
Receiver power/battery L.E.D. flashes	Batteries in receiver are weak or dead. Use AC adaptor as power source and to charge the battery.
Transmitter power L.E.D. does not light	Transmitter power is off. Turn transmitter power on.
	Loose power cord connection and transmitter power is off. Check transmitter power cord plug-to-outlet connection.
	No power to wall outlet and transmitter power is off. Make sure light switch that controls power flow to wall outlet is on.
	Power is off because circuit breaker for baby's room is off. Make sure house fuses and circuit breakers are on.
You can hear conversations or sounds from other homes	There is signal interference due to other nursery monitors on same channel or cordless telephone use. The monitor should automatically find a new channel to avoid interference.
Receiver is not picking up sounds from transmitter	You may need to pair the receiver and transmitter. Turn over the receiver and press the pairing button with a pen. Then, turn over the transmitter and press the pairing button with a pen. The signal L.E.D. on the receiver will flash and you will hear a tone.

Care

- Excess dirt in the transmitter microphone will hamper transmission of sound. Clean the outer surface of the transmitter and receiver with a cloth lightly dampened with a mild cleaning solution. Never immerse the transmitter, receiver or AC adaptor.