

INSIGNIA

Compact Disc Player with Ultimate Skip Protection and MP3 Playback

IS-PA040718

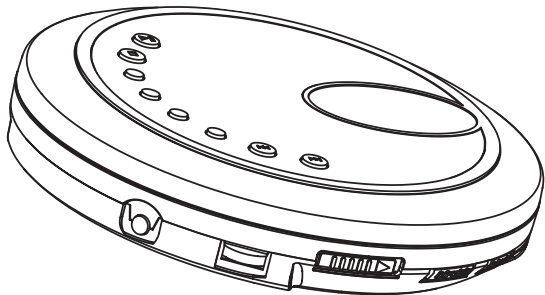

INSTRUCTION MANUAL

PLEASE READ THE INSTRUCTIONS CAREFULLY BEFORE OPERATING THIS UNIT.

WARNING

To prevent fire or shock hazard, do not expose this appliance to rain or moisture.

IMPORTANT

Since the CD circuitry may cause interference to other radio tuners nearby, switch this unit off when not in use or move it away from the affected radio tuner.

This device complies with Part 15 of the FCC Rules, operation is subject to the following two conditions: (1) This device may not cause harmful interference, and (2) this device must accept any interference received, including interference that may cause undesirable operation.

NOTE: This equipment has been tested and found to comply within the limits for a class B digital device, pursuant to Part 15 of the FCC Rules. These limits are designed to provide reasonable protection against harmful interference in a residential installation. This equipment generates, uses and can radiate radio frequency energy and, if not installed and used in accordance with the instructions, may cause harmful interference to radio communications. However, there is no guarantee that interference will not occur in a particular installation. If this equipment does cause harmful interference to radio or television reception, which can be determined by turning the equipment off and on, the user is encouraged to try to correct the interference by one or more of the following measures:

- Reorient or relocate the receiving antenna.
- Increase the separation between the equipment and receiver.
- Connect the equipment into an outlet on a circuit different from that to which the receiver is connected.
- Consult the dealer or an experienced radio / TV technician for help.

SAFETY CERTIFICATION

This Compact Disc Player is made and tested to meet safety standards of the FCC, requirements and compliance with safety performance of the U.S. Department of Health and Human Services, and also with FDA Radiation Performance Standards 21 CFR Subchapter J.



INVISIBLE LASER RADIATION WHEN OPEN AND INTERLOCK FAILED OR DEFEATED. AVOID DIRECT EXPOSURE TO LASER BEAM.

LASER SAFETY

This unit employs an optical laser beam system in the CD mechanism, designed with built-in safeguards. Do not attempt to disassemble; refer to qualified service personnel. Exposure to this invisible laser light beam may be harmful to the human eye.

THIS IS A CLASS-1 LASER PRODUCT. USE OF CONTROLS, OR ADJUSTMENTS OR PROCEDURES OTHER THAN THOSE SPECIFIED HEREIN, MAY RESULT IN HAZARDOUS LASER LIGHT BEAM EXPOSURE.

SAFETY PRECAUTIONS

1. Do not open the cabinet. Refer servicing to qualified personnel only.
2. Do not expose to excessive heat, direct sunlight, dust, moisture, vibration or shock.
3. Use ONLY the AC adaptor required; others may damage your unit. Disconnect from the wall outlet when the set is not to be used for an extended period of time.
4. When cleaning your unit, use a soft dry cloth, do not use solvents or commercially available cleaners as they may damage or discolor the finish.
5. Do not wear headphones while operating a motor vehicle, this could create a traffic hazard and is illegal in many areas.
6. The headphones supplied with your unit provide superior stereo listening while allowing you to hear outside sounds when listening at normally low volume levels. Listening at extremely high volume levels minimizes the intrusion of outside noise/sounds.
7. If you notice that the sound has become weak or distorted, this is an indication that your batteries are low. Replace with new or recharged batteries. (see "BATTERY OPERATION")

LOCATION OF CONTROL

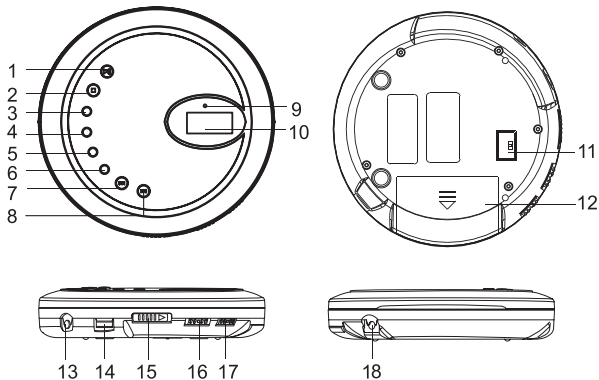

- | | |
|-------------------------------|--------------------------|
| 1. Play/Pause/Power On Button | 10. LCD Display |
| 2. Stop/Power Off Button | 11. Charge On/Off Switch |
| 3. Album +/ESP Button | 12. Battery Door |
| 4. Album - Button | 13. Phones Jack |
| 5. Program Button | 14. Volume Control |
| 6. Mode Button | 15. CD Door Open Switch |
| 7. Skip Backward Button | 16. Bass Boost Switch |
| 8. Skip Forward Button | 17. Hold Switch |
| 9. Battery Charge Indicator | 18. DC Input Jack |

Wire Remote Control

- Volume Control
- Skip - Button
- Skip + Button
- Stop/Power Off Button
- Play/Pause/Power On Button

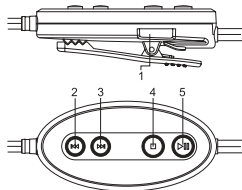

Note:

- Use only the supplied remote control unit with the player.
- You can also set the volume control of main unit to the proper sound level to the earphone.
- You can turn on the player by pressing and hold the PLAY/PAUSE/POWER ON button of remote control over 1 second.
- Operation is same as main unit.

POWER SOURCES: NORMAL BATTERIES/AC ADAPTER (NOT INCLUDED)

Battery Operation

1. Open the battery compartment cover and insert two "AA" alkaline batteries inside the battery compartment. Follow the polarity as indicated in the battery compartment.
2. Close the battery compartment cover.

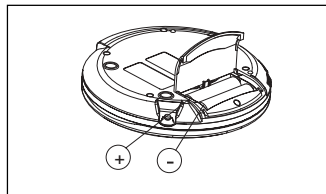

Battery Type	Average Playing Time (Continuous Play)		
	Normal CD	Anti-Shock	MP3
Alkaline "AA"	Approx. 9 hrs.	Approx. 8 hrs.	Approx. 8 hrs.
Ni-CAD Rechargeable (min specification recommended 1.2V - 650mA)	Approx. 4 hrs.	Approx. 3 hrs.	Approx. 2.5 hrs.

Note: Zinc/Carbon, or Zinc/Chloride type batteries are not recommended for this unit.

AC Operation (AC adapter not included)

1. Insert the DC plug, at the end of the AC adapter cord into the DC input jack.
2. Plug the AC adapter into AC power outlet socket. Use only with the recommended 6V AC adapter and make sure the local voltage corresponds to the adapters required AC input voltage.

Note:

1. While using power from AC adapter, normal batteries must be taken out of battery compartment.
2. If the AC plug of this unit does not fit in your AC outlet, a plug adapter should be used. Consult your local dealer on the type of plug adapter required.

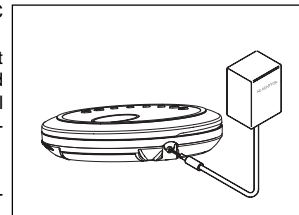

LOW BATTERY ALERT

When the battery indicator starts flashing in the LCD panel, this means that the batteries are losing their charge. In this case the CD player will not function properly and the batteries must be replaced.

If you are using Ni-CD rechargeable batteries, follow the instructions on how to recharge the batteries detailed in the owners manual.



CHARGING AND USE OF RECHARGEABLE BATTERIES

Rechargeable Battery Operation

This unit can fully recharge the specified rechargeable battery in approximately 15 hours. The rechargeable batteries (NOT supplied) should be recharged before they are used for the first time, if they are low in power or they have not been used for a long period (over 60 days).

1. Open the battery compartment cover and insert two of the recommended rechargeable batteries, matching polarity. (1.2V 650mA)
BOTH BATTERIES MUST BE RECHARGEABLE BATTERIES.

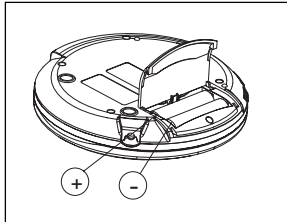

2. Plug in the AC adaptor (not included). Set the Function Switch to CD mode and the Charge Switch to the ON position to start charging.
USE ONLY THE AC ADAPTOR (NOT INCLUDED) RECOMMENDED WITH THE UNIT FOR CHARGING.

Note: Charge indicator will illuminate.

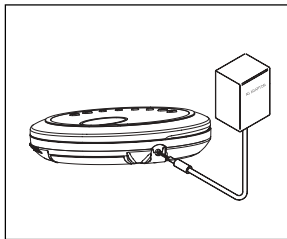

3. After 15 hours, unplug the AC adaptor (not included) and switch the Charge Switch to the OFF position.
DO NOT CHARGE CONTINUOUSLY FOR 24 HOURS OR MORE. DOING SO CAN CAUSE THE PERFORMANCE OF THE RECHARGEABLE BATTERY TO DETERIORATE.

4. If the operating time decreases drastically even when the rechargeable nickel-cadmium batteries are properly recharged, purchase a new set of rechargeable nickel-cadmium batteries. Dispose of nickel cadmium according to local environmental laws.

5. When charging new batteries or if the batteries have not been charged for a long time, playing time may be reduced. In this case, charge and discharge the batteries several times.

NOTE:

- Do not attempt to recharge, short-circuit, disassemble, heat or expose to fire.
- Do not mix battery types. (e.g. alkaline with zinc carbonate).
- When inserting new batteries, replace all at the same time. Do not mix old and new batteries.
- Weak batteries can leak and severely damage the unit.

CAR KIT

DC CAR ADAPTER/CORD

The supplied DC car adapter/cord is designed for use with vehicles equipped with a 12 volt negative ground electrical system only. The equipment is compatible if the negative (-) terminal of the battery is connected to the vehicle's metal body/chassis. If unsure, contact the vehicles' dealer.

Plug the small end of the car adapter into the DC 6V jack and then plug the other end into the cigarette lighter socket. The indicator light will illuminate red when powered on.

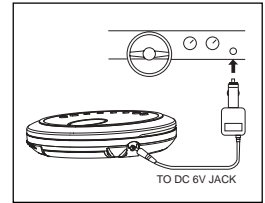

PRECAUTIONS

- USE ONLY THE SUPPLIED DC CAR ADAPTER/CORD. OTHER ADAPTERS COULD DAMAGE THE PLAYER.
- IF THE INSIDE OF THE VEHICLE'S CIGARETTE LIGHTER SOCKET IS DIRTY, THE PLUG MAY BECOME HOT AS A RESULT OF POOR ELECTRICAL CONTACT. BE SURE IT IS CLEAN BEFORE USE.
- AFTER USE, DISCONNECT THE CORD'S PLUGS FROM THE PLAYER AND THE CIGARETTE LIGHTER.
- SHOULD THE PLAYER CAUSE INTERFERENCE TO NEARBY RADIO, INCREASE THE DISTANCE BETWEEN PLAYER AND RECEIVER.

FUSE REPLACEMENT

Should the player fail to operate with the DC car adapter/cord, check the fuse (1-Amp). If blown, check all connections and inspect the cord for any damage. Always replace the fuse with same type and rating.

If the fuse blows again after replacement, this indicates a potential problem. DO NOT replace the fuse with a higher rating. Doing so may cause damage to the player.

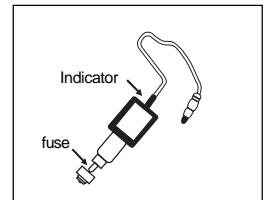

CHANGING THE CORD ORIENTATION (Optional Type 1 or 2)

(Type 1)

1. Remove the two large flathead slotted screws with a coin.
2. Gently remove plastic plate to expose the cord.
3. Gently lift the cord and reroute to rear edge. Be sure to insert cord in the appropriate restraining channel.
4. Reattach the plastic plate, reinsert the two screws, and retighten screws.

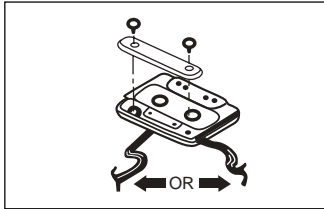

(Type 2)

1. Gently pull out the plug that was originally plugged into the corner of cassette.
2. Insert the plug into the jack perpendicular to the jack which the plug was removed.
3. If it is difficult to insert the plug into the jack rotate the plug until it fits the cassette corner properly.

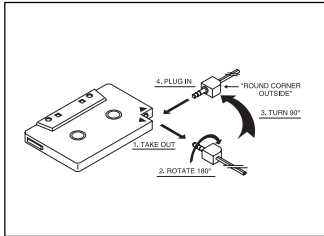

LISTENING IN THE CAR

1. Plug the cord into the HEAD- PHONES jack.
2. Insert the cassette adapter into the deck's cassette slot.

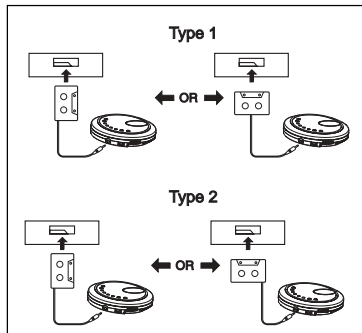

LISTENING WITH EARPHONES

Connect the plug of the stereo earphones into the PHONES (GREEN) socket.

Caution: Avoid excessive volume level and listening to sound for a long period of time when using earphones.

- Adjust volume to the desired level.

HANDLING COMPACT DISCS

This unit is designed to play only compact discs bearing the identification logo below.



Other discs may not conform to the CD standard and may not play properly.

- Dirty, scratched or warped discs may cause skipping or noise.
- Handle the disc only by the edges. To keep clean, do not touch its surface.
- Discs should be stored in their cases after use to avoid serious scratches.
- Do not expose disc to direct sunlight, high humidity, high temperature, dust, etc. Prolonged exposure to extreme temperatures can warp the disc.
- Do not stick or write anything on either side of disc. Sharp writing instruments or the inks used in some felt tip pens may damage its surface.

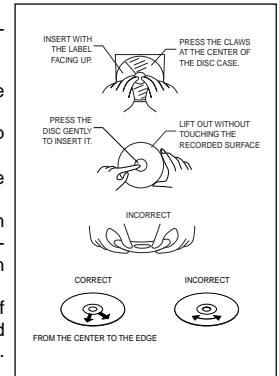
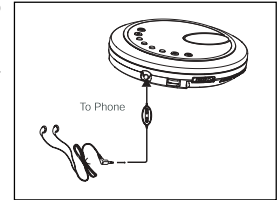

Remove the disc

Hold the edge and gently press the center pivot as illustrated to pick up the disc.

CAUTION:

Wait for the disc to stop rotating before pressing the OPEN button.

Note: This unit can play 3" (8cm) single CDs without an adapter. Do not use a CD single adapter for these discs.

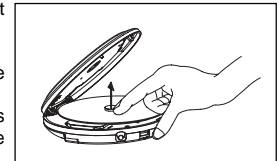

CLEANING DISCS

- Fingerprints should be carefully wiped from the surface of disc with a soft cloth. Unlike conventional records, compact discs have no grooves to collect dust and microscopic debris, so gently wiping them with a soft cloth should remove most particles. Wipe in a straight motion from the center to the edge.
- Never use thinner, benzine, record cleaner or anti-static spray on a compact disc. Such chemicals can damage its plastic surface.

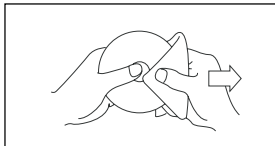

BASIC DISC PLAY

- Connect the earphones to the PHONES (GREEN) socket.
- Slide the OPEN switch to open the CD compartment lid.
- Adjust the VOLUME to desired sound level.
- Insert the disc with the label side facing up.
- Close the lid securely until a click is heard.
- Press the PLAY/PAUSE button to start playing.

To Emphasize the Bass Sound

Set the BASS BOOST switch to the ON position.

Note: The bass boost performance will be dependant on the VOLUME control setting.



HOLD Switch

This switch prevents accidental selection of an unwanted function during Playback or Stop mode. In the HOLD "ON" position, no function button on the unit can operate (except OPEN). Moving the switch to the "OFF" position will allow the unit to return to normal operation.



Turning Power On and Off

This unit has no ON/OFF switch. To turn on and off, press the following buttons.

To turn on: Press >|| PLAY/ PAUSE (playback starts).

To turn off: Press ■ STOP button once to standby mode.

Press ■ STOP button twice to turn off the power.

Auto Power-Off function

When the unit is stopped (standby mode) for approximately 30 sec, the power will automatically turn off.

FEATURE LIST

ITEM	DESCRIPTION	
AUTO POWER ON/OFF	Power on by pressing PLAY button Power off by pressing STOP button Auto power off at 30 sec after last operation during standby mode.	
ANTI CD SKIP	45 seconds 120 seconds	
PLAY MODE	[NORMAL] ONE REPEAT PLAY : Plays one track repeatedly ALBUM REPEAT PLAY : CD-MP3 album repeatedly (CDMP3 only) ALL REPEAT PLAY : Plays all tracks repeatedly INTRO PLAY : Plays 10 sec of every track RANDOM PLAY : Plays every track in random order [PROGRAM] PROGRAM PLAY : Maximum 60 Tracks for CD and 60 tracks for MP3 are programmable ONE REPEAT PLAY : Plays one track repeatedly ALL REPEAT PLAY : Plays all tracks repeatedly	
KEY	STOP	Stops playing Turns off the power during standby mode.
	PLAY/PAUSE	Turns on the power and starts playing Pause on/off
	F.SKIP	Count-up of track number on normal play Count-up of program number on programmed play Count-up of registered track number on programmed play Fast-forward operation during play (when button is pressed for 0.5 sec or longer).
	B.SKIP	Count-down of track number on normal play Count-down of program number on programmed play Count-down of registered track number on programmed play Fast-rewind operation during play (when button is pressed for 0.5 sec or longer).
	MODE	Change play mode cyclically NORMAL → ONE REPEAT → ALL REPEAT → INTRO → RANDOM ↑ [PROGRAM] ↑ ↑ [NORMAL] ↑
	PROGRAM	* ALBUM REPEAT, REPEAT ALL (CDMP3 ONLY) Program play to 60 tracks in CD mode and 60 tracks in MP3 mode, Program check and change.
ESP/ALBUM	Anti-Skip Function in CD mode and Album up Function in MP3 mode.	
ALBUM DOWN	CD-MP3 Album up CD-MP3 Album down in MP3 mode	
LCD	HOLD	Indicates that hold switch is on.
	BATTERY ALARM	Indicates battery change needed
	BATTERY EMPTY	Auto display is turned off.

LCD DISPLAY INFORMATION

WHEN POWER IS ON

- If a disc is in, auto adjustment starts. During adjustment, display shows - - .



- If no disc, **no disc** is displayed. Put the disc in and close the lid. Auto adjustment starts.



- If the lid is opened, display shows **OPEN**. Closing the lid starts auto adjustment.



- If unable to read TOC then **Er** is displayed. Note: TOC means Table Of Contents.



- When TOC data has been read, display shows TOC for 1 second.

- Starts play from track No. 1 automatically, ESP shows on displays.

TO PLAY (Normal play) FROM STOP CONDITION

- Press PLAY/PAUSE button, the display changes to 1 00:00 and starts play.



TO STOP

Press the STOP key. This will stop play and data will be displayed.



Supports 40 directories and 399 files for MP3-CD format disc.

TO PAUSE

Press the PLAY/PAUSE button to turn the pause function on. The time display digits will begin flashing. Press the PLAY/PAUSE button again to turn the pause function off.



SKIP AND SEARCH FUNCTION

Locating a Particular track

To go back to the beginning of the current or a previous track	Press ⏮ lightly and repeatedly.
To go to the beginning of following tracks	Press ⏭ lightly and repeatedly.

Locating a Particular Point in a track

To search backwards at high speed	Keep ⏮ depressed
To search forward at high speed	Keep ⏭ depressed

For CD format discs, the low level audio will be heard during the search process to assist in locating the correct point in the track.

REPEAT PLAY

For CD mode

- Press MODE button once and **1** is displayed. CD player plays current track repeatedly.
- Press MODE button twice and **ALL** is displayed. CD player plays all tracks repeatedly.



For MP3 mode

- Press MODE button once and **1** is displayed. CD player plays current track repeatedly.
- Press MODE button two times and **ALL** is displayed. CD player plays all tracks of current played disc repeatedly.
- Press MODE button three times and **ALL** is displayed. CD player plays all tracks repeatedly.

PROGRAM PLAY

This allows selected tracks on the disc to be played in any desired order.

To set the program play

- CD
- a. In the stop mode, press the PROGRAM button and **0P-01** is displayed. **PGM** and **0** start flashing.
- b. Press F.SKIP or B.SKIP button to select the track number.
- c. When desired track is displayed, press PROGRAM button to register. Then **PGM** and **0P-02** display .
- d. Repeat steps (b) and (c) (up to 60 tracks). After registering all tracks, display shows the first registered track.
- e. Registered track can be checked by pressing PROGRAM button.

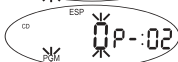
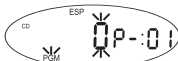

- MP3
- a. In the stop mode, press the PROGRAM button and **0P-01** is displayed. Tracks number and album number start flashing.
- b. Press ALBUM UP and ALBUM DOWN button to select the album number.
- c. When desired album number is displayed, press F.SKIP or B.SKIP button to select track number.
- d. Press PROGRAM button to store, 0P-02 will appear on display. Repeat (b) and (c) up to 60 tracks.
- e. Registered tracks can be checked by pressing PROGRAM button.

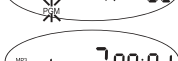
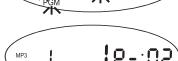
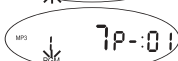
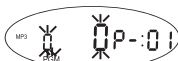

To complete programming and start play

Press PLAY/PAUSE button, the PGM stops flashing and play will begin.



MP3



To clear programming

- Open the door, or
- Power off, or
- In program mode, press STOP button.

INTRO PLAY

1. Press MODE button **three** times (for CD) / **four** times (for MP3), then **INT** is displayed.
2. Press the PLAY/PAUSE button. Starts INTRO play from track number 01.
3. The first 10 seconds of each track of the disc will be played.
4. Press the PLAY/PAUSE button again to return to normal playback.

CD

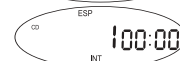

MP3



RANDOM PLAY

Enables all the tracks on a disc to be played in a Random (Shuffle) sequence.

1. Press MODE button **four** times (for CD) / **five** times (for MP3), and **RDM** is displayed.
2. Press PLAY/PAUSE button to start RANDOM play.
3. Select RANDOM mode during play, RDM play start.
 - After finished playing the current track or if F. SKIP or B. SKIP button is pressed, RANDOM play starts.

CD

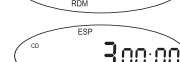
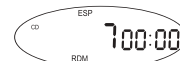

MP3



LOW BATTERY DETECTION

-  starts flashing when battery voltage level is too low. The player will auto stop and power off when the voltage level is too low.



MAINTENANCE

Cleaning the Cabinet

Wipe with a soft cloth. If the cabinet is very dirty, dampen the cloth with a weak solution of neutral detergent and water, and then wipe clean.

Cleaning the lens

A dirty lens will cause the sound to skip. If the lens is very dirty, the CD may not work. Open the disc cover and clean the lens as instructed below.

- Dust or Dry Particles

Using a camera lens brush/blower, blow on the lens a couple times, then wipe it lightly with the brush to remove dust. Then blow on the lens again.

- Fingerprints

If the lens cannot be cleaned by using a brush/blower, use a dry cotton swab, starting from the middle and moving to the outside edge.

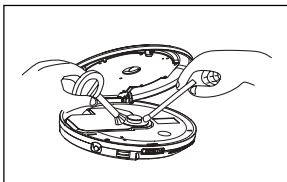

TROUBLESHOOTING GUIDE

Check the following guide for problem resolution

SYMPTOM	CAUSE	SOLUTION
CD/MP3 Player will not turn on	Dead or weak batteries	Replace batteries
	AC adapter not connected properly	Check AC adapter connection
Disc will not play	Defective compact disc	Reinsert the disc with disc label facing up, or try another compact disc
	CD compartment not closed	Close lid securely
	Moisture has formed	Remove the disc, and leave the compartment door open for about one hour to dry the moisture condensation.
Display freeze or will not play	Electro static discharge.	Take out and re-insert the battery to reset the unit.
No sound from earphones	Earphone plug not inserted properly	Reinsert earphone cord into phones jack
	Volume control set to minimum	Increase the volume
	Weak batteries	Replace with fresh batteries or use AC power
	Defective compact disc	Try another compact disc
Sound is skipping	The compact disc or pickup lens is dirty	Clean or replace the compact disc or clean the pickup lens
	Strong vibrations	Place the CD/MP3 Player on a level surface that is stable (no vibrations)

REMARKS:

1. This unit can support MP3 bit rate at 320, 192, 128, 96, 64, 32, 16KBPS.
2. It supports CDDA, CD-R and CD-RW Discs.
3. It can support only 40 directory, 399 files in MP3.
4. It plays the MP3 songs with . mp3 file format.
5. Burning Speed: Normal 4X / Max 8X.

PRODUCT SPECIFICATIONS

PICK UP

System	Compact disc digital audio system
Properties	Wavelength: $\lambda=780\text{nm}$
Supported Disc Type	CD Audio, CD-R, CD-RW, MP3

AUDIO

D/A conversion	DAC four times oversampling
Frequency response	20-20,000Hz
Wow and filter	Below measurable limits
No. of channels	2 Channel (stereo)
Output level	Earphones: 15mW (32 Ω)
Bass boost effect (100Hz)	> 6dB

DISPLAY

	Segment LCD
--	-------------

GENERAL

Power requirements	- 2 X LR6 "AA" alkaline battery -DC in 6V jack accepts AC power adapter (center positive with 4.0mm external dia. plug, regulated 6V DC, 600mA) (not included)
Power consumption	0.8W (DC 3V) under normal condition
Dimension	Approx. 140 (W) x 28.5 (H) x 144 (D) mm
Weight	Approx. 230g not including battery

DESIGN AND SPECIFICATION ARE SUBJECT TO CHANGE WITHOUT NOTICE.