

# Installation Instructions / Warranty

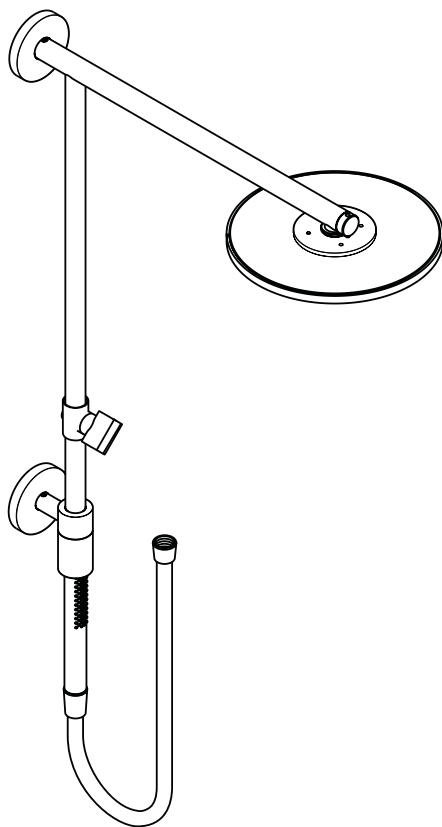

**Raindance Connect  
Showerpipe**  
27164001

**hansgrohe**

Raindance Connect Showerpipe  
27164001

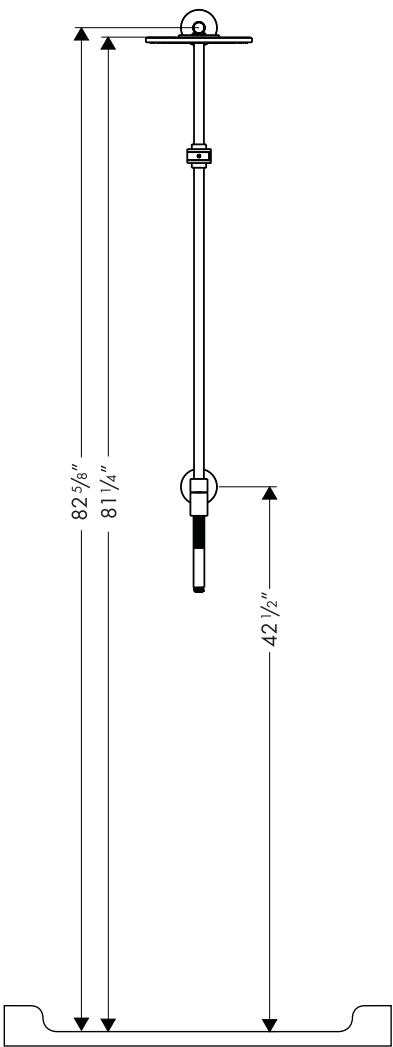
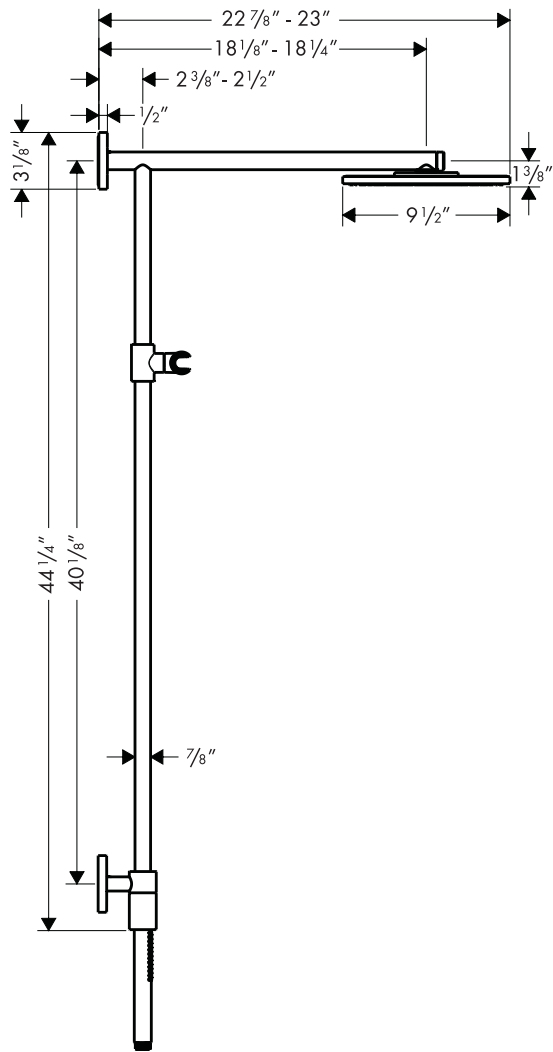

**Suggested installation**

## Technical Information

Max. water pressure	147 psi
Recommended water pressure	29 - 72 psi
Test pressure	232 psi
Max. flow rate	
showerhead	2.5 gpm
handshower	2.5 gpm

## Installation Considerations

 *This unit does not include a water supply. Use Hansgrohe model 27458XX3 or another supply that complies with ASME A112.18.1/CSA B215.1 including ASME A112.18.3.*

The installer should be sure that the mounting location for this product is flat (no projecting joints or tiles) and that the wall is suitable for the installation of this product.

The included mounting hardware is suitable for solid surface walls, such as:

- concrete
- concrete wallboard

- dense natural stone
- brick
- gypsum wallboard/plaster fiberboard surfaced with tile, marble, or stone

If this product is to be installed on another type of wall, such as a fiberglass or acrylic shower enclosure, please contact the manufacturer of the enclosure for recommendations regarding suitable mounting hardware, mounting locations, and reinforcement.

In Massachusetts, the maximum output temperature of the shower mixing valve can be no higher than 112°F.

## Recommended tools (not included)

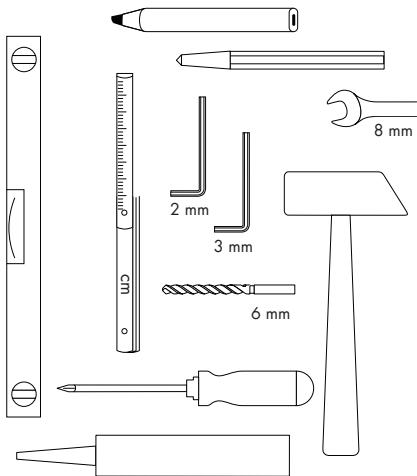

grease pencil or other marking tool  
level  
ruler  
2 & 3 mm Allen wrenches  
6 mm drill bit  
8 mm wrench  
Philips screwdriver  
waterproof sealant

# Installation

Drill the screw holes with a 6 mm bit.

Install the anchors.

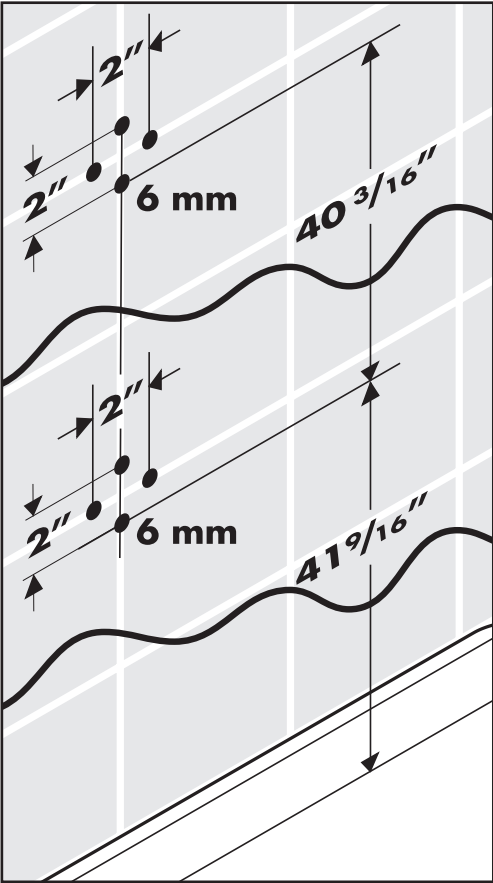

If both ends of the showerpipe are mounted on tile, install the top and bottom mounting wall flanges.

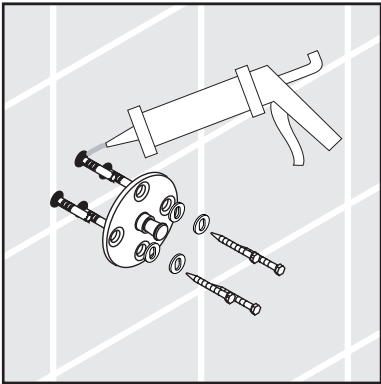

If the bottom of the showerpipe is mounted on tile, but the top is not, install the top wall flange with the tile matching disk.

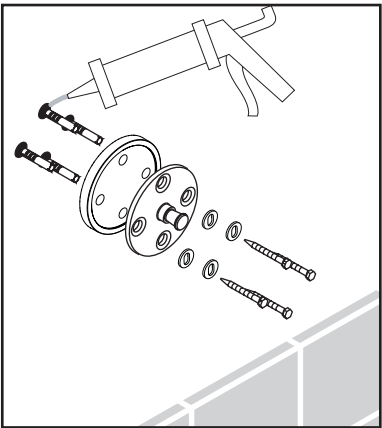

Push the shower arm and lower support into the ends of the riser. Install the escutcheons.

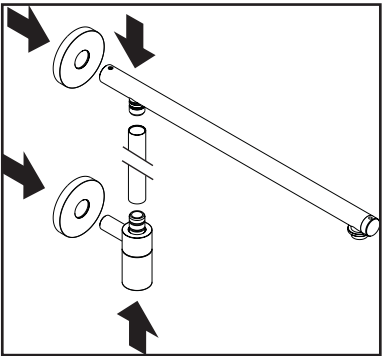

Push the showerpipe assembly over the wall flanges. Tighten the set screws with a 3 mm Allen wrench.

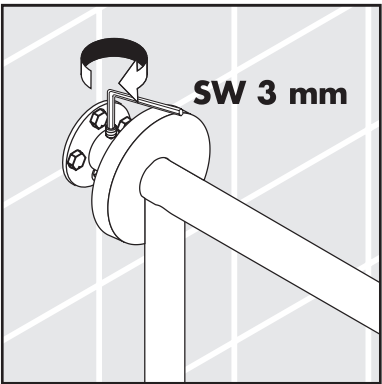

Install the showerhead on the shower arm.

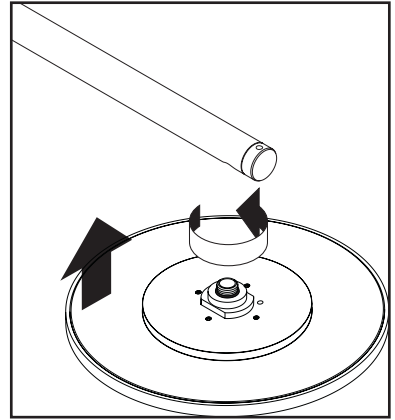

Use a level to make sure that the shower arm is straight.  
If it is not, loosen the mounting screws slightly with an 8 mm wrench. Reposition the arm until it is straight. Tighten the mounting screws.

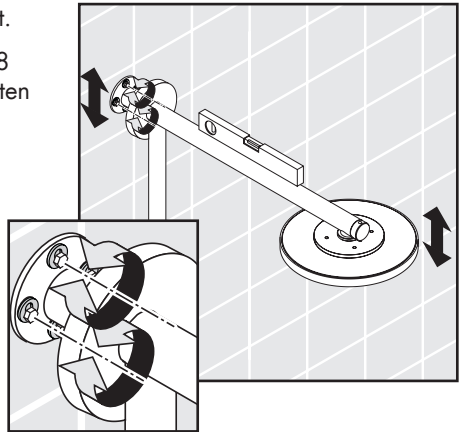

Attach the escutcheons to the flanges by rotating them clockwise.

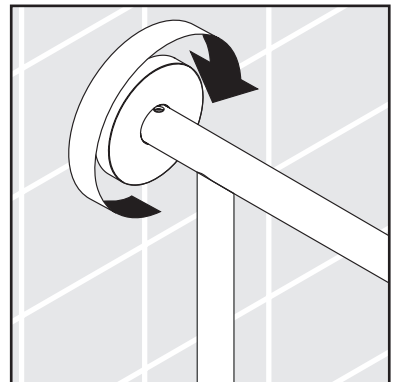

Tighten the shower arm safety screw with a 2 mm Allen wrench.

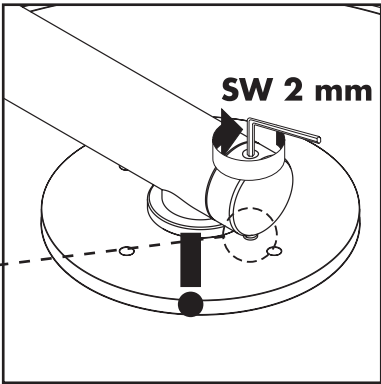

Place a hose washer in one end of the hose. Connect this end to the water supply (not included).



*This unit does not include a water supply. Use Hansgrohe model 27458XX3 or another supply that complies with ASME A112.18.1/CSA B215.1 including ASME A112.18.3.*

Place the screen washer in the other end of the hose. Connect this end to the handshower.

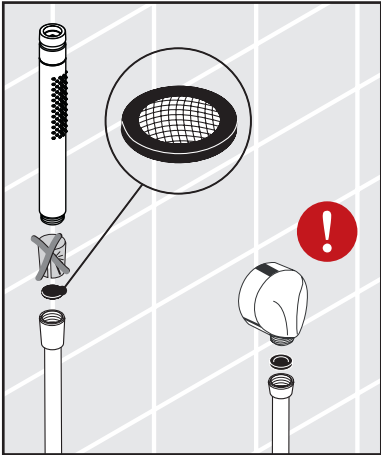

### Adjust the slider

To make the slider easier to move up and down the bar, turn the screw counter-clockwise.

To make it harder to move, turn the screw clockwise.

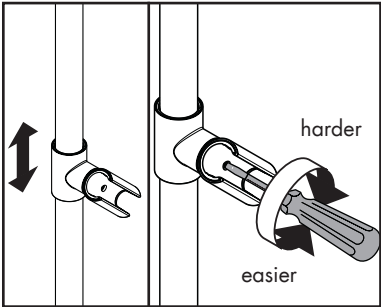

# User instructions

When the water is turned on, it will come from the handshower.

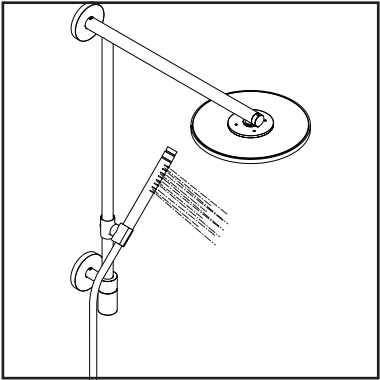

To use the showerhead, push the handshower up into the handshower holder on the bottom of the showerpipe.

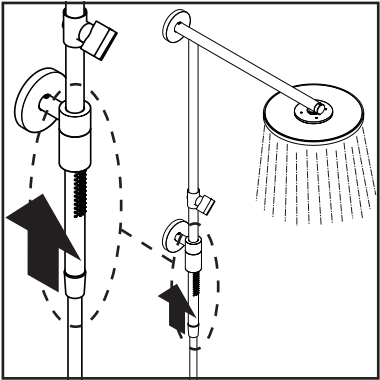

To remove the handshower from the showerpipe, push downwards on the holder (1), then pull the handshower down and out of the pipe(2).

Approximately 1 quart of water will come from the bottom of the showerpipe when the handshower is removed.

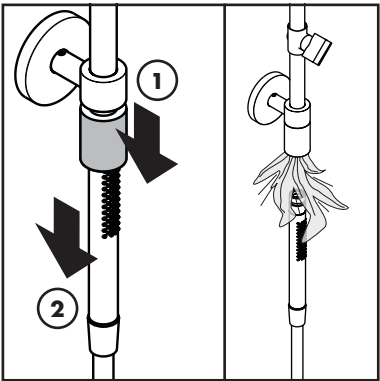



## Scale removal

The showerhead and the handshower use the Quick Clean™ cleaning system. If scale deposits are noticed in the spray channels, turn the water on lightly and rub across the channels with a finger or a sponge to dislodge them.

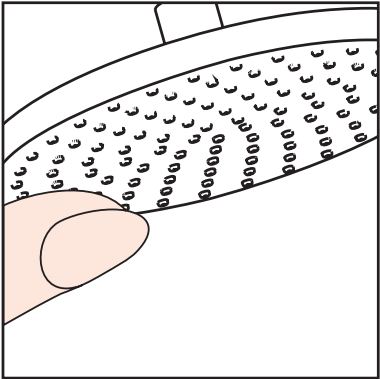

To remove scale deposits from the showerhead spray face, pour about  $\frac{3}{4}$ " of a commercial scale remover\*, such as Lime-Away™ or CLR™, into a shallow dish.

Soak the spray face for the amount of time shown in the label instructions.

Rinse the showerhead with clear water.

Install the showerhead. Flush it with clear water for at least one minute.

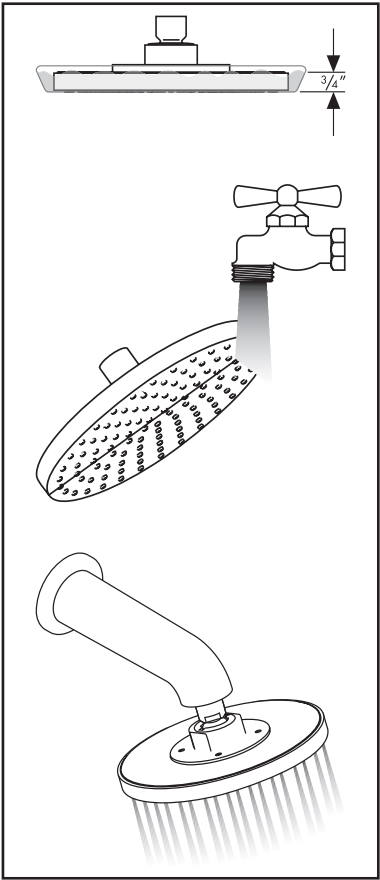

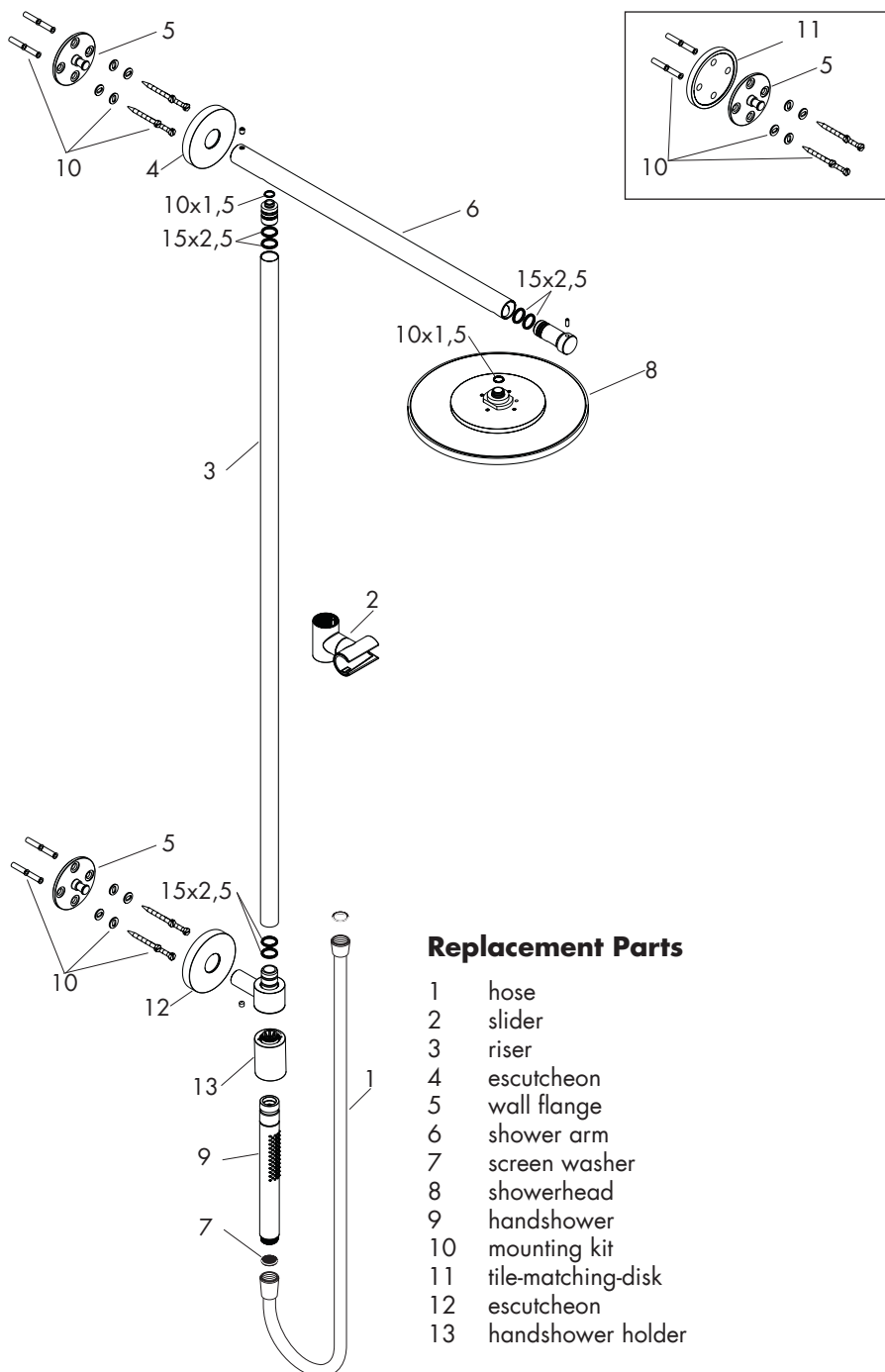

## Cleaning Recommendation for Hansgrohe Products

Modern lavatory faucets, kitchen faucets, and showers consist of very different materials to comply with the needs of the market with regard to design and functionality. To avoid damage and returns, it is necessary to consider certain criteria when cleaning.

### Cleaning Materials for Faucets and Showers

Acids are a necessary ingredient of cleaning materials for removing lime, however please pay attention to the following points when cleaning faucets and showers:

- Only use cleaning materials which are explicitly intended for this type of application.
- Never use cleaning materials which contain hydrochloric, formic, phosphoric, or acetic acid, as they cause considerable damage.
- Never mix one cleaning material with another.
- Never use cleaning materials or appliances with an abrasive effect, such as unsuitable cleaning powders, sponge pads, or micro fiber cloths.

### Cleaning Instructions for Faucets and Showers

Please follow the cleaning material manufacturer's instructions. In addition, pay attention to the following points:

- Clean the faucets and showers as and when required
- Use the amount of cleaning product and the amount of time recommended by the manufacturer. Do not leave the cleaner on the fixture longer than necessary.
- Regular cleaning can prevent calcification.
- When using spray cleaners, spray first onto a soft cloth or sponge. Never spray directly onto the faucet as droplets can enter openings and gaps and cause damage.
- After cleaning, rinse thoroughly with clean water to remove any cleaner residue.

### Important

Residues of liquid soaps, shampoos, and shower foams can also cause damage, so rinse with clean water after using.

**Please note:** if the surface is already damaged, the effect of cleaning materials will cause further damage.

**Components with damaged surfaces must be replaced or injury could result.**

**Damage caused by improper treatment is not covered under the warranty.**

## Limited Lifetime Consumer Warranty

This product has been manufactured and tested to the highest quality standards by Hansgrohe, Inc. ("Hansgrohe"). This warranty is limited to Hansgrohe products which are purchased by a consumer in the United States after March 1, 1996, and installed in either the United States or Canada.

### WHO IS COVERED BY THE WARRANTY

This warranty extends to the original consumer purchaser only. This warranty is non-transferable.

### WHAT IS COVERED BY THE WARRANTY

This warranty covers only your Hansgrohe manufactured product. Hansgrohe warrants this product against defects in material or workmanship as follows: Hansgrohe will repair at no charge for parts only or, at its option, replace any product or part of the product that proves defective because of improper workmanship and/or material, under normal installation, use, service and maintenance. If Hansgrohe is unable to provide a replacement and repair is not practical or cannot be timely made, Hansgrohe may elect to refund the purchase price in exchange for the return of the product.

### LENGTH OF WARRANTY

Replacement or repaired parts of products will be covered for the term of this warranty as stated in the following two sentences. If you are a consumer who purchased the product for use primarily for personal, family, or household purposes, this warranty extends for as long as you own the product and the home in which the product is originally installed. If you purchased

the product for use primarily for any other purpose, including, without limitation, a commercial purpose, this warranty extends only (i) for 1 year, with respect to Hansgrohe and Commercial products, and (ii) for 5 years, with respect to AXOR products.

THIS WARRANTY DOES NOT COVER, AND HANSGROHE WILL NOT PAY FOR:

- A. Conditions, malfunctions or damage not resulting from defects in material or workmanship.
- B. Conditions, malfunctions or damage resulting from (1) normal wear and tear, improper installation, improper maintenance, misuse, abuse, negligence, accident or alteration, or (2) the use of abrasive or caustic cleaning agents or "no-rinse" cleaning products, or the use of the product in any manner contrary to the product instructions. (3) Conditions in the home such as excessive water pressure or corrosion.
- C. Labor or other expenses for the disconnection, deinstallation, or return of the product for warranty service, or for installation or reinstallation of the product (including but not limited to proper packaging and shipping costs), or for installation or reinstallation of the product.
- D. Accessories, connected materials and products, or related products not manufactured by Hansgrohe.

#### TO OBTAIN WARRANTY PARTS OR INFORMATION

Contact your Hansgrohe retailer, or contact Technical Service at:

Hansgrohe Inc.  
1492 Bluegrass Lakes Parkway  
Alpharetta GA 30004  
Toll-free (800) 334-0455.

In requesting warranty service, you will need to provide

- 1. The sales receipt or other evidence of the date and place of purchase.
- 2. A description of the problem.
- 3. Delivery of the product or the defective part, postage prepaid and carefully packed and insured, to Hansgrohe Inc. 1492 Bluegrass Lakes Parkway, Alpharetta, Georgia 30004, Attention: Technical Service, if required by Hansgrohe.

When warranty service is completed, any repaired or replacement product or part will be returned to you postage prepaid.

#### EXCLUSIONS AND LIMITATIONS

REPAIR OR REPLACEMENT (OR, IN LIMITED CIRCUMSTANCES, REFUND OF THE PURCHASE PRICE) AS PROVIDED UNDER THIS WARRANTY IS THE EXCLUSIVE REMEDY OF THE PURCHASER. HANSGROHE NEITHER ASSUMES NOR AUTHORIZES ANY PERSON TO CREATE FOR IT ANY OBLIGATION OR LIABILITY IN CONNECTION WITH THIS PRODUCT.

HANSGROHE SHALL NOT BE LIABLE TO PURCHASER OR ANY PERSON FOR ANY INCIDENTAL, SPECIAL, OR CONSEQUENTIAL DAMAGES, ARISING OUT OF BREACH OF THIS WARRANTY OR ANY IMPLIED WARRANTY (INCLUDING MERCHANTABILITY).

Some States do not allow the exclusion or limitation of incidental or consequential damages, so the above limitation or exclusion may not apply to you. This warranty gives you specific legal rights, and you may have other rights which vary from State to State. You may be required by law to give us a reasonable opportunity to correct or cure any failure to comply before you can bring any action in court against us under the Magnuson-Moss Warranty Act.

#### PRODUCT INSTRUCTIONS AND QUESTIONS

Upon purchase or prior to installation, please carefully inspect your Hansgrohe product for any damage or visible defect. Prior to installing, always carefully study the enclosed instructions on the proper installation and the care and maintenance of the product. If you have questions at any time about the use, installation, or performance of your Hansgrohe product, or this warranty, please call or write to us or call us toll-free at 800 334 0455.

**hansgrohe**

Hansgrohe, Inc. • 1490 Bluegrass Lakes Parkway • Alpharetta, GA 30004  
Tel. 770-360-9880 • Fax 770-360-9887

[www.hansgrohe-usa.com](http://www.hansgrohe-usa.com)