



CECILWARE - #304 Stainless Steel Sinks

Assembly Instructions:

**PS-18, PS-24, KS18-2DB, KS18LDB, KS18RDB,
KS24LDB, KS24RDB, KS218-2DB, KS218LDB,
KS218RDB, KS218NDB, KS310-2DB, KS315-2DB,
KS318-2DB, KS318LDB, KS318RDB, KS318NDB,
KS31824-2DB, KS324-2DB, KS32418-2DB,
KS328-2DB, KS418-2DB & KS418NDB**

Cecilware Corporation
43-05 20th Avenue
Long Island City, NY 11105
Tel: 800-935-2211
Fax: 718-932-7860
www.cecilwarephotos.com

Section 1

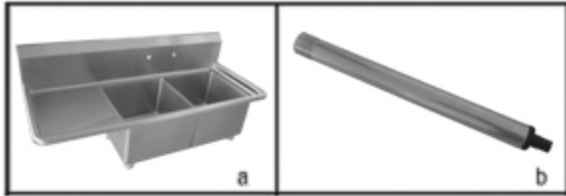

Parts List- See Section 1

- a. 1 Stainless Steel Sink Top
- b. 4 Galvanized Legs

Assembly - See Section 2

- Carefully take all of the parts out of the box.
- Turn sink upside down and set on floor or level surface.
- Align each leg with leg socket on sink and screw into place.
- Adjust the legs so that they are level and firmly affixed in the sink socket.
- Turn sink right-side up. If there is any movement in the sink, the feet can be used to make adjustment and level the sink ready for use.

Section 2

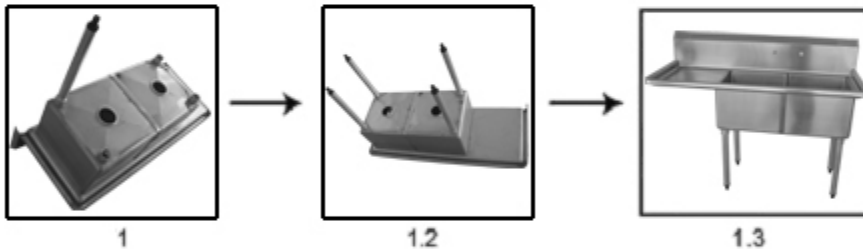

Care of the Sink

- Clean the sink regularly as required, using a cleaning agent recommended for stainless steel and galvanized legs.
- Always clean off any cleaning agent residues, as failure to do so may cause discolouring and marks to develop.
- Never leave any surface with water or damp areas, as this may cause discolouration.

Warning

- Whilst Cecilware attempts to remove all sharp edges, care must be taken when cleaning or handling the sink to prevent the risk of injury from exposed metal edges.
- Do not overload the sink causing it to bend.

Cecilware Corporation
43-05 20th Avenue
Long Island City, NY 11105
Tel: 800-935-2211
Fax: 718-932-7860
www.cecilwarephotos.com