

---

# Kodak EasyShare photo printer 300



## User's Guide

[www.kodak.com](http://www.kodak.com)

For interactive tutorials, [www.kodak.com/go/howto](http://www.kodak.com/go/howto)



Eastman Kodak Company  
Rochester, New York 14650

© Eastman Kodak Company, 2004



All screen images are simulated.

Kodak, EasyShare, and XtraLife are trademarks of  
Eastman Kodak Company.

P/N 4J3105

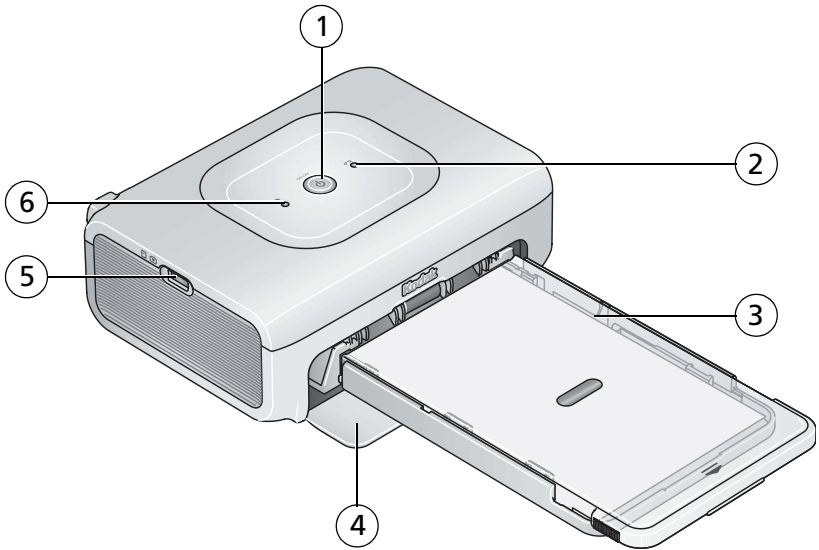
## Front/top/side view

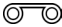

- |   |   |   |   |
|---|---|---|---|
| 1 | On/Off button/light    | 4 | Paper tray door   |
| 2 | Color cartridge light  | 5 | USB device connector (for PictBridge compatible device)                                       |
| 3 | Paper tray  | 6 | Paper light  |

## Back/top/side view

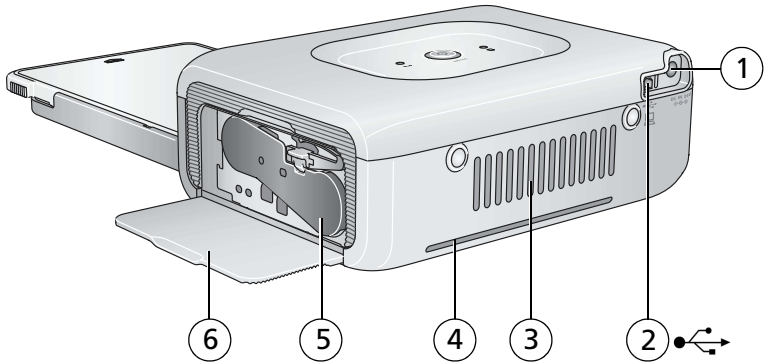

- |   |                             |   |                                      |
|---|-----------------------------|---|--------------------------------------|
| 1 | Power connector (DC-in)     | 4 | Slot for paper path                  |
| 2 | USB connector (to computer) | 5 | Color cartridge (installed as shown) |
| 3 | Cooling vents               | 6 | Cartridge door                       |

---

# Table of contents

<b>1 Getting started</b> .....	<b>1</b>
Finding a location for your photo printer .....	1
Connecting and turning on the power .....	2
Handling and storing the color cartridge .....	3
Installing and removing the color cartridge .....	3
Handling and storing the paper .....	4
Loading the paper .....	5
Installing and removing the paper tray .....	6
Setting the picture quality on your digital camera .....	7
<b>2 Printing from a PictBridge compatible camera</b> .....	<b>8</b>
Removing the perforated tabs from the paper .....	9
Canceling printing .....	9
<b>3 Installing software</b> .....	<b>10</b>
Minimum system requirements .....	10
Installing the software .....	10
<b>4 Printing from a computer</b> .....	<b>13</b>
Connecting to a computer .....	13
Canceling printing .....	16
<b>5 Care and maintenance</b> .....	<b>17</b>
General care .....	17
Cleaning the paper feed roller .....	18
Traveling with your photo printer .....	19

<b>6</b>	<b>Troubleshooting</b> .....	<b>20</b>
	Printing problems.....	20
	Photo printer status lights .....	26
<b>7</b>	<b>Getting help</b> .....	<b>29</b>
	Helpful links.....	29
	Telephone customer support .....	30
<b>8</b>	<b>Appendix</b> .....	<b>31</b>
	Photo printer specifications .....	31
	Important safety instructions .....	32
	Upgrading your software and firmware.....	32
	Additional care and maintenance .....	32
	Warranty.....	33
	Regulatory information.....	35

# 1

## Getting started

### Finding a location for your photo printer

- Place the photo printer on a flat, clean, dust-free surface, in a dry location, and out of direct sunlight.

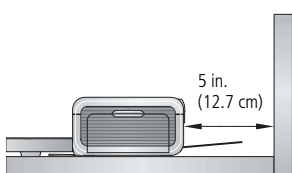

- Allow at least 5 in. (12.7 cm) clearance from the back of the photo printer for paper travel.
  - For proper ventilation, make sure the top and back of the photo printer are not blocked.
  - When connecting power or USB cables, keep the cables clear of the paper path to the front and rear of the photo printer.
- Avoid areas where ventilation ducts, open doors, or frequent passersby might expose the photo printer and paper to high levels of dust and debris. Airborne dirt particles can affect picture quality.
  - Allow enough space on all sides of the photo printer to let you connect and disconnect cables, change the color cartridge, and add paper.

## Connecting and turning on the power



### RISK OF ELECTRIC SHOCK:

Use only the AC power adapter included with your photo printer. Other adapters or cords can damage your camera, photo printer, or computer.

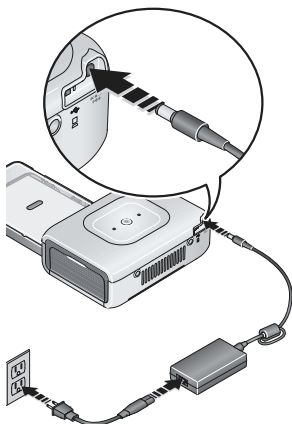

- 1 Connect the AC power cord to the AC power adapter, then to the back of the photo printer.

NOTE: The AC power cord included with your photo printer may not require assembly, and may be different from the one shown.

- 2 Plug the AC power cord into a power outlet.

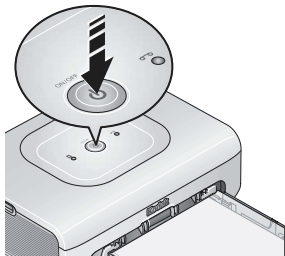

- 3 Press the On/Off button, , to turn the power on.

*The photo printer initializes and the On/Off button glows steady green.*

## Turning the power off

To turn the power off, press and hold the On/Off button for two seconds.



## Handling and storing the color cartridge

- For best quality prints, store the color cartridge in a location where the temperature does not exceed 85 °F (30 °C).
- To avoid getting fingerprints on the ribbon, handle the color cartridge by the spool ends.
- Keep the color cartridge away from direct sunlight and out of high-temperature environments (such as a vehicle parked in the sun).

## Installing and removing the color cartridge

- 1 Open the cartridge door on the side of the photo printer.

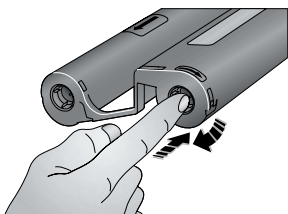

- 2 Check to make sure there is no slack in the color cartridge ribbon.

To remove slack, push in on the cartridge spool, then rotate the spool clockwise.

**IMPORTANT:** *Be careful not to rotate the spool more than necessary. Doing so could reduce the number of prints you are able to make.*

- 3 Slide the color cartridge in, label side up, with the arrow pointing toward the photo printer. Push the cartridge until it "clicks" into place.
- 4 Close the cartridge door.

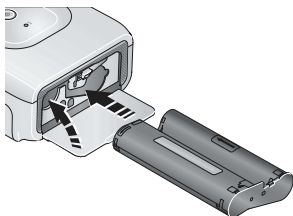

**IMPORTANT:** *The color cartridge may lock in place if there is a paper error. Do not attempt to remove the cartridge without first clearing the paper error. Make sure the Paper light is off before attempting to remove the cartridge (see Paper light under [Photo printer status lights](#), page 26).*

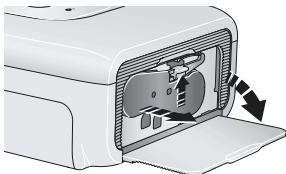

To remove the color cartridge, open the cartridge door, then push up on the green lever and slide the cartridge out.

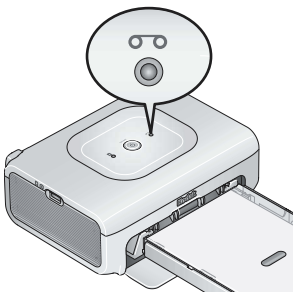

- When 5 or fewer prints remain, the Color cartridge light blinks slowly for several seconds.
- When the color cartridge is depleted, the Color cartridge light glows steady red.

After installing a new color cartridge, press the On/Off button to clear the cartridge error and resume printing.

## Handling and storing the paper

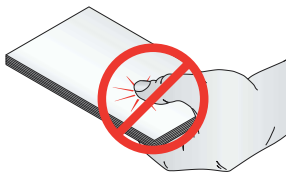

- To avoid fingerprints, handle the paper by the edges or by the perforated tabs. Do not touch the glossy side of the paper.
- When storing paper, do not remove paper that is in the paper tray. Instead, remove the paper tray itself, then close the paper tray cover and paper tray door to keep out dust and debris.

- Store paper flat.
- Keep the paper away from direct sunlight and out of high-temperature environments (such as a vehicle parked in the sun).

## Loading the paper

1 Remove the paper tray from the photo printer if installed (see [page 6](#)).

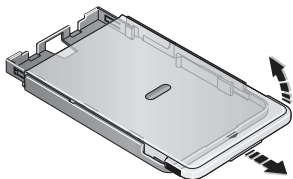

2 Slide the paper tray cover back until it "clicks" into place, about 1.25 in. (3 cm), then lift up on the end of the paper tray cover.

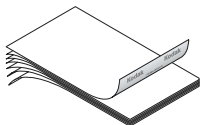

3 Carefully "fan" the paper to keep the sheets from sticking together.

**IMPORTANT:** *Do not load more than 25 sheets of paper. Use the upper limit line inside the paper tray as a guide to prevent overloading. Do not load paper that is missing perforated tabs. To avoid fingerprints, do not touch the glossy side of the paper.*

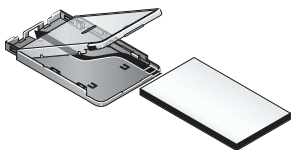

4 Load the paper into the paper tray, with the Kodak logo side facing down.

5 Close the paper tray cover.

Purchase Kodak color cartridge & paper kits and other accessories at a retailer of Kodak products, or visit [www.kodak.com/go/accessories](http://www.kodak.com/go/accessories).

## Installing and removing the paper tray

1 Open the paper tray door.

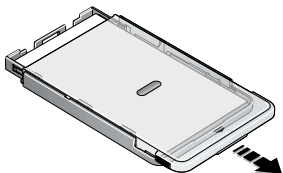

2 Slide the paper tray cover back until it "clicks" into place, about 1.25 in. (3 cm).

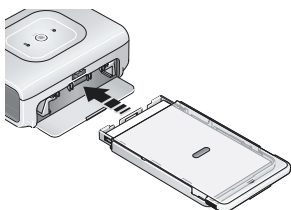

3 Slide the paper tray in the printer tray slot until the tray locks into place.

**IMPORTANT:** *To ensure the paper tray fits squarely on the photo printer, make sure to keep the paper tray cover all the way open while installing.*

Pull the paper tray out to remove it.

Close the paper tray cover and paper tray door to keep out dust and debris.

■ When the paper tray is empty, the Paper light glows steady red.

After refilling and installing the paper tray, press the On/Off button to clear the paper error and resume printing.

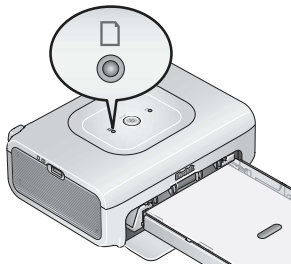

## Setting the picture quality on your digital camera



Before taking pictures, change the picture quality setting (or resolution) on your digital camera to **3:2 ★★★**. This ensures that the pictures you take are proportional to the photo printer paper, preventing unwanted cropping of your pictures. See your camera user's guide for more information.

## 2

# Printing from a PictBridge compatible camera

The Kodak EasyShare photo printer 300 offers PictBridge compatibility, which lets you print from your Kodak EasyShare digital camera or any PictBridge compatible camera or device.

1 Take pictures with your camera (see your camera user's guide).

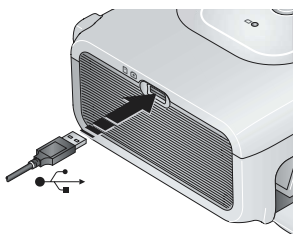

2 Connect your PictBridge compatible camera to the photo printer using the USB cable for your camera. Plug one end of the cable into the camera and the other into the USB device connector located on the side of the photo printer.

NOTE: If the PictBridge compatible camera is already plugged in but the connection is no longer available, disconnect then reconnect the USB cable to re-establish the connection.

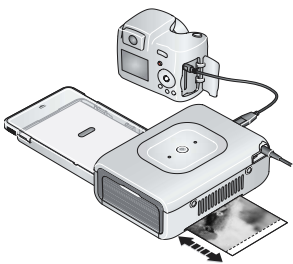

3 Use your digital camera to review pictures, choose printing options, and print. See your camera user's guide for details.

*The On/Off button blinks while printing. The paper cycles four times during the printing process before the finished print is ejected. The first three passes apply layers of yellow, magenta, and cyan colors to the print, and the fourth pass applies the Kodak XtraLife™ coating that protects and preserves the image.*

**IMPORTANT:** Wait until printing is complete before removing paper, the paper tray, or the camera. Failure to do so can cause paper misfeeds or jams.

## Removing the perforated tabs from the paper

**IMPORTANT:** Remove perforated tabs only after printing. Paper missing perforated tabs will not feed properly.

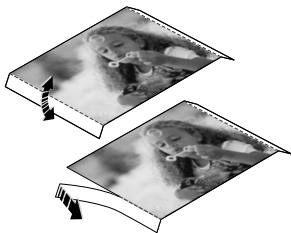

- 1 Fold the tabs up, then down.
- 2 Remove each tab and discard.

## Canceling printing

To cancel printing, press and hold the On/Off button for two seconds.

*The photo printer finishes the current print coating, ejects the print, then powers off.*

# 3

## Installing software

### Minimum system requirements

#### Windows OS-based computers

- Windows 98, 98SE, ME, 2000 SP1, or XP OS
- Internet Explorer 5.01 or higher
- 233 MHz processor or greater
- 64 MB RAM (128 MB RAM for Windows XP OS)
- 200 MB hard disk space available
- CD-ROM drive
- Available USB port
- Color monitor, 800 x 600 pixels (16-bit or 24-bit recommended)

#### Macintosh computers

- Power Mac G3, G4, G5, G4 Cube, iMac; PowerBook G3, G4; or iBook computers
- Mac OS 10.2 or higher
- Safari 1.0 or higher for complete installation
- 128 MB RAM
- 200 MB hard disk space available
- CD-ROM drive
- Available USB port
- Color monitor, 1024 x 768 pixels (thousands or millions of colors recommended)

### Installing the software

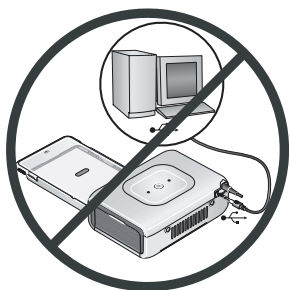

**IMPORTANT:** *Install Kodak EasyShare software before connecting the photo printer to the computer.*

- 1 Close all software applications that are open on your computer (including anti-virus software).
- 2 Place the Kodak EasyShare software CD into the CD-ROM drive.



### 3 Load the software:

**Windows OS-based computer**—if the install window does not appear, choose Run from the Start menu and type **d:\setup.exe** where **d** is the drive letter that contains the CD.

**Mac OS X**—double-click the CD icon on the desktop, then click the Install icon.

### 4 Follow the on-screen instructions to install the software.

- Select Complete to automatically install the most commonly used applications. Select Custom to choose the applications you wish to install.

**IMPORTANT:** *To use the photo printer with a computer, you must install the printer driver. If you choose Custom, make sure the photo printer is selected. The printer driver is automatically installed if you choose Typical.*

#### **Add the printer for Mac OS X:**

- a Open the finder window and click the Applications button. If you don't see the Applications button, open the Applications folder on your operating drive.
- b Open the Utilities folder, then double-click Print Center.
- c In the Printer List window, click Add Printer.
- d Select the photo printer, then click Add.

*The photo printer is added to your computer.*

**IMPORTANT:** *When prompted, take a few minutes to electronically register your photo printer and software. This lets you receive information regarding software updates and registers some of the products included with the photo printer. You must be connected to your Internet service provider to register electronically. To register later, visit [www.kodak.com/go/register](http://www.kodak.com/go/register).*

### 5 Restart the computer if prompted. If you turned off anti-virus software, turn it back on. See the anti-virus software manual for details.

For more information on installing the software, see the ReadMe file on the Kodak EasyShare software CD. For information on the software applications included on the Kodak EasyShare software CD, click the Help button in the EasyShare software.

## Uninstalling the software

If you wish to remove the printer driver or EasyShare software from your computer, use the following procedure:

### Windows OS-based computer:

- 1 Open the Control Panel:

From the Start menu, select Settings, then select Control Panel. (On Windows XP operating systems, depending on your configuration, Control Panel may be found in the Start menu.)

- 2 Double-click Add/Remove Programs.
- 3 Select Kodak EasyShare software, then click Remove.
- 4 Select Modify to uninstall single components, such as the printer driver, or select Remove to uninstall all components.
- 5 Follow the on-screen instructions. Restart the computer if prompted.

### Mac OS X:

- 1 Double-click the operating drive for your system.
- 2 Select Library, then select Printers.
- 3 Open the Kodak folder, then open the photo printer folder.
- 4 Double-click the photo printer uninstaller program.
- 5 Follow the on-screen instructions.

# 4

## Printing from a computer

### Connecting to a computer

1 Make sure Kodak EasyShare software is installed on the computer (see [page 10](#)).

2 Plug the labeled  end of the USB cable (included with the photo printer) into the labeled USB port on your computer. See your computer documentation for details.

3 Plug the other end of the USB cable into the USB connector on the back of the photo printer.

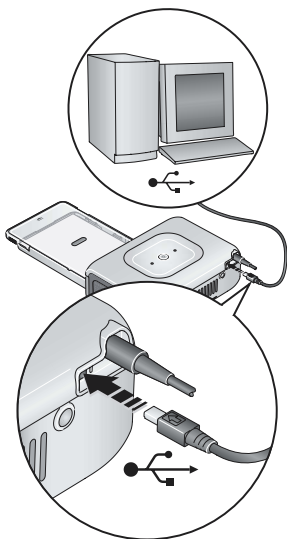

## Printing with Kodak EasyShare software

We recommend using Kodak EasyShare software (included) for printing pictures from your computer. This software lets you take advantage of a wide range of features, including full color enhancement, red-eye reduction, picture organization, and more.

- 1 Make sure Kodak EasyShare software is installed (see [page 10](#)) and the photo printer is connected to your computer (see [page 13](#)).
- 2 Click the My Collection tab.
- 3 Select the pictures you wish to print.
- 4 Click the Print at Home tab.
- 5 Make sure the photo printer is selected as the current printer.
- 6 Change any other settings, such as paper size and print layout, then click Print.

**IMPORTANT:** *Wait until printing is complete before removing paper or the paper tray. Failure to do so can cause paper misfeeds or jams.*

See the EasyShare software Help for details. For more information, and to download the latest version of EasyShare software, visit [www.kodak.com/go/easysharesw](http://www.kodak.com/go/easysharesw).

## Printing using other applications

- 1 Make sure the printer driver is installed (see [page 10](#)), and the photo printer is connected to your computer (see [page 13](#)).
- 2 Open the pictures you wish to print in the application from which you want to print.
- 3 Access printer settings by selecting Print or Page Setup from the File menu (depending on your application and operating system).
- 4 Make sure the photo printer is selected as the current printer.
- 5 Change any other settings as needed, then click OK or Print. (Depending on your application and operating system, you may first need to return to the main menu and select Print from the File menu.)

**IMPORTANT:** *Wait until printing is complete before removing paper or the paper tray. Failure to do so can cause paper misfeeds or jams.*

## Choosing a color mode

Kodak's color mode feature uses automatic color correction to help you make great-looking prints. The Kodak EasyShare photo printer 300 features three color mode options:

**Enhanced**—to get richer, more vivid colors.

**Natural**—to get great, natural color for everyday picture-making.

**None**—to disable automatic color correction.

To change the color mode:

### Windows 2000/XP OS:

- 1 From the Start menu, select Settings, then select Printers.  
NOTE: Depending on your Start Menu configuration, you may need to select Printers and Faxes from the Control Panel.
- 2 Right-click the photo printer icon, then select Printing Preferences.
- 3 Click the Color Correction tab.
- 4 Select a color correction option, then click OK.

### Windows 98/ME OS:

- 1 From the Start menu, select Settings, then select Printers.
- 2 Right-click the photo printer icon, then select Properties.
- 3 Click the Color Correction tab.
- 4 Under Color Correction, select a color mode option.
- 5 Click OK when complete.

**Mac OS X:**

- 1 Make sure the photo printer is selected as the current printer.
- 2 From an application File menu, select Print.
- 3 Select Color Control from the Copies & Pages pop-up menu.
- 4 Select Kodak color.
- 5 Select a color mode option.

## **Canceling printing**

**Windows OS-based computer:**

- 1 Double-click the printer icon in the system tray.
- 2 Click the print job you want to cancel.
- 3 From the menu bar, select Document, then select Cancel.

**Mac OS X:**

- 1 In Print Center, double-click the printer icon.
- 2 Click the job you want to cancel, then select Delete.

# 5

## Care and maintenance

### General care

**IMPORTANT:** *Disconnect the power before cleaning. Do not use harsh or abrasive cleaners or organic solvents on the photo printer or any of its parts.*

- To clean, wipe the outside of the photo printer with a clean, dry cloth.

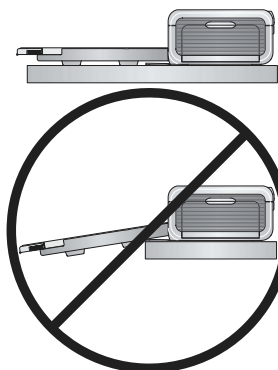

- Support the photo printer and tray by placing it on a flat, level surface. Do not block the cooling vents.
  - Avoid blocking the back of the photo printer and paper tray exit.
  - Keep power and USB cables away from the paper path.
  - Keep the surrounding area vacuumed and litter-free.
  - Protect the photo printer from tobacco smoke, dust, sand, and liquid spills.
- 
- Avoid placing objects on the photo printer.
  - Keep the photo printer, accessories, and supplies away from direct sunlight and out of high-temperature environments (such as a vehicle parked in the sun).
  - When storing paper, do not remove paper that is in the paper tray. Instead, remove the paper tray itself, then close the paper tray cover and paper tray door to keep out dust and debris.
  - Store paper flat.

## Cleaning the paper feed roller

To prevent misfeeds and to make sure your pictures look their best, we recommend that you keep the paper feed roller clean. Inspect the roller weekly for debris particles, and clean if necessary.

**IMPORTANT:** *Unplug the power before cleaning the paper feed roller.*

- 1 Unplug the AC power cord from the power outlet.
- 2 Remove the paper tray from the photo printer, and leave the paper tray door open.
- 3 **Lightly** moisten a lint-free cloth with water.

**IMPORTANT:** *Do not use cotton or cotton swabs to clean the paper feed roller.*

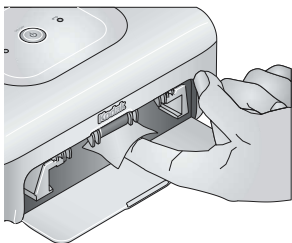

- 4 Use the moistened cloth to gently wipe clean the surface of the paper feed roller. Advance the feed roller with your thumb as necessary, and continue cleaning.
- 5 Allow the paper feed roller to fully dry before reconnecting the power.



## Traveling with your photo printer

**IMPORTANT:** *When traveling, keep the photo printer, accessories, and supplies away from direct sunlight and out of high-temperature environments (such as a vehicle parked in the sun). Consider purchasing the AC power adapter and cord for the region to which you are traveling.*

- 1 Disconnect the power and remove all cables.
- 2 Remove the paper tray from the photo printer; close the paper tray cover and the paper tray door on the photo printer.
- 3 Repack the photo printer in the original packing box, or use a travel bag (sold separately).



Purchase an AC power cord, travel bag, and other accessories at a retailer of Kodak products, or visit [www.kodak.com/go/accessories](http://www.kodak.com/go/accessories).



## 6

# Troubleshooting

When you have questions about your photo printer, start here. Additional technical information is available in the ReadMe file located on the Kodak EasyShare software CD. For updates to Troubleshooting information, visit [www.kodak.com/go/photoprinters](http://www.kodak.com/go/photoprinters).

## Printing problems

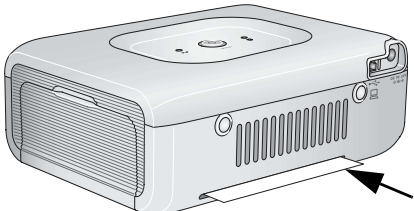
If...	Try the following
Paper does not feed (Paper light may glow steady and On/Off light may blink)	<p><b>IMPORTANT:</b> Use only Kodak color cartridge &amp; paper kits for your photo printer. Do not use inkjet paper.</p> <ul style="list-style-type: none"> <li>■ The paper tray may be empty. Load paper (page 5), re-install the paper tray, then press the On/Off button, .</li> <li>■ Check the paper:               <ol style="list-style-type: none"> <li>1 Remove the paper tray (page 6).</li> <li>2 Inspect the paper supply: make sure paper is not damaged in any way, or removable tabs have not been detached. Reload with new paper if necessary.</li> <li>3 Carefully "fan" the paper to keep the sheets from sticking together.</li> <li>4 Reload the paper tray. <b>Do not exceed the fill line.</b></li> <li>5 Re-install the paper tray, then press  to resume printing.</li> </ol> </li> <li>■ Clean the paper feed roller (page 18).</li> </ul>
Multiple sheets of paper are pulled through printer	<ol style="list-style-type: none"> <li>1 Remove the paper tray (page 6).</li> <li>2 Remove the paper supply from the paper tray. Carefully "fan" the paper to keep the sheets from sticking together.</li> <li>3 Reload the paper tray. <b>Do not exceed the fill line.</b></li> <li>4 Re-install the paper tray then press  to resume printing.</li> </ol>

If...	Try the following
<p>Printer is jammed (Paper light, cartridge light, and/or On/Off light may blink quickly)</p>	<p><b>IMPORTANT:</b> Use only Kodak color cartridge &amp; paper kits for your photo printer. Do not use inkjet paper.</p> <ul style="list-style-type: none"> <li>■ If the Paper light is blinking quickly:               <ol style="list-style-type: none"> <li>1 Remove the paper tray (page 6).</li> <li>2 Turn the power off for 5 seconds, then turn it back on. Carefully remove the jammed paper if it does not automatically eject.</li> </ol> <p><b>IMPORTANT:</b> Check the paper slot on the back of the photo printer for jammed paper:</p> <div style="text-align: center;">  </div> <ol style="list-style-type: none"> <li>3 Remove the paper supply from the paper tray. Carefully "fan" the paper to keep the sheets from sticking together.</li> <li>4 Reload the paper tray. <b>Do not exceed the fill line.</b></li> <li>5 Re-install the paper tray, then press  to resume printing.</li> </ol> <ul style="list-style-type: none"> <li>■ If the Color cartridge light is blinking quickly, check the color cartridge:               <p><b>IMPORTANT:</b> The color cartridge may lock in place if there is a paper error. Do not attempt to remove the cartridge without first clearing the paper error. Make sure the Paper light is off before attempting to remove the cartridge (see Paper light under <a href="#">Photo printer status lights</a>, page 26).</p> <p>Remove the color cartridge, remove any slack from the ribbon, then re-install the cartridge (page 3).</p> </li> </ul> </li> </ul>



If...	Try the following
Printing stops during mid-print (paper stops feeding, and Paper light and On/Off light may blink)	<p><b>IMPORTANT:</b> Use only Kodak color cartridge &amp; paper kits for your photo printer. Do not use inkjet paper.</p> <ul style="list-style-type: none"> <li>■ Check the paper:               <ol style="list-style-type: none"> <li>1 Remove the paper tray (page 6).</li> <li>2 Check the paper slot on the back of the photo printer.</li> <li>3 Remove loose paper from the photo printer. If paper is jammed, see page 21.</li> <li>4 Inspect the paper supply: make sure removable tabs have not been detached from the paper. Reload with new paper if necessary.</li> <li>5 Carefully "fan" the paper to keep the sheets from sticking together.</li> <li>6 Reload the paper tray. <b>Do not exceed the fill line.</b></li> <li>7 Re-install the paper tray, then press  to resume printing.</li> </ol> </li> </ul>
Print is smudged	<ul style="list-style-type: none"> <li>■ Fingerprints may be on glossy side of paper. Handle paper by the edges or by the removable tabs (page 4).</li> </ul>
Print is spotted	<ul style="list-style-type: none"> <li>■ Check to see if the paper is dirty, and use a dry, lint-free cloth to wipe the paper clean. For excessive dirt or debris, thoroughly clean the paper tray, and load new paper (page 5). Check and clean the paper feed roller if necessary (page 18).</li> </ul> <p>NOTE: When storing paper, do not remove paper that is in the paper tray. Instead, remove the paper tray itself, then close the paper tray cover and paper tray door to keep out dust and debris.</p>

If...	Try the following
Print is too light	<p><b>IMPORTANT:</b> Use only Kodak color cartridge &amp; paper kits for your photo printer. Do not use inkjet paper.</p> <ul style="list-style-type: none"> <li>■ Make sure the paper is loaded with the Kodak logo facing down. Reload if necessary (page 5).</li> <li>■ Try re-taking the picture with the flash off. See your camera user's guide for details.</li> <li>■ Adjust the exposure compensation on your camera, and try re-taking the picture. See your camera user's guide for details.</li> <li>■ Edit the picture using Kodak EasyShare software on your computer. See the EasyShare software Help for details.</li> </ul>
Print is too dark or is discolored	<ul style="list-style-type: none"> <li>■ Try re-taking the picture with the flash on, or move within the flash range of the camera. See your camera user's guide for details.</li> <li>■ Adjust the exposure compensation on your camera, and try re-taking the picture. See your camera user's guide for details.</li> <li>■ Edit the picture using Kodak EasyShare software on your computer. See the EasyShare software Help for details.</li> <li>■ Make sure the photo printer is not placed in direct sunlight or is not operating in a high-temperature environment.</li> <li>■ Make sure the cooling vents are not blocked or dirty (page 1).</li> </ul>
Pictures are cropped	<ul style="list-style-type: none"> <li>■ Change the picture quality setting (or resolution) on your digital camera to 3:2. See your camera user's guide for details.</li> <li>■ Adjust cropped pictures using Kodak EasyShare software on your computer.</li> <li>■ If you are printing from an application on your computer, select the proper paper size in print options.</li> </ul>
A selected picture does not print.	<ul style="list-style-type: none"> <li>■ The image file may be corrupt. Review the picture on the camera or computer and delete if necessary.</li> </ul>





If...	Try the following
Nothing happens when you try to print	<ul style="list-style-type: none"> <li>■ Check the power connections (<a href="#">page 2</a>).</li> <li>■ Remove the paper tray, check that paper is properly loaded, and re-install (<a href="#">page 6</a>).</li> <li>■ If the Paper light glows steady, load paper (<a href="#">page 5</a>).</li> <li>■ Make sure the color cartridge is properly installed (<a href="#">page 3</a>). If the Color cartridge light glows steady, install a new cartridge.</li> </ul>
Nothing happens when you try to print (from PictBridge compatible device)	<ul style="list-style-type: none"> <li>■ Check the USB connections from the PictBridge compatible device to the photo printer (<a href="#">page 8</a>).</li> <li>■ Re-establish the connection: disconnect, then reconnect the USB cable from the PictBridge compatible device to the photo printer.</li> <li>■ Make sure there is at least one picture in the PictBridge compatible device's internal memory or memory card.</li> </ul>
Nothing happens when you try to print (from computer)	<ul style="list-style-type: none"> <li>■ Check the USB connections from the photo printer to the computer (<a href="#">page 13</a>).</li> <li>■ Access the printer menu for your system. Remove check marks next to Pause Printing and Offline, if checked.</li> <li>■ Close unnecessary software applications. Disconnect then reconnect the USB cable from the photo printer to the computer (<a href="#">page 13</a>).</li> <li>■ Make sure Kodak EasyShare software is installed (<a href="#">page 10</a>). Install if necessary. If you choose Custom installation, make sure to install the printer driver.</li> <li>■ Uninstall, then reinstall Kodak EasyShare software (<a href="#">page 10</a>).</li> <li>■ Make sure your computer meets the minimum system requirements (<a href="#">page 10</a>). Upgrade your system if necessary.</li> </ul>





If...	Try the following
<p>Printing is slow</p>	<p><b>NOTE:</b> When printing a large number of prints, printing may slow down to prevent the print head from overheating.</p> <ul style="list-style-type: none"> <li>■ Make sure the photo printer is not placed in direct sunlight or is not operating in a high-temperature environment.</li> <li>■ Make sure the cooling vents are not blocked or dirty (page 1).</li> <li>■ Close unnecessary software applications.</li> <li>■ Make sure your computer meets the minimum system requirements (page 10). Upgrade your system if necessary.</li> </ul>
<p>Unable to remove color cartridge (Paper light may glow steady or blink)</p>	<p><b>IMPORTANT:</b> <i>The color cartridge may lock in place if there is a paper error. Do not attempt to remove the cartridge without first clearing the paper error. Make sure the Paper light is off before attempting to remove the cartridge (see Paper light under Photo printer status lights, page 26).</i></p> <ul style="list-style-type: none"> <li>■ Check to see if the paper tray is empty or if paper is missing perforated tabs. Reload paper if necessary (page 5), then try again.</li> <li>■ Make sure paper is not jammed. Clear the jam if necessary (page 21), then try again.</li> <li>■ Turn the power off then on again, and try again.</li> </ul> <p><b>IMPORTANT:</b> <i>Upon reconnecting the power, the color cartridge may advance to the next picture slot on the ribbon, resulting in a supply mismatch (see below).</i></p>
<p>Paper runs out before the color cartridge (or vice versa)</p>	<ul style="list-style-type: none"> <li>■ Supply mismatch can result from several different situations, including: <ul style="list-style-type: none"> <li>—Scraping of paper as a result of jams or other errors</li> <li>—Gradual advancement of the color cartridge ribbon as a result of removing ribbon slack or clearing jams</li> <li>—Advancement of the color cartridge ribbon upon reconnecting power to unlock the color cartridge</li> </ul> </li> </ul> <p>Supply mismatch is likely to occur as you continue to use your photo printer. If you wish to keep your cartridge and paper supply synchronized, discard unused cartridge or paper when one or the other is fully depleted.</p>

## Photo printer status lights

On/Off button/light		
Light status	Cause	Action/solution
	<p><b>IMPORTANT:</b> <i>The color cartridge may lock in place if there is a paper error. Do not attempt to remove the cartridge without first clearing the paper error. Make sure the Paper light is off before attempting to remove the cartridge (see Paper light).</i></p>	
Light is off	The power is off.	None required. Connect the power and press  to turn the power on (page 2).
Light glows steady	The photo printer is on.	None required.
Light blinks	The photo printer is printing.	None required.

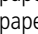

Color cartridge light		
Light status	Cause	Action/solution
	<b>IMPORTANT:</b> <i>The color cartridge may lock in place if there is a paper error. Do not attempt to remove the cartridge without first clearing the paper error. Make sure the Paper light is off before attempting to remove the cartridge (see Paper light).</i>	
Light is off	The color cartridge is properly installed and is working normally.	None required.
Light blinks	Slow blink (for several seconds): the color cartridge is nearly depleted.	None required.
	Fast blink: there is a color cartridge jam	Clear the jam (page 21), then press  .
Light glows steady	The color cartridge is depleted.	Install a new color cartridge (page 3), then press  .
	The color cartridge is not installed or is not fully seated.	Remove and re-install the color cartridge (page 3), then press  .

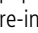
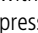
Paper light		
Light status	Cause	Action/solution
	<b>IMPORTANT:</b> <i>The color cartridge may lock in place if there is a paper error. Do not attempt to remove the cartridge without first clearing the paper error. Make sure the Paper light is off before attempting to remove the cartridge.</i>	
Light is off	The paper tray is properly installed and has an ample supply of paper.	None required.
Light blinks	There is a paper jam.	Clear the jam (page 21), then press  .
	Printing stopped during mid-print; the paper may be damaged or is missing removable tabs (page 22).	Remove loose paper. Check the paper supply. Reload with new paper if necessary, then press  .
Light glows steady	The paper tray is empty.	Load paper (page 5), then press  .
	The paper tray is not installed or is improperly installed.	Remove the paper tray, check that paper is properly loaded, and re-install (page 6). Press  to resume printing.
	Paper did not feed; removable tabs may be missing or sheets may be stuck together (page 20).	Check the paper supply. Reload with new paper if necessary, then press  .
	The paper feed roller may be dirty.	Clean the paper feed roller (page 18).

### Still having problems?

Visit [www.kodak.com/go/support](http://www.kodak.com/go/support), or see [Chapter 7, Getting help](#), or contact your camera manufacturer.

## 7

## Getting help

## Helpful links

<b>Photo printer</b>	Get support for your product (FAQs, troubleshooting information, etc.)	<a href="http://www.kodak.com/go/photoprinters">www.kodak.com/go/photoprinters</a>
	Purchase full range of accessories	<a href="http://www.kodak.com/go/accessories">www.kodak.com/go/accessories</a>
	Download latest photo printer software, firmware and drivers	<a href="http://www.kodak.com/go/photoprinterdownloads">www.kodak.com/go/photoprinterdownloads</a>
	See online tutorials	<a href="http://www.kodak.com/go/howto">www.kodak.com/go/howto</a>
<b>Software</b>	Get information on EasyShare software	<a href="http://www.kodak.com/go/easysharesw">www.kodak.com/go/easysharesw</a> (or click the Help button in the EasyShare software)
	Get help with the Windows operating system and working with digital pictures	<a href="http://www.kodak.com/go/pcbasics">www.kodak.com/go/pcbasics</a>
<b>Other</b>	Get support for Kodak docks, cameras, software, accessories, more	<a href="http://www.kodak.com/go/support">www.kodak.com/go/support</a>
	Get information on Kodak EasyShare printer docks and photo printers	<a href="http://www.kodak.com/go/photoprinters">www.kodak.com/go/photoprinters</a>
	Get information on Kodak inkjet products	<a href="http://www.kodak.com/go/inkjet">www.kodak.com/go/inkjet</a>
	Optimize your printer for truer, more vibrant colors	<a href="http://www.kodak.com/go/onetouch">www.kodak.com/go/onetouch</a>
	Register your photo printer	<a href="http://www.kodak.com/go/register">www.kodak.com/go/register</a>

## Telephone customer support

If you have questions concerning the operation of the software or photo printer, you may speak with a customer support representative. Before you call, have the camera or printer connected to your computer. Be at your computer, and have the following information available:

- Computer model, Operating system
- Processor type and speed (MHz)
- Amount of memory (MB) and free hard disk space
- Photo printer and camera serial numbers
- Version of Kodak EasyShare software
- Exact error message you received

Australia	1800 147 701	Greece	00800 441 25605	Spain	91 749 76 53
Austria	0179 567 357	Hong Kong	800 901 514	Sweden	08 587 704 21
Belgium	02 713 14 45	India	91 22 617 5823	Switzerland	01 838 53 51
Brazil	0800 150000	Italy	02 696 33452	Taiwan	0800 096 868
Canada	1 800 465 6325	Japan	03 5540 9002	Thailand	001 800 631 0017
China	800 820 6027	Korea	00798 631 0024	UK	0870 243 0270
Denmark	3 848 71 30	Netherlands	020 346 9372	US	1 800 235 6325
Indonesia	001 803 631 0010	New Zealand	0800 440 786	Outside US	585 726 7260
Ireland	01 407 3054	Norway	23 16 21 33	International Toll Line	+44 131 458 6714
Finland	0800 1 17056	Philippines / Metro Manila	1 800 1 888 9600 / 632 6369600	International Toll Fax	+44 131 458 6962
France	01 55 1740 77	Portugal	021 415 4125		
Germany	069 5007 0035	Singapore	800 6363 036		

Visit: <http://www.kodak.com/US/en/digital/contacts/DAInternationalContacts.shtml>

## 8

# Appendix

## Photo printer specifications

For more specifications, visit [www.kodak.com/go/photoprinters](http://www.kodak.com/go/photoprinters).

Photo printer specifications	
Printing process	Thermal dye transfer
Operating environment (for optimum picture quality)	Temperature: 50 to 95 °F (10 to 35 °C) Humidity: 10% to 86% RH
Power	Output: 24 V DC Input: 100 V to 120V AC @ 50/60 Hz, via AC power adapter (US and Canada only) 100 V to 240V AC @ 50/60 Hz, via AC power adapter (all other countries)
Print speed	Approximately 90 seconds for full 4 x 6 in. (102 x 152 mm) print NOTE: Print speed is dependent on picture size, number of continuous prints, and environmental conditions.
Dimensions	Without paper tray: 5.39 x 7.44 x 2.91 in. (137 x 189 x 74 mm)
	With paper tray: 13.23 x 7.44 x 2.91 in. (336 x 189 x 74 mm)
Weight	Without paper tray: 33.5 oz (950 g)
	With paper tray: 38.4 oz (1090 g)
Print size	4 x 6 in. (102 x 152 mm)
Paper size with perforated tabs	4 x 7.25 in. (102 x 184 mm)
Picture resolution	300 ppi, continuous tone

## Important safety instructions

### Using this product

- Read and follow these instructions before using Kodak products. Always follow basic safety procedures.
- The use of an accessory attachment that is not recommended by Kodak, such as an AC adapter, may cause fire, electric shock, or injury.



#### **CAUTION:**

**Do not disassemble this product; there are no user-serviceable parts inside. Refer servicing to qualified service personnel. Do not expose this product to liquid, moisture, or extreme temperatures. Kodak AC adapters and battery chargers are intended for indoor use only. The use of controls, adjustments, or procedures other than those specified herein may result in exposure to shock and/or electrical or mechanical hazards.**

## Upgrading your software and firmware

Download the latest versions of the software included on the Kodak EasyShare software CD and the photo printer firmware (the software that runs on the photo printer). Visit [www.kodak.com/go/photoprinters](http://www.kodak.com/go/photoprinters).

## Additional care and maintenance

- Do not allow chemicals, such as suntan lotion, to come into contact with the painted surface of the photo printer.
- If the photo printer has been subjected to inclement weather or you suspect water has gotten inside the photo printer, turn off the photo printer and remove the paper tray and color cartridge. Allow all components to air-dry for at least 24 hours before using the photo printer again. If this does not resolve the problem, contact customer support (see [page 30](#)).

- Service agreements may be available in your country. Contact a dealer of Kodak products for more information.
- The photo printer and the AC power adapter contain a small amount of lead in the circuit board. Disposal of this material may be regulated due to environmental considerations.

Disposal of the color cartridge is not regulated and should not be subject to state or local landfill, incineration, or recycling requirements.

For more disposal or recycling information, contact your local authorities. In the US, visit the Electronics Industry Alliance Web site at [www.eiae.org](http://www.eiae.org).

## Warranty

### Limited Warranty

Kodak warrants Kodak digital cameras and accessories (excluding batteries) to be free from malfunctions and defects in both materials and workmanship for one year from the date of purchase.

Retain the original dated sales receipt. Proof of the date of purchase will be required with any request for warranty repair.

### Limited warranty coverage

**This limited warranty will be honored only within the geographical location that Kodak digital cameras and accessories were purchased.**

Kodak will REPAIR or REPLACE Kodak digital cameras and accessories if they fail to function properly during the warranty period, subject to any conditions and/or limitations stated herein. Such repair service will include all labor as well as any necessary adjustments and/or replacement parts. Such repair or replacement is the sole remedy under this warranty.

If replacement parts are used in making repairs, these parts may be remanufactured, or may contain remanufactured materials. If it is necessary to replace the entire product, it may be replaced with a remanufactured product.

## Limitations

Request for Warranty service will not be accepted without proof of date of purchase, such as a copy of the original dated Kodak digital camera or accessory sales receipt. (Always keep the original for your records.)

This warranty does not apply to the battery(s) used in digital cameras or accessories. This warranty does not cover circumstances beyond Kodak's control, nor problems caused by failure to follow the operating instructions in the Kodak digital cameras and accessories User's Guides.

**This warranty does not apply when failure is due to shipping damage, accident, alteration, modification, unauthorized service, misuse, abuse, use with incompatible accessories or attachments, failure to follow Kodak's operation, maintenance or repacking instructions, failure to use items supplied by Kodak (such as adapters and cables), or claims made after the duration of this warranty.**

Kodak makes no other express or implied warranty for this product. In the event that the exclusion of any implied warranty is ineffective under the law, the duration of the implied warranty will be one year from the purchase date.

The option of replacement is Kodak's only obligation. Kodak will not be responsible for any special, consequential or incidental damages resulting from the sale, purchase, or use of this product, regardless of the cause. Liability for any special, consequential or incidental damages (including but not limited to loss of revenue or profit, downtime costs, loss of the use of the equipment, cost of substitute equipment, facilities or services, or claims of your customers for such damages resulting from the purchase, use or failure of the product), regardless of cause or for breach of any written or implied warranty is expressly disclaimed and excluded herefrom.



## Your rights

Some states or jurisdictions do not allow exclusion or limitation of incidental or consequential damages, so the above limitation or exclusion may not apply to you. Some states or jurisdictions do not allow limitations on how long an implied warranty lasts, so the above limitation may not apply to you.

This warranty gives you specific rights, and you may have other rights which vary from state to state or by jurisdiction.

## Outside the United States and Canada

In countries other than the United States and Canada, the terms and conditions of this warranty may be different. Unless specific Kodak warranty is communicated to the purchaser in writing by a Kodak company, no warranty or liability exists beyond any minimum requirements imposed by law, even though defect, damage, or loss may be by negligence or other act.

## Regulatory information

### FCC compliance and advisory



Kodak EasyShare photo printer 300

This equipment has been tested and found to comply with the limits for a Class B digital device, pursuant to Part 15 of the FCC Rules. These limits are designed to provide reasonable protection against harmful interference in a residential installation.

This equipment generates, uses, and can radiate radio frequency energy and, if not installed or used in accordance with the instructions, may cause harmful interference to radio communications. However, there is no guarantee that interference will not occur in a particular installation.

If this equipment does cause harmful interference to radio or television reception, which can be determined by turning the equipment off and on, the user is encouraged to try to correct the interference by one or more of the following measures: 1) reorient or relocate the receiving antenna; 2) increase the separation between the equipment and the receiver; 3) connect the equipment to an outlet on a circuit different from that to which the receiver is connected; 4) consult the dealer or an experienced radio/TV technician for additional suggestions.

Any changes or modifications not expressly approved by the party responsible for compliance could void the user's authority to operate the equipment. Where shielded interface cables have been provided with the product or specified additional components or accessories elsewhere defined to be used with the installation of the product, they must be used in order to ensure compliance with FCC regulation.

## Canadian DOC statement

**DOC Class B compliance**—This Class B digital apparatus complies with Canadian ICES-003.

**Observation des normes-Class B**—Cet appareil numérique de la classe B est conforme à la norme NMB-003 du Canada.

---

# Index

## A

AC power adapter & cord, connecting, 2  
accessories & supplies, ordering, 29

## B

button, on/off, i, 2

## C

cable

AC power adapter & cord, 2  
USB, 8, 13

camera

connecting to photo printer, 8  
printing from, 8  
setting picture quality, 7

Canadian compliance, 36

canceling printing, 9, 16

care & maintenance

general, 17, 32  
handling, storing cartridge, 3  
handling, storing paper, 4  
paper feed roller, 18  
traveling with photo printer, 19

cartridge. *See* color cartridge

color cartridge

door, ii, 3  
handling, storing, 3  
installing, removing, 3  
light, i, 27

color, automatic correction of, 15

computer

connecting photo printer to, 13  
installing software, 10  
printing from, 13  
system requirements, 10  
uninstalling software, 12

connecting

photo printer to computer, 13  
PictBridge compatible camera, 8  
power, 2

connector

power (DC-in), ii, 2  
USB (from device), 8  
USB (to computer), ii, 13

cooling vents, ii

customer support, 30

## D

DC-in, power connector, ii, 2

disposal and recycling, 33

door

cartridge, ii, 3  
paper tray, i, 6

## E

EasyShare software. *See*  
Kodak EasyShare software

## F

FCC compliance, 35  
firmware, upgrading, 29, 32

## H

help  
software, 29  
telephone support, 30  
troubleshooting, 20  
web links, 29

## I

installing  
paper tray, 6  
software, 10

## K

Kodak EasyShare software  
help, 29  
installing, 10  
printing with, 14  
uninstalling, 12  
Kodak web sites, 29

## L

lights  
color cartridge, i, 27  
on/off, i, 26  
paper, i, 28  
status, 26

## M

Macintosh OS  
installing software on, 10  
system requirements, 10  
uninstalling software, 12  
maintenance  
general, 17, 32  
handling, storing cartridge, 3  
handling, storing paper, 4  
paper feed roller, 18

## O

on/off button/light, i, 2

## P

paper  
feed roller, cleaning, 18  
handling, storing, 4, 9  
light, i, 28  
loading, 5  
removing perforated tabs, 9  
slot, ii  
paper tray, i  
door, i  
installing, removing, 6  
PictBridge compatible camera, printing  
from, 8  
pictures  
automatic color correction of, 15  
printing from PictBridge compatible  
camera, 8  
setting quality, 7

power  
AC adapter & cord, 2  
connecting, 2  
connector (DC-in), ii, 2  
on/off button/light, i, 2, 26

printer driver  
installing, 10  
updating, 29, 32

printing  
canceling, 9, 16  
from a computer, 13  
from applications, 14  
from PictBridge compatible  
camera, 8  
problems, 20  
with Kodak EasyShare software, 14

**Q**  
quality setting on camera, 7

**R**  
recycling and disposal, 33  
regulatory information  
Canadian compliance, 36  
FCC compliance, 35  
requirements, system, 10

**S**  
safety, 32  
service and support, 30  
setup  
color cartridge, 3  
loading paper, 5  
location for photo printer, 1  
paper tray, 6  
slot, paper path, ii  
software  
help, 29  
installing, 10  
Kodak EasyShare, printing with, 14  
printing from applications, 14  
system requirements, 10  
uninstalling, 12  
upgrading, 29, 32  
specifications, 31  
status lights, 26  
supplies & accessories, ordering, 29  
support, technical, 30  
system requirements, computer, 10

**T**  
telephone support, 30  
traveling with photo printer, 19  
tray, paper. See paper tray  
troubleshooting  
printing problems, 20  
status lights, 26

**U**

- uninstalling software, 12
- upgrading software & firmware, 29, 32
- URLs, Kodak web sites, 29
- USB
  - cable, 8, 13
  - connector (from device), 8
  - connector (to computer), ii, 13

**V**

- vents, cooling, ii

**W**

- warranty, 33
- Windows OS
  - installing software on, 10
  - system requirements, 10
  - uninstalling software, 12