

TOSHIBA

Portégé M100

Model(s):

Intel® Pentium M 1.20GHz LV/12.1" XGA/256MB/DVD/40GB/Mdm/LAN/Intel 802.11b/Win-XP-Pro

Part Number

PPM10U-0000X7

Product Highlights

(Custom Configuration Options Highlighted Below)

- **Extreme Mobility & Performance:** Weighing a mere 4.4 lbs and featuring the Intel® Centrino™ mobile technology, Toshiba's Portégé M100 is a lightweight mobile champion delivering enhanced performance, integrated wireless connectivity and increased battery life ensuring productivity is never compromised.
- **Long Battery Life for the Road Warrior:** Powered by Intel® Centrino™ mobile technology delivering added performance and enhanced battery life, the Portégé M100 offers up to 8.5 hours of battery life** (with optional 2nd battery) – a full day's work without cables for the mobile customer who needs to maintain productivity while traveling.
- **A Welcome Investment to Any Company:** Toshiba's Portégé M100 shares common docking and Slim SelectBay® accessories with Toshiba's award winning Tecra® line of corporate notebooks, reducing overall IT costs. Additionally, with the included ConfigFree software, users will be able to troubleshoot network issues for hassle-free connectivity.
- **Always Connected:** A complete mobile solution, the Portégé M100 offers a full-range of wireless connectivity including integrated Bluetooth™ (optional upgrade), integrated Wi-Fi (IEEE 802.11b or 802.11ab wireless connectivity, 10/100 Ethernet and v.92 modem.
- **Sleek, Impressive Design:** Draped in an eye-catching magnesium case, the Portégé M100 delivers performance, wireless connectivity and style in a sturdy, lightweight form factor. The integrated Slim SelectBay provides the convenience and flexibility to manage all of your optical drive performances and expansion options.

System Characteristics

CPU (See CPU Performance Disclaimer)**

- Intel® Pentium® M Processor, 1.20GHz (LV - 2.5V)
- Intel 855GM Chipset
- 400 MHz processor side bus clock speed

L2 Cache

- 1 MB Level 2 Cache integrated on die

Memory

- 256-2GB SODIMM memory
- 256MB, 512MB, 1GB, PC2100 DDR

Mass Storage

- **60.0, 40.0,** Enhanced IDE (ATA-5) hard disk drive; 9.5mm height; 60GB: 5400rpm, 12/12ms average access time (read/write), 2/2ms track to track seek time (read/write); 40GB: 5400rpm, 12/12ms average access time (read/write), 2.5/3ms track to track seek time (read/write), user removable
- **Slim SelectBay DVD-ROM,** 5.25" EIDE (ATAPI), 12.7mm height, 8X DVD-ROM, 24X CD-ROM speed, 90ms random access time (DVD-ROM), 10.8MB/sec max data transfer rate (DVD-ROM). Compatibility: CD-ROM, CD-R (read only), CD-RW (read only), DVD-ROM, DVD-R (read only)
- **Slim SelectBay DVD-ROM/CD-RW,** 5.25" EIDE (ATAPI), 12.7mm height, 8X DVD-ROM, 8X CD-R, 8X CD-RW, 24X CD-ROM, 180ms random access time (DVD-ROM), 10.8MB/sec max data transfer rate (DVD-ROM). Compatibility: CD-ROM, CD-R (read/write), CD-RW (read/rewrite), DVD-ROM, DVD-R (read only)
- Slim SelectBay Battery, Lithium Ion (10.8V, 3000mAh)
- Slim SelectBay Hard Disk Drive: 40GB (Adapter required)
- **USB Floppy Drive,** 3.5", 1.44MB

Graphics/Video

- 12.1" TFT Poly-Silicon color LCD; internal display supports up to 16M colors at 1024 x 768 (XGA)
- Intel 855GM Graphics Controller, 16MB pre-allocated, up to 64MB
- 3D Graphics Accelerator, 4x AGP bus support; 2D Graphics Accelerator

- External Color Support:
800 x 600, 640 x 480; 60/75/85/100Hz Non-Interlaced @ 16M
1024 x 768; 65/75/85/100Hz Non-Interlaced @ 16M
1280 x 1024, 1024 60/75/85/100Hz Non-Interlaced @ 16M
1280 x 1024; 60/75/85/100Hz Non-Interlaced @ 16M
1600 x 1200; 60Hz Non-Interlaced @ 16M

Input Devices

- Keyboard: 84 keys with 12 function keys, 2.7mm key stroke, 6mm height; Dedicated Windows® & Application keys support; Hotkey function
- Mouse: Integrated AccuPoint® II pointing device with scroll buttons
- Toshiba Console Button
- Presentation Button

Expandability

- 2 Expansion memory slots (including Main Memory)
- 2 PC Card slots support 2 Type II or 1 Type III PC Cards, PCMCIA R2.01, PC Card16, CardBus
- Secure Digital™ (SD) slot

Communications

- Integrated V.92/56K modem

Due to FCC limitations, speeds of 53kbps are the maximum permissible transmission rates during download. Actual data transmission speeds will vary depending on line conditions.

- Integrated 10Base-T/100Base-TX Ethernet
- Integrated Fast Infrared (4Mbps)
- Optional integrated Wi-Fi compliant wireless LAN – Intel, Cisco (802.11b), Atheros 802.11ab
- Optional integrated Bluetooth (v1.1)

Ports

- i.LINK (IEEE 1394)
- RGB (monitor) port
- 2 Universal Serial Bus (USB) port 2.0
- Infrared port
- 240 pin docking connector
- RJ-45 LAN port
- RJ-11 modem port

Physical Description

- Dimensions (LxWxH): 10.6" x 9.8" x 1.2/1.3"
- Weight: 4.4lbs (with DVD-ROM drive)
- Travel weight: 3.8 (with weight saver)
- LED Indicators: Power, Hard Drive, Slim SelectBay, DC-IN, Primary Battery, Wireless indicator, Caps Lock, Arrow Lock, Numeric Lock, SD Indicator light

Sound

- Integrated software sound AD1981B
- 16-bit stereo; Built-in stereo speakers
- Direct 3D Sound; DirectSound and DirectMusic; Full Duplex and MIDI support
- Sound Volume Control Dial
- Microphone port, headphone port

Power Supply

- AC Adapter: 45W Auto sensing external AC Adapter, 100-240V / 50-60Hz frequency (Universal) input voltage.
Dimensions (LxWxH): 4.25" x 1.8" x 1.1"
- Weight: 0.48lbs
- Battery Pack: 6-cell, (4000mAh) rechargeable, removable Lithium Ion (Li-Ion) battery,
Dimension (LxWxH): 2.8" x 5.0" x 0.8"
- Weight: 0.73lbs
- Battery Life (main battery/main + 2nd battery): 04:26 (Hrs:Min)/ 08:40 (Hrs:Min) ***Measured by MobileMark™
- Recharge time: 2.5 hours
- Battery life may vary depending on applications, power management settings and features utilized. Recharge time varies depending on usage. *Measured by MobileMark™ 2002.

TOSHIBA

Security

- Slot for cable lock; Memory and HDD (by screw only); User Power-on password, HDD Password, Supervisor Password, Keyboard Lock (by HotKey), Screen Blank (by Hotkey), Screen Saver by software

BIOS

- TSETUP, APM, ACPI, PnP, VESA, DPMS, DDC, SM BIOS, PC BIOS support

Operating System

- Microsoft® Windows XP Professional or 2000 Professional

Additional Software

- Adobe Acrobat Reader
- InterVideo WinDVD
- Windows Media Player
- Microsoft Internet Explorer
- Toshiba Custom Utilities
- Electronic User's Guide
- Toshiba ConfigFree™ Software

Warranty

- 3 year parts, labor and 1 year battery

Environmental Specifications

- **Temperature:** Operating: 5° to 35°C (41° to 95°F); Non-operating: -20° to 65°C (-4° to 149°F)
- **Thermal gradient:** Operating: 15°C per hour maximum; Non-operating: 20°C per hour maximum
- **Relative Humidity:** Operating: 20% to 80%; Non-operating: 10% to 90%
- **Altitude (relative to sea level):** Operating: -60 to 3000 meters; Non-operating: -60 to 10,000 meters
- **Shock:** Operating: 7G; Non-operating- 60G
- **Vibration:** Operating: 0.2G; Non-operating: 1.0G

Accessories

Toshiba Accessories

PA3283U-1ACA	75W Universal AC Adapter
PA3241U-1ACA	45W Universal AC Adapter
PA3176U-2BRS	Li-Ion Battery
PA3091U-1CHG	Battery Charger
PA3082U-2PRP	Advanced Port Replicator II w/ 75W AC Adapter
PA3109U-1FDD	Floppy Disk Drive
PA3133U-1H40	40GB Hard Disk Drive (Adapter required)
PA3096U-1BRS	Slim SelectBay Battery
PA3090U-1ETC	Slim SelectBay Hard Disk Drive Adapter
PA3162U-1CD2	Slim SelectBay CD-RW/DVD-ROM
PA3271U-1BTM	Bluetooth SD Card 2

KINGSTON Memory

KTT3614/128	Kingston 128MB PC2100 DDR SDRAM Memory
KTT3614/256	Kingston 256MB PC2100 DDR SDRAM Memory
KTT3614/512	Kingston 512MB PC2100 DDR SDRAM Memory
KTT3614/1G	Kingston 1GB PC2100 DDR SDRAM Memory

Toshiba SD (Secure Digital) Memory

SD-M3203B3	32MB SD Card
SD-M6403B3	64MB SD Card
SD-M1283B3	128MB SD Card
SD-M2564B3	256MB SD Card

Targus Cases-Security

NWCTM1	Metropolitan Carrying Case (koskin)
NWCSS1	Suburban Carrying Case (nylon)
NWDEFCL	PORT-NoteWorthy Defcon Cable Lock

CMS Storage Devices

UABS2-60.0	CMS ABSplus 60GB USB 2.0 Automatic Backup System
UABS2-40.0	CMS ABSplus 40GB USB 2.0 Automatic Backup System
ABSPLUS-60.0	CMS ABSplus 60GB PCMCIA Automatic Backup System
ABSPLUS-40.0	CMS ABSplus 40GB PCMCIA Automatic Backup System

Product/Part Numbers/UPC

Part number: PPM10U-0000X7

UPC: 032017193406

Portégé M100 w/Intel Pentium M 1.20GHz, 12.1" XGA, DVD-ROM, 256MB, 40GB, Modem, LAN, Intel 802.11b, Win-XP-Pro

* GB = 1 Billion Bytes

***MobileMark™ is a trademark of the Business Application Performance Corporation

**** **TFT Display Disclaimer:** Small bright dots may appear on your TFT display when you turn on your PC. Your display contains an extremely large number of thin-filmtransistors (TFT) and is manufactured using high-precision technology. Any small bright dots that may appear on your display are an intrinsic characteristic of the TFT manufacturing technology.

** Central Processing Unit ("CPU") Performance Disclaimer:

CPU performance in your computer product may vary from specifications under the following conditions:

- use of certain external peripheral products
- use of battery power instead of AC power
- use of certain multimedia games or videos with special effects
- use of standard telephone lines or low speed network connections
- use of complex modeling software, such as high end computer aided design applications
- use of computer in areas with low air pressure (high altitude >1,000 meters or >3,280 feet above sea level)
- use of computer at temperatures outside the range of 5°C to 35°C (41°F to 95° F) or >25°C (77°F) at high altitude (all temperature references are approximate).

CPU performance may also vary from specifications due to design configuration.

Under some conditions, your computer product may automatically shut-down. This is a normal protective feature designed to reduce the risk of lost data or damage to the product when used outside recommended conditions. To avoid risk of lost data, always make back-up copies of data by periodically storing it on an external storage medium. For optimum performance, use your computer product only under recommended conditions. Read additional restrictions under "Environmental Conditions" in your product Resource Guide. Contact Toshiba Technical Service and Support for more information.

Return Policy

TAIS does not accept the return of component parts, or bundled software, which have been removed from the PC system. Pro-rata refunds on individual PC components or bundled software, including the operating system, will not be granted. If you wish to return a complete PC system, contact the TAIS dealer where you purchased the product, and comply with the dealer's standard return policies and procedures.

Subject to Change

While Toshiba has made very effort at the time of publication to ensure the accuracy of the information provided herein, product specifications, configurations, prices, system/component/options availability are all subject to change without notice. For the most up-to-date product information about your computer, or to stay current with the various computer software or hardware options, visit Toshiba's Web site at pcsupport.toshiba.com

Front with display open

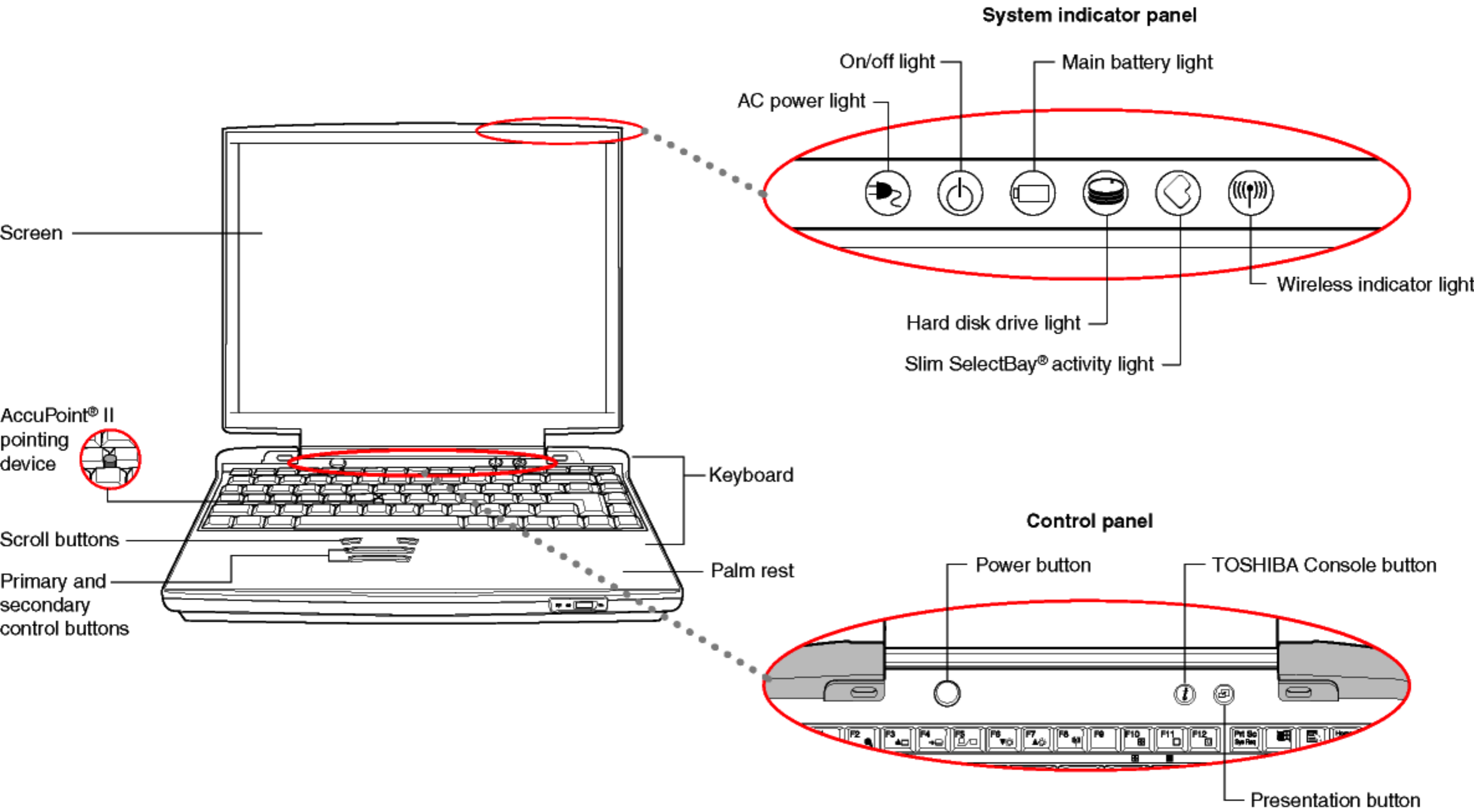

Front with display closed

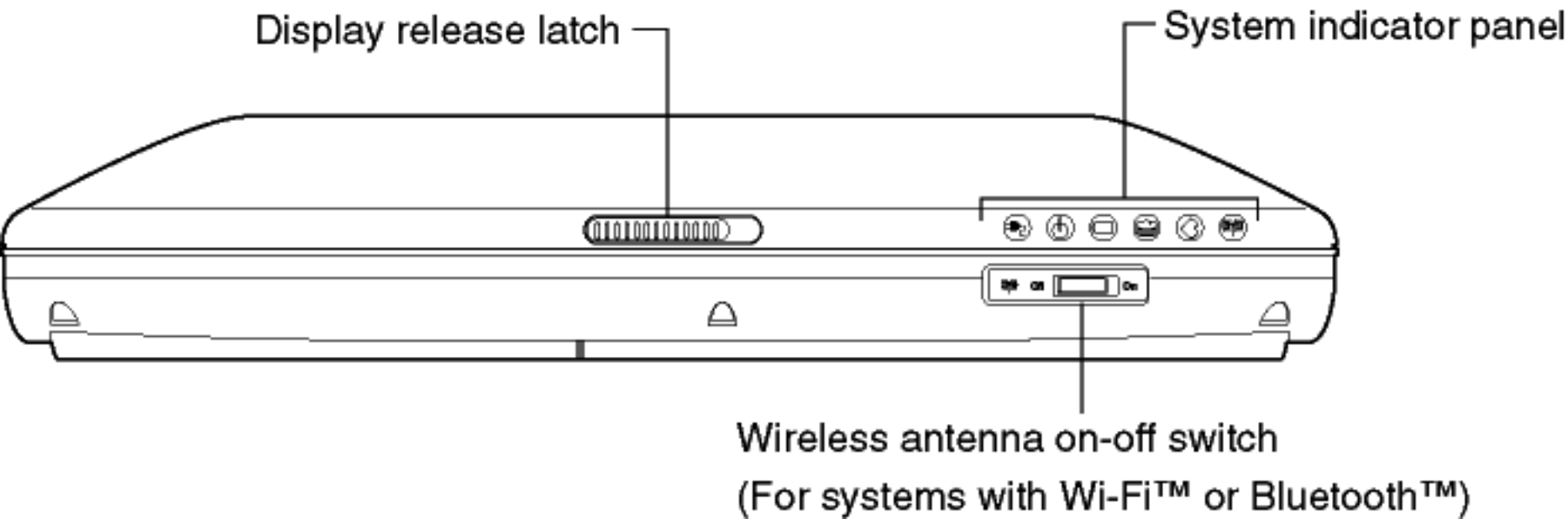

Left side

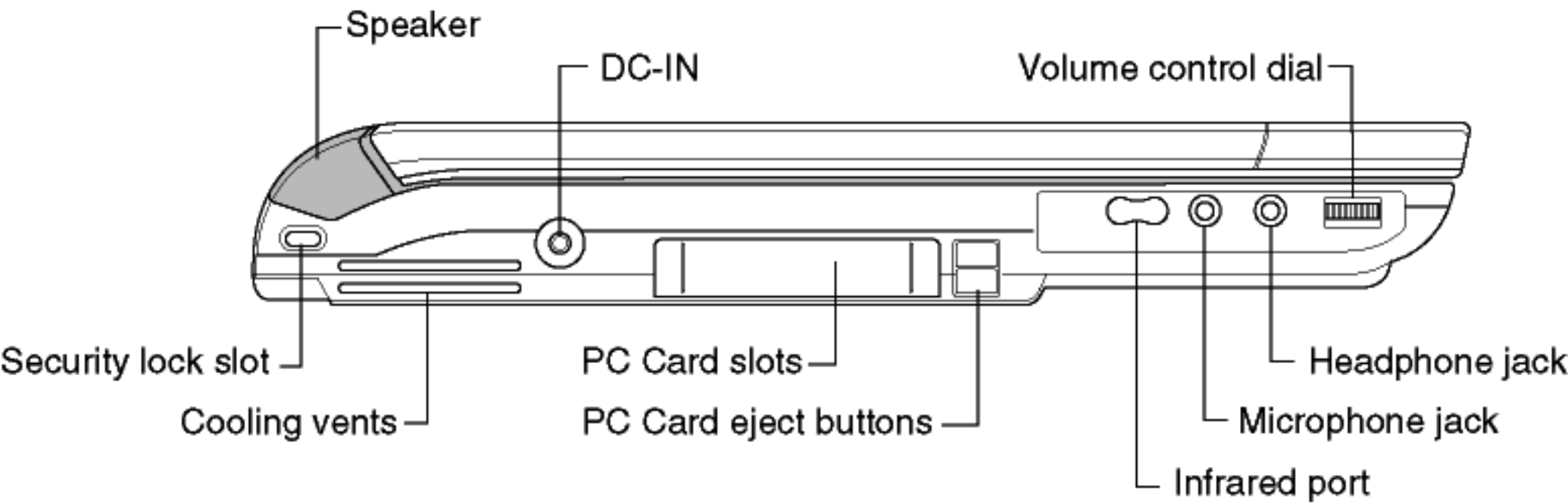

Right side

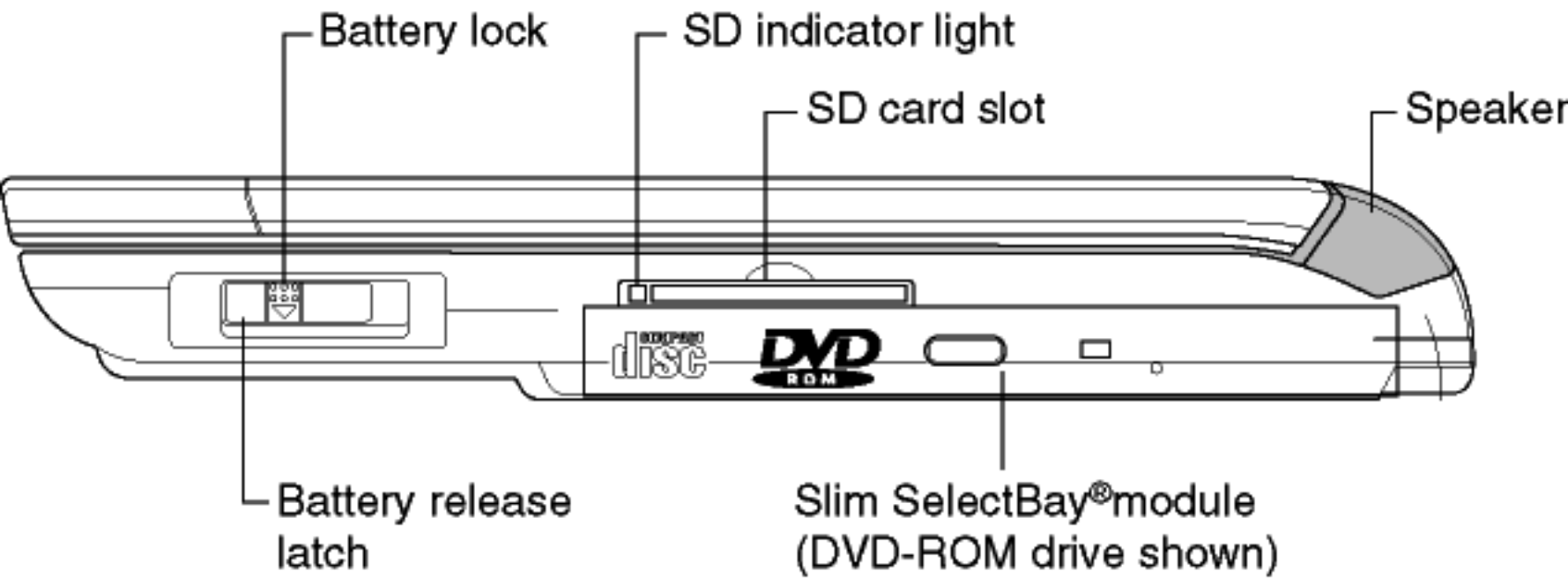

Back

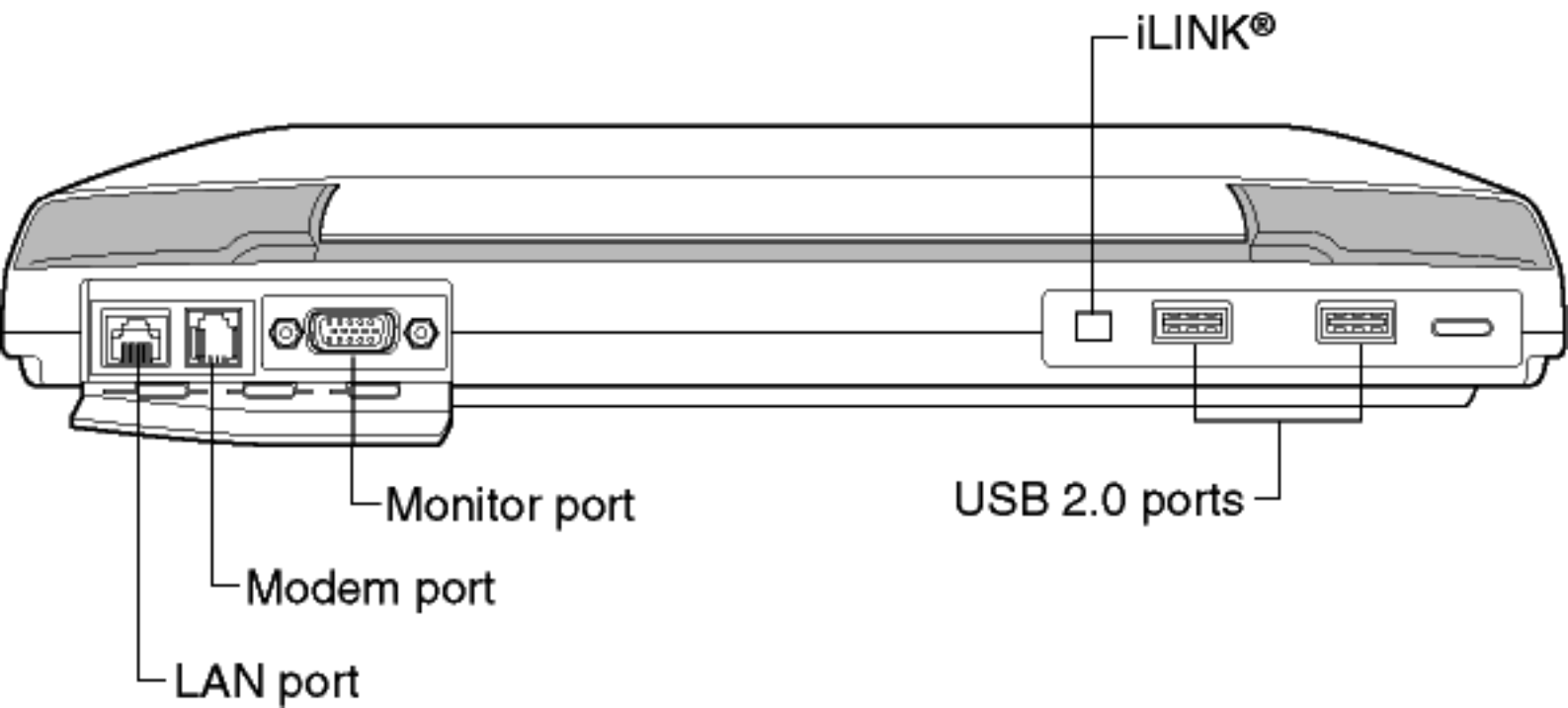

Underside

Expansion port

Slim SelectBay®
release latch

Slim SelectBay®

Battery module

*Wi-Fi™ Mini-PCI
module

*Bluetooth™
module

Hard drive

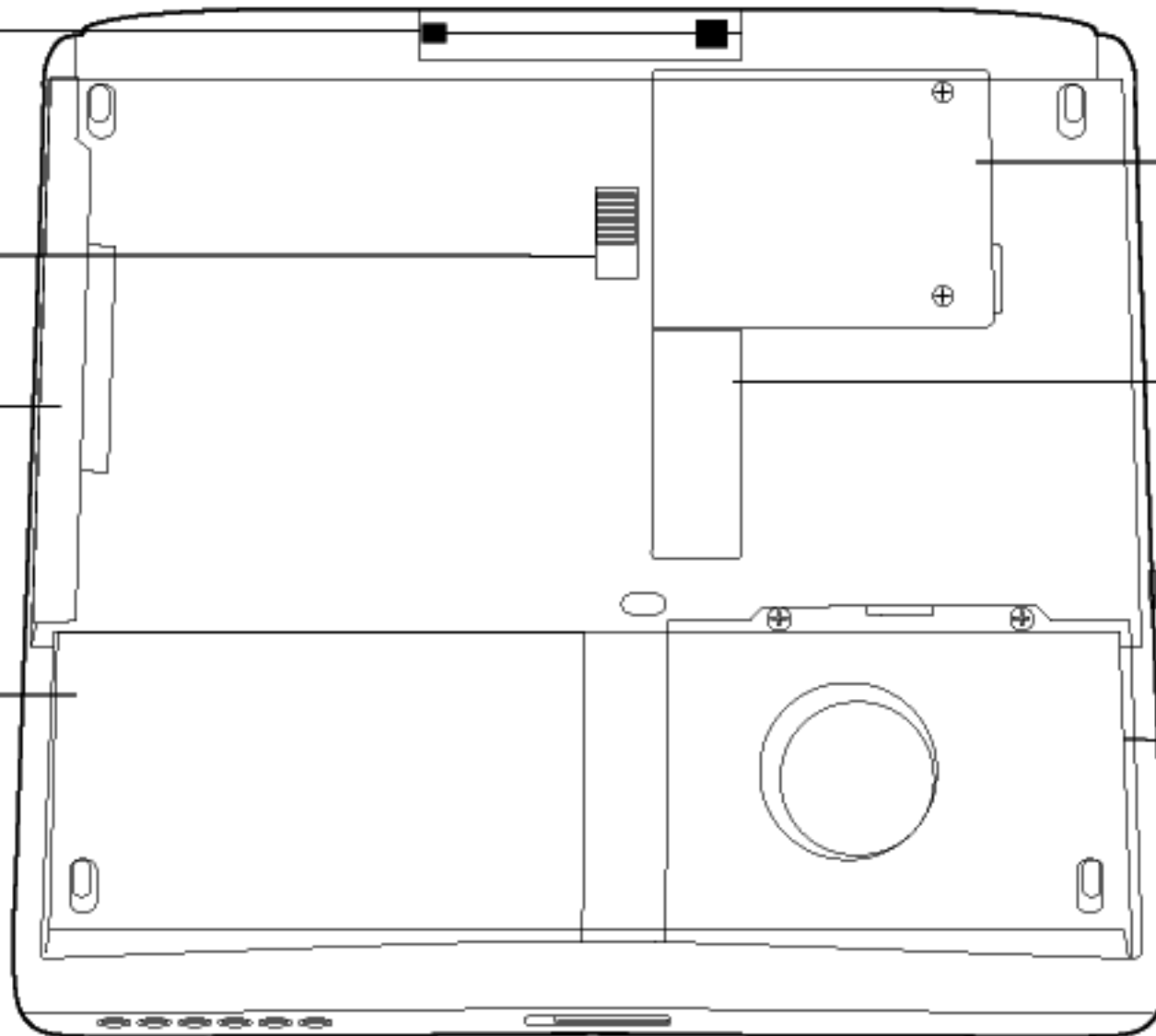

*For systems with Wi-Fi™ or Bluetooth™; to access these modules, contact a Toshiba Authorized Service Provider