

contents

- Overview
- Standard Features
- Options
- Memory
- Storage
- TechSpecs

QuickSpecs

Compaq Deskpro EN Series Small Form Factor

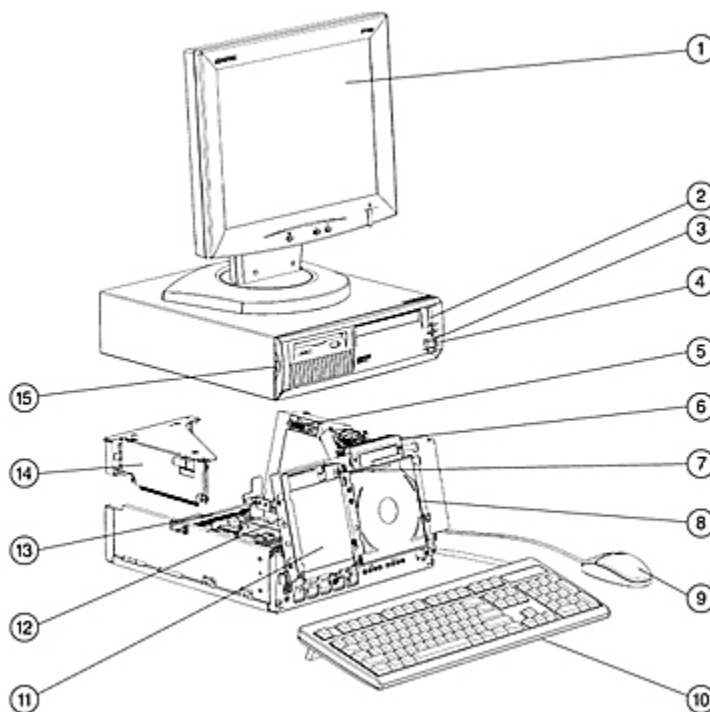

- | | |
|--|---|
| 1. TFT5000 Flat Panel Color Monitor (optional) | 8. 24X Max Slimline CD-ROM Drive (optional) |
| 2. Power Button | 9. Mouse |
| 3. Microphone Jack | 10. Keyboard |
| 4. Headphone Jack | 11. 1.44-MB Diskette Drive |
| 5. Easy Access Power Supply | 12. Tilt Drive Cage |
| 6. SMART III Ultra ATA Hard Drive | 13. Slide-Out System Board |
| 7. Drive Release Latch | 14. Removable Expansion Card Cage |
| | 15. Quick Release Cover Latch |

What's New

- Windows 2000

At A Glance

- 66-, 100- or 133-MHz Front Side Bus models
- Intel Pentium® III processor (133 MHz) 733-, 667-, 600E- or 533E- MHz
- Intel Pentium III processor (100 MHz) 500, 550, 600, 650 or 700 MHz
- Intel Celeron™ processors (66 MHz) 466 or 500 MHz
- Compact form factor enables easy deployment in small office space environments.
- Compaq Premier•Sound™
- Compaq Intelligent Manageability
- Service-friendly design, including Quick Release Cover Latches, Tilt Drive Cage and Slide-Out System Board
- Energy Star compliant with energy-saving features
- Dual Installation Windows 95/98, Windows 95, Windows 98, or Windows

NT 4.0 pre-installed (model dependent)

- Protected by Compaq Services, including a three-year, Limited Warranty - Terms and conditions vary by country. Certain restrictions and exclusions apply.

contents

- Overview
- Standard Features
- Options
- Memory
- Storage
- TechSpecs

Standard Features

Models

Deskpro EN Series Small Form Factor

Available in multiple configurations

Processor

Choice of Intel Pentium III or Celeron processor.

Upgradability

Allows for upgrade of processor, memory, graphics and hard drives

Network Controller

Embedded Intel PRO/100+ Management Adapter

Expansion Slots

PCI	1
PCI/ISA	1

Note: Availability will depend on configuration.

Expansion Bays

Internal	1
External	2

Note: Availability will depend on configuration.

Storage

Diskette Drive	1.44 MB
CD-ROM Drive	24X Max Slimline CD-ROM Drive
Hard Drives	One of the following:
	13.5-GB 7200 rpm SMART III Ultra ATA 66 with Drive Protection System
	10.0-GB 7200 rpm SMART III Ultra ATA 66 with Drive Protection System
	6.4-GB 5400 rpm SMART III Ultra ATA 66
	6.4-GB 5400 rpm SMART III Ultra ATA 33
	4.3-GB 5400 rpm SMART III Ultra ATA 66

Interfaces

Parallel	1
Serial	2
Pointing Device (Mouse)	1
Keyboard	1
Graphics	1
RJ-45	1
USB	2

Graphics – One of the following:

Matrox Millennium G400-SD AGP Graphics Controller with 16-MB SDRAM standard, not upgradable, providing maximum resolution of 2048 x 1536 x 16.7M colors at 65 Hz

Integrated Intel 3D Graphics featuring Intel Dynamic Video Memory (DVM) technology with 8-MB video memory equivalent performance, providing maximum resolution of 1280 x 1024 with 16.7M colors 85 Hz

Embedded ATI RAGE PRO TURBO AGP 2X 64-bit Graphics Controller with 4-

MB SGRAM upgradable to 8 MB, providing maximum resolution of 1280 x 1024 x 16.7M colors at 85 Hz

Audio – One of the following:

AC97 (integrated) with Compaq *Premier•Sound*, input/output jacks, internal speakers

Integrated Compaq *Premier•Sound* using ESS 1869 16-bit Full-Duplex audio, line-in, line-out jacks, internal speaker

Intelligent Manageability

Compaq Intelligent Manageability, a key component of PC Lifecycle Solutions, is the broad set of manageability features found on all Compaq Deskpro desktops, Armada portables, Professional Workstation, and Proliant server products. These best-in-class features on PC clients comply with industry standards, such as DMI and Wired for Management, while pioneering new ground in client manageability. Compaq introduced the industry's first line of manageable clients in 1995 and has been driving the industry ever since. With Compaq's lifecycle management philosophy, enterprises have all of the pieces for end-to-end management and proven tools for hassle-free management of PCs and significantly lower Total Cost of Ownership.

Intelligent Manageability offers solutions in the areas of Initial Configuration and Deployment, Asset Tracking and Security, Software Updating and Management, and Fault Notification and Recovery. For more information, visit our website: www.compaq.com/im.

Form Factor

Small Form Factor provides flexibility of placement.

Operating System – One of the following:

Windows NT 4.0

Windows 2000

Windows 98

Windows 95

Windows 95/98

(End user must make a one-time selection between Windows 95 and Windows 98. If end user desires the rejected product(s) after selection is made, the end user must acquire and pay for rejected product separately.)

Software

Insight Personal Edition

Computer Setup Utility

Microsoft Internet Explorer

Safety and Comfort Guide

Diagnostics for Windows

Intelligent Manageability Agent

Security

Setup Password

Memory Change Alert

Ownership Tag

QuickLock/QuickBlank

Power-On Password

Removable Media Boot Control

Removable Media Write Control

Serial Port Control

Parallel Port Control

USB Port Control

Network Server Mode

Power Supply – One of the following:

90 Watts, surge tolerant

120 Watts

Service and Support

On-site Warranty: This three-year limited warranty delivers three years of on-site, next business-day service for parts and labor and includes free telephone support 7 x 24. Global coverage ensures that any product purchased in one country and transferred to another non-restricted country will remain fully covered under the original warranty.

Note: Terms and conditions vary by country. Certain restrictions and exclusions apply.

Note: On-site service may be provided pursuant to a service contract between Compaq and an authorized Compaq third-party provider, and is not available in certain countries. Global warranty response times are based on commercially reasonable best effort and may vary by country.

Note: Technical telephone support applies only to Compaq-configured Compaq and third-party Compaq-qualified hardware and software. Toll-free calling and 7 x 24 support may not be available in some countries.

Models

P733/820/13.5/128/C/4 164374-xx3

Front Side Bus	133-MHz	Optical Drive	24X Max Slimline CD-ROM Drive
Processor	Intel Pentium III 733-MHz	Hard Drive	13.5-GB Ultra ATA 66
Cache Memory	256-KB integrated L2	Graphics	Matrox Millennium G400-SD AGP
Memory		Audio	AC97 with Compaq Premier•Sound
Standard	128 MB	Software	Windows NT 4.0
Maximum	512 MB		

P733/820/13.5/128/C/9 164374-xx2

Front Side Bus	133-MHz	Optical Drive	24X Max Slimline CD-ROM Drive
Processor	Intel Pentium III 733-MHz	Hard Drive	13.5-GB Ultra ATA 66
Cache Memory	256-KB integrated L2	Graphics	Matrox Millennium G400-SD AGP
Memory		Audio	AC97 with Compaq Premier•Sound
Standard	128 MB	Software	Windows 95/98
Maximum	512 MB		

P700/10+/128/C/4 164197-xx3

Front Side Bus	100-MHz	Optical Drive	24X Max Slimline CD-ROM Drive
Processor	Intel Pentium III 700-MHz	Hard Drive	10.0-GB Ultra ATA 66
Cache Memory	256-KB integrated L2	Graphics	ATI RAGE PRO TURBO AGP
Memory		Audio	Integrated Compaq Premier•Sound
Standard	128 MB	Software	Windows NT 4.0
Maximum	512 MB		

P700/10+/128/C/9 164197-xx2

Front Side Bus	100-MHz	Optical Drive	24X Max Slimline CD-ROM Drive
Processor	Intel Pentium III 700-MHz	Hard Drive	10.0-GB Ultra ATA 66
Cache Memory	256-KB integrated L2	Graphics	ATI RAGE PRO TURBO AGP
Memory		Audio	Integrated Compaq Premier•Sound
Standard	128 MB	Software	Windows 95/98
Maximum	512 MB		

P667/810e/13.5/64/C/4 153902-xx3			
Front Side Bus	133-MHz	Optical Drive	24X Max Slimline CD-ROM Drive
Processor	Intel Pentium III 667-MHz	Hard Drive	13.5-GB Ultra ATA 66
Cache Memory	256-KB integrated L2	Graphics	Integrated Intel 3D Graphics
Memory		Audio	AC97 with Compaq <i>Premier•Sound</i>
Standard	64 MB	Software	Windows NT 4.0
Maximum	512 MB		
P667/820/13.5/128/C/4 122766-xx5			
Front Side Bus	133-MHz	Optical Drive	24X Max Slimline CD-ROM Drive
Processor	Intel Pentium III 667-MHz	Hard Drive	13.5-GB Ultra ATA 66
Cache Memory	256-KB integrated L2	Graphics	Matrox Millennium G400-SD AGP
Memory		Audio	AC97 with Compaq <i>Premier•Sound</i>
Standard	128 MB	Software	Windows NT 4.0
Maximum	512 MB		
P667/820/13.5/128/C/9 122766-xx3			
Front Side Bus	133-MHz	Optical Drive	24X Max Slimline CD-ROM Drive
Processor	Intel Pentium III 667-MHz	Hard Drive	13.5-GB Ultra ATA 66
Cache Memory	256-KB ECC L2	Graphics	Matrox Millennium G400-SD AGP
Memory		Audio	AC97 with Compaq <i>Premier•Sound</i>
Standard	128 MB	Software	Windows 95/98
Maximum	512 MB		
P667/810e/13.5/64/C/9 153902-xx5			
Front Side Bus	133-MHz	Optical Drive	24X Max Slimline CD-ROM Drive
Processor	Intel Pentium III 667-MHz	Hard Drive	13.5-GB Ultra ATA 66
Cache Memory	256-KB ECC L2	Graphics	Integrated Intel 3D Graphics
Memory		Audio	AC97 with Compaq <i>Premier•Sound</i>
Standard	64 MB	Software	Windows 95/98
Maximum	512 MB		
P667/810e/13.5/64/4 153902-xx2			
Front Side Bus	133-MHz	Optical Drive	None
Processor	Intel Pentium III 667-MHz	Hard Drive	13.5-GB Ultra ATA 66
Cache Memory	256-KB ECC L2	Graphics	Integrated Intel 3D Graphics
Memory		Audio	AC97 with Compaq <i>Premier•Sound</i>
Standard	64 MB	Software	Windows NT 4.0
Maximum	512 MB		
P667/810e/13.5/64/9 153902-xx4			
Front Side Bus	133-MHz	Optical Drive	None
Processor	Intel Pentium III 667-MHz	Hard Drive	13.5-GB Ultra ATA 66
Cache Memory	256-KB ECC L2	Graphics	Integrated Intel 3D Graphics
Memory		Audio	AC97 with Compaq <i>Premier•Sound</i>

Standard	64 MB	Software	Windows 95/98
Maximum	512 MB		
P650/10+/128/C/4			159177-xx4
Front Side Bus	100-MHz	Optical Drive	24X Max Slimline CD-ROM Drive
Processor	Intel Pentium III 650-MHz	Hard Drive	10.0-GB Ultra ATA 66
Cache Memory	256-KB ECC L2	Graphics	ATI RAGE PRO TURBO AGP
Memory		Audio	Integrated Compaq Premier•Sound
Standard	128 MB	Software	Windows NT 4.0
Maximum	512 MB		
P650/10+/128/C/9			159177-xx2
Front Side Bus	100-MHz	Optical Drive	24X Max Slimline CD-ROM Drive
Processor	Intel Pentium III 650-MHz	Hard Drive	10.0-GB Ultra ATA 66
Cache Memory	256-KB ECC L2	Graphics	ATI RAGE PRO TURBO AGP
Memory		Audio	Integrated Compaq Premier•Sound
Standard	128 MB	Software	Windows 95/98
Maximum	512 MB		
P650/10+/64/C/4			159176-xx5
Front Side Bus	100-MHz	Optical Drive	24X Max Slimline CD-ROM Drive
Processor	Intel Pentium III 650-MHz	Hard Drive	10.0-GB Ultra ATA 66
Cache Memory	256-KB ECC L2	Graphics	ATI RAGE PRO TURBO AGP
Memory		Audio	Integrated Compaq Premier•Sound
Standard	64 MB	Software	Windows NT 4.0
Maximum	512 MB		
P650/10+/64/C/9			159176-xx3
Front Side Bus	100-MHz	Optical Drive	24X Max Slimline CD-ROM Drive
Processor	Intel Pentium III 650-MHz	Hard Drive	10.0-GB Ultra ATA 66
Cache Memory	256-KB ECC L2	Graphics	ATI RAGE PRO TURBO AGP
Memory		Audio	Integrated Compaq Premier•Sound
Standard	64 MB	Software	Windows 95/98
Maximum	512 MB		
P650/10+/64/4			159176-xx4
Front Side Bus	100-MHz	Optical Drive	None
Processor	Intel Pentium III 650-MHz	Hard Drive	10.0-GB Ultra ATA 66
Cache Memory	256-KB ECC L2	Graphics	ATI RAGE PRO TURBO AGP
Memory		Audio	Integrated Compaq Premier•Sound
Standard	64 MB	Software	Windows NT 4.0
Maximum	512 MB		
P650/10+/64/9			159176-xx2
Front Side Bus	100-MHz	Optical Drive	None
Processor	Intel Pentium III 650-MHz	Hard Drive	10.0-GB Ultra ATA 66
Cache Memory	256-KB ECC L2	Graphics	ATI RAGE PRO TURBO AGP

Memory		Audio	Integrated Compaq <i>Premier•Sound</i>
Standard	64 MB	Software	Windows 95/98
Maximum	512 MB		
P600E/820/13.5/128/C/4			119448-xx5
Front Side Bus	133-MHz	Optical Drive	24X Max Slimline CD-ROM Drive
Processor	Intel Pentium III 600-MHz	Hard Drive	13.5-GB Ultra ATA 66
Cache Memory	256-KB ECC L2	Graphics	Matrox Millennium G400-SD AGP
Memory		Audio	AC97 with Compaq <i>Premier•Sound</i>
Standard	128 MB	Software	Windows NT 4.0
Maximum	512 MB		
P600E/820/13.5/128/C/9			119448-xx3
Front Side Bus	133-MHz	Optical Drive	24X Max Slimline CD-ROM Drive
Processor	Intel Pentium III 600-MHz	Hard Drive	13.5-GB Ultra ATA 66
Cache Memory	256-KB ECC L2	Graphics	Matrox Millennium G400-SD AGP
Memory		Audio	AC97 with Compaq <i>Premier•Sound</i>
Standard	128 MB	Software	Windows 95/98
Maximum	512 MB		
P600E/810e/13.5/64/9			154727-xx3
Front Side Bus	133-MHz	Optical Drive	None
Processor	Intel Pentium III 600-MHz	Hard Drive	13.5-GB Ultra ATA 66
Cache Memory	256-KB ECC L2	Graphics	Integrated Intel 3D Graphics
Memory		Audio	AC97 with Compaq <i>Premier•Sound</i>
Standard	64 MB	Software	Windows 95/98
Maximum	512 MB		
P600E/810e/13.5/64/9			154727-xx5
Front Side Bus	133-MHz	Optical Drive	None
Processor	Intel Pentium III 600-MHz	Hard Drive	13.5-GB Ultra ATA 66
Cache Memory	256-KB ECC L2	Graphics	Integrated Intel 3D Graphics
Memory		Audio	AC97 with Compaq <i>Premier•Sound</i>
Standard	64 MB	Software	Windows 95/98
Maximum	512 MB		
P600E/810e/13.5/64/C/4			154727-xx2
Front Side Bus	133-MHz	Optical Drive	24X Max Slimline CD-ROM Drive
Processor	Intel Pentium III 600-MHz	Hard Drive	13.5-GB Ultra ATA 66
Cache Memory	256-KB ECC L2	Graphics	Integrated Intel 3D Graphics
Memory		Audio	AC97 with Compaq <i>Premier•Sound</i>
Standard	64 MB	Software	Windows 95/98
Maximum	512 MB		
P600E/810e/13.5/64/C/4			154727-xx4
Front Side Bus	133-MHz	Optical Drive	24X Max Slimline CD-ROM Drive
Processor	Intel Pentium III 600-MHz	Hard Drive	13.5-GB Ultra ATA 66

Cache Memory	256-KB ECC L2	Graphics	Integrated Intel 3D Graphics
Memory		Audio	AC97 with Compaq Premier•Sound
Standard	64 MB	Software	Windows NT 4.0
Maximum	512 MB		
P600E/10+/128/C/2			174380-xx2
Front Side Bus	100-MHz	Optical Drive	24X Max Slimline CD-ROM Drive
Processor	Intel Pentium III 600-MHz	Hard Drive	10.0-GB Ultra ATA 66
Cache Memory	256-KB ECC L2	Graphics	ATI RAGE PRO TURBO AGP
Memory		Audio	Integrated Compaq Premier•Sound
Standard	128 MB	Software	Windows 2000
Maximum	512 MB		
P600/10+/128/C/4			154724-xx4
Front Side Bus	100-MHz	Optical Drive	24X Max Slimline CD-ROM Drive
Processor	Intel Pentium III 600-MHz	Hard Drive	10.0-GB Ultra ATA 66
Cache Memory	512-KB ECC L2	Graphics	ATI RAGE PRO TURBO AGP
Memory		Audio	Integrated Compaq Premier•Sound
Standard	128 MB	Software	Windows NT 4.0
Maximum	512 MB		
P600/10+/128/C/8			154724-xx3
Front Side Bus	100-MHz	Optical Drive	24X Max Slimline CD-ROM Drive
Processor	Intel Pentium III 600-MHz	Hard Drive	10.0-GB Ultra ATA 66
Cache Memory	512-KB ECC L2	Graphics	ATI RAGE PRO TURBO AGP
Memory		Audio	Integrated Compaq Premier•Sound
Standard	128 MB	Software	Windows 98
Maximum	512 MB		
P600/10+/128/C/5			154724-xx2
Front Side Bus	100-MHz	Optical Drive	24X Max Slimline CD-ROM Drive
Processor	Intel Pentium III 600-MHz	Hard Drive	10.0-GB Ultra ATA 66
Cache Memory	512-KB ECC L2	Graphics	ATI RAGE PRO TURBO AGP
Memory		Audio	Integrated Compaq Premier•Sound
Standard	128 MB	Software	Windows 95
Maximum	512 MB		
P600/10+/64/C/4			154723-xx5
Front Side Bus	100-MHz	Optical Drive	24X Max Slimline CD-ROM Drive
Processor	Intel Pentium III 600-MHz	Hard Drive	10.0-GB Ultra ATA 66
Cache Memory	512-KB ECC L2	Graphics	ATI RAGE PRO TURBO AGP
Memory		Audio	Integrated Compaq Premier•Sound
Standard	64 MB	Software	Windows NT 4.0
Maximum	512 MB		
P600/10+/64/4			154723-xx3

Front Side Bus	100-MHz	Optical Drive	None
Processor	Intel Pentium III 600-MHz	Hard Drive	10.0-GB Ultra ATA 66
Cache Memory	512-KB ECC L2	Graphics	ATI RAGE PRO TURBO AGP
Memory		Audio	Integrated Compaq Premier•Sound
Standard	64 MB	Software	Windows NT 4.0
Maximum	512 MB		
P600/10+/64/C/5			154723-xx4
Front Side Bus	100-MHz	Optical Drive	24X Max Slimline CD-ROM Drive
Processor	Intel Pentium III 600-MHz	Hard Drive	10.0-GB Ultra ATA 66
Cache Memory	512-KB ECC L2	Graphics	ATI RAGE PRO TURBO AGP
Memory		Audio	Integrated Compaq Premier•Sound
Standard	64 MB	Software	Windows 95
Maximum	512 MB		
P600/10+/64/5			154723-xx2
Front Side Bus	100-MHz	Optical Drive	None
Processor	Intel Pentium III 600-MHz	Hard Drive	10.0-GB Ultra ATA 66
Cache Memory	512-KB ECC L2	Graphics	ATI RAGE PRO TURBO AGP
Memory		Audio	Integrated Compaq Premier•Sound
Standard	64 MB	Software	Windows 95
Maximum	512 MB		
P550/10+/128/C/4			133756-xx9
Front Side Bus	100-MHz	Optical Drive	24X Max Slimline CD-ROM Drive
Processor	Intel Pentium III 550-MHz	Hard Drive	10.0-GB Ultra ATA 66
Cache Memory	512-KB ECC L2	Graphics	ATI RAGE PRO TURBO AGP
Memory		Audio	Integrated Compaq Premier•Sound
Standard	128 MB	Software	Windows NT 4.0
Maximum	512 MB		
P550/10+/128/4			133756-xx8
Front Side Bus	100-MHz	Optical Drive	None
Processor	Intel Pentium III 550-MHz	Hard Drive	10.0-GB Ultra ATA 66
Cache Memory	512-KB ECC L2	Graphics	ATI RAGE PRO TURBO AGP
Memory		Audio	Integrated Compaq Premier•Sound
Standard	128 MB	Software	Windows NT 4.0
Maximum	512 MB		
P550/10+/128/C/8			144493-294
Front Side Bus	100-MHz	Optical Drive	24X Max Slimline CD-ROM Drive
Processor	Intel Pentium III 550-MHz	Hard Drive	10.0-GB Ultra ATA 66
Cache Memory	512-KB ECC L2	Graphics	ATI RAGE PRO TURBO AGP
Memory		Audio	Integrated Compaq Premier•Sound
Standard	128 MB	Software	Windows 98
Maximum	512 MB		

P550/10+/128/C/5 133756-xx7			
Front Side Bus	100-MHz	Optical Drive	24X Max Slimline CD-ROM Drive
Processor	Intel Pentium III 550-MHz	Hard Drive	10.0-GB Ultra ATA 66
Cache Memory	512-KB ECC L2	Graphics	ATI RAGE PRO TURBO AGP
Memory		Audio	Integrated Compaq Premier•Sound
Standard	128 MB	Software	Windows 95
Maximum	512 MB		
P550/10+/128/5 133756-xx6			
Front Side Bus	100-MHz	Optical Drive	None
Processor	Intel Pentium III 550-MHz	Hard Drive	10.0-GB Ultra ATA 66
Cache Memory	512-KB ECC L2	Graphics	ATI RAGE PRO TURBO AGP
Memory		Audio	Integrated Compaq Premier•Sound
Standard	128 MB	Software	Windows 95
Maximum	512 MB		
P550/10+/64/C/8 144493-293			
Front Side Bus	100-MHz	Optical Drive	24X Max Slimline CD-ROM Drive
Processor	Intel Pentium III 550-MHz	Hard Drive	10.0-GB Ultra ATA 66
Cache Memory	512-KB ECC L2	Graphics	ATI RAGE PRO TURBO AGP
Memory		Audio	Integrated Compaq Premier•Sound
Standard	64 MB	Software	Windows 98
Maximum	512 MB		
P550/6.4/64/C/4 133756-xx5			
Front Side Bus	100-MHz	Optical Drive	24X Max Slimline CD-ROM Drive
Processor	Intel Pentium III 550-MHz	Hard Drive	6.4-GB Ultra ATA 33
Cache Memory	512-KB ECC L2	Graphics	ATI RAGE PRO TURBO AGP
Memory		Audio	Integrated Compaq Premier•Sound
Standard	64 MB	Software	Windows NT 4.0
Maximum	512 MB		
P550/6.4/64/4 133756-xx4			
Front Side Bus	100-MHz	Optical Drive	None
Processor	Intel Pentium III 550-MHz	Hard Drive	6.4-GB Ultra ATA 33
Cache Memory	512-KB ECC L2	Graphics	ATI RAGE PRO TURBO AGP
Memory		Audio	Integrated Compaq Premier•Sound
Standard	64 MB	Software	Windows NT 4.0
Maximum	512 MB		
P550/6.4/64/C/8 144493-292			
Front Side Bus	100-MHz	Optical Drive	24X Max Slimline CD-ROM Drive
Processor	Intel Pentium III 550-MHz	Hard Drive	6.4-GB Ultra ATA 33
Cache Memory	512-KB ECC L2	Graphics	ATI RAGE PRO TURBO AGP
Memory		Audio	Integrated Compaq Premier•Sound

Standard	64 MB	Software	Windows 98
Maximum	512 MB		
P550/6.4/64/C/5			133756-xx3
Front Side Bus	100-MHz	Optical Drive	24X Max Slimline CD-ROM Drive
Processor	Intel Pentium III 550-MHz	Hard Drive	6.4-GB Ultra ATA 33
Cache Memory	512-KB ECC L2	Graphics	ATI RAGE PRO TURBO AGP
Memory		Audio	Integrated Compaq <i>Premier•Sound</i>
Standard	64 MB	Software	Windows 95
Maximum	512 MB		
P550/6.4/64/5			133756-xx2
Front Side Bus	100-MHz	Optical Drive	None
Processor	Intel Pentium III 550-MHz	Hard Drive	6.4-GB Ultra ATA 33
Cache Memory	512-KB ECC L2	Graphics	ATI RAGE PRO TURBO AGP
Memory		Audio	Integrated Compaq <i>Premier•Sound</i>
Standard	64 MB	Software	Windows 95
Maximum	512 MB		
C500/810/6.4/64/C/4			144479-xx4
Front Side Bus	66-MHz	Optical Drive	24X Max Slimline CD-ROM Drive
Processor	Intel Celeron 500-MHz	Hard Drive	6.4-GB Ultra ATA 66
Cache Memory	128-KB ECC L2	Graphics	Integrated Intel 3D Graphics
Memory		Audio	AC97 with Compaq <i>Premier•Sound</i>
Standard	64 MB	Software	Windows NT 4.0
Maximum	512 MB		
C500/810/6.4/64/C/8			144479-xx3
Front Side Bus	66-MHz	Optical Drive	24X Max Slimline CD-ROM Drive
Processor	Intel Celeron 500-MHz	Hard Drive	6.4-GB Ultra ATA 66
Cache Memory	128-KB ECC L2	Graphics	Integrated Intel 3D Graphics
Memory		Audio	AC97 with Compaq <i>Premier•Sound</i>
Standard	64 MB	Software	Windows 98
Maximum	512 MB		
C500/810/6.4/64/C/5			144479-xx2
Front Side Bus	66-MHz	Optical Drive	24X Max Slimline CD-ROM Drive
Processor	Intel Celeron 500-MHz	Hard Drive	6.4-GB Ultra ATA 66
Cache Memory	128-KB ECC L2	Graphics	Integrated Intel 3D Graphics
Memory		Audio	AC97 with Compaq <i>Premier•Sound</i>
Standard	64 MB	Software	Windows 95
Maximum	512 MB		
C500/810/6.4/64/4			144478-xx4
Front Side Bus	66-MHz	Optical Drive	None
Processor	Intel Celeron 500-MHz	Hard Drive	6.4-GB Ultra ATA 66
Cache Memory	128-KB ECC L2	Graphics	Integrated Intel 3D Graphics

Memory		Audio	AC97 with Compaq <i>Premier•Sound</i>
Standard	64 MB	Software	Windows NT 4.0
Maximum	512 MB		
C500/810/6.4/64/8			144478-xx3
Front Side Bus	66-MHz	Optical Drive	None
Processor	Intel Celeron 500-MHz	Hard Drive	6.4-GB Ultra ATA 66
Cache Memory	128-KB ECC L2	Graphics	Integrated Intel 3D Graphics
Memory		Audio	AC97 with Compaq <i>Premier•Sound</i>
Standard	64 MB	Software	Windows 98
Maximum	512 MB		
C500/810/6.4/64/5			144478-xx2
Front Side Bus	66-MHz	Optical Drive	None
Processor	Intel Celeron 500-MHz	Hard Drive	6.4-GB Ultra ATA 66
Cache Memory	128-KB ECC L2	Graphics	Integrated Intel 3D Graphics
Memory		Audio	AC97 with Compaq <i>Premier•Sound</i>
Standard	64 MB	Software	Windows 95
Maximum	512 MB		
C500/810/4.3/64/C/4			144479-xx7
Front Side Bus	66-MHz	Optical Drive	24X Max Slimline CD- ROM Drive
Processor	Intel Celeron 500-MHz	Hard Drive	4.3-GB Ultra ATA 66
Cache Memory	128-KB ECC L2	Graphics	Integrated Intel 3D Graphics
Memory		Audio	AC97 with Compaq <i>Premier•Sound</i>
Standard	64 MB	Software	Windows NT 4.0
Maximum	512 MB		
C500/810/4.3/64/C/8			144479-xx6
Front Side Bus	66-MHz	Optical Drive	24X Max Slimline CD- ROM Drive
Processor	Intel Celeron 500-MHz	Hard Drive	4.3-GB Ultra ATA 66
Cache Memory	128-KB ECC L2	Graphics	Integrated Intel 3D Graphics
Memory		Audio	AC97 with Compaq <i>Premier•Sound</i>
Standard	64 MB	Software	Windows 98
Maximum	512 MB		
C500/810/4.3/64/C/5			144479-xx5
Front Side Bus	66-MHz	Optical Drive	24X Max Slimline CD- ROM Drive
Processor	Intel Celeron 500-MHz	Hard Drive	4.3-GB Ultra ATA 66
Cache Memory	128-KB ECC L2	Graphics	Integrated Intel 3D Graphics
Memory		Audio	AC97 with Compaq <i>Premier•Sound</i>
Standard	64 MB	Software	Windows 95
Maximum	512 MB		
C500/810/4.3/32/5			144478-xx5
Front Side Bus	66-MHz	Optical Drive	None
Processor	Intel Celeron 500-MHz	Hard Drive	4.3-GB Ultra ATA 66

Cache Memory	128-KB ECC L2	Graphics	Integrated Intel 3D Graphics
Memory		Audio	AC97 with Compaq <i>Premier•Sound</i>
Standard	32 MB	Software	Windows 95
Maximum	512 MB		
C466/810/6.4/64/C/4			120241-xx4
Front Side Bus	66-MHz	Optical Drive	24X Max Slimline CD-ROM Drive
Processor	Intel Celeron 466-MHz	Hard Drive	6.4-GB Ultra ATA 66
Cache Memory	128-KB ECC L2	Graphics	Integrated Intel 3D Graphics
Memory		Audio	AC97 with Compaq <i>Premier•Sound</i>
Standard	64 MB	Software	Windows NT 4.0
Maximum	512 MB		
C466/810/6.4/64/C/8			120241-xx3
Front Side Bus	66-MHz	Optical Drive	24X Max Slimline CD-ROM Drive
Processor	Intel Celeron 466-MHz	Hard Drive	6.4-GB Ultra ATA 66
Cache Memory	128-KB ECC L2	Graphics	Integrated Intel 3D Graphics
Memory		Audio	AC97 with Compaq <i>Premier•Sound</i>
Standard	64 MB	Software	Windows 98
Maximum	512 MB		
C466/810/6.4/64/C/5			120241-xx2
Front Side Bus	66-MHz	Optical Drive	24X Max Slimline CD-ROM Drive
Processor	Intel Celeron 466-MHz	Hard Drive	6.4-GB Ultra ATA 66
Cache Memory	128-KB ECC L2	Graphics	Integrated Intel 3D Graphics
Memory		Audio	AC97 with Compaq <i>Premier•Sound</i>
Standard	64 MB	Software	Windows 95
Maximum	512 MB		
C466/810/6.4/64/4			131015-xx4
Front Side Bus	66-MHz	Optical Drive	None
Processor	Intel Celeron 466-MHz	Hard Drive	6.4-GB Ultra ATA 66
Cache Memory	128-KB ECC L2	Graphics	Integrated Intel 3D Graphics
Memory		Audio	AC97 with Compaq <i>Premier•Sound</i>
Standard	64 MB	Software	Windows NT 4.0
Maximum	512 MB		
C466/810/6.4/64/8			131015-xx3
Front Side Bus	66-MHz	Optical Drive	None
Processor	Intel Celeron 466-MHz	Hard Drive	6.4-GB Ultra ATA 66
Cache Memory	128-KB ECC L2	Graphics	Integrated Intel 3D Graphics
Memory		Audio	AC97 with Compaq <i>Premier•Sound</i>
Standard	64 MB	Software	Windows 98
Maximum	512 MB		
C466/810/6.4/64/5			131015-xx2
Front Side Bus	66-MHz	Optical Drive	None

Processor	Intel Celeron 466-MHz	Hard Drive	6.4-GB Ultra ATA 66
Cache Memory	128-KB ECC L2	Graphics	Integrated Intel 3D Graphics
Memory		Audio	AC97 with Compaq <i>Premier•Sound</i>
Standard	64 MB	Software	Windows 95
Maximum	512 MB		
C466/810/4.3/64/C/4			120241-xx7
Front Side Bus	66-MHz	Optical Drive	24X Max Slimline CD-ROM Drive
Processor	Intel Celeron 466-MHz	Hard Drive	4.3-GB Ultra ATA 66
Cache Memory	128-KB ECC L2	Graphics	Integrated Intel 3D Graphics
Memory		Audio	AC97 with Compaq <i>Premier•Sound</i>
Standard	64 MB	Software	Windows NT 4.0
Maximum	512 MB		
C466/810/4.3/64/C/8			120241-xx6
Front Side Bus	66-MHz	Optical Drive	24X Max Slimline CD-ROM Drive
Processor	Intel Celeron 466-MHz	Hard Drive	4.3-GB Ultra ATA 66
Cache Memory	128-KB ECC L2	Graphics	Integrated Intel 3D Graphics
Memory		Audio	AC97 with Compaq <i>Premier•Sound</i>
Standard	64 MB	Software	Windows 98
Maximum	512 MB		
C466/810/4.3/64/C/5			120241-xx5
Front Side Bus	66-MHz	Optical Drive	24X Max Slimline CD-ROM Drive
Processor	Intel Celeron 466-MHz	Hard Drive	4.3-GB Ultra ATA 66
Cache Memory	128-KB ECC L2	Graphics	Integrated Intel 3D Graphics
Memory		Audio	AC97 with Compaq <i>Premier•Sound</i>
Standard	64 MB	Software	Windows 95
Maximum	512 MB		
C466/810/4.3/32/5			131015-xx5
Front Side Bus	66-MHz	Optical Drive	None
Processor	Intel Celeron 466-MHz	Hard Drive	4.3-GB Ultra ATA 66
Cache Memory	128-KB ECC L2	Graphics	Integrated Intel 3D Graphics
Memory		Audio	AC97 with Compaq <i>Premier•Sound</i>
Standard	32 MB	Software	Windows 95
Maximum	512 MB		

Options

Memory		
RDRAM		
128-MB Memory Kit (1 x 128-MB RDRAM 45ns RIMM)		103989-B21
64-MB Memory Kit (1 x 64-MB RDRAM 45ns RIMM)		103988-B21
Bulk		
128-MB Memory Kit (bulk) (1 x 128-MB RDRAM 45ns RIMM)		117671-B21

contents

- Overview
- Standard Features
- Options
- Memory
- Storage
- TechSpecs

64-MB Memory Kit (bulk) (1 x 64-MB RDRAM 45ns RIMM)	117670-B21
RDRAM ECC	
128-MB Memory Kit (1 x 128-MB RDRAM 45ns ECC RIMM)	103994-B21
64-MB Memory Kit (1 x 64-MB RDRAM 45ns ECC RIMM)	103993-B21
Bulk	
128-MB Memory Kit (bulk) (1 x 128-MB RDRAM 45ns ECC RIMM)	117676-B21
64-MB Memory Kit (bulk) (1 x 64-MB RDRAM 45ns ECC RIMM)	117675-B21
66-MHz SDRAM DIMMs	
SDRAM	
128-MB Memory Kit (1 x 128-MB SDRAM DIMM, 66 MHz)	270812-B21
64-MB Memory Kit (1 x 64-MB SDRAM DIMM, 66 MHz)	242805-B21
32-MB Memory Kit (1 x 32-MB SDRAM DIMM, 66 MHz)	242804-B21
SDRAM ECC	
128-MB Memory Kit (1 x 128-MB SDRAM ECC DIMM, 66 MHz)	270843-B21
64-MB Memory Kit (1 x 64-MB SDRAM ECC DIMM, 66 MHz)	270842-B21
32-MB Memory Kit (1 x 32-MB SDRAM ECC DIMM, 66 MHz)	270841-B21
100-MHz SDRAM DIMMs	
SDRAM	
256-MB Memory Kit (1 x 256-MB SDRAM DIMM, 100 MHz)	102306-B21
128-MB Memory Kit (1 x 128-MB SDRAM DIMM, 100 MHz)	166614-B21
64-MB Memory Kit (1 x 64-MB SDRAM DIMM, 100 MHz)	166613-B21
32-MB Memory Kit (1 x 32-MB SDRAM DIMM, 100 MHz)	166612-B21
Bulk	
128-MB Memory Kit (1 x 128-MB SDRAM DIMM, 100 MHz)	294454-B21
64-MB Memory Kit (1 x 64-MB SDRAM DIMM, 100 MHz)	294218-B21
32-MB Memory Kit (1 x 32-MB SDRAM DIMM, 100 MHz)	294216-B21
SDRAM ECC	
256-MB Memory Kit (1 x 256-MB SDRAM ECC DIMM, 100 MHz)	102307-B21
128-MB Memory Kit (1 x 128-MB SDRAM ECC DIMM, 100 MHz)	166618-B21
64-MB Memory Kit (1 x 64-MB SDRAM ECC DIMM, 100 MHz)	166617-B21
32-MB Memory Kit (1 x 32-MB SDRAM ECC DIMM, 100 MHz)	166616-B21
Bulk	
128-MB Memory Kit (bulk) (1 x 128-MB SDRAM ECC DIMM, 100 MHz)	294455-B21
64-MB Memory Kit (bulk) (1 x 64-MB SDRAM ECC DIMM, 100 MHz)	294219-B21
32-MB Memory Kit (bulk) (1 x 32-MB SDRAM ECC DIMM, 100 MHz)	294217-B21
Note: RDRAM can only support a total of 32 devices. Each memory module contains a different number of devices.	
Note: Bulk memory skus are priced individually but must be ordered in lots of 50. Only orders of 50 are accepted.	
Note: There is no exchange or return program available for replacing standard memory.	
Monitors	
TFT8000 Flat Panel	307906-001
TFT5000 Flat Panel	325700-001
P1610 Color	305708-001
P110 Color	325600-001
P75 Color	307806-001
V1000 Color	351757-001
V900 Color	303500-001

V700 Color	325800-001
V500 Color	325900-001
S900 Color	360562-001
S700 Color	360512-001
S710 (Carbon)	154499-002
S510 (Carbon)	168636-002
Graphics	
4-MB 100-MHz R.92 SGRAM (to support the ATI RAGE PRO TURBO AGP 2X)	294419-B21
Matrox Millennium G200-SD PCI Graphics Controller (with 8-MB SDRAM)	124806-B21
Matrox Millennium G200 DVI/DFP Daughter Card	124807-B21
Removable Storage	
Compaq SuperDisk (LS-120) 2X High-Capacity Floppy Drive Kit	388117-B21
Optical Drives	
PCI Dxr3 DVD Decoder Card	294422-B21
24X Max Slimline CD-ROM	294358-B21
24X Max Slimline CD-ROM (Bulk)	294370-B21
24X Max Slimline CD-ROM (new bezel)	124726-B21
6X Slimline DVD-ROM	144386-B21
Hard Drives	
Ultra ATA 66 Hard Drives with Drive Protection System (DPS)	
27.0-GB 7200 rpm SMART III Ultra ATA 66 Hard Drive with DPS	161610-B21
20-GB 7200 rpm SMART III Ultra ATA 66 Hard Drive with DPS	124724-xx1
13.5-GB 7200 rpm SMART III Ultra ATA 66 Hard Drive with DPS	124723-xx1
10.0-GB 7200 rpm SMART III Ultra ATA 66 Hard Drive with DPS	127452-xx1
6.4-GB 5400 rpm SMART III Ultra ATA 66 Hard Drive with DPS	124721-xx1
SCSI Hard Drives	
9.1-GB 10,000 rpm Wide Ultra3 SCSI Hard Drive	159763-B21
9.1-GB 7200 rpm Wide Ultra 2 SCSI Hard Drive	120204-B21
Note: SCSI hard drives require a SCSI controller.	
Controllers/Cables/Adapters	
Wide UltraSCSI Controller Kit	294311-xx1
Wide Ultra2 SCSI Controller Kit	124720-B21
Multimedia	
Compaq Microphone Kit	103589-B21
Sound Blaster Audio PCI 128 PS Kit	388550-xx1
Compaq <i>Premier</i> Sound PS115 Speakers	133566-xxx
Communications	
Intel PRO/100+ Management Adapter	127453-B21
Compaq USB ISDN Adapter	321750-B31
Compaq Microcom 610 Internal ISDN Adapter	333056-B21
Compaq NC3121 Fast Ethernet NIC PCI 10/100 WOL	323551-B21
Compaq NC4621 Token Ring NIC PCI 4/16 WOL	379956-B21
Compaq 10 T PCI Intel UTP Controller	317356-B21
Compaq 10/100 TX PCI Intel UTP Controller	317600-B21
Compaq 16/4 TR ISA IBM UTP/STP Controller	301207-B21
Compaq 56K USB Fax Modem	322050-001
Compaq Microcom 510 56K External Fax Modem	316906-002
Compaq Microcom 415 56K External Fax Modem w/ Speakerphone	321108-002
Compaq 56K ISA Fax Modem	294900-002
Compaq 56K PCI Fax Modem	321500-001
Compaq Microcom 705 Corporate Communicator	294700-001

Note: Designed only to allow faster downloads from K56flex compliant digital sources. Maximum achievable download transmission rates may not reach 56 Kbs and will vary with line conditions. Modem only works with Windows 9.x and Windows NT.

Input/Output Devices

Compaq I/O Expansion Board	294293-xx1
Easy Access Keyboard	122660-xx6
Compaq Enhanced Smart Card Keyboard	115504-xx6
Compaq Smart Card Keyboard	115506-xx6
Compaq 2-Button Mouse	143315-xx3
Compaq Scroll Mouse	170299-B21
Fingerprint Identification Reader	294307-xx1
Compaq Smart Card Reader	113771-B21
Compaq Enhanced Smart Card Reader	113784-B21

Support Software CD

Annual Subscription	183426-xxx
Current Month (single CD-ROM)	272505-001

Hardware

System Mounting Bracket	288416-B21
-------------------------	------------

Contents

- Overview
- Standard Features
- Options
- Memory
- Storage
- TechSpecs

Memory

BX chipset and 810 chipset (32-MB)

Standard Memory

32-MB DIMM Standard

Standard	Slot	
	1	2
32 MB		Empty

Standard Memory Plus Optional Memory

Support for up to 160 MB of SDRAM DIMM memory is available with the installation of optional SDRAM Memory Kits.

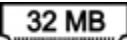
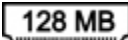
Up to	Slot	
	1	2
160 MB		

Standard Memory Replaced With Optional Memory

Support for up to 512 MB of SDRAM DIMM memory is available with the removal of the standard 32-MB DIMM and the installation of optional SDRAM Memory Kits.

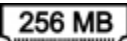
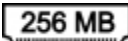
Up to	Slot	
	1	2
512 MB		

BX chipset, 810 chipset and 810e chipset (64-MB)

Standard Memory

64-MB DIMM Standard

Standard	Slot	
	1	2
64 MB		Empty

Standard Memory Plus Optional Memory

Support for up to 320 MB of SDRAM DIMM memory is available with the installation of optional SDRAM Memory Kits.

Up to	Slot	
320 MB	1 64 MB	2 256 MB

Standard Memory Replaced With Optional Memory

Support for up to 512 MB of SDRAM DIMM memory is available with the removal of the standard 64-MB DIMM and the installation of optional SDRAM Memory Kits.

Up to	Slot	
512 MB	1 256 MB	2 256 MB

BX chipset (128-MB)

Standard Memory

128-MB DIMM Standard

Standard	Slot	
128 MB	1 128 MB	2 Empty

Standard Memory Plus Optional Memory

Support for up to 256 MB of SDRAM DIMM memory is available with the installation of optional SDRAM DRIMM Memory Kits.

Up to	Slot	
256 MB	1 128 MB	2 128 MB

Standard Memory Replaced With Optional Memory

Support for up to 512 MB of SDRAM DIMM memory is available with the removal of the standard 128-MB DIMM and the installation of optional SDRAM Memory Kits.

Up to	Slot	
512 MB	1 256 MB	2 256 MB

Note: It is not necessary to add memory in pairs or kits. Memory upgrades are accomplished by adding single or multiple DIMMs of the same or varied sizes. This chart does not represent all possible memory configurations.

820 chipset (128-MB)

Standard Memory

128-MB RIMM Memory Installed

Standard	Slot	
128 MB	1 128 MB 8 devices	2 Continuity 0 devices

Standard Memory Plus Optional Memory

Support for up to 384 MB of RDRAM memory is available with the installation of optional RDRAM Memory Kits.

Up to	Slot	
	1	2
256 MB	128 MB 8 devices	128 MB 16 devices
384 MB	128 MB 8 devices	256 MB 16 devices

Standard Memory Replaced With Optional Memory

Support for up to 512 MB of RDRAM RIMM memory is available with the removal of the standard 128-MB RIMM and the installation of optional RDRAM Memory Kits.

Up to	Slot	
	1	2
512 MB	256 MB 16 devices	256 MB 16 devices

Note: It is not necessary to add memory in like pairs or kits. Memory upgrades are accomplished by adding single or multiple RIMMs of the same or varied sizes. This chart does not represent all possible memory configurations. RDRAM can only support a total of 32 devices. Each memory module contains a different number of devices.

Note: All Deskpro EN Series Small Form Factor models come standard with 100-MHz DIMMs. 350-MHz or faster processors can use only 100-MHz DIMMs.

Note: The number of devices in the memory modules will decrease in the year 2000, allowing maximum memory to increase.

contents

- Overview
- Standard Features
- Options
- Memory
- Storage
- TechSpecs

Storage

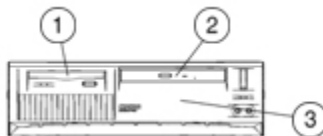

Drive Support

	Quantity Supported	Position Supported	Controller
Removable Media			
1.44-MB Diskette Drive	1	1	Floppy
Compaq SuperDisk (LS-120 Drive) 2X High-Capacity Floppy Drive	1	1	IDE
24X Max Slimline CD-ROM Drive	1	2	IDE
6X Slimline DVD-ROM Drive	1	2	IDE
Hard Drives			
27.0-GB 7200 rpm SMART III Ultra ATA 66 Hard Drive	1	3	IDE
20.0-GB 5400 rpm SMART III Ultra ATA Hard Drive	1	3	IDE
13.5-GB 7200 rpm SMART III Ultra ATA 66 Hard Drive	1	3	IDE
10.0-GB 7200 rpm SMART III Ultra ATA 66 Hard Drive	1	3	IDE
10.0-GB 5400 rpm SMART III Ultra ATA Hard Drive	1	3	IDE
6.4-GB 5400 rpm SMART III Ultra ATA Hard Drive	1	3	IDE

TechSpecs

System Unit

Dimensions (HxWxD)	3.56 x 12.5 x 14.6 in/9 x 31.8 x 37.1 cm
Weight (approximate)	20 lbs/9.1 kg
Weight Supported	100 lbs/45.5 kg
Power Supply	
Operating Voltage Range	90 to 132 VAC/180 to 264 VAC
Rated Voltage Range	100 to 120 VAC/200 to 240 VAC
Rated Line Frequency	47 to 63 Hz
Rated Input Current	2.4A/1.2A
Maximum Rated Power	90W
Temperature	
Ambient Air Temperature	50° to 95° F/10° to 35° C
Storage	50° to 122° F/10° to 50° C
Humidity	
Operating	10% to 90%
Non-operating	10% to 90%
Maximum Altitude	
Operating	10,000 ft/3,048 m
Non-operating	30,000 ft/9,144 m
Enhanced Keyboard	
Dimensions (HxWxD)	1.5 x 18 x 6.5 in/3.81 x 45.72 x 16.51 cm
Weight	3.15 lbs/1.59 kg

contents

- ▣ Overview
- ▣ Standard Features
- ▣ Options
- ▣ Memory
- ▣ Storage
- ▣ TechSpecs

1.44-MB Diskette Drive

Diskette Size	3.5 in
LED Indicators	Green
Read/Write Capacity per Diskette (high/low density)	1.44 MB/720 KB
Drive Height	1 in
Drive Rotation	300 rpm
Transfer Rate (high/low density)	500/250 Kb/s
Bytes/Sector	512
Sectors/Track (high/low density)	18/9
Tracks/Side (high/low density)	80/80
Seek Time	
Track-to-Track (high/low density)	3/6 ms
Average (high/low density)	94/173 ms
Settling Time	15 ms
Latency Average	100 ms
Cylinders (high/low)	80/80
Read/Write Heads	2

SMART III Ultra ATA 66 Hard Drives

13.5 GB

Capacity	13,500 MB	Seek Time (typical reads, including settling)	
Height	1 in/25.4 mm	Single Track	1.7 ms
Width	3.5 in/88.9 mm	Average	8.5 ms
Interface	Ultra ATA 66	Full-Stroke	15 ms
Transfer Rate		Rotational Speed	7200 rpm
Synchronous (Maximum)	66.6 MB/s	Physical Configuration	
		Bytes/Sector	512
		Logical Blocks	19,541,088
		Operating Temperature	41° to 131° F/5° to 55° C

10.0 GB

Capacity	10,000 MB	Seek Time (typical reads, including settling)	
Height	1 in/25.4 mm	Single Track	1.7 ms
Width	3.5 in/88.9 mm	Average	8.5 ms
Interface	Ultra ATA 66	Full-Stroke	15.0 ms
Transfer Rate		Rotational Speed	7200 rpm
Synchronous (Maximum)	66.6 MB/s	Physical Configuration	
		Bytes/Sector	512
		Logical Blocks	19,541,088
		Operating Temperature	41° to 131° F/5° to 55° C

6.4 GB

Capacity	6400 MB	Seek Time (typical reads, including settling)	
Height	1 in/25.4 mm	Single Track	< 1.3 ms
Width	3.5 in/88.9 mm	Average	9 ms
Interface	Ultra ATA 66	Full-Stroke	20 ms
Transfer Rate		Rotational Speed	5400 rpm
Synchronous (Maximum)	66.6 MB/s	Physical Configuration	
		Bytes/Sector	512
		Logical Blocks	12,594,960
		Operating Temperature	41° to 131° F/5° to 55° C

4.3 GB

Capacity	4300 MB	Seek Time (typical reads, including settling)	
Height	1 in/25.4 mm	Single Track	< 1.3 ms

Width	3.5 in/88.9 mm	Average	9 ms
Interface	Ultra ATA 66	Full-Stroke	20 ms
Transfer Rate		Rotational Speed	5400 rpm
Synchronous (Maximum)	66.6 MB/s	Physical Configuration	
		Bytes/Sector	512
		Logical Blocks	8,421,840
		Operating Temperature	41° to 131° F/5° to 55° C

SMART III Ultra ATA 33 Hard Drives

6.4 GB Capacity	6400 MB	Seek Time (typical reads, including settling)	
Height	1 in/25.4 mm	Single Track	1.3 ms
Width	3.5 in/88.9 mm	Average	9.9 ms
Interface	Ultra ATA	Full-Stroke	19.7 ms
Transfer Rate		Rotational Speed	5400 rpm
Synchronous (Maximum)	33.3 MB/s	Physical Configuration	
		Bytes/Sector	512
		Logical Blocks	8,386,000
		Operating Temperature	41° to 113° F/5° to 45° C

24X Max Slimline CD-ROM Drive

Disk	CD-ROM (Mode 1 and 2), CD-DA, CD-XA (Mode 2, Form 1 and 2)
Applicable Disk	CD-I Photo CD (Single and Multi-session), Mixed Mode (Audio and Data combined)
Capacity	550 MB (Mode 1, 12 cm) 640 MB (Mode 2, 12 cm) 180 MB (8 cm)
Block Size	2,048, 1,024 bytes (Mode 1) 2,340, 2,336, 1,024 bytes (Mode 2) 2,352 bytes (CD-DA) 2,326 bytes (CD-XA)
Rotational Speed	5200 rpm
Diameter	4.7 in, 3.15 in/12 cm, 8 cm
Center Hole	0.6 in/15 mm
Thickness	0.05 in/1.2 mm
Track Pitch	1.6 µm
Interface	ATAPI IDE
Access Time (typical)	
Random	< 140 ms
Full-Stroke	< 300 ms
Audio Output Level (Line-Out)	0.7 V @ 47K ohm
Data Transfer Rate	
Sustained	150 KB/s
Variable	1500 to 3600 KB/s
Cache Buffer	128 KB
Start-up Time	< 10 sec
Stop Time	< 4 sec
Laser Parameters	
Type	Semiconductor Laser GaAl As
Wave Length	780 ± 25 nm
Divergence Angle	53.5° ± 1.5°
Output Power	0.14mW
Operating Conditions	
Temperature	41° to 131°F/5° to 55°C
Humidity	10% to 80%
Dimensions (HxWxD, maximum)	5 x 5.22 x 5.47 in/12.7 x 132.6 x 139 mm
Weight	12 oz/< 340 g

Embedded Intel PRO/100+ Management Adapter Controller

Network Interface	10/100 Base TX
Expansion Bus Architecture	PCI 2.2
Network Transfer Rate	
10Base-T (Half-Duplex)	10 Mb/s
10Base-T (Full-Duplex)	20 Mb/s
100Base-TX (Half-Duplex)	100 Mb/s
100Base-TX (Full-Duplex)	200 Mb/s
Connectors	RJ-45
Standards Compliance	
10 Mb/s Ethernet	IEEE 802.3
100 Mb/s Ethernet	IEEE 802.3u
I/O Address	Auto-configured
Remote Wakeup	Yes
Temperature	
Operating	32° to 131°F/0° to 55°C
Humidity (non-condensing)	
Operating	85% at +131°F/55°C
Altitude	
Operating	10,000 ft/3,048 m
Communication Processor	Intel 82559
OS Driver Support	
MS Windows NT 3.51 and 4.0	NDIS 3.0, 4.0 Compliant
MS Windows 95, 98, 2000 Bets	NDIS 3.0, 4.0, 5.0 Compliant
Novell NetWare Server v. 3.x, 4.x and 5.0	ODI Compliant
SunSoft Solaris	Not Supported
SCO UnixWare, OpenDesktop, OpenServer	Supported

Integrated Intel 3D Graphics Controller

	4-MB Display Cache (or 8-MB equivalent performance)	
Resolution (maximum)	Colors Supported	Refresh Rate
1280 x 1024	16.7M	85 Hz
Acceleration	3 ROP BitBLT, Line Draw, Text, Color Expansion, Basic Video Color, Conversion and Scaling and Triangle Setup Engine	
Memory	4-MB Display Cache (or 8-MB equivalent performance), not upgradable	

Embedded ATI RAGE PRO TURBO AGP 2X Graphics Controller

	8-MB SGRAM	
Resolution (maximum)	Colors Supported	Refresh Rate
1280 x 1024	16.7M	85 Hz
Acceleration	3 ROP BitBLT, Line Draw, Text, Color Expansion, Basic Video Color, Conversion and Scaling and Triangle Setup Engine	
Memory	4-MB SGRAM standard, upgradable to 8-MB SGRAM	

Matrox Millennium G400-SD AGP

	16 MB SDRAM	
Resolution (maximum)	Colors Supported	Refresh Rate
2048 x 1536	16.7M	65 Hz
Acceleration	3 ROP BitBLT, Line Draw, Text, Color Expansion, Basic Video Color, Conversion and Scaling and Triangle Setup Engine	
Memory	16 MB SDRAM	