

L Series 36" (914) Built-In Single Oven
MODEL SO36U

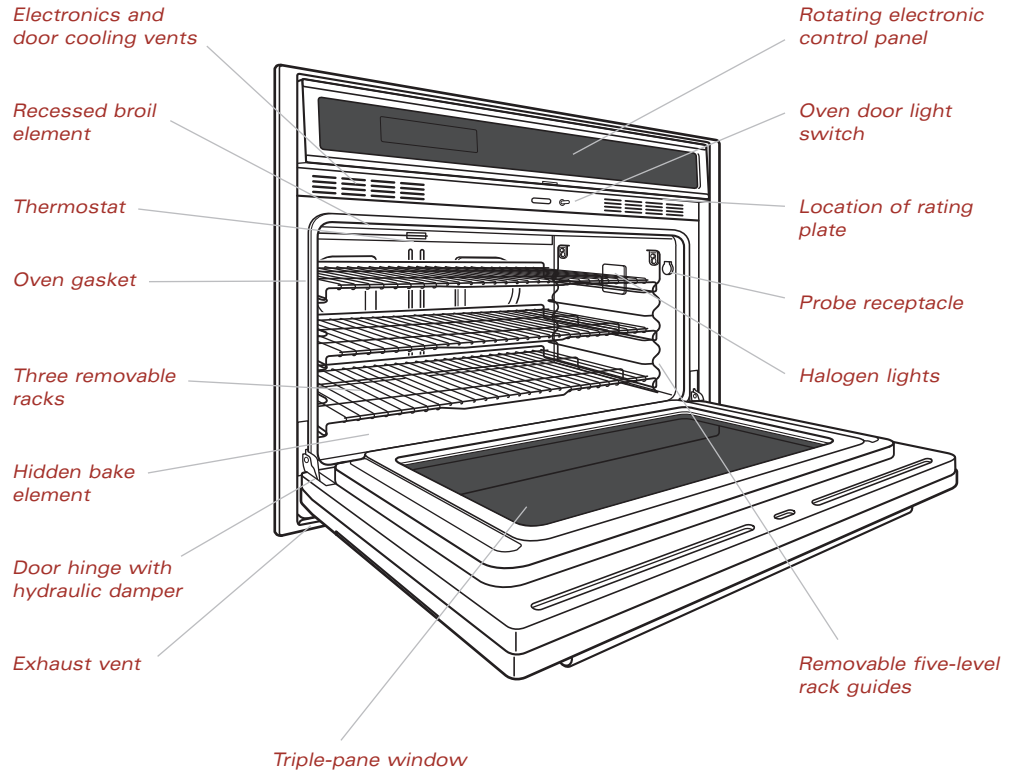

Model SO36U
Unframed



► The Wolf L Series Model SO36U unframed 36" (914) built-in single oven is available in the classic, platinum and carbon stainless steel finishes.



This appliance is certified by Star-K to meet strict religious regulations in conjunction with specific instructions found on www.star-k.org.

It's hard to put into a few words the differences you will see in the Wolf L Series built-in ovens compared to others on the market. Some of those differences are very dramatic and some are very subtle. Suffice to say that you and your clients will notice the differences.

The unframed door style is sleek and contemporary in appearance.

Did you notice that the control panel closes? It's an attractive feature and will enable you to hide that control panel that many of us have labored to make functional and tried to make beautiful.

Inside, the beauty, design and functionality continue. Brilliant halogen lights illuminate the beautiful blue interior. As you open the oven door, feel the smoothness of the door damper system. Pull that bottom oven rack all the way out and notice how it is nestled on the door rails. With the dual convection fans, all L Series models offer ten different cooking modes.

L Series 36" (914) Built-In Single Oven
MODEL SO36U

FEATURES

- ▶ Unframed door style
 - ▶ Classic, platinum and carbon stainless steel finishes
 - ▶ Dual convection logic control system
 - ▶ Ten cooking modes—bake, roast, broil, convection bake, convection roast, convection broil, convection, bake stone (accessory required), dehydrate (accessory required) and proof
 - ▶ Rotating glass touch control panel
 - ▶ Cobalt blue porcelain oven interior
 - ▶ Three removable racks, five-level rack guides and full-extension bottom rack
 - ▶ Large viewing triple-pane window
- ▶ Dual interior halogen lighting
 - ▶ Hidden bake element and recessed broil element
 - ▶ Temperature probe and receptacle
 - ▶ Self-clean, delayed start and Sabbath features
 - ▶ Door hinge with hydraulic damper assures smooth opening and closing of the door
 - ▶ Factory-installed trim
 - ▶ CSA certified for US and Canada
 - ▶ Two and five year residential warranty—exclusions apply; warranty information can be found on our website, wolfappliance.com

OVERALL DIMENSIONS ▼

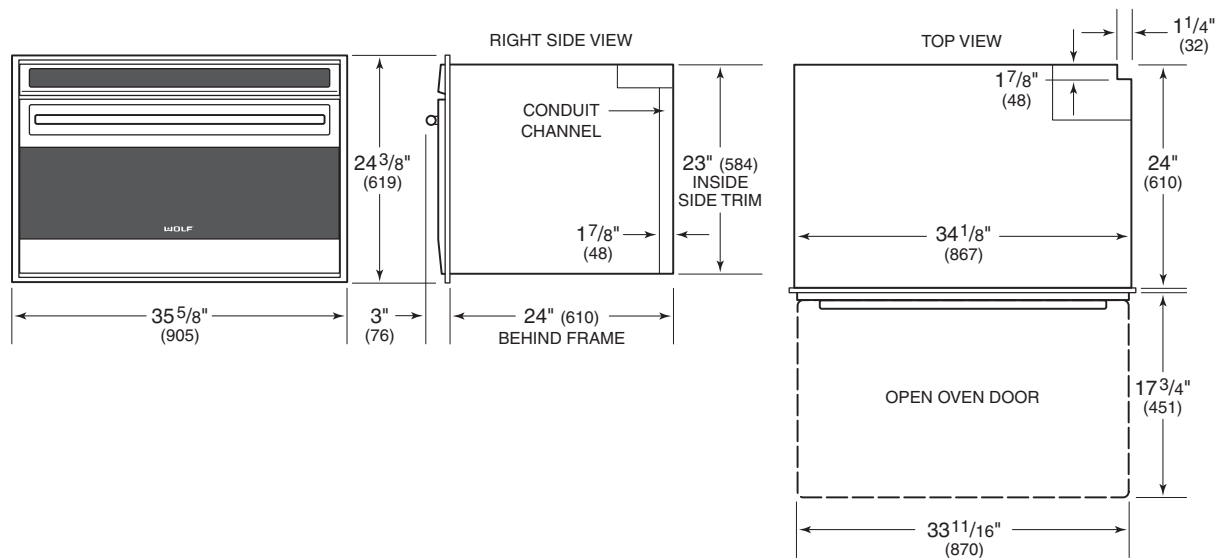

Unit dimensions may vary by ± 1/8" (3).

Dimensions in parentheses are in millimeters unless otherwise specified.

L Series 36" (914) Built-In Single Oven

MODEL SO36U



Model SO36U
Unframed

MODEL OPTIONS ▼

Unframed Door Style -

Classic Stainless Steel	SO36U/S
Platinum Stainless Steel	SO36U/P
Carbon Stainless Steel	SO36U/B

ACCESSORIES

- ▶ Bake stone accessory, includes stone, rack and peel
- ▶ Two-piece broiler pan and temperature probe
- ▶ Set of three oven racks
- ▶ Dehydration racks with door stop

Accessories are available through your Wolf dealer. To obtain local dealer information, visit the Showroom Locator section of our website, wolfappliance.com.

SPECIFICATIONS ▼

Overall Oven Width	35 ⁵ / ₈ " (905)
Overall Oven Height	24 ³ / ₈ " (619)
Overall Oven Depth	24" (610)
Open Oven Door Clearance	17 ³ / ₄ " (451)
Overall Oven Interior Capacity	4.4 cu ft (125 L)
Overall Interior Dimensions	30" W x 13 ¹ / ₄ " H x 19" D (762 x 337 x 483)
Usable Interior Dimensions	26 ¹ / ₂ " W x 13 ¹ / ₄ " H x 16 ³ / ₈ " D (673 x 337 x 416)
Recommended Cabinet Width	39" (991)
Minimum Cabinet Width	36" (914)
Minimum Cabinet Depth	24" (610)
Minimum Base Support	250 lbs (113 kg)
Opening Width	34 ¹ / ₂ " (876)
Opening Height	24 ¹ / ₁₆ " (611)
Trim Overlaps	³ / ₁₆ " (5) top, ¹ / ₈ " (3) bottom ³ / ₄ " (19) each side
Electrical Supply Requirements	240/208 V AC, 60 Hz 30 amp circuit
Conduit	3 ft (.9 m) flexible 4-wire
Electric Rating	5.1 kW at 240 V 3.8 kW at 208 V
Total Amps	21
Shipping Weight	288 lbs (131 kg)

Specifications are subject to change without notice.

Unit dimensions may vary by ± 1/8" (3).

Dimensions in parentheses are in millimeters unless otherwise specified.

L Series 36" (914) Built-In Single Oven
MODEL SO36U

WALL INSTALLATION

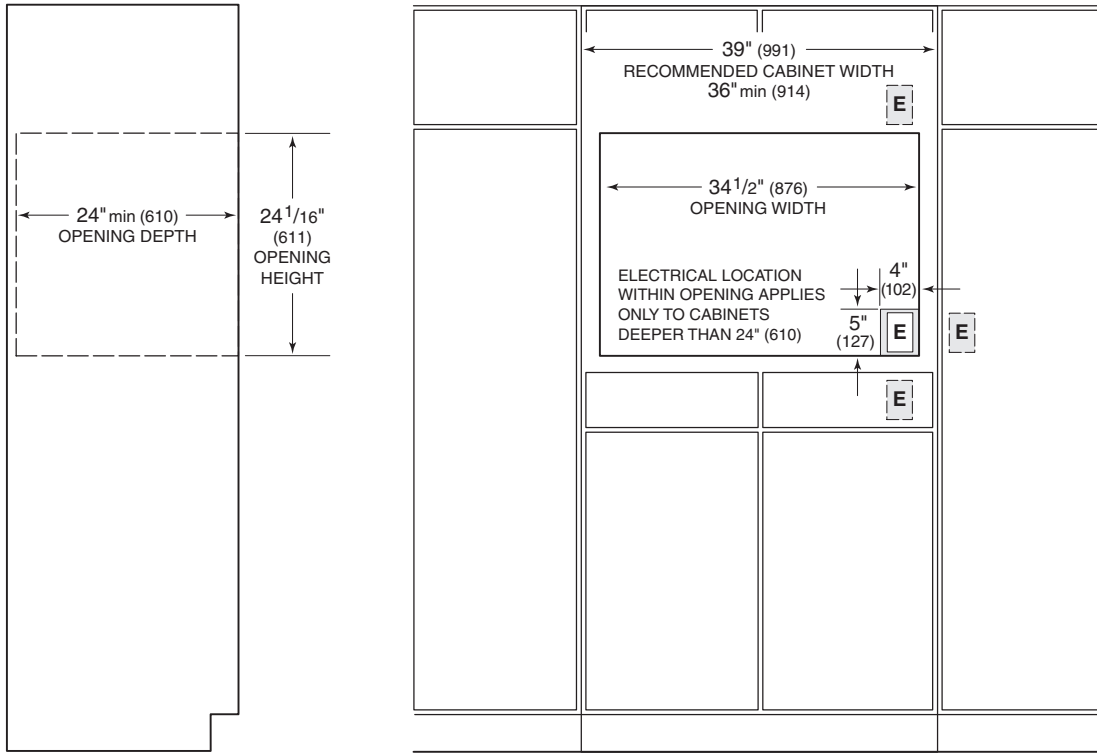

IMPORTANT NOTE: Unless you are using cabinets deeper than 24" (610), it is recommended that the electrical supply be placed in an adjacent cabinet within reach of the conduit. Choose the location shown in the illustrations that best suits your installation.

UNDERCOUNTER INSTALLATION

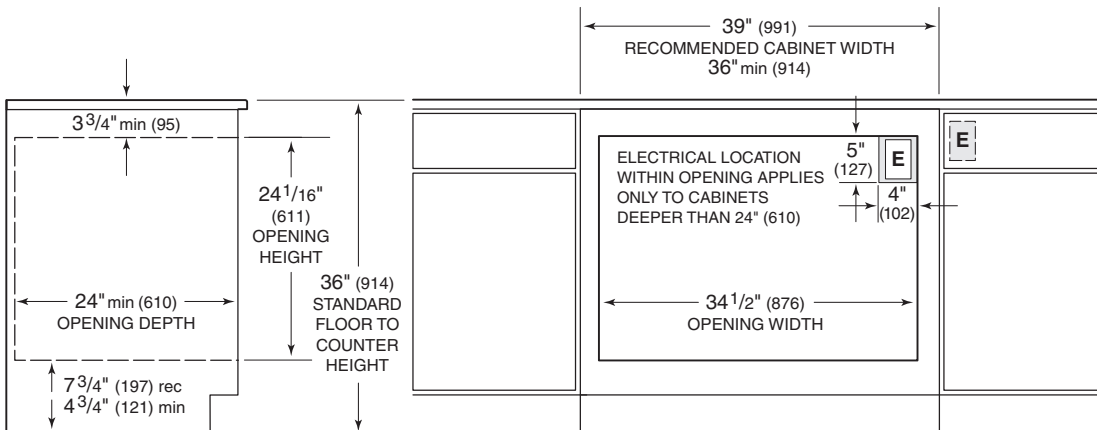

Dimensions in parentheses are in millimeters unless otherwise specified.

L Series 36" (914) Built-In Single Oven MODEL SO36U

INSTALLATION NOTES

- ▶ Refer to the illustrations and specifications for overall dimensions, finished rough opening dimensions and installation specifics.
- ▶ For ease of installation, Wolf recommends using a 39" (991) wide cabinet with the L Series 36" (914) single oven. You will need a minimum 24" (610) of usable cabinet depth. The cabinet base platform must be able to support 250 lbs (113 kg).
- ▶ Wolf L Series built-in ovens have a face trim on all four sides and will overlap stiles and rails. The trim overlaps $\frac{1}{8}$ " (3) on the bottom, $\frac{3}{16}$ " (5) on the top and $\frac{3}{4}$ " (19) on each side.
- ▶ L Series single ovens require a separate, grounded 4-wire 240/208 V AC, 60 Hz, 30 amp service with its own circuit breaker. It is provided with a 3' (.9 m) flexible 4-wire conduit for connection at the electrical supply.

IMPORTANT NOTE: Unless you are using cabinets deeper than 24" (610), it is recommended that the electrical supply be placed in an adjacent cabinet within reach of the conduit. A 2" (51) diameter hole to route the conduit through cabinetry will be required. Refer to the illustrations on page 4 for location of electrical supply.

- ▶ You must follow all National Electrical Code regulations. In addition, be aware of local codes and ordinances when installing your service.
- ▶ A Wolf L Series single oven may be installed below an induction, electric or gas cooktop. Unless you are using cabinets deeper than 24" (610), it is recommended that the electrical supply be placed in the base cabinet to the right of the oven within reach of the conduit.

- ▶ When an L Series 36" (914) single oven is installed below a cooktop, it is recommended that the opening for the oven be $7\frac{3}{4}$ " (197) from the floor to ease the use of the oven door.

IMPORTANT NOTE: Wolf built-in ovens are designed and agency approved for installation with Wolf cooktops only. A built-in oven cannot be installed below a Wolf rangetop. For additional specifications, refer to the induction, electric and gas cooktop sections of our website, wolfappliance.com.

- ▶ An L Series single oven may be installed in combination with a Wolf microwave and warming drawer. Refer to page 6 for specifications.
- ▶ An L Series single oven may be installed next to another L Series single oven. You must allow for a $2\frac{1}{2}$ " (64) space between the oven rough openings. Also, a separate inner wall is required for each oven between openings.
- ▶ An L Series 36" (914) single oven may be installed above another 36" (914) oven. You must allow enough space between the oven openings to accommodate a base support for the top oven. Each base cabinet support must be able to support 250 lbs (113 kg).
- ▶ Refer to the installation instructions shipped with each Wolf product for detailed specifications.

L Series 36" (914) Built-In Single Oven
MODEL SO36U

COMBINATION INSTALLATION

A Wolf L Series 36" (914) built-in single oven may be installed in combination with a Wolf convection microwave with L Series 36" (914) trim and warming drawer with integrated drawer front.

Keep in mind that the width of the custom panel for the warming drawer with integrated drawer front will vary according to the specific installation.

Wolf recommends using 39" (991) cabinets with this installation. Also, you need a minimum 24" (610) of usable cabinet depth for the oven.

The base platform for the oven must be able to support 250 lbs (113 kg), the platform for the microwave must be able to support 125 lbs (57 kg) and the warming drawer platform must be able to support 200 lbs (91 kg).

An anti-tip block or platform must be installed to prevent the warming drawer from tipping forward when the drawer is opened. The warming drawer must be fully enclosed, top and bottom.

For electrical requirements and additional specifications, refer to the microwave oven and warming drawer sections of our website, wolfappliance.com. Also refer to the installation instructions provided with the microwave trim kit and warming drawer front for detailed specifications.

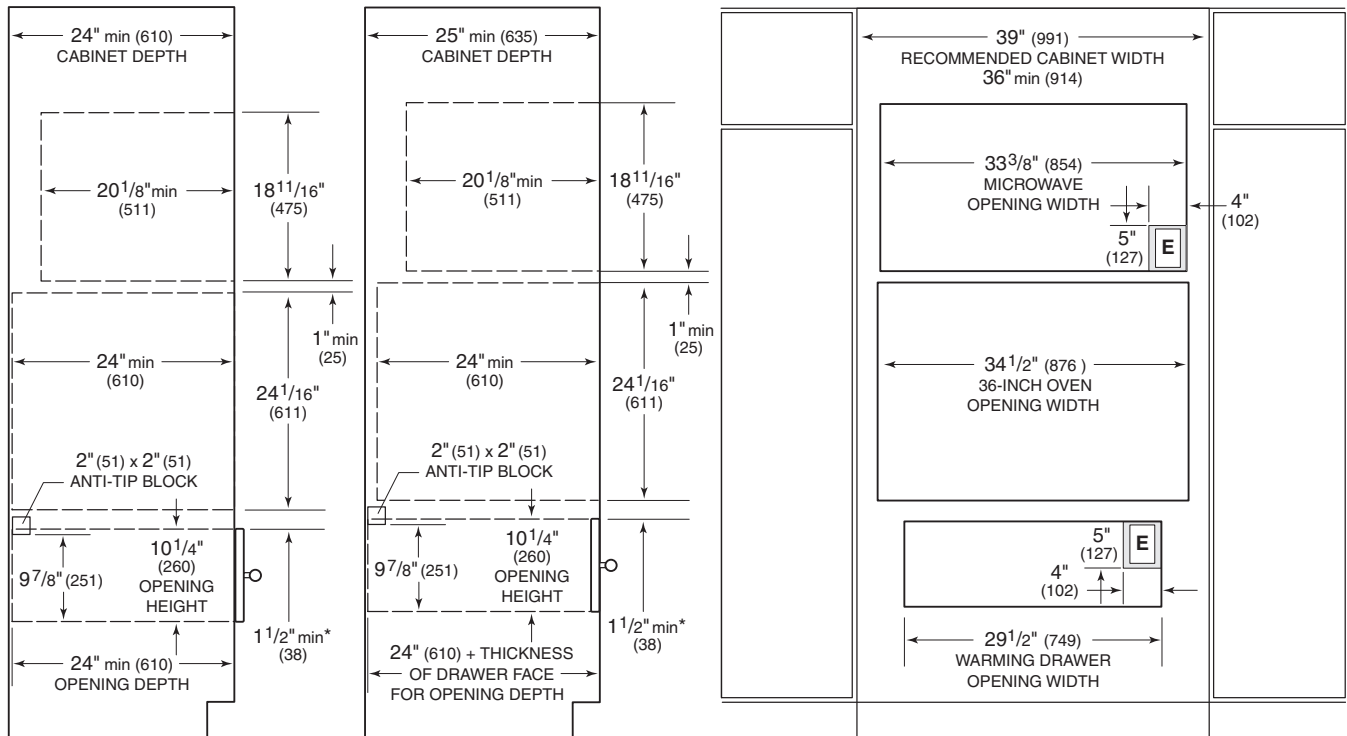

OVERLAY APPLICATION

FLUSH INSET APPLICATION

NOTE: Refer to the 36" (914) built-in single oven specifications for electrical location.

*Dimension may increase depending on the size of the drawer front panel.

The width of the custom panel for the warming drawer with integrated drawer front will vary according to the specific installation, but the rough opening width will remain 29 1/2" (749).

Installation specifications for an L Series 36" (914) single oven installed with convection microwave with L Series 36" (914) trim and warming drawer with integrated drawer front.

Dimensions in parentheses are in millimeters unless otherwise specified.