



If you have any questions or comments
please contact the Toyota Customer
Experience Center at 1-800-331-4331, or
visit our informative, interactive Web site at
<http://www.toyota.com>

Solara
Convertible
2005
Pocket Reference Guide





moving forward ▶

2005 Camry Solara Convertible

This *Pocket Reference Guide* is a summary guide for basic vehicle operations. It contains brief descriptions of fundamental operations so you can locate and use the vehicle's main equipment quickly and easily.

The *Pocket Reference Guide* is not intended as a substitute for the *Owner's Manual* located in the vehicle's glove box. We strongly encourage you to review the *Owner's Manual* and supplementary manuals so you will have a better understanding of the vehicle's capabilities and limitations.

Your dealership and the entire staff of Toyota Motor Sales, U.S.A., Inc., wish you many years of satisfied driving in your new Camry Solara Convertible.

! A word about safe vehicle operations

This *Pocket Reference Guide* is not a full guide to Camry Solara Convertible operations. Every Camry Solara Convertible owner should review the *Owner's Manual* that accompanies this vehicle.

Pay special attention to the boxed information highlighted in yellow throughout the *Owner's Manual*. Each box contains safe operating instructions to help you avoid injury or equipment malfunction.

All information in this *Pocket Reference Guide* is current at the time of printing. Toyota reserves the right to make changes at any time without notice.

Spare tire & tools

Tool location

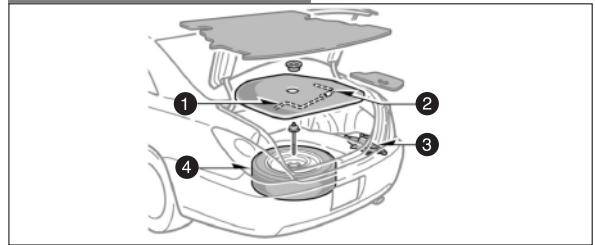

- 1 Jack handle
- 2 Wheel nut wrench
- 3 Jack
- 4 Spare tire

Removing the spare tire

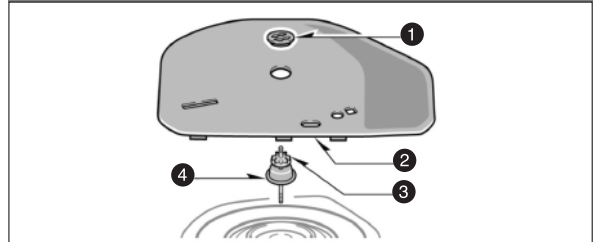

- 1 Loosen and remove the nut.
- 2 Remove the spare tire cover.
- 3 Loosen and remove the bolt.
- 4 Remove the spacer.

Refer to the *Owner's Manual* for jack positioning and tire changing procedures.

Trunk-Internal release handle

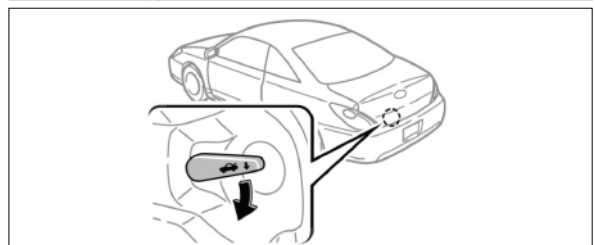

To open the trunk from inside Pull down the phosphorescent handle on the inside of the trunk.

TABLE OF CONTENTS

Item	Page no.
OVERVIEW	
Clock	7
Engine compartment	8
Fuel tank door opener and cap	6
Hood release lever	7
Indicator symbols	4-5
Instrument cluster	4-5
Instrument panel	2-3
Light control-Instrument panel	7
Trunk release lever	6
FEATURES/OPERATIONS	
Air conditioning/Heating	16-17
Audio	18-20
Auto lock functions-Programmable¹	9
Automatic transmission	10
Convertible top operation	14
Cruise control	21
Cup holders	21
Door locks	10
Engine immobilizer	15
Garage door opener (HomeLink [®]) ³	20
Keyless entry	9
Lights² & turn signals	12
Parking brake	14
Power outlets	11
Seat adjustments	11
Seats-Head restraints	11
Tilt and telescopic steering wheel	13
Windows	15
Windshield wiper & washer	13
SAFETY AND EMERGENCY FEATURES	
Airbag-Supplemental Restraint System	23-24
Seat belts	22
Seat belt guides	22
Spare tire & tools	25
Tire Pressure Warning System	22
TRAC (Traction Control)	23
Trunk-Internal release handle	25
VSC (Vehicle Stability Control)	23

¹ Programmable by consumer.

² Visit your Toyota dealer for information on customizing this feature.

³ HomeLink[®] is a registered trademark of Johnson Controls, Inc.

OVERVIEW

Instrument panel

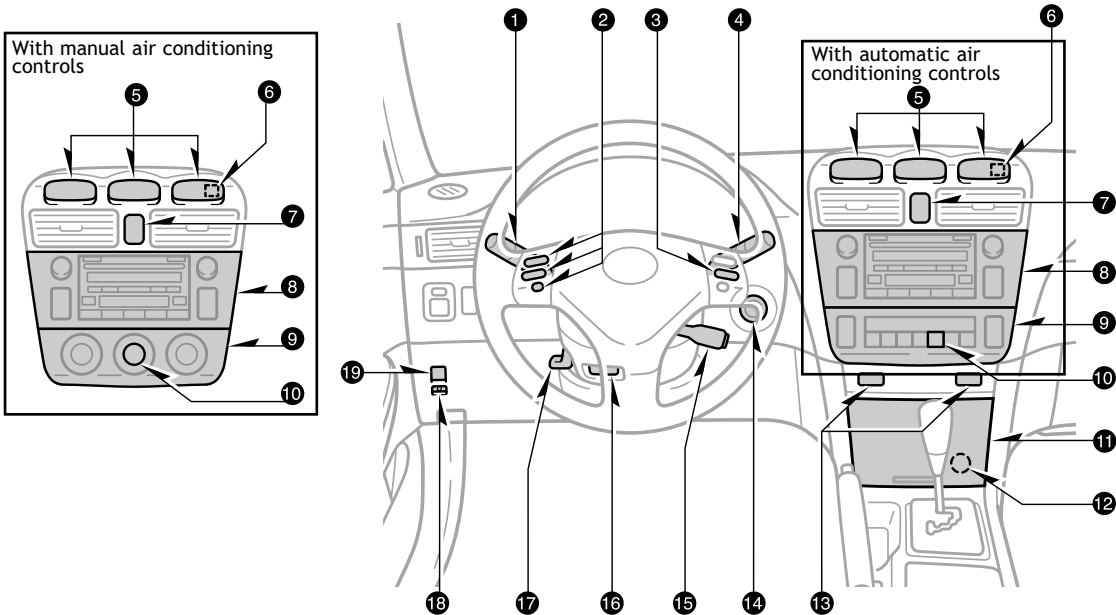

- ❶ Headlight, turn signal and front fog light controls
- ❷ Audio steering wheel switches
- ❸ Multi-information display control switch
- ❹ Wiper and washer controls
- ❺ Multi-information displays
- ❻ Front passenger occupant classification indicator light/front passenger seat belt reminder light
- ❼ Emergency flasher switch
- ❽ Audio or navigation system^{1, 2}
- ❾ Air conditioning controls
- ❿ Rear window and outside rearview mirror defogger¹ switch
- ⓫ Auxiliary box
- ⓬ 12V Power outlet

- Ⓜ Seat heater switches¹
- Ⓨ Ignition switch
- Ⓩ Cruise control lever
- ⓐ Tilt steering lock release lever
- ⓑ Telescopic steering lock release lever
- ⓓ Tire Pressure Warning reset switch
- ⓔ "TRAC OFF" (Traction Control "OFF") switch¹

¹If installed

²For details, refer to the *Navigation System Owner's Manual*.

Instrument cluster

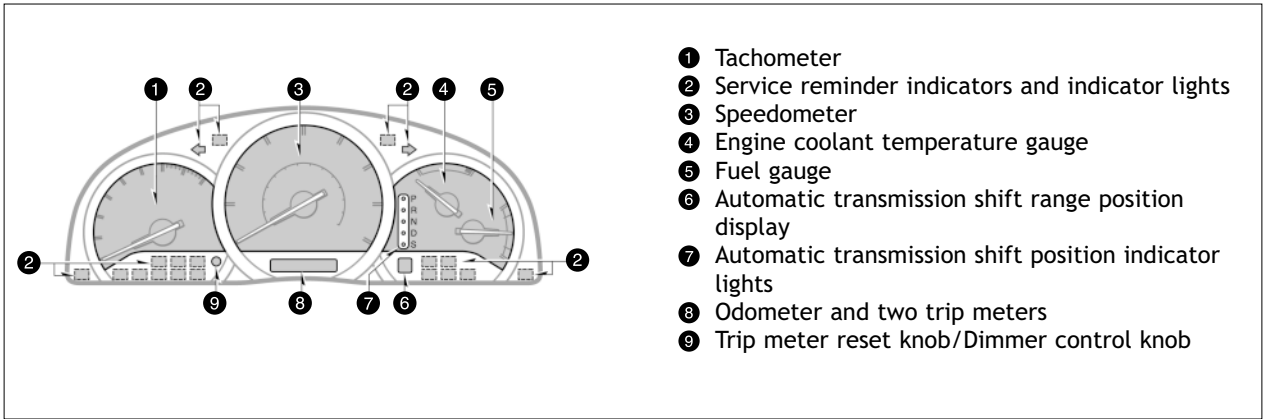

- 1 Tachometer
- 2 Service reminder indicators and indicator lights
- 3 Speedometer
- 4 Engine coolant temperature gauge
- 5 Fuel gauge
- 6 Automatic transmission shift range position display
- 7 Automatic transmission shift position indicator lights
- 8 Odometer and two trip meters
- 9 Trip meter reset knob/Dimmer control knob

Indicator symbols

BRAKE	Brake system warning light ¹
	Driver seat belt reminder light ¹
PASSENGER 	Front passenger seat belt reminder light ¹
	Battery warning light ¹
	Malfunction indicator light ¹
	Low engine oil pressure warning light ¹
	Low fuel level warning light ¹
ABS	Anti-lock Brake System warning light ¹

CAUTION

When the Anti-lock Brake System (ABS) function is in action, you may feel the brake pedal pulsating and hear a noise. In this situation, to let the Anti-lock Brake System work for you, just hold the brake pedal down more firmly. Do not pump the brake as this will result in reduced braking performance.

	Open door warning light ¹
	Airbag SRS warning light ¹
	Low Tire Pressure Warning light ¹
VSC	Vehicle Stability Control/Traction Control warning light ¹
	Low windshield washer fluid level warning light ¹
MAINT	Engine oil replacement reminder light ¹
PASSENGER AIRBAG OFF ON	Front passenger occupant classification indicator light
	Turn signal indicator light
	Headlight high beam indicator light
	Slip indicator light
TRAC OFF	Traction Control off indicator light
CRUISE	Cruise control indicator light ²

¹ For details, refer to “Service reminder indicators and warning buzzers,” Section 1-6, 2005 Owner’s Manual.

² If this light flashes, refer to “Cruise control,” Section 1-7, 2005 Owner’s Manual.

Fuel tank door opener and cap

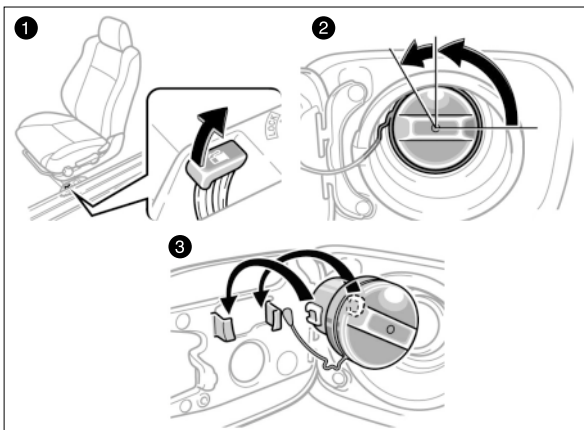

- 1 To open the fuel tank door from driver side seat Pull up on the opener.
- 2 To remove the fuel tank cap Turn the cap counterclockwise 90 degrees, then turn it an additional 30 degrees. Pause slightly before removing it.
- 3 The removed cap can be stored on the fuel tank door.
- 4 To replace the fuel tank cap Turn clockwise until a click is heard. If not tightened enough, Check Engine "  indicator may illuminate.

Trunk release lever

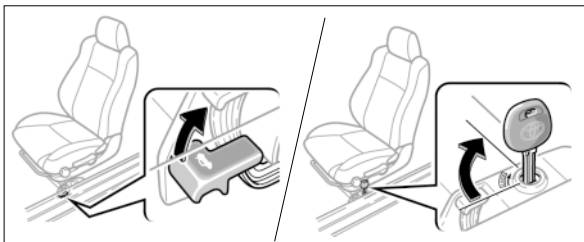

To open from driver's seat Pull up on the trunk release lever. This will NOT lock the trunk, ONLY the lever.

Note: To deactivate the trunk lid lock release lever from driver seat Insert the master key, and turn it clockwise. Sub/Valet key will not work on the glove box or trunk. Refer to the *Owner's Manual* for more details.

Hood release lever

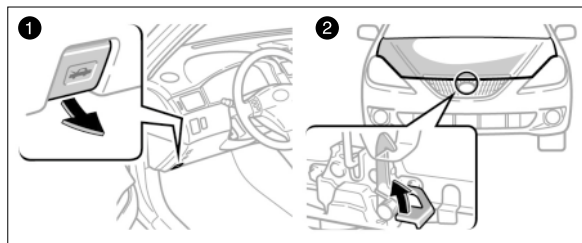

- 1 To release the hood Pull the lever inside vehicle.
- 2 To open the hood Insert finger through the opening between the hood and grill. Pull up on the catch lever inside the compartment and lift the hood.

Light control-Instrument panel

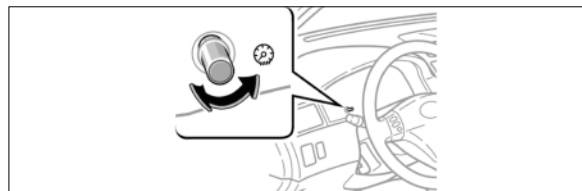

To adjust the brightness of the instrument panel lights Turn the knob right to increase, or left to decrease the brightness of the instrument panel lights.

Clock



To reset the hour Push the "H" button.
To reset the minutes Push the "M" button.

Refer to the *Owner's Manual* for more details.

Engine compartment

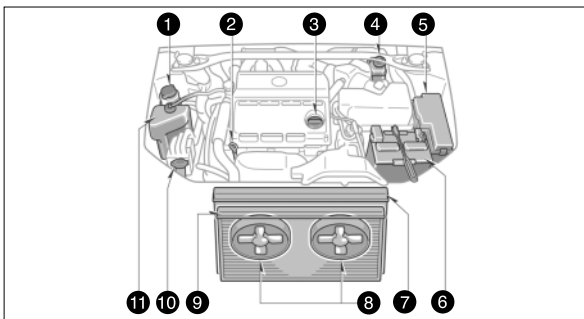

- 1 Power steering fluid reservoir
- 2 Engine oil level dipstick
- 3 Engine oil filler cap
- 4 Brake fluid reservoir
- 5 Fuse block
- 6 Battery
- 7 Radiator
- 8 Electric cooling fans
- 9 A/C condenser
- 10 Windshield washer fluid tank
- 11 Engine coolant reservoir

Note: Regularly scheduled maintenance, including oil changes, will help extend the life of your vehicle and maintain performance. Please refer to the "Owner's Warranty Information Booklet," "Scheduled Maintenance Guide" or "Owner's Manual Supplement."

Auto lock functions-Programmable

Automatic door locks can be programmed to operate in 3 different modes.

Auto shift-locking Doors lock when shifting from Park.

Auto shift-unlocking Doors unlock when shifting into Park.

Auto door-unlocking Doors unlock when the ignition key is turned to the "ACC" or "LOCK" position and driver's door is opened.

Refer to the *Owner's Manual* for more information on this feature, and how to change modes.

Keyless entry

Locking operation



1 To lock Push "🔒."

Unlocking operation



- 2 To unlock driver door Push "🔓" once.
- To unlock all the doors Push "🔓" twice.

NOTE: After unlocking, if a door is not opened within thirty (30) seconds, all doors will relock for safety.

Trunk lid operation

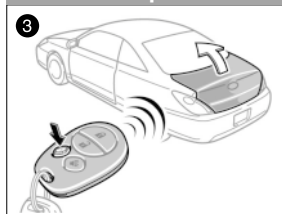

3 To open Push and hold "🚪."

aAlarm operation



4 To activate alarm with remote Push "🚨."

Refer to the *Owner's Manual* for more details.

Automatic transmission

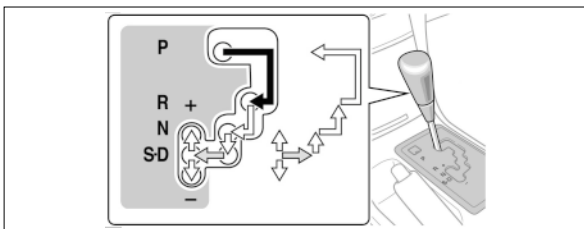

↓ When shifting from "P" (Park), the ignition switch must be "ON," and the brake pedal depressed.

⇅ Shift normally.

- P** Park Engine starting and key removal
- R** Reverse
- N** Neutral
- D** Drive Overdrive "ON"*
- S** "S" mode driving
 - +: Upshifting
 - : Downshifting

"S" (Sequential) mode

← To select "S" mode or to downshift out of overdrive Push the selector lever to the left from "D."

To shift in "S" mode Pull to "-" and release to downshift. Push to "+" and release to upshift.

*Downshifting increases power going uphill, or provides engine braking going downhill. For best fuel economy during normal driving conditions, always drive with the shift lever in the "D" position.

Refer to the *Owner's Manual* for more details.

Door locks

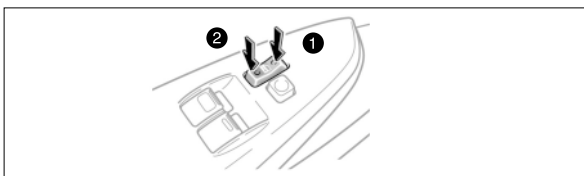

- ① To lock Push down on the front of the switch.
- ② To unlock Push down on the back of the switch.

Seat adjustments

Manual Seat

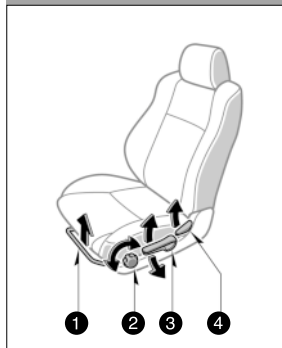

- ① Position lever
- ② Cushion angle knob
- ③ Height crank Driver side only. Crank up to raise, or down to lower.
- ④ Seatback angle lever

Power Seat

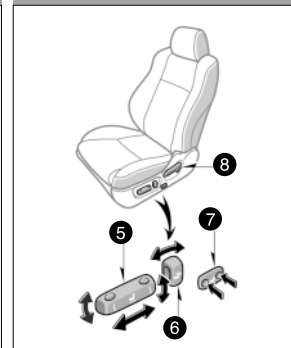

- ⑤ Position, cushion angle and height selector
- ⑥ Seatback angle selector
- ⑦ Lumbar support selector
- ⑧ Seatback lock release lever

Refer to the *Owner's Manual* for more details.

Seats-Head restraints

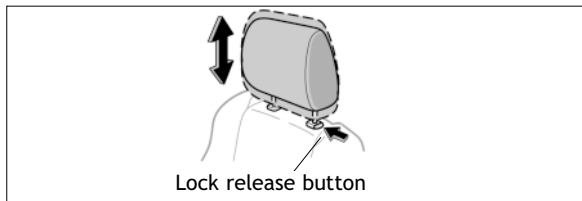

Power outlets

Auxiliary box (12V)

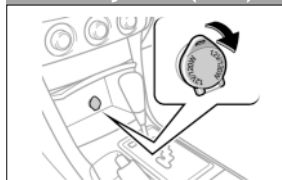

Console box (12V)



Designed for car accessories. Key must be in the "ACC" or "ON" position to be used.

Lights & turn signals

Headlights

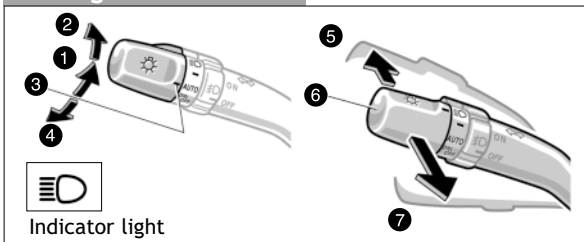

Indicator light

- ➊ **Parking, tail, license plate, side marker and instrument panel lights** Twist the lever knob to position 1.
- ➋ **Headlights and all of the above** Twist the lever knob to position 2.
- ➌ **AUTO** Twist the lever knob to position 3.
- ➍ **To turn off daytime running light system ("DRL OFF")** Twist the lever knob to position 4.
- ➎ **High beams** Push the lever forward.
- ➏ **Low beams**
- ➐ **High beam flasher** Pull the lever toward you.
-Automatic light cutoff system Automatically turns lights off after 30 seconds when any of the doors is open and closed with the ignition in the "ACC" or "LOCK" position. Turn off by pushing "LOCK" button on remote twice.
-Daytime running light system Automatically turns on the headlights at a reduced intensity.

Turn signals

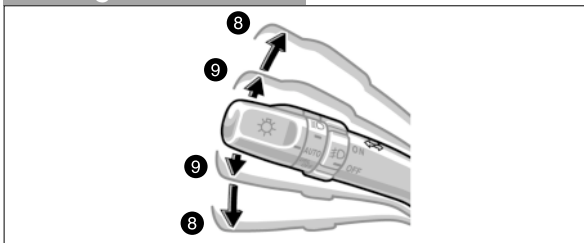

- ➑ **Right or left turn** Push the lever up or down.
- ➒ **Lane change** Move the lever up or down to position 9 and hold.

Windshield wiper & washer

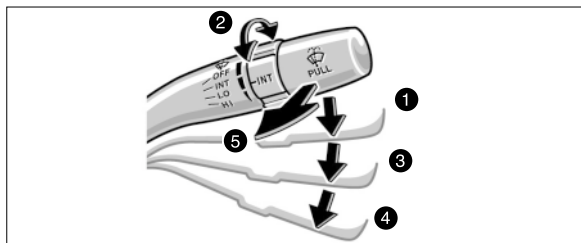

- ➊ **Intermittent speed** Push the lever down to position 1.
- ➋ **Interval adjuster** Twist the band to adjust the intermittent speed.
- ➌ **Slow speed** Push the lever down to position 3.
- ➍ **Fast speed** Push the lever down to position 4.
- ➎ **Wash and wipe** Pull the lever toward you.

Tilt and telescopic steering wheel

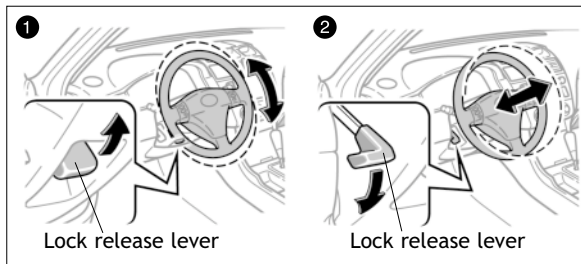

- ➊ **To change the steering wheel angle** Hold the steering wheel, pull the lock release lever, set the desired angle, then release the lever.
- ➋ **To change the steering wheel column length** Push the lock release lever down, set the desired length, then return the lever to its locked position.

Note: Do not attempt to adjust while the vehicle is in motion.

Parking brake

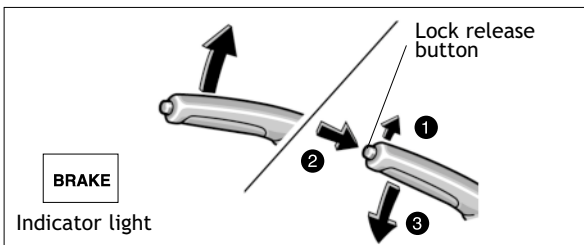

To set Pull the lever up.

To release (1) Pull the lever up slightly, (2) press the lock release button, and (3) lower.

Convertible top operation

Lowering the convertible top

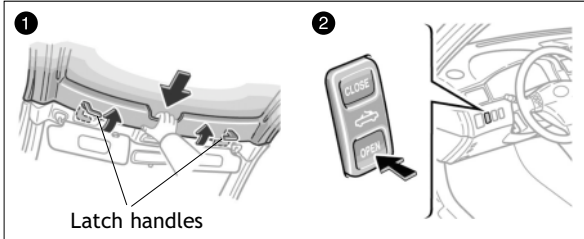

- 1 Lower the sun visors and pull the latch release handles fully backward.
- 2 Push and hold the switch on the "OPEN" side until the convertible top is completely lowered.

Raising the convertible top

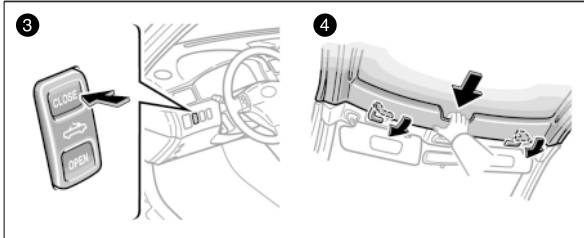

- 3 Lower the sun visors. Push the switch on the "CLOSE" side until the top stops moving.
- 4 Pull down the convertible top and push the latch handles fully forward until they are hooked.

Refer to the *Owner's Manual* for more details.

Windows

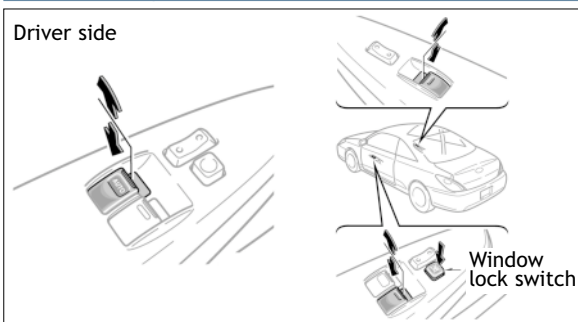

Window operation

To open or close Push down or pull up on the switch.
Automatic down operation (Driver side only) Push the switch completely down and release to fully open. To stop window mid-way, pull up on the switch.

Window lock switch

Push the switch to deactivate the passenger windows.

All windows

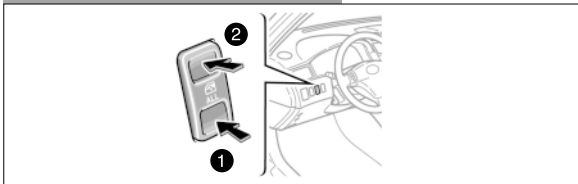

Side and quarter windows can be operated from the master switch.

- 1 To open Push and hold the lower side of the switch.
- 2 To close Push and hold the upper side of the switch.

Engine immobilizer

This is a theft deterrent system. The engine will start only when the electronic code in the key's transponder chip corresponds to the registered ID code for the vehicle. Please note that key replacement can be expensive. Refer to the *Owner's Manual* for more details.

Air conditioning/Heating

Manual air conditioning

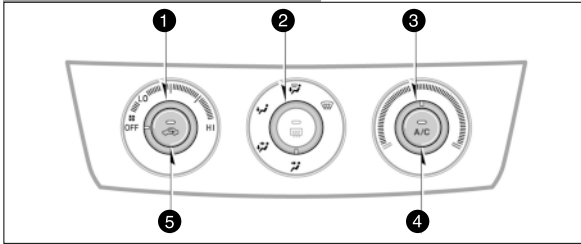

- 1 Fan speed selector
- 2 Air flow selector (See "To select air flow vents" below)
- 3 Temperature selector
- 4 "A/C" switch Air conditioning on/off switch.
- 5 Air intake switch
 - Indicator "ON" Recirculate cabin air.
 - Indicator "OFF" Fresh air.

To select air flow vents

Turn the air flow selector to select following:

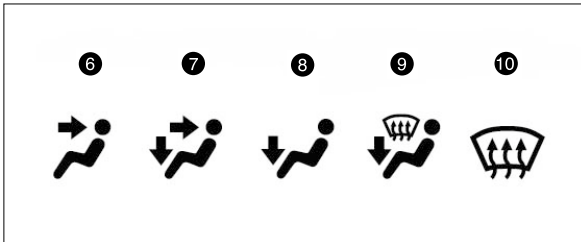

- 6 Instrument panel
- 7 Floor and panel
- 8 Floor
- 9 Floor and windshield¹
- 10 Windshield¹

¹ Use Fresh air mode ("🚗" indicator light "OFF") to reduce window fogging.

Automatic air conditioning

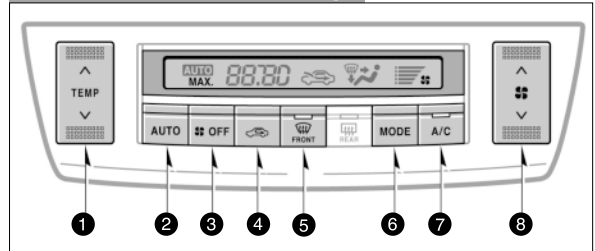

- 1 Temperature selector
- 2 "AUTO" switch Push to turn automatic air conditioning on/off.
- 3 "OFF" switch Air conditioning off button.
- 4 Air intake switch Select fresh or recirculate cabin air.
- 5 Windshield air flow button
- 6 "MODE" button
- 7 "A/C" switch Air conditioning on/off switch.
- 8 Fan speed selector

To select air flow vents

Turn the air flow selector to select following:

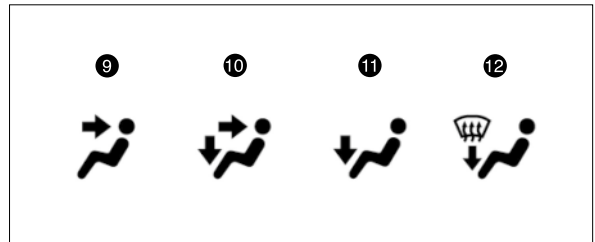

- 9 Instrument panel
- 10 Floor and panel
- 11 Floor
- 12 Floor and windshield¹

¹ Use Fresh air mode ("🚗" indicator light "OFF") to reduce window fogging.

Refer to the *Owner's Manual* for more details.

Audio

Type 1

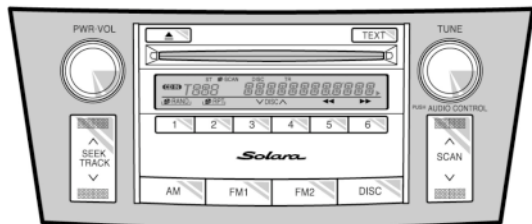

*Functions for buttons 1-6 are indicated above each button on LCD.

Type 2

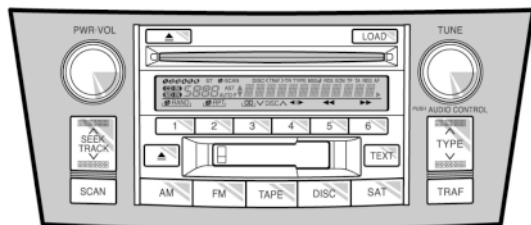

*Functions for buttons 1-6 are indicated above each button on LCD.

BASIC OPERATION

To turn on the audio system Push "PWR-VOL," "AM," "FM," "FM1," "FM2," "SAT," "TAPE" or "DISC."

To turn off the system Push "PWR-VOL."

To adjust the volume Turn "PWR-VOL."

To adjust tone and balance Push the "TUNE-AUDIO CONT" knob. The mode changes with each push in succession from Bass, Treble, Fade, Balance. Turn the knob right or left to adjust each mode.

CASSETTE TAPE PLAYER

To play Insert a cassette tape.

To fast forward Push "▶▶."

To rewind Push "◀◀."

To select a direction Push "◀▶."

To eject a cassette tape Push "▲."

RADIO

To select a station or XM satellite radio channel* Push either side of "SEEK/TRACK."

To scan stations or XM satellite radio channels* Push "SCAN." Push and hold to scan preset stations or XM satellite radio channels*. Push again to hold selection.

To select the band or XM satellite radio channel* Push "AM," "FM," "FM1," "FM2" or "SAT."

-To preset a station or XM satellite radio channel* Tune in the desired station and press a preset button (1-6) until you hear a beep.

-To select a preset station or XM satellite radio channel* Push desired preset button (1-6).

-To select a XM satellite radio channel category* Push "TYPE" button.

Type 2 only is equipped with ...
RDS (Radio Data System-FM only)

-Push TYPE "∧" or "∨" to view current program genre. Push again within 6 seconds to select new genre.

-Push "SEEK/TRACK" or "SCAN" to find same genre programs.

-Push "TEXT" to receive information transmitted from radio stations.

*Type 2 only (if installed)

CD PLAYER

To play Insert a compact disc.

To select a track Push either side of "SEEK/TRACK."

To scan tracks on a disc Push either side of "SCAN." Push again to hold selection.

To eject a compact disc Push "▲."

To view CD text Push "TEXT" to display disc information.

Type 2 only is equipped with ...
CD Changer

-To load one disc Push "LOAD" and insert 1 disc.

-To load multiple discs Push and hold "LOAD" until you hear a beep. Insert one disc.

Note: Wait until the green indicator illuminates to install next disc.

Audio continued

Steering wheel switches

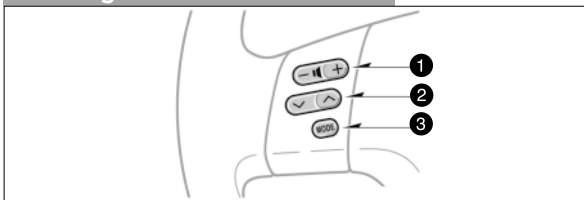

- ① **Volume control switch**
- ② **" ^ v " switch**
In radio mode Push to select a preset station or XM satellite radio channel*, push and hold to seek the next strong station.
In tape mode Push to skip up or down to a next/previous track, push and hold to fast forward or reverse.
In CD mode Push to skip up or down to a next/previous track.
- ③ **"MODE" switch** Push to select an audio mode. Push and hold to turn the audio system "OFF." Refer to the *Owner's Manual* for more details.

*If installed

Garage door opener (HomeLink®)* (if installed)

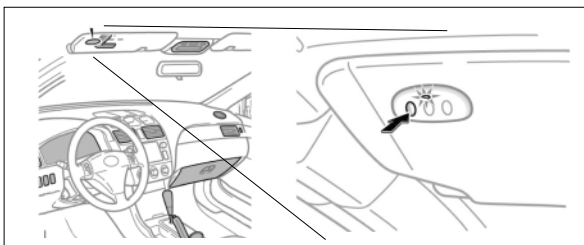

Located on the sun visor, Garage door openers manufactured under license from HomeLink®* can be programmed to operate garage doors, estate gates, security lighting, etc.

Refer to the *Owner's Manual* for more details. For programming assistance, contact the Toyota Customer Experience Center at 1-800-331-4331, or visit <http://www.homelink.com>

*HomeLink® is a registered trademark of Johnson Controls, Inc.

Cruise control

Turning system on/off

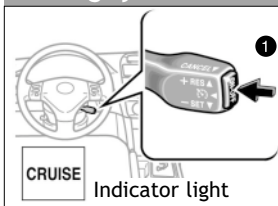

Setting a speed

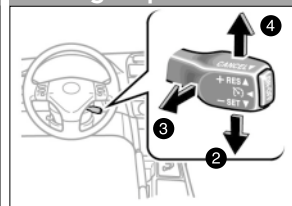

- ① **To turn the system "ON" or "OFF"** Push the button.
- ② **To set a speed** Bring your vehicle to the desired speed. Push the lever down toward "- SET."
- ③ **To cancel the set speed** Pull the lever to "CANCEL." The set speed may also be cancelled by depressing the brake pedal.
- ④ **To resume set speed after cancel** Push the lever up toward "+ RES." If vehicle speed falls below 25 mph, the set speed will not be resumed.

NOTE: To raise set speed, push up toward "+RES." To lower set speed, push down toward "-SET." Refer to the *Owner's Manual* for more details.

Cup holders

Front

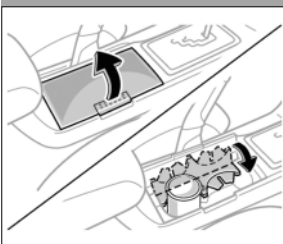

Rear

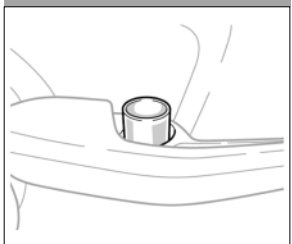

SAFETY AND EMERGENCY FEATURES

Seat belts

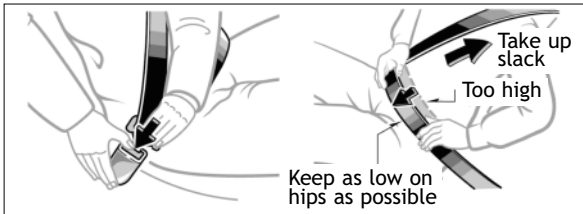

If belt is fully extended, then retracted even slightly, it cannot be re-extended beyond that point, unless fully retracted again. This feature is used to help hold child restraint systems securely.

To find more information about seat belts, and how to install a child restraint system, refer to the *Owner's Manual*.

Seat belt guides

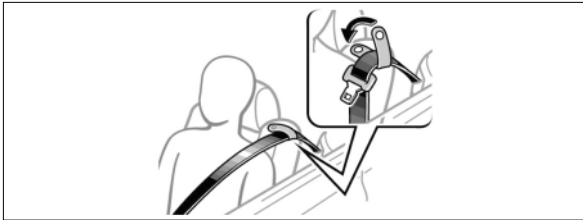

To provide convenience for driver reaching for seat belt and for passengers getting in or out of rear seat. Detach the hanger magnet. Place the seat belt through the guide and reattach the magnets.

Tire Pressure Warning System

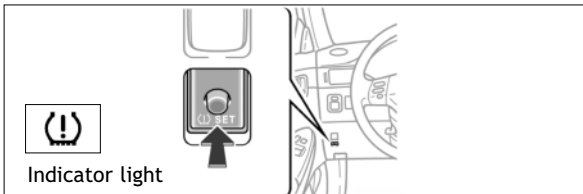

Designed to provide warning when tire pressure of any one of the tires is critically reduced while the vehicle is moving. It must be re-initialized by pushing and holding the "(!) SET" button if indicator light blinks twice every second, and/or after replacing or rotating tires or wheels.

Refer to the *Owner's Manual* for more details.

TRAC (Traction Control) (if installed)

Helps control spinning of the front wheels, which may occur when accelerating on slippery roads. Refer to the *Owner's Manual* for more details.

VSC (Vehicle Stability Control)¹ (if installed)

Helps provide comprehensive control of the Anti-lock Brakes, Brake-Assist², Traction Control, engine control and other systems. This system helps maintain control of the vehicle under adverse conditions. Refer to the *Owner's Manual* for more details.

¹ Vehicle Stability Control (VSC) is an electronic system designed to help the driver maintain vehicle control under adverse conditions. It is not a substitute for safe driving practices. Factors including speed, road conditions and driver steering input can all affect whether VSC will be effective in preventing loss of control.

² Brake-Assist is designed to help the driver take full advantage of the benefits of ABS (Anti-lock Brake System). It is not a substitute for safe driving practices. Braking effectiveness also depends on proper brake-system maintenance and tire and road conditions.

Airbag-Supplemental Restraint System

The Airbag Supplemental Restraint System (SRS) front and side airbags are designed to help provide further protection for the driver and outboard passenger in addition to the primary safety protection provided by the seat belts.

Front passenger occupant classification system
Monitors the load on the front passenger seat, and detects if the seat belt is fastened to determine passenger occupancy and size of passenger, if any.

- For the system to correctly determine conditions**
- Do not place heavy objects on the front passenger seat.
 - Do not attach a seatback table to the front passenger seatback.
 - Do not put weight on the front passenger seat by putting your hands or feet on the front passenger seatback from the rear passenger seat.

Please read the following caution, and refer to the *Owner's Manual* for more details.

CAUTION

- The driver and front passenger airbag Supplemental Restraint System (SRS) is designed only as a supplement to the primary protection of the seat belt systems of the driver and front passenger. The front seat occupants are particularly susceptible to injury if they do not wear their seat belts; when sudden braking or a collision occurs, they may be thrown forward. To obtain maximum protection in an accident, the driver and all passengers in the vehicle should always wear their seat belts when driving because serious injuries or death can result to unrestrained occupants. For instructions and precautions concerning the seat belt system, see "Seat belts" in the *Owner's Manual*.
- Toyota strongly urges the use of a proper child restraint system on the rear seat that conforms to the size of the child. According to accident statistics, a child is safer when properly restrained in the rear seat than on the front seat.
- Never use a rear-facing child restraint system in the front seat even if the front passenger occupant classification indicator light is "OFF." The force of the rapid inflation of the passenger airbag can cause severe injury or death to a child.
- Unless it is unavoidable, do not install a forward-facing child restraint system in the front seat even if the front passenger occupant classification indicator light is "OFF." If you must install a forward-facing child restraint system in that the front seat, move the seat as far back as possible.
- Make sure you have complied with all installation instructions provided by the child restraint manufacturer and the system is properly secured.
- Make sure the front passenger occupant classification indicator light indicates "ON" when using the seat belt extender for the front passenger seat. If the indicator light indicates "OFF," disconnect the extender tongue from the seat belt buckle, then reconnect the seat belt. Reconnect the seat belt extender after making sure the indicator light indicates "ON." If you use the seat belt extender while the indicator light indicates "OFF," the front passenger airbag and side airbag on the front passenger side may not activate correctly, which could cause death or serious injury in the event of collision.
- If an adult sits in the front passenger seat, the occupant classification indicator light should indicate "ON." If the "OFF" indicator is illuminated, ask the passenger to sit up straight, well back in the seat, feet on the floor, and with the seat belt worn correctly. If the "OFF" indicator still remains illuminated, either ask the passenger to move to the rear seat, or if that is not possible, move the front passenger seat fully rearward.
- The SRS side and side curtain airbags (optional) are designed to deploy in certain types of severe side impact collisions. In all other collisions, the side impact and side curtain airbags will not deploy. For instructions and precautions, see your *Owner's Manual*.
- Do not lean against the side doors when the vehicle is in use. The side and side curtain airbags inflate with considerable speed and force. Death or serious injury could result.
- Do not modify, cover or replace the surface of the front seats. Such changes could disable the system or prevent the airbags from activating correctly, resulting in death or serious injury.