



# **Dialogic® IMG 1010 Integrated Media Gateway**

**IMG 1010 Module Install Instructions  
Release 10.3.x / 10.5.x**

## Copyright and Legal Notice

Copyright © 2005-2008 Dialogic Corporation. All Rights Reserved. You may not reproduce this document in whole or in part without permission in writing from Dialogic Corporation at the address provided below.

All contents of this document are furnished for informational use only and are subject to change without notice and do not represent a commitment on the part of Dialogic Corporation or its subsidiaries ("Dialogic"). Reasonable effort is made to ensure the accuracy of the information contained in the document. However, Dialogic does not warrant the accuracy of this information and cannot accept responsibility for errors, inaccuracies or omissions that may be contained in this document.

INFORMATION IN THIS DOCUMENT IS PROVIDED IN CONNECTION WITH DIALOGIC® PRODUCTS. NO LICENSE, EXPRESS OR IMPLIED, BY ESTOPPEL OR OTHERWISE, TO ANY INTELLECTUAL PROPERTY RIGHTS IS GRANTED BY THIS DOCUMENT. EXCEPT AS PROVIDED IN A SIGNED AGREEMENT BETWEEN YOU AND DIALOGIC, DIALOGIC ASSUMES NO LIABILITY WHATSOEVER, AND DIALOGIC DISCLAIMS ANY EXPRESS OR IMPLIED WARRANTY, RELATING TO SALE AND/OR USE OF DIALOGIC PRODUCTS INCLUDING LIABILITY OR WARRANTIES RELATING TO FITNESS FOR A PARTICULAR PURPOSE, MERCHANTABILITY, OR INFRINGEMENT OF ANY INTELLECTUAL PROPERTY RIGHT OF A THIRD PARTY.

Dialogic products are not intended for use in medical, life saving, life sustaining, critical control or safety systems, or in nuclear facility applications.

Due to differing national regulations and approval requirements, certain Dialogic products may be suitable for use only in specific countries, and thus may not function properly in other countries. You are responsible for ensuring that your use of such products occurs only in the countries where such use is suitable. For information on specific products, contact Dialogic Corporation at the address indicated below or on the web at <http://www.dialogic.com/>.

It is possible that the use or implementation of any one of the concepts, applications, or ideas described in this document, in marketing collateral produced by or on web pages maintained by Dialogic may infringe one or more patents or other intellectual property rights owned by third parties. Dialogic does not provide any intellectual property licenses with the sale of Dialogic products other than a license to use such product in accordance with intellectual property owned or validly licensed by Dialogic and no such licenses are provided except pursuant to a signed agreement with Dialogic. More detailed information about such intellectual property is available from Dialogic's legal department at 9800 Cavendish Blvd., 5th Floor, Montreal, Quebec, Canada H4M 2V9.

Dialogic encourages all users of its products to procure all necessary intellectual property licenses required to implement any concepts or applications and does not condone or encourage any intellectual property infringement and disclaims any responsibility related thereto. These intellectual property licenses may differ from country to country and it is the responsibility of those who develop the concepts or applications to be aware of and comply with different national license requirements.

Any use case(s) shown and/or described herein represent one or more examples of the various ways, scenarios or environments in which Dialogic® products can be used. Such use case(s) are non-limiting and do not represent recommendations of Dialogic as to whether or how to use Dialogic products.

Dialogic, Dialogic Pro, Brooktrout, Cantata, SnowShore, Eicon, Eicon Networks, Eiconcard, Diva, SIPcontrol, Diva ISDN, TruFax, Realblobs, Realcomm 100, NetAccess, Instant ISDN, TRXStream, Exnet, Exnet Connect, EXS, ExchangePlus VSE, Switchkit, N20, Powering The Service-Ready Network, Vantage, Making Innovation Thrive, Connecting People to Information, Connecting to Growth and Shiva, among others as well as related logos, are either registered trademarks or trademarks of Dialogic. Dialogic's trademarks may be used publicly only with permission from Dialogic. Such permission may only be granted by Dialogic's legal department at 9800 Cavendish Blvd., 5th Floor, Montreal, Quebec, Canada H4M 2V9. Any authorized use of Dialogic's trademarks will be subject to full respect of the trademark guidelines published by Dialogic from time to time and any use of Dialogic's trademarks requires proper acknowledgement.

Windows is a registered trademark of Microsoft Corporation in the United States and/or other countries. Other names of actual companies and products mentioned herein are the trademarks of their respective owners.

## Hardware Limited Warranty

**Warranty for Hardware Products:** Dialogic Corporation or its subsidiary that originally sold the hardware product ("Dialogic") warrants to the original purchaser of this hardware product, that at the time of delivery the hardware product supplied hereunder will be free from defects in material and workmanship. This warranty is for the standard period set out on Dialogic's website at <http://www.dialogic.com/warranties> and is subject to all of the terms and limitations set out on the Dialogic website at <http://www.dialogic.com/warranties>.

**Additional Exclusions:** Dialogic will have no obligation to make repairs or replacements necessitated by your fault or negligence, improper or unauthorized use of the product, repairs or modifications made without Dialogic's prior written approval or by causes beyond the control of Dialogic, including, but not limited to, power or air conditioning failure, acts of God, improper interface with other units, or malfunction of any equipment or software used with the Dialogic product(s). If Dialogic is requested and agrees to make repairs or replacements necessitated by any such causes, you will pay for such service or replacement at Dialogic's then prevailing rates.

**No Other Warranties:** DIALOGIC DISCLAIMS AND YOU WAIVE ALL OTHER WARRANTIES, EITHER EXPRESS OR IMPLIED, INCLUDING BUT NOT LIMITED TO IMPLIED WARRANTIES OF MERCHANTABILITY, NON-INFRINGEMENT AND FITNESS FOR A PARTICULAR PURPOSE AND ANY WARRANTY AGAINST LATENT DEFECTS, WITH RESPECT TO ANY DIALOGIC PRODUCT.

**No Liability for Damages:** IN NO EVENT SHALL DIALOGIC OR ITS SUPPLIERS BE LIABLE FOR ANY DAMAGES WHATSOEVER (INCLUDING, WITHOUT LIMITATION, DAMAGES FOR LOSS OF PROFITS, INTERRUPTION OF ACTIVITIES, LOSS OF INFORMATION OR OTHER PECUNIARY LOSS AND DIRECT OR INDIRECT, CONSEQUENTIAL, INCIDENTAL, ECONOMIC OR PUNITIVE DAMAGES) ARISING OUT OF THE USE OF OR INABILITY TO USE ANY DIALOGIC PRODUCT.

**Limitation of Liability:** DIALOGIC'S MAXIMUM CUMULATIVE LIABILITY SHALL BE LIMITED TO THE AMOUNTS ACTUALLY PAID BY YOU TO DIALOGIC FOR THE SPECIFIC PRODUCT BEING THE OBJECT OF THE CLAIM. YOU RELEASE DIALOGIC FROM ALL AMOUNTS IN EXCESS OF THE LIMITATION. YOU ACKNOWLEDGE THAT THIS CONDITION IS ESSENTIAL AND THAT DIALOGIC WOULD NOT SUPPLY TO YOU IF IT WERE NOT INCLUDED.

## IMPORTANT NOTE:

Please be aware that the following terminology and abbreviations are used throughout this document. Please also be sure to consult the legal notice for other important details.

When used herein, the term "IMG 1010" refers to the "Dialogic® IMG 1010 Integrated Media Gateway" product.

When used herein, the term "GCEMS" refers to the "Dialogic® Gate Control Element Management System"

## Technical Support

Technical Support Number: 781-433-9600

Technical Support Fax: 781-449-9520

<http://www.dialogic.com/>

## Installing a Dialogic® IMG 1010 VoIP or Media Module to Dialogic® IMG 1010 Integrated Media Gateway.

### Caution:

Electrostatic Discharge Protection (EDP) must always be used. Electrostatic Discharge (ESD) protective straps, shoes, or mats must be used when working with electronic components. Electrostatic discharge from your body can damage integrated circuits during installation.

### Required Tools and Parts:

- Dialogic® IMG 1010 VoIP Module or Dialogic® IMG 1010 Media Module (Dialogic supplied).
- 4 Phillips pan head screws (Dialogic supplied).
- #1 Phillips head screwdriver (customer supplied).

### Remove Dialogic® IMG 1010 Motherboard

1. Switch power to OFF (O) at rear of docking station.
2. Loosen the two ejector captive fasteners located on each side of the front panel.
3. Lift the ejectors upward and pull to unseat the tray from the docking station.
4. Remove Dialogic® IMG 1010 Motherboard. See [Diagram 1 - Removing Dialogic® IMG 1010 Motherboard Tray](#).
5. Locate Module on Dialogic® IMG 1010 Motherboard. See [Diagram 2 - Dialogic® IMG 1010 VoIP and Media Module Positions](#).

### Installing Dialogic® IMG 1010 VoIP or Dialogic® IMG 1010 Media Module

1. Position the module over the four standoffs on Dialogic® IMG 1010 Motherboard.
2. Align the connectors on the module with the connectors on the motherboard and press together. See diagram below:

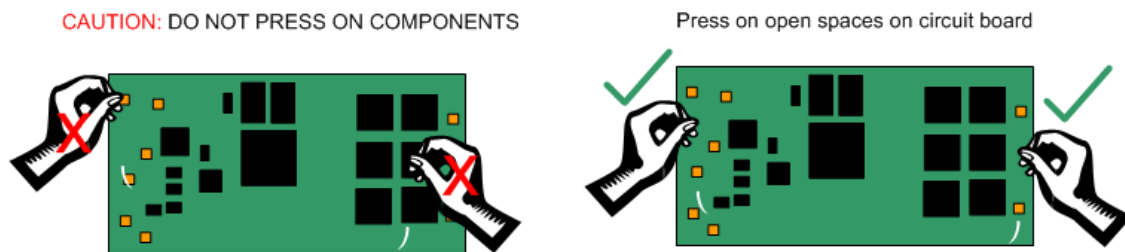

### Cautions:

- The connectors must be properly aligned and fully seated.
- When pressing the module onto the motherboard do not press on the components installed on the module; instead, do press on an open area on the edge of the Printed Circuit Board itself.

3. Attach the module with the four (4) Phillips pan head screws. Do not over tighten the screws. (Recommended torque: 3-5 in-lbs (.34-.56 N-M)).

4. Re-insert Dialogic® IMG 1010 Motherboard Tray. Align the rail on each side of the tray with the guides on the inside of the docking station.
5. Verify the ejectors are in the up position.
6. Slide the tray in until the power connectors and signal connectors initially mate (the ejectors will start to move down).

**Cautions:**

- Do not force the tray if any resistance occurs when mating with the docking station. Using undue force could damage the unit.
- The guides only provide gross alignment to the power and signal connectors. The guide pins on the main board and I/O card are self-aligning and provide alignment for the connectors.
- The tray guides also act as the conduit for any Electrostatic Discharge (ESD) as the tray initially mates with the docking station.

7. When the tray is seated and the connectors are mated, push the ejectors down and tighten the captive fasteners.
8. Switch the power to ON (1) at rear of docking station.
9. Configure Module. See Configuring Media or Configuring VoIP in the On-line Help Documentation on the Dialogic Technical Support web site: <http://www.dialogic.com/manuals>

**Diagram 1 - Removing Dialogic® IMG 1010 Motherboard Tray**

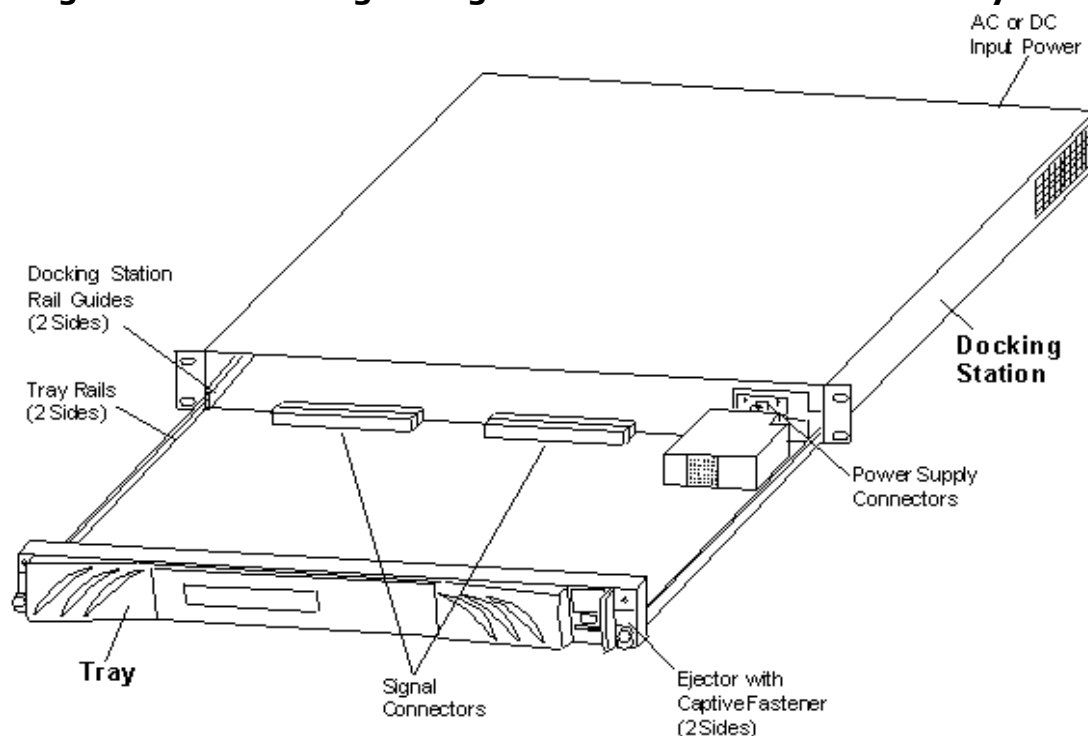

## Diagram 2 - Module Positions

**Important:** If only one Dialogic® IMG 1010 VoIP Module is to be installed, it must be at Position 0. See illustration below.

