

SMT Power Inductor (MOLDING TYPE)

MPO10X Type

Features

- RoHS compliant.
- Low profile, high current SMD type.
- Frequency range up to 1MHz.
- Lowest DCR/ μH , in this package size.
- Low buzz noise due to its gap-less structure.

Applications

- Notebook/Desktop/Server/Video Card applications.
- High current POL converters.
- Low profile, high current power supplies.
- Battery powered devices.
- Ideal for power source circuits, DC-DC converter.
- DC-AC inverters inductor application.

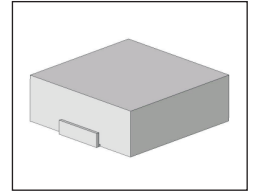

Mechanical Dimension:

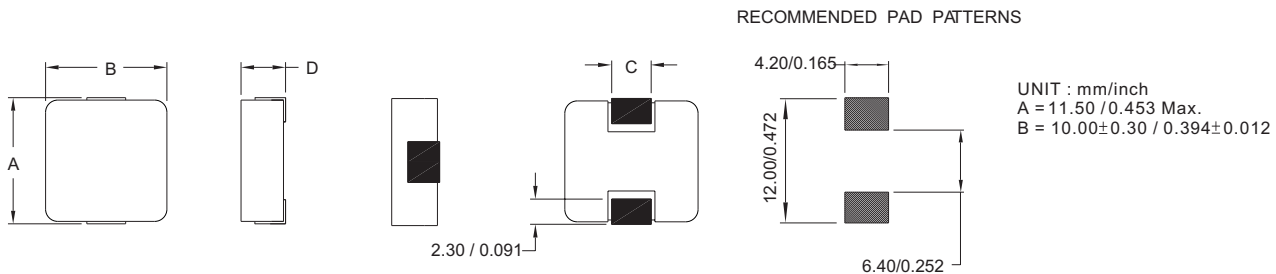

Electrical Characteristics: At 25°C: 100KHz, 0.25V

| PART NO. | Lo ¹ (μH) | DCR (m Ω) TYP. | DCR (m Ω) MAX. | Isat ¹ (Adc) | I _r ² (Adc) | Dimension "C" mm / inch \pm 0.5 / \pm 0.02 | Dimension "D" mm / inch MAX |
|--------------|--------------------------------------|---------------------------|---------------------------|----------------------------|--------------------------------------|--|-----------------------------------|
| MPO1035-R68 | 0.68 \pm 20% | 2.30 | 2.80 | 38 | 25 | 2.3 / 0.091 | 3.5 / 0.138 |
| MPO1035-1R0 | 1.00 \pm 20% | 3.35 | 3.80 | 26 | 21 | 2.0 / 0.079 | 3.5 / 0.138 |
| MPO104-R36 | 0.36 \pm 20% | 1.08 | 1.20 | 45 | 30 | 3.5 / 0.138 | 4.0 / 0.157 |
| MPO104-R39 | 0.39 \pm 20% | 1.08 | 1.20 | 35 | 30 | 3.5 / 0.138 | 4.0 / 0.157 |
| MPO104-R45-C | 0.45 \pm 20% | 1.25 | 1.45 | 35 | 30 | 3.5 / 0.138 | 4.0 / 0.157 |
| MPO104-R56 | 0.56 \pm 20% | 1.60 | 1.80 | 25 | 36 | 3.0 / 0.118 | 4.0 / 0.157 |
| MPO104-1R0 | 1.00 \pm 20% | 2.80 | 3.00 | 30 | 21 | 2.6 / 0.103 | 4.0 / 0.157 |
| MPO104-1R5 | 1.50 \pm 20% | 3.80 | 4.20 | 33 | 20 | 2.3 / 0.091 | 4.0 / 0.157 |

1. Isat is the DC current which cause the inductance drop approximately 30% of its nominal inductance without current.
3. I_r is the DC current which cause the surface temperature of the part increase approximately than 40°C.



DELTA ELECTRONICS, INC.

(TAOYUAN PLANT CPBG) 252, SAN YING ROAD, KUEISAN INDUSTRIAL ZONE, TAOYUAN SHIEN, 333, TAIWAN, R.O.C.

TEL: 886-3-3591968; FAX: 886-3-3591991

<http://www.deltawww.com>