



RMT-10 VHF Rack-Mount Transmitter Instruction Manual



TABLE OF CONTENTS

Quick Start	2
A Word to Vega Users	2
Unpacking	2
Introduction	4
Installation	5
Whip Antenna Length	6
XLR Connector.	6
Power Supply	6
Adjustments	7
Audio Compression Adjustment*.	7
Audio Level Setting	7
Frequency-Compensation Adjustments	8
Compatibility.	8
Frequency Selection.	8
Troubleshooting	8
Antennas	8
RF Noise	9
Warranty (Limited)	10
Factory Service Center	10
Claim	10
Specifications	11

Quick Start

Please see Figure 1 and the instructions on the next page for a quick start.

A Word to Vega Users

In selecting Vega equipment, you are in the company of audio professionals worldwide. Leadership for over 30 years has made “Vega” synonymous with wireless equipment. Our equipment provides superb sound quality, outstanding performance, and the durability needed for years of successful operation.

Unpacking

Verify the number of boxes shown as “shipped” has been received in good condition. Unpack and save cartons for storage or reshipping. If, for any reason, you do not find the equipment to be completely satisfactory, please immediately contact your Vega dealer or the Vega factory.

Should service ever be required, remember your authorized Vega service dealer knows your equipment best. They have the training and test equipment necessary to restore your equipment to its peak performance.

Please feel free to contact either your authorized Vega dealer or the Vega factory for information or assistance at any time.

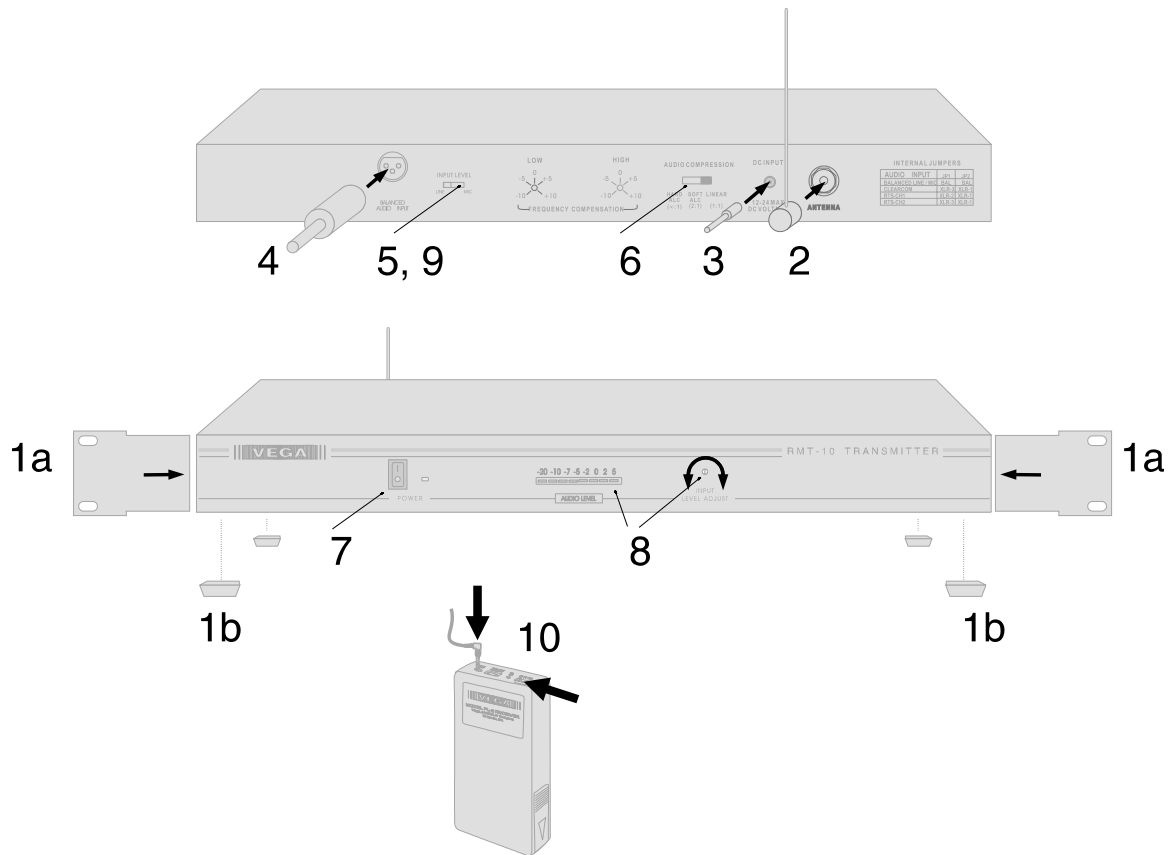

5. Put on rack-mount (1a) "ears" or (1b) rubber feet (for details see "Installation" next page).
6. Attach the whip antenna (see the "Whip Antenna Length" section) or the optional dipole antenna to the ANTENNA connector on the rear panel.
7. Connect wall-type power supply to the rear-panel DC INPUT and then plug the power supply into an ac outlet.
8. Connect audio source to the rear-panel XLR connector (see "XLR Connector" next page).
9. Set the rear-panel INPUT LEVEL (MIC/LINE switch) to the LINE position.
10. Set the rear-panel AUDIO COMPRESSION switch to LINEAR.
11. Turn on the RMT-10 with the front-panel POWER switch.
12. With an audio input applied to the unit, adjust the front-panel INPUT LEVEL ADJUST control until the AUDIO LEVEL bargraph meter indicates peaks in the 0 to +2 VU range.
13. If the peaks do not reach at least 0 VU with the previous adjustment, set the rear-panel MIC/LINE switch to MIC, then readjust the front-panel AUDIO LEVEL control until the AUDIO LEVEL bargraph meter indicates peaks in the 0 to +2 VU range.
14. Attach an earpiece or headset to the receiver, turn on, select the correct frequency, then verify correct reception. See the receiver's manual for details.

Introduction

This document describes setup, adjustment, and operation only; detailed maintenance information is not included. If you have any questions, consult your dealer or the Vega factory.

Your Vega Model RMT-10 is a single-channel VHF FM transmitter. It transmits a mono audio signal to compatible receivers (typically Vega PL-2s). The RMT-10's "transmitter module" (PCB) can be swapped (by authorized personnel) to allow operation on a different frequency—any one of over 1,600 different frequencies between 169 MHz and 216 MHz. Consult your dealer or the Vega factory for details.

The RMT-10 accepts either line or mic audio via a standard XLR connector. The "input level" switch allows selection between mic (−40 to −10 dBu) or line (−10 and +20 dBu) audio input. RMT-10s may also be internally programmed to work with Clear-Com or RTS wired intercom systems ("receive-only" mode). The RMT-10 may also be configured to pass a 70-volt speaker line (input up to 250 volts push-to-talk).

Fine audio-level adjustments may be made using the 30-dB variable attenuator conveniently located on the front panel. To improve intelligibility, the transmission signal may be adjusted via "frequency compensation" and "audio compression" controls. Two "frequency compensation" controls for boosting or cutting the low and high frequencies are provided on the rear panel. The "audio compression" control limits dynamic range by either a 2:1 logarithmic compressor or a wide-range automatic level control (ALC) system. See the "Adjustments" section for details.

Noise reduction is achieved with a proprietary two-ended compander system that is always active. The compander is compatible with Vega's PL-2 portable VHF receiver.

A 1/4-wave "whip" antenna is provided with the RMT-10. Other antennas, such as the Vega Model 123U dipole antenna, may be used to facilitate rack-mount installation or to improve coverage where the standard whip antenna would otherwise be blocked or shielded by equipment cabinets or large objects.

Installation

The RMT-10 can be mounted in a standard 19-inch (48-cm) rack, or operate standing alone. **For stand-alone operation:** Peel off the four rubber feet's protective paper (provided with the RMT-10) and attach to the bottom of the chassis at each corner.

For rack-mount use, the detachable rack-mount “ears” must first be installed on the RMT-10 as follows:

1. Loosen the four screws (do not remove) on the two sides of the unit that hold the top cover onto the chassis.
2. Slide the cover back as far as it will go—about 1/8 inch (3 mm).
3. Slide the smaller end of the front-mount ear into the grooves in each end of the front panel. Be sure the ear's vertical locking groove is facing the unit's rear.
4. Slide the top cover forward so the front edges engage the locking grooves in the rack-mount ears. Re-tighten the cover onto the chassis (four screws). Verify the rack-mount ears are secure and will not slip out.

The RMT-10 is now ready to be installed into a standard 19-inch (43-cm) rack using the #10 screws and finish washers provided, or the equivalent metric hardware.

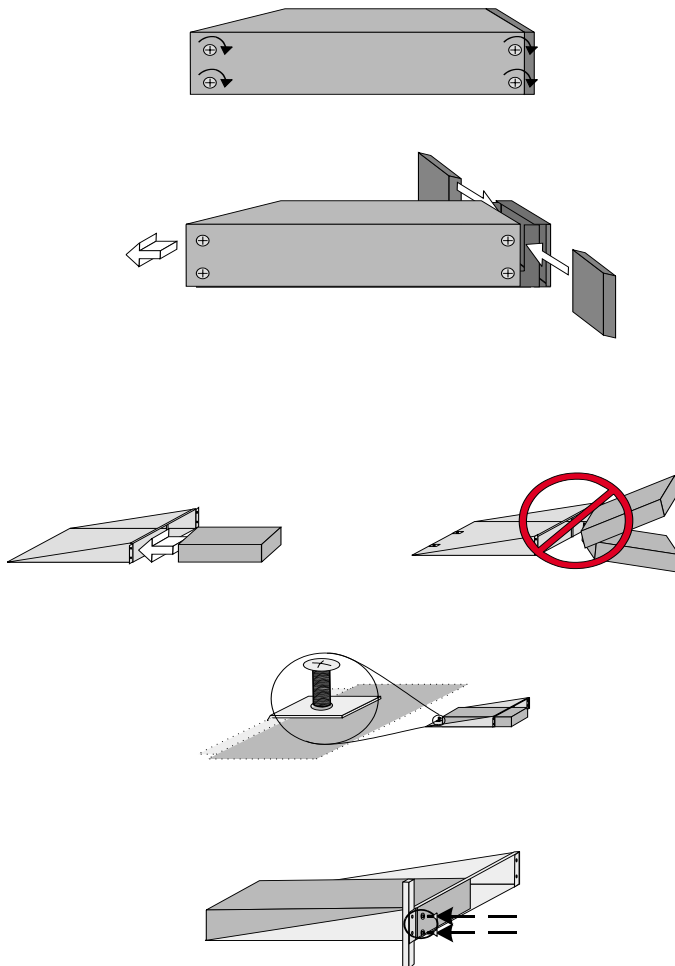

Whip Antenna Length

For optimum antenna efficiency, the wire whip may be cut to length. Do NOT try to cut the whip with wire cutters, the whip is made from tough steel and will likely destroy the wire cutters. Use a bench grinder or equivalent to grind through the whip wire, being careful to use protective goggles and heavy gloves while grinding operation. The chart below lists the length required for various operating frequencies. The lengths shown are for the exposed portion of the whip. The actual cut length will be 0.175" (0.45 cm) longer. In addition, the values differ from the theoretical quarter wave length due to the loading effects of the ball on the end of the whip and the connector barrel. Approximate length of whip versus frequency:

170 MHz 17.8" (45.2 cm)
 180 MHz 17.1" (43.4 cm)
 190 MHz 16.3" (41.4 cm)
 200 MHz 15.6" (39.6 cm)
 210 MHz 15.0" (38.1 cm)

For frequencies between the chart entries, the length may be interpolated.

XLR Connector

Connect the system's audio source to the XLR connector located on the rear panel. This is a balanced, transformer-isolated input, which is dc isolated to 50 volts. For the standard mic-or line-level input modes, the pin assignments on this connector are: pin 1: shield, pin 2: audio positive, pin 3: audio negative.

When internally programmed for use with a Clear-Com or RTS intercom, the pin assignments will be consistent with that required by the intercom system. The programming jumpers are located inside the unit at the rear of the PCB, near the XLR connector. Programming is as follows:

Mode	JP1	JP2
Balanced mic line	BAL	BAL
Clear-Com	XLR 3	XLR 1
RTS Channel	XLR 2	XLR 1
RTS Channel	XLR 3	XLR 1
70 Volt Live	70 V	70V

When reprogrammed, plug the wall-type power supply into a standard power outlet, and insert the dc power connector into the power jack located on the rear panel of the RMT-10.

Power Supply

WARNING: If providing dc power from another source, external fusing is strongly advised. No internal circuit fuse is provided with the RMT-10. The provided power supply is internally impedance- and thermal-limited and therefore does not require additional circuit protection. Consult the Vega factory for more information.

You may wish to supply dc power from a source other than the provided wall-mounted power supply. In this case, connect +12 to +20 Vdc (0.3 A minimum) to the power connector on the rear of the RMT-10. A compatible mating connector is the Switchcraft 760. When connecting external dc, carefully observe the following polarity rules:

Power supply negative (–) to the outer conductor
 Power supply positive (+) to the inner conductor

Adjustments

Note: Normal setup and operation does not require internal access. Refer all service and internal adjustments to qualified service personnel. Specifically, the user may not make adjustments to the transmitter module. See the “Troubleshooting” section for additional information.

Use the same adjustment procedures for use with Clearcom, RTS, and 70-volt line applications.

Audio Compression Adjustment*

The “Audio Compression” switch limits audio signal dynamic range as follows:

HARD ALC improves intelligibility by providing about 35 dB of automatic level control with fixed gain at low input levels. SOFT ALC position provides soft, 2:1 logarithmic gain compression—deemphasizing louder audio while emphasizing low-level audio. LINEAR does not alter the audio signal at all, and provides no dynamic range adjustment.

Set the “LOW” and “HIGH” frequency compensation controls to the mid, or “0,” position.

*The adjustment procedure for an intercom system or 70-volt line input is identical, except the mic/line switch is not needed and is nonfunctional.

Note: Whenever a different dynamic-range setting is selected, it will be necessary to readjust the variable audio level control to achieve the 0 VU reading on the front-panel bargraph. If the VU meter consistently reads significantly lower than 0 VU, the system will not be operating at the best possible signal-to-noise ratio.

Audio Level Setting

The RMT-10 accommodates audio levels between –40 dB to +20 dB, a 60 dB range.

If you know the approximate level of the input audio, set the mic/line as follows:

Program Audio Level	Mic/Line Switch Setting
–10 to +20 dBu	“LINE”
–40 to –10 dBu	“MIC”

Next, adjust the front-panel INPUT LEVEL ADJUST control until the front-panel VU-meter bargraph just reaches the “0 VU” position on voice peaks.

If you don't know the approximate level of the audio input, set the MIC/LINE switch to LINE. Apply the desired program audio signal to the audio input connector. Observe the front-panel VU meter. Adjust the front-panel variable audio level control until the VU-meter bargraph just reaches the “0 VU” position.

If the VU meter bargraph consistently reads well below 0 VU, set the MIC/LINE switch to the MIC position and readjust the variable audio level control for 0 VU reading. If the VU-meter bargraph cannot be adjusted up to the 0 VU level with the MIC/LINE switch in the MIC position, increase the audio level at the source.

For use with Clearcom or RTS intercoms, or for 70-volt line applications, use the same basic adjustment procedures as above.

Frequency-Compensation Adjustments

Listen to the program audio on a compatible receiver (Vega PL-2). Experiment with the dynamic-range limiter settings and select the position that best meets your audio-quality and intelligibility needs. The controls should be adjusted to achieve maximum intelligibility for the particular listener group involved.

For the hearing impaired, a beginning setting of +5 to +6 for the “high” control, –4 to –5 on the “low” control, and HARD ALC, is a good starting point.

These frequency compensation controls provide 10 dB adjustments to the low and high frequencies, respectively. Unlike stereo tone controls, these adjustments affect audio response well into the audio midrange.

Compatibility

The RMT-10 transmitter is intended to be used only with Model PL-2 portable receiver(s) or other Vega receivers that are specifically identified as being compatible with RMT-10.

Frequency Selection

For successful operation, it is necessary to choose a transmit frequency for the RMT-10 that can coexist with other RF systems in the coverage area. The frequency of the RMT-10 must be specified at the time of purchase. The Vega factory provides a frequency-coordination service free of charge for this purpose.

NOTE: There are restrictions on use of specific frequency ranges by certain types of users. If you do not understand these restrictions or are uncertain of their applicability, consult your dealer or the Vega factory.

Troubleshooting

Most Vega equipment provides years of trouble-free operation. However, as with all electronic devices, problems might occur. Problems are usually due to low batteries, improper antenna placement, etc.—not equipment failure. Vega equipment is thoroughly tested before leaving the factory.

The following paragraphs describe the most common problems. Please review this information and take any necessary corrective action. If you still experience difficulties, contact the Vega factory or your sales representative. Often, the problem can be resolved by phone, avoiding downtime for unnecessary returns.

Should repairs be necessary within the first year of operation (under warranty), Vega will promptly correct the problem and return the unit. Service for older units may also be obtained from Vega; contact the factory or your sales representative for information.

Return of both transmitter and receiver is recommended, allowing us to perform a complete checkout and test of the entire system. This can be especially helpful for elusive or intermittent problems.

Antennas

Proper mounting and placement of antenna(s) is vitally important in wireless systems. If overlooked, antennas might cause unnecessary problems. In all cases, a clear and unobstructed line-of-sight path between the transmitting antenna and the receiver(s) is required.

The antenna might be concealed behind fabric, thin plastic, acoustic tile, and thin plywood without significantly affecting performance. However, close proximity to metallic objects such as furniture, lighting fixtures, scaffolding, electrical cables, metal structural members, aluminum window frames, and equipment cabinets must be avoided. Whip and dipole antennas require at least a 5-inch (0.1-m) minimum spacing from metal surfaces. Other types of antennas may require greater spacing. The manufacturer's recommendations should be followed when using yagis and other types of specialized antennas.

Problem Sources

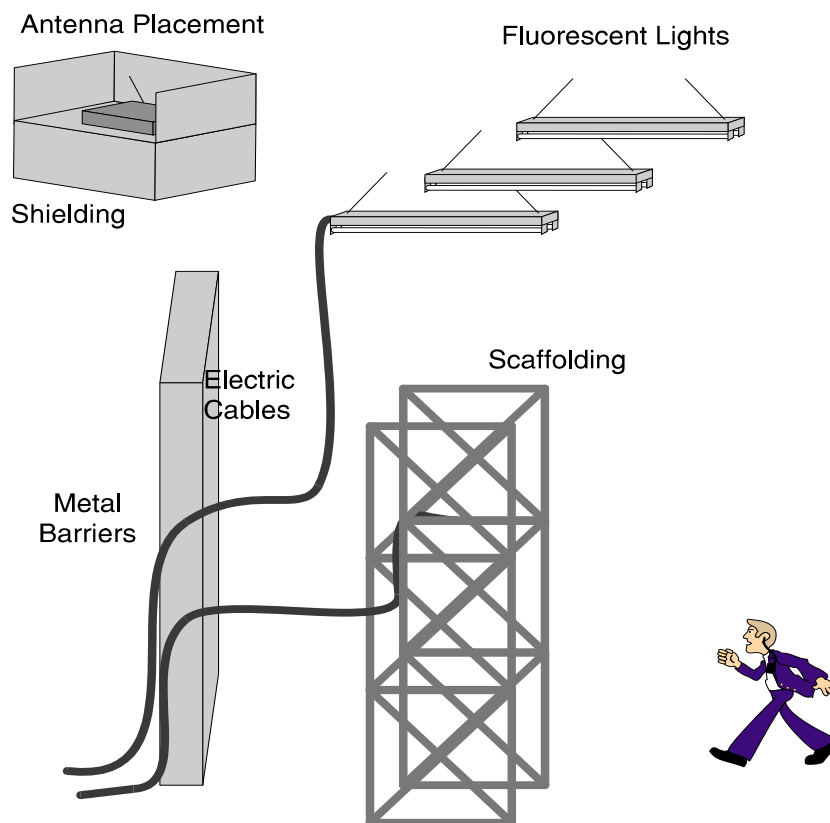

RF Noise

Problems with RF noise sources (fluorescent lights, car ignitions, industrial equipment, etc.) are quite rare. Defective fluorescent lighting fixtures, however, can generate significant amounts of RF energy. Usually, repairing the fixture will cure the problem. This situation is true for most other interference sources as well. That is, unless the equipment is electrically defective, the interference will not adversely affect Vega wireless equipment.

Warranty (Limited)

All Vega wireless products are guaranteed against malfunction due to defects in materials and workmanship for one year, beginning at the date of original purchase. If such a malfunction occurs, the product will be repaired or replaced (at our option) without charge during the one-year period, if delivered to the Vega factory. Warranty does not extend to damage due to improper repairs, finish or appearance items, malfunction due to abuse or operation under other than the specified conditions, nor to incidental or consequential damages. Some states do not allow the exclusion or limitation of incidental or consequential damages, so the above limitation might not apply to you. This warranty gives the customer specific legal rights, and there may be other rights which vary from state to state.

Vega authorized service centers enable Vega to give customers immediate service on repairs. These service centers are fully qualified and equipped to handle the servicing of Vega equipment, and turnaround time is excellent. To obtain the address of your nearest authorized warranty service center, contact your dealer or the factory.

If you should require service, pack the equipment carefully and return it to the factory service center or the nearest authorized service center.

Important: Be sure the exact return address and a description of the symptoms are enclosed inside the package with your equipment.

It is also advisable to return the transmitter and receiver for full system performance test when practical.

Factory Service Center:

Vega
9900 E. Baldwin Place
El Monte, CA91731-2294
Telephone: (626) 442-0782
Fax: (626) 444-1342
Faxback: (626) 444-2017

Claims

No liability will be accepted for damages directly or indirectly arising from the use of our materials or from any other causes. Our liability shall be expressly limited to replacement or repair of defective materials.

Specifications

Product Description: VHF audio transmitter

Frequency Control: Single frequency, crystal controlled

Frequency Stability: $\pm 0.005\%$

Operating Frequency Range: 169-216 MHz

RF Power Output: 50 mW, maximum

Modulation: Direct FM, 45K0F3E

Maximum Deviation: ± 7.5 kHz

Deviation Limiter Range: Frequency-compensated active rectifier, voltage-controlled amplifier

Balanced Audio Input (Mic/Line Mode): 3-pin female XLR; 1-ground, 2-audio +, 3-audio -

Audio Input Level Select : Rear-panel-mounted slide switch

Audio Input Level: LINE: -10 to $+20$ dBu;
MIC: -40 to -10 dBu;
70 volt: 3 to 80 volts RMS

Audio Input Adjust Range: 30 dB nominal

Audio Frequency Compensation Adjustments: Low ± 10 dB; high ± 10 dB

Audio Frequency Response: 120 Hz to 10 kHz ± 2 dB (frequency controls electrically centered)

Noise-Reduction System: Two-ended 2:1 logarithmic companding

User-Selectable Audio Processing: Hard ALC (35 dB range) or soft ALC (2:1 compensated logarithmic compressor)

User-Accessible Controls and Indicators: **Front Panel:** power on/off switch; power-on LED; audio input level adjust; VU meter (8-segment LED).

Rear Panel: audio input connector (3-pin XLR female); audio-processing switch (3-position: hard ALC, linear, soft ALC); audio input level: (2-position: mic or line); frequency compensation (two screwdriver-adjustable controls, high and low); dc power input; RF output (SO-239)

Power Required: $+12-20$ V, 5,0,0,0,0dc, 300 mA, maximum, negative ground

Power Supply Provided: Wall-mount, 12 V_{dc}, 500 mA, unregulated (120 V_{ac} standard, 240 V_{ac} optional)

Packaging: 19 in (48 cm) rack mount; 17 in (43 cm) W \times 1.72 in (4.4 cm) H \times 5.1 in (13 cm) D, excluding detachable rack-mount ears

Weight: 3.2 lb (1.5 kg), without power supply



www.vegawireless.com

9900 East Baldwin Place • El Monte, California 91731-2294

Telephone: (626) 442-0782 • Toll-Free: 800-877-1771

Fax: (626) 444-1342 • CompuServe: 73513,1417

© Vega April 2000