

ELECTRIC GUITAR

Pacifica 012

SERVICE MANUAL



WARNING : CHEMICAL CONTENT NOTICE!

The solder used in the production of this product contains LEAD. In addition, other electrical/electronic and/or plastic (Where applicable) components may also contain traces of chemicals found by the California Health and Welfare Agency (and possibly other entities) to cause cancer and/or birth defects or other reproductive harm.

DO NOT PLACE SOLDER, ELECTRICAL/ELECTRONIC OR PLASTIC COMPONENTS IN YOUR MOUTH FOR ANY REASON WHAT SO EVER!

Avoid prolonged, unprotected contact between solder and your skin! When soldering, do not inhale solder fumes or expose eyes to solder/flux vapor!

If you come in contact with solder or components located inside the enclosure of this product, wash your hands before handling food.

CONTENTS

OVERALL ASSEMBLY	2
CIRCUIT DIAGRAM	4
WIRING	4
SPECIFICATIONS	4

This document is printed on chlorine free (ECF) paper with soy ink.

OVERALL ASSEMBLY

E27 Bridge Assembly: Vintage Type (QC493900)

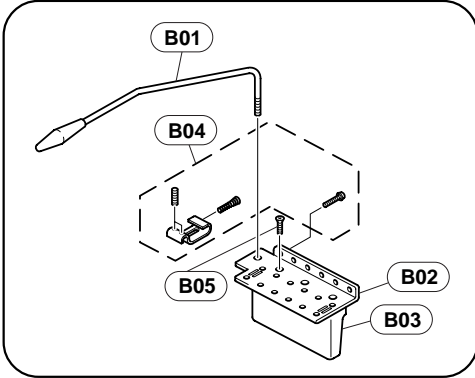

A01a

A seal is attached on the rear of the neck.

PAC 012

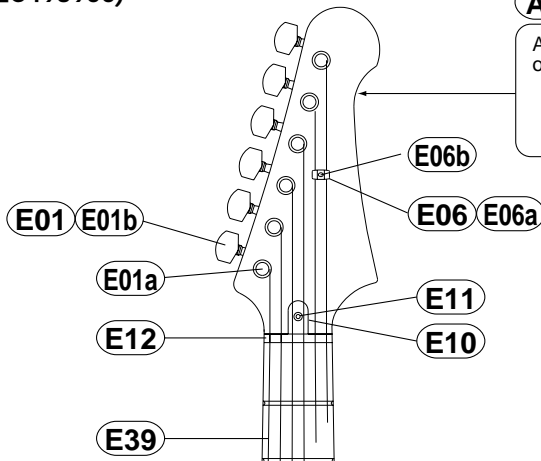

F11 Jack Installation

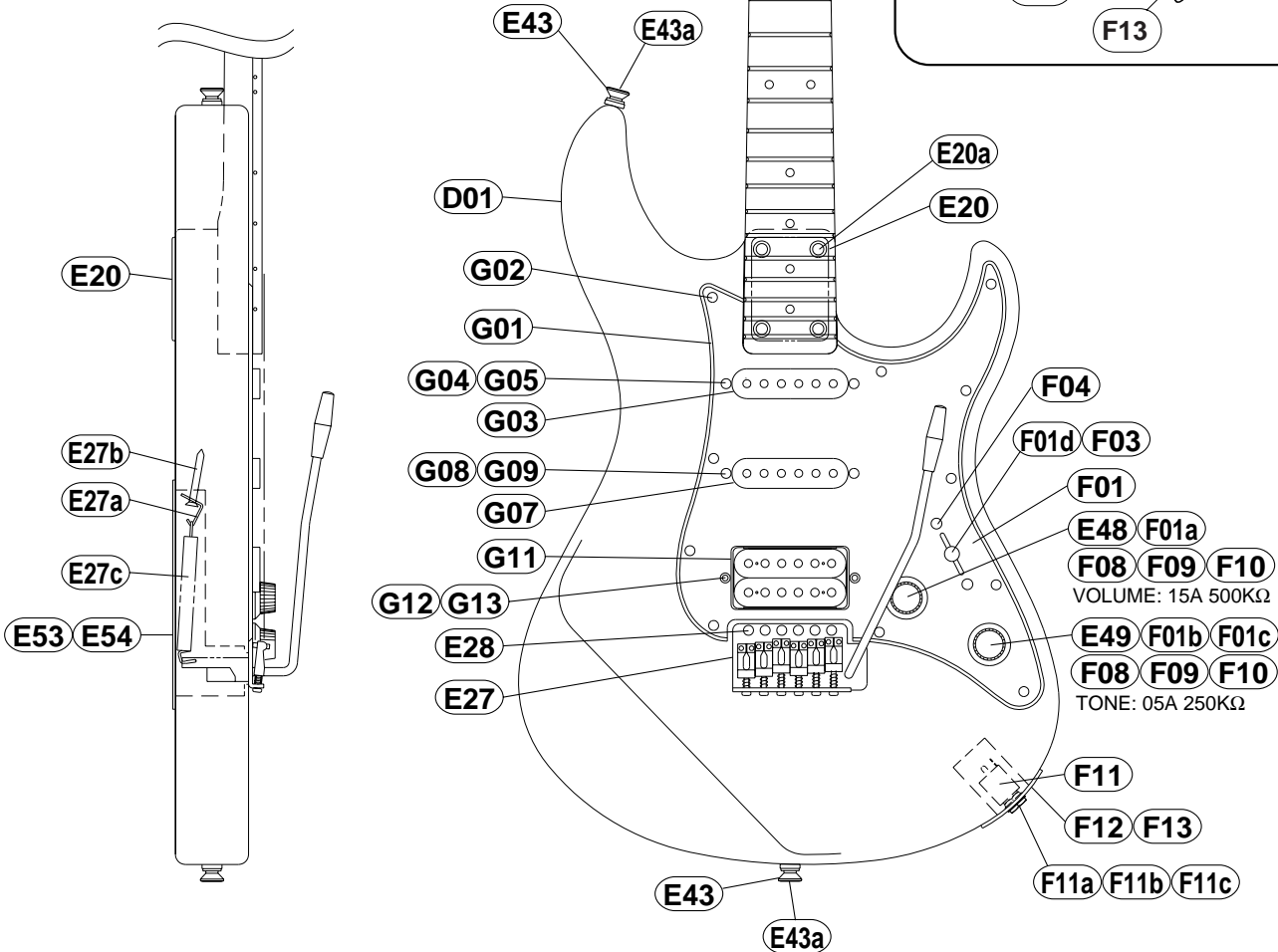
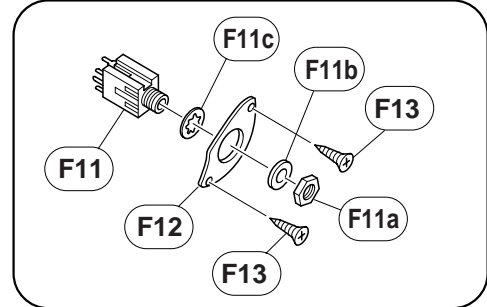

REF NO.	PART NO.	DESCRIPTION		REMARKS	QTY	RANK
		OVERALL ASSEMBLY		Pacifica 012		
* A01	AAX32330	Neck Assembly		NS		
A01a	--	Seal		(QC65750)		
D01	--	Body				
E01	QC493600	Tuning Machine Assembly	Chrome	1set		08
E01a	--	Bushing				
E01b	--	Screw	2.1X10 (Chrome)			
E06	QC493700	String Guide	VINTAGE 2092SB	Chrome		01
E06a	--	Spacer				
E06b	--	Screw	1.8X10 (Chrome)			
E10	VD955900	Rod Cover	Black			01
E11	EB620070	Oval Head Wood Screw	2.1X10 FCM3BL	Black		
E12	VB344800	Nut	Urea 41mm (Black)			04
E20	QC493800	Neck Plate	SQUARE 2022JP	Chrome		05
E20a	EN240060	Oval Head Tapping Screw	4.0X35 FNM33G	Nickel	4	01
E27	QC493900	Bridge Assembly	VINTAGE 1021ST1	Chrome		09
E27a	--	Arm Spring Plate	1010-031			
E27b	EN240060	Oval Head Tapping Screw	4.0X35 FNM33G	Nickel	2	01
E27c	--	Arm Spring	1010-033 (Nickel)		3	
E28	EQ231256	Round Head Wood Screw	3.1X25 FCM33G	Chrome	6	01
E39	--	Strings	KOREA K1060	1set (QC58310)		
E43	QC494000	Strap Button	ST-type (Chrome)		2	01
E43a	EN230140	Oval Head Tapping Screw	3.5X25 FCM33G	Chrome	2	04
E48	QC562400	Volume Knob	KPK6D2S1H-B	White		04
E49	QC562500	Tone Knob	KPK6D2S1H-A	White		04
* E53	QB822360	Back Cover	Bridge ST-type	White		
E54	03706330	Oval Head Wood Screw	2.7X13 FCM33G	Chrome	6	02
F01	--	Electrical Unit		(QC49430)		
F01a	HS120070	Variable Resistor	15A 500K ohm	VOLUME		03
F01b	HS120100	Variable Resistor	05A 250K ohm	TONE		03
F01c	QC562300	Mylar Capacitor	KELM2A473J 0.022uF			01
F01d	QC561800	Pickup Switch	5-P Lever KESL05			06
F03	QC561900	Knob	KPK7D-05 (White)	with Pickup Switch		05
F04	QC562000	Oval Head Screw	3.0X8 FNM33G (Nickel)	with Pickup Switch	2	
F08	--	Hexagonal Nut	M8 t=2	with Volume	2	
F09	--	Flat Washer	8 t=0.5	with Volume	2	
F10	--	Toothed Lock Washer	10 t=0.5	with Volume	2	
F11	QC562600	Electrical Unit (Jack)	KEJP6.3 MONO			03
F11a	LX200020	Hexagonal Nut	9S FCM33G (Chrome)			01
F11b	LX200010	Flat Washer	9S FCM33G (Chrome)			01
F11c	ET800180	Toothed Lock Washer	A9S FNM33G(Nickel)			01
F12	VB518300	Jack Panel	Black			05
F13	EB620020	Oval Head Wood Screw	2.7X13 FCM3BL	Black	2	03
G01	QC561000	Pick Guard	KPF4D-2S1H (White)			15
G02	03706330	Oval Head Wood Screw	2.7X13 FCM33G	Chrome	11	02
G03	QC561100	Pickup Assembly	S/C KEU9DE6000S	FRONT		11
G04	QC561200	Pickup Spring	5X7.5X18 A		2	
G05	QC561300	Oval Head Screw	3.0X25 FNM33G	Nickel	2	
G07	QC561400	Pickup Assembly	S/C KEU9DE6000N	CENTER		11
G08	QC561200	Pickup Spring	5X7.5X18 A		2	
G09	QC561300	Oval Head Screw	3.0X25 FNM33G	Nickel	2	
G11	QC561500	Pickup Assembly	H/B KEU9DE615WH	REAR		08
G12	QC561600	Pickup Spring	5X30 B		2	
G13	QC561700	Oval Head Screw	3.0X30 FNM33G	Nickel	2	
H01	QC354000	Accessory Unit	G-1	1set		07
	--	Cord	2.5 BK			
	--	Wrench	#1.5	(QC58320)		
	--	Wrench	#5			
	QC493900	Bridge Assembly	VINTAGE 1021ST1	Chrome		09
B01	AAX10000	Arm	Chrome (Head:WH)			05
B02	AAX10010	Bridge Base	Chrome			05
B03	AAX10020	Bridge Tail				05
B04	AAX10030	Bridge Piece Assembly	Chrome		6	04
B05	EX803070	Flat Head Screw	4.0X9 FCM33G	Chrome	3	01

*: New Parts

RANK: Japan only

■ CIRCUIT DIAGRAM

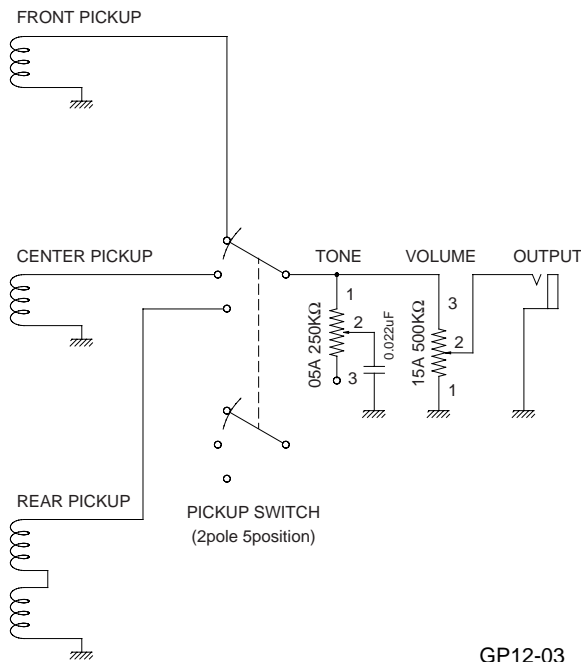

■ WIRING

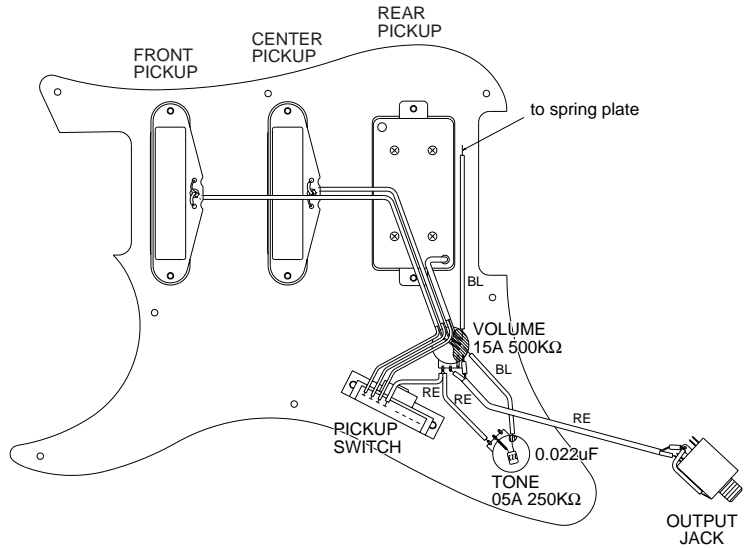

GP12-03

■ SPECIFICATIONS

● STANDARD SPECIFICATIONS

Scale Length 648.0mm
 Body-Neck Construction Bolt On
 Length 978.5mm
 Width 325.5mm
 Net Weight 3.4kg

● COLOR

Body
 BL Black
 RM Red Metallic
 DBM Dark Blue Metallic
 Neck
 NS Natural Satin

● BODY

Material Agatize
 Body Depth 44mm

● FINGERBOARD

Material Sonokeling
 Fingerboard Width 0-F 41.0 mm, 12-F 51.4 mm
 No. of Frets 22

● NECK

Material Maple
 Neck Thickness 1-F 20.9 mm, 12-F 22.9 mm

● PARTS

Hardware Chrome Plated
 Nut Urea
 Bridge Vintage Type: Chrome
 Strings Korea: K1060

● CONTROLS

Volume 15A 500KΩ x 1
 Tone 05A 250KΩ x 1
 Pickup Switch 2 pole 5 position Lever Switch

● PICKUPS

Front/Center Single Coil
 Rear Humbucking
 Magnet
 Front/Center/Rear Ceramics