

THOMSON

u s e r
m a n u a l

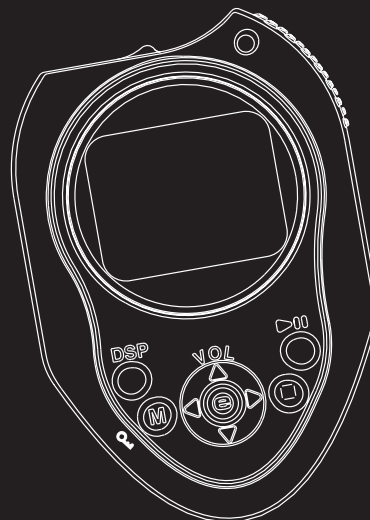

THOMSON
46, quai Alphonse Le Gallo
92648 Boulogne
Cedex FRANCE
www.thomson.net

56038440

PDP2648S
PDP2656S
PDP2662S

It is important to read this instruction book prior to using your new product for the first time.
Es importante leer este manual antes de usar por vez primera su equipo.

Safety Information

EN

IMPORTANT NOTE: To reduce the risk of fire or shock hazard, do not expose this player to rain or moisture.

CAUTION

RISK OF ELECTRIC SHOCK
DO NOT OPEN



This symbol indicates "dangerous voltage" inside the product that presents a risk of electric shock or personal injury.

ATTENTION

RISQUE DE CHOC ELECTRIQUE
NE PAS OUVRIR



This symbol indicates important instructions accompanying the product.

TO REDUCE THE RISK OF ELECTRIC SHOCK, DO NOT REMOVE THE COVER (OR BACK). NO USER-SERVICEABLE PARTS ARE INSIDE. REFER SERVICING TO THE QUALIFIED SERVICE PERSONNEL.

Safety Information

EN

Sound Pressure Control



Sound Pressure Control

Les articles de loi L44.5 et 44.6 du code de la santé publique, modifiés par l'article 2 de la loi du 28 Mai 1996 imposent une puissance acoustique maximale de 100 décibels. Le casque livré (code 55700930) et votre appareil respectent la législation en vigueur.

A pleine puissance, l'écoute prolongée du baladeur peut endommager l'oreille de l'utilisateur.

The descriptions and characteristics given in this document are given as a general indication and not as a guarantee. In order to provide the highest quality product possible, we reserve the right to make any improvement or modification without prior notice. The English version serves as the final reference on all products and operational details should any discrepancies arise in other languages.

Your THOMSON product is designed and manufactured with high quality materials and components which can be recycled and reused.

In the European Union there are separate collection systems for used electrical and electronic product.

Please, help us to conserve the environment we live in!



This symbol means that electrical and electronic equipment, at their end-of-life, should be disposed of separately from your household waste.

Please, dispose of this equipment at your local community waste collection/recycling centre.

End User License Agreement

EN

IMPORTANT-READ CAREFULLY: This End User License Agreement ("Agreement") is a legal agreement between you and Thomson Inc. ("Thomson") for the Thomson Lyra device application/driver software program and associated documentation, if any ("Program").

ACKNOWLEDGMENT

BY INSTALLING THE SOFTWARE OR CLICKING ON THE ACCEPTANCE BUTTON OF THE SOFTWARE, COPYING OR OTHERWISE USING THE PROGRAM, YOU ACKNOWLEDGE AND AGREE THAT YOU HAVE READ THIS AGREEMENT, UNDERSTAND IT, AND AGREE TO BE BOUND BY ITS TERMS AND CONDITIONS. IF YOU DO NOT AGREE TO THE TERMS OF THIS LICENSE AGREEMENT, CLICK ON THE REJECTION BUTTON AND/OR DO NOT INSTALL THE SOFTWARE AND/OR DO NOT USE THE PROGRAM.

LICENSE

a) You are granted the license (i) to use the Program on a single workstation and (ii) to make one (1) copy of the Program into any machine-readable form for backup of the Program, provided the copy contains all of the original Program's proprietary notices.

b) You may transfer the Program and license, only as part of the Thomson Lyra device, to another party if the other party agrees to accept the terms and conditions of this Agreement. If you transfer the Program, you must at the same time either transfer all copies to the same party or destroy any copies not transferred.

End User License Agreement

EN

LICENSE RESTRICTIONS

a) Except for the licenses expressly granted to you in this Agreement, no other licenses are implied.

b) You may not (i) modify, translate, reverse engineer, decompile, disassemble (except to the extent that this restriction is expressly prohibited by law) or create derivative works based upon the Program or (ii) copy the Program, except as expressly permitted herein. You agree that you shall only use the Program in a manner that complies with all applicable laws in the jurisdictions in which you use the Program, including, but not limited to, applicable restrictions concerning copyright and other intellectual property rights.

c) The Program may contain pre-release code that does not perform at the level of a final code release. In this case, the Program may not operate properly. Updated versions of the Program can be downloaded from www.thomson-lyra.com.

d) Thomson is not obligated to provide support services for the Program.

e) The Program is provided with "RESTRICTED RIGHTS". Use, duplication, or disclosure by the U.S. Government is subject to restrictions as set forth in subparagraph (c)(1)(ii) of DFARS 252.227-7013, or FAR 52.227-19, or in FAR 52.227-14 Alt. III, as applicable.

TERM AND TERMINATION

a) The license is effective on the date you accept this Agreement, and remains in effect until terminated by either party.

b) You may terminate this license without any notice or delay, by destroying or permanently erasing the Program and all copies thereof.

c) If you use, copy, modify, or transfer the Program, or any copy, in whole or part, except as expressly provided for in this license, your license is automatically terminated.

d) When the license is terminated, you must destroy or permanently erase the Program and all copies thereof.

End User License Agreement

EN

WARRANTY DISCLAIMER

THE PROGRAM IS PROVIDED "AS IS" WITHOUT WARRANTY OF ANY KIND, EITHER EXPRESSED OR IMPLIED, INCLUDING, BUT NOT LIMITED TO THE IMPLIED WARRANTIES OF MERCHANTABILITY, FITNESS FOR A PARTICULAR PURPOSE, TITLE OR NON-INFRINGEMENT. THE ENTIRE RISK AS TO THE QUALITY AND PERFORMANCE OF THE PROGRAM IS WITH YOU. SHOULD THE PROGRAM PROVE DEFECTIVE, YOU (AND NOT THOMSON, ITS SUPPLIERS, ITS AFFILIATES OR ITS DEALERS) ASSUME THE ENTIRE COST FOR ALL NECESSARY REPAIR OR CORRECTION.

This exclusion of warranty may not be allowed under some applicable laws. As a result, the above exclusion may not apply to you, and you may have other rights depending on the law that applies to you.

OWNERSHIP RIGHTS

All title and intellectual property rights in and to the Program and any copies thereof are owned by Thomson or its suppliers. All title and intellectual property rights in and to the content which may be accessed through use of the Program is the property of the respective content owner and may be protected by applicable copyright or other intellectual property laws and treaties. This license grants you no rights to use such content.

End User License Agreement

EN

LIMITATION OF LIABILITY

a) TO THE MAXIMUM EXTENT PERMITTED BY APPLICABLE LAW, IN NO EVENT SHALL THOMSON, ITS AFFILIATES, OR ITS DEALERS BE LIABLE FOR ANY SPECIAL, INCIDENTAL, INDIRECT OR CONSEQUENTIAL DAMAGES WHATSOEVER (INCLUDING, WITHOUT LIMITATION, DAMAGES FOR LOSS OF PROFITS, BUSINESS INTERRUPTION, CORRUPTION OF FILES, LOSS OF BUSINESS INFORMATION OR ANY OTHER PECUNIARY LOSS) REGARDLESS OF CAUSE OR FORM OF ACTION, INCLUDING CONTRACT, TORT OR NEGLIGENCE, ARISING OUT OF THE USE OF OR INABILITY TO USE THE PROGRAM, EVEN IF THOMSON HAS BEEN ADVISED OF THE POSSIBILITY OF SUCH DAMAGES. BECAUSE SOME STATES AND JURISDICTIONS DO NOT ALLOW THE EXCLUSION OR LIMITATION OF LIABILITY OF CONSEQUENTIAL OR INCIDENTAL DAMAGES, THE ABOVE LIMITATION MAY NOT APPLY TO YOU.

b) YOU ASSUME RESPONSIBILITY FOR THE SELECTION OF THE APPROPRIATE PROGRAM TO ACHIEVE YOUR INTENDED RESULTS, AND FOR THE INSTALLATION, USE, AND RESULTS OBTAINED.

WINDOWS MEDIA

This version of the Lyra Personal Digital Player ("Lyra Player") contains software licensed from Microsoft that enables you to play Windows Media Audio (WMA) files ("WMA Software"). The WMA Software is licensed to you for use with the RCA/THOMSON Portable Audio Device digital music player under the following conditions. By installing and using this version of the Lyra Player, you are agreeing to these conditions. IF YOU DO NOT AGREE TO THE CONDITIONS OF THIS END USER LICENSE AGREEMENT, DO NOT INSTALL OR USE THIS VERSION OF THE Lyra Player.

End User License Agreement

EN

The WMA Software is protected by copyright and other intellectual property laws. This protection also extends to documentation for the WMA Software, whether in written or electronic form.

GRANT OF LICENSE. The WMA Software is only licensed to you as follows: You may use this version of the Lyra Player containing the WMA Software only with the Portable Audio Device player.

You may not reverse engineer, decompile, or disassemble the WMA Software, except and only to the extent that such activity is expressly permitted by applicable law in spite of this limitation.

You may transfer your right to use this version of the Lyra Player only as part of a sale or transfer of your Portable Audio Device player, on the condition that the recipient agrees to the conditions in this End User License Agreement. If the version of the Lyra Player that you are transferring is an upgrade, you must also transfer all prior versions of the Lyra Player that you have which include the WMA Software.

MICROSOFT IS NOT PROVIDING ANY WARRANTY OF ANY KIND TO YOU FOR THE WMA SOFTWARE, AND MICROSOFT MAKES NO REPRESENTATION CONCERNING THE OPERABILITY OF THE WMA SOFTWARE.

The WMA Software is of U.S. origin. Any export of this version of the Lyra Player must comply with all applicable international and national laws, including the U.S. Export Administration Regulations, that apply to the WMA Software incorporated in the Lyra Player.

End User License Agreement

EN

THIRD PARTY SOFTWARE

ANY THIRD PARTY SOFTWARE THAT MAY BE PROVIDED WITH THE PROGRAM IS INCLUDED FOR USE AT YOUR OPTION. IF YOU CHOOSE TO USE SUCH THIRD PARTY SOFTWARE, THEN SUCH USE SHALL BE GOVERNED BY SUCH THIRD PARTY'S LICENSE AGREEMENT, AN ELECTRONIC COPY OF WHICH WILL BE INSTALLED IN THE APPROPRIATE FOLDER ON YOUR COMPUTER UPON INSTALLATION OF THE SOFTWARE. THOMSON IS NOT RESPONSIBLE FOR ANY THIRD PARTY'S SOFTWARE AND SHALL HAVE NO LIABILITY FOR YOUR USE OF THIRD PARTY SOFTWARE.

GOVERNING LAW

This Agreement is governed by the laws of France, without regard to its conflict of laws.

GENERAL TERMS

This Agreement can only be modified by a written agreement signed by you and Thomson, and changes from the terms and conditions of this Agreement made in any other manner will be of no effect. If any portion of this Agreement shall be held invalid, illegal, or unenforceable, the validity, legality, and enforceability of the remainder of the Agreement shall not in any way be affected or impaired thereby. This Agreement is the complete and exclusive statement of the agreement between you and Thomson, which supersedes all proposals or prior agreements, oral or written, and all other communications between you and Thomson, relating to the subject matter of this Agreement.

Table of Contents

EN

Safety Information

End User License Agreement

Table of Contents1

Before You Begin3

Unpacking Your Unit3

What's so special about this

mp3 player?3

Computer System Requirements 3

Precautions for the unit4

Caution4

Caution While Driving4

Important Battery Information . . .5

Please Respect the Environment! . .5

Headset Safety5

Inserting battery into the player . .6

Using Headphones7

How to Use Your Armband7

Connecting the Lyra Player to your

Computer8

General Controls9

Front View9

Top View10

Back View10

Display Overview11

Menu Navigation12

Main Menu12

Music Sub-menu13

Sports Sub-menu13

Menu Navigation13

Digital Music Operation14

Selecting Music Mode14

Music Playback Operation14

Play / Pause14

Skipping Tracks15

Scan Tracks15

Stop Playback15

Adjusting the Volume15

Additional Music Features16

My Selections16

Adding Songs to My Selections

Removing Songs from My

Selections16

View My Selections16

Clear My Selections16

View Music Sub-Menu17

Repeat17

Shuffle17

DSP17

Table of Contents

EN

Audible File Operation18

Audible Playback Operation . . .18

Play / Pause18

Skipping Files18

Scan Files18

Stop Playback18

Adjusting the Volume18

Sports mode19

Selecting Sports Mode19

Selecting Stopwatch Mode . . .19

Stopwatch20

Multiple Lap Timing20

Calorie Measurement21

Selecting Calorie Mode21

Selecting Pulse Rate Mode . . .21

Measuring Pulse Rate21

Measuring Calories burnt22

Personal Information22

System Settings23

Settings23

Memory Usage23

Version24

More Information24

Check for Updates24

Frequently Asked Questions . . .24

Troubleshooting Tips25

Before You Begin

EN

"Dear Thomson Customer, Thank you for purchasing the Thomson Lyra™ Digital Audio Player. This product will play open mp3 and Windows Media™ audio (WMA) content as well as content purchased from most online music download services.

After purchasing and downloading music to your PC, you are now ready to move content to your player. To transfer the music, you must use Windows Media Player or the application recommended by the online music download service.

(Note: Services and applications must be Windows Media audio-compliant and support Digital Rights Management.)"

Unpacking Your Unit

When you unpack your new player, be sure you have removed all the accessories and information papers. The items below should have been packed in the box with your player.

- Lyra player
- Music Management CD
- USB cable
- Headphones
- Belt clip
- Armband



Warning:

The armband is designed for carrying the player on upper arm only. DO NOT wear the armband on other parts of the body such as the neck to avoid choking hazard or breathing difficulty.

What's so special about this mp3 player?

This player is meant to play mp3, audible (.aa) and Windows Media™ audio files recorded in the built-in flash memory. To do so, you need the use of a Windows computer with USB port, connection cable (included) and a music management software (MusicMatch Jukebox).

Computer System Requirements

- Pentium III 500MHz or higher recommended
- Macintosh iMac G3 or higher
- Windows @98SE, Me, 2000, or XP
- Mac OS X Version 10.1.5 or higher
- Internet Explorer 4.0 or higher
- Internet access
- 100MB free hard disk space for the software
- 64MB RAM (128 MB recommended)
- CD-ROM drive capable of digital audio extraction
- USB port (2.0 recommended)
- Sound card

Before You Begin

EN



Warning:

This product is for your personal use only. Unauthorized recording or duplication of copyrighted material may infringe upon the rights of third parties and may be contrary to copyright laws.



Note

Make sure the tracks are encoded in mp3 or Windows Media formats and supported bitrates. Bitrates supported by the player: mp3 - 32 to 320kbps
wma - 48 to 192kbps

- Clean the unit with a soft cloth or a damp chamois leather. Never use solvents.
- The unit must only be opened by qualified personnel.

Caution

- Keep product out of direct sunlight. Exposure to direct sunlight or extreme heat (such as inside a parked car) may cause damage or malfunction.
- Do not expose to rain or moisture.

Caution While Driving

Use of headphones while operating an automobile or moving vehicle is not recommended and is unlawful in some states and areas. Be careful and attentive on the road. Stop operation of the unit if you find it disruptive or distracting while driving.

Precautions for the Unit

- Do not use the unit immediately after transportation from a cold place to a warm place; condensation problem may result.
- Avoid shock to the unit.
- Do not store the unit near fire, places with high temperature or in direct sunlight.
- Do not operate or store unit in places with frequent static electricity or electrical noise (e.g. speaker, TV set).

Before You Begin

EN

Important Battery Information

- When storing the unit, be sure to remove the batteries because they may leak and damage the unit.
- Batteries may leak electrolyte if inserted incorrectly, if disposed of in fire, or if an attempt is made to charge a battery not intended to be recharged.
- Never mix new batteries with old ones. Do not mix battery types.
- Discard leaky batteries immediately. Leaking batteries may cause skin burns or other personal injury.
- Do not charge batteries which are not intended to be recharged.
- Dispose of batteries, according to federal, state and local regulations.

Please Respect the Environment!



Before throwing any batteries away, consult your distributor who may be able to take them back for specific recycling.

Headset Safety

Have a Blast- Just Not in Your Eardrums



Make sure you turn down the volume on the unit before you put on headphones. Increase the volume to the desired level only after headphone are in place.

- Do not play your headset at a high volume. Hearing experts warn against extended high-volume play.
- If you experience a ringing in your ears, reduce volume or discontinue use.
- You should use extreme caution or temporarily discontinue use in potentially hazardous situations. Even if your headset is an open-air type designed to let you hear outside sounds, don't turn up the volume so high that you are unable to hear what is around you.

Before You Begin

EN

Insert battery into the player

1. To remove the battery door, use a coin to turn the screw to unlock the battery compartment.

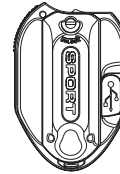

2. Lift up the battery compartment.
3. Insert a "AA"(UM3) battery with polarities corresponding to the indications on the compartment. (Refer to "Before You Begin" for important battery information.)
4. Place the battery compartment to the original position, lock the compartment with the screw.



Note

Refer to the power level indicator on display for battery level. Replace with new batteries when the indicator is empty. Refer to "Display Overview" on page 11.

Before You Begin

EN Using Headphones

Insert phone plug into the headphones jack (📶) of the player for listening.

Have a Blast- Just Not in Your Eardrums. Make sure you turn down the volume on the unit before you put on headphones. Increase the volume to the desired level only after headphones are in place.



Caution:
Do not insert ear hook into your ears.

How to Use Your Armband

1. Snap the belt clip to the back of the unit. Recommend inserting the top of the clip in first and then snapping the bottom into place.

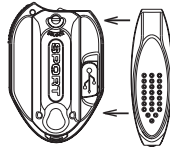

2. If using the armband, just slide the belt clip through the armband vinyl clip holder.

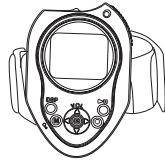

3. The unit will seem to have a lot of movement within the strap, but once it is on the arm the slack and movement will be less.

Before You Begin

Connecting the Lyra Player to your Computer

1. Lift the rubber cover that is covering the USB socket on the back of the player.
2. Insert the smaller end of the USB cable into the socket on the unit tightly.

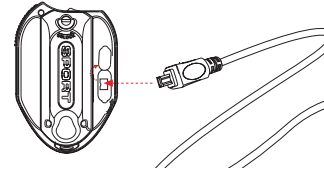

3. Insert the larger end of the USB cable to the USB socket on the back of the computer.

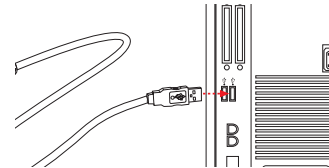

EN



Note
Refer to the "USB Driver Installation; MusicMatch Jukebox™ Software" instruction manual for procedures in setting up USB drivers and transferring files to the player.



Note
You must profile your contents on your PC or on player menu setting after file transfer in order for the new files to appear in the Navigation Menus. Refer to the "USB Driver Installation; MusicMatch Jukebox™ Software" instruction manual for profiling details.

General Controls

EN

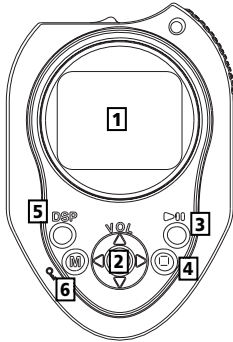

Front View

- 1. Display** - Shows user interface.
- 2. SELECT** - Enters the selected menu level. During menu navigation in music mode - Tags an unselected item to be included into the My Selections playlist. Removes a selected item from the My Selections playlist.
In stopwatch mode - Sets lap time.
- UP (▲)** - Scrolls up when navigating through the menu and moves the cursor up.
In music playback mode - Increases the volume.

- DOWN (▼)** - Scrolls down when navigating through the menu and moves the cursor down.
In music playback mode - Decreases the volume.
- LEFT (◀)** - In navigation mode - Returns to the previous menu level.
In music mode - Skips to the previous song or the beginning of the current song. Press and hold to scan backwards.
- RIGHT (▶)** - Enters the selected menu.
In music mode - Skips to the next song. Press and hold to scan forward.

- 3. ON/PLAY/PAUSE (▶||)** - Press and hold turns the unit on.
In music navigation mode - Starts music playback.
In music playback mode - pauses and resumes playback.
In stopwatch mode - Stops / Starts timer.

General Controls

EN

Back View

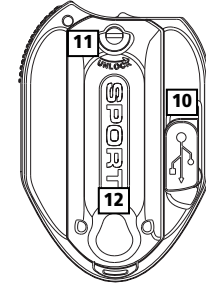

- 4. OFF/STOP (■)** - Turns the unit off. Press and hold in any mode to turn off the unit.
In music playback mode - Stops music playback.
In stopwatch mode - Resets timer.
- 5. DSP** - Changes DSP setting in music playback mode.
- 6. M / LOCK (🔒)** - Accesses the menu. Press and hold to lock and unlock the unit.

Top View

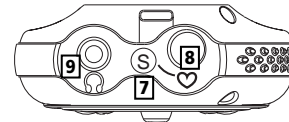

- 7. S** - Enters / exits sports mode.
- 8. Pulse rate sensor ♥** - Place your finger here for pulse rate measurement.
- 9. Headphones Jack (🎧)** - Insert the headphones plug here

- 10. USB port (🔌)** - Attach the small end of the mini-USB cable here.
- 11.** Turn the screw to unlock the battery compartment.
- 12.** Battery Compartment - Insert battery here.

General Controls

EN Display Overview

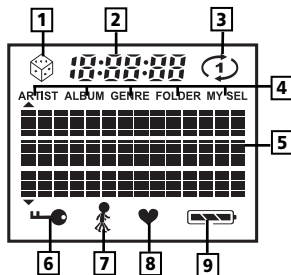

1. The shuffle icon is displayed when random playback is selected.
2. The song elapse time is displayed during music playback.
3. The repeat icon is displayed when the repeat feature is activated.
 - ⌂ - indicates repeat one song
 - ⌂ - indicates repeat all songs in the current view.
4. These icons indicate the current sorting method.
 - ARTIST
 - ALBUM
 - GENRE
 - FOLDER
 - MYSEL
5. In music mode, this section shows song information.
6. The lock icon is displayed when the key lock function is activated.
7. The stopwatch icon is displayed when stopwatch function is activated.
8. The heart icon is displayed when measuring pulse rate.
9. The battery indicator shows the battery level.
 - 🔋 - Battery is full
 - 🔋 - Battery is empty
 When the battery is almost empty, the icon blinks.

Menu Navigation

The information in this section presumes you've successfully transferred files to your Lyra Digital Audio Player, and you're ready to play some music (refer to the Software Instruction Manual).

Main Menu

Main Menu is the main menu. The navigation scheme is the same no matter how many menus you access. The main menu consists of the following items:

▶ Folders	⌂
Artists	⌂
Albums	⌂
Titles	⌂
Genres	⌂
MySel	⌂

Folders - Items in mp3, WMA and audible format are listed.

Artists - The first level lists the artist folders, the second level lists the Albums for each artist and the third level lists the songs from each artist's albums.

Albums - Items are sorted into folders according to the albums.

Titles - Items are sorted according to the song title.

Genres - Items are sorted into folders according to their genres.

MySel (My Selections playlist) - Items selected into the My Selections playlist are listed in the order in which they were added.



Note

You must profile your contents on your PC after file transfer in order for the new files to appear in the Navigation Menus. Refer to the software instruction manual for profiling details.

Menu Navigation

EN

Music Sub-menu

▶ Repeat	Off
Shuffle	Off
DSP	Flat
Clear MySel	
Profile	
Settings	▶
Mem Usage	▶
Version	▶

Sports Sub-menu

▶ Stopwatch
Calorie
Pulse Rate
Personal Info

Menu Navigation

1. To Scroll up and down the menu and move the cursor to items on screen, press **UP** (▲) or **DOWN** (▼).
2. To enter and view the submenu, press **RIGHT** (▶) or **SELECT**.
3. To go back to the previous menu level, press **LEFT** (◀).

Digital Music Operation

EN



Note

You must profile your contents on your PC after file transfer in order for the new files to appear in the Navigation Menus. Refer to the software instruction manual for profiling details.

Music Playback Operation

Use the navigation buttons to select the item to play.

Play / Pause

- Once the item that you want to play is selected, press **ON/PLAY/PAUSE** (▶||) to begin playback. This item can be an artist, an album, a playlist, or a song.
- Press again to pause playback.
- Press **ON/PLAY/PAUSE** (▶||) again to resume playback.

Selecting Music Mode

1. If the unit is in another mode, press **M / LOCK** (🔒) to view sub-menu.

▶ Go to Music Settings ▶

2. Use **UP** (▲) or **DOWN** (▼) to move the cursor to *Go to Music* for music mode and press **RIGHT** (▶) to select.

Digital Music Operation

EN Display (when music is playing)

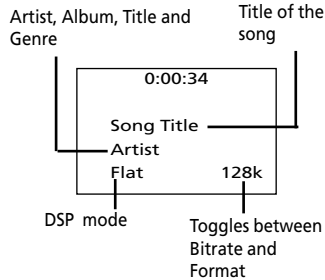

Skipping Tracks

- To go to the previous track, press and release **LEFT** (◀) within the beginning 4 seconds of the current track. Otherwise, press and release **LEFT** (◀) twice.
- To skip to the next track, press and release **RIGHT** (▶).

Scan Tracks

- To scan backwards in the track that is playing, press and hold **LEFT** (◀).
- To scan forwards in the track that is playing, press and hold **RIGHT** (▶).

Stop Playback

To stop playback, press **OFF/STOP** (■). The display returns to the previous menu level.

Adjusting the Volume

- To turn up the volume, press **UP** (▲). The volume level shows briefly to indicate the increase in volume level.
- To turn down the volume, press **DOWN** (▼). The volume level shows briefly to show the decrease in volume level.

Digital Music Operation

Additional Music Features My Selections (My Sel)

- ♪ - The song is not included in the My Selections playlist.
- ♪ - The song is included in My Selections.



Tip
You can also select a folder and add all songs inside to My Selections playlist.

Adding Songs to My Selections

- In navigation mode, use **UP** (▲), **DOWN** (▼), **LEFT** (◀) and **RIGHT** (▶) to move the cursor to the song to be added to My Selections.
- Press **SELECT** to tag it (only in navigation mode).

View My Selections

- From the main menu, use **UP** (▲) and **DOWN** (▼) to move the cursor to *MySel*.

Titles	▶
Genres	▶
MySel	▶
- Press **SELECT** to enter and view items in *MySel*.

Removing Songs from My Selections

- In navigation mode, use **UP** (▲), **DOWN** (▼), **LEFT** (◀) and **RIGHT** (▶) to move the cursor to select the song to be removed from My Selections.
- Press **SELECT** to remove it (only in navigation mode).

Clear My Selections

- In the *MySel* folder, press **M / LOCK** (Ⓜ) to view music sub-menu.
- Use **UP** (▲) and **DOWN** (▼) to move the cursor to *Clear MySel* and press **SELECT**.

Shuffle	Off
DSP	Flat
▶ Clear MySel	

Digital Music Operation

EN

View Music Sub-menu

Press **M / LOCK** (🔒) to view the music sub-menu at any time in music mode.

Repeat

1. In music mode, press **M / LOCK** (🔒) to view the music sub-menu.
2. Use **UP** (▲) and **DOWN** (▼) until the cursor is at Repeat.

▶ Repeat	Off
----------	-----

3. Press **SELECT** to toggle among repeat options.
Repeat Off (default) - Repeat is off.
Repeat One (🔄) - Repeats the current song.
Repeat All (🔄) - Repeats all the songs in the player.



Note

If Shuffle and Repeat settings are changed when a song is playing, new settings will start when the current song is finished playing.

Shuffle

1. From music sub-menu, use **UP** (▲) and **DOWN** (▼) until the cursor is at Shuffle.

▶ Shuffle	Off
DSP	Flat
Clear MySel	

2. Press **SELECT** to select between Shuffle Off (default) - Shuffle is off.
Shuffle On (🎲) - Plays songs in the player randomly.



Tip

Shuffle On / Repeat One - A song is selected randomly from the current view and is played repeatedly.
Shuffle On / Repeat All - Songs in the player are played in random order repeatedly.

DSP

1. From the music sub-menu, use **UP** (▲) and **DOWN** (▼) until the cursor is at DSP.

▶ Shuffle	Off
DSP	Flat
Clear MySel	

2. Press **SELECT** to select among Flat (default), Bass, Pop, Rock and Jazz.
3. Or you can press **DSP** to change the DSP directly (music mode only.)

Audible File Operation

EN

Audible Playback Operation

Use the navigation buttons to select the item to play.



Note

Audible files can only be selected in folder mode. (Not available in Artist, Album, Titles and Genre mode)

Play / Pause

- Once the audible file that you want to play is selected, press **ON/PLAY/PAUSE** (▶||) to begin playback.

Skipping Files

- To skip to the next file, press and release **RIGHT** (▶).
- To go to the previous file, press and release **LEFT** (◀).

For multisection files, pause the unit before following the above steps. Otherwise, the unit will skip to next/previous section only.

Scan Files

- To scan backwards in the file that is playing, press and hold **LEFT** (◀).
- To scan forwards in the file that is playing, press and hold **RIGHT** (▶).

Stop Playback

To stop playback, press **OFF/STOP** (■). The display returns to the previous menu level.

Adjusting the Volume

- To turn up the volume, press **UP** (▲). The volume level shows briefly to indicate the increase in volume level.
- To turn down the volume, press **DOWN** (▼). The volume level shows briefly to show the decrease in volume level.



Note

This unit only supports audible files in format 2, 3 and 4.

Sports mode

EN

Selecting Sports Mode

1. In any mode, press **S** to enter sports mode directly.



Tip

Entering sports mode will not affect normal music playback.

Selecting Stopwatch mode

1. In sports mode, use **UP** (▲) and **DOWN** (▼) to move the cursor to *Stopwatch*.

```
▶ Stopwatch
  Calorie
  Pulse Rate
```

2. Press **SELECT** to enter stopwatch mode.

Sports mode

EN

Stopwatch

In stopwatch mode,

- Press **ON/PLAY/PAUSE** (▶||) to start timer.
- Press **ON/PLAY/PAUSE** (▶||) again to stop timer.

```
Stopwatch
0:03:00.00
```

- When the timer is stopped, press **ON/PLAY/PAUSE** (▶||) to resume.
- When timer is stopped, press **OFF/STOP** (■) again to reset timer.

Multiple Lap Timing

In stopwatch mode, when the timer is running, press **SELECT** to set a lap time.

```
0:05:00.00
Lp1 0:05:00.00
```

When the second lap time is set, the unit will display the lap difference on the display for 2 seconds.

```
0:12:00.00
Lp2 0:07:00.00
+ 0:02:00.00
```

After 2 seconds, the average lap time will be displayed.

```
0:12:00.00
Lp2 0:07:00.00
Avg 0:06:00.00
```

Press **ON/PLAY/PAUSE** (▶||) again to stop timer, you can review all the lap times after pressing **OFF/STOP** (■). Press **OFF/STOP** (■) again to clear all lap times and reset the timer.



Tip

You can take a maximum of 9 lap times.

Sports mode

EN Selecting Pulse Rate Mode

1. In sports mode, use **UP** (▲) and **DOWN** (▼) to move the cursor to **Pulse Rate**.

Stopwatch
Calorie
▶ Pulse Rate

2. Press **SELECT** to enter pulse rate mode.



Attention

This device is a novelty item not meant to be a piece of medical equipment and it is to be used solely as an approximate calculation to aid in the monitoring of one's general health parameters during exercise. You should consult with your doctor before starting any exercise program.



Note

- Place your finger on the sensor gently, applying too much pressure to the sensor may lead to measurement error or inaccuracy.
- Do not move your finger when measuring pulse rate.
- Do not take measurements while moving
- Do not measure if finger is dirty or oily
- Do not expose the sensor directly to sunlight during measurement.

Measuring Pulse Rate

1. Follow the above instructions to enter pulse rate mode, the unit will ask you to place finger on the pulse rate sensor.

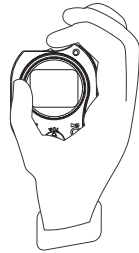

2. Slightly place your finger on the sensor, the heart icon will blink at the same rate as your pulse rate, pulse rate will be displayed after the measurement is finished.

Pulse Rate
72 bpm



Tip

During pulse rate measurement, normal music playback will not be affected.

Sports mode

Personal Information

1. In sports mode, use **UP** (▲) and **DOWN** (▼) to move the cursor to **Personal Info**.

▶ Personal Info

2. Press **SELECT** to enter personal information mode.
3. Use **UP** (▲) and **DOWN** (▼) to move the cursor to age or weight.

▶ Age 20y
Weight 170lb

4. Press **SELECT** or **RIGHT** (▶) to change the highlighted item, use **UP** (▲), **DOWN** (▼), **LEFT** (◀) and **RIGHT** (▶) to adjust, then press **SELECT** again to save.

▶ Age 20y
Weight 170lb



Note

- The calorie calculation will not take place if the second pulse rate measured is below or equal to 104bpm.
- You have to input the personal information (age and weight) prior to activating the calorie feature.

Selecting Calorie Mode

1. In sports mode, use **UP** (▲) and **DOWN** (▼) to move the cursor to **Calorie**.

Stopwatch
▶ Calorie
Pulse Rate

2. Press **SELECT** to enter calorie mode.

Calorie Measurement

The calorie burnt calculation is based on the following parameters.

- Age
- Weight
- Current Pulse Rate
- Pulse Rate at previous measurement

Measuring Calories Burnt

1. Before doing exercise, follow the above instructions to enter calorie mode, the unit will ask you to place finger on the pulse rate sensor.

Calorie
Place finger
on sensor



2. Place your finger on the sensor, the heart icon would blink at the same rate as your pulse rate, pulse rate will be displayed after the measurement is finished.

Calorie
Measuring 1st
Pulse Rate



3. After finishing the exercise, measure the pulse rate again, then the current pulse rate and calories burnt during exercise will be displayed.

Calories Burnt
1200 kcal



System Settings

EN

Settings

1. In any mode, press **M / LOCK** (Ⓜ) to view music sub-menu.
2. Use **UP** (▲) or **DOWN** (▼) to move the cursor to *Settings*.

```
Profile
▶ Settings
Mem Usage
```

3. Press **RIGHT** (▶) or **SELECT** to enter the *Settings* menu.

```
Contrast      0
▶ Backlight   10S
Powersave    3m
```

4. Use **UP** (▲) or **DOWN** (▼) to move the cursor to the setting you want to change.
5. Press **RIGHT** (▶) or **SELECT** to select among options for each setting.
Contrast : -5, -4, -3, -2, -1, 0, 1, 2, 3, 4, 5
Backlight : 10s, 20s, 30s, on
Powersave : 1m, 3m, 5m, Off
Language : Engl, Fran, Deut, Espa, Ital
Unit : English, Metric

Memory Usage

Memory Usage (Mem Usage) shows the amount of free space on the memory.

1. Press **MENU M / LOCK** (Ⓜ) to view music sub-menu.
2. Use **UP** (▲) or **DOWN** (▼) to move the cursor to *Mem Usage* (Memory Usage).

```
Profile
Settings
▶ Mem Usage
```

3. Press **RIGHT** (▶) or **SELECT** to view memory usage information.

```
Free / Total
167M / 246M
```

System Settings

Version

1. Press **M / LOCK** (Ⓜ) to view music sub-menu.
2. Use **UP** (▲) or **DOWN** (▼) to move the cursor to *Version*.

```
Mem Usage
▶ Version
```

3. Press **RIGHT** (▶) or **SELECT** to view firmware version.

```
Version 0.10
```

EN

More Information

Check for Updates

Visit <http://www.thomson-lyra.com> for the latest news and firmware upgrades for our Lyra Digital Audio Player. You must update your system after new downloads have been made in order for the new applications to be executed.

Frequently Asked Questions

You can get FAQ information at <http://www.thomson-lyra.com>.

More Information

EN

Troubleshooting Tips

The player does not turn on when the PLAY button is pressed?

- Batteries may be inserted incorrectly.
- Batteries may be empty.

Skipping tracks or bad sound quality?

- Repeat, random or program function may be activated.
- There may be strong magnetic fields (e.g. too close to TV) near the unit.
- Low Battery level. Replace with new ones.

Cannot perform playback?

- LOCK function may be activated.
- There may be no mp3 tracks in the internal memory.

USB display does not appear when connected to computer?

- Check connection between your unit and the computer. (Refer to the "USB Driver Installation; MusicMatch Jukebox™ Software" instruction manual)
- Check if the USB drivers are properly installed (Refer to the "USB Driver Installation; MusicMatch Jukebox™ Software" instruction manual)

The player does not respond to key operations?

- Turn the player off by removing the batteries. Reinsert the batteries properly and turn the player on again to resume normal operations.



Note:

For better result, we recommend a constant encoded bit rate from 32 to 320kbps for mp3 and 48kbps to 192kbps for Windows Media Audio. Nevertheless, your unit may play tracks encoded in variable bit rate (VBR).

More Information

EN

Cannot playback tracks on the player.

- Make sure audio tracks are encoded in the mp3 or Windows Media formats at supported bitrates. Bitrates support by the player:
mp3 – 32 to 320 kbps
wma – 48 to 192 kbps
- WMA files may be DRM protected and you don't have the proper rights (license) to play the files.
- Check the website and/or application help system of the music download service provider from where the content was purchased from for license acquisition details. For more information on how license acquisition works, go to www.microsoft.com/windowsmedia/drm.



Note:

Under some rare circumstances, your unit might report less memory than is available for storing music files. If this happens, format the device to recover all the memory.



Note:

This unit may temporarily cease to function if subjected to electrostatic disturbance. To resume normal operation, it may be necessary to remove and reinstall the batteries. If the unit is connected to the computer via USB cable, disconnect and reconnect of the USB cable is required.



Warning:

Formatting the device will erase all stored contents. Backup all the valuable files before doing so.

More Information

EN



HELPLINE THOMSON

Votre Contact THOMSON : 0 826 820 456
(pour la France 0,15 € / mn)

Ihr Kontakt zu THOMSON: 0180 1000 390, ab 16.10.2000.
(für Deutschland, Kosten zum Ortstarif)

You can contact THOMSON by dialling: 0871 712 1312
(For Great-Britain, all calls will be charged 0,10£ / mn)

Para contactar con THOMSON marque: 901 900 410, a partir del 16.10.2000
(las llamadas serán cargadas al precio de la tarifa local)

Il vostro contatto THOMSON: 8488 10 168, dal 16.10.2000
(tariffa chiamata urbana)

www.thomson-europe.com

THOMSON

u s e r
m a n u a l

PDP2648S

PDP2656S

PDP2662S

Software Installation
MusicMatch Jukebox™ Software
(mp3, Windows Media™ Audio)

Installation des software
Logiciel MusicMatch Jukebox™
(mp3, Windows Media™ Audio)

Instalación de logiciel
Software MusicMatch Jukebox™
(mp3, Reproductor de Audio
para Windows Media™)

THOMSON
46, quai Alphonse Le Gallo
92648 Boulogne
Cedex FRANCE
www.thomson.net

56038410

It is important to read this instruction book prior to using your new product for the first time.
Es importante leer este manual antes de usar por vez primera su equipo.

End User License Agreement

EN

IMPORTANT-READ CAREFULLY: This End User License Agreement ("Agreement") is a legal agreement between you and Thomson Inc. ("Thomson") for the Thomson Lyra device application/driver software program and associated documentation, if any ("Program").

ACKNOWLEDGMENT

BY INSTALLING THE SOFTWARE OR CLICKING ON THE ACCEPTANCE BUTTON OF THE SOFTWARE, COPYING OR OTHERWISE USING THE PROGRAM, YOU ACKNOWLEDGE AND AGREE THAT YOU HAVE READ THIS AGREEMENT, UNDERSTAND IT, AND AGREE TO BE BOUND BY ITS TERMS AND CONDITIONS. IF YOU DO NOT AGREE TO THE TERMS OF THIS LICENSE AGREEMENT, CLICK ON THE REJECTION BUTTON AND/OR DO NOT INSTALL THE SOFTWARE AND/OR DO NOT USE THE PROGRAM.

LICENSE

a) You are granted the license (i) to use the Program on a single workstation and (ii) to make one (1) copy of the Program into any machine-readable form for backup of the Program, provided the copy contains all of the original Program's proprietary notices.

b) You may transfer the Program and license, only as part of the Thomson Lyra device, to another party if the other party agrees to accept the terms and conditions of this Agreement. If you transfer the Program, you must at the same time either transfer all copies to the same party or destroy any copies not transferred.

End User License Agreement

EN

LICENSE RESTRICTIONS

a) Except for the licenses expressly granted to you in this Agreement, no other licenses are implied.

b) You may not (i) modify, translate, reverse engineer, decompile, disassemble (except to the extent that this restriction is expressly prohibited by law) or create derivative works based upon the Program or (ii) copy the Program, except as expressly permitted herein. You agree that you shall only use the Program in a manner that complies with all applicable laws in the jurisdictions in which you use the Program, including, but not limited to, applicable restrictions concerning copyright and other intellectual property rights.

c) The Program may contain pre-release code that does not perform at the level of a final code release. In this case, the Program may not operate properly. Updated versions of the Program can be downloaded from www.thomson-lyra.com.

d) Thomson is not obligated to provide support services for the Program.

e) The Program is provided with "RESTRICTED RIGHTS". Use, duplication, or disclosure by the U.S. Government is subject to restrictions as set forth in subparagraph (c)(1)(ii) of DFARS 252.227-7013, or FAR 52.227-19, or in FAR 52.227-14 Alt. III, as applicable.

TERM AND TERMINATION

a) The license is effective on the date you accept this Agreement, and remains in effect until terminated by either party.

b) You may terminate this license without any notice or delay, by destroying or permanently erasing the Program and all copies thereof.

c) If you use, copy, modify, or transfer the Program, or any copy, in whole or part, except as expressly provided for in this license, your license is automatically terminated.

d) When the license is terminated, you must destroy or permanently erase the Program and all copies thereof.

End User License Agreement

EN

WARRANTY DISCLAIMER

THE PROGRAM IS PROVIDED "AS IS" WITHOUT WARRANTY OF ANY KIND, EITHER EXPRESSED OR IMPLIED, INCLUDING, BUT NOT LIMITED TO THE IMPLIED WARRANTIES OF MERCHANTABILITY, FITNESS FOR A PARTICULAR PURPOSE, TITLE OR NON-INFRINGEMENT. THE ENTIRE RISK AS TO THE QUALITY AND PERFORMANCE OF THE PROGRAM IS WITH YOU. SHOULD THE PROGRAM PROVE DEFECTIVE, YOU (AND NOT THOMSON, ITS SUPPLIERS, ITS AFFILIATES OR ITS DEALERS) ASSUME THE ENTIRE COST FOR ALL NECESSARY REPAIR OR CORRECTION.

This exclusion of warranty may not be allowed under some applicable laws. As a result, the above exclusion may not apply to you, and you may have other rights depending on the law that applies to you.

OWNERSHIP RIGHTS

All title and intellectual property rights in and to the Program and any copies thereof are owned by Thomson or its suppliers. All title and intellectual property rights in and to the content which may be accessed through use of the Program is the property of the respective content owner and may be protected by applicable copyright or other intellectual property laws and treaties. This license grants you no rights to use such content.

End User License Agreement

EN

LIMITATION OF LIABILITY

a) TO THE MAXIMUM EXTENT PERMITTED BY APPLICABLE LAW, IN NO EVENT SHALL THOMSON, ITS AFFILIATES, OR ITS DEALERS BE LIABLE FOR ANY SPECIAL, INCIDENTAL, INDIRECT OR CONSEQUENTIAL DAMAGES WHATSOEVER (INCLUDING, WITHOUT LIMITATION, DAMAGES FOR LOSS OF PROFITS, BUSINESS INTERRUPTION, CORRUPTION OF FILES, LOSS OF BUSINESS INFORMATION OR ANY OTHER PECUNIARY LOSS) REGARDLESS OF CAUSE OR FORM OF ACTION, INCLUDING CONTRACT, TORT OR NEGLIGENCE, ARISING OUT OF THE USE OF OR INABILITY TO USE THE PROGRAM, EVEN IF THOMSON HAS BEEN ADVISED OF THE POSSIBILITY OF SUCH DAMAGES. BECAUSE SOME STATES AND JURISDICTIONS DO NOT ALLOW THE EXCLUSION OR LIMITATION OF LIABILITY OF CONSEQUENTIAL OR INCIDENTAL DAMAGES, THE ABOVE LIMITATION MAY NOT APPLY TO YOU.

b) YOU ASSUME RESPONSIBILITY FOR THE SELECTION OF THE APPROPRIATE PROGRAM TO ACHIEVE YOUR INTENDED RESULTS, AND FOR THE INSTALLATION, USE, AND RESULTS OBTAINED.

WINDOWS MEDIA

This version of the Lyra Personal Digital Player ("Lyra Player") contains software licensed from Microsoft that enables you to play Windows Media Audio (WMA) files ("WMA Software"). The WMA Software is licensed to you for use with the RCA/THOMSON Portable Audio Device digital music player under the following conditions. By installing and using this version of the Lyra Player, you are agreeing to these conditions. IF YOU DO NOT AGREE TO THE CONDITIONS OF THIS END USER LICENSE AGREEMENT, DO NOT INSTALL OR USE THIS VERSION OF THE Lyra Player.

End User License Agreement

EN

The WMA Software is protected by copyright and other intellectual property laws. This protection also extends to documentation for the WMA Software, whether in written or electronic form.

GRANT OF LICENSE. The WMA Software is only licensed to you as follows: You may use this version of the Lyra Player containing the WMA Software only with the Portable Audio Device player.

You may not reverse engineer, decompile, or disassemble the WMA Software, except and only to the extent that such activity is expressly permitted by applicable law in spite of this limitation.

You may transfer your right to use this version of the Lyra Player only as part of a sale or transfer of your Portable Audio Device player, on the condition that the recipient agrees to the conditions in this End User License Agreement. If the version of the Lyra Player that you are transferring is an upgrade, you must also transfer all prior versions of the Lyra Player that you have which include the WMA Software.

MICROSOFT IS NOT PROVIDING ANY WARRANTY OF ANY KIND TO YOU FOR THE WMA SOFTWARE, AND MICROSOFT MAKES NO REPRESENTATION CONCERNING THE OPERABILITY OF THE WMA SOFTWARE.

The WMA Software is of U.S. origin. Any export of this version of the Lyra Player must comply with all applicable international and national laws, including the U.S. Export Administration Regulations, that apply to the WMA Software incorporated in the Lyra Player.

End User License Agreement

EN

THIRD PARTY SOFTWARE

ANY THIRD PARTY SOFTWARE THAT MAY BE PROVIDED WITH THE PROGRAM IS INCLUDED FOR USE AT YOUR OPTION. IF YOU CHOOSE TO USE SUCH THIRD PARTY SOFTWARE, THEN SUCH USE SHALL BE GOVERNED BY SUCH THIRD PARTY'S LICENSE AGREEMENT, AN ELECTRONIC COPY OF WHICH WILL BE INSTALLED IN THE APPROPRIATE FOLDER ON YOUR COMPUTER UPON INSTALLATION OF THE SOFTWARE. THOMSON IS NOT RESPONSIBLE FOR ANY THIRD PARTY'S SOFTWARE AND SHALL HAVE NO LIABILITY FOR YOUR USE OF THIRD PARTY SOFTWARE.

GOVERNING LAW

This Agreement is governed by the laws of France, without regard to its conflict of laws.

GENERAL TERMS

This Agreement can only be modified by a written agreement signed by you and Thomson, and changes from the terms and conditions of this Agreement made in any other manner will be of no effect. If any portion of this Agreement shall be held invalid, illegal, or unenforceable, the validity, legality, and enforceability of the remainder of the Agreement shall not in any way be affected or impaired thereby. This Agreement is the complete and exclusive statement of the agreement between you and Thomson, which supersedes all proposals or prior agreements, oral or written, and all other communications between you and Thomson, relating to the subject matter of this Agreement.

Table of Contents

EN

End User License Agreement

Table of Contents

Before You Begin1

Computer System Requirements . . .1
What's so special about this mp3 player?2

Getting Started3

Insert the Included CD-ROM into CD-ROM Drive3
Welcome Screen3
Purchased Location3
Install the USB Driver (Windows 98SE Only)4
Install Necessary Software4
End User License Agreement . . .5
Install MusicMatch Jukebox . . .5
Install Additional Services6
Audible Welcome6
Rebooting the Computer6
Installation Completed6
Launch the MusicMatch Software . .7

Transferring Music7

Connecting the Player to the Computer7
Transferring Files to the Lyra Digital Audio Player8
Transfer Files via MusicMatch Jukebox9
Transfer Files via Windows Explorer (Drag and Drop)10
Disconnecting Your Lyra from the Computer11

File Management12

System Tray Applications12
Profile12

Troubleshooting Tips13

The descriptions and characteristics given in this document are given as a general indication and not as a guarantee. In order to provide the highest quality product possible, we reserve the right to make any improvement or modification without prior notice. The English version serves as the final reference on all products and operational details should any discrepancies arise in other languages.

Before You Begin

EN

Dear Thomson Customer,
Thank you for purchasing the Thomson Lyra™ Digital Audio Player. This product will play open mp3 and Windows Media™ audio (WMA) content as well as content purchased from most online music download services.

After purchasing and downloading music to your PC, you are now ready to move content to your player. To transfer the music, you must use Windows Media Player or the application recommended by the online music download service.

(Note: Services and applications must be Windows Media audio-compliant and support Digital Rights Management.)



Warning:

Use of this product is for your personal use only. Unauthorized recording or duplication of copyrighted material may infringe upon the rights of third parties and may be contrary to copyright laws.

Computer System Requirements

- Pentium III 500MHz or higher recommended
- Macintosh iMac G3 or higher
- Windows® 98SE, Me, 2000, or XP
- Mac OS X Version 10.1.5 or higher
- Internet Explorer 4.0 or higher
- Internet access
- 100MB free hard disk space for the software
- 64MB RAM (128 MB recommended)
- CD-ROM drive capable of digital audio extraction
- USB port (2.0 recommended)
- Sound card



Note

Make sure the tracks are encoded in mp3 or Windows Media formats and supported bitrates. Bitrates supported by the player:
mp3 - 32 to 320 kbps
wma - 48 to 192 kbps

Before You Begin

EN What's so special about this mp3 player?

This player is meant to play mp3, audible and Windows Media™ audio files encoded on a memory card or recorded in the built-in flash memory. To do so, you need the use of a Windows computer with USB port, connection cable (included) and a music management software (MusicMatch Jukebox).

The Music Management CD that comes with your Lyra Digital Audio Player contains all of the necessary software components you need to make your Lyra Digital Audio Player work properly.

These components do the following:

- install USB driver for Windows 98SE users. (Refer to page 4)
- enable you to transfer files from your computer to your Lyra Digital Audio Player.

- profile the player (Refer to page 12).
- use the MusicMatch Jukebox software to organize your music collection and transfer the music to your Lyra Digital Audio Player.

The MusicMatch Jukebox™ software compresses audio files (from music CDs) to the mp3, mp3PRO or Windows Media Audio (WMA) format so you can play them on your Lyra Digital Audio Player. The MusicMatch software also enables you to download files from the internet that are already compressed and then transfer those files to your Lyra player (or play the music on your computer).

Getting Started

Insert the Included CD-ROM into CD-ROM Drive

Turn on your computer and place the Music Management CD that came with your Lyra Digital Audio Player into your computer.



Note

Don't connect the USB cable to the PC or Lyra Digital Audio Player before or during the driver installation.



Note

- If you're running Windows ME/2000/XP no additional drivers are required.
- If you're running Windows 98SE, you must install the USB drivers from the CD-ROM in order for the Lyra Digital Audio Player to function properly.

Welcome Screen

If the setup screen does not appear, double click *My Computer*, double click your CD-ROM drive icon, and double click *Install* to run the installer.



Getting Started

EN Preferred Language

Select your preferred language, then click *Next* to continue.



Install the USB Driver (Windows 98SE Only)

For Windows 98SE systems, you need to install a USB driver before your computer can recognize your Lyra player. It will be installed automatically by following steps on the next page.



Note

The installation program will detect whether your system requires a USB driver. The program will install the USB driver first, restart the computer, and then begin to install the necessary software.

Getting Started

Install Necessary Software

Click *Install*, and follow the on-screen instructions to install all necessary files.



End User License Agreement

Please read the End User License Agreement carefully, you can quit the installation anytime if you do not agree with it.

Click *Accept* to continue installation.



Install MusicMatch Jukebox

MusicMatch Jukebox is a music management software used to organize and manage digital audio files and can be used to transfer the music to your Lyra Digital Audio Player.

1. Click *Install* to run the MusicMatch setup program.



Wait while the installation program begins. It may take up to 20 seconds for the installer to start.

2. Follow the on-screen instructions to setup and install MusicMatch Jukebox.

For more information on MusicMatch Jukebox, click *Tutorials* on the CD or go to www.musicmatch.com.



Note

It is recommended to uninstall any previous installations of the MusicMatch Jukebox software before proceeding. After the uninstall process has been completed, delete the MusicMatch folder found under *C:\Program Files*.

EN

Getting Started

EN

Audible welcome

Click for additional information about Audible.



Note

You must register with Audible to download the Audible Manager software. Please make sure to read the terms of use before registering.

Install Additional Services

Click for additional digital music services provided by our partners.



Rebooting the computer

You may need to restart your computer for software to run properly.



Installation completed

Installation is completed! You can go to the manufacturer's website for more information.



Getting Started

EN

Launch the MusicMatch software

The MusicMatch software converts audio files to the mp3, mp3PRO and WMA formats so you can play them on your Lyra Digital Audio Player.

1. Remove the Music Management CD from your computer.

2. Start the MusicMatch Jukebox software (double click on the MusicMatch icon in your system tray or on your desktop).



The MusicMatch icon found in your computer's system tray.

Transferring Music

Connecting the Player to the Computer

Connect the Lyra Digital Audio Player to your computer with the USB cable provided.

Turn on the unit, the Lyra Digital Audio Player will appear as a Removable Disk drive.

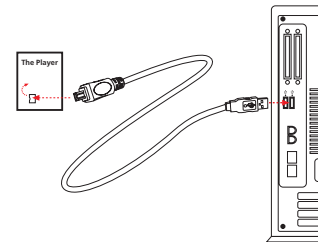

Note

It might take several seconds for the device (the Lyra Digital Audio Player) to be detected, especially in Windows 2000/XP. Click Refresh in My Computer or Explorer to make sure the device has been detected.

Transferring Music

EN



Note

The Lyra Digital Audio Player is capable of transferring files at full-speed mode of USB 2.0. This is up to 40 times faster than USB 1.1. If USB 2.0 port is available on your computer, use it to connect to your Lyra Digital Audio Player. The Lyra player is still backward compatible with the older USB 1.1 ports. However, you will not be able to take full advantage of the potential speed increase.

Transferring Files to the Lyra Digital Audio Player

You can transfer files to your Lyra Digital Audio Player via MusicMatch Jukebox or via Windows Explorer.

If your Lyra Digital Audio Player isn't already connected to your computer, connect it to the computer using the provided USB cable as illustrated on the previous page.



Attention

Do not disconnect the USB cable during music download. Doing so may corrupt system files or the files being downloaded.



Note

Secure music download

files must be transferred to your Lyra player through Windows Media Player or the application recommended (e.g. MusicMatch Jukebox) by the online music download service. Please visit the online music download service's website where you purchased your content from for more details on transferring secure music to your player.

For more information on Windows Media Player, visit <http://www.microsoft.com/windows/windowsmedia>.

Transferring Music

EN



Note

Some wma files may be DRM protected. You must acquire licenses for DRM protected wma files before they can be played on the Lyra player. For more information, go to www.microsoft.com/windows/windowsmedia/drm

3. Click on *Options* and select your portable device under *Select Device*. Click *OK*.
Your device should be listed under *Portable Device*.
4. Select the playlist item and drag it to the active device listed under *Portable Device*. Only those playlists saved in step 1 are displayed on the playlist window.
The songs in the playlist will now be automatically transferred to your Lyra Digital Audio Player.

Transfer Files via MusicMatch Jukebox

1. Drag and drop desired tracks from the Music Library to the Playlist display and save the playlist.



Note

Be sure to save the playlist or it will not be displayed on the playlist window of the Portable Device Manager screen.

2. From the menu area, select *Files/Send to Portable Device* or click *Send to Portable* under the *copy* item on the left side of the MusicMatch Jukebox screen to display the Portable Device Manager screen.

During transfer a progress indicator appears in the *Portable Device Manager* screen, and "USB Transferring" flashes in the Lyra player's LCD.

Transferring Music

EN



Attention

Make sure all data are transferred to the Lyra

Digital Audio Player before unplugging the USB cable.



Note

If you're running Windows 2000 you must stop the device before unplugging it. Click the icon (the *Unplug or Eject hardware* icon) from the system tray and select the USB Mass Storage device for the drive letter associated with the Lyra player, and select the device you want to stop. See the Windows Help for details about the Unplug or Eject Hardware topic.

From Windows Explorer, highlight all the files/folders you want to transfer to your Lyra Digital Audio Player and drag them to the drive letter that is associated with it.



Note

You must profile your contents after file transfer in order for the new files to appear in the Navigation Menu. Refer to page 12 for profiling details.

Transfer Files via Windows Explorer (Drag and Drop)

If your Lyra Digital Audio Player isn't already connected to your computer, connect the Lyra Digital Audio Player to the computer using the provided USB cable as illustrated on page 7 and turn on the unit.

Transferring Music

EN

Disconnecting Your Lyra from the Computer



Note

Before disconnecting the USB cable from the computer or the Lyra Digital Audio Player, be sure the "Safe to unplug" message is displayed.

The *Stop a Hardware device* screen appears. Select the device to be stopped again for confirmation and click **OK**.



You can also stop your Lyra player by right clicking on the  icon from the system tray and selecting the drive corresponding to your player.

From the System Tray, double click the left mouse button on the icon and select *Unplug or eject hardware*. The *Unplug or Eject Hardware* screen appears. Select the drive corresponding to your Lyra player.



File Management

EN System Tray Applications Profile

New files that are transferred to your Lyra Digital Audio Player using Windows Explorer (drag and drop) will not appear in the Navigation Menus until you profile the contents.

1. Connect your Lyra Digital Audio Player to the computer using the provided USB cable if it is not already connected.
2. Right click on the Lyra icon  in the System tray (bottom right hand corner of the computer screen).



3. Select the *Profile Device Content...* item to start the profiling and sorting contents.

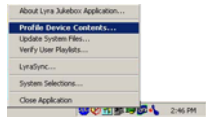

4. Click *Done* when profiling is complete.



Attention

Make sure all data are transferred to the Lyra Digital Audio Player before unplugging the USB cable.

If you're running Windows 2000 you must stop the device before unplugging it. Click the icon (the *Unplug or Eject hardware* icon) from the system tray and select the USB Mass Storage device for the drive letter associated with the Lyra Digital Audio Player, and select the device you want to stop. See the *Windows Help* for details about the *Unplug or Eject Hardware* topic.

Troubleshooting Tips

EN

Problem	Checkpoints / Action
After connecting the player to computer, "USB connected" does not appear on the display.	<ul style="list-style-type: none"> • Press ON button to power on the player after connecting to the computer.
Cannot access the player via Windows 2000 computer.	<ul style="list-style-type: none"> • Install the Service Pack 3 for Windows 2000. Visit www.windowsupdate.microsoft.com to check for the latest updates.
Cannot playback tracks on the player.	<ul style="list-style-type: none"> • Make sure audio tracks are encoded in the mp3 or Windows Media formats at supported bitrates. Bitrates support by the player: mp3 – 32 to 320 kbps wma – 48 to 192 kbps • WMA files may be DRM protected and you don't have the proper rights (license) to play the files. <p>Check the website and/or application help system of the music download service provider from where the content was purchased from for license acquisition details.</p> <p>For more information on how license acquisition works, go to www.microsoft.com/windowsmedia/drm</p>
What does the PlaysForSure logo mean?	<p>PlaysForSure is a new logo program from Microsoft®. Consumers can match the PlaysForSure logo on a large selection of devices and online music stores. If you see the logo, you'll know your digital media will play for sure.</p> <p>For more information on the Microsoft PlaysForSure program, visit www.PlaysForSure.com.</p> <p>For more information on RCA PlaysForSure devices, visit www.rca.com.</p>