

Digital Audio Player
SA101

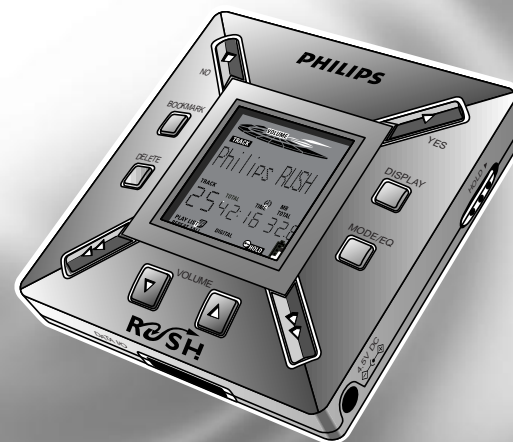

Toll Free Help Line
Ligne d'assistance au service libre
Línea de ayuda telefónica sin cargo
800-531-0039



Let's make things better.



PHILIPS

SAFETY

Know these **safety** symbols



This “bolt of lightning” indicates uninsulated material within your unit may cause an electrical shock. For the safety of everyone in your household, please do not remove the product covering.



The “exclamation point” calls attention to features for which you should read the enclosed literature closely to prevent operating and maintenance problems.

WARNING: To prevent fire or shock hazard, do not expose this equipment to rain or moisture.

CAUTION: To prevent electric shock, match the wide blade of the plug to a wide slot, and fully insert.

INFORMATION

For details on warranty registration or the Player, visit the Philips web site:

www.rush.philips.com

For questions about RealJukebox and its features, visit:

www.real.com

Record your Player’s model and serial numbers here. The serial number is located inside the battery compartment, and the model number is on the back of the Player.

Model number: _____

Serial number: _____

IN CANADA

English: This digital apparatus does not exceed the Class B limits for noise emissions from digital apparatus as set out in the Radio Interference Regulations of the Canadian Department of Communications.

Français: Cet appareil numérique n’émet pas de bruits radioélectriques dépassant les limites applicables aux appareils numériques de Classe B prescrites dans le Règlement sur le Brouillage Radioélectrique édicté par le Ministère des Communications du Canada.

IMPORTANT SAFETY INSTRUCTIONS - Please read before operating equipment.

This product was designed and manufactured to meet strict quality and safety standards. There are, however, some installation and operation precautions which you should be particularly aware of.

- 1. Read these instructions.** Read all the safety and operating instructions before operating the appliance.
- 2. Keep these instructions.** Retain the safety and operating instructions for future reference.
- 3. Heed all warnings.** Adhere to all warnings on the appliance and in the operating instructions.
- 4. Follow all instructions.** All operating and use instructions should be followed.
- 5. Do not use this apparatus near water** – for example, near a bathtub, washbowl, kitchen sink, or laundry tub, in a wet basement, near a swimming pool, etc.
- 6. Clean only with a damp cloth.** The appliance should be cleaned only as recommended by the manufacturer.
- 7. Install in accordance with the manufacturer's instructions. Do not block any of the ventilation openings.** For example, the appliance should not be situated on a bed, sofa, rug, or similar surface or placed in a built-in installation, such as a bookcase or cabinet that may impede the flow of air through the ventilation openings.
- 8. Do not install near any heat sources** such as radiators, heat registers, stoves, or other apparatus (including amplifiers) that produce heat.
- 9. Only use attachments/accessories** specified by the manufacturer.
- 10. Refer all servicing to qualified service personnel.** Servicing is required when the apparatus has been damaged in any way, such as the power-supply cord or plug has been damaged; liquid has been spilled or objects have fallen into the apparatus; or the apparatus has been exposed to rain or moisture, does not operate normally, or has been dropped.

TABLE OF CONTENTS

Safety	3-4	RealJukebox Features	18-20
Table of Contents	5	Playing Music	21
General Information	6	Adjusting Volume and Sound	22
Maintenance	7	Putting Buttons on Hold	23
Batteries	7	Display	24
Power Adapter	8	Selecting Tracks/Searching	25
Controls	9-10	Repeating and Shuffling Tracks	26
Connecting RUSH to your Computer	11	Bookmarks	27
Installing RealJukebox	12	Clearing Tracks	28
Recording Formats (Encoding Options) ...	13	Carrying Pouch	29
Using RealJukebox	14	Smart Help	30-31
SmartMedia Card	15	Limited Warranty	32-33
Preventing Card Erasure and Overwriting .	16	Index	34
RealJukebox On-line Tutorial	17		

Windows is a registered trademark of Microsoft Corporation.

Pentium is a registered trademark of Intel Corporation.

RealJukebox is a registered trademark of RealNetworks Corporation. **Audible** and **AudibleReady** are registered trademarks of Audible, Inc. All rights reserved. All trade names referenced are the service mark, trademark or registered trademarks of their respective manufacturers.

The Player complies with the Federal Communications Commission Rules, Part 15. Operation is subject to the following two conditions:

1. This device may not cause harmful interference, and
2. This device must accept any interference received, including interference that may cause undesired operation.

GENERAL INFORMATION

RUSH is a solid-state, portable, digital audio player.

It can:

- play MP3 format files that you get from the Internet, and
- play digitized and compressed CD tracks, tape tracks, audio books, newspapers, sound effects, etc., that are encoded into MP3 format using RealJukebox.

Because the Player is fully electronic with no moving parts and lasers, you can play music while you are moving without missing the quality.

SUPPLIED ACCESSORIES

Make sure you received all these items. If an item is missing, please contact your dealer.

- one parallel cable
- one power adapter
- one blue SmartMedia card
- one protective rubber seal for the DATA I/O jack
- one SmartMedia card holder with label and chrome stickers
- one RUSH installation CD-ROM
- one set of in-ear headphones
- one carrying pouch
- two AAA, R03 or UM4 alkaline batteries

COMPUTER REQUIREMENTS

- Windows 95 or 98; Internet Explorer 3.01 or above; Netscape 4.0 or above; and Internet access
- Intel® Pentium® 200 MHz
- 64 MB internal memory (recommended)
- Free on the personal computer (PC): 15 MB for the RealJukebox software, plus 1 MB for every minute of music you store on the PC
- CD-ROM drive
- Parallel port with ECP/EPP mode
- 16 bit sound card
- 256 color video card

HEADPHONE USE

Listen at a moderate volume. Using headphones at high volume can impair your hearing. Do not use headphones while driving or cycling.

COPYRIGHT INFORMATION

Unauthorized duplication and distribution of Internet/CD recordings violate copyright law and international treaties. You should use the MP3 software only for personal purposes.

MAINTENANCE

- Do not expose the Player, batteries, or SmartMedia cards to strong magnetic fields, humidity, rain, sand, or excessive heat caused by heating equipment or direct sunlight.
- Do not drop the Player or allow objects to fall on the Player.
- Do not allow the Player to contact water. Dry the surface of the Player if it becomes wet. Water entering the Player may cause major damage.
- To clean the Player, use a soft, slightly dampened chamois leather. Do not use any cleaning agents containing alcohol, ammonia, benzene, or abrasives as these may harm the Player.

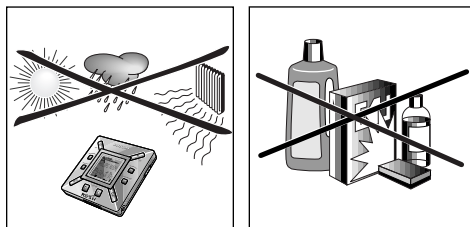



BATTERIES

BATTERIES

1. Remove the battery compartment lid and insert two AAA batteries (preferably alkaline) as indicated by the + and – symbols inside the battery compartment.
2. Replace the battery compartment lid.
Powered  will appear very briefly on the display.

INDICATION OF EMPTY BATTERIES

The number of blocks inside the battery symbol  indicates the power level.

- When the power is almost empty, the symbol  starts to flash. Replace the batteries or change to AC power. *Details are on page eight.*
- **Battery Low** appears on the display if you ignore the flashing battery symbol. The Player will shut off automatically.



Smart Help

- Remove the batteries if they are dead or if the Player will not be used for more than two weeks.
- Batteries contain chemical substances, so dispose of them properly.
- Remove the batteries from the Player when you use the AC adapter.

POWER ADAPTER

BEGIN

- 1 Make sure your local voltage matches the **4.5V** voltage of the adapter.
- 2 Remove the batteries from the Player.
- 3 Connect the adapter to the Player's 4.5V DC jack and to an AC power outlet.
Powered  will appear briefly on the display (if there are no batteries in the Player).
- 4 Always disconnect the adapter from the AC power outlet if you are not using it.

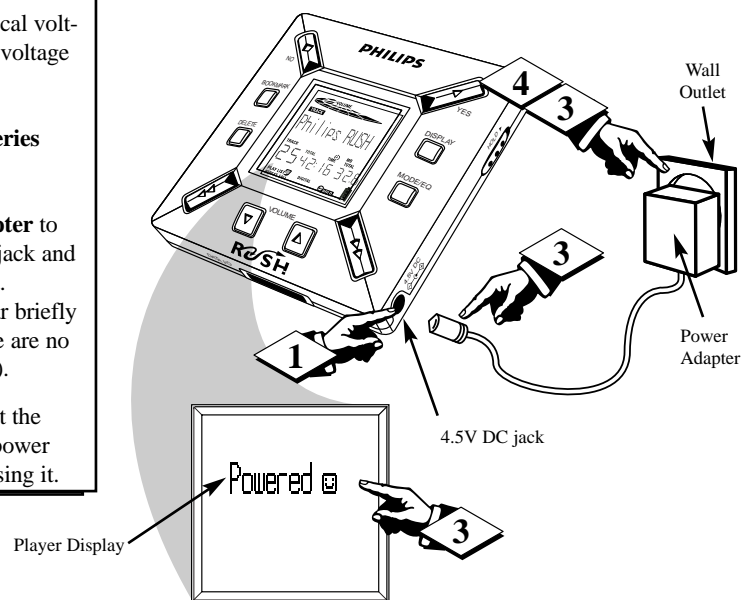

CONTROLS

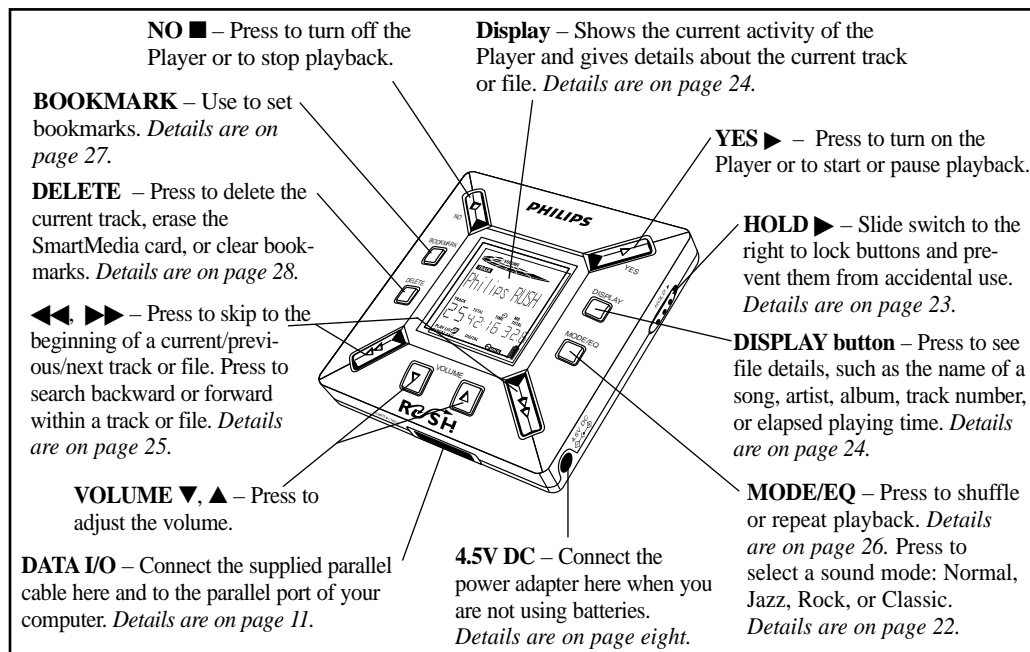

CONTROLS, CONTINUED



General Info

We have reduced the packaging to its minimum and made it easy to separate into two materials: cardboard (box) and polyethylene (bags).

Your Player consists of materials which can be recycled if disassembled by a specialized company. Please observe the local regulations to dispose of packing materials, dead batteries and old equipment.

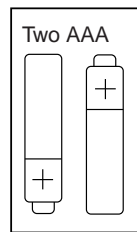

Battery Compartment – Install two AAA, R03, or UM4 batteries here.

 – 3.5 mm stereo headphone jack

SmartMedia Card

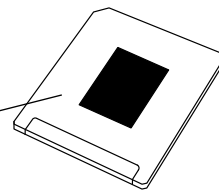

CARD EJECT – Push the switch toward the SmartMedia card to eject the card. Make sure the Player is off.

CARD INSERT – Insert the SmartMedia card here. Make sure the Player is off.

CONNECTING RUSH TO YOUR COMPUTER

BEGIN

- 1 Press NO ■ to turn off the Player. Make sure the computer is off.
- 2 If a printer cable is connected to the parallel port on your computer, disconnect the printer cable.
- 3 Connect the supplied parallel cable to the computer's parallel port. Remove the protective rubber seal from the DATA I/O jack on the Player, then connect the small end of the cable to the DATA I/O jack.
- 4 Press YES ► to turn on the Player.
- 5 Press the POWER button on the computer to turn on your computer.

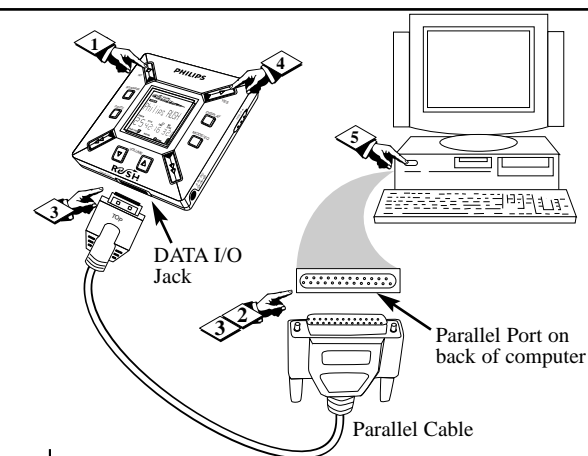

Smart Help

- Make sure the top of the parallel cable (marked TOP) is facing up when you connect the cable to the DATA I/O jack.
- Keep the protective rubber seal in place on the DATA I/O jack when not in use.

INSTALLING REALJUKEBOX

Install the RealJukebox software to manage your playlist on your PC. RealJukebox lets you:

- *Record CD tracks onto your PC or send the CD songs to RUSH for portable playback.*
- *Index your songs according to artist, album, or genre.*
- *Download music from the Internet.*

BEGIN

1 RealJukebox works in ECP (Extended Capability Port or Printer Port) mode. To make sure your computer is in ECP mode, select My Computer → Control panel → System → Device Manager → Ports. **Select ECP at Ports.**

2 Insert the RealJukebox CD into your computer's CD-ROM drive. The setup screen will appear on your monitor.

3 Follow the on-screen directions to install the RealJukebox software. Refer to page 13 when setting the Encoding Options.

More details about RealJukebox are on pages 13-14 and 17-20.

IF YOU ARE NOT IN ECP MODE:

- Restart your computer.
- Refer to your computer instruction manual, or contact the dealer to enter BIOS setup.
- Select ECP as the parallel port mode.

IF YOUR COMPUTER DOES NOT SUPPORT ECP MODE:

- Refer to your computer instruction manual, or contact the dealer to select EPP (Enhanced Parallel Port) or bi-directional mode.



Smart Help

- Connect to the Internet while using RealJukebox to use all the features.
- If any other media player is listed as the default device for your computer, the RealJukebox player will not function properly until that device is disabled.
- ECP provides high performance, bi-directional communication between a host adapter and a peripheral.

RECORDING FORMATS (ENCODING OPTIONS)

RUSH plays files recorded in MP3, Wave Audio, or RealAudio format. Before recording, select a format and a Secure Files setting.

BEGIN

1 While installing RealJukebox (details are on page 12), select **Encoding Options**.

2 The following formats will be available.

Select your format.

- **MP3** (MPEG layer 3 Audio) compression levels are 96, 64, and 56 Kbps stereo, using the supplied RealJukebox software. If you upgrade your software, RUSH can play music with compression levels up to 224 Kbps.
- **RealAudio** (from RealNetworks) saves your music as RealAudio (.rmx) secure or RealAudio unsecured (.rmj) files. Compression levels are 96, 64, and 44 Kbps stereo and 32 Kbps monaural.
- **Wave Audio** is unencoded, uncompressed music. It has the best sound but uses the most disk space, as much as 650 megabytes per CD.
- **Secure Files On:** Files can only be played on the PC on which they were recorded.
- **Secure Files Off:** The files can be played on more than one PC.



Note

- A higher Kbps number means better sound quality. However, as the Kbps number increases, so does the amount of disk space used.
- For the best recording results, activate **Use Error Correction**. From the main RealJukebox menu, select Options, then choose Preferences, then Recording Options. Select Use Error Correction, then click OK.

USING REALJUKEBOX

Play the broadest range of digital music. Listen to music while you record.

Download and install new plug-ins and updates. Go to the on-line tutorial,

Download a CD track or artist and album information.

Access the Philips SmartConnect web site.

Put your CD collection on your PC. Record CDs at high speed.

Create and save Playlists. Sort and manage songs and CDs by genre, artist, album, song title, etc.

Find and download music, including MP3 songs, from the Internet.

Drag and drop music from RealJukebox to **RUSH!**



The screenshot shows the RealJukebox application window. The title bar reads 'RealJukebox for Philips SmartConnect'. The interface includes a menu bar (File, Edit, View, Controls, Settings, Help), a toolbar with icons for file operations and playback, and a main content area. On the left is a sidebar with icons for 'Library', 'SmartConnect', and 'Get Music'. The main area is divided into a 'Library' pane on the left showing a tree view of music collections (Artist, Genre, Album, Songs, All Tracks, Playlists, Portable Players/Storage) and a 'Track Names' pane on the right displaying a list of tracks with columns for 'Track Name', 'Artist', and 'Album'. The track list includes entries like 'Software (Rush)', 'Midnight Cocktail', 'Vivid Awe', 'Setting the Stage', 'Circles', 'Spring Break', 'Circles For Your Thoughts', 'Bliss', 'In My Palm', and 'Weak'.

SMARTMEDIA CARD

You can store up to an hour of music on the card, erasing and overwriting as much as you want.

BEGIN

- 1 Press **NO** ■ to turn off the Player before inserting or removing the card.
- 2 Insert a **SmartMedia Card** into **CARD INSERT** with the clipped corner of the card aligned as shown on the Player.
- 3 To remove the card, **slide the CARD EJECT switch** toward the card and remove the card.



Smart Help

These messages may appear on the display.

- **Blank 32 Mb** means your card is blank.
- **Card details** appears if the card contains files.
- **Wrong Card** appears if the format is incompatible with the Player.
- **No Audio Tr** means the track is not an audio track or your card is blank.

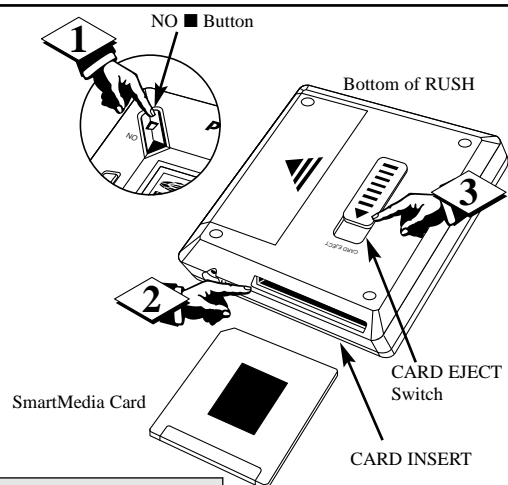

PREVENTING CARD ERASURE AND OVERWRITING

BEGIN

- 1 To prevent accidental erasure or overwriting of your card, **place a chrome sticker (supplied) over the circle on the front of the card.**
- 2 If you later decide to erase or overwrite your card, remove the chrome sticker first. *Details are on page 28.*

Write Protect may appear on the display if you forget to remove the chrome sticker and try to delete tracks or erase your card.

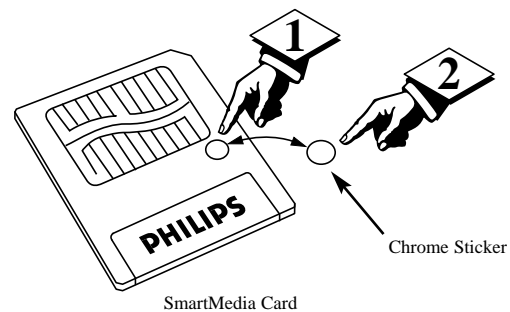

Note

- Use only the Philips blue SmartMedia cards for your Player. Do not use SmartMedia cards from a digital camera or computer.
- After a SmartMedia card has been formatted for MP3 files, the card will not be recognized by your PC or digital camera.
- Chrome stickers are supplied with the SmartMedia card.

REALJUKEBOX ON-LINE TUTORIAL

The RealJukebox on-line tutorial is a helpful resource when you want more information on RealJukebox features. To get to this information, follow the steps below. Read the tutorial before using and recording files.

BEGIN

- 1 Use your Internet browser to go to:
www.real.com
- 2 At the www.real.com site, select
RealJukebox.
- 3 Select **RealJukebox Central**, usually
located at the bottom of the page.
- 4 Choose **Using RealJukebox**.
- 5 At **Using RealJukebox**, select the information you want to study, including **Quick Start**, **Advanced Features**, or **Service & Support**.



Smart Help

You also may go to the on-line tutorial by selecting **Help** in RealJukebox.

REALJUKEBOX FEATURES

MAKING MP3 FILES FROM A CD

BEGIN

- 1 Double-click to select the **RealJukebox** symbol on your PC.
- 2 Insert an audio CD in the CD-ROM drive. CD track details will appear on the screen. (Make sure you have selected **record/play CD** at the left of the RealJukebox screen.)
- 3 Select the track you want to record in MP3.
- 4 From **Controls** in the RealJukebox toolbar, choose **Record**. The recording status will appear on the screen. When recording is complete, the track will be stored in the **Music Library** of RealJukebox on your PC.
Note: If you choose Record without choosing a track, the entire audio CD will be recorded. RealJukebox will record the entire audio CD within the same time it takes to play the first few tracks, depending on the total amount of tracks. You can stop recording at anytime by selecting **Stop**.

SENDING FILES TO RUSH FROM YOUR PC

BEGIN

- 1 Before connecting the RUSH Player to your computer, insert batteries or connect the power adapter. *Details are on pages seven, eight, and 11.* Make sure a SmartMedia card is in the Player.
- 2 Press **YES** ► to turn on the RUSH Player.
- 3 Double-click the RealJukebox symbol to select RealJukebox on your PC.
- 4 Single click the plus symbol ⊕ beside **Portable Players/Storage** to access **Philips RUSH → Flash Card** details.
- 5 To transfer an MP3 file to RUSH, click on the file and drag it from the **Music Library** to the Flash Card detail listed under **Portable Players/Storage → Philips Rush**.
- 6 Click **Flash Card**, then **Begin Transfer** (at the bottom of the screen) to copy the tracks to the RUSH SmartMedia card. The status of the transfer will show on the screen.

REALJUKEBOX FEATURES, CONTINUED

ORGANIZING THE LIBRARY

You can organize the **Master Library** into three groupings: **Artist**, **Album** or **Genre**.

Enter the **Master Library** from the Options menu: (**Options**)
→**Preferences** →**Music Library**
→**Master Library**. Your Master Library can be organized in several ways, allowing you to select the way you want to group your music.



Note

To personalize your groupings while you are in RealJukebox, right click on the track that you want to rename. A menu will appear. Select **rename**, then rename the information as you wish.

CREATING A PLAYLIST

Create a playlist for playback on your computer or to download to RUSH.

BEGIN

- 1 Click **New Playlist** at the bottom of the screen.
- 2 **Type in a name for your playlist. Click OK** to add that name to the playlist at the left of your screen.
- 3 **Select the music from your master library** that you want to put in the playlist.
- 4 **Drag and drop the desired songs to your playlist. Click the file name to review** the list that you have created.

REALJUKEBOX FEATURES, CONTINUED

DOWNLOADING MUSIC FROM THE INTERNET

BEGIN

- 1 With access to the Internet on your PC, click **get music** in RealJukebox. RealJukebox will connect you to the Internet.
- 2 Select your music and download it to your library and playlist. Follow the steps on the site; different sites may vary.



Note

For MP3 news and files, try these web sites:

Emusic <http://www.emusic.com>
Audible Inc. <http://www.audible.com>
AudioExplosion, Inc. <http://www.audioexplosion.com>
AudioHighway.com <http://www.audiohighway.com>
Big Heavy World <http://www.bigheavyworld.com>
MP3.com <http://www.mp3.com>
SINC Recordings <http://www.sincrecordings.com>
Songs.com <http://www.songs.com>

Some sites may charge you for the music that you download. Carefully review the information provided by the site.

PLAYING MUSIC

BEGIN

- 1 Press YES ► to turn on the Player. **Philips RUSH** will appear on the display, then playback will begin. (If the Player is already on, press YES ► to start playback.) If no card is inserted, **Insert Card** will appear.
- 2 Press YES ► briefly to pause playback. To resume playback, press YES ► again. (Press NO ■ once to stop playback.)
- 3 Press NO ■ twice to turn off the Player during playback. If playback is stopped, press NO ■ once to turn off the Player.

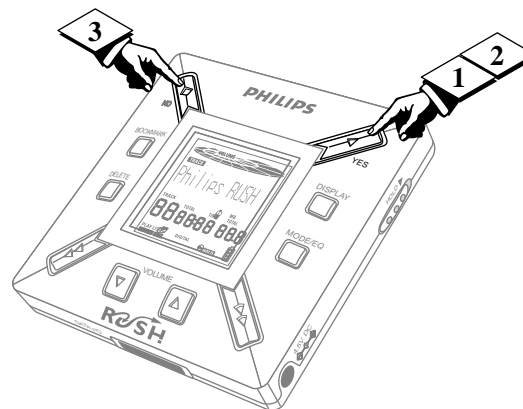

Smart Help

Track playback will resume at the point at which it was last stopped, even if you turn off the Player.

ADJUSTING VOLUME AND SOUND

BEGIN

- 1** Press and hold **VOLUME ▼** or **▲** to decrease or increase the volume. The volume bar will appear on the display.
- 2** Press and hold **MODE/EQ** for two seconds until you see one of the sound modes: Normal, Jazz, Rock, or Classic.
- 3** Press **MODE/EQ** briefly and repeatedly until your preferred sound mode appears on the display. The setting will be saved, even if the Player is turned off.

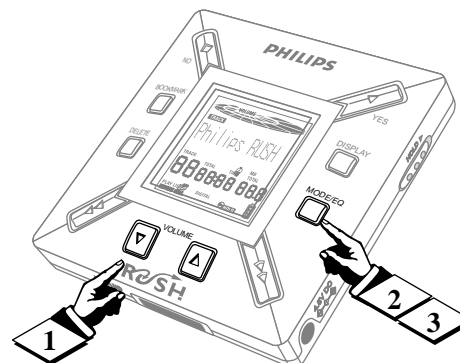

PUTTING BUTTONS ON HOLD

HOLD prevents the Player's buttons from operating accidentally.

BEGIN

1 Press the **HOLD ►** switch to the right as indicated to lock the buttons. When HOLD is activated, **HOLD** will appear on the display and the buttons will not function. If you try to turn the Player on or off when HOLD is active, **Hold Switch** will appear on the display.

2 To use the buttons again, cancel HOLD by **sliding the HOLD ► switch** to the left.

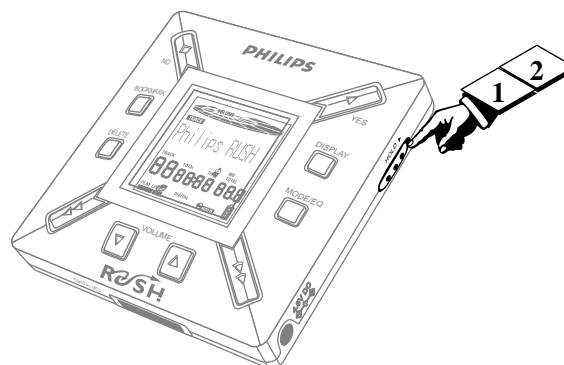

DISPLAY

BEGIN

- 1 Press the **DISPLAY** button repeatedly to see information about the items stored on the SmartMedia card.
- 2 Press **YES** ► to have your chosen detail remain on the screen. Otherwise, the display will return to the first choice listed within four seconds.
- 3 If you want to see the details under **Option?**
 - Press **YES** ► while the display shows **Option?**
 - Press the **DISPLAY** button briefly and repeatedly until you see your option.

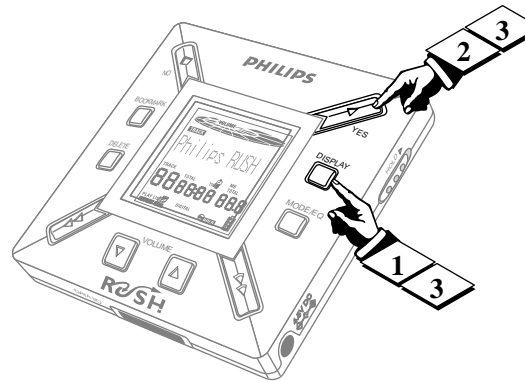

General Info

Display information includes: TRACK song title; ARTIST name, if entered, or No Artist Info; ALBUM title, if entered, or No Album Info; CARD title, if entered, or No Card Info; FILE name; TRACK TIME, including Remained Time (remaining playing time of current track) and Total Time (total playing time of file); and Option?, including technical details such as Free Memory, Total Memory, Sampling Frq. (Frequency) and Compression rate. *Additional details are on page 19.*

SELECTING TRACKS/SEARCHING

BEGIN

- 1 Press ◀◀ or ▶▶ once or repeatedly until the desired track number appears on the display.
- 2 To search within a track, **press and hold** ◀◀ or ▶▶. Watch the track time on the display; when the desired point is reached, release the ◀◀ or ▶▶ button.

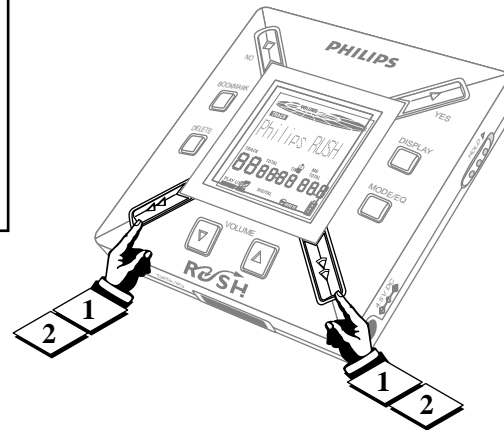

REPEATING AND SHUFFLING TRACKS

BEGIN

- 1** Press the **MODE /EQ** button briefly and repeatedly to select:
REPEAT 1 – repeats current track;
REPEAT ALL – repeats all tracks;
or **SHUFFLE** – plays tracks in random order. Your selection will appear on the display in the bottom left corner.
- 2** To return to normal playback, press the **MODE/EQ** button repeatedly until the display is clear.

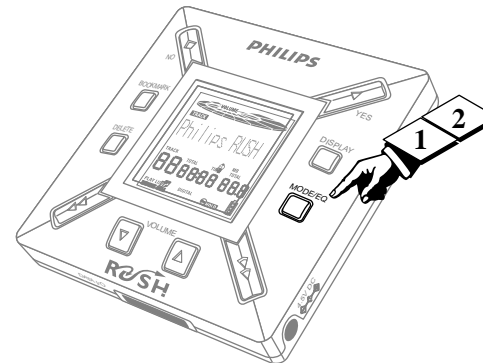

BOOKMARKS

BOOKMARK allows you to start playback instantly at a selected point within a file/track. You can set up to 10 bookmarks.

BEGIN

- 1** When the desired point is reached during playback, **press and hold BOOKMARK** for more than two seconds. **Mark Set** appears on the display.
- 2** Repeat step 1 to set other bookmarks.
- 3** To start playback from a bookmark, **press BOOKMARK** quickly and repeatedly until you see the desired bookmark on the display. Playback will begin automatically.

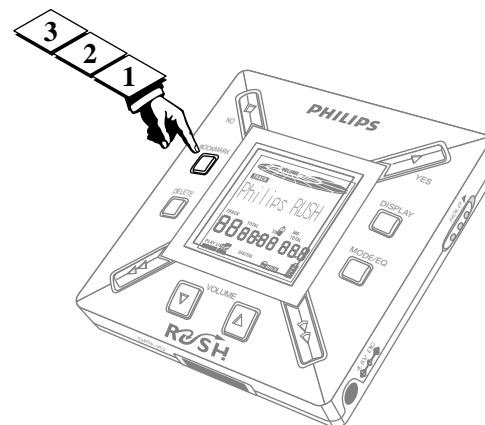

Note

Setting more than 10 bookmarks will overwrite your original set of bookmarks.

CLEARING TRACKS

*When clearing tracks, bookmarks, or the SmartMedia card, use **DELETE** only when you are absolutely sure you no longer want the existing contents!*

BEGIN

- 1 During playback, press **YES** ► to pause playback.
- 2 Within 15 seconds, press **DELETE** repeatedly to see: **Delete Track? Erase Card? or Clear Marks?**
- 3 If you no longer wish to delete the information, press **NO** ■. To delete the bookmark, track, or card, press **YES** ►. If you chose Erase Card at step 2, the display asks: **Are You Sure?** To delete the entire card, press **YES** ►. Depending on your selection, the display shows **Clearing Marks, Clearing Tracks, or Erasing Card**, then **Marks Cleared, Track Deleted, or Card Erased**.

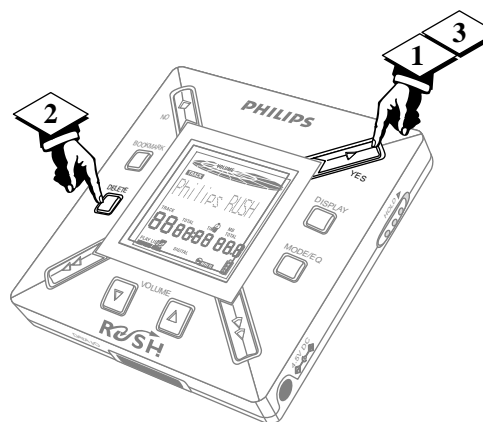

Note

The Player will clear all bookmarks automatically if you choose **Clear Marks?**.

CARRYING POUCH

Disconnect the headphones before using the pouch.

BEGIN

- 1** Store your extra SmartMedia card(s) in the pocket.
- 2** Insert the **Player** into the pouch with the display screen facing the plastic square.
- 3** Insert the **strap** through the plastic square and pull the strap to adjust it securely.
- 4** Adjust the **elastic cords** to make sure all the buttons are accessible.

Detachable key ring

Push back the hinge of the key ring, then hook it onto a belt, etc.

Belt strap

If your belt is a suitable width, thread the belt through the strap at the back of the pouch.

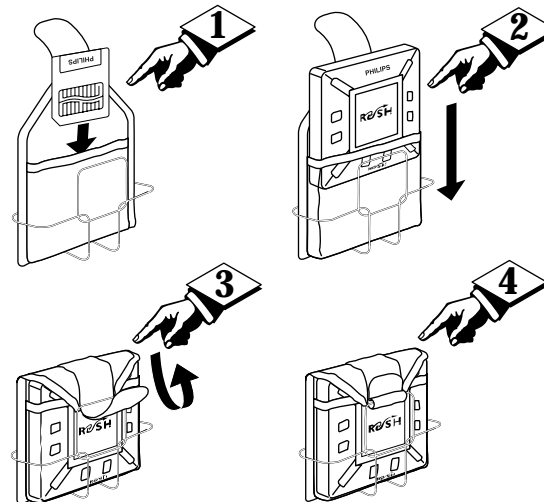

SMART HELP

If you have questions about RealJukebox, visit www.Real.com .

For help with the RUSH Player, visit www.rush.philips.com, or call Philips at 1-800-531-0039.

The display is blank or there is no sound.

- Make sure the batteries are inserted correctly. Install new ones if necessary. *Details are on pages seven and 10.*
- Make sure the power adapter is connected securely. Check the power supply at the wall outlet. *Details are on page eight.*
- Press YES ► until information appears on the display. *Details are on page 21.*
- Make sure the headphones are connected securely.

RUSH does not respond when you press buttons.

- Turn off Hold. *Details are on page 23.*
- Remove the batteries, then replace them after several seconds.

Sound skips during playback on RUSH.

- If the file was recorded at a compression level exceeding 224 Kbps, use a lower compression level to record CD tracks into MP3 format. *Details are on page 13.*

Unable to download MP3 file

- Check the batteries. Make sure the connections between RUSH and your PC are secure. *Details are on pages 11 and 18.*
- Make sure your computer is in ECP mode. *Details are on page 12.*

SMART HELP, CONTINUED

External drive of PC has no power.

- Secure all connections. Turn on the power at the wall outlet. Turn on the PC.

SmartMedia card can not be inserted or will not play.

- Insert card correctly. *Details are on page 15.*
- Use MP3 format. *Details are on page 13.*
- The card may be damaged. Replace the card.
- Use only Philips blue SmartMedia cards.
Do not use cards from a digital camera or another MP3 player.

RUSH skips or repeats files during playback.

- Press MODE/EQ to cancel Shuffle or Repeat mode. *Details are on page 26.*

Long delay between songs

- This could occur if you alternate between recording in MP3, RealAudio, or Wave Audio formats.
Group songs according to format before transferring them to RUSH.



Note

Player Weight

65 g (without batteries)

Player Dimensions (mm)

70.5 (w) x 70.5 (h) x 17.7 (d)

Amplifier system

Audio out 2 x 5mW

Signal to Noise ratio >60dB

Frequency response .30Hz - 16KHz

Connections

I/O Interface 26-pin mini connector

DC jack . . .3.5 mm, 4.5V center '+'

Power Supply

Batteries .Two AAA, R03, or UM4

External supply 4.5V DC

LIMITED WARRANTY

PORTABLE AUDIO

90 days Free Exchange / One year Free Parts

This product must be carried in for an exchange.

WHO IS COVERED?

You must have proof of purchase to exchange the product. A sales receipt or other document showing that you purchased the product is considered proof of purchase. Attach it to this owner's manual and keep both nearby.

WHAT IS COVERED?

Warranty coverage begins the day you buy your product. For 90 days thereafter, a defective or inoperative product will be replaced with a new, renewed, or comparable product at no charge to you. From 90 days to one year from the day of purchase, all parts will be repaired or replaced, but you pay for all labor charges. After one year from the day of purchase, you pay for the replacement or repair of all parts, and for all labor charges.

A replacement product is covered only for the original warranty period. When the warranty on the original product expires, the warranty on the replacement product also expires.

WHAT IS EXCLUDED?

Your warranty does not cover:

- labor charges for installation or setup of the product, adjustment of customer controls on the product, and installation or repair of antenna systems outside of the product.
- product repair and/or part replacement because of misuse, accident, unauthorized repair or other cause not within the control of Philips Consumer Electronics.

- reception problems caused by signal conditions or cable or antenna systems outside the unit.
- a product that requires modification or adaptation to enable it to operate in any country other than the country for which it was designed, manufactured, approved and/or authorized, or repair of products damaged by these modifications.
- incidental or consequential damages resulting from the product. (Some states do not allow the exclusion of incidental or consequential damages, so the above exclusion may not apply to you. This includes, but is not limited to, prerecorded material, whether copyrighted or not copyrighted.)
- a product used for commercial or institutional purposes.

WHERE IS EXCHANGE AVAILABLE?

You may exchange the product in all countries where the product is officially distributed by Philips Consumer Electronics. In countries where Philips Consumer Electronics does not distribute the product, the local Philips service organization will attempt to provide a replacement product (although there may be a delay if the appropriate product is not readily available).

BEFORE REQUESTING EXCHANGE...

Please check your owner's manual before requesting an exchange. Adjustments of the controls discussed there may save you a trip.

LIMITED WARRANTY

EXCHANGING A PRODUCT IN U.S.A., PUERTO RICO OR U.S.VIRGIN ISLANDS...

Contact your dealer to arrange an exchange. Or, ship the product, insured and freight prepaid, and with proof of purchase enclosed, to the address listed below.

Small Product Service Center
Philips Service Solutions Group
907 Snapps Ferry Road, Plant 2, Building 6
Greeneville, TN 37743

(In U.S.A., Puerto Rico and U.S.Virgin Islands, all implied warranties, including implied warranties of merchantability and fitness for a particular purpose, are limited in duration to the duration of this express warranty. But, because some states do not allow limitations on how long an implied warranty may last, this limitation may not apply to you.)

EXCHANGING A PRODUCT IN CANADA...

Please contact Philips at:

1-800-661-6162 (French Speaking)
1-800-363-7278 (English Speaking)

(In Canada, this warranty is given in lieu of all other warranties. No other warranties are expressed or implied, including any implied warranties of merchantability or fitness for a particular

purpose. Philips is not liable under any circumstances for any direct, indirect, special, incidental or consequential damages, howsoever incurred, even if notified of the possibility of such damages.)

TO GET OUT-OF-WARRANTY EXCHANGE...

In U.S.A., Puerto Rico or U.S.Virgin Islands, contact Philips Service Solutions Group at 1-800-531-0039 to obtain the cost of out-of-warranty exchange. Then carefully pack the product and ship it to the Small Product Service Center (address listed at left). In Canada, call the phone number listed above under "Exchanging a Product in Canada" to obtain the cost of out-of-warranty exchange.

REMEMBER...

Please record the model and serial numbers found on the product below. Also, please fill out and mail your warranty registration card promptly. It will be easier for us to notify you if necessary.

MODEL # _____

SERIAL # _____

This warranty gives you specific legal rights. You may have other rights which vary from state/province to state/province.

Philips Service Solutions Group, P.O. Box 2976, Longview, Texas 75606, (903) 242-4800

INDEX

batteries	7, 10	maintenance	7	"searching" ◀◀, ▶▶	
BOOKMARK button.....	9, 27	Master Library	19	buttons.....	9, 25
bookmarks, setting of.....	27	MODE/EQ button.....	9, 22, 26	secure files	13
CARD EJECT.....	10, 15	MP3		shuffling tracks.....	26
CARD INSERT	10, 15	files, making of	18	Smart Help.....	30-31
carrying pouch	29	format.....	13	SmartMedia Card.....	10, 16
chrome sticker.....	16	sending to RUSH	18	erasure.....	16
clearing tracks	28	NO ■ button	9, 21	overwriting	16
compression levels	13	on-line tutorial.....	17	storage.....	29
connections.....	11	parallel cable	11	software, installation of	12
controls	9-10	playing music	21	specifications.....	31
DATA I/O jack	9, 11	Playlist.....	19	table of contents.....	5
DC jack	8-9	power adapter.....	8	track selection	25
DELETE button	9, 28	RealAudio	13	volume, adjusting of	22
Display	9	RealJukebox		VOLUME ▲, ▼ buttons ..	9, 22
DISPLAY button.....	9, 24	installing.....	12	Wave Audio.....	13
general information.....	6	using	13-14, 17-20	YES ▶ button.....	9, 11, 21
headphone jack	10	recording formats	13		
HOLD ▶ switch	9, 23	repeating tracks	26		
limited warranty.....	32-33	safety precautions	3-4		



PHILIPS
www.rush.philips.com