

Always there to help you

Register your product and get support at
www.philips.com/welcome



GoGEAR

SA4VBE



User manual

PHILIPS

Contents

1 Important safety information	3
General maintenance	3
Environmental information	4
Recycling the product	4
2 Your new player	6
What's in the box	6
PC software for the player	6
Files loaded on the player	6
Overview	6
Controls	6
Home screen	7
Lock/unlock the keys	7
Volume reminder	7
3 Get started	9
Charge power	9
Switch the player on or off	9
Automatic standby and shut-down	9
4 Music	10
Transfer music to the player	10
Find music on the player	10
Find music by song information	10
Find music by playlist	10
Find music by file folder	10
Superscroll	10
Play music	11
Play from the same collection	11
Select play options	11
Playlists	11
Add songs to a playlist-on-the-go	11
Remove songs from a playlist-on-the-go	12
Delete songs from the player	12
5 Audiobooks	13
Sync audio books to the player	13
Install AudibleManager on the PC	13
Download audiobooks to the PC	13
Sync to the player	13
Find audiobooks on the player	14
Play audiobooks	14
Use bookmarks	14
Delete audiobooks from the player	14
6 Videos	15
Transfer videos to the player	15
Install Philips Media Converter	15
Use Philips Media Converter	15
Find videos on the player	15
Play videos	16
Delete videos from the player	16
7 Pictures	17
Add pictures to the player	17
Find pictures on the player	17
View pictures	17
Start a slideshow	17
Select play options	17
Delete pictures from the player	17
8 Folder view	18
9 Settings	19
Play mode	19
Sound settings	19
Sleep timer	19
Display settings	19
Screensaver	19
Slideshow settings	19
Language	20
Information	20
Legal	20
Format device	20
Factory settings	20
10 Update the firmware through Philips Device Manager	21
11 Troubleshooting	23
12 Technical data	24

Need help?

Please visit

www.philips.com/welcome

where you can access a full set of supporting materials such as the user manual, the latest software updates, and answers to frequently asked questions.

1 Important safety information

General maintenance

The translation of this document is for reference only.

In the event of any inconsistency between the English version and the translated version, the English version shall prevail.

! Caution

- To avoid damage or malfunction:
- Use only power supplies listed in the user manual.
- Do not expose the product to excessive heat caused by heating equipment or direct sunlight.
- Do not drop the product or allow objects to fall on your player.
- Do not allow the product to be submerged in water. Do not expose headphone socket or battery compartment to water; as water entering the set may cause major damage.
- Active mobile phones in the vicinity may cause interference.
- Back up your files. Ensure that you retain the original files you have downloaded to your device. Philips is not responsible for any loss of data if the product becomes damaged or not readable / legible.
- Manage (transfer, delete, etc.) your music files only with the supplied music software to avoid problems.
- Do not use any cleaning agents containing alcohol, ammonia, benzene, or abrasives as these may harm the product.
- Batteries (battery pack or batteries installed) shall not be exposed to excessive heat such as sunshine, fire or the like.
- Danger of explosion if battery is incorrectly replaced. Replace only with the same or equivalent type.

About operating and storage temperatures

- Operate in a place where temperature is always between 0 and 45°C (32 to 113°F)

- Store in a place where temperature is always between -20 and 45°C (-4 to 113°F).
- Battery life may be shortened in low temperature conditions.

Replacement parts/accessories:

Visit www.philips.com/support to order replacement parts/accessories.

Hearing Safety



A pleine puissance, l'écoute prolongée du baladeur peut endommager l'oreille de l'utilisateur.



! Warning

- To prevent possible hearing damage, do not listen at high volume levels for long periods.

The maximum output voltage of the player is not greater than 150 mV.

Wide band characteristic voltage WBCV:>= 75 mV

Modifications

Modifications not authorized by the manufacturer may void user's authority to operate the product.

Copyright information

All other brands and product names are trademarks of their respective companies or organizations.

Unauthorized duplication of any recordings whether downloaded from the Internet or made from audio CDs is a violation of copyright laws and international treaties.

The making of unauthorized copies of copy-protected material, including computer programs, files, broadcasts and sound recordings, may be an infringement of copyrights and constitute a criminal offense. This equipment should not be used for such purposes.

The Windows Media and the Windows logo are registered trademarks of Microsoft Corporation in the United States and/or other countries.

Be responsible! Respect copyrights.



**Be responsible
Respect copyrights**

Philips respects the intellectual property of others, and we ask our users to do the same. Multimedia content on the internet may have been created and/or distributed without the original copyright owner's authorization.

Copying or distributing unauthorized content may violate copyright laws in various countries including yours.

Compliance with copyright laws remains your responsibility.

The recording and transfer to the portable player of video streams downloaded to your computer is intended only for use with public domain or properly licensed content. You may only use such content for your private, non-commercial use and shall respect eventual copyright instructions provided by the copyright owner of the work. Such instruction may state that no further copies shall be made.

Video streams may include copy protection technology that prohibits further copying. For such situations the recording function will not work and you will be notified with a message.

Data logging

Philips is committed to improving the quality of your product and enhancing the Philips user experience. To understand the usage profile of this device, this device logs some info / data to the non-volatile memory region of the device.

These data are used to identify and detect any failures or problems you as a user may experience while using the device. The data stored, for example, will be the duration of playback in music mode, duration of playback in turner mode, how many times battery low was encountered, etc. The data stored do not reveal the content or media used on the device or the source of downloads. The data stored on the device are retrieved and used ONLY if the user returns the device to the service center and ONLY to simplify error detection and prevention. The data stored shall be made available to user on user's first request.

Environmental information

All unnecessary packaging has been omitted. We have tried to make the packaging easy to separate into three materials: cardboard (box), polystyrene foam (buffer) and polyethylene (bags, protective foam sheet.)

Your system consists of materials which can be recycled and reused if disassembled by a specialized company. Please observe the local regulations regarding the disposal of packaging materials, and old equipment.

Recycling the product

Your product is designed and manufactured with high quality materials and components, which can be recycled and reused. When you see the crossed-out wheel bin symbol attached to a product, it means the product is covered by the European Directive 2002/96/EC:



Never dispose of your product with other household waste. Please inform yourself about the local rules on the separate collection of electrical and electronic products. The correct disposal of your old product helps prevent potentially negative consequences on the environment and human health.

Warning

- For products with "non-exchangeable" built-in batteries: The removal of (or the attempt to remove) the battery invalidates the warranty. This procedure is only to be performed at the end of the product's life.

Your product contains a built-in rechargeable battery covered by the European Directive 2006/66/EC, which cannot be disposed of with normal household waste.



To safeguard the functionality and safety of your product, take your product to an official collection point or service center where a professional can remove the battery as shown:

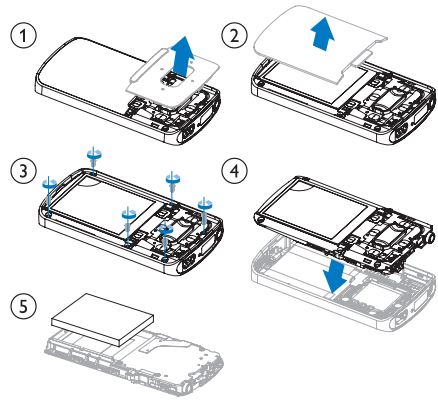

Please inform yourself about the local rules on separate collection of batteries. The correct disposal of batteries helps prevent potentially negative consequences on the environment and human health.

Notice for the European Union

This product complies with the radio interference requirements of the European Union.

2 Your new player

What's in the box

Make sure that you have received the following items:
Player

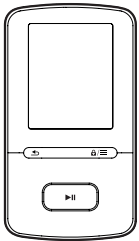

Earphones

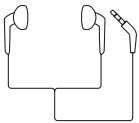

USB cable



Quick start guide



Safety and Warranty sheet



Note

- The images serve as reference only. Philips reserves the right to change color/design without notice.

PC software for the player

VIBE can work with the following PC software:

- Philips Device Manager** (helps you get firmware updates and recover the player)
- Philips Media Converter** (helps you convert videos to the file type that is supported on the player; and transfer the converted files to the player)

Files loaded on the player

The following files are loaded on VIBE:

- User manual
- Frequently asked questions

Overview

Controls

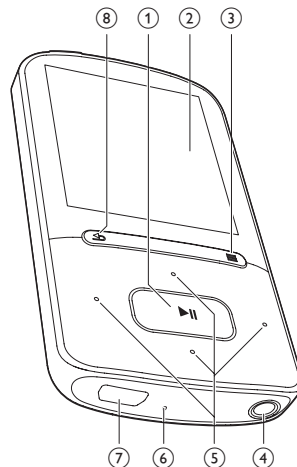

1 Play/Pause

- Press and hold: Switch the player on or off

- Press: Select options, or start/pause/resume play

② Display

③ /

- Press: Show options menu
- Press and hold: Lock/unlock all buttons

④

- 3.5-mm headphone connector

⑤ /

- **on the list of options:**
Press: Skip to the previous/next option
Press and hold: Show the initial of current option in a list of options that are sorted by alphabet
- **on the play screen:**
Press: Increase/decrease the volume
Press and hold: Increase/decrease the volume quickly



- **on the play screen:**
Press: Skip to the next/previous file
Press and hold: Fast forward or rewind within current file

⑥ RESET

- Press the hole by using the tip of a ball pen when the screen does not respond to the pressing of keys





⑦



- USB connector for power charging and data transfer

⑧

- Press: Back one level





Home screen

Menu	Mode	To
	Music	play audio files
	Video	watch videos
	Pictures	view pictures
	Folder view	view files in folders

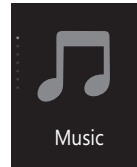
	Settings	customize the settings of VIBE
	Now playing	show current play screen

Navigate from the Home screen



- From the Home screen, you can access functional menus by pressing the navigation buttons  /  and .
- To go back to previous screens, press  repeatedly.

Switch between the Home screen and play screen

On the Home screen,

- press ;
- alternatively, press  and select [Now playing] or [Last played].

On the Home screen,



- Press  repeatedly.

To select a theme for the display,

- On the Home screen, press  and select [Theme].

Lock/unlock the keys

When the player is on, use the lock to prevent accidental operation.

- Press and hold  /  to lock or unlock the keys.
 - ↳ All buttons except the volume keys are locked and a lock icon is displayed.



Volume reminder

VIBE can have you reminded when:



- the volume reaches the high level (80 dBA); or
- you have listened at a high volume level for 20 hours.

With the feature of volume reminder, the Philips MP3/MP4 player complies with the European Union regulations (EN 60950-1) in protecting your hearing safety.

When you increase the volume,

- 1** Press .
 - ↳ When the volume level reaches the high level, a pop-up screen is displayed.
- 2** To continue to increase the volume, select **[Yes]** and press  to confirm.
 - ↳ You can continue to increase the volume.
- To exit volume adjustment, select **[No]** and press  to confirm.
 - ↳ The play resumes at the previous volume level.

When you have listened at a high volume level for 20 hours, a pop-up is displayed.

- To keep listening at a high volume level, select **[Yes]** and press  to confirm.
- To exit high volume, select **[No]** and press  to confirm.
 - ↳ The volume level drops below the high level (80 dBA) .

3 Get started

Charge power

VIBE has a built-in battery that can be charged through the USB socket of a computer. Connect VIBE to a PC by using the USB cable.

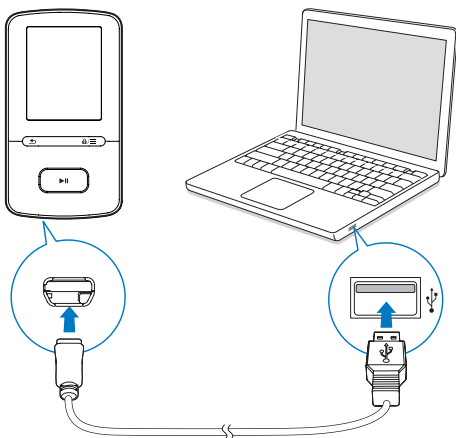

Note

- When you connect VIBE to a computer, you are briefly prompted to select: [Charge & transfer] or [Charge & play].
- VIBE automatically applies [Charge & transfer], if no new selection is made.

Battery level indication

- When the battery is low, the low battery screen is displayed repeatedly.
- When the charging process is complete, is displayed.

Note

- Rechargeable batteries have a limited number of charge cycles. Battery life and number of charge cycles vary by use and settings.

Charge through a USB AC/DC adapter

To charge VIBE through a USB AC/DC adapter (not supplied), make sure that the power output is 5.0V and 0.5A.

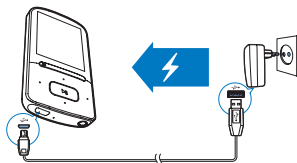

Switch the player on or off

Press and hold until the player is switched on or off.

Automatic standby and shut-down

The player has an automatic standby and shut-down feature that can save battery power: After 5 minutes in idle mode (no play, no button is pressed), the player switches off.

4 Music

Transfer music to the player

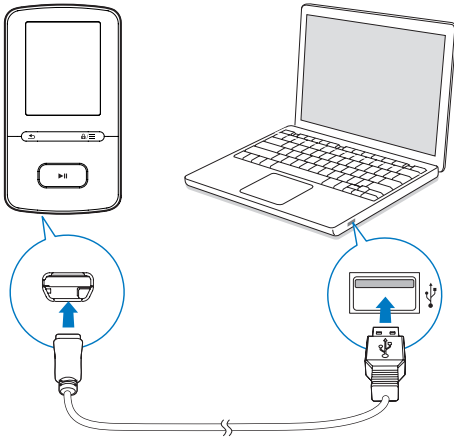

You can transfer music from your PC media library to **VIBE** in the following ways:

- Drag and drop music files in Windows Explorer.

To drag and drop music files in Windows Explorer,

- 1 Connect **VIBE** to a PC.
- 2 On the PC, under **My Computer** or **Computer**,
 - select **VIBE**, and create file folders.
- 3 On the PC, drag and drop music files to the file folders on **VIBE**.
 - Alternatively, drag and drop file folders from the PC to **VIBE**.

Find music on the player

On **VIBE**, you can find music by song information, playlist, or file folder. With **Superscroll**, you can quickly browse through the music library by initial.

Find music by song information

In **♪**, songs are sorted by metadata or ID3 tag under different collections: **[All songs]**, **[Artists]**, **[Albums]**, or **[Genres]**.

[All songs]

- Songs are sorted by song title in alphabetical order.

[Artists]

- Songs are sorted by artist in alphabetical order;
- Under each artist, songs are sorted by album in alphabetical order.

[Albums]

- Songs are sorted by album in alphabetical order.

[Genres]

- Songs are sorted by genre, such as pop, rock.

Find music by playlist

In **♪** > **[Playlists]**, find the playlists-on-the-go that you create on the player.

Find music by file folder

In **■**, find music by file folder.

Superscroll

In a list of options that are sorted by alphabet, **Superscroll** allows you to browse the options by initial.

- Press and hold **⏏** / **⏏** to start **Superscroll**.
 - ↳ On the screen, you can see the initials of current options.



↳ On the play screen, you can see the file information and play status.

To adjust the volume,

- On the play screen, press / .

To select a music file on the play screen,

- Repeatedly press / .

To rewind or fast forward within current song,

- On the play screen, press and hold / .

Play music

You can start play from a song, or play an entire album or artist.

To start play from a song,

- 1 Select a song.
- 2 Press to start play.
↳ Play starts from current song.

To play the entire album or artist,

- 1 Select an album or artist.
- 2 Press > [Play].
- 3 Press to start play.



On the play screen,

- Press to pause and resume play.
- To go to the previous screen, press .
- ↳ The play screen returns a few seconds later.

Play from the same collection

During the song play, you can switch to a collection the same as that of current song.

- 1 On the play screen, press and select [Play mode].
- 2 In [Play music from...], select [... this artist], [... this album], or [... this genre]. Press .
- ↳ You start to play current artist, album, or genre.

To play all the songs on the player,

- 1 On the play screen, press and select [Play mode].
- 2 In [Play music from...], select [All songs]. Press .

Select play options

On the play screen, press to select play options, such as play mode, sound settings, and sleep timer (see 'Settings' on page 19).

Playlists

On the players, you can find the following playlists:

- playlists that you transfer from the PC media library;
- three playlists-on-the-go for you to add songs on the player.

Add songs to a playlist-on-the-go

To add current song,

- 1 Select or play a song.
- 2 On the list of songs or play screen,
 - press  and select **[Add to playlist]**.
- 3 Select a playlist-on-the-go. Press **▶||**.
 - ↳ A confirmation message is displayed.
- 4 Select **[Yes]** to confirm.
 - ↳ You save current song to the playlist.

To add an album or artist,

- 1 Select an album or artist.
- 2 On the list of albums or artists,
 - press  and select **[Add to playlist]**.
- 3 Select a playlist-on-the-go. Press **▶||**.
 - ↳ A confirmation message is displayed.
- 4 Select **[Yes]** to confirm.
 - ↳ You save the album or artist to the playlist.

Remove songs from a playlist-on-the-go

To remove current song from a playlist,

- 1 On the play screen, press  > **[Remove from Playlist]**.
- 2 Select a playlist-on-the-go. Press **▶||**.
 - ↳ A confirmation message is displayed.
- 3 Select **[Yes]** to remove.
 - ↳ You remove current song from the selected playlist.

Delete songs from the player

To delete current song during play,

- 1 On the play screen, press  and select **[Delete]**.
 - ↳ A confirmation message is displayed.
- 2 Select **[Yes]** to delete the song.
 - ↳ Current song is deleted from the player.

5 Audiobooks

Go to **J** > **[Audiobooks]** to play books in audio formats that you have downloaded from www.audible.com.

Sync audio books to the player

From www.audible.com, download and install the **AudibleManager** software on your PC. Through the software, you can

- download audiobooks from www.audible.com to your PC library of audio books;
- sync the audiobooks to your player.

Install AudibleManager on the PC

- 1 Connect your PC to the Internet.
- 2 From www.audible.com, download the **AudibleManager** software for MP3/ MP4 players.
- 3 Install the software on your PC:
 - On the setup screen, select **Philips GoGear (selected models)** from the drop-down list of listening devices;

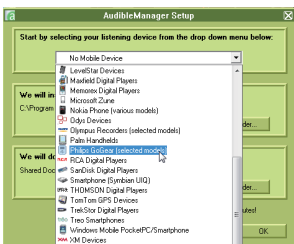

- Follow onscreen instructions to complete the installation.

Download audiobooks to the PC

- 1 Connect your PC to the Internet.

- 2 Launch **AudibleManager** on your PC.
- 3 On **AudibleManager**, click the **My Library Online** button to connect to www.audible.com.
- 4 Select and download audio books:
 - Log in to your account with www.audible.com;
 - Download audio books in the format of **4** or **e**.
 - ↳ The downloaded books are automatically added to your library on **AudibleManager**.

Sync to the player

- 1 Launch **AudibleManager** on your PC.
- 2 Connect the player to the PC. Wait till the player is recognized by **AudibleManager**.
- 3 On **AudibleManager**, click **Add to Device**.
 - The first time you connect the player to **AudibleManager**, activate the player as prompted.

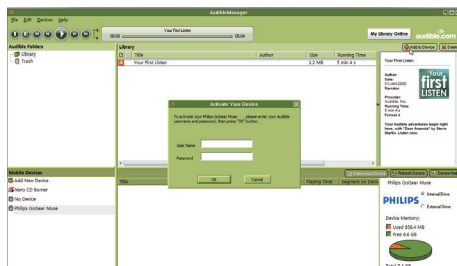

To check the audio books transferred to the player,

See the player pane on **AudibleManager**.

- If necessary, click **Refresh Device**.

Find audiobooks on the player

In **J** > **[Audiobooks]**, audiobook files are organized by book title or author:

[Books]

- Books are sorted by book title in alphabetical order.

[Authors]

- Books are sorted by author in alphabetical order.

Play audiobooks

- 1 Select a book.
- 2 Press **▶||** to start play.
 - ↳ On the play screen, you can see the book information and play status.
 - On the play screen, press **▶||** to pause and resume play.
 - To go to the previous screen, press **⏪**.

To skip titles or sections during play,

- 1 On the play screen, press **≡** > **[Navigation mode]**. Select **[Titles]** or **[Section]**.
- 2 On the play screen, press **⏮** / **⏭**.

Use bookmarks

On an audiobook, you can add up to 10 bookmarks to the play time. Start play from the bookmarked play time as needed.

To add a bookmark,

- 1 On the play screen, press **≡** and select **[Bookmarks]** > **[Add bookmark]**.
- 2 Select a location.

- ↳ Current play time is added to the location in the list of bookmarks.

To play from a bookmarked play time,

- On the play screen, press **≡** and select **[Bookmarks]** > **[Go to bookmark]**. Select an option.
 - ↳ Play starts from the selected play time.

To delete a bookmark,

- On the play screen, press **≡** and select **[Bookmarks]** > **[Delete bookmark]**. Select an option.
 - ↳ You remove the play time from the list of bookmarks.

Delete audiobooks from the player

- 1 On the play screen, press **≡** > **[Delete Audiobook]**.
 - ↳ A confirmation message is displayed.
- 2 Select **[Yes]** to delete the audiobook.
 - ↳ Current audiobook is deleted from the player.

6 Videos

Transfer videos to the player

You can transfer videos to the player in two ways:

- Transfer through **Philips Media Converter**;
With the video converter software, you can convert videos to the file type that is supported on the player, and transfer the converted files to the player.
- Drag and drop video files (.AMV files) in Windows Explorer.
By doing so, you can organize your video collection by file folder.

Install Philips Media Converter

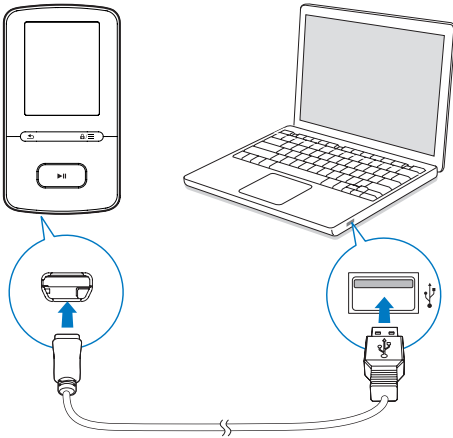

- 1 Connect **VIBE** to a PC.
- 2 On the PC, select **My Computer** (Windows XP / Windows 2000) / **Computer** (Windows Vista / Windows 7 / 8).
- 3 Click the **Philips GoGear VIBE** icon. Double-click the **PMCsetup.exe**.
- 4 Follow the onscreen instructions to complete the installation of the software.







Tip

- You can also get the **Philips Media Converter** software from www.philips.com/support.

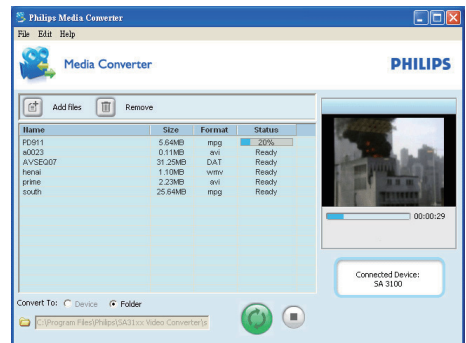
Use Philips Media Converter

- 1 On your PC, launch **Philips Media Converter**.
- 2 Connect the player to the PC by using the USB cable.
 - Wait until the player is recognized by **Philips Media Converter**.



- 3 In **Philips Media Converter**, add videos from your PC library:
 - Click .
 - ↳ The video is added to the list of files for conversion and transfer.
 - To remove a video from the list of files, click .
- 4 In **Philips Media Converter**, start the file conversion and transfer:
 - Click .

Find videos on the player

To find videos by file name,

- Go to .
- ↳ Videos are listed by file name in alphabetical order.

To find videos by file folder,

- Go to .
 - ↳ Videos are organized by file folder as on the PC.

Play videos

- 1 Select a video.
- 2 Press  to start play.
 - ↳ The video plays in the landscape view.

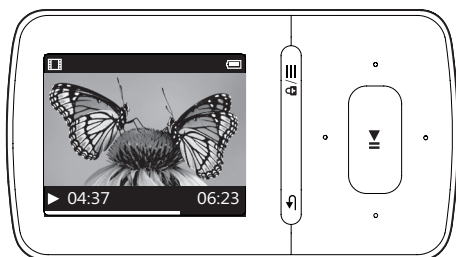

On the play screen,

- Press  to pause and resume play.

To select a video file on the play screen,

- Repeatedly press  / .

To rewind or fast forward within current video,

- On the play screen, press and hold  / .

Delete videos from the player

- 1 Select or play a video.
- 2 On the list of videos or play screen,
 - press  and select **[Delete video]**.
 - ↳ A confirmation message is displayed.
- 3 Select **[Yes]** to delete the video.
 - ↳ Current video is deleted from the player.

7 Pictures

Add pictures to the player

- 1 Connect **VIBE** to a computer.
- 2 On the PC, under **My Computer** or **Computer**,
 - select **VIBE**, and create file folders.
- 3 On the PC, drag and drop files to the file folders on the **VIBE**.
 - Alternatively, drag and drop file folders from the PC to **VIBE**.

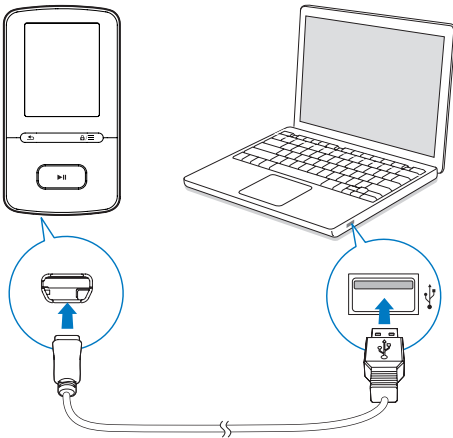

Find pictures on the player

To find pictures by file name,

- Go to .
 - ↳ Pictures are listed by file name in alphabetical order.

To find pictures by file folder,

- Go to .
 - ↳ Pictures are organized by file folder as on the PC.

View pictures

- On the list of pictures, press / and to select a picture.

On the play screen,

- press / to select a picture.

Start a slideshow

- When you view pictures, press to start a slideshow.
 - ↳ Pictures play one by one.

Select play options

On the play screen, press to select play options:

- During slideshow, first press to pause.

In **[Slideshow settings]**, select your options for slideshow:

[Time per slide]	Select the time interval between two slides.
[Repeat]	Play pictures in current folder repeatedly.
[Shuffle]	Play pictures in current folder in random order.

Delete pictures from the player

- 1 Select or play a picture.
- 2 On the list of pictures or play screen,
 - press and select **[Delete picture]**.
 - ↳ A confirmation message is displayed.
- 3 Select **[Yes]** to delete the picture.
 - ↳ Current picture is deleted from the player.

8 Folder view

Go to  to view and play media files from the media library on the player.

9 Settings

In *****, select your options for the player:

- 1 Press **⊞** / **⊞** to select an option.
- 2 Press **▶||** to confirm.

Play mode

In **[Play mode]**, select play modes for music play:

[Play music from...]

- Switches to a collection the same as that of current song.

[Repeat]

- **[Repeat 1]:** Repeats current song.
- **[Repeat all]:** Repeats all songs in current folder.

[Shuffle]

- **[On]:** Plays all songs in current folder in random order.

If both **[Repeat all]** and **[Shuffle]** are activated,

- All songs in current folder are repeated in random order.

Sound settings

[FullSound]	Restores the sonic details that music compression loses (e.g. MP3, WMA).
--------------------	--

[Equalizer]	Defines sound settings as desired.
--------------------	------------------------------------

≡ Note

- Equalizer is deactivated when you select **FullSound**.

Sleep timer

Switch on the sleep timer. The **VIBE** can switch off automatically after a certain time duration.

- In **[Sleep timer] > [Set sleep timer...]**, select an option. Press **▶||**.
 - ↳ After the selected time duration, the device is switched off automatically.

After the sleep timer is switched on,

- Select ***** > **[Sleep timer]**;
- Alternatively, on the music play screen, press **≡** > **[Sleep timer]**.
 - ↳ You can see the time left before the player is switched off.

Display settings

[Theme]

- Selects the theme for the display.

Screensaver

If you have selected a screensaver, the screensaver appears on the idle screen after the pre-defined time duration.

To select a screensaver,

- 1 From the Home screen, select ***** > **[Display settings] > [Screensaver]**.
- 2 In **[Screensaver]**, press **⊞** / **⊞** and **▶||** to select an option:

[None]	shows blank screen.
---------------	---------------------

[Album art]	shows the CD cover of current song or last played song, if available.
--------------------	---

[Screen off]	switches off the screen.
---------------------	--------------------------

[Demo mode]	shows major features of the player.
--------------------	-------------------------------------

To exit the screensaver,

- Press any key.

Slideshow settings

[Time per slide]

- Selects play time for each slide.
- [Repeat]**
- Plays all slides repeatedly, if activated.
- [Shuffle]**
- Plays all slides in random order, if activated.

Language

You can change the language selection in **[Language]**.

Information

In **[Information]**, learn the following information about the player:

[Player information]

[Model:]	full product name Check the full product name when updating firmware from the support website.
[Firmware version:]	current firmware version Check the firmware version when updating firmware from the support website.
[Support site:]	web site that provides support for the player

[Disk space]

[Free space:]	space available
[Total space:]	memory size
[Songs]	number of songs that are stored on the player
[Pictures]	number of pictures that are stored on the player
[Videos]	number of videos that are stored on the player

[File type supported]

[Music]	supported types of music files
[Pictures]	supported types of picture files
[Videos]	supported types of video files

Legal

In **[Legal]**, find the legal information about the player.

Format device

Format the player: You remove all the data that are stored on the player.

- Select **[Format device]**, and then, select **[Yes]** as prompted.

Factory settings

In **[Factory settings]**, restore the player to factory settings. Files transferred to the player are retained.

10 Update the firmware through Philips Device Manager

Install Philips Device Manager

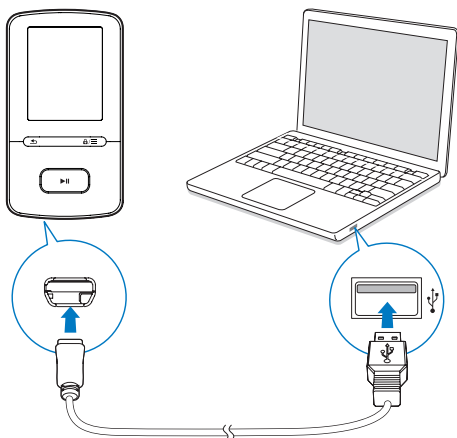

- 1 Connect **VIBE** to a PC.
- 2 On the PC, select **My Computer** (Windows XP / Windows 2000) / **Computer** (Windows Vista / Windows 7 / 8).
- 3 Right click on the **Philips GoGear VIBE** icon. Select **Install Philips Device Manager**.
 - Alternatively, click the **Philips GoGear VIBE** icon. Double-click the **installer.exe**.
- 4 Follow the onscreen instructions to complete the installation of the software.

Note

- The installation requires you to agree to the license terms.

Check for firmware updates

- 1 Make sure that you have connected your PC to the Internet.
- 2 Launch **Philips Device Manager**.
 - ↳ A dialog box is displayed.
- 3 Connect **VIBE** to your PC.
 - ↳ When the device is connected, "SASVBEXX" is displayed on the text box.
 - ↳ You can find current firmware version of the device.



- 4 To check for firmware updates,
 - ① Close the dialog box of Philips Device Manager.
 - ② At the base of the PC screen, right click  and select Check for updates.

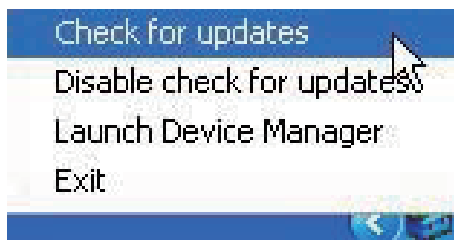

- ↳ **Philips SA5VBEXX Device Manager** checks for updates from the Internet.

Update the firmware

- 1** When the firmware update is available, follow the onscreen instructions to download and install the firmware.
- 2** Disconnect **VIBE** from the PC.
 - ↳ **VIBE** restarts after the firmware is updated and is ready for use again,

11 Troubleshooting

If **VIBE** is not working properly or the display freezes, you can reset it without losing data:

How do I reset **VIBE**?

- Insert a pen tip or other object into the reset hole on **VIBE**. Hold until the player shuts down.
- If the reset option is unsuccessful, recover **VIBE** through **Philips Device Manager**:

- 1** On your PC, launch **Philips Device Manager**.
- 2** Enter the recovery mode:
 - ①** Switch off **VIBE**.
 - ②** Press and hold the volume button , and then, connect **VIBE** to your PC.
 - ③** Keep holding the button until **Philips Device Manager** recognizes **VIBE** and enters the recovery mode.
- 3** Start the recovery process:
 - ①** On **Philips Device Manager**, click the **Repair** button. Follow the onscreen instructions to complete the recovery process.
 - ②** When the recovery is completed, disconnect **VIBE** from your PC.
- 4** Restart **VIBE**.

12 Technical data

Power

- Power supply: 290 mAh Li-ion polymer internal rechargeable battery
- Play time¹
Music (.mp3): up to 20 hours (FullSound off); up to 12 hours (FullSound on)
Video (.mp4): up to 4 hours

Software

- **Philips Media Converter:** to convert and transfer³ videos
- **Philips Device Manager:** to update the firmware and recover the player

Connectivity

- Headphone 3.5 mm
- USB 2.0 High speed

Sound

- Channel separation: > 45 dB
- Frequency Response: 80-18,000 Hz
- Output power: 2 x 2.4 mW
- Signal to noise ratio: > 84 dB

Audio playback

Supported formats:

- MP3
Bitrate: 8-320 kbps and VBR
Sampling rates: 8, 11.025, 16, 22.050, 32, 44.1, 48 kHz
- WMA (unprotected)
Bitrate: 5-320 kbps
Sampling rates: 8, 11.025, 16, 22.050, 32, 44.1, 48 kHz

Video playback

Supported formats:

- AMV

Picture display

Supported formats:

- JPEG
- BMP

Storage media

Built-in memory capacity²:

- SA4VBE04 4GB NAND Flash
- SA4VBE08 8GB NAND Flash
- SA4VBE16 16GB NAND Flash

Media transfer³

- Media Converter (video transfer)
- Windows Explorer (drag and drop)

Display

- Color LCD 128 x 160 pixels



Note

- Specifications are subject to change without notice.
- ¹ Rechargeable batteries have a limited number of charge cycles. Battery life and number of charge cycles vary by use and settings.
- ² 1GB = 1 billion bytes; available storage capacity is less. Full memory capacity may not be available as some memory is reserved for the player. Storage capacity is based on 4 minutes per song and 128 kbps MP3 encoding.
- ³ Transfer speed depends on operating system and software configuration.

PC requirements

- Windows® XP (SP3 or above) / Vista / 7/ 8
- Pentium III 800 MHz processor or higher
- 512 MB RAM
- 500 MB hard disk space
- Internet connection
- Windows® Internet Explorer 6.0 or later
- USB port

