

Main unit

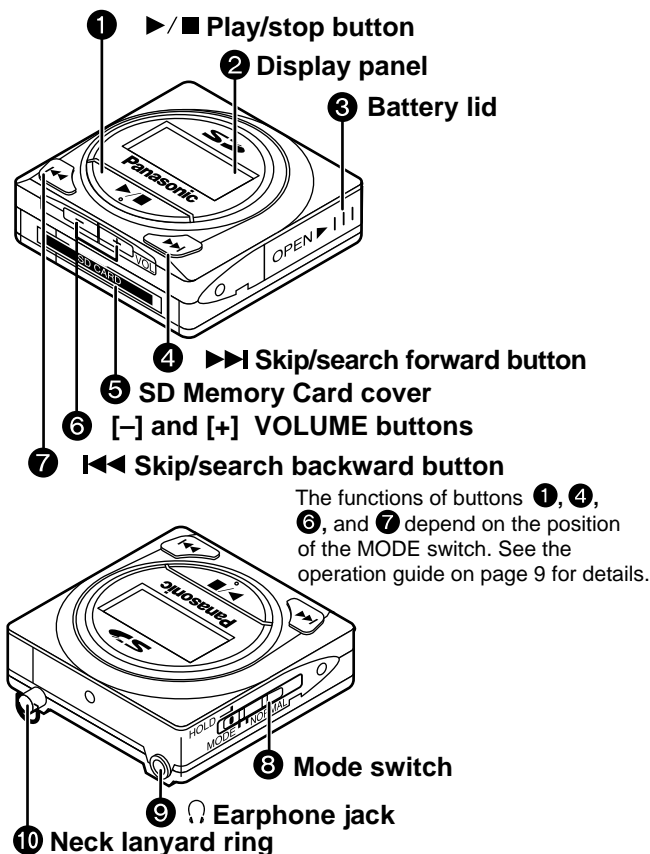

Stereo earphones

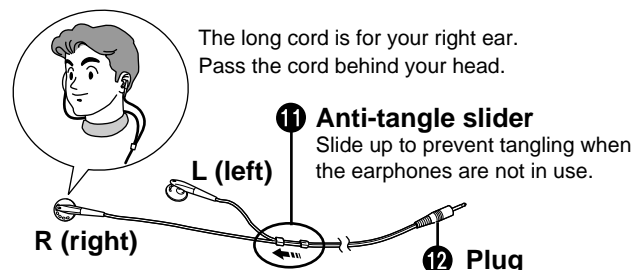

Earphone extender

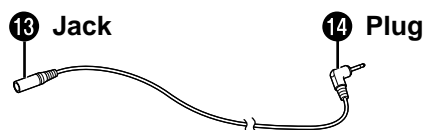

Display panel

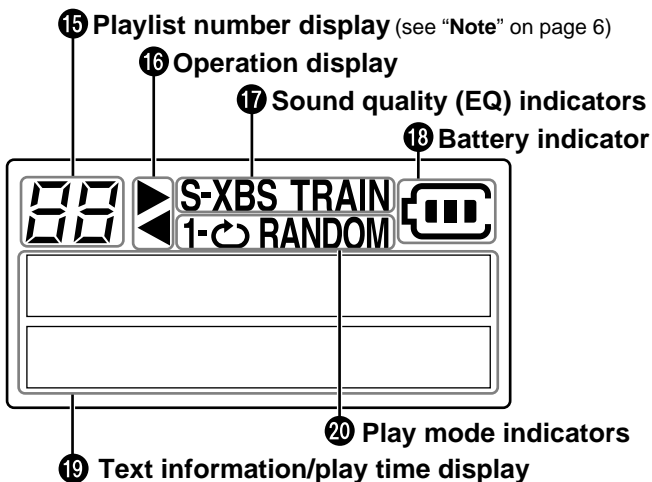

Charging the rechargeable battery

1 Insert the rechargeable battery.

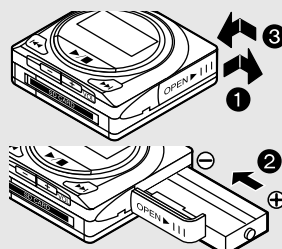

2 Connect the AC adaptor to the charger.

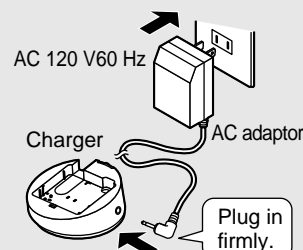

3 Put the unit into the charger.

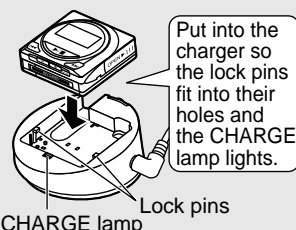

While charging: blinks briefly every two seconds.

When fully charged: lights briefly every five seconds.

After 4 hours: goes out.

To remove the unit from the charger

Press [▲] (EJECT) and lift the unit out. (Do not try to remove the unit while the lock pins are engaged.)

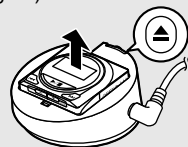

Using the included battery case

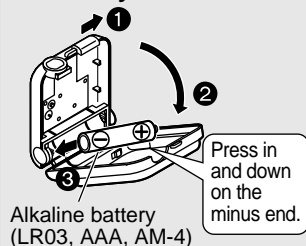

Rechargeable battery (included)

- Charge before initial use after purchase or after an interval of three months or longer.
- It takes approximately 3 hours to fully charge the included battery.
- The included battery can be recharged about 300 times. The battery has reached the end of its life if play time dramatically reduces after recharging.
- The battery may heat up while charging, but this is normal.
- Replace the rechargeable battery within 30 seconds because the clock stops while disconnecting the battery. If necessary, see page 8 for setting the clock.
- Separate from radios while charging as the charger can cause interference.
- You can play the unit while charging, but the battery cannot be fully charged. Stop play to charge fully.
- You cannot operate the unit if the rechargeable battery is not inserted, even if you put it into the charger. The message "NO BATTERY" appears on the display when you press [▶/■].

Battery indicator

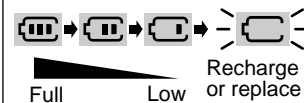

Note:

When the unit is not to be used for a long time, turn it off and unplug the AC adaptor from the household AC outlet.

The unit continues to consume 1 W even when you have pressed [▶/■] to turn it off.

To use dry cell batteries

Insert an alkaline battery (LR03, AAA, AM-4) into the battery case along with the unit.

To extend play time

You can get up to 50 hours of play by using the rechargeable battery and dry cell battery together.

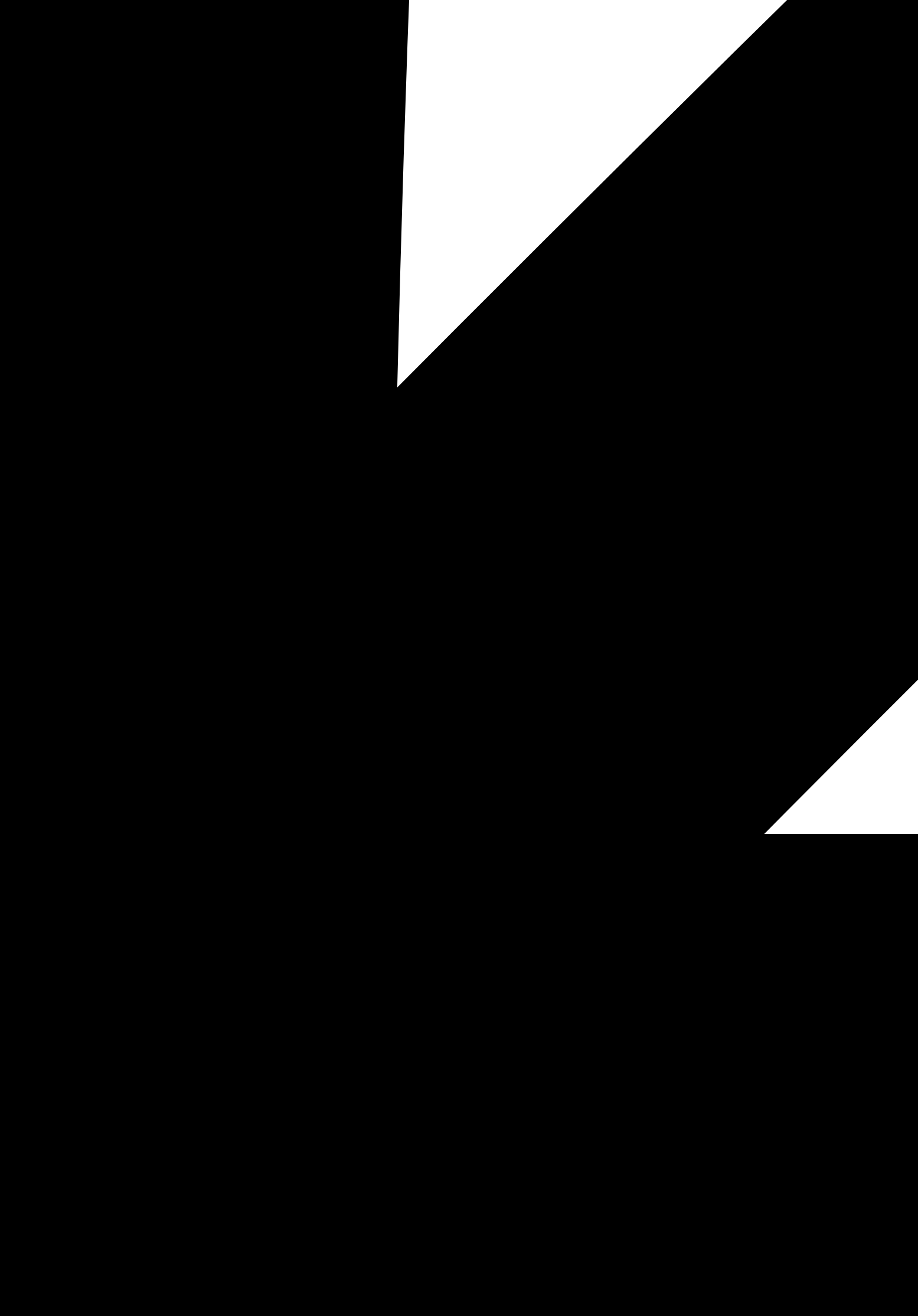



Setting the clock

- During play, set to MODE.**
If you want to stop the following operation part-way, set to NORMAL.
- Press.**
This is the clock/playlist setting mode.
- Select "TIME".**
Press. This is the clock setting mode.
- Select the display mode.**
Press. This is the clock setting mode.
- Set the time.**
The time flashes. Press. The clock starts.
- Set to NORMAL.**

- To display the clock, set the mode switch to HOLD during play or press [▶/■] while the switch is set to HOLD.
- Adjust the clock regularly to maintain accuracy.

Adjusting and changing the display

Adjusting the contrast

- During play, set the mode switch to HOLD.
- While pressing and holding [▶/■], press [+]
(darker) or [-] (lighter) volume button.

Changing the display

- During play, set the mode switch to MODE.
 - Press [◀◀] to change the display.
- Track titles, playlist titles, and artist information scroll from right to left if they do not fit on the display.
 - Titles including text data the unit doesn't support cannot be displayed.

Track number Elapsed play time Bitrate display

A few seconds after changing, the display returns to the track title indication automatically. Press and hold if you want to maintain the display.

Track title → Total number of tracks → Total play time → Playlist title → Artist information

Display when playing AAC audio data. The display when playing other data is shown at right.

MP3 128kbps
WMA 128kbps

- Set the mode switch to NORMAL.

Using the supplied accessories

Armband / Carrying case

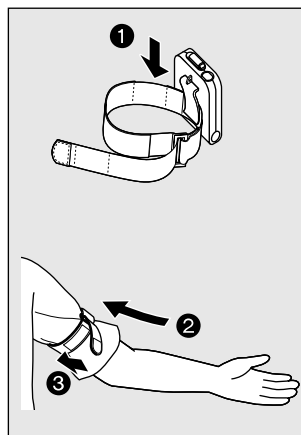

- Attach the carrying case to the armband.
- Undo the fabric fastener and fit the armband onto your arm.
- Do up the fabric fastener.

Note:
To prevent the unit from falling, do not swing the assembled unit around.

Neck lanyard

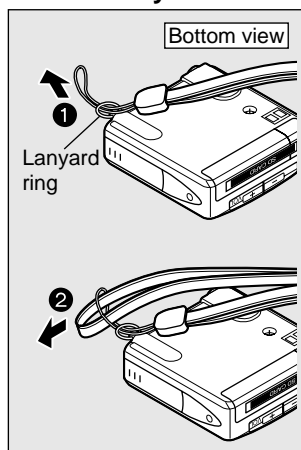

Attach the neck lanyard to the lanyard ring.

Note:
Take care that the lanyard does not get caught and choke you.

- SD logo is a trademark.



- Microsoft, Windows Media, and the Windows Logo are trademarks or registered trademarks of Microsoft Corporation in both the United States and other countries.



- Other names of systems and products mentioned in these instructions are usually the registered trademarks or trademarks of the manufacturers who developed the system or product concerned. The (TM) and (R) marks are not used to identify registered trademarks and trademarks in these instructions.

9

Cut here

Panasonic®

SD Audio Player
Operation Guide

Keep this card in your wallet or purse for quick reference.

Model No. **SV-SD80**

MODE switch position	◀◀	▶▶	▶/■	[-]	[+]
NORMAL	Skip/search backward	Skip/search forward	Play/stop	Reduce volume	Increase volume
MODE	Display change	Clock/playlist setting mode	Play/stop	Repeat/Random change	Sound quality (EQ)
	Cancel selection	Confirm selection	Selection in clock/playlist setting mode		
HOLD	—	—	Clock	—	—

Care and use

Main unit / Supplied accessories

- **Keep the SD Memory Card and the rechargeable battery out of the reach of children to prevent them from being swallowed.**
- Leave some slack in the cord of the earphones, the earphone extender, and the neck lanyard if you wind them around the unit.

Do not:

- disassemble, remodel, drop, or allow the unit to get wet.
- use or store in locations directly exposed to sunlight, a heat vent, or a heating appliance.
- use or store in humid or dusty locations.
- use or store in locations exposed to corrosive gases.
- insert objects other than SD Memory Cards.
- use force to open the battery lid or card cover.
- use cracked or warped cards.
- short-circuit the power supply terminals of the unit, the charger, or the battery case.
- detach the label on the card or attach other labels or stickers.

To protect your data

- **Do not touch the metal terminals of the SD Memory Card with your hands or metal objects.**
- **Use an oil-based felt pen to write on the card. Do not use pencil or ballpoint pen as these can damage the card.**
- **Take care to keep the metal terminals free from ink.**
- Switch the write-protect switch of the card to "LOCK". Unlock when you want to record or edit the card again.

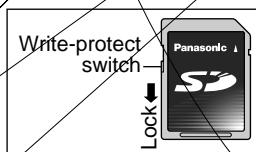

Rechargeable battery / Dry cell battery

- Remove the battery if the unit is not to be used for a long time.
- Carry and store the rechargeable battery in the supplied rechargeable-battery case to prevent contact with metal objects.

Do not:

- recharge ordinary dry cell batteries.
 - disassemble, short-circuit, or put in a fire or water.
 - peel off the cover or use if the cover has been peeled off.
- Mishandling of batteries can cause electrolyte leakage which can damage items the fluid contacts and may cause a fire.
If electrolyte leaks from the battery, consult your dealer.
Wash thoroughly with water if electrolyte comes in contact with any part of your body.

Listening caution



Do not use while operating a motorized vehicle. It may create a traffic hazard and is illegal in many areas.

You should use extreme caution or temporarily discontinue use in potentially hazardous situations.

Even if your headphones or earphones are the open-air type designed to let you hear outside sounds don't turn up the volume so high that you can't hear what's around you.

Sound can be deceiving. Over time your hearing "comfort level" adapts to higher volumes of sound. So what sounds "normal" can actually be loud and harmful to your hearing.

Guard against this by setting your equipment at a safe level BEFORE your hearing adapts.

To establish a safe level:

- Start your volume control at a low setting.
- Slowly increase the sound until you can hear it comfortably and clearly, and without distortion.

Once you have established a comfortable sound level:

- Leave it there.

Maintenance

Clean with a soft, dry cloth.

Do not use any type of abrasive pad, scouring powder or solvent such as alcohol or benzine.

When one of the following messages appears on the display:	
NO CARD	• You haven't inserted a card.
NotSDAUDIO	• There is no SD-audio data on the card.
NO LIST	• You haven't created a playlist.
NO TITLE	• The track or playlist doesn't have a title.
NO INFO.	• There is no information entered for the artist.
NO TRACK	• You haven't checked out tracks for the playlist.
UNFORMAT	• The card isn't formatted.
DATA ERROR	• The data format isn't standard.
LOCKED	• The unit cannot play the card you inserted.
NotPLAY	• Non-AAC, non-MP3, or non-WMA data is on the card. (Appears during play.)
NotDISPLAY	• Text data the unit cannot display is on the card.
NotSUPPORT	• Non-AAC, non-MP3, or non-WMA data is on the card. (Appears on the bitrate display described on page 8.)
U01	• The battery is dead.
NO BATTERY	• You haven't inserted the rechargeable battery into the unit.
ERROR	• An error has occurred. Remove and reinsert the card. If this doesn't correct the display, turn the unit off and on (page 4). If this still doesn't correct the display, try removing and reinserting the battery.
Now Busy	• The unit is manipulating data. Wait a moment.
EMERGENCY STOP	• Because the unit cannot manipulate irregular data on the card, the power is turned off.

*Service in Puerto Rico
Matsushita Electric of Puerto Rico, Inc. Panasonic Sales Company/*

ONLY FOR U.S.A

Panasonic Consumer Electronics Company,
Division of Matsushita Electric Corporation of America
One Panasonic Way Secaucus, New Jersey 07094

Panasonic Sales Company, Division of Matsushita Electric
of Puerto Rico, Inc.

Ave. 65 de Infantería, Km. 9.5
San Gabriel Industrial Park, Carolina, Puerto Rico 00985

Panasonic/Technics Audio Products Limited Warranty

Panasonic Consumer Electronics Company or Panasonic Sales Company (collectively referred to as "the Warrantor") will repair or replace this product with new or refurbished parts or equivalent product, free of charge in the U.S.A. or Puerto Rico, in the event of a defect in materials or workmanship as follows (all time periods commence from the date of original purchase):

AUDIO PRODUCTS—labor and parts for one (1) year.

ALL AUDIO RACKS (cabinets)—parts only 30 days.

TECHNICS STAND ALONE SPEAKERS, SUBWOOFER SPEAKERS—labor and parts for three (3) years.

USB READER-WRITER, PERSONAL COMPUTER CARD ADAPTERS—(when applicable)—exchange defective unit with a new or refurbished one for one (1) year.

ACCESSORIES—HEADPHONES, CARTRIDGES, MICROPHONES, ADAPTERS—labor and parts for ninety (90) days.

RECHARGEABLE BATTERIES—(when applicable)—exchange defective item for new one for ten (10) days. Non-rechargeable batteries are not warranted.

SD MEMORY CARDS, RECHARGEABLE BATTERY PACKS—(when applicable)—exchange defective item for new one for ninety (90) days. Non-rechargeable battery packs are not warranted.

Carry-in or mail-in service in the U.S.A. can be obtained during the warranty period by contacting a Panasonic Services Company (PASC) Factory Servicenter listed in the Servicenter Directory. Or call toll free, 1-800-211-7262 to locate a PASC authorized Servicenter. Carry-in or mail-in service in Puerto Rico can be obtained during the warranty period by calling the Panasonic Sales Company telephone number listed in the Servicenter Directory.

This warranty is extended only to the original purchaser. A purchase receipt or other proof of date of original purchase will be required before warranty service is rendered.

This warranty only covers failures due to defects in materials and workmanship which occur during normal use and does not cover normal wear to the stylus (when applicable) or a dealer installed cartridge or stylus. The warranty does not cover damages which occur in shipment or failures which are caused by products not supplied by the warrantor, or failures which result from accident, misuse, abuse, neglect, mishandling, faulty installation, misapplication, set-up adjustments, maladjustment of consumer controls, improper operation or maintenance, improper antenna, inadequate signal reception or pick-up, alteration, modification, power line surge, improper voltage supply, lightning damage, commercial use, such as; hotel, office, restaurant, or other business or rental use of the product, or service by anyone other than a PASC Factory Servicenter or a PASC authorized Servicenter, or damage that is attributable to acts of God.

LIMITS AND EXCLUSIONS

There are no express warranties except as listed above.

THE WARRANTOR SHALL NOT BE LIABLE FOR INCIDENTAL OR CONSEQUENTIAL DAMAGES RESULTING FROM THE USE OF THIS PRODUCT, OR ARISING OUT OF ANY BREACH OF THIS WARRANTY, INCLUDING WITHOUT LIMITATION, DAMAGE TO TAPES, RECORDS OR DISCS. ALL EXPRESS AND IMPLIED WARRANTIES, INCLUDING THE WARRANTIES OF MERCHANTABILITY, AND FITNESS FOR A PARTICULAR PURPOSE, ARE LIMITED TO THE APPLICABLE WARRANTY PERIOD SET FORTH ABOVE. Some states do not allow the exclusion or limitation of incidental or consequential damages, or limitations on how long an implied warranty lasts, so the above exclusions or limitations may not apply to you.

This warranty gives you specific legal rights and you may also have other rights which vary from state to state.

If a problem with this product develops during or after the warranty period, you may contact your dealer or Servicenter. If the problem is not handled to your satisfaction, then write to the Consumer Affairs Department at the company address indicated above.

If you ship the product

Carefully pack and send it prepaid, adequately insured and preferably in the original carton.

Attach a postage-affixed letter, detailing the complaint, to the outside of the carton.

Do NOT send the product to the Executive or Regional Sales offices. They are NOT equipped to make repairs.

