

Panasonic®



Model No.

SL-SX320/SL-SX315

SL-SX313/SL-SX321C

Portable CD player
Operating Instructions

Dear Customer

Thank you for purchasing this product. Before connecting, operating or adjusting this product, please read these instructions completely. Please keep this manual for future reference.

The model number and serial number of this product can be found on either the back or the bottom of the unit.

Please note them in the space provided below and keep for future reference.
MODEL NUMBER _____
SERIAL NUMBER _____

HOLD

This function causes the unit to ignore accidental button presses. Set to HOLD so the unit doesn't power on accidentally or play is interrupted.

Note on CD-R and CD-RW

This unit can play CD-DA format audio CD-R and CD-RW that have been finalized* upon completion of recording. It may not be able to play some CD-R or CD-RW due to the condition of the recording.

*Finalizing is a process that enables CD-R/CD-RW players to play audio CD-R and CD-RW.

Resume function

The player stores the track where you stopped play or power was cut off. Opening the lid when the unit is in stop mode cancels the function.

Auto power off function

If the unit is left in stop mode for approximately 10 minutes, the unit powers itself off automatically.



Panasonic Consumer Electronics Company,
Division of Matsushita Electric Corporation of America
One Panasonic Way Secaucus, New Jersey 07094 <http://www.panasonic.com>
Panasonic Sales Company,
Division of Matsushita Electric of Puerto Rico, Inc. ("PSC")
Ave. 65 de Infantería, Km. 9.5 San Gabriel Industrial Park, Carolina, Puerto Rico 00985

Panasonic Canada Inc.
5770 Ambler Drive, Mississauga, Ontario L4W 2T3 www.panasonic.ca

© 2002 Matsushita Electric Industrial Co., Ltd.
Printed in China

RQT6789-1P
F1102KN1073

Troubleshooting guide

Before requesting service, make the following checks. If you are in doubt about some of the check points, or if the remedies indicated in the chart do not solve the problem, see "Product information" (→right) for assistance.

No play.	<ul style="list-style-type: none"> •The HOLD function is on (→above). •The disc isn't correctly set. •The disc is scratched or dirty. (Tracks skipped.) •There is moisture on the lens. Wait for about an hour and then try again. •The lens is dirty: clean it with a blower (recommended product: SZZP1038C). If the lens gets marked with fingerprints, gently wipe them off with a cotton swab.
No sound or there is a lot of noise.	<ul style="list-style-type: none"> •Ensure the plugs are inserted firmly. •Wipe the plugs clean with a clean cloth. •The elapsed playing time disappears and sound is interrupted if bumps continue repeatedly. •Separate this unit from mobile telephones.
Play doesn't resume from the track where play stopped at.	<ul style="list-style-type: none"> •This doesn't work if you open the lid while the unit is in stop mode. •This doesn't work during random play. •It may not work correctly under some conditions.
Play doesn't start from the first track.	<ul style="list-style-type: none"> •Random play modes may be on (→page 4). •Play resumes from the track where you last stopped play or power was cut off (play may start from a different track if you change discs after power is cut off). Use skip to return to the first track.
The unit stops working.	Disconnect then reconnect all power sources (batteries and AC adaptor).
The battery indicator fails to appear or is incorrect.	<ul style="list-style-type: none"> •The indicator does not appear when an AC adaptor is connected. •The indicator does not appear correctly under some conditions.

Display

<i>hold</i>	→ The HOLD function is on (→above).
<i>no disc</i>	→ <ul style="list-style-type: none"> •You haven't inserted a disc or it isn't inserted correctly. •You have inserted a disc this unit cannot play.
<i>OPEN</i>	→ The disc lid is open.
<i>F</i>	→ Full: The program already contains 20 tracks.

Product service

- 1. Damage requiring service**—The unit should be serviced by qualified service personnel if:
 - (a) The AC power supply cord or AC adaptor has been damaged; or
 - (b) Objects or liquids have gotten into the unit; or
 - (c) The unit has been exposed to rain; or
 - (d) The unit does not operate normally or exhibits a marked change in performance; or
 - (e) The unit has been dropped or the cabinet damaged.
- 2. Servicing**—Do not attempt to service the unit beyond that described in these operating instructions. Refer all other servicing to authorized servicing personnel.
- 3. Replacement parts**—When parts need replacing ensure the servicer uses parts specified by the manufacturer or parts that have the same characteristics as the original parts. Unauthorized substitutes may result in fire, electric shock, or other hazards.
- 4. Safety check**—After repairs or service, ask the servicer to perform safety checks to confirm that the unit is in proper working condition.

Product information

For product information or assistance with product operation:
In the U.S.A., contact the Panasonic Customer Call Center at 1-800-211-7262, or e-mail consumerproducts@panasonic.com, or the website (<http://www.panasonic.com>).
In Canada, contact the Panasonic Canada Inc. Customer Care Centre at 905-624-5505, or visit the website (www.panasonic.ca), or an authorized Servicentre closest to you.

User memo:

DATE OF PURCHASE _____
DEALER NAME _____
DEALER ADDRESS _____
TELEPHONE NUMBER _____

IMPORTANT SAFETY INSTRUCTIONS

Read these operating instructions carefully before using the unit. Follow the safety instructions on the unit and the safety precautions listed below. Keep these operating instructions handy for future reference.

Safety

- Power source**—Connect the unit to a power source of the type described in these instructions or as marked on the unit.
- Polarization**—The unit is equipped with a polarized power plug where one blade is wider than the other. This safety feature ensures that the plug fits into your household AC outlet only one way. If the plug doesn't fit one way, try reversing it. If the plug still doesn't fit, contact an electrician to replace the obsolete outlet. Do not attempt to defeat the safety purpose of the plug.
- Power cord protection**—Route the AC power supply cord so that it will not be walked on or pinched by items placed on or against it. Never take hold of the plug or cord with wet hands. Always grasp the plug body firmly when connecting and disconnecting it.
- Overloading**—When connecting the AC power supply cord, be careful not to overload the household AC outlet, extension cord, or outlet from any other device as this can result in fire or electric shock.
- Nonuse periods**—Turn the unit off when it is not in use. Unplug the unit from the household AC outlet if it is not to be used for a long time. Unplug the unit during lightning storms. Leaving the unit connected to a household AC outlet for extended periods can cause battery fluid leakage.
- Attachments and accessories**—Use only the attachments and accessories recommended in these operating instructions.

Installation

■ Placement

- Foreign material**—Ensure objects and liquids do not get into the unit. Avoid exposing the unit to excessive smoke, dust, mechanical vibration, and shock.
- Magnetism**—Situate the unit away from equipment and devices that generate strong magnetic fields.
- Stacking**—Do not place anything on top of this unit.
- Wall and ceiling mounting**—Do not mount the unit on walls or ceilings unless specified in the instructions.

■ Environment

- Water and moisture**—Do not use the unit near water, such as near a bathtub or swimming pool. Avoid damp basements.
- Heat**—Situate the unit away from heat sources, such as radiators. Do not leave it in an automobile exposed to direct sunlight with the doors and windows closed as this may deform the cabinet. Do not situate where temperatures fall below 5 °C (41 °F) or rise above 35 °C (95 °F).

Maintenance

Unplug the unit from the household AC outlet before cleaning.
Clean with a damp cloth.
Do not use abrasive pads, scouring powders, or solvents.

Service

- Damage requiring service**—The unit should be serviced by qualified service personnel if:
 - The AC power supply cord or AC adaptor has been damaged; or
 - Objects or liquids have gotten into the unit; or
 - The unit has been exposed to rain; or
 - The unit does not operate normally or exhibits a marked change in performance; or
 - The unit has been dropped or the cabinet damaged.
- Servicing**—Do not attempt to service the unit beyond that described in these operating instructions. Refer all other servicing to authorized servicing personnel.
- Replacement parts**—When parts need replacing ensure the servicer uses parts specified by the manufacturer or parts that have the same characteristics as the original parts. Unauthorized substitutes may result in fire, electric shock, or other hazards.
- Safety check**—After repairs or service, ask the servicer to perform safety checks to confirm that the unit is in proper working condition.

WARNING:

TO REDUCE THE RISK OF FIRE, ELECTRIC SHOCK OR PRODUCT DAMAGE, DO NOT EXPOSE THIS APPARATUS TO RAIN, MOISTURE, DRIPPING OR SPLASHING AND THAT NO OBJECTS FILLED WITH LIQUIDS, SUCH AS VASES, SHALL BE PLACED ON THE APPARATUS.

CAUTION!

THIS PRODUCT UTILIZES A LASER. USE OF CONTROLS OR ADJUSTMENTS OR PERFORMANCE OF PROCEDURES OTHER THAN THOSE SPECIFIED HEREIN MAY RESULT IN HAZARDOUS RADIATION EXPOSURE. DO NOT OPEN COVERS AND DO NOT REPAIR YOURSELF. REFER SERVICING TO QUALIFIED PERSONNEL.

CAUTION: (SL-SX320, SL-SX315 and SL-SX313)

Use only car adaptor, Model: SH-CDC9
manufactured by Matsushita Electric Industrial Co., Ltd.

Marking sign is located on bottom of the unit.

THE FOLLOWING APPLIES ONLY IN THE U.S.A.

CAUTION:

This equipment has been tested and found to comply with the limits for a Class B digital device, pursuant to Part 15 of the FCC Rules.

These limits are designed to provide reasonable protection against harmful interference in a residential installation. This equipment generates, uses and can radiate radio frequency energy and, if not installed and used in accordance with the instructions, may cause harmful interference to radio communications. However, there is no guarantee that interference will not occur in a particular installation. If this equipment does cause harmful interference to radio or television reception, which can be determined by turning the equipment off and on, the user is encouraged to try to correct the interference by one or more of the following measures:

- Reorient or relocate the receiving antenna.
- Increase the separation between the equipment and receiver.
- Connect the equipment into an outlet on a circuit different from that to which the receiver is connected.
- Consult the dealer or an experienced radio/TV technician for help.

Any unauthorized changes or modifications to this equipment would void the user's authority to operate this device.

This device complies with Part 15 of the FCC Rules. Operation is subject to the following two conditions: (1) This device may not cause harmful interference, and (2) this device must accept any interference received, including interference that may cause undesired operation.

ONLY FOR U.S.A.

Panasonic Consumer Electronics Company,
Division of Matsushita Electric Corporation of America
One Panasonic Way Secaucus, New Jersey 07094

Panasonic Sales Company, Division of Matsushita Electric of Puerto Rico, Inc.,
Ave. 65 de Infantería, Km. 9.5
San Gabriel Industrial Park, Carolina, Puerto Rico 00985

Panasonic Audio Products Limited Warranty

Limited Warranty Coverage

If your product listed below does not work properly because of a defect in materials or workmanship, Panasonic Consumer Electronics Company or Panasonic Sales Company (collectively referred to as "the warrantor") will, for the length of the period indicated on the chart below, which starts with the date of original purchase ("warranty period"), at its option either (a) repair your product with new or refurbished parts, or (b) replace it with a new or a refurbished product. The decision to repair or replace will be made by the warrantor.

Product or Part Name	Parts	Labor
Radio, Clock Radio, Radio with Tape Player or Recorder, Portable CD Player, Headphone Stereo, Tape Recorder, Speaker	One (1) Year	One (1) Year
Rechargeable batteries (in exchange for defective item)	Ten (10) Days	Not Applicable
SD Memory Card (in exchange for defective item)	Ninety (90) Days	Not Applicable

During the "Labor" warranty period there will be no charge for labor. During the "Parts" warranty period, there will be no charge for parts. You must mail-in your product during the warranty period. This Limited Warranty excludes both parts and labor for batteries, antennas, and cosmetic parts (cabinet). This warranty only applies to products purchased and serviced in the United States or Puerto Rico. This warranty is extended only to the original purchaser of a new product which was not sold "as is". A purchase receipt or other proof of the original purchase date is required for warranty service.

To obtain service in the USA please contact:

Panasonic Services Company, Panasonic Plus Department
20421 84th Avenue South
Kent, WA 98032
Tel: 1-800-833-9626 Fax: 1-800-237-9080

For assistance in Puerto Rico call Panasonic Sales Company (787)-750-4300 or fax (787)-768-2910.

When shipping the unit carefully pack and send it prepaid, adequately insured and preferably in the original cart. Include a letter detailing the complaint and provide a day time phone number where you can be reached.

Customer Services Directory

For Product Information, Operating Assistance, Literature Request, Dealer Locations, and Customer Service inquiries please visit Web Site:

<http://www.panasonic.com>

You can purchase parts, accessories, locate your nearest servicer and more by visiting our Web Site or E-mail us via web:

http://www.panasonic.com/consumer_electronics/support/customerfeedback.asp

Contact:
1-800-211-PANA (7262),
Monday-Friday 9 am-9 pm; Saturday-Sunday 10 am-7 pm, EST.

For hearing or speech impaired TTY users, TTY: 1-877-833-8855

Accessory Purchases

1-800-332-5368 (Customer Orders Only)
1-800-237-9080 (Fax Only)
(Monday-Friday 9 am to 8 pm, EST.) Panasonic Services Company
20421 84th Avenue South, Kent, WA 98032
(Accepts Visa, MasterCard, Discover Card, American Express, and Personal Check)

For hearing or speech impaired TTY users, TTY: 1-866-605-1277

Service in Puerto Rico
Matsushita Electric of Puerto Rico, Inc. Panasonic Sales Company/Factory Servicer:
Ave. 65 de Infantería, Km. 9.5, San Gabriel Industrial Park,
Carolina, Puerto Rico 00985
Phone (787) 750-4300 Fax (787) 768-2910

Location of controls/Connection to other equipment

Turn off this unit and the other equipment before connection.

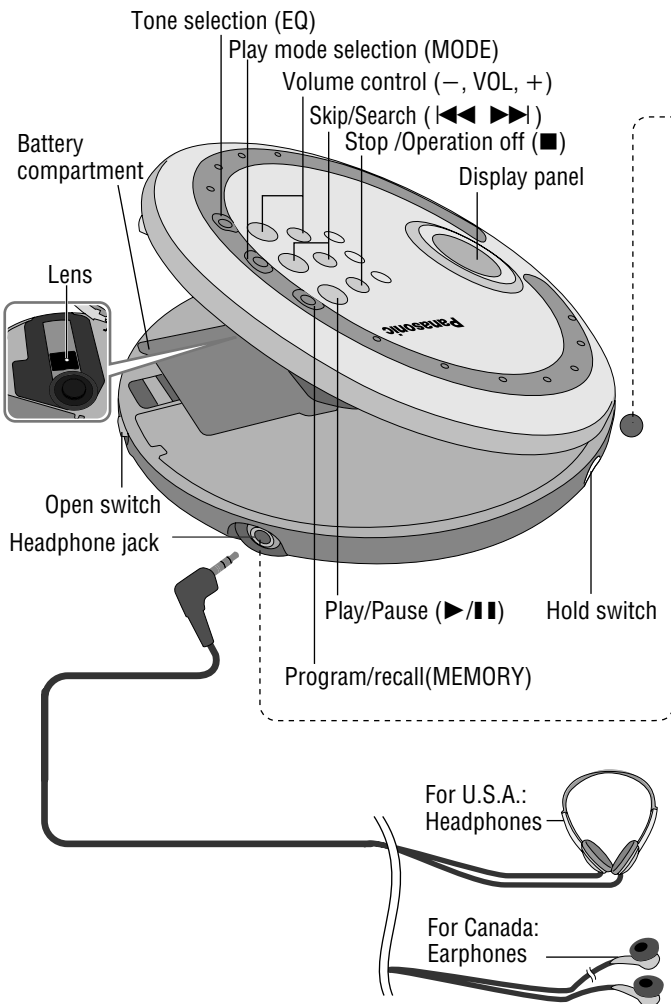

To DC IN jack

AC adaptor (RP-AC46) (not included)

Car power adaptor
(Purchase **SH-CDC9** for SL-SX320, SL-SX315 and SL-SX313)
● When you switch off the car, the volume returns to 10.

To Headphone jack

Car stereo cassette adaptor
(Purchase **SH-CDM10A** for SL-SX320, SL-SX315 and SL-SX313)
● Set the unit's volume to 10.

Audio cable (not included)
● Set the unit's volume to 10.

Household AC outlet

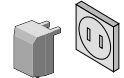

Car audio



Some cannot be connected.

Audio system

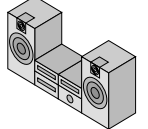

Adjust the volume level on the audio system.

Supplied Accessories

Check the packing carton for these accessories.

For U.S.A.

● 1 Pair of stereo headphones:

SL-SX320 SL-SX313 SL-SX321C

LOBAD0000162

SL-SX315

LOBAD0000157

For Canada

● 1 Pair of stereo earphones:

LOBAB0000123

SL-SX321C ONLY

● 1 Car power adaptor:

SH-CDC12PEY

● 1 Car stereo cassette adaptor:

SHCDM10B1PYK

Use numbers indicated when ordering replacements or optional accessories from your Panasonic dealer.

In U.S.A. contact 1-800-332-5368 or the website (<http://www.panasonic.com>).

Power Supply

Dry cell batteries (not included)

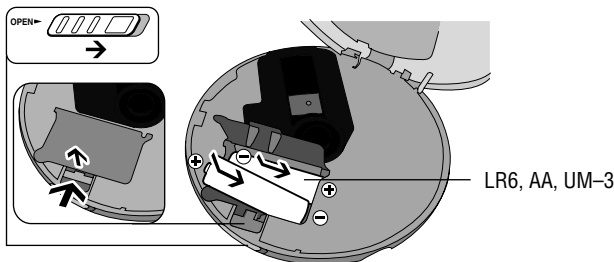

- Fit the battery lid so it is secure and flush with the battery compartment if it comes loose, otherwise it can scratch your discs.
- To remove the batteries, lift from the left.
- Play time: About 33 hours

Rechargeable batteries (not included)

- If rechargeable batteries are to be used, rechargeable batteries manufactured by Panasonic are recommended.
- This unit cannot recharge batteries. The battery indicator will not function correctly when using rechargeable batteries.

The battery indicator

This indicator appears when the unit is on.

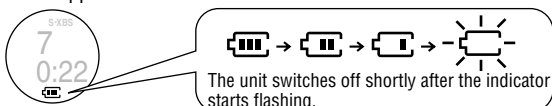

- Before playing starts the battery indication may flash although the batteries are not drained. This is normal.

Car adaptor

The SL-SX321C comes with a car adaptor. (Refer to the separate installation instructions.) Be sure to obtain the car power adaptor (SH-CDC9) for SL-SX320, SL-SX315 and SL-SX313 available as an optional accessory.

How to Use

Playback

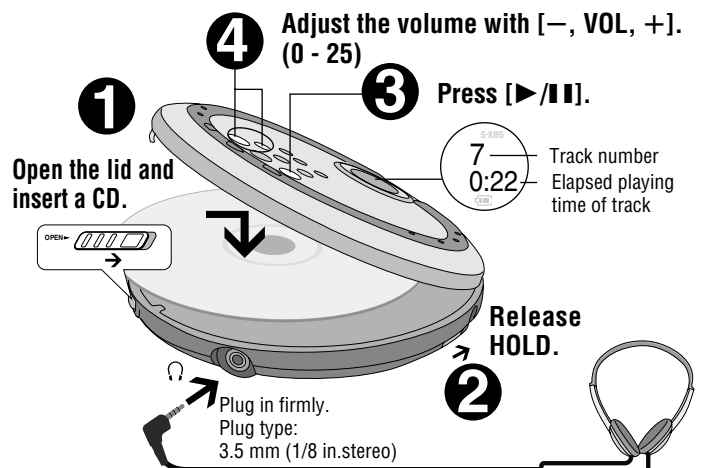

- The volume returns to 10 when you disconnect the power source.

(Earphones for Canada)

Pause



- Press again to restart play.

Search



- You can search only within the current track during program, one-track repeat, or random play modes (↔ page 4).

Stop



- Press again to turn the unit off.

Skip



- Press [I<<<] twice to skip to the beginning of the previous track during play.

Other Play Methods

Program Play

- 1 Select the tracks while stopped.



- 2 Press to register.

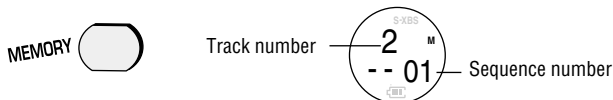

- 3 Repeat steps 1 and 2 to register up to 20 tracks.

- 4 Start play.



- To confirm the contents of the program
Press [MEMORY] while the disc is playing.
- To delete the entire program
Press [■].

Changing the sound quality

Each time you press [EQ]

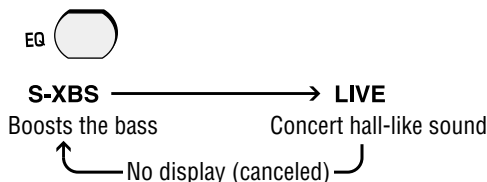

- The effect may differ between different kinds of music.

Caution

Batteries

- Do not peel off the covering on batteries and do not use if the covering has been peeled off.
- Align the poles + and - correctly when inserting the batteries.
- Do not mix different types of batteries or old and new batteries.
- Remove the batteries if you do not intend to use the unit for a long time.
- Do not throw into fire, short-circuit, disassemble, or subject to excessive heat.
- Do not attempt to recharge dry cell batteries.
- When carrying batteries in a pocket or bag, ensure no metal objects such as necklaces are placed together with them. Contact with metal may cause short-circuiting which can cause a fire.

CDs

- Do not use irregularly shaped CDs.
- Do not use non-specification discs.
- Do not use CDs printed with label printers available on the market.
- Do not use CDs with labels and stickers that are coming off or with adhesive exuding from under labels and stickers.

Listening



Do not play your headphones or earphones at a high volume. Hearing experts advise against continuous extended play.

If you experience a ringing in your ears, reduce volume or discontinue use.

Do not use while operating a motorized vehicle. It may create a traffic hazard and is illegal in many areas.

You should use extreme caution or temporarily discontinue use in potentially hazardous situations.

Even if your headphones or earphones are the open-air type designed to let you hear outside sounds, don't turn up the volume so high that you can't hear what's around you.

Sound can be deceiving. Over time your hearing "comfort level" adapts to higher volumes of sound. So what sounds "normal" can actually be loud and harmful to your hearing.

Guard against this by setting your equipment at a safe level BEFORE your hearing adapts.

To establish a safe level:

- Start your volume control at a low setting.
- Slowly increase the sound until you can hear it comfortably and clearly, and without distortion.

Once you have established a comfortable sound level:

- Leave it there.

Allergies

Discontinue use if you experience discomfort with the earphones or any other parts that directly contact your skin. Continued use may cause rashes or other allergic reactions.

Play modes

Each time you press [MODE]

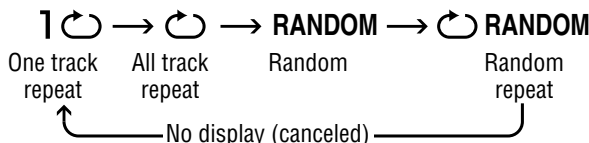

- You cannot skip back to other tracks during random play.

Anti-Skip System

This system reduces the skipping caused by vibration to a minimum. You can change the anti-skip memory time to improve sound quality.

Each time you press and hold [MODE]



POS2 ← → POS1

Better sound quality,
10-second anti-skip memory

Normal sound quality,
45-second anti-skip memory

Specifications

Audio

No. of channels:
2 (left and right, stereo)

Frequencies response:
20 to 20,000 Hz
(+0 dB to -7 dB)

DA converter: 1 bit, MASH

Headphone output level:
RMS max. 6 mW+6 mW/
16 Ω (adjustable)

Pickup

Light source: Semiconductor laser
Wavelength: 780 nm

General

Power supply:
DC input (via optional AC adaptor):
DC 4.5 V

Operational temperature range:
0 °C-40 °C
(32 °F-104 °F)

Play time:

[When used in hold mode with EQ canceled, at 25 °C (77 °F) on a flat, stable surface]
2 optional alkaline batteries:
About 33 hours

- The play time may be less depending on the operating conditions.
- Play time will be considerably reduced when playing CD-RW.

Dimensions (W×H×D):

135×27.7×135 mm
(5⁵/₁₆"×1¹/₁₆"×5⁵/₁₆"

Mass:
206 g (7.3 oz.)
(with batteries)
160 g (5.6 oz.)
(without batteries)

Note:

Specifications are subject to change without notice.

Mass and dimensions are approximate.