

Concerning Compact Discs



Only compact discs bearing this mark can be used with this unit.

However, continued use of irregular shaped CDs can damage the unit.



How to remove a disc from its case **How to store the disc in its case**



How to hold a disc



If the surface is dirty

Wipe it with a damp cloth and then wipe dry.

Wipe from the center toward the outer circumference.



Handling precautions

- If you are taking the CD from a cold to a warm environment, moisture may form on the CD. Wipe this off with a soft, dry, lint-free cloth before using the CD.
- Do not write on the label side with a ball-point pen or other writing instrument.
- Do not use record cleaning sprays, benzene, thinner, static electricity prevention liquids or any other solvent.
- Do not attach labels or stickers to CDs. (Do not use CDs with exposed adhesive from tape or left over peeled off stickers.)

- Do not use scratch-proof protectors etc.

Storage precautions

Be sure to store CDs in their cases to protect them from dust, scratches, and warping.

Do not place or store CDs in the following places

- Locations exposed to direct sunlight
- Humid or dusty locations
- Locations directly exposed to a heat vent or heating appliance
- In the glove compartment or on the rear deck of an automobile

Portable CD player

Panasonic®

Dear Customer

Thank you for purchasing this product. For optimum performance and safety, please read these instructions carefully.

Operating Instructions

Model No. SL-CT489V



The model number and serial number of this product can be found on either the back or the bottom of the unit.

Please note them in the space provided below and keep for future reference.

MODEL NUMBER SL-CT489V
SERIAL NUMBER _____



Supplied Accessories

Check the packing carton for these accessories.

For U.S.A.

Stereo headphones . . . 1 (RFEV716P-KS)
"AA" (LR6) batteries . . . 2
"AAA" (LR03) batteries . . . 2

For Canada

Stereo earphones . . . 1 (LOBAB0000165)
Wired remote control . . . 1 (N2QCB000011)
Adaptor . . . 1 (RFA1631-H)

Use numbers indicated in parentheses when asking for replacement parts.
(Only for U.S.A.) To order accessories contact 1-800-332-5368 or web site (<http://www.panasonic.com>).

Before connecting, operating or adjusting this product, please read these instructions completely. Please keep this manual for future reference.



Panasonic Consumer Electronics Company,
Division of Matsushita Electric Corporation of America

One Panasonic Way Secaucus, New Jersey 07094 <http://www.panasonic.com>

Panasonic Sales Company, Division of Matsushita Electric of Puerto Rico, Inc. ("PSC")
Ave. 65 de Infantería, Km. 9.5 San Gabriel Industrial Park, Carolina, Puerto Rico 00985

Panasonic Canada Inc.
5770 Ambler Drive, Mississauga, Ontario L4W 2T3 www.panasonic.ca

© 2001 Matsushita Electric Industrial Co., Ltd.



RQT5983-P
F0401YH0
Printed in Japan

IMPORTANT SAFETY INSTRUCTIONS

Read these operating instructions carefully before using the unit. Follow the safety instructions on the unit and the safety precautions listed below. Keep these operating instructions handy for future reference.

Safety

- 1. Power source**—Connect the unit to a power source of the type described in these instructions or as marked on the unit.
- 2. Polarization**—The unit is equipped with a polarized power plug where one blade is wider than the other. This safety feature ensures that the plug fits into your household AC outlet only one way. If the plug doesn't fit one way, try reversing it. If the plug still doesn't fit, contact an electrician to replace the obsolete outlet. Do not attempt to defeat the safety purpose of the plug.
- 3. Power cord protection**—Route the AC power supply cord so that it will not be walked on or pinched by items placed on or against it. Never take hold of the plug or cord with wet hands. Always grasp the plug body firmly when connecting and disconnecting it.
- 4. Overloading**—When connecting the AC power supply cord, be careful not to overload the household AC outlet, extension cord, or outlet from any other device as this can result in fire or electric shock.
- 5. Nonuse periods**—Turn the unit off when it is not in use. Unplug the unit from the household AC outlet if it is not to be used for a long time. Unplug the unit during lightning storms. Leaving the unit connected to a household AC outlet for extended periods can cause battery fluid leakage.
- 6. Attachments and accessories**—Use only the attachments and accessories recommended in these operating instructions.

Installation

Placement

- 1. Foreign material**—Ensure objects and liquids do not get into the unit. Avoid exposing the unit to excessive smoke, dust, mechanical vibration, and shock.
- 2. Magnetism**—Situate the unit away from equipment and devices that generate strong magnetic fields.
- 3. Stacking**—Do not place anything on top of this unit.
- 4. Wall and ceiling mounting**—Do not mount the unit on walls or ceilings unless specified in the instructions.

Environment

- 1. Water and moisture**—Do not use the unit near water, such as near a bathtub or swimming pool. Avoid damp basements.
- 2. Heat**—Situate the unit away from heat sources, such as radiators. Do not leave it in an automobile exposed to direct sunlight with the doors and windows closed as this may deform the cabinet. Do not situate where temperatures fall below 5 °C (41 °F) or rise above 35 °C (95 °F).

Maintenance

(See page 5 for details.)
Unplug the unit from the household AC outlet before cleaning.
Clean with a damp cloth.
Do not use abrasive pads, scouring powders, or solvents.

Service

- 1. Damage requiring service**—The unit should be serviced by qualified service personnel if:
 - (a) The AC power supply cord or AC adaptor has been damaged; or
 - (b) Objects or liquids have gotten into the unit; or
 - (c) The unit has been exposed to rain; or
 - (d) The unit does not operate normally or exhibits a marked change in performance; or
 - (e) The unit has been dropped or the cabinet damaged.
- 2. Servicing**—Do not attempt to service the unit beyond that described in these operating instructions. Refer all other servicing to authorized servicing personnel.
In the U.S.A., contact the Panasonic Customer Call Center at 1-800-211-7262, or e-mail consumerproducts@panasonic.com, or web site (<http://www.panasonic.com>).
In Canada, contact Panasonic Canada Inc. Customer Care Centre at 905-624-5505, web site (www.panasonic.ca), or an authorized Servicentre closest to you.
- 3. Replacement parts**—When parts need replacing ensure the servicer uses parts specified by the manufacturer or parts that have the same characteristics as the original parts. Unauthorized substitutes may result in fire, electric shock, or other hazards.
- 4. Safety check**—After repairs or service, ask the servicer to perform safety checks to confirm that the unit is in proper working condition.



This manual was printed with soy based ink.

Power Supply Preparations

Refer to the specifications (page 8) for information on operating times when using rechargeable batteries or dry cell batteries.

Using the dry cell batteries

Important note about the memory and the power supply

To preserve the contents of the memory, ensure the unit has a constant supply of power.

- Turn the unit off before changing the batteries and before connecting or disconnecting the AC adaptor.
- The unit can maintain the memory without power for about one minute. Change batteries or reconnect the AC adaptor within this time.
- As a precaution, insert batteries even when using the AC adaptor or car adaptor.

Insert two "AA" (LR6) alkaline batteries or two "AAA" (LR03) alkaline batteries using the supplied adaptor.

When using "AA" (LR6) batteries

1 Insert the batteries.

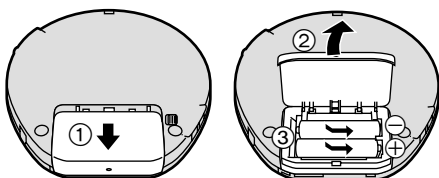

2 Close the battery lid.

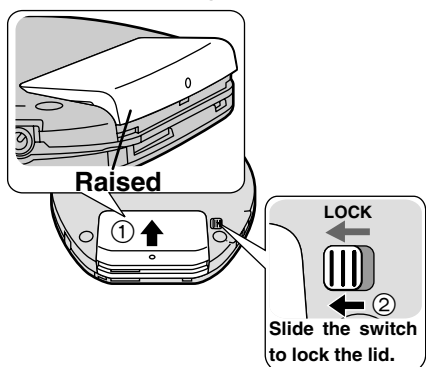

When using "AAA" (LR03) batteries

1 Insert the adaptor.

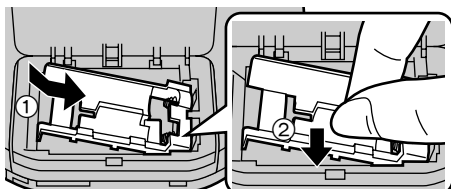

Reverse the above procedure to remove the adaptor.

2 Insert the batteries.

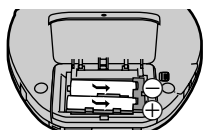

3 Close the battery lid.

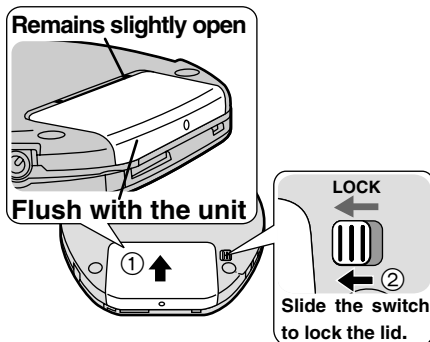

If the battery lid comes loose

Slide the lid back into place horizontally.

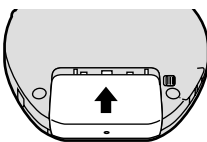

Removing batteries

Push up on the battery in the direction indicated by the arrow. Then lift it out. (Remove "AAA" (LR03) batteries in the same way.)

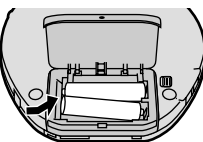

Using the AC adaptor (not included)

For U.S.A

To order the optional AC adaptor **RP-AC46** contact 1-800-332-5368 or web site (<http://www.panasonic.com>).

For Canada

Be sure to obtain the optional AC adaptor **RP-AC46**. It is available through your Panasonic dealer.

Connect the AC adaptor.

DC IN jack (DC IN 4.5 V \diamond \ominus \oplus)

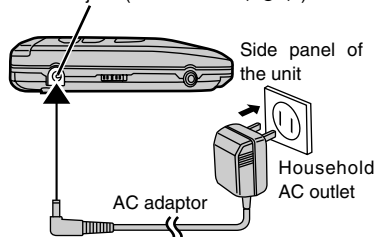

Conserving power

To save power when the unit is not to be used for a long time, unplug the AC adaptor from the household AC outlet.

Using the rechargeable batteries (not included)

Recharge the batteries before use.

Use either "AA" batteries or, by inserting the supplied adaptor, "AAA" batteries. This unit cannot recharge batteries other than those especially designed for it.

Obtain the optional rechargeable batteries:

"AA" rechargeable Ni-Cd batteries: P-3GAVA/2B

"AAA" nickel-metal hydride rechargeable batteries: HHR-4AHA/2B

Charging procedure

1 Insert the rechargeable batteries.

(Refer to "Using the dry cell batteries".)

2 Connect the AC adaptor.

(Refer to "Using the AC adaptor".)

Recharging starts and the "CH" charging indicator flashes on the unit's display. The indicator goes out when charging is complete.

3 When charging is complete, unplug the AC adaptor from the household AC outlet and DC IN jack.

- Never mix dry cell and rechargeable batteries.
- Turn the unit off before replacing the rechargeable batteries.

Note

- Rechargeable batteries have a service life of approximately 300 charge-discharge cycles. The batteries have reached the end of their operational life if they last for a noticeably shorter time after recharging, or if they cannot be recharged at all. Replace the batteries.
- Recharging may only be performed when the unit is powered off.
- The AC adaptor and rechargeable batteries may become warm while recharging is in progress. This is not a malfunction.
- Leaving the AC adaptor connected can cause the batteries to go flat. After recharging the batteries and disconnecting the AC adaptor from the household AC outlet, ensure you disconnect the AC adaptor from the unit's [DC IN 4.5 V \diamond \ominus \oplus] terminal.

When the battery indicator flashes

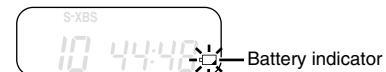

This indicator flashes when the batteries are almost out of power. Power is cut off completely a short while later.

Rechargeable batteries: Recharge batteries.

Dry-cell batteries: Replace batteries with new ones.

Note

- The length of time the unit will continue to operate between when the battery indicator starts flashing and when the power is cut off differs depending on the type of batteries used.
- The battery indicator may not be displayed if rechargeable batteries other than those designated by Panasonic are used.

Using the car adaptor (not included)

Be sure to obtain the car adaptor (SH-CDC9), available as an optional accessory.

CAUTION:

Use only car adaptor, Model: SH-CDC9 manufactured by Matsushita Electric Industrial Co., Ltd.

The car adaptor can be used to recharge the unit's batteries while in the car.

If the unit malfunctions or freezes during use, disconnect the power source (the AC adaptor or batteries).

Re-connect the power source and continue operation.

HOLD function

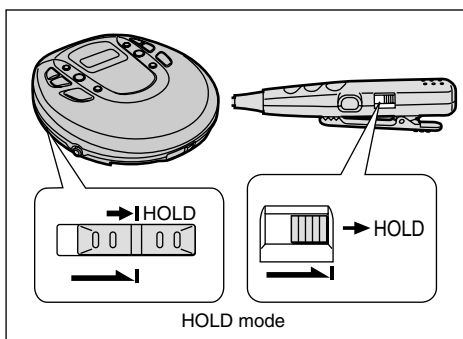

This function causes the unit to ignore accidental button presses. (The disc lid can still be opened and closed.)

The HOLD function prevents the following:

- The unit is powered on accidentally when not in use, causing the batteries to run down.
- A button is accidentally pressed during play, interrupting the operation.

To use the HOLD function

Set [HOLD] to the HOLD position.

The unit and wired remote control have HOLD functions, each of which works independently.

"hold" indication

When the main unit is in HOLD mode, pressing any button causes the indication "hold" to appear on the display.

When the unit is powered off

The "hold" indication appears only when [▶||] or [RADIO/BAND] is pressed.

Before operating the buttons

Be sure to move [HOLD] to release the unit from the HOLD mode.

Listening to CDs Basic Play

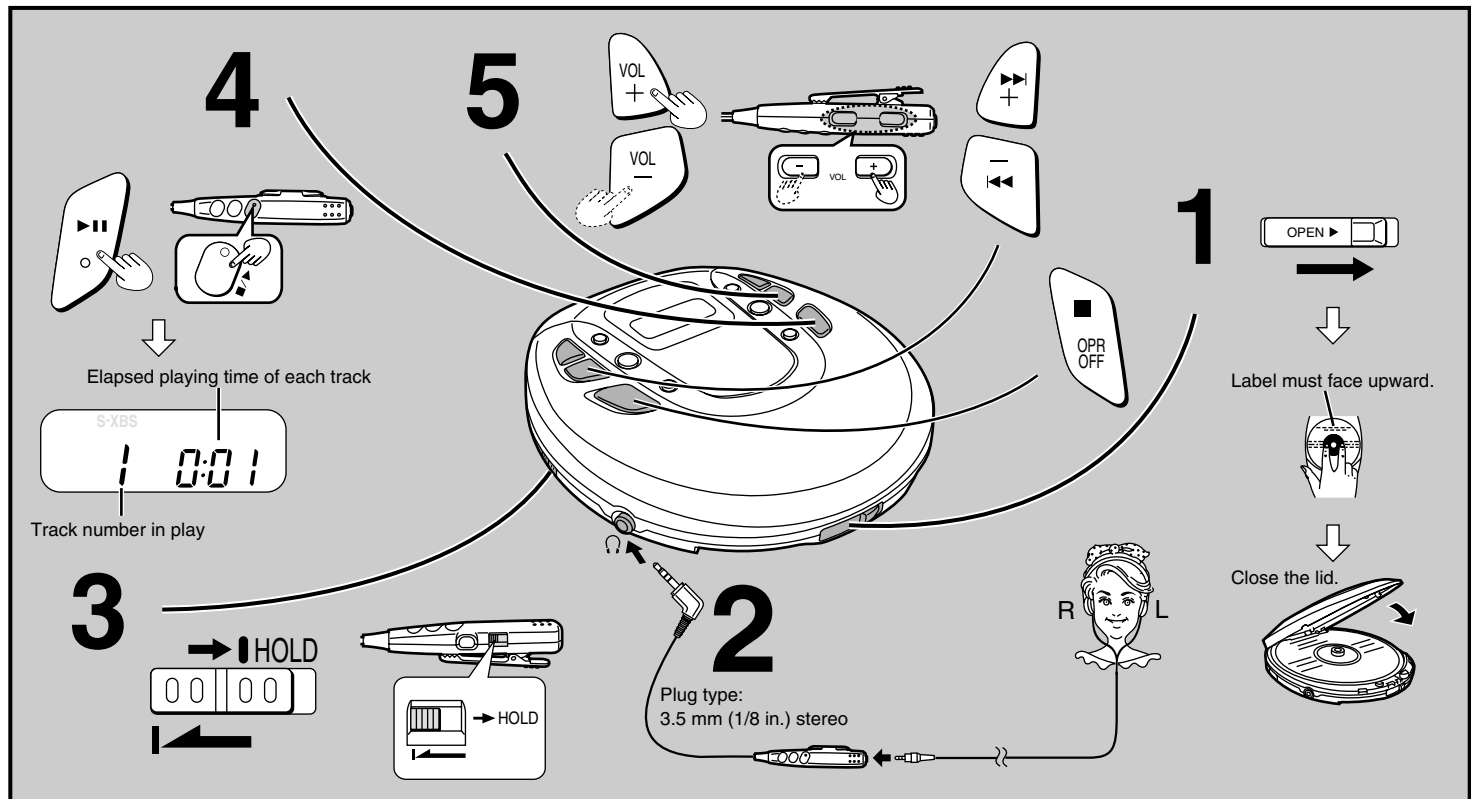

- 1** Slide [OPEN▶] to open the lid, and insert the disc.
- 2** Connect the wired remote control and the stereo headphones/stereo earphones to [🎧]. (Plug in firmly.)
- 3** Release [HOLD].
- 4** Press [▶||] (main unit) or press [▶/▶] (remote control) to start play. (Play stops automatically when all the tracks have been played.)

- 5** Adjust the volume.
 - + : To increase the volume level
 - : To decrease the volume level
 - The volume range is 0-25. (Press and hold to change the volume successively.)
 - A tone (beep-beep) sounds when you reach the minimum or maximum volume when using the remote control.
 - The volume changes when pressed while the level is displayed. If any other display is shown, it changes to show the current level. (The volume returns to 10 when you disconnect the power source.)
 - If the unit has been connected to the car audio system, set this unit's volume to 10, then adjust the volume level on the system.

■ To pause play (main unit only)

Press during play.
(Press again to restart play.)

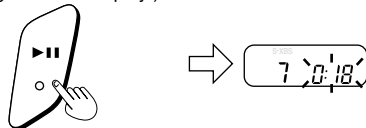

■ To stop play Stop mode

Press during play.



■ To turn off the unit Off mode

Press during stop mode (main unit) or press and hold during play or stop mode (remote control).

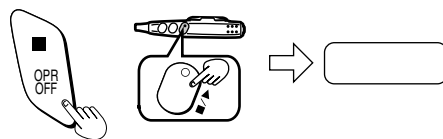

The resume function remains active.

■ Skip / Search function

Skip : Press during play. (Press [- ◀◀] (main unit) or [◀◀] (remote control) twice to skip to the beginning of the previous tracks.)

Search : Press and hold during play.

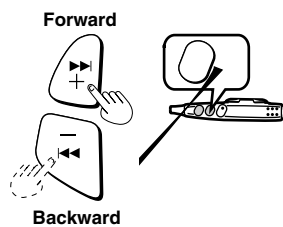

- During program play (page 4), these buttons are used to skip forward or backward through the programmed sequence of tracks.
- You cannot skip to tracks that have been played in random or random repeat play (page 4).
- During program play, 1-track repeat play, random play and random repeat play (page 4), search operation is limited to the current track only.

For your reference:

“no disc” indication

This indication appears for about 30 seconds if [▶||] (main unit) or [▶/▶] (remote control) is pressed when no disc is loaded in the unit or if the disc is not properly secured.

“OP ER” indication

This indication appears for about 10 minutes when the lid is opened. (However, the indication does not appear when the unit is powered off.)

Resume function notes

- Opening the lid while in the stop mode or replacing the disc while in the off mode cancels the function. (It may remain active if you replace a disc in the off mode.)
- Play may resume from the beginning of the next track if you stopped play near the end of a track.
- The resume function is automatic and you cannot turn it off.

Removing discs

- 1** Press [■, OPR OFF] to stop play and disc rotation.
- 2** Slide [OPEN▶] to open the lid.
- 3** Press [PUSH] to release the disc.

Do not stop the disc by hand or try to remove it before it stops rotating. This can damage CDs.

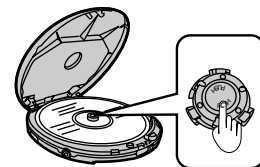

Note

Never insert foreign objects into the unit.

Auto-off function

If you leave the unit in stop mode for about 10 minutes (30 seconds if disc is not loaded), it turns off to save the batteries.

Note on CD-R and CD-RW

This unit can play CD-DA format audio CD-R and CD-RW that have been finalized* upon completion of recording. It may not be able to play some CD-R or CD-RW due to the condition of the recording.

*Finalizing is a process that enables CD-R/CD-RW players to play audio CD-R and CD-RW.

Listening to CDs Other Play Methods

The letters such as **B** in the various illustrations refer to the descriptions in the "Location of Controls" section.

Skip play

The disc plays from the specified track through to the end, then play stops automatically.

Preparation: Put unit in stop mode.

1 Select the desired track.

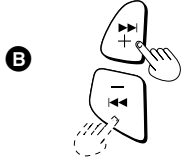

2



Program play

Up to 24 tracks can be entered in the programmed sequence.

Preparation: Put unit in stop mode.

1 Select the desired track.

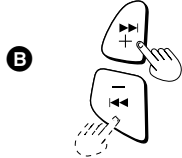

2 Register in sequence.

(The indication "M" and the programmed sequence appear on the display.)



3 Repeat steps 1 and 2 to program all the desired tracks.

4



■ **To program the same track in the sequence more than once**

After step 2, press [MEMORY/RECALL] the desired number of times.

■ **If "f" is displayed**

No more tracks can be programmed.

■ To confirm the contents of the program

Press [MEMORY/RECALL] while the disc is playing. (The numbers of the programmed tracks appear on the display in sequence.)

■ To delete the entire programmed sequence

Press [OFF].

Note

The repeat and random play modes are canceled after steps 1 and 2.

Repeat play/Random play

Press during play or stop mode.

Each time the button is pressed;

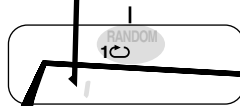

1 (1-track repeat)

One track is repeated.

(All-track repeat)

All the tracks on the disc are repeated.

RANDOM (Random)

The tracks play once each in random order and then play stops.

RANDOM, (Random repeat)

The tracks play repeatedly in random order.

When pressed during program play

Each time the button is pressed;

1 M (1-track repeat)

One track is repeated.

M (Memory repeat)

The programmed tracks are repeated.

Note

• You can select the first track to play in random play and random repeat play by pressing [1] while the disc is stopped. All the tracks are played.

• You cannot select random play or random repeat play during program play.

• The mode is canceled when you disconnect the power source.

Changing the sound quality

Press during play or stop mode.



Each time the button is pressed;

"S-XBS" → " " (Cancel)

S-XBS:

Select this setting to boost the low-range response.

Note

The setting returns to S-XBS when you disconnect the power source.

Using the Unit with Optional Accessories

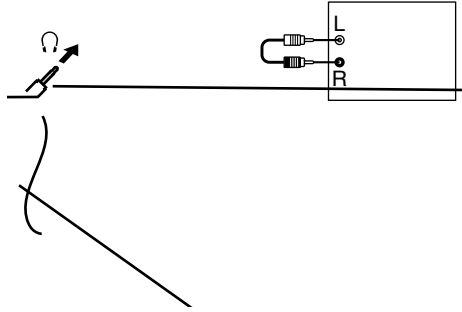

Panasonic Consumer Electronics Company,
Division of Matsushita Electric Corporation of America
One Panasonic Way Secaucus, New Jersey 07094

Panasonic Sales Company, Division of Matsushita
Electric of Puerto Rico, Inc.
Ave. 65 de Infantería, Km. 9.5
San Gabriel Industrial Park, Carolina, Puerto Rico 00985

Panasonic Portable Audio Limited Warranty

Memory Mode

Important

After putting stations into channels, ensure the unit has a constant power supply. Leaving it without batteries or AC power for more than one minute can clear the memory.

■ **Recalling preset stations**

Preparation:



■

■

■

Listening to the Radio

The letters such as ❶ in the various illustrations refer to the descriptions in the "Location of Controls" section. (See page 4.)

To obtain good reception

AM

Try various directions to obtain optimum reception.

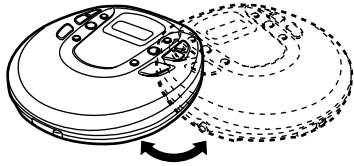

Note

The AM antenna is located in the lid of the unit so noise may increase if the unit is held. This is not malfunction.

FM

The headphone/earphone cord is also the FM antenna, so extend it rather than leaving it coiled.

How to receive an FM broadcast clearly

Press for more than 1.5 seconds during FM reception.

(main unit only)

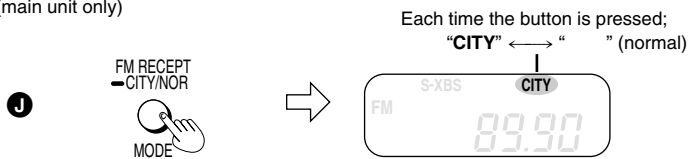

Leave off under normal conditions. Set to "CITY" if reception is poor or if there is interference from another station.

To select stereo or monaural FM

Press during FM reception.

(main unit only)

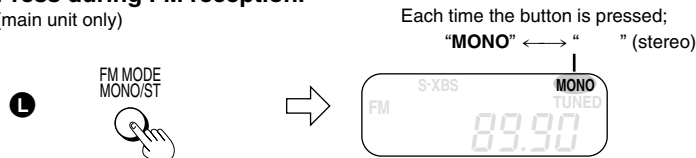

When there is noise during FM reception

Select "MONO".

Sound becomes monaural, but noise is reduced.

Product Service

Do not attempt to remove the cover(s) or repair the unit yourself. Refer servicing to qualified personnel only.

Product information

For product service, product information or assistance with product operation: In the U.S.A., contact the Panasonic Customer Call Center at 1-800-211-7262, or e-mail consumerproducts@panasonic.com, or web site (<http://www.panasonic.com>). In Canada, contact Panasonic Canada Inc. Customer Care Centre at 905-624-5505, web site (www.panasonic.ca), or an authorized Servicentre closest to you.

User memo:

DATE OF PURCHASE _____
 DEALER NAME _____
 DEALER ADDRESS _____
 TELEPHONE NUMBER _____



The product you have purchased is powered by a nickel-cadmium battery which is recyclable. Please call 1-800-8-BATTERY for information on how to recycle this battery.

When using overseas

(main unit only)

Change the frequency step according to the area.

Preparation: Press [RADIO/BAND] to switch on the power.

1 Press for more than 5 seconds to display the step.

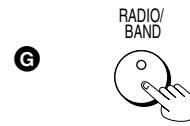

2 Within 10 seconds

Press to select the step.

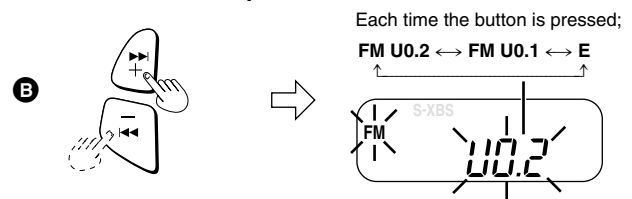

FM U0.2 (original setting) : FM 0.2 MHz, AM 10 kHz

FM U0.1 : FM 0.1 MHz, AM 10 kHz

E : FM 0.05 MHz, AM 9 kHz

3 Within 10 seconds

Press and hold until the frequency is displayed to confirm the step.

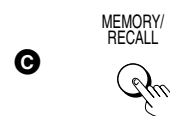

To return to the previous frequency step

Repeat the above procedure.

Note

Converting the allocation erases the stations previously stored in memory.

Changing the sound quality

The operation is the same as when playing CDs. (See page 4.)

CAUTION!

THIS PRODUCT UTILIZES A LASER. USE OF CONTROLS OR ADJUSTMENTS OR PERFORMANCE OF PROCEDURES OTHER THAN THOSE SPECIFIED HEREIN MAY RESULT IN HAZARDOUS RADIATION EXPOSURE. DO NOT OPEN COVERS AND DO NOT REPAIR YOURSELF. REFER SERVICING TO QUALIFIED PERSONNEL.

WARNING:

TO REDUCE THE RISK OF FIRE, ELECTRIC SHOCK OR PRODUCT DAMAGE, DO NOT EXPOSE THIS APPLIANCE TO RAIN, SPLASHING, DRIPPING OR MOISTURE.

THE FOLLOWING APPLIES ONLY IN THE U.S.A.

CAUTION:

This equipment has been tested and found to comply with the limits for a Class B digital device, pursuant to Part 15 of the FCC Rules.

These limits are designed to provide reasonable protection against harmful interference in a residential installation. This equipment generates, uses and can radiate radio frequency energy and, if not installed and used in accordance with the instructions, may cause harmful interference to radio communications. However, there is no guarantee that interference will not occur in a particular installation. If this equipment does cause harmful interference to radio or television reception, which can be determined by turning the equipment off and on, the user is encouraged to try to correct the interference by one or more of the following measures:

- Reorient or relocate the receiving antenna.
- Increase the separation between the equipment and receiver.
- Connect the equipment into an outlet on a circuit different from that to which the receiver is connected.
- Consult the dealer or an experienced radio/TV technician for help.

Any unauthorized changes or modifications to this equipment would void the user's authority to operate this device.

This device complies with Part 15 of the FCC Rules. Operation is subject to the following two conditions: (1) This device may not cause harmful interference, and (2) this device must accept any interference received, including interference that may cause undesired operation.

Specifications

CD SECTION

■Audio

No. of channels: 2 (left and right, stereo)
 Frequency response: 20 to 20,000 Hz
 (+0 dB to -8 dB)
 DA converter: 1 bit, MASH
 Headphone
 output level: RMS max. 6 mW+6 mW/
 16 Ω (adjustable)

■Pickup

Light source: Semiconductor laser
 Wavelength: 780 nm

RADIO SECTION

■Frequency

Radio frequency: **FM**; 87.90–107.90 MHz
 (0.20 MHz steps)
 87.50–108.00 MHz
 (0.10 MHz/0.05 MHz steps)
AM; 520–1710 kHz
 (10 kHz steps)
 522–1629 kHz
 (9 kHz steps)

GENERAL

Power supply: DC 4.5 V with optional
 AC adaptor RP-AC46

Dimensions (W×H×D):
 131×27.4 (32.7 with AA batteries)×135.7 mm
 5¹/₂"×1¹/₂" (1¹/₂"×5¹/₂"

Mass: 210 g (7.4 oz.) (with AAA batteries)
 234 g (8.3 oz.) (with AA batteries)
 187 g (6.6 oz.) (without batteries)

Operational temperature
 range: 0 °C–40 °C
 (32 °F–104 °F)

Rechargeable temperature
 range: 5 °C–40 °C
 (41 °F–104 °F)

- Rechargeable batteries are optional.
- The play time may be less depending on the operating conditions.
- Play time will be considerably reduced when playing CD-RW.

Recharging time
 P-3GAVA/2B About 5 hours
 HHR-4AHA/2B About 5 hours

Note:
 Specifications are subject to change without notice.
 Mass and dimensions are approximate.

Troubleshooting Guide

Before requesting service, make the below checks. If you are in doubt about some of the check points, or if the remedies indicated in the chart do not solve the problem:

In the U.S.A., contact the Panasonic Customer Call Center at 1-800-211-7262, or e-mail consumerproducts@panasonic.com, or web site (<http://www.panasonic.com>).

In Canada, contact Panasonic Canada Inc. Customer Care Centre at 905-624-5505, web site (www.panasonic.ca), or an authorized Servicentre closest to you.

Problem	Check this
Cannot close the lid.	Is the disc properly secured in place?
Cannot play discs.	<ul style="list-style-type: none"> ●Is the unit in HOLD mode? ●Is the disc properly secured in place? ●Is the disc dirty or scratched? ●Is there condensation on the lens? (Wait for about an hour and then try again.)
Tracks on disc do not play in order, starting with the first track.	<ul style="list-style-type: none"> ●Is the random play mode on? ●Did you stop play in the middle of the disc last time?
Cannot hear music—too noisy.	<ul style="list-style-type: none"> ●Are the headphones/earphones and wired remote control plugs inserted all the way? ●Are the plugs dirty? (Wipe away dirt on plug.) ●Separate the unit from mobile phones.
TV picture is distorted. Radio reception is noisy.	Are you using the unit too near a TV or tuner? (Keep the unit away from the TV or tuner.)
No reception. The FM frequency range is different.	Has the frequency step been set for your area?

Cautions

Listening caution

Do not play your headphones or earphones at a high volume. Hearing experts advise against continuous extended play.

If you experience a ringing in your ears, reduce volume or discontinue use.

Do not use while operating a motorized vehicle. It may create a traffic hazard and is illegal in many areas.

You should use extreme caution or temporarily discontinue use in potentially hazardous situations.

Even if your headphones or earphones are the open-air type designed to let you hear outside sounds, don't turn up the volume so high that you can't hear what's around you.

Sound can be deceiving. Over time your hearing "comfort level" adapts to higher volumes of sound. So what sounds "normal" can actually be loud and harmful to your hearing.

Guard against this by setting your equipment at a safe level BEFORE your hearing adapts.

To establish a safe level:

- Start your volume control at a low setting.
- Slowly increase the sound until you can hear it comfortably and clearly, and without distortion.

Once you have established a comfortable sound level:

- Leave it there.