

***Proctor-Silex®***

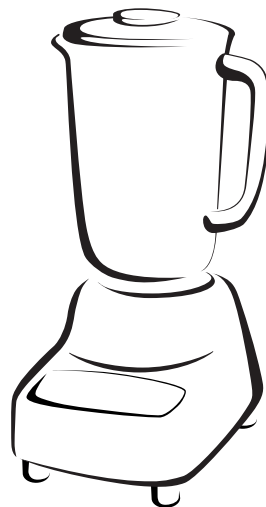

**Use & Care for Blenders..... 2**

USA: 1-800-851-8900 — We invite you to carefully read  
this instruction manual before using your appliance.

840086000

## IMPORTANT SAFEGUARDS

When using electric appliances, basic safety precautions should always be followed, including the following:

1. Read all instructions. Keep these instructions for future reference.
2. Verify that the voltage in your home corresponds to that of your appliance.
3. To protect against risk of electrical shock, do not put cord, plug, base, or motor in or near water or other liquid.
4. Close supervision is necessary when any appliance is used by or near children.
5. Unplug cord from outlet when not in use, before putting on or taking off parts, and before cleaning.
6. Avoid contact with moving parts.
7. Do not operate any appliance with a damaged cord or plug, or after the appliance malfunctions or is dropped or damaged in any manner. Contact an authorized service facility for information on examination, electrical repair, mechanical repair, or adjustment.
8. The use of attachments, including canning jars, not recommended or sold by Hamilton Beach/Proctor-Silex, Inc. may cause a risk of injury to persons.
9. Do not use outdoors.
10. Do not let cord hang over edge of table or counter, or touch hot surfaces, including the stove.
11. Keep hands and utensils out of container while blending to reduce the risk of severe personal injury and/or damage to blender. A rubber spatula may be used but must be used only when blender is not running.
12. Blades are sharp, handle carefully.
13. Do not use a broken, chipped or cracked blender jar.
14. Do not use broken, cracked or loose cutting blades.
15. To reduce the risk of injury, never place cutting unit blades on base without jar properly attached.
16. Always operate blender with cover in place.

17. When blending hot liquids, remove center piece of two-piece cover. Do not fill blender container beyond the 3 cup level. Always begin processing at the lowest speed setting. Keep hands and other exposed skin away from the cover opening to prevent possible burns.
18. Screw on jar retaining ring firmly. Injury can result if moving blades accidentally become exposed.
19. If the jar should turn when the motor is switched ON, switch OFF immediately and tighten jar in threaded retaining ring.
20. Do not leave blender unattended while it is operating.
21. To disconnect cord, turn the control to OFF, then remove plug from wall outlet.
22. Do not use appliance for other than intended purpose.

## SAVE THESE INSTRUCTIONS

### CONSUMER SAFETY INFORMATION

**This appliance intended for household use only. Use for food or liquids only.**

This appliance is equipped with a polarized plug. This type of plug has one blade wider than the other. The plug will fit into an electrical outlet only one way. This is a safety feature intended to help reduce the risk of electrical shock. If you are unable to insert the plug into the outlet, try reversing the plug. If the plug should still fail to fit, contact a qualified electrician to replace the obsolete outlet. Do not attempt to defeat the safety purpose of the polarized plug by modifying the plug in any way.

The length of the cord used on this appliance was selected to reduce the hazards of becoming tangled in, or tripping over a longer cord. If a longer cord is necessary an approved extension cord may be used. The electrical rating of the extension cord must be equal to or greater than the rating of the blender. Care must be taken to arrange the extension cord so that it will not drape over the countertop or tabletop where it can be pulled on by children or accidentally tripped over.

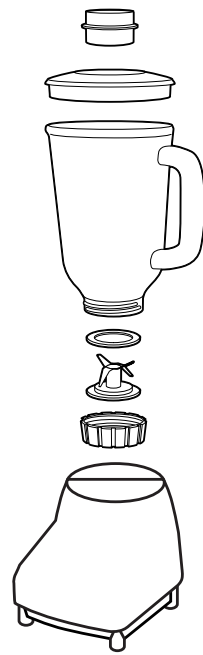

7. Process food or beverages. Place hand on lid when blending liquids. Push button on control panel to start blender.
8. ALWAYS turn blender off and wait until blades have stopped rotating before removing jar.
9. To remove jar after blending is complete, lift the jar straight up. If it is not easily removed, rock gently and lift. Do not twist.
10. NEVER replace jar onto unit while motor is running.

---

## How to Clean the Blender

1. Unplug blender from electrical outlet.
2. Wipe blender base, control panel, and cord with a damp cloth or sponge. To remove stubborn spots, use a mild, non-abrasive cleanser.
3. To clean jar, unscrew retaining ring and remove cutting unit assembly from jar.
4. Carefully remove blades and gasket from bottom of retaining ring.
5. Carefully wash blades, retaining ring, gasket, jar (if plastic), and cover in hot, soapy water. Rinse and dry thoroughly. Do not soak. **Do not wash blades, retaining ring, gasket, plastic jar, or cover in a dishwasher.**
6. Reassemble cutting unit assembly onto jar, replace jar onto blender base.
7. Store blender with cover ajar to prevent container odor.

---

## Hints for Best Use

- Processing hot foods or liquids in the blender may cause hot liquid to spurt out when the cover is removed. Always remove the filler-cap from the cover before blending hot foods or liquids.
- To add foods when blender is operating, remove filler-cap from container cover and add ingredients through the opening.
- If blending action stops during blending or ingredients stick to sides of the jar, turn blender OFF. Remove cover and use a rubber spatula to push mixture toward blades.
- Do not try to mash potatoes, mix stiff dough, whip egg whites, grind raw meat, or extract juices from fruits and vegetables. The blender is not made to perform these tasks.
- Do not store food or liquids in the blender jar.
- Avoid bumping or dropping the blender.

---

## Customer Service

If you have a question about your blender, call our toll-free customer service number. Before calling, please note the model, type, and series numbers and fill in that information below. These numbers can be found on the bottom of your blender. This information will help us answer your question much more quickly.

**MODEL:** \_\_\_\_\_ **TYPE:** \_\_\_\_\_ **SERIES:** \_\_\_\_\_

The following warranty applies only to product purchased in the United States. For product purchased in Mexico please see the separate enclosed warranty.

#### **LIMITED WARRANTY**

This product is warranted to be free from defects in material and workmanship for a period of one hundred eighty (180) days from the date of original purchase, except as noted below. During this period, we will repair or replace this product, at our option, at no cost. THE FOREGOING WARRANTY IS IN LIEU OF ANY OTHER WARRANTY, WHETHER EXPRESS OR IMPLIED, WRITTEN OR ORAL INCLUDING ANY WARRANTY OF MERCHANTABILITY OR FITNESS FOR A PARTICULAR PURPOSE. ANY LIABILITY IS EXPRESSLY LIMITED TO AN AMOUNT EQUAL TO THE PURCHASE PRICE PAID, AND ALL CLAIMS FOR SPECIAL, INCIDENTAL AND CONSEQUENTIAL DAMAGES ARE HEREBY EXCLUDED. There is no warranty with respect to the following, which may be supplied with this product: glass parts, glass containers, cutter/strainer, blades and/or agitators. This warranty extends only to the original consumer purchaser and does not cover a defect resulting from abuse, misuse, neglect, use for commercial purposes, or any use not in conformity with the printed directions. This warranty gives you specific legal rights, and you may also have other legal rights which vary from state to state, or province to province. Some states or provinces do not allow limitations on implied warranties or special, incidental or consequential damages, so the foregoing limitations may not apply to you.

If you have a claim under this warranty, DO NOT RETURN THE APPLIANCE TO THE STORE! Please call our CUSTOMER SERVICE NUMBER. (For faster service please have model, series, and type numbers ready for operator to assist you.)

#### **CUSTOMER SERVICE NUMBER**

In the U.S. 1-800-851-8900

Web site address: [www.proctorsilex.com](http://www.proctorsilex.com)

**KEEP THIS NUMBER FOR FUTURE REFERENCE!**

HAMILTON BEACH ♦ PROCTOR-SILEX, INC.

263 Yadkin Road, Southern Pines, NC, USA 28387

840086000

Printed In Mexico

4/01