

Specifications

Frequency range	
FM:	87.9–107.9 MHz (200 kHz steps) 87.5–108.0 MHz (100 kHz steps)
AM:	520–1710 kHz (10 kHz steps)
Sampling frequency	44.1 kHz
Decoding	16 bit linear
Beam source	Semiconductor laser (wavelength 780 nm)
No. of channels	2 channel, stereo
Wow and flutter	Less than possible measurement data
DA converter	MASH (1 bit DAC)
Speakers	8 cm (3") 6 Ω×2
Jacks	
Output	PHONES: 3.5 mm (1/8") stereo (32 Ω)
Power requirement	AC 120 V, 60 Hz
Power consumption:	14 W
Memory back-up	9 V (One 6F22/6LR61, 006P battery)
Dimensions (W×H×D)	
Main unit;	151×193×186 mm (5 ¹⁵ / ₁₆ "×7 ⁵ / ₈ "×7 ⁵ / ₁₆ ")
Sub unit;	110×193×184 mm (4 ³ / ₈ "×7 ⁵ / ₈ "×7 ¹ / ₄ ")
Mass	
Main unit;	1.69 kg (3.73 lb) without battery
Sub unit;	0.86 kg (1.9 lb)



Note:

Specifications are subject to change without notice.
Mass and dimensions are approximate.

Power consumption in standby mode: 3.3 W

Supplied accessories

Please check and identify the supplied accessories.

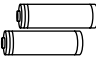
- | | | | |
|---|---|--|---|
| <input type="checkbox"/> 1 AC power supply cord
(RJA0065-1D) |  | <input type="checkbox"/> 1 Remote control
(EUR648259) |  |
| <input type="checkbox"/> 1 AM loop antenna
(RSA0031) |  | <input type="checkbox"/> 2 Batteries |  |

Use numbers in parentheses when asking for replacement parts.

(Only for U.S.A.)

To order accessories, contact 1-800-332-5368 or web site (<http://www.panasonic.com>).

CD selection

Choose CDs with this mark:



Do not;

- use irregularly shaped CDs.
- use CDs with labels and stickers that are coming off or with adhesive exuding from under labels and stickers.
- attach scratch-proof covers or any other kind of accessory.
- write anything on the CD.
- clean CDs with liquids. (Wipe with a soft, dry cloth.)
- use CDs printed with label printers available on the market.

Playing CD-R and CD-RW

This unit can play CD-DA (digital audio) format audio CD-R and CD-RW that have been finalized (a process that enables CD-R/CD-RW players to play audio CD-R and CD-RW) upon completion of recording. It may not be able to play some CD-R or CD-RW due to the condition of the recording.

Panasonic

CD Clock Radio Operating Instructions Model No. RC-CD600

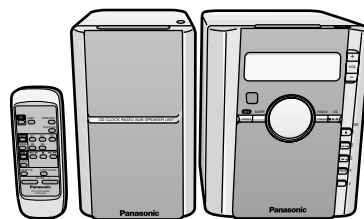

Dear Customer

Thank you for purchasing this product.
For optimum performance and safety, please read these instructions carefully.



Before connecting, operating or adjusting this product, please read these instructions completely. Please keep this manual for future reference.



Panasonic Consumer Electronics Company, Division of Matsushita Electric Corporation of America

One Panasonic Way Secaucus, New Jersey 07094

<http://www.panasonic.com>

Panasonic Sales Company, Division of Matsushita Electric of Puerto Rico, Inc. ("PSC")

Ave. 65 de Infantería, Km. 9.5 San Gabriel Industrial Park, Carolina, Puerto Rico 00985

Panasonic Canada Inc.

5770 Ambler Drive, Mississauga, Ontario L4W2T3

www.panasonic.ca

© 2001 Matsushita Electric Industrial Co., Ltd.

Printed in China

RQTT0477-P

F1201KB0

The remote control

Batteries

- Insert so the poles (⊕ and ⊖) match those in the remote control.
- Do not mix old and new batteries or different types of batteries.
- Do not use rechargeable batteries.

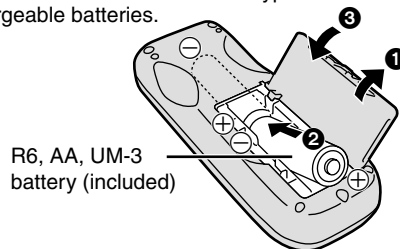

Use

Aim at the sensor, avoiding obstacles, at a range of 7 meters (23 feet) directly in front of the main unit.

- Keep the transmission window and the unit's sensor free from dust.
- Operation can be affected by strong light sources, such as direct sunlight, and the glass doors on cabinets.

Do not;

- put heavy objects on the remote control.
- take the remote control apart.
- spill liquids onto the remote control.

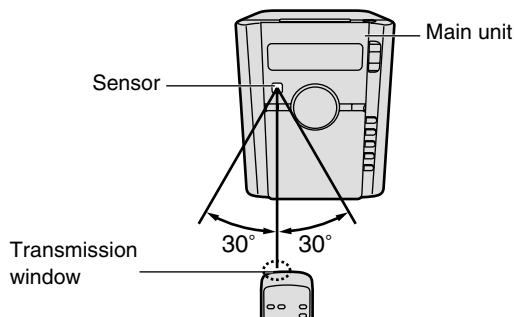

Setup

1 Put the main and sub units either side of the bed.



2 ① Open the back panel of the sub unit and take out enough cord for the distance between the units.
② Close the panel, ensuring the cord fits into the slit at the bottom of the compartment.

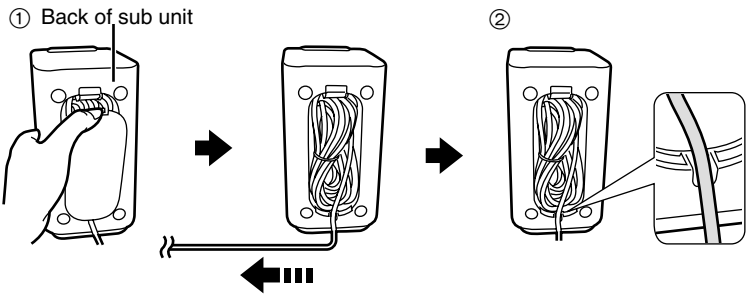

3 Connect the cables to the terminals of the same color, so ⊕ and ⊖ are correct.

Never allow the exposed wires to contact each other when connected. Incorrect connection can damage the unit.

The green and blue cables carry commands. The red and black cables carry sound

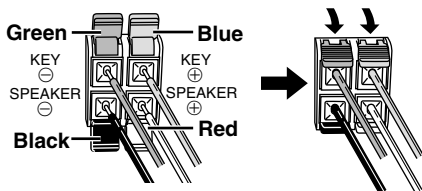

4 Connect the AM loop antenna. Stand the antenna up so it clicks into place.



6 Connect the AC power supply cord. Connect this cord after all other cables and cords are connected.

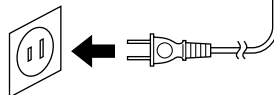

Note
The included AC power supply cord is for use with this unit only. Do not use it with other equipment.

7 Change the speaker channel.
R: If the main unit is to the right when you are lying down.
L: If the main unit is to the left when you are lying down.

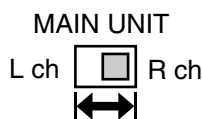

Note
If you set the units up away from the bed, set [MAIN UNIT] to [L] if you put the main unit on the right, and vice versa.

5 Insert the memory backup battery. This saves the clock, timer, and radio-pre-set settings if power is interrupted.

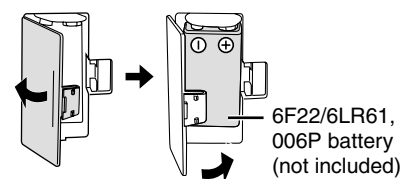

The battery lasts about a year (one month without AC power).

Using headphones (not included)

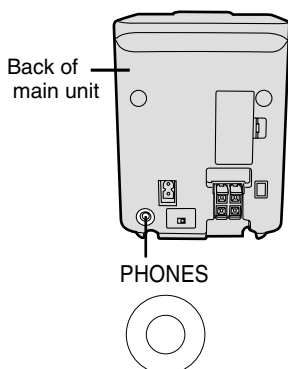

Plug type: 3.5 mm (1/8 in.) stereo

- The alarms function when you connect headphones, and the buzzer sounds through the speakers, even if you set ALARM 1 (CD or radio).
- Avoid listening for long periods of time to prevent hearing damage.

Setting the time

This is a 12-hour clock. This example shows how to set the clock for 3:30 P.M. Reset the clock regularly to maintain accuracy. (Monthly accuracy +/- 30 seconds.)

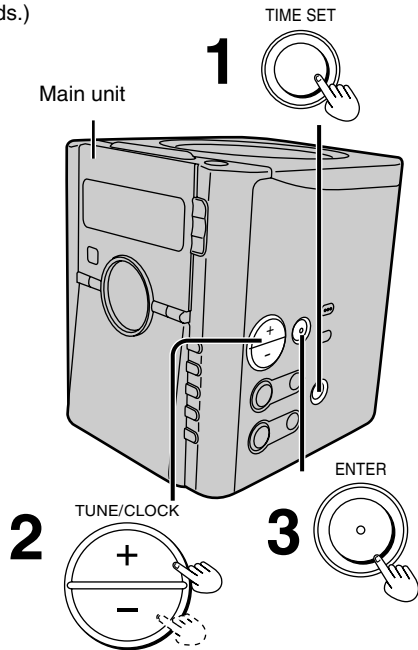

1 Press and hold [TIME SET] until the clock starts flashing.



2 Press [+ , - , TUNE/CLOCK] to set the time.

[+]: increases the time in one-minute units

[-]: decreases the time in one-minute units

Press and hold to change the time faster.

3 Press [ENTER] to complete.

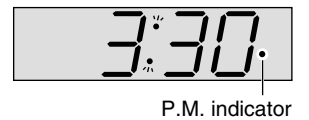

Listening to CDs

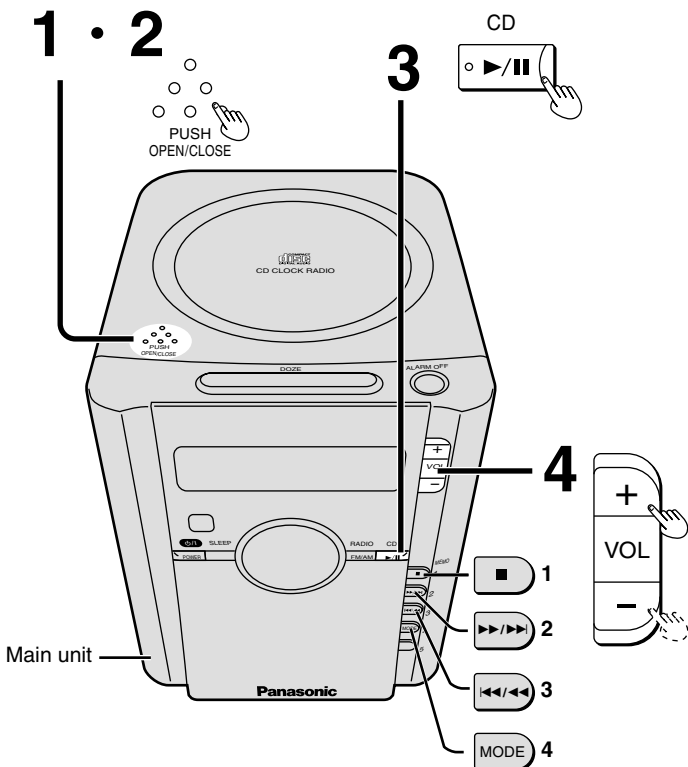

1 Press [PUSH, OPEN/CLOSE] and insert a CD.

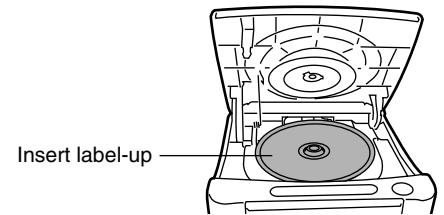

2 Press [PUSH, OPEN/CLOSE] to close the CD lid.

Total playing time

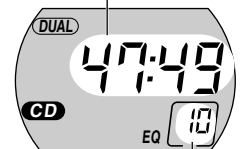

3 Press [▶/||, CD].

The CD plays from the first track through to the last track.

Number of tracks
Elapsed play time

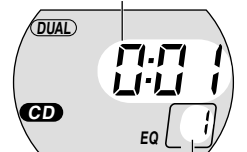

4 Adjust the volume.

[+]: Increase

[-]: Decrease

Track playing

■ **To stop play**
Press [■, 1].

Note

Stop the disc before opening the CD lid to prevent damage to the CD.

■ **To pause play**
Press [▶/||, CD].

Press again to resume play.

■ **Searching through tracks**

While playing or paused

Press and hold [◀◀/▶▶, 3] (backward) or [▶▶/▶▶, 2] (forward).

■ **Skipping tracks**

Press [◀◀/▶▶, 3] (backward) or [▶▶/▶▶, 2] (forward).

CD play modes: repeat one track (1 ↻), all tracks (↻), or play them randomly (RANDOM)

Press [MODE, 4].

Each time you press the button:

1 ↻ → ↻ → RANDOM → cancel (no display)

The mode cancels when you open the CD lid.

Listening to the radio

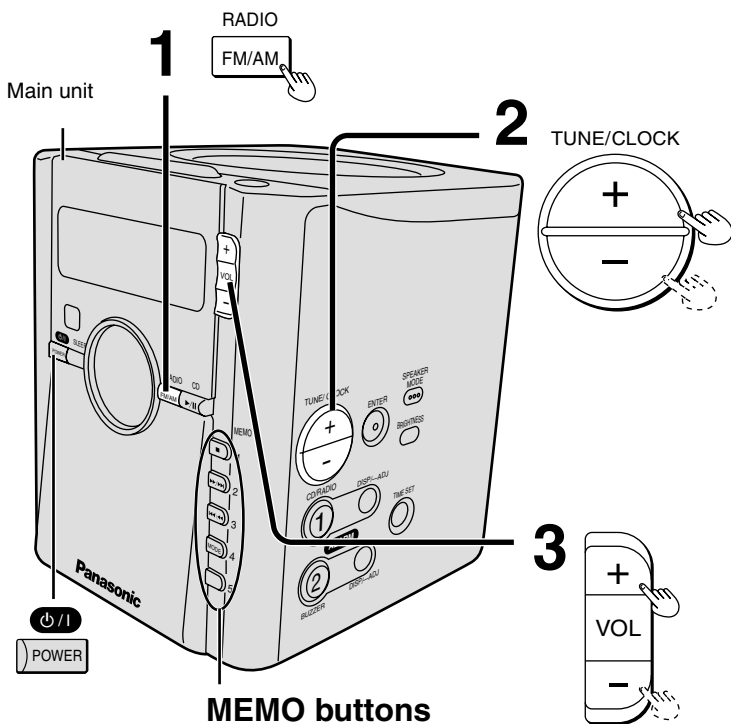

Manual tuning

- 1 Press [FM/AM, RADIO] to select the band. Each time you press the button:
FM 1 → FM 2 → AM 1 → AM 2

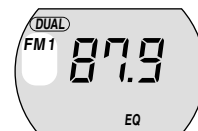

- 2 Press [+ , - , TUNE/CLOCK] to tune to a station. Press and hold until the frequency starts scrolling to start automatic tuning. Tuning stops when a station is found.
- 3 Adjust the volume.
[+]: Increase
[-]: Decrease

■ To turn the radio off
Press [POWER, O/I].

Preset tuning

You can preset up to 20 stations: 5 each in FM 1, FM 2, AM 1, and AM 2.

- Presetting
- While listening to the station you want to preset Press and hold a MEMO button ([1, 2, 3, 4, or 5]) until the channel number appears.



The station occupying a channel is erased if you preset another station in its place.

Channel number

■ To listen to a preset station

1. Press [FM/AM, RADIO] to select the band.
2. Press the MEMO button ([1, 2, 3, 4, or 5]) to select the channel.

To improve reception

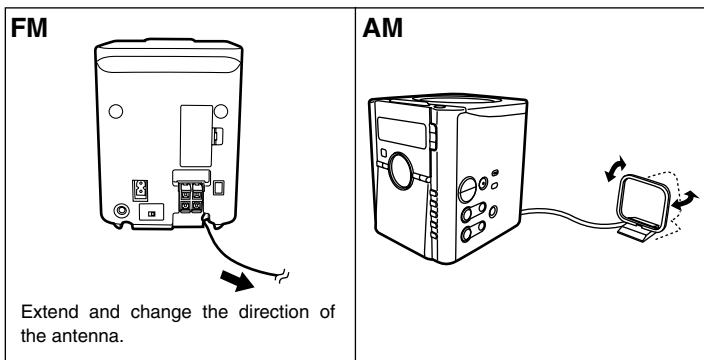

If FM reception is poor

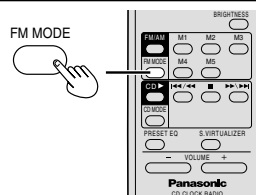

On the remote control Press [FM MODE].
"MONO" lights.
Sound is monaural but noise is reduced.
Press again to cancel.

Changing the brightness

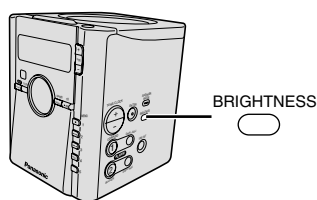

You can dim the clock and turn the LCD light off.

Press [BRIGHTNESS]. Press again to brighten the clock and turn the LCD light on.

Speaker mode

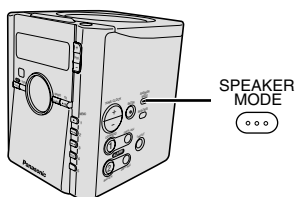

Select whether to have sound come from both units (DUAL), the main unit only (MAIN), or the sub unit only (SUB).

The mode you select applies to all sound sources and remains active until you change it.

Press [SPEAKER MODE]. The mode changes each time you press the button.

DUAL → MAIN → SUB

Note

When using headphones, set the speaker mode to DUAL. Sound will come only from the left or right side if you set the mode to MAIN or SUB.

Changing the FM step

Change the FM step to receive FM stations allocated 0.1-MHz steps. First press [FM/AM, RADIO] to select FM 1. Now, press and hold [FM/AM, RADIO]. The display changes in a few seconds to show the current lowest FM frequency. Continue to hold down the button. The minimum frequency changes and the step is changed at the same time. Changing the step erases all preset stations. Repeat the above to change the step back.

Sound quality

Using the preset equalizer

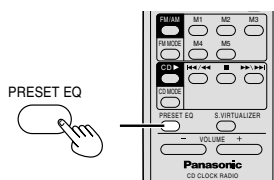

Press [PRESET EQ]. Each time you press the button:
XBS: Emphasizes the bass " _ _ _ _"
CLEAR: Clarifies higher sounds " _ _ _ _"
SOFT: For background music " _ _ _ _"
VOCAL: Adds gloss to vocals " _ _ _ _"
OFF:

Using the sound virtualizer

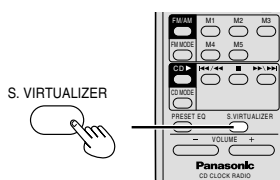

This effect stabilizes the midrange sounds, such as vocals, and gives sound natural width and depth. Use it when listening to stereo sources.

Press [S. VIRTUALIZER]. " ■■■■■ " lights on the LCD.

Using the alarms

You can set the unit to play either a CD or the radio with ALARM 1, or to sound a buzzer with ALARM 2. You can set the two alarms separately and choose which unit the alarms are to sound from.

Setting the CD/Radio alarm (ALARM 1)

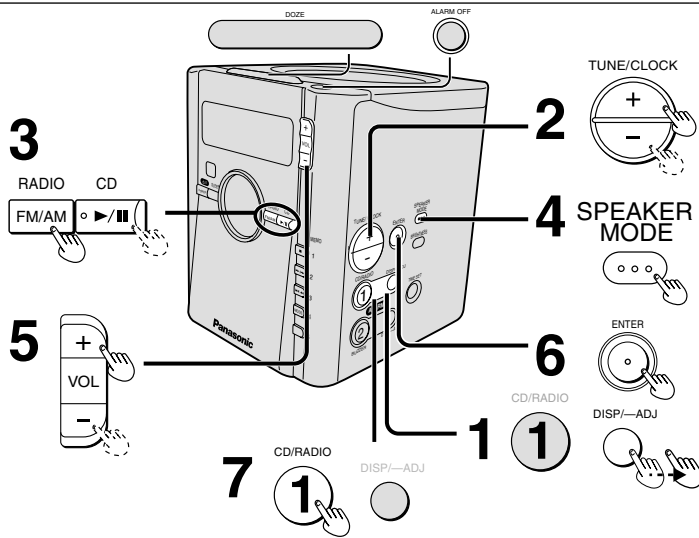

- 1 Press and hold [DISP/ADJ] (ALARM 1). The time display and ALARM 1 indicator start flashing.

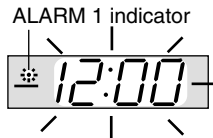

- 2 Press [+ , - , TUNE/CLOCK] to set the time. Press and hold to change the time faster.
- 3 Select the source to wake up to.
 - To play the radio
 - Press [FM/AM, RADIO] to select the band and tune to the station.
 - To play a CD
 - Press [▶/||, CD] to start playing the CD.
- 4 Press [SPEAKER MODE] to select the unit(s) to play through.
 - Each time you press the button:
 - DUAL: alarm sounds through both units
 - MAIN: alarm sounds through the main unit
 - SUB: alarm sounds through the sub unit
- 5 Press [VOL, +, -] to set the volume.
- 6 Press [ENTER] to complete the settings.
- 7 Press [1, CD/RADIO] to turn the alarm on. The ALARM 1 indicator lights. The CD or radio starts at the set time and stops automatically after an hour. (The buzzer sounds if you didn't insert a CD.)

For your reference:

You can still play a CD or the radio after you have set the alarm.

To shut off the alarm

Press [ALARM OFF].
If the speaker mode is MAIN, press [ALARM OFF] on the main unit.
If the speaker mode is SUB, press [ALARM OFF] on the sub unit.
The alarm stops but the settings remain intact so the alarm will sound again at the same time the next day.

To turn the alarm off

Press [1, CD/RADIO] or [2, BUZZER].
The settings remain intact. Press again to turn the alarm on again.

Setting the buzzer alarm (ALARM 2)

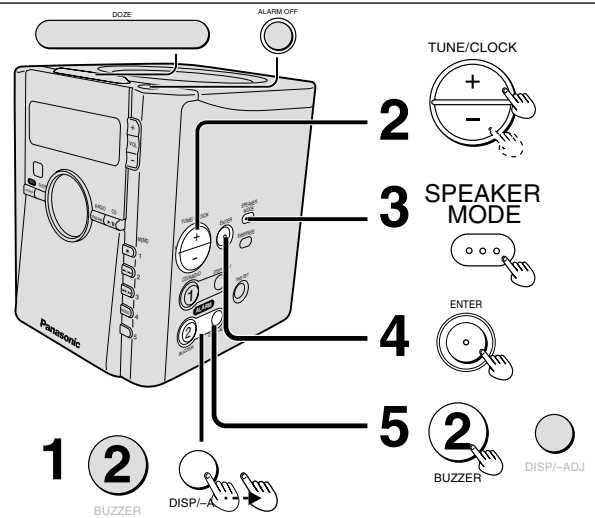

- 1 Press and hold [DISP/ADJ] (ALARM 2). The time display and ALARM 2 indicator start flashing.

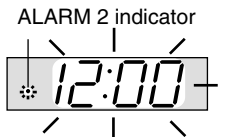

- 2 Press [+ , - , TUNE/CLOCK] to set the time. Press and hold to change the time faster.
- 3 Press [SPEAKER MODE] to select the unit(s) to play through.
 - Each time you press the button:
 - DUAL: alarm sounds through both units
 - MAIN: alarm sounds through the main unit
 - SUB: alarm sounds through the sub unit
- 4 Press [ENTER] to complete the settings.
- 5 Press [2, BUZZER] to turn the alarm on. The ALARM 2 indicator lights. The buzzer sounds at the set time and stops automatically after an hour. (You cannot change the volume of the buzzer.)

To shut the alarm off temporarily

Press [DOZE].
If the speaker mode is MAIN, press [DOZE] on the main unit.
If the speaker mode is SUB, press [DOZE] on the sub unit.
The alarm sounds again about 6 minutes later.

To check the settings

Press [DISP/ADJ].
The clock shows the set time (ALARM 1, ALARM 2) and the LCD shows speaker setting and the source and volume for the CD/RADIO alarm (ALARM 1).

Using the sleep timer

The sleep timer turns the unit off after a set time. You cannot set it while an alarm is working.

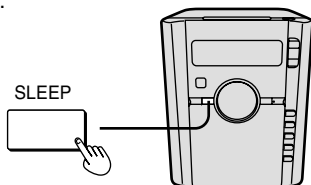

Press [SLEEP] to select the time (minutes).

Each time you press the button:
30 → 60 → 90 → 120 → OFF

- To check the remaining time Press [SLEEP].
- To change the setting Press [SLEEP] once to display the remaining time, then press again to change the setting.

Control guide

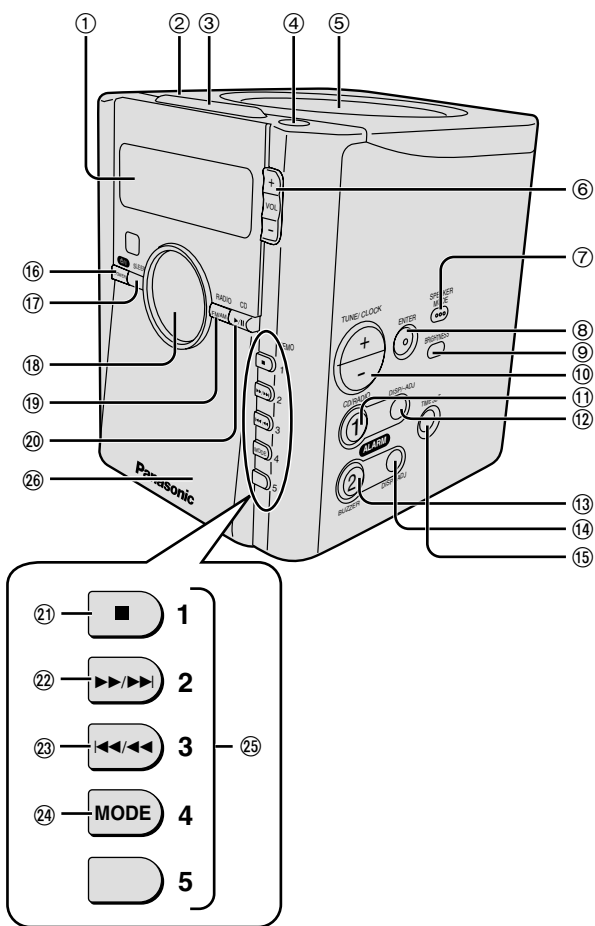

Main unit

- ① Clock
- ② PUSH, OPEN/CLOSE: to open or close the CD lid
- ③ DOZE: to shut off the alarm temporarily when speaker mode is DUAL or MAIN
- ④ ALARM OFF: to shut off the alarm when speaker mode is DUAL or MAIN
- ⑤ CD lid
- ⑥ VOLUME buttons
- ⑦ SPEAKER MODE: to select whether to output from both units (DUAL), the main unit (MAIN), or the sub unit (SUB)
- ⑧ ENTER: to complete clock and alarm settings
- ⑨ BRIGHTNESS: to dim the clock and turn off the LCD light
- ⑩ +, -, TUNE/CLOCK: to tune the radio and change time settings
- ⑪ 1, CD/RADIO: to turn ALARM 1 on and off
- ⑫ DISP/ADJ (ALARM 1): to display the setting or to change the setting
- ⑬ 2, BUZZER: to turn ALARM 2 on and off
- ⑭ DISP/ADJ (ALARM 2): to display the setting or to change the setting
- ⑮ TIME SET: press and hold to enter the clock setting mode
- ⑯ POWER, I / I : press to switch the unit from on to standby mode or vice versa.

In standby mode, the unit is still consuming a small amount of power.

- ⑰ SLEEP: to select a time for the unit to switch to standby
- ⑱ LCD (liquid crystal display)
- ⑲ FM/AM, RADIO: to turn the radio on and select the band
- ⑳ II / I , CD: to play or pause a CD
- ㉑ \blacksquare , 1: in CD mode, press to stop play.
- ㉒ II / II , 2: in CD mode, press to skip or search forward
- ㉓ II / II , 3: in CD mode, press to skip or search backward
- ㉔ MODE, 4: in CD mode, press to select a play mode
- ㉕ MEMO 1, 2, 3, 4, 5: in radio mode, press to select a preset channel
- ㉖ Speaker

Note

These speakers do not have magnetic shielding. Do not place them near televisions personal computers or other devices easily influenced by magnetism.

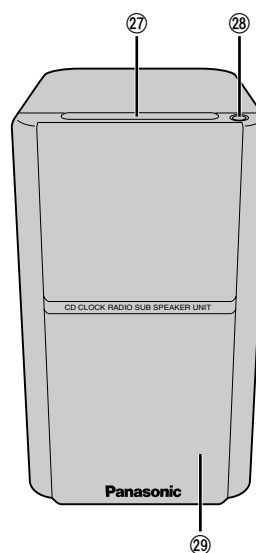

Sub unit

- ㉗ DOZE: to shut off the alarm temporarily when speaker mode is DUAL or SUB
- ㉘ ALARM OFF: to shut off the alarm when speaker mode is DUAL or SUB
- ㉙ Speaker

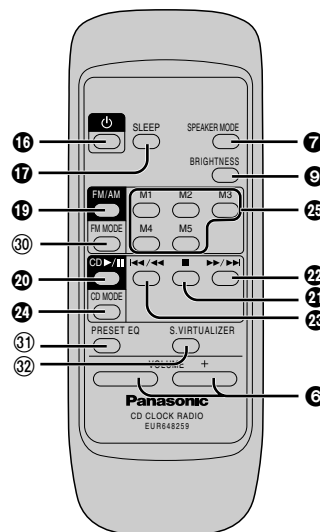

Remote control

Buttons such as ⑯ function same as those on the main unit.

- ⑳ FM MODE: to turn on "MONO" if FM reception is poor
- ㉑ PRESET EQ: to select a preset sound quality
- ㉒ S. VIRTUALIZER: to turn the sound virtualizer on or off

IMPORTANT SAFETY INSTRUCTIONS

Read these operating instructions carefully before using the unit. Follow the safety instructions on the unit and the safety precautions listed below. Keep these operating instructions handy for future reference.

Safety

- 1. Power source**—Connect the unit to a power source of the type described in these instructions or as marked on the unit.
- 2. Polarization**—The unit is equipped with a polarized power plug where one blade is wider than the other. This safety feature ensures that the plug fits into your household AC outlet only one way. If the plug doesn't fit one way, try reversing it. If the plug still doesn't fit, contact an electrician to replace the obsolete outlet. Do not attempt to defeat the safety purpose of the plug.
- 3. Power cord protection**—Route the AC power supply cord so that it will not be walked on or pinched by items placed on or against it. Never take hold of the plug or cord with wet hands. Always grasp the plug body firmly when connecting and disconnecting it.
- 4. Overloading**—When connecting the AC power supply cord, be careful not to overload the household AC outlet, extension cord, or outlet from any other device as this can result in fire or electric shock.
- 5. Nonuse periods**—Turn the unit off when it is not in use. Unplug the unit from the household AC outlet if it is not to be used for a long time. Unplug the unit during lightning storms.
- 6. Attachments and accessories**—Use only the attachments and accessories recommended in these operating instructions.

Installation

■ Placement

- 1. Ventilation**—Situate the unit so that it receives proper ventilation. Do not install in a confined space such as a bookcase or cabinet. Allow at least 10 cm (4 inches) clearance from the rear of the unit. To prevent the risk of electric shock or fire due to overheating ensure curtains and other materials do not obstruct the unit's ventilation.
- 2. Foreign material**—Ensure objects and liquids do not get into the unit. Avoid exposing the unit to excessive smoke, dust, mechanical vibration, and shock.
- 3. Magnetism**—Situate the unit away from equipment and devices that generate strong magnetic fields.
- 4. Stacking**—Do not place heavy objects on top of this unit.
- 5. Surface**—Place the unit on a flat, level surface.
- 6. Carts and stands**—Use the unit only with carts and stands recommended by the manufacturer. Move carts with care. Sudden stops, excessive force, and uneven surfaces can cause carts to overturn.
- 7. Wall and ceiling mounting**—Do not mount the unit on walls or ceilings unless specified in the instructions.



■ Environment

- 1. Water and moisture**—Do not use the unit near water, such as near a bathtub or swimming pool. Avoid damp basements.
- 2. Heat**—Situate the unit away from heat sources, such as radiators. Do not situate where temperatures fall below 5°C (41°F) or rise above 35°C (95°F).

Maintenance

Unplug the unit from the household AC outlet before cleaning. Clean with a damp cloth. Do not use abrasive pads, scouring powders, or solvents.

Service

- 1. Damage requiring service**—The unit should be serviced by qualified service personnel if:
 - (a) The AC power supply cord or the plug has been damaged; or
 - (b) Objects or liquids have gotten into the unit; or
 - (c) The unit has been exposed to rain; or
 - (d) The unit does not operate normally or exhibits a marked change in performance; or
 - (e) The unit has been dropped or the cabinet damaged.
- 2. Servicing**—Do not attempt to service the unit beyond that described in these operating instructions. Refer all other servicing to authorized servicing personnel.
- 3. Replacement parts**—When parts need replacing ensure the servicer uses parts specified by the manufacturer or parts that have the same characteristics as the original parts. Unauthorized substitutes may result in fire, electric shock, or other hazards.
- 4. Safety check**—After repairs or service, ask the servicer to perform safety checks to confirm that the unit is in proper working condition.

Care of the CD lens

Open the lid and clean the lens.
Use a cotton swab to gently wipe off any finger-prints.
Recommended product:
Lens cleaner kit (SZZP1038C)

Use of batteries

- Align the poles (⊖ and ⊕) properly when inserting the batteries.
 - Do not heat or disassemble batteries. Do not allow them to contact flame or water.
 - Remove the batteries if the unit is not to be used for a long time.
 - Do not use the batteries if the covering has been peeled off.
- Mishandling of batteries can cause electrolyte leakage which can damage items the fluid contacts and may cause a fire.
If electrolyte leaks from the batteries, consult your dealer.
Wash thoroughly with water if electrolyte comes in contact with any part of your body.

Listening caution



Selecting fine audio equipment such as the unit you've just purchased is only the start of your musical enjoyment. Now it's time to consider how you can maximize the fun and excitement your equipment offers. This manufacturer and the Electronic Industries Association's Consumer Electronics Group want you to get the most out of your equipment by playing it at a safe level. One that lets the sound come through loud and clear without annoying blaring or distortion—and, most importantly, without affecting your sensitive hearing.

We recommend you to avoid prolonged exposure to excessive noise.

Sound can be deceiving. Over time your hearing "comfort level" adapts to higher volumes of sound. So what sounds "normal" can actually be loud and harmful to your hearing. Guard against this by setting your equipment at a safe level BEFORE your hearing adapts.

To establish a safe level:

- Start your volume control at a low setting.
- Slowly increase the sound until you can hear it comfortably and clearly, and without distortion.

Once you have established a comfortable sound level:

- Set the dial and leave it there.

Taking a minute to do this now will help to prevent hearing damage or loss in the future. After all, we want you listening for a lifetime.

THE FOLLOWING APPLIES ONLY IN THE U.S.A.

CAUTION:

This equipment has been tested and found to comply with the limits for a Class B digital device, pursuant to Part 15 of the FCC Rules.

These limits are designed to provide reasonable protection against harmful interference in a residential installation. This equipment generates, uses and can radiate radio frequency energy and, if not installed and used in accordance with the instructions, may cause harmful interference to radio communications. However, there is no guarantee that interference will not occur in a particular installation. If this equipment does cause harmful interference to radio or television reception, which can be determined by turning the equipment off and on, the user is encouraged to try to correct the interference by one or more of the following measures:

- Reorient or relocate the receiving antenna.
- Increase the separation between the equipment and receiver.
- Connect the equipment into an outlet on a circuit different from that to which the receiver is connected.
- Consult the dealer or an experienced radio/TV technician for help.

Any unauthorized changes or modifications to this equipment would void the user's authority to operate this device.

This device complies with Part 15 of the FCC Rules. Operation is subject to the following two conditions: (1) This device may not cause harmful interference, and (2) this device must accept any interference received, including interference that may cause undesired operation.

Product Service

- 1. Damage requiring service**—The unit should be serviced by qualified service personnel if:
 - (a) The AC power supply cord or AC adaptor has been damaged; or
 - (b) Objects or liquids have gotten into the unit; or
 - (c) The unit has been exposed to rain; or
 - (d) The unit does not operate normally or exhibits a marked change in performance; or
 - (e) The unit has been dropped or the cabinet damaged.
- 2. Servicing**—Do not attempt to service the unit beyond that described in these operating instructions. Refer all other servicing to authorized servicing personnel.
- 3. Replacement parts**—When parts need replacing ensure the servicer uses parts specified by the manufacturer or parts that have the same characteristics as the original parts. Unauthorized substitutes may result in fire, electric shock, or other hazards.
- 4. Safety check**—After repairs or service, ask the servicer to perform safety checks to confirm that the unit is in proper working condition.

Product information

For product information or assistance with product operation:
In the U.S.A., contact the Panasonic Customer Call Center at 1-800-211-7262, or e-mail consumerproducts@panasonic.com, or web site (<http://www.panasonic.com>).

In Canada, contact Panasonic Canada Inc. Customer Care Centre at 905-624-5505, web site (www.panasonic.ca), or an authorized Servicentre close to you.

The model number and serial number of this product can be found on either the back or the bottom of the unit.

Please note them in the space provided below and keep for future reference.

MODEL NUMBER RC-CD600
SERIAL NUMBER _____

User memo:

DATE OF PURCHASE _____
DEALER NAME _____
DEALER ADDRESS _____
TELEPHONE NUMBER _____

CAUTION:
TO PREVENT ELECTRIC SHOCK MATCH WIDE
BLADE OF PLUG TO WIDE SLOT, FULLY INSERT.

CAUTION!

THIS PRODUCT UTILIZES A LASER.
USE OF CONTROLS OR ADJUSTMENTS OR PERFORMANCE OF PROCEDURES OTHER THAN THOSE SPECIFIED HEREIN MAY RESULT IN HAZARDOUS RADIATION EXPOSURE.
DO NOT OPEN COVERS AND DO NOT REPAIR YOURSELF.
REFER SERVICING TO QUALIFIED PERSONNEL.

WARNING:

TO REDUCE THE RISK OF FIRE, ELECTRIC SHOCK OR PRODUCT DAMAGE, DO NOT EXPOSE THIS APPARATUS TO RAIN, MOISTURE, DRIPPING OR SPLASHING AND THAT NO OBJECTS FILLED WITH LIQUIDS, SUCH AS VASES, SHALL BE PLACED ON THE APPARATUS.

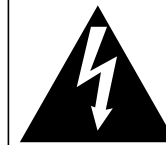

CAUTION
RISK OF ELECTRIC SHOCK
DO NOT OPEN



CAUTION: TO REDUCE THE RISK OF ELECTRIC SHOCK, DO NOT REMOVE SCREWS. NO USER-SERVICEABLE PARTS INSIDE.
REFER SERVICING TO QUALIFIED SERVICE PERSONNEL.



The lightning flash with arrowhead symbol, within an equilateral triangle, is intended to alert the user to the presence of uninsulated "dangerous voltage" within the product's enclosure that may be of sufficient magnitude to constitute a risk of electric shock to persons.



The exclamation point within an equilateral triangle is intended to alert the user to the presence of important operating and maintenance (servicing) instructions in the literature accompanying the appliance.

Troubleshooting guide

Before requesting service, make the below checks. If you are in doubt about some of the check points, or if the remedies indicated in the chart do not solve the problem:
In the U.S.A., contact the Panasonic Customer Call Center at 1-800-211-7262, or e-mail consumerproducts@panasonic.com, or web site (<http://www.panasonic.com>).

In Canada, contact Panasonic Canada Inc. Customer Care Centre at 905-624-5505, web site (www.panasonic.ca), or an authorized Servicentre close to you.

Common Problems

Problem	Check this
The clock shows "--:--".	Set the clock.
There is a lot of noise.	Separate the unit from mobile phones, televisions, and other tuners.
The alarm doesn't sound at the set time.	Ensure the alarm's indicator is on ("ALARM 1" or "ALARM 2").
The memory has been cleared.	<ul style="list-style-type: none"> ●Reset the items into the memory. ●Insert a memory back-up battery to preserve the contents of the memory.
No sound from the sub unit.	<ul style="list-style-type: none"> ●Check the connections. ●Check the speaker mode.
No operation from the sub unit.	<ul style="list-style-type: none"> ●Check the connections. ●Check the speaker mode.

CD

Problem	Check this
"-- --" appears on the LCD.	You haven't inserted a CD.
"E" appears on the LCD.	The operation cannot be performed.
Play doesn't start or display is incorrect.	<ul style="list-style-type: none"> ●Clean the CD. ●Wait an hour for condensation to dry, then try again. ●Make sure the label is facing up. ●Replace the CD if it is scratched, warped, or irregularly shaped.

Remote control

Problem	Check this
The remote control doesn't work.	<ul style="list-style-type: none"> ●Check that the batteries are inserted correctly. ●Replace the batteries if they are worn. ●Aim at the sensor on the main unit.