

iHome™

Model iH6
The Home System
For Your iPod®

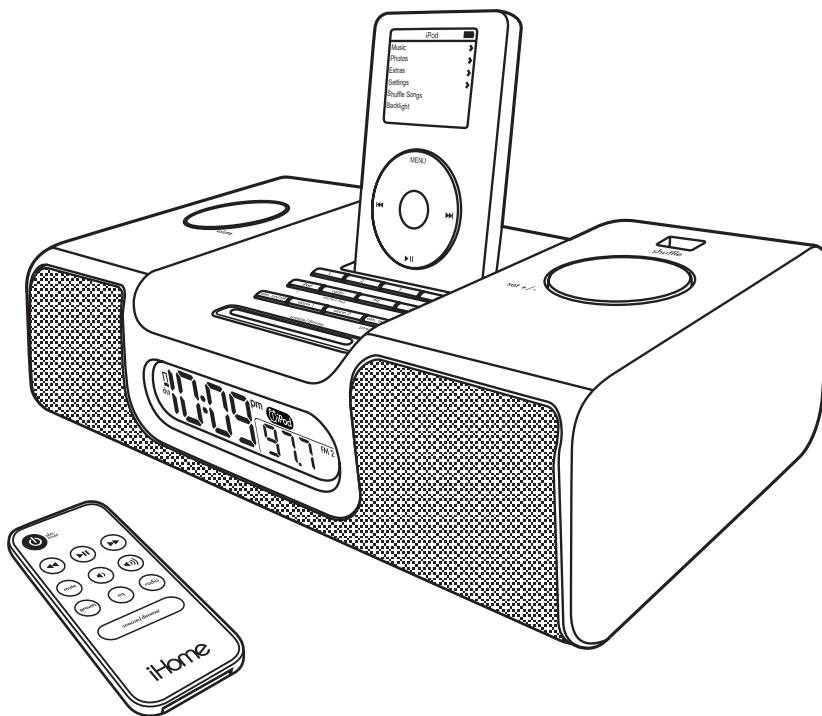

NOTE: THIS UNIT WILL NOT CONTROL OR CHARGE 3G iPod

Questions? Visit www.ihomeaudio.com

Table of Contents

Quick Start	1
Controls and Indicators / iH6 Display	2
Using the iH6	3-4
Replacing iH6 Backup Batteries	4
Install/Replace Backup Battery	
Batteries information	
Using the Remote Control Unit	5
A Consumer Guide to Product Safety	6
Troubleshooting	7-8
Solucionando problemas	9-10
Warranty Information	11

A Consumer Guide to Product Safety

This device complies with part 15 of the FCC Rules. Operation is subject to the condition that this device does not cause harmful interference.

This equipment complies with the limits for a Class B digital device as specified in Part 15 of FCC Rules. These limits provide reasonable protection against radio and TV interference in a residential area.

However, your equipment might cause TV or radio interference even when it is operating properly. To eliminate interference you can try one or more of the following corrective measures:

- Reorient or relocate the receiving antenna.
- Increase the distance between the equipment and the radio or TV.
- Use outlets on different electrical circuits for the equipment and the radio or TV.

Consult your dealer or an experienced radio/television technician if the problem still exists.

Modifying or tampering with your system's internal components can cause a malfunction and might invalidate the system's warranty and void your FCC authorization to operate it.

Maintenance

- Place the unit on a level surface away from sources of direct sunlight or excessive heat.
- Protect your furniture when placing your unit on a natural wood and lacquered finish. A cloth or other protective material should be placed between it and the furniture.
- Clean your unit with a soft cloth moistened only with mild soap and water. Stronger cleaning agents, such as Benzine, thinner or similar materials can damage the surface of the unit.

quick start

1:power

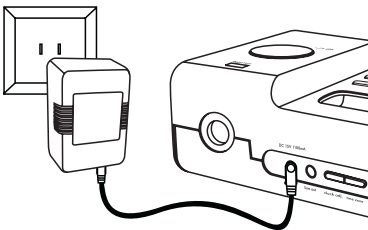

Attach AC adaptor cable to jack on back of the iH6 and plug the other end into a wall socket.

2:antenna



Snap AM antenna into provided stand, then plug antenna cable into socket on back of iH6. Move antenna 12" away.

3:inserts

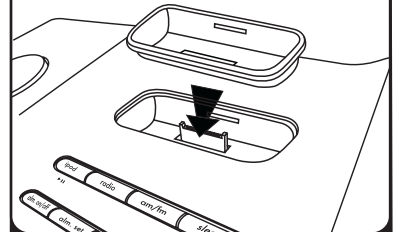

Select the dock insert for your iPod® model from the table below and place insert in dock. **Never dock an iPod without an insert in place.**

iPod photo thin (20, 30 GB)
Insert 6

iPod photo thick (40, 60 GB)
Insert 7

iPod nano
Insert 8

iPod with video (30 GB)
Insert 9

iPod with video (60 GB)
Insert 10

thin (20, 30 GB) iPod photo

thick (40, 60 GB) iPod photo

iPod nano

thin (30 GB) iPod with video

thick (60 GB) iPod with video

NOTE: If you do not have an insert for your iPod, please visit an Apple store, www.ihomeaudio.com, or call iHome toll free at 800-288-2792 to purchase one

4:time



- Press & hold the Time Zone button on back until it flashes
- Turn the Set Wheel to select your time zone
- Press the Time Zone button again.
- Move the DST switch on back of unit to +1 or -1 (adds or subtracts an hour)

5:iPod/shuffle



Insert iPod® into dock with proper insert (iPod must not be in a skin or case) OR insert shuffle into shuffle dock. Both iPod and shuffle will charge while docked. Press iPod Button on iH6 to play iPod. Turn on shuffle, press play on shuffle and iPod button on iH6 to play shuffle.

6:radio

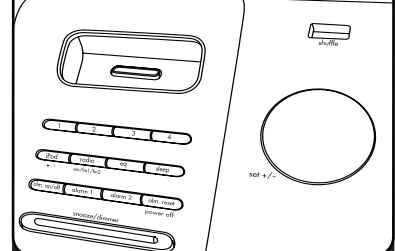

Press the Radio button and press again to select AM/FM band. Turn the Set Wheel to tune in a station. Press and hold a preset button (1, 2, 3 or 4) to save the station as a preset.

Controls and Indicators

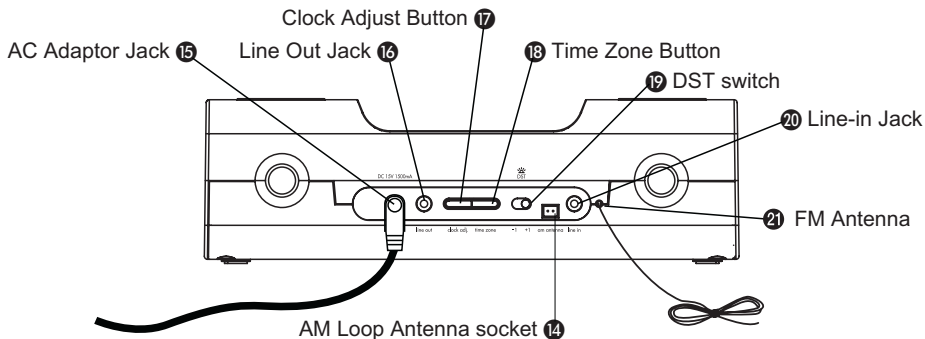
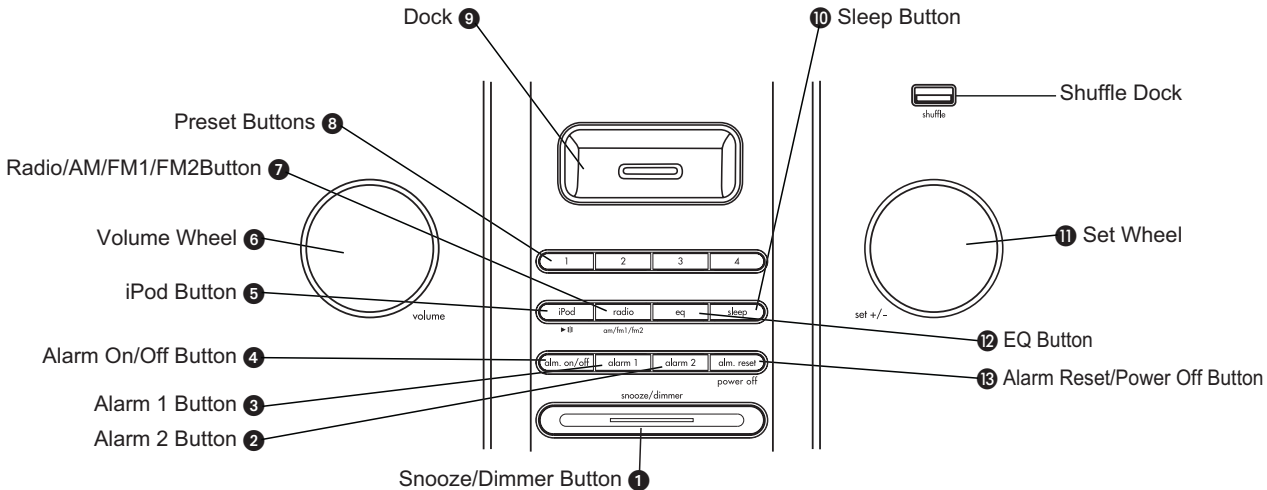

iH6 Display

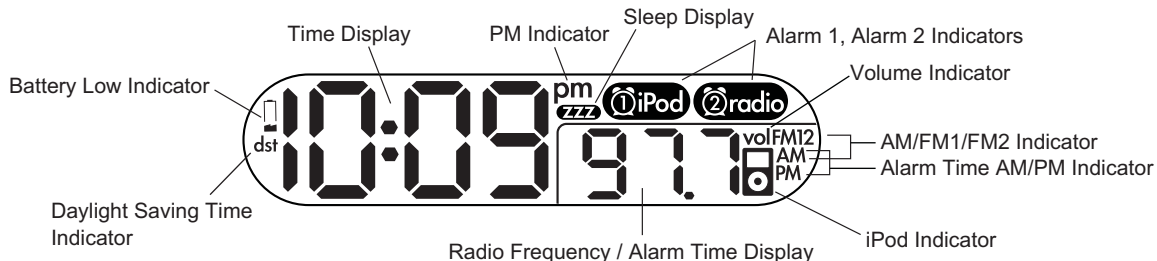

Connect iH6 to Power Source

- a) Plug the AC adaptor cable into the 15 AC Adaptor Jack and the other end into a standard 120v wall socket. Adaptor must be plugged in to operate. **The iH6 does not operate on batteries.**

Setting the Clock

- a) Press and hold the 13 Time Zone Button until the display flashes.
- b) Turn the Set Wheel to select your time zone.
- c) Press the Time Zone Button again. The clock will display the current time in your time zone.
- d) To adjust the time for Daylight Saving Time, slide the 19 DST switch to +1 to advance the time 1 hour. Slide to -1 to turn the clock back 1 hour.

To Set Clock Manually

- a) Press and hold the 17 Clock Adjust Button. The clock display will flash.
- b) Turn the 11 Set Wheel until the current time is displayed (a PM indicator appears when time is set to PM; there is no AM indicator).
- c) Press the Clock Adjust Button to accept the time. The year display will flash.
- d) Turn the Set Wheel to adjust the year and press the Clock Adjust Button. The date display will flash.
- e) Turn the Set Wheel to adjust the date and press the Clock Adjust Button. Two beeps will indicate clock setting is complete. Use DST switch to adjust for Daylight Saving Time.

Using the Alarms

Setting the Alarms

- a) Press and hold the 3 Alarm 1 Button until the alarm time flashes to wake to iPod (buzzer alarm sounds if no iPod is detected) or the 2 Alarm 2 Button to wake to the current radio station at a separate alarm time. You cannot wake to iPod shuffle.
- b) Turn the Set Wheel to set the alarm time (a PM indicator appears when time is set to PM; there is no AM indicator).
- c) Press the Alarm 1 Button again (or the Alarm2 Button if you are setting second alarm). Alarm is now armed, indicated by the numbered alarm clock icon (alarm 1 iPod or alarm 2 radio).

Arming and Disarming Alarm (Turn Alarm Function ON and OFF)

- a) Press the 4 Alarm On/Off Button to arm or disarm alarm functions. When armed, the related alarm icon appears in display.

Resetting the Alarm to Come on the Next Day

- a) When the alarm is sounding, press the 13 Alarm Reset/Power Off Button to stop alarm and reset it to come on the following day.

Snooze

- a) Press the 1 Snooze/Dimmer Button after the alarm sounds. The alarm will be silenced and come on again 9 minutes later. Snooze can be pressed several times during the 1 hour alarm cycle.

Sure Alarm

The iH6 has a sure alarm feature so the buzzer alarm will still sound in the event of power failure, if backup batteries are installed.

iPod and shuffle

Playing and charging your iPod or shuffle

- a) Place proper insert for your iPod (see insert table under Quick Start) in 9 Dock, then gently dock iPod. To use your shuffle, gently dock it in the Shuffle Dock. When docked, iPod and shuffle will charge until fully charged. **Unit will not overcharge iPod or shuffle. Note: The iH6 will not control or charge 3G iPod models.**
- b) Press the 5 iPod Button to play iPod, and again to pause. For shuffle play, press iPod button and use controls on your shuffle. Do not play iPod and shuffle at the same time.
- c) Turn 6 Volume Wheel to adjust iH6 volume up or down
- d) Press the EQ Button to select Treble, Bass or Balance. Turn the Set Wheel to adjust settings. EQ settings for iPod and radio mode are independent.
- e) Press 13 Alarm Reset/Power Off Button to turn iH6 and iPod off. To turn shuffle off, use shuffle controls.

Note: If you dock an iPod with a drained battery, it may take up to 6 minutes of charging before the iPod will respond.

Using the iH6

Radio

Setting up Antennas

- Snap AM loop antenna into provided stand, then plug AM antenna cable into 14 AM Loop Antenna socket on back of unit. Move antenna 12" away from unit for best reception.
- Extend 21 FM Antenna (on back of unit) fully for best reception. Do not strip, alter or attach to other antennas.

Tuning and Playing the Radio

- Press the 7 Radio Button to select radio play mode. Press as needed to select AM, FM1 or FM2 radio band.
- Turn the Set Wheel to tune radio to a desired station.
- To memorize the current station as a preset, press and hold 8 Preset Button 1,2,3 or 4. Repeat steps a,b,and c to preset up to 12 stations (4 AM, 8 FM). To listen to a preset station at any time, simply press the desired preset button.
- Turn the 6 Volume Wheel to adjust iH6 volume up or down.
- Press the EQ Button to select Treble, Bass or Balance. Turn the Set Wheel to adjust settings. EQ settings for iPod and radio mode are independent.
- Press 13 Alarm Reset/Power Off Button to turn iH6 and iPod off.

Using the Line-in and Line-out Jacks

- An audio patch cord comes with the iH6. Use it to play nondocking iPods or other audio devices through the iH6 20 Line-in Jack (one end in the device's line out or headphones jack, the other in the iH6 line in jack). Make sure there is no iPod docked in the iH6 when using the line-in jack (however, you can charge shuffle while using line-in). Press the iPod Button.
- Use the 16 Line Out Jack to connect the iH6 to the line-in jack of other audio devices such as a tape recorder or amplifier. The Volume Wheel of the iH6 does not control line-out volume (adjust on attached device instead). The Line Out Jack is not recommended for headphones.

Using Sleep Mode

- Sleep mode lets you sleep to your iPod or the radio, gradually lowering the volume until the unit shuts off at the selected time.
- Press the 10 Sleep Button to select an amount of time before the iH6 will turn off: 120, 90, 60, 30 or 15 minutes.
 - Turn the Volume Wheel to set the sleep volume (this volume setting is separate from your standard volume setting).

Using Dimmer

- Press the 1 Snooze/Dimmer Button during normal operation to adjust brightness of LCD display.

Replacing iH6 Backup Batteries

Install/Replace Backup Battery

The iH6 uses a backup battery system to provide continuous alarm operation and clock settings in the event of a power failure. If the Battery Low Icon located on the left of the display is flashing, it is time to replace the backup batteries. Please make sure the AC adaptor is connected, otherwise all settings may be lost during battery replacement.

Open the battery compartment cover located on the bottom of the unit. Insert 2 "AA" batteries as indicated. **We recommend the use of alkaline batteries for longer life.**

Batteries information:

- Do not mix old and new batteries.
- Do not mix alkaline, standard (carbon -zinc) or rechargeable (nickel-cadmium) batteries.

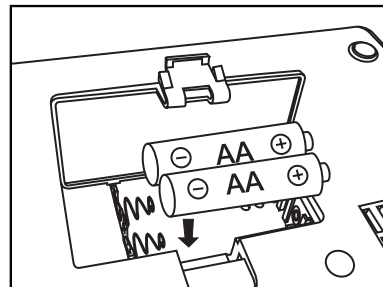

Using The Remote Control Unit

The Remote Control controls basic functions on the iH6 and certain iPod® functions when the iPod® is docked in the iH6. For best results, use the remote control within 12 feet of the unit.

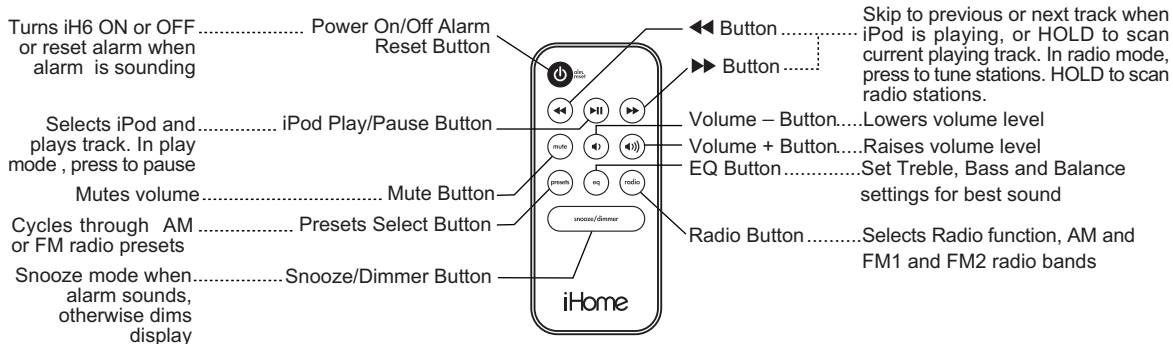

Install/Replace the Remote Control Batteries

The remote control batteries are already installed at the factory. When the remote control stops operating or its range seems reduced, replace the batteries with new ones.

1. The battery door is located on the back end of the unit.
2. Press to release the battery door latch.
3. Insert one “CR2032” 3-volt lithium batteries. Make sure the polarity (the + and – side of the battery) is correct.
4. Replace the battery holder back in the remote control.

NOTE: PLEASE DISCARD BATTERIES PROPERLY

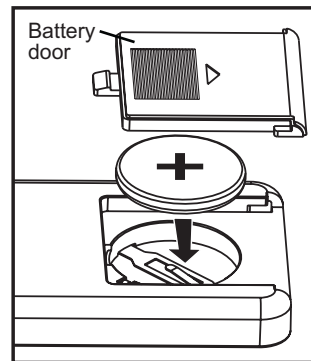

IMPORTANT SAFETY INSTRUCTIONS

When used in the directed manner, this unit has been designed and manufactured to ensure your personal safety. However, improper use can result in potential electrical shock or fire hazards. Please read all safety and operating instructions carefully before installation and use, and keep these instructions handy for future reference. Take special note of all warnings listed in these instructions and on the unit.

1. **Water and Moisture** – The unit should not be used near water. For example: near a bathtub, washbowl, kitchen sink, laundry tub, swimming pool or in a wet basement.
2. **Ventilation** – The unit should be situated so that its location or position does not interfere with its proper ventilation. For example, it should not be situated on a bed, sofa, rug or similar surface that may block ventilation openings. Also, it should not be placed in a built-in installation, such as a bookcase or cabinet, which may impede the flow of air through the ventilation openings.
3. **Heat** – The unit should be situated away from heat sources such as radiators, heat registers, stoves or other appliances (including amplifiers) that produce heat.
4. **Power Sources** – The unit should be connected to a power supply only of the type described in the operating instructions or as marked on the appliance.
5. **Power-Cable Protection** – Power supply cables should be routed so that they are not likely to be walked on or pinched by items placed upon or against them. It is always best to have a clear area from where the cable exits the unit to where it is plugged into an AC socket.
6. **Cleaning** – The unit should be cleaned only as recommended. See the Maintenance section of this manual for cleaning instructions.
7. **Objects and Liquid Entry** – Care should be taken so that objects do not fall and liquids are not spilled into any openings or vents located on the product.
8. **Attachments** – Do not use attachments not recommended by the product manufacturer.
9. **Lightning and Power Surge Protection** – Unplug the unit from the wall socket and disconnect the antenna or cable system during a lightning storm or when it is left unattended and unused for long periods of time. This will prevent damage to the product due to lightning and power-line surges.
10. **Overloading** – Do not overload wall sockets, extension cords, or integral convenience receptacles as this can result in a risk of fire or electric shock.
11. **Damage Requiring Service** – The unit should be serviced by qualified service personnel when:
 - A. the power supply cable or plug has been damaged.
 - B. objects have fallen into or liquid has been spilled into the enclosure.
 - C. the unit has been exposed to rain.
 - D. the unit has been dropped or the enclosure damaged.
 - E. the unit exhibits a marked change in performance or does not operate normally.
12. **Antenna** – Do not connect an external antenna to the unit (other than that provided).
13. **Periods of Nonuse** – If the unit is to be left unused for an extended period of time, such as a month or longer, the power cable should be unplugged from the unit to prevent damage or corrosion.
14. **Servicing** – The user should not attempt to service the unit beyond those methods described in the user's operating instructions. Service methods not covered in the operating instructions should be referred to qualified service personnel.

Questions? Visit www.ihomeaudio.com

Troubleshooting

Symptom	Possible Problem	Solution
iH6 does not turn on	AC adaptor isn't plugged into a working wall socket or not plugged into the power supply jack on back of the unit	Plug the AC adaptor into a working wall socket and plug the connector into the supply jack on the unit
iH6 doesn't respond	iH6 requires a reset	If unit is plugged in and doesn't respond, try resetting the unit by following these steps: a) remove iPod from dock b) unplug unit from power source c) remove back up batteries d) wait 1 hour, then resume use
	iPod is not docked properly	Remove your iPod from the dock and check for obstruction on the connectors in the dock and on your iPod. Then reseal it in the dock.
Battery Low icon always flashing	Batteries are weak	Replace with new batteries
	Batteries were not installed properly	Check to make sure the polarity (+ and – ends) matches the diagram in the battery compartment
iPod does not respond to the unit/iPod is playing but no sound comes out	iPod is not docked properly	Remove your iPod from the dock and check for obstruction on the connectors in the dock and on your iPod. Then reseal it in the dock.
	Your iPod software is too old	Upgrade software on your iPod. For details visit http://www.apple.com/ipod/download
	iPod is locked up/plays but no sound comes out	Check the volume setting. Make sure your iPod is working properly before docking into the unit. Please refer to your iPod manual for details. See above for software upgrade information. You may need to reset your iPod. To do so: 1. Toggle the Hold switch to hold position, then off. 2. Press and hold the Menu and center Select buttons at the same time until Apple logo appears. You may need to repeat this step.
	Using 1 st or 2 nd generation iPod, iPod Shuffle or other devices.	iH6 cannot control those iPods or other devices.
Remote Control didn't work	Battery weak	Replace current battery with new battery
	Remote Control is out of range of the iH6 remote sensor	Move within 30 feet of the unit.
iH6/iPod performance is erratic	The iH6 is reacting to external interference	Move unit away from potential sources of external interference such as computers, modems, wireless devices (routers) or fluorescent light.
No sound from iH6	Volume is set too low on iH6	Make sure volume is turned up
iPod didn't charge up	iPod is not installed properly	Remove your iPod from the dock and check for obstruction on the connectors in the dock and on your iPod. Then reseal it in the dock.
	iPod is locked up/ frozen	Please make sure your iPod is working properly before docking into the unit. Please refer to your iPod manual for details.
	iPod battery has problem	
No AM band radio sound but others OK	AM loop antenna is not connected to the unit	Plug the AM loop antenna connector to the jack on the back of the unit
AM band radio is very noisy	AM loop antenna isn't located properly	Move the AM loop antenna away from the main unit/iPod and rotate it for best reception

Troubleshooting

Symptom	Possible Problem	Solution
Sound is distorted	Volume level is set too high	Decrease the volume
	Sound source is distorted	<p>If the iPod original sound source (MP3) is old or of poor quality, distortion and noise are easily noticed with high-power speakers. Try a different audio source such as a music CD.</p> <p>If you are using an external sound source like older generation of iPod or iPod Shuffle, try reducing the output volume on the device itself. Also try turning bass boost OFF.</p>
Unit/adaptor gets warm after extended play at high volume	This is normal	Turn unit off for awhile or lower volume
Can't hear headphones/speakers attached to line out jack	Line out jack is not meant for headphones. Speakers need a power source	The signal from the line out jack needs amplification. Use powered speakers/monitors or other amplified audio device.

Solucionando problemas

Síntoma	Causa	Solución
La unidad no enciende	El adaptador de corriente AC no está conectado a un tomacorriente que funcione o no está conectado en la parte posterior de la unidad	Conecte el adaptador de corriente a un tomacorriente que funcione y a la parte posterior de la unidad
La unidad no responde	La unidad debe ser reprogramada	Si la unidad está conectada y no responde, pruebe reprogramarla siguiendo estos pasos: a) Quite el iPod de la base b) Desconecte la unidad del tomacorriente c) Quite las baterías auxiliares d) Espere 1 hora y vuelva a probar
El iPod no encastra correctamente	No ha colocado el encastre del iPod, o está utilizando el encastre incorrecto.	Verifique que el encastre sea el apropiado para su iPod
	El iPod no encastra correctamente	Quite el iPod del encastre y retire la posible obstrucción del encastre o de su iPod. Vuelva a colocar el iPod dentro del encastre.
El ícono de batería baja está destellando	Las baterías están gastadas	Reemplace las baterías
	Las baterías no están instaladas correctamente	Verifique que la polaridad de las baterías (- y +) se encuentren de acuerdo al diagrama del compartimiento de baterías.
El iPod no se comunica con la unidad	El iPod no está instalado correctamente	Quite el iPod del encastre y verifique posibles obstrucciones del encastre o de su iPod. Vuelva a colocar el iPod dentro del encastre.
	Su software es obsoleto	Renueve su software. Para mayor información, diríjase a http://www.apple.com/ipod/download
	El iPod no responde	Verifique que su iPod funcione correctamente antes de conectarlo a la unidad. Refiérase al manual de su iPod para más detalles.
	Usted tiene un iPod de primera o segunda generación, un Shuffle u otro tipo de aparato	El iH6 no puede controlar estos otros aparatos
No sale sonido de su iH6	El volumen del iH6 se encuentra muy bajo	Asegúrese de subir el volumen
El iPod no carga	El iPod no está instalado correctamente	Quite el iPod del encastre y retire la posible obstrucción del encastre o de su iPod. Vuelva a colocar el iPod dentro del encastre.
	El iPod está trabado/no responde	Por favor asegúrese de que su iPod funcione correctamente antes de colocarlo en el encastre. Refiérase al manual de su iPod para mayor información.
	La batería del iPod podría tener algún inconveniente	
La banda de AM no suena pero las demás sí El sonido sale distorsionado	La antena no está ubicada correctamente	Aleje la antena de la unidad y gírela para mejorar la recepción
	El volumen se encuentra muy alto	Baje el volumen
	El sonido sale distorsionado de la unidad	Si el sonido original de su iPod era de pobre calidad, las distorsiones y ruidos se harán más notables con los parlantes de alta potencia. Pruebe utilizar otra fuente de audio como un CD. Si está utilizando un iPod de primeras generaciones o un Shuffle, intente bajar el volumen de su aparato. También intente apagar el amplificador de bajos
El control remoto no funciona	Las baterías están gastadas	Reemplace las baterías por nuevas
	No está apuntando el control remoto hacia el iH6	Apunte el control remoto hacia el iH6 y manténgase a una distancia máxima de 10 pies de la unidad.

Solucionando problemas

Síntoma	Causa	Solución
La unidad recalienta luego de largos periodos de uso a alto volumen	Esto es normal	Apague la unidad o baje el volumen
No puede escuchar los auriculares/parlantes que están conectados a la ficha de salida "line out"	La línea de salida no está diseñada para auriculares. Los parlantes necesitan una fuente de alimentación	La señal de salida requiere amplificación. Utilice parlantes u otra clase de aparato amplificado.
El funcionamiento del iH6/iPod es errático.	El iH6 está reaccionando a interferencias externas.	Aleje la unidad de Fuentes potenciales de interferencia externa como computadoras, modems, ruteadores inalámbricos, luz fluorescente, etc.

Limited 90-Day Warranty Information

iHome Products, a division of SDI Technologies Inc. (hereafter referred to as SDI Technologies), warrants this product to be free from defects in workmanship and materials, under normal use and conditions, for a period of 90 days from the date of original purchase.

Should this product fail to function in a satisfactory manner, it is best to first return it to the store where it was originally purchased. Should this fail to resolve the matter and service still be required by reason of any defect or malfunction during the warranty period, SDI Technologies will repair or, at its discretion, replace this product without charge (except for a \$10.00 charge for handling, packing, return UPS/postage, and insurance). This decision is subject to verification of the defect or malfunction upon delivery of this product to the Factory Service Center listed below. The product must include proof of purchase, including date of purchase. The fee for service without proof of purchase is \$30.00.

Before returning this product for service, please first replace the batteries (if applicable) with fresh ones, as exhausted or defective batteries are the most common cause of problems encountered.

If service is still required:

1. Remove the batteries (if applicable) and pack the unit in a well padded, heavy corrugated box.
2. Enclose a photocopy of your sales receipt, credit card statement, or other proof of the date of purchase, if within the warranty period.
3. Enclose a check or money order payable to the order of SDI Technologies, for the sum of \$10.00 (\$30.00 without proof of purchase).
4. Send the unit prepaid and insured, to the Factory Service Center listed below.

Consumer Repair Department
SDI Technologies Inc.
1330 Goodyear Dr.
El Paso, TX 79936-6420

Disclaimer of Warranty

NOTE: This warranty is valid only if the product is used for the purpose for which it was designed. It does not cover (i) products which have been damaged by negligence or willful actions, misuse or accident, or which have been modified or repaired by unauthorized persons; (ii) cracked or broken cabinets, or units damaged by excessive heat; (iii) damage to digital media players, CD's or tape cassettes (if applicable); (iv) the cost of shipping this product to the Factory Service Center and its return to the owner.

This warranty is valid only in the United States of America and does not extend to owners of the product other than to the original purchaser. In no event will SDI Technologies or any of its affiliates, contractors, resellers, their officers, directors, shareholders, members or agents be liable to you or any third party for any consequential or incidental damages, any lost profits, actual, exemplary or punitive damages. (Some states do not allow limitations on implied warranties or exclusion of consequential damages, so these restrictions may not apply to you.) This warranty gives you specific legal rights, and you may also have other rights which vary from state to state. Your acknowledgment and agreement to fully and completely abide by the above mentioned disclaimer of warranty is contractually binding to you upon your transfer of currency (money order, cashier's check, or credit card) for purchase of your SDI Technologies product.

Questions? Visit www.ihomeaudio.com
For operating instructions: 1-877-ihome01(1-877-446-6301) Toll Free
For any other questions: 1-800-288-2792 Toll Free