

Fellowes®

1789 Norwood Avenue Itasca, Illinois 60143-1095
630-893-1600 Customer Service: 1-800-945-4545
<http://www.fellowes.com>

Australia
Tullamarine, Vic.

Benelux
Vianen, NL

Canada
Markham, Ont.

France
Rennes, I-V

Germany
Garbsen, Han.

Italy
Camerano, AN

Japan
Tokyo

Poland
Warsaw

United Kingdom
Doncaster, S. Yorks.

Fellowes®

Opti Trac
INSTRUCTION GUIDE

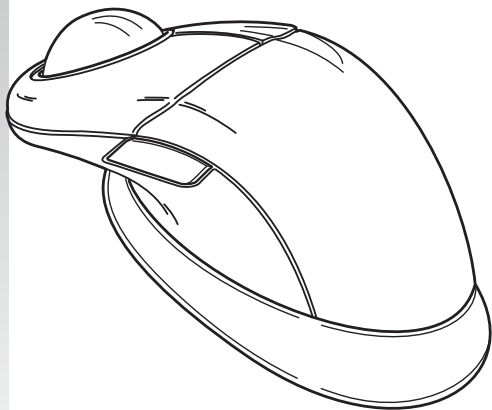

1 INTRODUCTION

Congratulations on your purchase! A revolutionary departure from those that have come before, the Opti Trac delivers a new level of freedom and control. Because everyone has their own idea of the perfect input experience, the Opti Trac operates equally as a mouse and a trackball—switching back and forth with the touch of a button. Incorporating revolutionary Optical Sensor technologies, the Opti Trac is equipped with the following features:

- One touch control to change from an optical mouse to an optical trackball.
- Trackball operates as a state-of-the-art scroll wheel, while in optical mouse mode.
- Increased accuracy: the optical image sensor records motions on the mousing surface 1,500 times per second for pin-point accuracy.
- Four programmable buttons.
- Consumer designed shape for enhanced comfort and control.
- No parts to clean: the mouse detects the movement optically, instead of with rubber ball mechanics.

2 HARDWARE REQUIREMENTS

The Fellowes Opti Trac requires a PC-compatible computer with an available USB or PS/2 port.

3 SOFTWARE REQUIREMENTS

The Fellowes Opti Trac requires Windows 95/98/2000/ME or XP. Be sure to check the Fellowes website at: www.fellowes.com for the latest drivers supporting the latest operating systems.

4 GET CONNECTED

Installing the Software

- a. Un-install or remove the current mouse driver. Before installing the Fellowes EasyPoint driver, we suggest you check if any other mouse driver is installed in your system. If yes, to avoid conflict with the Fellowes driver, please un-install or remove that driver before installation of the Fellowes EasyPoint software.
- b. Remember to save your Fellowes EasyPoint CD in case you ever need to reinstall the software.
- c. The input device will not function properly without installation of Fellowes software. The device will work as a basic mouse as soon as you plug it in, but to make full use of the device, you must install the software.
- d. Turn on the power to your computer.
- e. Insert the Fellowes EasyPoint CD into your CD-ROM drive. The Fellowes EasyPoint software is programmed to Auto Run, however if this function is disabled in your computer, please follow the steps below:
 - f. Choose the **"Start"** menu (Ctrl & Esc) and select **"Run"**.
 - g. Type [drive]:SETUP in the command line box and press Enter to select OK.
 - h. Follow the on-screen prompts to complete installation.
 - i. The Setup program will install the driver and add the icons automatically.
 - j. When the installation is complete, the standard option is to restart your computer.

For installation on a USB port:

(Windows 98 or higher required)

- a. Connect the mouse cable to the USB port on the computer (or a USB port on a hub connected to your computer) at any moment. USB installation does not require you to power off your computer.

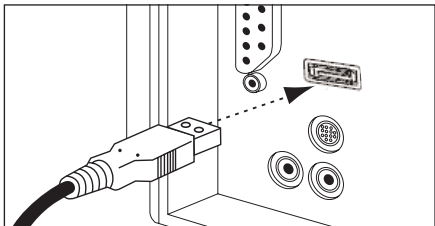

For installation on a PS/2 mouse port: *(PS/2 is not the preferred connection method, USB offers more functionality and control as compared to PS/2)*

- a. Turn off the power to your computer.
- b. Attach the 6-pin connector to the PS/2 port.
- c. Turn on the power to your computer.

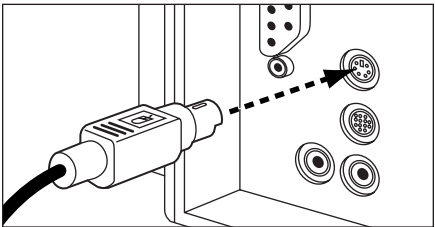

5 FELLOWES EASY POINT SOFTWARE

Your Easy Point software includes features for making button assignments, controlling cursor movements, and setting up the mouse in Windows. To access the Easy Point software, double click the mouse icon on the Windows Taskbar.



Mouse icon as it appears
in the Windows Taskbar

The Easy Point software can also be accessed by clicking the **Start** button, point to **Programs**, then **Fellowes** followed by **Easy Point**.

6 SWITCHING FROM MOUSE TO TRACKBALL

The use of two input devices in one has never been made easier. Simply click the right side button and the Opti Trac will become a trackball. While in Trackball mode, move the trackball to control the cursor.

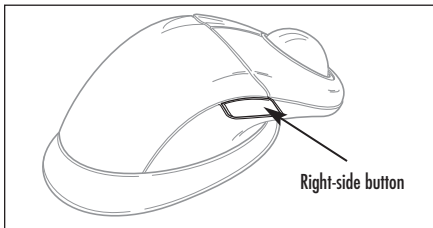

Click the right-side button again and the Opti Track will return to operating as an optical mouse. While operating as an optical mouse, the trackball will function as a scroll wheel.

7 TROUBLESHOOTING

The Fellowes Opti Trac does not work after installation or is not detected:

- Check all connections to be sure they are secured to the correct ports, and then restart the computer.
- Make sure the PS/2 mouse port has the proper configuration. Refer to your computer documentation for the correct port configuration. You may also have other system devices that conflict with the mouse. Check the IRQ/address settings of these devices for conflicts, and change the settings as required.
- If using as a PS/2 mouse, make sure that the BIOS setting on the connect port of your computer shows Enable. Refer to your computer document for the correct port configuration.

The screen cursor does not track well or the cursor does not move:

- The optical sensor on the mouse will not function on a highly-reflective surface such as glass, a mirror or some black surfaces. Hence, the surface of your desktop may be interfering with the performance of the input device. Utilize a traditional mouse pad or use the mouse on a different surface.

The cursor moves uncontrollably around the screen, files may open and other unexplained occurrences:

- There is a conflict with drivers and/or devices. Please remove all other drivers or devices until the problem is resolved.
- Use the other port type (USB or PS/2) to resolve the conflict.

8 FELLOWES CUSTOMER SERVICE

Our technical support representatives are readily available to help you with your problems. We will do our best to resolve the issue, or we will offer you full support in your decision to obtain a refund (please keep a copy of your dated sales receipt as proof of purchase). For technical support call 1-888-FEL-TECH or email at: www.feltech@fellowes.com. For questions about the warranty or functionality of this product, call 1-800-945-4545.

9 SOFTWARE LICENSE AGREEMENT

The enclosed software is being licensed to the original purchaser only on the condition that all of the terms contained in this license agreement are accepted. This is a legal agreement between the original purchaser and Fellowes. By opening the product package the purchaser agrees to be bound by the terms and conditions of the agreement. If these terms are not accepted, promptly return the software and all other items that are part of this product in their original package with the original receipt to the point of purchase for a full refund.

Fellowes and its suppliers offer a nonexclusive license for use of one (1) copy of the enclosed software package ("Fellowes EasyPoint Driver") on one (1) computer only with the Fellowes optical mouse you have purchased. You may make one (1) copy

of the software for backup purposes only; this copy must be labeled with all copyright and other notices included on the software as supplied by Fellowes. Installation onto a network server for the purpose of internal distribution of the software is permitted only if each user has purchased an individual software package for each computer to which the software is distributed.

Fellowes Inc. and its suppliers retain ownership of all software rights. User shall not decompile, disassemble or modify the software in any way. User may not transfer the software using any means (except as expressly permitted above). User may not transfer the software or Fellowes input product except upon permanent transfer, provided user does not retain a copy of the software, and provided transferee agrees to be bound by the terms and conditions of this license. Upon any violation of any of the provisions in this agreement, rights to use the software shall terminate and all copies shall be returned to Fellowes.

10 FEDERAL COMMUNICATIONS COMMISSION (FCC) NOTICE

This device complies with Part 15 of the FCC Rules. Operation is subject to the following two conditions: (1) this device may not cause harmful interference, and (2) this device must accept any interference received, including interference that may cause undesired operation.

This equipment has been tested and found to comply with the limits of a Class B digital device, pursuant to Part 15 of the FCC Rules. These limits are designed to provide reasonable protection

against harmful interference in a residential installation. This equipment generates, uses and can radiate radio frequency energy and, if not installed and used in accordance with the instructions, may cause harmful interference to radio communications. However, there is no guarantee that interference will not occur in particular installations, which can be determined by turning the equipment off and on, the user is encouraged to try to correct the interference by one or more of the following measures:

1. Reorient / Relocate the receiving antenna
2. Increase the separation between the equipment and receiver
3. Connect the equipment into an outlet on a circuit different from that the receiver is connected.
4. Consult the dealer or an experienced radio / TV technician for help

CAUTION: Changes or modifications not expressly approved by the manufacturer responsible for compliance could void the user's authority to operate the equipment.

1 1 DISCLAIMER

The following does not apply to any country where such provisions are inconsistent with the local law:

Fellowes Inc. makes no warranties with respect to this documentation, whether expressed or implied. All material is provided "as is". This includes, but is not limited to, any implied warranties of merchantability and fitness for a particular purpose. The information covered in this document is subject to change

without notice. Fellowes Inc. assumes no responsibility for any errors that may appear in this document.

All brand names mentioned in this manual are trademarks or registered trademarks of their respective companies.

Copyright 2001 Fellowes Inc. All rights reserved.



Technical documentation as required is kept at the following address:

Company: Fellowes Europe

Address: Yorkshire Way West Moor Park

Country: Doncaster, South Yorkshire

Telephone No.: 44-1302-885-331

Fax No.: 44-1302-836-999

12 LIMITED WARRANTY

Fellowes Inc. warrants this mouse to be free from defects in material and workmanship for a period of three years from the date of purchase by the original consumer. If any part is found to be defective during the warrant period, your sole and exclusive remedy will be repair or replacement, at Fellowes' option and expense, of the defective part.

This warranty does not apply in cases of abuse, mishandling or unauthorized repair. ANY IMPLIED WARRANTY, INCLUDING THAT OF MERCHANTABILITY OR FITNESS FOR A PARTICULAR PURPOSE, IS HEREBY LIMITED IN DURATION TO THE APPROPRIATE

WARRANTY PERIOD SET FORTH ABOVE. In no event shall Fellowes be liable for any consequential or incidental damages attributable to this product. This warranty gives you specific legal rights. You may have other legal rights which vary from state to state.

To obtain service under this warranty on products purchased in the USA, return the machine prepaid to the address found in the Instruction Guide. Please allow two weeks for processing. Return with product:

- Copy of original sales receipt.
- A card stating your name, address, daytime telephone number, product model and serial number, plus a brief description of the problem

For specific instructions on obtaining service under this warranty on products purchased outside the USA, contact the appropriate office listed on the back of the Instruction Guide.

Warrantor: Fellowes Inc.