

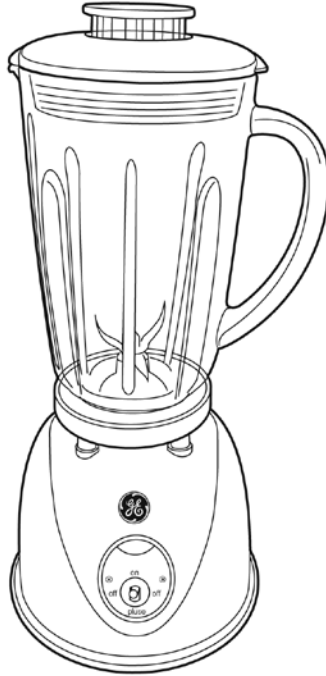

BLENDER



Item Stock Number

169053

UPC: 681131690539

**For Customer Assistance, call Customer Service at
1-877-207-0923 (US) or 1-877-556-0973 (Canada)**

169053 • 681131690539

IMPORTANT SAFEGUARDS

When using electrical appliances, basic safety precautions should always be followed, including the following:

1. Carefully read all instructions before using.
2. To protect against risk of electrical shock, do not immerse cord, plug or blender base in water or other liquid.
3. Close supervision is necessary when any appliance is used by or near children.
4. Unplug from outlet when the appliance is not in use, before putting on or taking off parts, and before cleaning.
5. Avoid contacting moving parts.
6. Do not operate any appliance with a damaged cord or plug or after the appliance malfunctions, or is dropped or damaged in any manner. Call our toll-free customer service number for information on examination, repair or adjustment.
7. The use of attachments, including canning jars, not recommended by the manufacturer because they may cause a risk of fire, electric shock, or injury to persons.
8. Do not use outdoors.
9. Do not let cord hang over edge of table or counter, or touch hot surfaces.
10. Keep hands and utensils out of container while blending to reduce the risk of severe injury to persons or damage to the blender. A scraper may be used but must be used only when the blender is not running.
11. Blades are sharp. Handle carefully.
12. To reduce the risk of injury, never place cutter-assembly blades on base without jar properly attached.
13. Always operate blender with the cover in place.
14. When blending hot liquids, remove center piece of two-piece cover.
15. Do not place on or near a hot gas or electric burner or in a heated oven.
16. To disconnect, turn the control to off then remove plug from wall outlet.
17. Do not use appliance for other than intended use.

SAVE THESE INSTRUCTIONS!

Consumer Safety Information

This appliance is intended for indoor household use only.

Short Power Supply Cord Information

A short power supply cord is provided to reduce the risk of becoming entangled in or tripping over a long cord. Extension cords may be used if care is exercised in their use.

If an extension cord is used, the marked electrical rating of the extension cord should be at least as great as the electrical rating of the appliance. The cord should be arranged so that it will not drape over the countertop or tabletop where it can be pulled on by children or tripped over unintentionally. If the appliance is of the grounded type, the extension cord should be a grounding-type 3-wire cord.

Grounding Instructions

This appliance must be grounded while in use to protect the operator from electrical shock. The appliance is equipped with a 3-conductor cord and a 3-prong grounding-type plug to fit the proper grounding-type receptacle. The appliance has a plug that looks like sketch A. An adaptor, sketch B, should be used for connecting sketch A-type plug to two-ground receptacles. The grounding tab, which extends from the adaptor, must be connected to a permanent ground such as a properly grounded outlet box as shown in sketch C, using a metal screw.

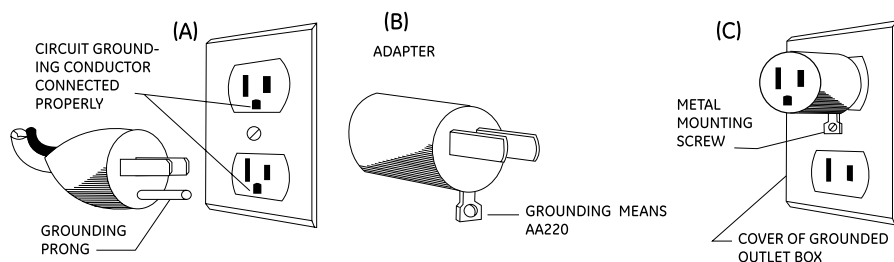

PARTS

1. Blender Base
2. Power On Light
3. Power Switch (see detail)
4. Blade Collar
5. Filler Cap
6. Blade
7. Glass Jar
8. Lid
9. Cord Storage

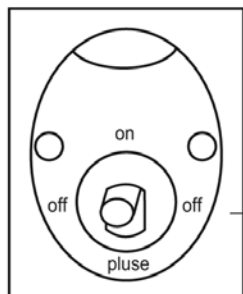
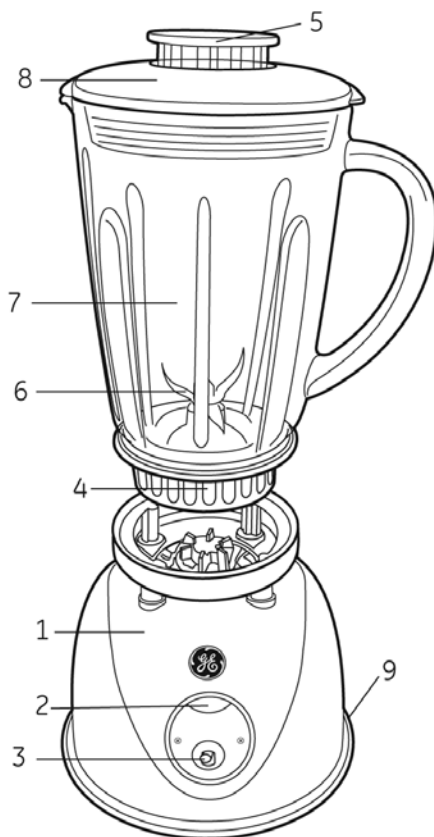

MODEL

Model No.	Rated voltage	Rated power	Capacity	Dimensions	Weight
169053	120V	500W	1.25L	44x22x20CM 17.3x8.7x7.9 inches	3.984Kg 8.783 lb.

HOW TO ASSEMBLE

Control Panel

Before First Use: After unpacking the blender, wash everything except the blender base in hot, soapy water. Dry thoroughly. Wipe the blender base with a damp cloth or sponge. **DO NOT IMMERSE THE BASE IN WATER.** Care should be taken when handling the cutting blades as they are very sharp.

1. Before starting, make sure that the blender cord is unplugged and that the power switch, located on the middle of the blender base is in the "off" position.
2. Check the jar to be certain that the cutting blade assembly gasket (a), rubber seal (b), and jar gasket (c) are in the proper positions. Cutting blade assembly must be securely tightened to the jar before placing food or liquid in the jar. Tighten the cutting blade assembly by holding the jar and rotating the cutting blade assembly clockwise.
3. Place the jar assembly on the blender base so that it is firmly seated and not tilted to one side. Never place the blade assembly on the blender base without the jar being completely assembled and securely tightened.

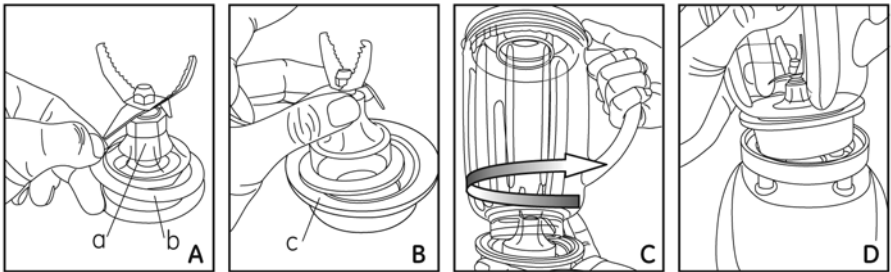

OPERATING INSTRUCTIONS

1. Add ingredients to be processed and place lid on the jar. Be sure lid is fully seated. Be sure the power switch is still in the "off" position before plugging the blender into the wall outlet.
2. Blue light indicates power on. You can start to operate the unit.
3. Turn the power switch to your desired setting.
 - On**— For ingredients that require continuous processing to a smooth mixture, use "on" setting.
 - Pulse**— Short bursts of power. It is used for chopping and ice-crushing. You can hold the power switch down in the "Pulse" position for continuous processing until desired texture is achieved.
 - Off**— To stop processing, turn the power switch to "off" position.
4. Always be sure to switch the power switch to the "off" position when you are not blending.

USER MAINTENANCE INSTRUCTIONS

Cleaning

1. Before cleaning, be sure that the unit is “off,” power-on light is off and the cord is unplugged from the outlet.
2. Whenever possible, rinse the filler cap and lid immediately after processing to make cleanup easier. Do not immerse the motor base in liquid. IF washing the jar by hand, wash in hot, soapy water, rinse, and dry thoroughly. If necessary, use a nylon bristle brush to thoroughly clean the jar.
3. Do not use rough scouring pads or cleansers on any plastic or metal parts.
4. Do not fill the jar with boiling water. Do not place any of the parts in boiling water.
5. Do not allow the blade assembly in the jar to soak in water for long periods of time.

CAUTION – NEVER IMMERSE THE BASE IN WATER OR ANY OTHER LIQUID

CUSTOMER ASSISTANCE

If you have a claim under this warranty, please call our Customer Assistance Number. For faster service, please have the model, type and series numbers ready for the operator to assist you. These numbers can be found on the bottom of your appliance.

Model: _____ **Type:** _____ **Series:** _____

Customer Assistance Number 1-877-207-0923 (U.S.) or 1-877-556-0973 (Canada)

Keep these numbers for future reference!

For more information, please visit us at www.walmart.com

TWO-YEAR LIMITED WARRANTY

What does your warranty cover?

- Any defect in material or workmanship.

For how long after the original purchase?

- Two years.

What will we do?

- Provide you with a new one.
- For those items still under warranty but no longer available, WAL-MART reserves the right to replace with a similar GE branded product of equal or greater value.

How do you make a warranty claim?

- Save your receipt.
- Properly pack your unit. We recommend using the original carton and packing materials.
- Return the product to your nearest WAL-MART store or call Customer Assistance at 1-877-207-0923 (U.S.) or 1-877-556-0973 (Canada).

What does your warranty not cover?

- Parts subject to wear, including, without limitation, glass parts, glass containers, cutter/strainer, blades, seals, gaskets, clutches, motor brushes, and/or agitators, etc.
- Commercial use or any other use not found in printed directions.
- Damage from misuse, abuse, or neglect, including failure to clean product regularly in accordance with manufacturer's instructions.

How does state law relate to this warranty?

- This warranty gives you specific legal rights, and you may also have other rights which vary from state to state or province to province.
- This warranty is in lieu of any other warranty or condition, whether express or implied, written or oral, including, without limitation, any statutory warranty or condition of merchantability or fitness for a particular purpose.
- WAL-MART, GE and the product manufacturer expressly disclaim all responsibility for special, incidental and consequential damages or losses caused by use of this appliance. Any liability is expressly limited to an amount equal to the purchase price paid whether a claim, however instituted, is based on contract, indemnity, warranty, tort (including negligence), strict liability, or otherwise. Some states or provinces do not allow this exclusion or limitation of incidental or consequential losses so the foregoing disclaimer may not apply to you.

What if you encounter a problem with this product while using it outside the country of purchase?

- The warranty is valid only in the country of purchase and you follow the warranty claim procedure as noted.



is a trademark of General Electric Company and is used under the license by Wal-Mart Stores Inc., Bentonville, AR 72716

Marketed in Canada by:

Wal-Mart Canada Corp.
1940 Argentia Road, Mississauga, Ontario L5N1P9