

VLP 102 Pendant Microphone and Charging Station Setup Guide

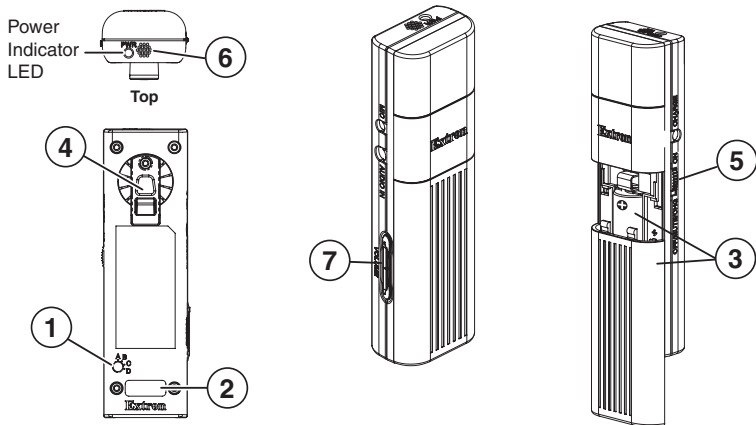

- ① Set the channel using the rotary switch. **A and C = 2.3 MHz;** **B and D = 2.8 MHz.**
- NOTE** Each microphone must be on a different frequency. Set the channel to C or D to disable the volume buttons.
- ② Apply the Teacher or Student sticker to identify the microphone.
 - ③ Remove the battery door, and insert the AA battery. Charge the battery if necessary.
 - ④ Attach the lanyard to the rotating clip. Adjust the lanyard to position the microphone approximately 4" below the user's chin.
 - ⑤ Turn the microphone on by sliding the power switch up.
 - ⑥ Speak in a normal tone of voice. Do not block the microphone port opening.
 - ⑦ Adjust the volume if necessary.

IMPORTANT:
For user manual or
installation instructions, refer to:
www.extron.com

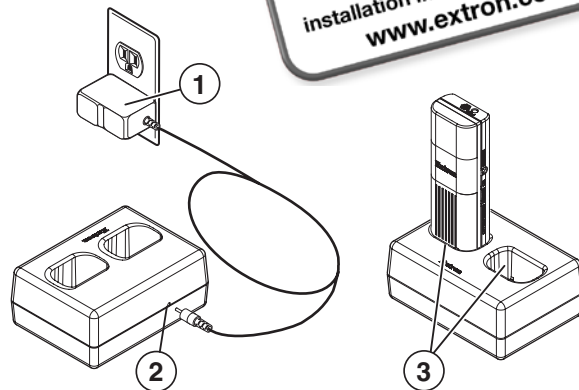

- ① Plug the wall charger (5 V, 1 A) into a wall outlet.
- ② Connect the wall charger's cable to the charging station's power jack.
- ③ Place the microphone in one of the charger's slots, with the charging contacts facing down. **Charge for at least 6 hours.**

NOTE The microphone can be left to charge for extended periods. In maintenance mode, the charge is retained when complete.

CAUTION Do not charge alkaline or NiCd batteries.

68-1631-01 Rev. A 01 09

VLR 102 IR Receiver and VLR 102SR Secondary Receiver Setup Guide

- ① Cut a 2" to 3" diameter hole in the ceiling tile.
- ② Align the center of the receiver housing with the hole in the ceiling tile.
- ③ Insert the mounting screw through the receiver housing and the hole in the ceiling tile.
- ④ Attach the Z-bracket to the end of the screw on the back side of the ceiling tile. Replace the ceiling tile.
- ⑤ Set the Mix DIP switch to off and the Tone DIP switch to on (VLR 102 only).
- ⑥ Pull an Ethernet cable to the receiver location, and connect one end of the cable to the RJ-45 jack (labeled OUT) on the receiver base.
- ⑦ Align the arrow on the dome's tab with the raised arrow on the edge of the housing. Rotate the dome to the right (clockwise) until the arrow on the tab aligns with the raised dot on the housing.
- ⑧ Connect the other end of the Ethernet cable to the VoiceLift adapter for a VLR 102 Receiver, or to the RJ-45 jack labeled IN for a VLR 102SR Secondary Receiver.
- ⑨ Connect the VoiceLift adapter to a PoleVault switcher.

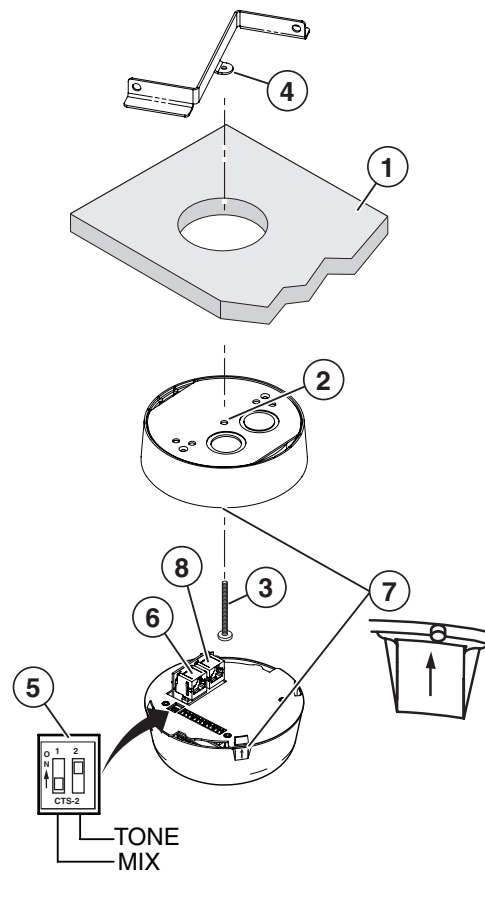
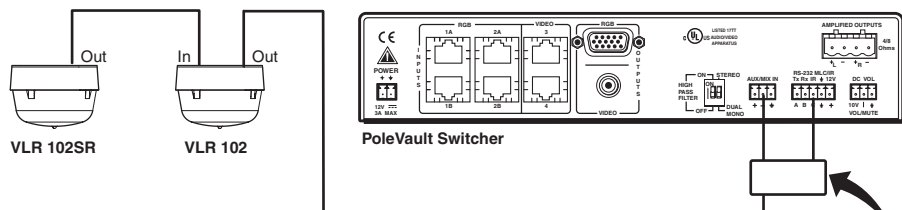

Extron USA - West Headquarters +800.633.9876 Inside USA / Canada Only +1.714.491.1500 +1.714.491.1517 FAX	Extron USA - East +800.633.9876 Inside USA / Canada Only +1.919.863.1794 +1.919.863.1797 FAX	Extron Europe +900.3987.6673 Inside Europe Only +31.33.453.4040 +31.33.453.4050 FAX	Extron Asia +800.7339.8766 Inside Asia Only +65.6383.4400 +65.6383.4664 FAX	Extron Japan +81.3.3511.7655 +81.3.3511.7656 FAX	Extron China +400.883.1568 Inside China Only +86.21.3760.1568 +86.21.3760.1566 FAX	Extron Middle East +971.4.2991800 +971.4.2991880 FAX
---	---	--	--	---	---	---