

# S1

bluetooth car kit

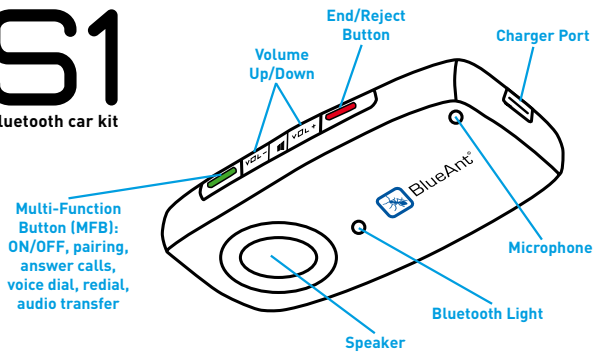

## Let's Get Started

To use the S1 you need to **pair your phone**:

1. Make sure the S1 is off. You can tell whether the S1 is on or off by looking at the Bluetooth Light on the front. If the light is on or flashing, then the S1 is on: turn it off by holding down (the Multi-Function Button) for about 5 seconds. The S1 will beep and the light will turn red and then go out.
2. With the S1 off, hold down (the MFB) for about 5 seconds, until the Bluetooth Light starts flashing red and blue. The S1 is now in pairing mode.
3. Go to the Bluetooth menu on your phone. Turn on Bluetooth and perform a search for Bluetooth devices (see the section on **pairing** in your phone's manual for help with this).
4. When the phone displays a list of devices, select the **BLUEANT S1**, enter the code **0000** when prompted, and accept any connection requests. When the S1 has connected to your phone, the Bluetooth Light will flash blue every few seconds.

You only need to pair each phone once: the S1 will automatically reconnect in future. On some phones you need to set the S1 as a "trusted connection" in the options menu to enable automatic reconnection: see your phone's manual for more details.

## Installing the S1 in your Car

1. Attach the clip to the slots on the back of the S1 and slide it so that it locks into place.
2. You can attach the clip 2 different ways, depending on how you want to position the S1 on your car's visor.
3. Slide the clip and the S1 onto your car sun visor. Make sure that the microphone is directed towards you.

## When the Phone Rings

- 1.
2. Say ACCEPT CALL, ACCEPT, ANSWER or OK: Use the buttons:
  - > Click to accept the call.
  - > Click to reject the call.

**NOTE** You can only answer calls with your voice if you've turned on the **voice answer feature**.

To turn voice answer on or off, the S1 must be in "Standby" mode (no ongoing call or music streaming).

- > To turn voice answer on, hold down **VOL +** for about 5 seconds (until the S1 beeps).
- > To turn voice answer off, hold down **VOL -** for about 5 seconds (until the S1 beeps).

If the voice answer feature is on, the S1 plays an extra beep when the phone rings. To use voice answer you **must** say the words **clearly and slowly**.

## Making Calls

To make a call, do any of the following:

- > Dial a number on your phone: the audio will automatically transfer to the S1.
- > To redial the last number you called, hold down (the MFB) for about 3 seconds (this function is only available if your phone supports the handsfree Bluetooth profile).
- > If your phone supports voice dialing, then you can use it to make calls. Hold down (the MFB) for about 1 second to activate your phone's voice dialing feature. You may need to record voice tags on your phone to use this feature: see your phone's manual for more details.
- > To end a call, click (the End/Reject button).

## Transferring Audio Back to your Phone

You can transfer audio from the S1 back to your phone by holding down (the MFB) for about 3 seconds.

Hold down (the MFB) for about 1 second to transfer audio back to the S1 (although please note that not all phones support this feature).

## Pairing Another Phone: Multipoint

The S1 can simultaneously connect to 2 Bluetooth® devices. To pair and connect a second phone, simply repeat the pairing process.



When 2 phones are connected:

- > You can receive calls on either phone and **answer whichever one rings**.
- > If you use the S1 to initiate a call, it will happen on the current **primary phone**.

The primary phone is the one that either connected to the S1 most recently or has most recently had an active call through the S1.

You can also force the S1 to swap the primary and secondary phones by holding down (the End/Reject button) for 5 seconds (you might want to do this so that you can use the S1's calling functions to initiate a call on the new primary phone).

The S1 can store pairing information for up to 8 Bluetooth devices. If you pair a ninth device, it will replace the pairing information for the phone that has not connected to the S1 for the longest time.

## Charging

Your S1 has an initial charge to get started. In future you must charge it for up to 3 hours.

1. Connect the supplied charger to the S1 and plug it in to an external power source. During charging, the Bluetooth Light will turn orange.
2. Charge the S1 until the Bluetooth Light turns solid green.

## Automatic Reconnection

If you leave the S1 switched on when you take your phone out of Bluetooth range (for example when you get out of the car) then the S1 will automatically search for your phone and reconnect when you bring the phone back into range. It may take up to 10 seconds for the S1 to find your phone and connect.

## Playing Music

If your phone supports the **Bluetooth A2DP profile**, you can play music from it through the S1 speaker.

To play music, make sure your phone is paired and connected, then simply go to your phone's music player and press play.

If the music does not automatically play through the S1, select the S1 on your phone's "play via" or "listen via" setting.

- > Double click (the MFB) to play/pause the music.
- > The music will pause automatically if you receive a call on the phone.

## Switching the S1 On and Off

- > To turn the S1 on, hold down (the MFB) until the Bluetooth Light starts flashing blue (about 1 second).
- > To turn the S1 off, hold down (the MFB) until the Bluetooth Light turns red and then goes out (about 5 seconds).

## Problems?

If you are having trouble, the first thing to try is to reset your phone (see your phone's manual for help with this). If you are still having problems, you can **reset the S1** and start again:

1. Switch the S1 off.
2. Hold down **VOL +** and (the MFB) until you hear a loud siren/distinctive tone.
3. The S1 will turn on. Hold down (the MFB) for about 5 seconds to turn it off again.

The S1 has now been reset: all pairing and other information has been deleted. When you turn the S1 back on again it will go straight to pairing mode.

## Help and Support

This guide is just to get you started with your S1. If you are having trouble getting the S1 to work, visit [docs.blueantwireless.com](http://docs.blueantwireless.com) to download the user guide, which has full details of all the S1's features and functions.

Please call us before returning the S1 to a store and we will help you through any difficulty you may have.

- > In North America call 1 866 891 3032.
- > In other countries please see [www.blueantwireless.com](http://www.blueantwireless.com) for your local support number.

## The Legal Bit

By using this product you are agreeing to BlueAnt's terms and conditions, available at [www.blueantwireless.com](http://www.blueantwireless.com).

In order to activate your **full warranty coverage**, please register your product online at [www.blueantwireless.com](http://www.blueantwireless.com).

Check the laws and regulations on the use of mobile devices and accessories such as your BlueAnt device in the areas where you drive. Always obey them.

Do not leave your device, or use your device, in any area where the temperature may exceed 60°C (140°F), such as inside a closed car on a hot day.

The Bluetooth® word mark and logos are registered trademarks owned by Bluetooth SIG, Inc. and any use of such marks by BlueAnt Wireless is under license.



BlueAnt®

SIMPLY CONNECT

© 2009 BlueAnt Wireless. All Rights Reserved.