

**Do not return product to retail store. For Technical Assistance and product return information, please call Customer Care:**

**877-221-1252**

**HOURS: Monday through Friday from 8:00 a.m. to 4:45 pm CST.**

NOTE: THE MANUFACTURER IS NOT RESPONSIBLE FOR ANY RADIO OR TV INTERFERENCE CAUSED BY UNAUTHORIZED MODIFICATIONS TO THIS EQUIPMENT. SUCH MODIFICATIONS COULD VOID THE USER AUTHORITY TO OPERATE THE EQUIPMENT

**FC** NOTE: This equipment has been tested and found to comply with the limits for a Class B digital device, pursuant to Part 15 of the FCC Rules. These limits are designed to provide reasonable protection against harmful interference in a residential installation. This equipment generates, uses and can radiate radio frequency energy and, if not installed and used in accordance with the instructions, may cause harmful interference to radio communications. However, there is no guarantee that interference will not occur in a particular installation.

If this equipment does cause harmful interference to radio or television reception, which can be determined by turning the equipment off and on, the user is encouraged to try to correct the interference by one or more of the following measures:

- Reorient or relocate the receiving antenna.
- Increase the separation between the equipment and receiver.
- Connect the equipment into an outlet on a circuit different from that to which the receiver is connected.
- Consult the dealer or an experienced radio/TV technician for help.



PLEASE DISPOSE OF OLD OR DEFECTIVE BATTERIES IN AN ENVIRONMENTALLY SAFE WAY IN ACCORDANCE WITH YOUR LOCAL REGULATIONS



If at any time in the future you need to dispose of this product please note that: Waste electrical products should not be disposed together with household waste. Please recycle where facilities exist. Check with your local Authority or retailer for recycling advice

#### LIMITED WARRANTY – INTERNATIONAL

Consumer may have more remedies at law than follows. Chaney Instrument Company warrants to the owner, this product to be free from defect in material and workmanship for one year from date of purchase. CHANEY INSTRUMENT SHALL NOT BE LIABLE FOR ANY INCIDENTAL, INDIRECT OR CONSEQUENTIAL DAMAGES, WHETHER ARISING IN CONTRACT OR TORT. Chaney Instrument's obligation (at its option) is limited to repair or replace this product. For in-warranty repair, send product, accompanied by Guarantee, bearing Dealer's name and date of purchase, with \$5.00 to cover handling and postage, to:

Chaney Instrument Company  
965 Wells Street  
Lake Geneva, Wisconsin 53147

www.chaneyinstrument.com  
Tel: 877-221-1252  
Made in China

## Wireless Weather Station & Atomic Clock

MODEL # 00972

### Main Unit

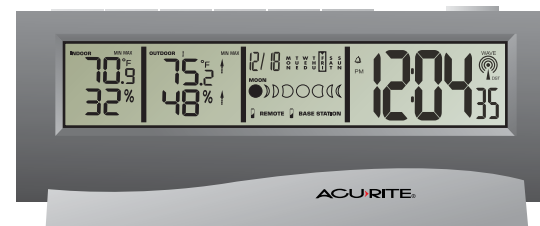

### Wireless Sensor

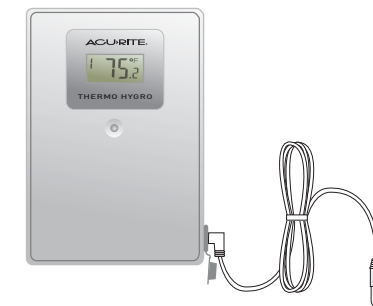

with low  
temperature  
adaptor

Thank You! We appreciate you for purchasing the new generation radio-controlled wireless weather station and atomic clock. This instrument is designed and engineered with state-of-the-art technology and components. It will provide these accurate and reliable measurements: date, time, and indoor/outdoor temperatures and humidity levels.

### 1 CHECK PACKAGE CONTENTS

- (1) Main Unit - 7.25" x 2.75" x 1.5"\*
- (1) Wireless Sensor - dimensions: 2.5" x 3.5" x 1"\*
- (1) 10"\* wired low temperature adaptor
- (2) 1" (2.5cm) screws with plastic anchors
- (1) Instruction manual

\* dimensions approximate

### 2 READ

Please read this entire manual carefully before you set up the instrument and begin to use it. In this way you can become familiar with the features of the weather station & clock to get the most benefit from it.

### 3 INSTALL BATTERIES

**Main Unit:** Always install batteries into the main unit first. On the back of the unit, remove the battery compartment cover. Insert 2 AA alkaline (or lithium - See NOTES below) batteries. Replace the cover.

**Wireless Sensor:** After batteries have been put into the main unit, remove the 4 screws to remove the back cover of the wireless sensor. Insert 2 AA alkaline (or lithium) batteries. Press the "TX" button and replace the back cover and the 4 screws on the sensor. Put the sensor aside for now, and continue to learn about the main unit. Later, in part 5 of this manual you'll learn more about the wireless sensor.

**NOTE:** When replacing the batteries for the wireless sensor, remove the batteries from the sensor and clear the sensor's channel on the main unit by pressing and holding the CHANNEL button when the corresponding channel is displayed. Reinstall the batteries into the wireless sensor and press and release the TX button to synchronize the units.

#### Operating Range of Batteries

LITHIUM BATTERIES	-22°F (-30°C)	(70°C)	158°F
ALKALINE BATTERIES	-4°F (-20°C)	(70°C)	158°F

Severe cold (below -4° F/-20° C) can cause alkaline batteries to freeze and function improperly. Use lithium batteries in extremely low temperature conditions to ensure continued operation.



#### Low Battery Indicator:

When the battery level is low for the main unit or the wireless sensor, the low battery level icons will illuminate.

### 4 CHOOSE WHERE TO PLACE THE MAIN UNIT and WIRELESS SENSOR

**Main Unit:** Choose wall mount or table-top placement.

- Choose a location for each unit that is at least 10 feet away from other electronic devices that may interfere with the wireless signal.
- Wall mounting: Use the mounting slot on the back of the unit to hang it from one of the supplied screws.
- Table-top placement: Fold out the integrated table-top stands to place the main unit on a table-top surface.

**Wireless Sensor:** When placing the sensor, consider these things:

- Although the sensor is designed for outdoor use, placement in a protected area will prolong its life.
- Mounting: Use the mounting slot on the back of the unit to hang it from one of the supplied screws.
- The sensor must be within 100 feet (30 meters) of the main unit.
- The sensor is resistant to weather and to water. It is NOT WATERPROOF.
- Prolonged exposure to cold weather may cause damage to the LCD panel.
- Wireless sensor can be placed outdoors to observe outdoor temperatures and humidity.

#### Main Unit BACK

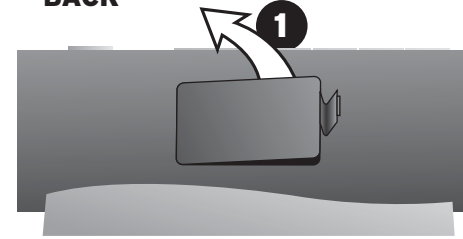

#### Remove Battery Compartment Cover

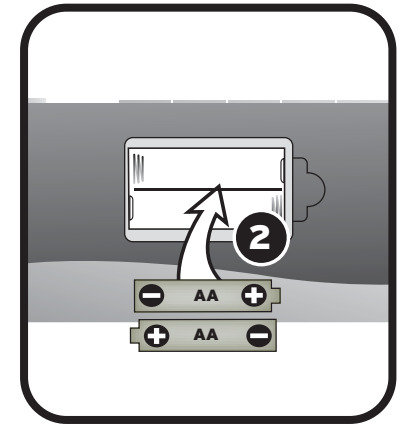

#### Wireless Sensor BACK

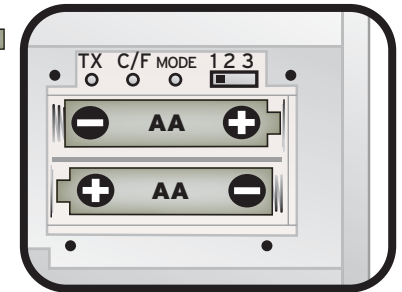
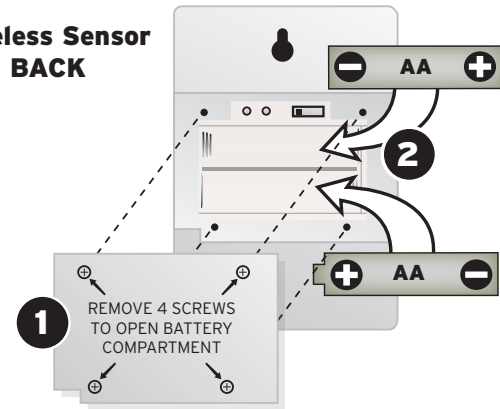

#### Placement

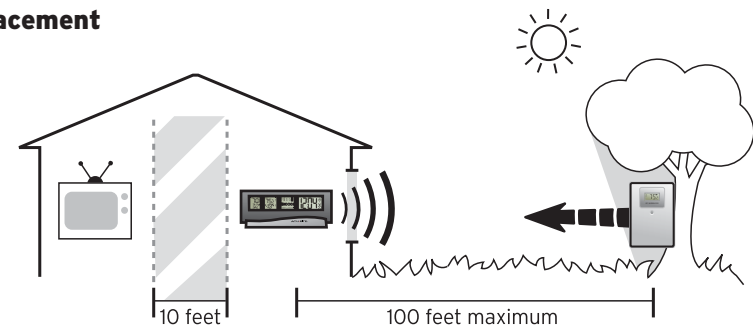

## Using the included LOW TEMPERATURE ADAPTOR

The wireless sensor will operate normally down to -4 °F. Below -4 °F, the electronics may operate erratically or become non-functional until the temperature raises again. In case temperatures fall below -4°F, bring the wireless sensor indoors and use the included low temperature adaptor by running the wire out through a soft seal opening such as a window or door. When routing the wire for the low temperature adaptor, make certain that the wire will not be severed or damaged.



**NORMAL TEMPERATURES**

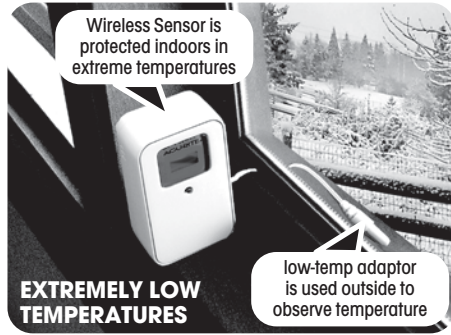

**EXTREMELY LOW TEMPERATURES**

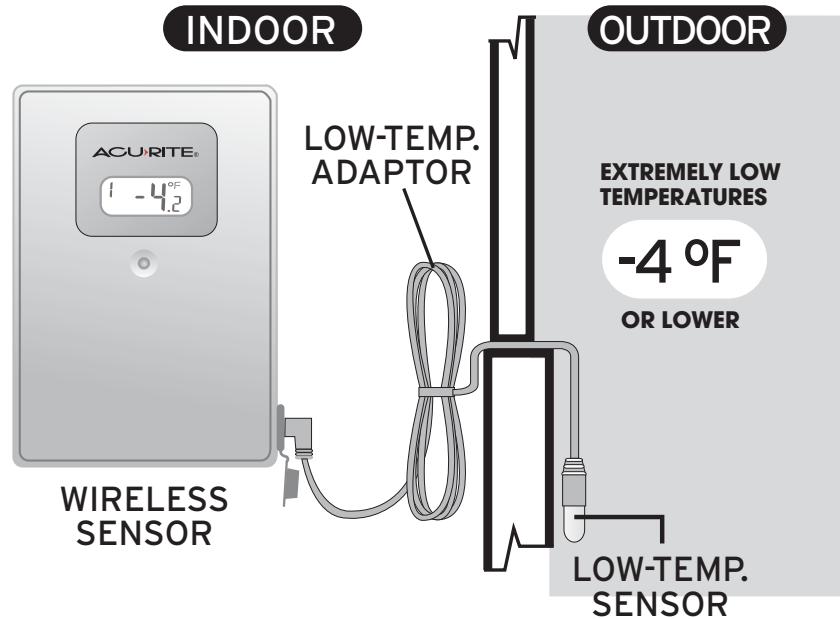

**NOTE:** The wired TEMPERATURE ADAPTOR only observes temperature, not humidity. If the adaptor is placed outdoors, and the wireless sensor is indoors- the wireless sensor will only transmit the indoor humidity reading & the outdoor temp. reading.

## MAIN UNIT FUNCTION BUTTONS

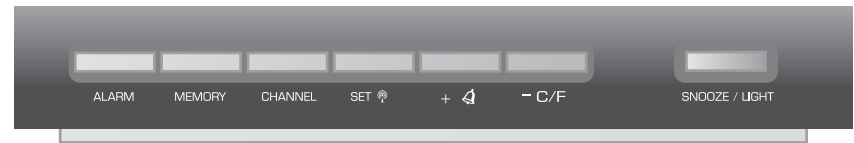

( top of main unit )

## 5 PREVIEW THE DISPLAYS

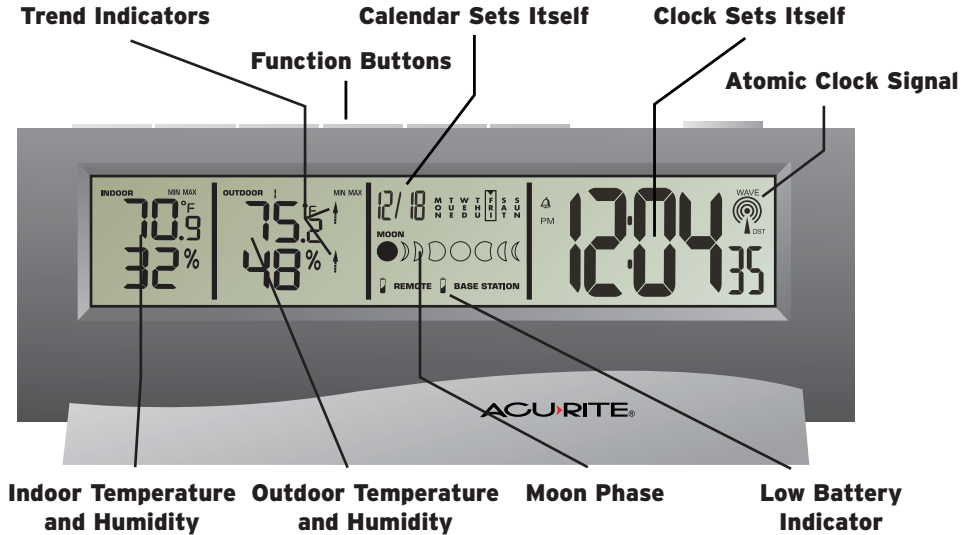

## Wireless Sensor Display



Press the "MODE" button inside the back of the wireless sensor to display temperature and/or humidity in one of three ways:

- 1) Temperature continuously,
- 2) Humidity continuously, or
- 3) Temperature for 5 seconds, then humidity for 5 seconds

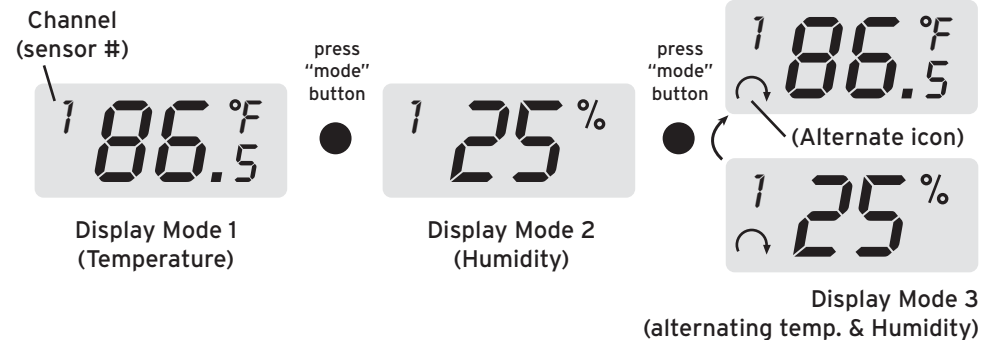
**NOTE:** The sensor's display setting does not affect the main unit's display.

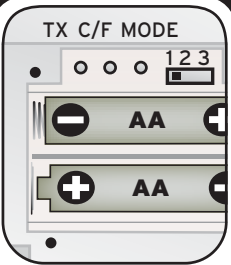

## 6 UNDERSTAND WHAT THE BUTTONS DO

MAIN UNIT Operation buttons are located on the front and back of the main unit	BUTTON NAME	PRESS & RELEASE	PRESS & HOLD FOR 3 SECONDS
	CH (CHANNEL)	choose channel 1,2, or 3	clears the current channel
	MEMORY (min/max)	read maximum & minimum values for temperatures, humidity (both indoor & outdoor)	N/A
	ALARM	view alarm time for 5 seconds	set alarm time
	SET 	starts radio controlled time synchronization	to set clock & calander manually
	+ 	turn alarm on/off OR raise a setting by one unit	fast advance setting mode
	- C/F zone	select °C or °F OR lower a setting by one unit	fast reverse in time setting mode & current time zone setting
	SNOOZE / LIGHT	silence the alarm for 5 minutes  -or- activate backlight for low-light viewing	N/A
WIRELESS SENSOR	BUTTON NAME	PRESS & RELEASE	 3 buttons & slide switch Inside BACK of remote sensor case
	TX	sends wireless signal to main unit	
	C/F	select °C or °F display mode for wireless sensor	
	Mode	choose display mode for wireless sensor	
CH (1,2or 3)	choose channel 1, 2, or 3		

## 7 MAIN UNIT FEATURES

**Radio-controlled Clock :** The unit starts synchronizing the clock after the 1st channel of the wireless sensor begins to send its information to the main unit. (This is called registration.) The built-in antenna receives the official time signal from the US Government's National Institute of Standards and Technology. A microchip translates the time signal and adjusts the time display for the correct time, and date.

### Manually Setting the Time and Date:

- 1) Press and hold the "SET" button, and the year display will flash on the screen. Using the "+" and "-" buttons set the year. When the correct year is entered, press and release the "SET" button to confirm the setting.
- 2) Once you have confirmed the year, follow the same procedure to set the month, date, hour, minute, 12 or 24-hour time preference, and DST (Daylight Saving Time).

**NOTE:** You cannot change any settings manually if the clock is attempting to synchronize. Allow the clock to finish the cycle, and then manual changes can be made if the clock has not automatically acquired the signal and set itself to the correct time.

### Time Zone:

Note: Default setting is Pacific Time. If you live outside of the Pacific Time Zone, you will need to set your Time Zone using the following procedure:

- 1) Press **and hold** the "- / C/F" button on the front of the clock for three seconds. The area of the clock where the seconds are usually displayed will be replaced with the letter for the time zone it is currently set in.
- 2) If set to the default setting, you will see a flashing letter "P" on the screen after pressing and holding the "- / C/F" button. Press **and release** the "- / C/F" button until the letter shown corresponds to your time zone:

**P = Pacific M = Mountain C = Central E = Eastern**

Once your zone is displayed, there is nothing more you need to do. After about 3 seconds, the seconds will once again be displayed on your clock.

The antenna icon () will flash on and off during synchronization. If the icon disappears, this indicates that the radio signal is not available. If you are unable to obtain a signal after a long period of time, try placing the base unit away from sources of interference such as computers, televisions, cordless phone bases, and other electronic items.

Note: The synchronization process can take 24-72 hours.

### Celsius/Fahrenheit:

Press and release the "-" (minus) button. A beep sounds, and the display will change to either Fahrenheit or Celsius.

### Moon Phase: ●)D)O)C)C)

The moon phase will automatically display based on the calendar date. The moon phase display will scroll from left to right, and pause for about 5 seconds to display the current moon phase. NOTE: the moon phase will not be correct unless the date and year are programmed correctly.

### OTHER ADJUSTMENTS

#### Trend Indicators:

Arrow icons in the upper display will indicate the following trends:

**Rising**



**Steady**



**Falling**



The arrow icons will indicate rising, steady or falling if the temperature or humidity change is more than 1 unit (degree/percent) within an hour.

#### SETTING THE ALARM:

- 1) Hold "ALARM" for 3 seconds.
- 2) The hour number(s) flash. Press "+" or "-" to enter the desired hour. Press "ALARM" to confirm the hour setting.
- 3) The minute number(s) flash. Press "+" or "-" to enter the desired minute. Press "ALARM" to confirm the minute setting.

To view the alarm time, press the "ALARM" button during the normal operating mode. Alarm time will display for five seconds. Then, the current time is displayed.

**To Turn the Alarm On and Off:** Press the "+" button during the normal operating mode. The bell (alarm) icon will show if the alarm is set and activated.

**To Turn off the Alarm for One Day:** To turn the alarm off for one day, press the "ALARM" button when the alarm sounds

#### Snooze/Light:

When the alarm sounds, press the "SNOOZE/LIGHT" button to trigger the snooze feature. The alarm is silenced for five minutes. Then, it will sound an alarm again. The "SNOOZE/LIGHT" button also activates the built-in backlight for 5 seconds.

#### MIN / MAX MEMORY:

Press the "MEMORY" button to view the maximum values (Inside/Outside Temperature and Humidity) for 5 seconds. Press the "MEMORY" button again to view the minimum memory.

**The memory will automatically refresh every 24 hours.**

### 8 MULTIPLE WIRELESS SENSORS

The main unit supports up to three wireless sensors. Each additional wireless sensor must be designated a different channel number. Assigning different channel numbers differentiate each sensors temperature and hygrometer readings for the main units' display.

**Additional wireless sensors are sold separately. Call 1-800-556-2548 to order. WIRELESS SENSOR MODEL # 01022**

- 1) Open each sensor by removing the 4 screws and the cover.
- 2) Install batteries, see section 3.
- 3) Use the interior slide switch to select a channel - 1, 2, or 3.
- 4) Choose Celsius or Fahrenheit with the C/F button, for the sensor display.
- 5) With the "MODE" button choose what you want the sensor display to show:  
Temperature only,  
Humidity only, or  
Temperature and humidity, alternating.
- 6) Press the "TX" button to send a signal to the base station.
- 7) Replace the cover and the 4 screws.
- 8) Mount the sensor. See section 4 for placement of the wireless sensor unit.

### 9 PRODUCT SPECIFICATIONS

MODEL#00592W

#### MEASUREMENT RANGE:

Indoor main unit	:	0° C to + 50° C (+32° F to +122° F)
Outdoor/Indoor humidity	:	20% - 99% RH
Wireless sensor	:	-20° C to +70° C (-4° F to +158° F)
with low-temp adaptor	:	-30° C to +70° C (-22° F to +158° F)
Barometer	:	900 to 1050 mb/hPa
Channel	:	maximum of three wireless sensors
Transmission	:	up to 30M (100 ft.) open area, RF434 MHz
Resolution	:	0.1° for temperature, 1% for humidity, 1 hPa
mb for	:	pressure
Clock	:	WWVB radio-controlled, quartz back-up
Batteries	:	AA x 2 alkaline for main unit; AA x 2 alkaline
for	:	wireless sensor