

OLYMPUS®

DIGITAL VOICE RECORDER

DS-3300

Quick Start Guide

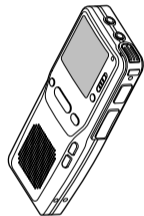

Display (LCD Panel)

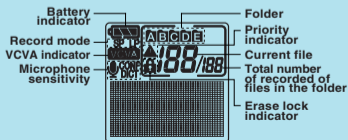

Getting Started

Turning ON the Recorder

Slide the power switch to the ON position to activate the recorder.

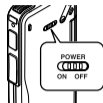

Power Save Mode

When the recorder is ON but not in use for sometime, it will switch to power save mode automatically. To reactivate the recorder again, press any of the buttons on the recorder.

CUSTOM Button (Programmable)

The CUSTOM button can be assigned two kinds of functions by being pressed in different ways. By default, the button is programmed on PRIORITY for both ways:



CUSTOM Button

CUSTOM button	Default	Assigned
Short	PRIORITY	
Continuous	PRIORITY	

*Insert here your settings.

The following functions can be assigned to CUSTOM button.

- DISPLAY button
- Recording Mode setting button
- Microphone Sensitivity setting button
- VCVA setting button
- PRIORITY setting button

Recording

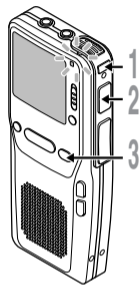

- a Current recording mode
- b New file number
- c Selected Author ID

- 1 Press the **NEW** button to create a new file.
- 2 Press the **REC** button to start recording. The record/play indicator lamp glows red. Aim the microphone at the sound source.
- 3 Press the **STOP** button to stop recording. If you want to append additional recordings to the same file, press the REC button again.

Overwrite Recording

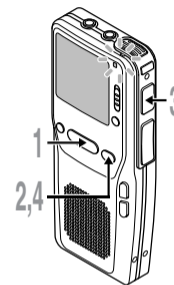

- a Current playback time
- b Total recording time of the file

- 1 Select and play the file you want to overwrite.
- 2 Stop playback at the starting point of overwrite.
- 3 Press the **REC** button to start overwriting. The record/play indicator lamp glows red.
- 4 Press the **STOP** button to stop overwriting.

Insert Recording

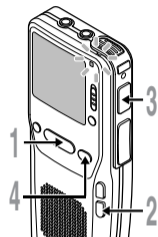

- 1 Select and play the file you want to insert an additional recording into.
- 2 While playing the file, press the **FOLDER/MENU** button to insert an additional recording. "INSERT ?" appears on the display.
- 3 Press the **REC** button to start inserting an additional recording. The record/play indicator lamp glows red. "INSERT REC" and the remaining recording time will alternate on the display.
- 4 Press the **STOP** button to stop inserting the additional recording.

OLYMPUS®

OLYMPUS IMAGING CORP.
Shinjuku Monolith, 3-1 Nishi-Shinjuku 2-chome, Shinjuku-ku, Tokyo 163-0914, Japan
Tel. 03-3340-2111

OLYMPUS IMAGING AMERICA INC.
Two Corporate Center Drive, PO BOX 9058, Melville, NY 11747-9058, U.S.A.
Tel. 1-800-622-6372

OLYMPUS IMAGING EUROPA GMBH
(Premises/Goods delivery) Wendenstrasse 14-18, 20097 Hamburg, Germany.
Tel. 040-237730
(Letters) Postfach 10 49 08, 20034 Hamburg, Germany.

OLYMPUS UK LTD.
2-8 Honduras Street, London EC1Y 0TX, United Kingdom
Tel. 020-7253-2772

<http://www.olympus.com>

Authorized Olympus Dealer

Playing

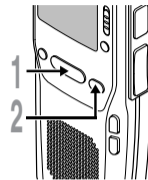

1 Select the file, then press the **PLAY** button to start playback.

2 Press the **STOP** button at any point you want to stop the playback.

Playback functions

Operation

Fast Forward	Press the FF button once while stopped.
Rewind	Press the REW button once while stopped.
Cue	Hold the FF button while stopped or playing a file.
Review	Hold the REW button while stopped or playing a file.
Fast skip	Press the FF button once while fast-forwarding or twice while stopped.
Backward skip	Press the REW button once while rewinding or twice while stopped. If the REW button is pressed within 2 seconds, the recorder skips to the beginning of the previous file.

Erasing a File

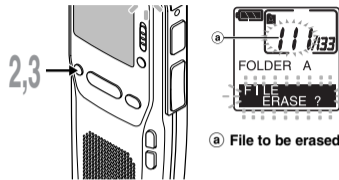

1 Select the file you want to erase.

2 Press the **ERASE** button. "FILE ERASE ?" flashes on the display for approximately 8 seconds.

3 Press the **ERASE** button once more while "FILE ERASE ?" is flashing. The display changes to "FILE ERASE !" and erasing will start.

"ERASE DONE" is displayed when the file is erased. File numbers will be reassigned automatically.

Menu List

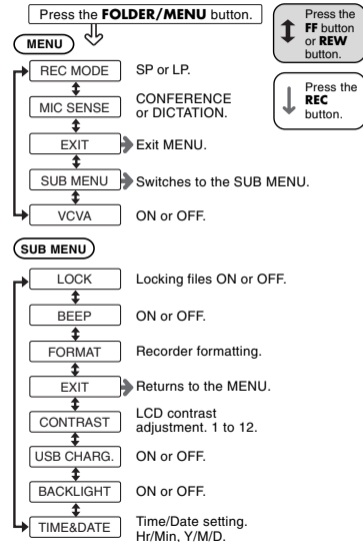

Alarm Message List

Message	Action
BATTERY LOW	Charge the battery or replace with new batteries.
FILE IS LOCKED	Unlock the file.
INDEX FULL	Erase index marks that are no longer required.
FOLDER FULL	Erase unnecessary files.
MEMORY ERROR	Insert a compatible card.
MEMORY FULL	Erase files that are no longer required or insert another card.
FORMAT ERROR	Reformat the card.
SYSTEM ERROR	This is a malfunction. Contact the place of purchase.
INSERT CARD	Insert a card.
CARD COVER IS OPEN	Close the card cover securely until it click.

E1-BZ8094-01
AP0503