

Safety Instructions & Operator's Manual for

SNAPPER®

LT12 & LT16 SERIES 2 LAWN TRACTORS

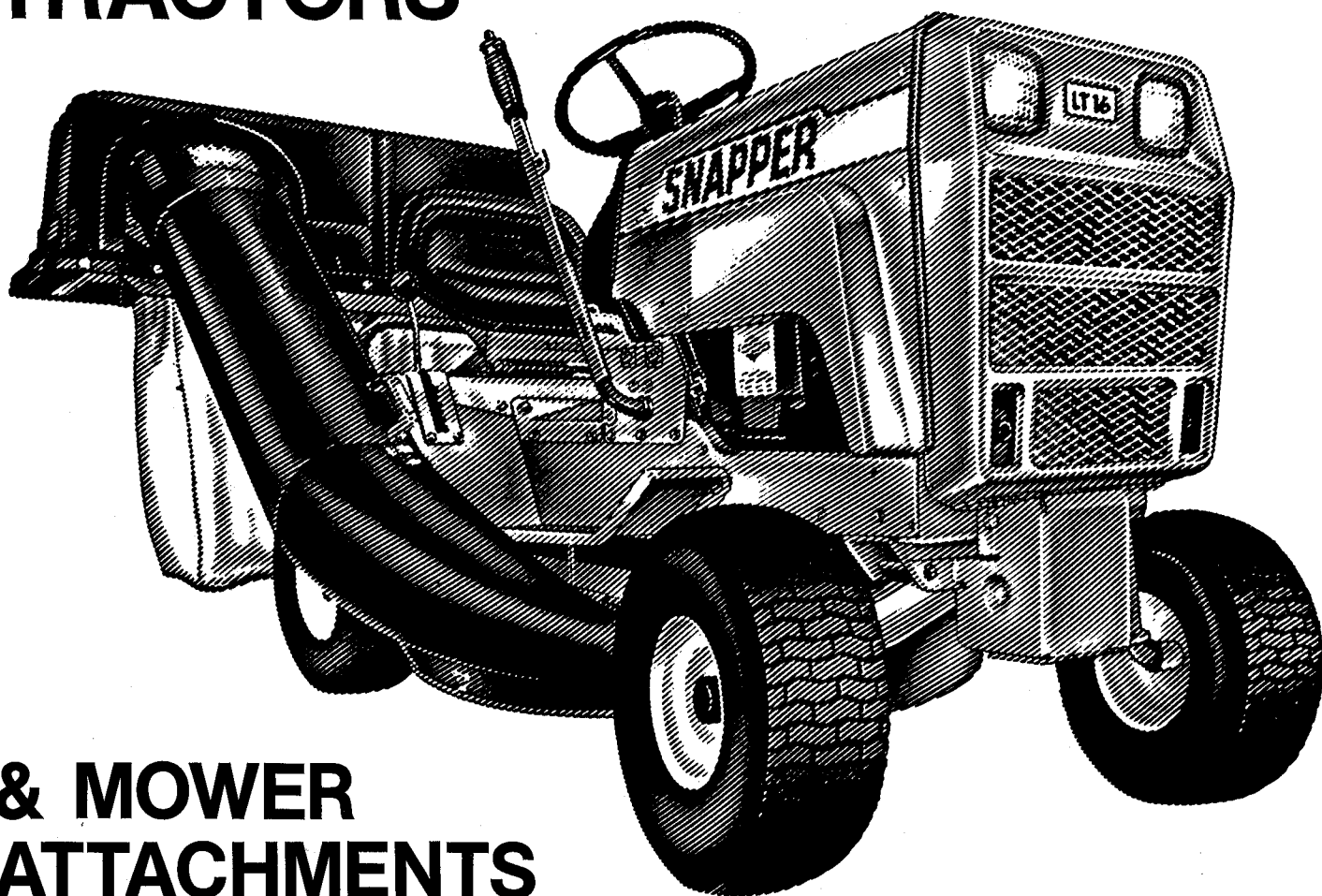

& MOWER ATTACHMENTS

Thank you for buying a SNAPPER product! Your SNAPPER Lawn Tractor was designed and built to provide long and satisfactory service. Keep in mind that it, like any other mechanical device, can be potentially dangerous if used improperly and that no accident prevention program can be successful without the wholehearted co-operation of the person responsible for the operation of the equipment. Study this manual and pay particular attention to the Important Safety Precautions on page 2. Following these instructions will help you continue to enjoy the trouble-free performance expected of a SNAPPER product.



SNAPPER POWER EQUIPMENT

McDonough, GA • 30253



MANUAL #1-5069 REV. 2 (9/87)

IMPORTANT SAFETY INSTRUCTIONS

WARNING: This powerful cutting machine is capable of amputating hands and feet and can throw objects that can cause injury and damage! Failure to observe the following safety instructions could result in serious injury. Carefully read this manual and question your dealer if something is not clear. Should the dealer be unable to answer to your satisfaction, write or call the Customer Service Department at SNAPPER Power Equipment, McDonough, Georgia 30253 (phone 404-957-9141).

PROTECTION FOR CHILDREN

1. DO NOT allow children in yard when machine is operated.
2. DO NOT allow children to ride on machine or on attachments.
3. DO NOT allow pre-teenage children to operate machine.
4. Only responsible teenagers with mature judgement shall be allowed to operate machine and only under close supervision.

PROTECTION AGAINST TIPOVERS

1. DO NOT operate machine on slopes exceeding 15° (27% grade).
2. On slopes above 10° (18% grade); exercise extreme caution; shift into LO gear beforehand, turn blade OFF when traveling uphill; reduce speed to No. 1 position, avoid sharp turns.
3. Avoid uphill starts. If machine is stopped going uphill, turn blade off and back slowly down the slope.
4. DO NOT mow under any condition where traction or stability is doubtful without first test driving over the terrain with blade OFF.
5. Stay alert for holes and other hidden hazards and keep away from ditches, washouts, culverts, fences and protruding objects.
6. DO NOT mow back and forth across face of slopes.
7. KEEP A SAFE DISTANCE (at least three feet) away from edge of ditches and other drop offs.

OTHER IMPORTANT PRECAUTIONS

1. Read and follow operator's manuals and instructions furnished with attachments.
2. Only mature, responsible persons shall operate the machine.
3. Mount and dismount machine from left side.
4. Wear appropriate protective clothing when mowing such as long pants and substantial footwear, not barefoot or with open sandals.
5. Practice operation of machine with blade OFF to learn controls and develop skill.
6. Persons under the influence of alcohol or drugs must not operate machine.
7. Know how to stop blade and engine quickly in preparation for emergencies.

8. Keep people and pets a safe distance from machine.
9. Shields, deflectors, switches, blade controls and other safety devices must be in proper position and functional.
10. Clear area to be worked of wire, rocks and other objects that could cause injury if thrown by blade.
11. STOP blade, stop engine and remove key when leaving machine.
12. DO NOT operate machine unless properly seated with feet on foot rests or pedal.
13. Keep hands and feet away from rotating blade underneath deck. Never place foot on ground while blade is ON or when machine is in motion!
14. Turn blade OFF, stop engine and wait for blade to stop before attempting to unclog grass or leaves to prevent loss of fingers or hand.
15. Blade must be switched OFF except when cutting grass. Set cutter in highest position when mowing over rough ground.
16. Deflector or grass catcher must be in position. Never point discharge at people, passing cars, windows or doors. Watch out for traffic when crossing or near roadways.
17. Operate in reverse only after careful observation of entire area behind the machine. DO NOT mow in reverse unless absolutely necessary.
18. Service machine and make adjustments only when engine is stopped.
19. Have machine serviced by an authorized Snapper dealer at least once a year and have the dealer install any new safety devices.
20. Use only genuine Snapper replacement parts to assure that original standards are maintained.
21. Tighten all nuts, bolts, screws, frequently and check, adjust, repair or replace brakes as needed.
22. Lubricate machine at intervals specified in manual to prevent controls from binding.
23. Mow only in daylight or with good artificial light.
24. Handle gasoline with care! Never remove cap while engine is running. Fill tank outdoors only with engine stopped and cool. Clean spilled gasoline from machine. Store gasoline in approved container, out of the reach of children, in well ventilated, unoccupied building.
25. DO NOT change engine governor speed settings or overspeed engine.
26. Check grass catcher components frequently for signs of wear or deterioration and replace as needed to prevent injury from items going through weak or worn spots.
27. Exercise caution when pulling loads. Limit loads to those you can safely control and attach loads to hitch plate as specified with Snapper attachment instructions.

OPERATION

KEEP RED BOOT OVER
POSITIVE TERMINAL

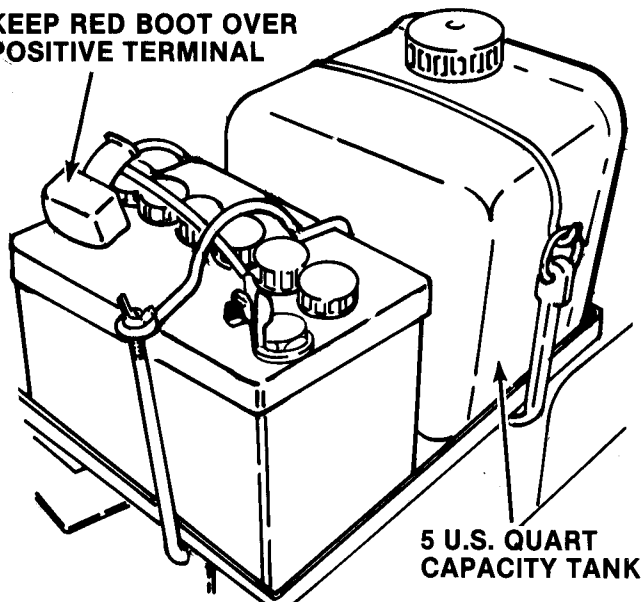

FIG. 1 - BATTERY & FUEL TANK

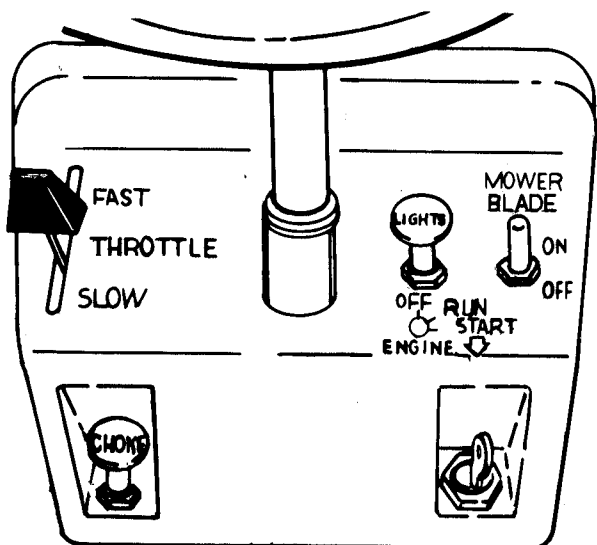

FIG. 2 - DASH PANEL CONTROLS

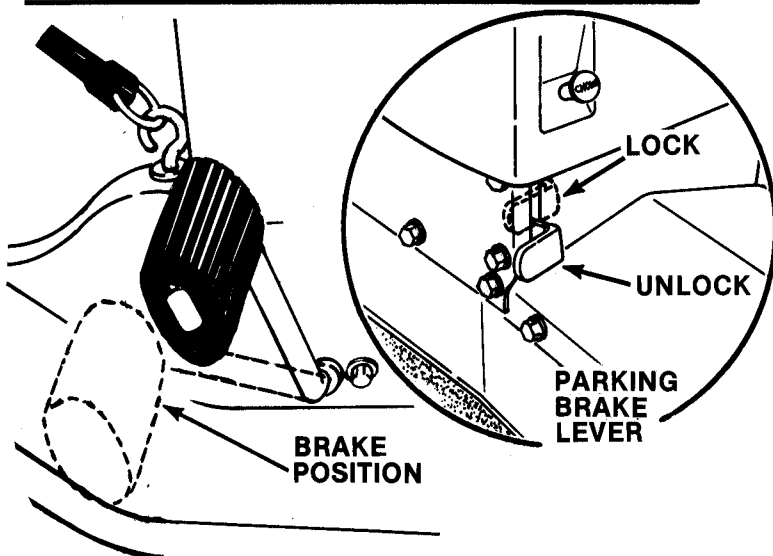

FIG. 3 - CLUTCH/BRAKE PEDAL OPERATION

Become thoroughly familiar with the location of all controls and the function of each before operating the machine. Make sure each operator reads the important safety precautions on page 2 of this manual and all safety messages on the tractor and attachments.

PRE-START CHECKS

Before each start-up, check and/or perform the following:

1. CHECK TIRES and add air as needed to bring pressure up to specifications (12 psi front, 10 rear tires).
2. CHECK ENGINE OIL and add new oil as needed to bring level up to (but not over) the full mark on the dipstick.
3. CHECK EXTERIOR SURFACES and remove any accumulation of grass, oil, chaff, dirt etc. especially from areas such as cooling inlets and outlets on tractor and cooling fins on engine.
4. CHECK FUEL and add gasoline (of grade specified in engine manual) to bring the level up to but not higher than the full line on side of tank.
5. RE-ADJUST SEAT & STEERING WHEEL as needed to most comfortable position (Refer to instructions on page 4).

OPERATION

Know beforehand how to stop the machine in preparation for possible emergencies. The mower is stopped by moving the MOWER BLADE switch downward to OFF. Forward or rearward motion of tractor is stopped by pushing the CLUTCH/BRAKE pedal all the way down. The engine is stopped by turning the engine ignition key to the OFF position. Keep these points in mind while operating.

STARTING ENGINE

1. The lawn tractor is equipped with interlocks to prevent starting of the engine until the following conditions are met.

- A. The operator must be seated on the tractor seat.
- B. The CLUTCH/BRAKE pedal must be fully depressed.
- C. THE MOWER BLADE switch must be in the OFF position.

The seat interlock also functions to shut off the engine in the event the operator's seat is vacated while the machine is in operation with either the mower blade switch ON or the CLUTCH/BRAKE pedal not fully depressed. In the event of an interlock malfunction, do not operate the tractor until the condition is corrected.

2. Pull the CHOKE knob all the way out to start cold engine. Little or no choking will be needed when restarting a warm engine.

3. Move engine THROTTLE past midpoint into a FAST setting. You may have to vary the setting somewhat at first to find the best position for your engine.

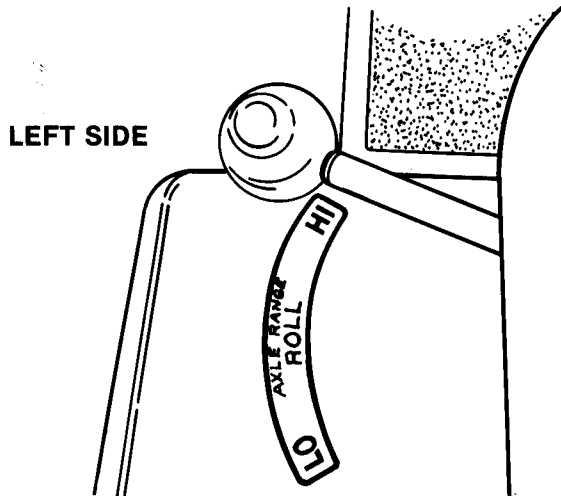

FIG. 4 - AXLE RANGE SELECTOR ON LEFT

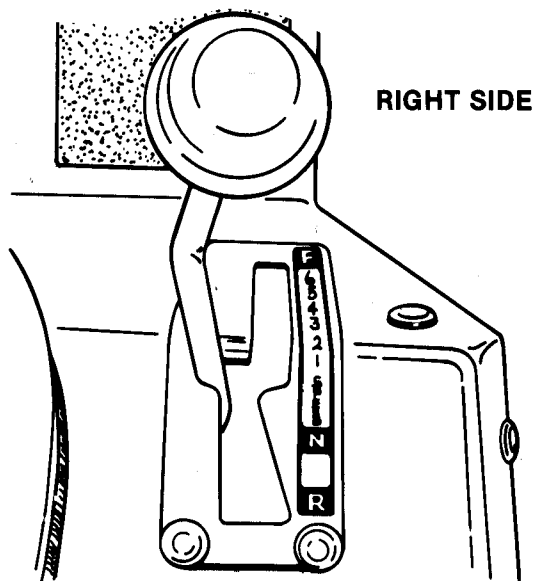

FIG. 5 - GROUND SPEED SELECTOR

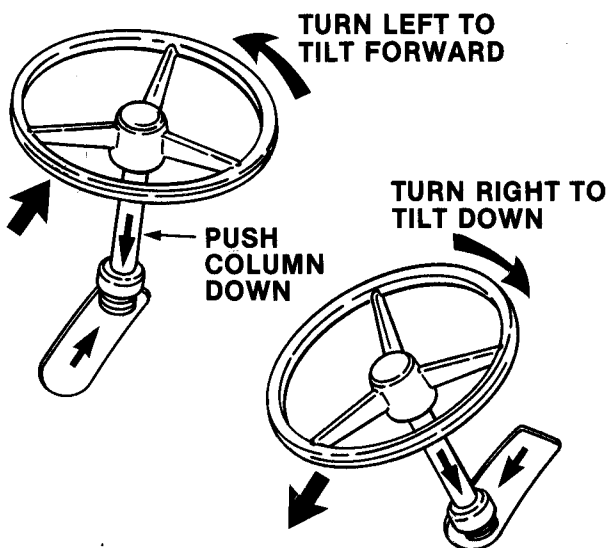

FIG. 6 - TILTING STEERING WHEEL

4. Insert key in ENGINE IGNITION switch , turn key to START position to crank engine and hold until engine starts then release. NOTE: Limit cranking intervals to five seconds duration to prevent overheating of starting motor and/or depletion of battery energy. Normally five seconds is sufficient cranking time for starting. If this time is exceeded locate and correct cause of starting problem.

5. As engine warms, gradually push choke knob back in to panel. Move throttle to desired engine speed setting.

TO START MOTION

After the engine has been started and is running smoothly, proceed as follows to start forward or rearward motion.

1. Before releasing the Clutch/Brake pedal, shift the axle into HI(fast) or LO (slow) range with the selector located to the left of the operator's seat (figure 4). NOTE: To avoid gear damage, DO NOT shift axle range with machine in motion! It may be necessary to rock tractor slightly forward or reverse to shift.

2. With Clutch/Brake pedal depressed, shift Speed selector to 1 for forward or R for reverse and release pedal. (For comfort and safety always shift back to 1 before starting forward.)

Avoid uphill starts. If machine is stopped going up slope, turn blade OFF and back slowly down slope. If uphill start must be made, turn blade OFF and set throttle at half speed. The axle range selector must be in LO and the speed selector must be in 1.

TO STOP MOTION

Push Clutch/Brake pedal all the way down to stop forward or rearward motion.

TO SET PARKING BRAKE

Depress Clutch/Brake Pedal.
Raise parking brake lever to lock pedal down.

TO ROLL MACHINE

Shift axle range selector to roll or hold Clutch/Brake pedal half down.

TO ADJUST OPERATOR'S SEAT

FORE & AFT ADJUSTMENT: With machine stopped, loosen the two wingnuts on seat rails. Sit in operators seat and while depressing the clutch/brake pedal, slide the seat forward or rearward to the most comfortable position then lock in position by tightening both wingnuts.

SEAT TENSION ADJUSTMENT: Raise Seat. Turn large wing nut clockwise for heavier operator or counter clockwise for lighter operator. Fig. 7

TO ADJUST STEERING WHEEL

After the operator's seat has been adjusted as described above, sit in the seat and set the steering wheel to the most comfortable position. To adjust, grasp steering column and push down then turn the wheel to the left to tilt forward or to the right to tilt down. Make sure the wheel does not interfere when getting on and off the tractor.

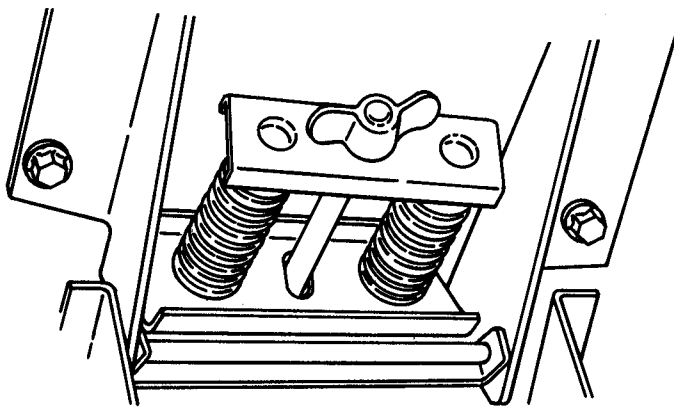

FIG. 7 - SEAT TENSION ADJUSTMENT

TO OPERATE MOWER

During transport or for clearance through gates it may become necessary to raise the discharge deflector. Reinstall the wing nuts on the studs when the deflector is raised so they will not be lost. Be sure to lower the deflector and clamp it securely down with the wing nuts before mowing.

The cutting height can be changed to any one of nine positions by raising or lowering the cutting deck attachment with the implement lift lever as shown. Fig. 8

To prevent accidental starting of the blades, the mower blade switch (Figure 2) is designed so that it must be pulled out before it can be moved forward to the blade ON position.

To suit mowing conditions, experiment by increasing engine speed and/or decreasing driving speed until smoothest cut is obtained without placing engine under heavy strain.

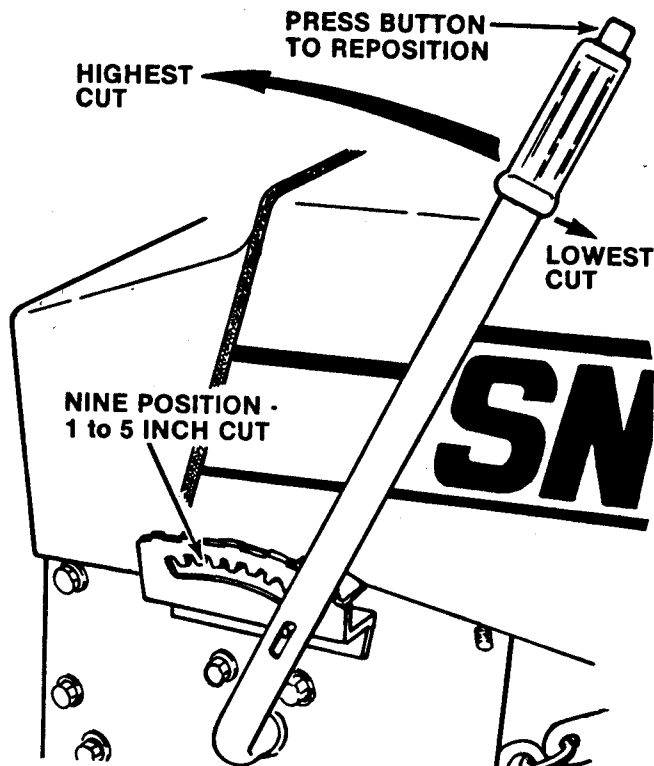

FIG. 8 - IMPLEMENT LIFT LEVER

FRONT AXLE AS VIEWED FROM UNDERNEATH TRACTOR

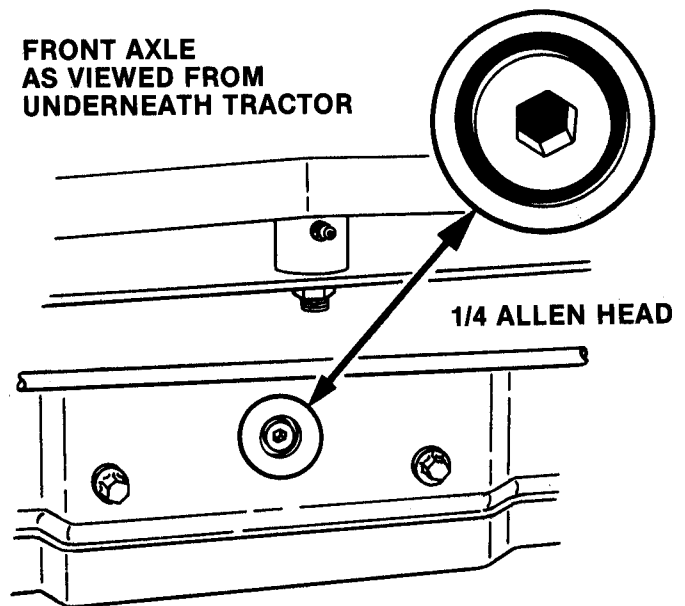

FIG. 9 - ENGINE OIL DRAIN

SERVICE

To retain the quality of your tractor, use Genuine Snapper Replacement Parts only. Contact your local Snapper dealer for parts and service assistance. For the correct part or information for your particular mower, always mention model and serial number. We recommend returning the tractor to an authorized Snapper Dealer on a yearly basis for inspection and addition of any new devices which might upgrade the safety of your mower. For the nearest Snapper Dealer, check the yellow pages under the heading LAWN MOWERS. For engine parts and service, look for the engine manufacturer's dealers under the heading ENGINES-gasoline.

DRAINING ENGINE OIL

The oil drain plug is located on the bottom of the engine in the approximate center of the oil pan just to the rear of the front tie rod. A 1/4" allen head wrench is required to remove the plug. Refer to the engine owner's manual for engine oil specifications.

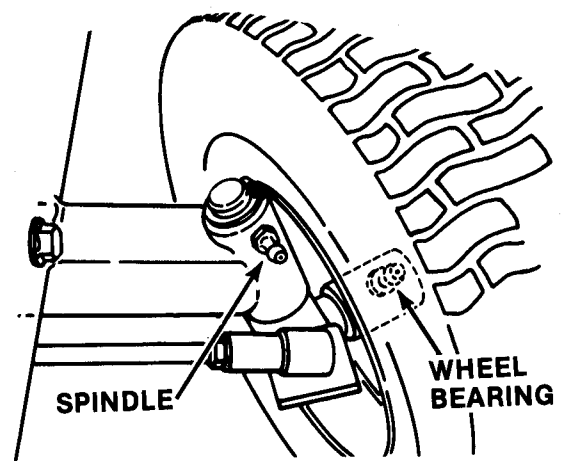

FIG. 10 - FRONT END GREASE POINTS

MAINTENANCE & LUBRICATION SCHEDULE

Refer to the engine owner's manual for service specifications on the engine itself. The following applies primarily to the tractor and optional mower attachments. Clean fittings before greasing.

FIRST 5 HOURS (NEW UNIT)

- ENGINE OIL: Change oil in crankcase. Refer to engine owner's manual.
- TRACTOR: Check all fasteners and retighten as needed.

EVERY 25 OPERATING HOURS

- FRONT WHEEL BEARINGS: Lubricate bearings through the fitting on hub of front wheels (figure 11).
- FRONT AXLE PIVOT & SPINDLES: Lubricate spindle fitting at each wheel (see figure 11) and the center pivot fitting on underside of the front axle.
- CHANGE OIL IN ENGINE CRANKCASE with oil of weight in grade specified in engine owner's manual.
- ENGINE AIR CLEANER: Refer to engine owner's manual for details.
- IDLER (41" and 48"): Lubricate bearing thru fitting on idler arm pivot.

continued

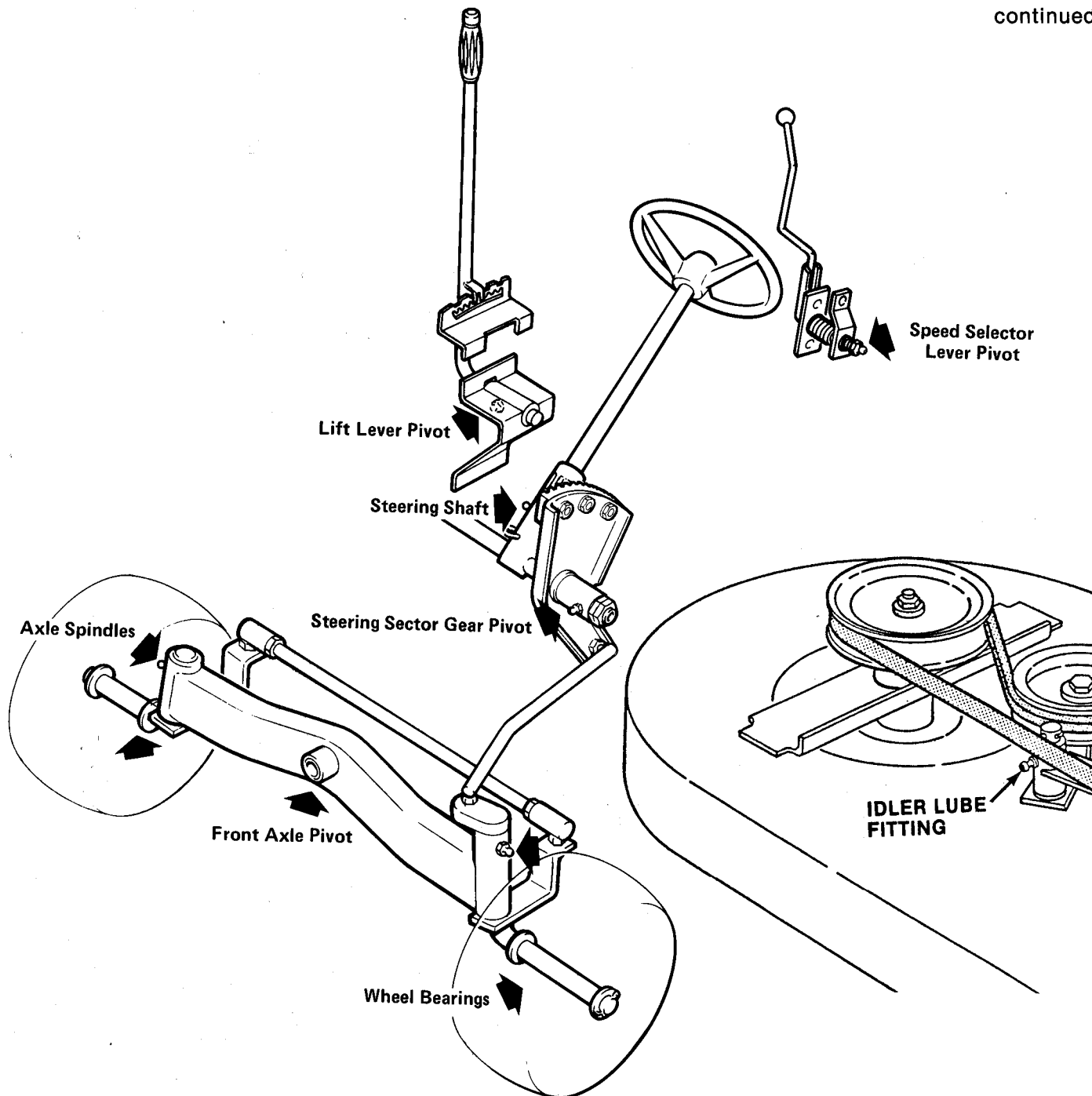

FIGURE 11 -- LUBRICATION POINT SCHEMATIC

TWICE YEARLY SERVICE (OR EVERY 50 HOURS)

- LUBRICATE FITTINGS (with two shots of grease) on:
 1. Steering mechanism (between gas tank and battery).
 2. Steering sector gear pivot (under gas tank).

END OF EACH SEASON (OR EVERY 100 HOURS)

- LUBRICATE FITTINGS (with two shots of grease) on: 1. ground speed selector lever (figure 11 & 13) 2. implement lift lever
- TRANSMISSION DIFFERENTIAL: Remove check plug on inside of unit shown in figure 12 to check level of oil. Add Snapper #00 grease as needed thru upper fill hole to bring the level up to the lower edge of the check plug hole. Reinstall plugs after servicing.
- CHAIN CASE: Remove plug and check. If dry, add one ounce of Snapper 00 grease--do not overfill. Total capacity must not exceed 2 ounces.
- MOWER ATTACHMENT SPINDLE (S): Lubricate fitting for blade spindle bearings with two shots only of bearing grease once each year.
- SERVICE Engine air cleaner element, spark plug.
- SERVICE FUEL FILTER as instructed below.

FUEL SYSTEM SERVICE

Check the in-line fuel filter at frequent intervals and replace before the screen becomes clogged with sediment. Make sure the replacement is correctly installed with IN marking toward the tank and OUT side toward the engine. Route the fuel line thru the holder strap. Check the fuel system components frequently and replace any parts showing worn spots or cracks.

BATTERY SERVICE

Check the battery once each month. Remove the caps and add distilled water as necessary to bring the level of the electrolyte up to about $3/32$ " over plates in each cell. **DO NOT FILL TO THE RINGS.** Carefully reinstall battery caps. In freezing weather, charge the battery after adding water to thoroughly mix the water in the electrolyte. Keep the terminals and straps clean and tight and make sure the red boot (shown in figure 1) remains in position over the positive terminal. Always disconnect negative (-) terminal first and reconnect last!

The engine is equipped with a flywheel alternator to charge the battery. If the tractor is not run regularly, connect the battery to a charger monthly to maintain the specific gravity at 1.250 or higher. If this reading falls below 1.175, the battery liquid may freeze when temperatures drop to around zero degrees F.

continued

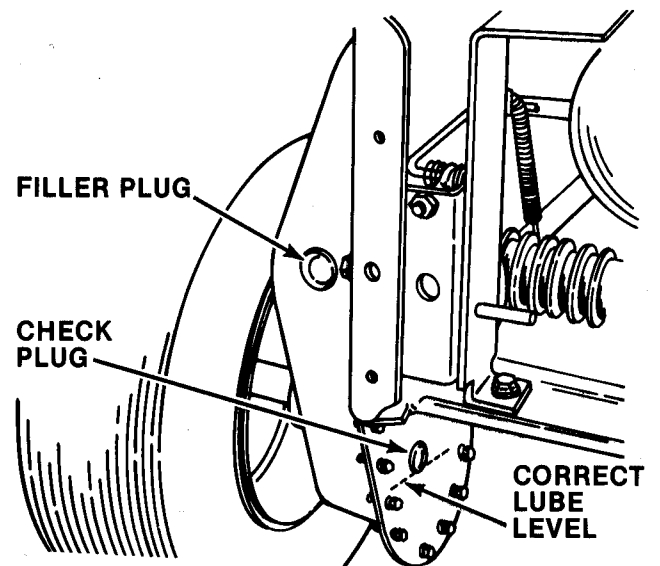

FIG. 12 - TRANSMISSION LUBE LEVEL

To charge, connect per instructions furnished with charger. If time allows, slow charge at 1 amp for ten hours or as an alternate, fast charge at 3 amps for four hours. Observe all precautions while charging.

TO ADJUST TIRE PRESSURE

Check tire pressure at frequent intervals. A low tire on one side causes uneven mowing. Pressure in front tires should be maintained at 12 psi while rear tire pressure should be 10 psi.

DRIVEN DISC SERVICE

If the drive does not engage after extended use, it may be that the driven disc is excessively worn and is not contacting the drive disc. The driven disc must be replaced if the rubber is worn down to $1/16$ " above the metal. Replace the rubber driven disc when excessively worn or when unevenly worn. To replace, remove the rear cover plate, shift the drive into neutral, remove the three nuts from the hub, remove the old disc and replace it with new disc.

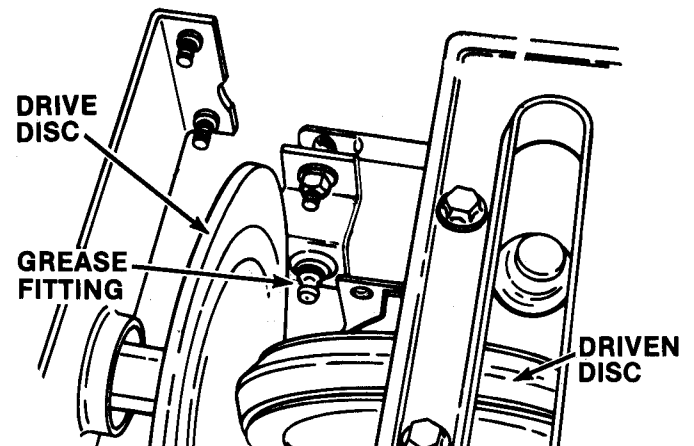

FIG. 13 - SPEED SHIFT & DRIVE DETAIL

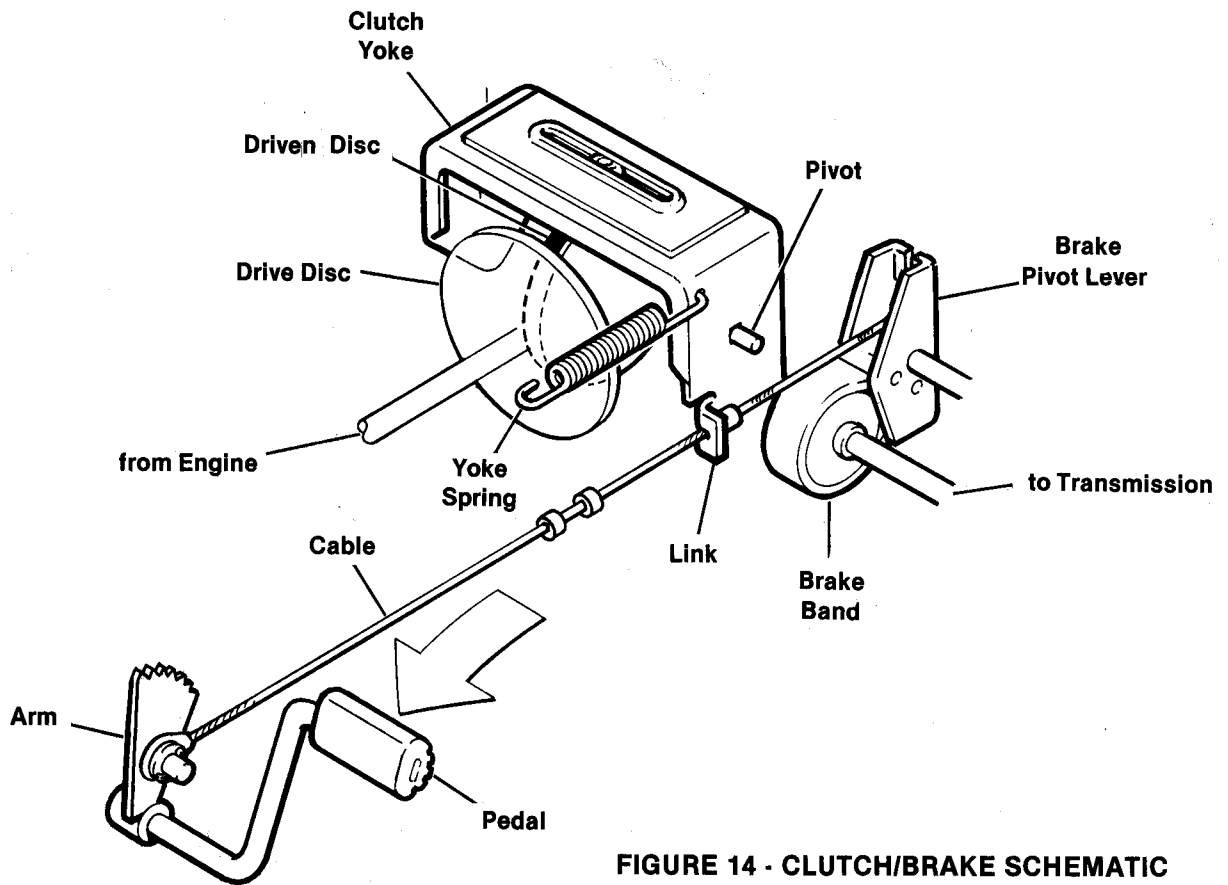

FIGURE 14 - CLUTCH/BRAKE SCHEMATIC

WHEEL BRAKE ADJUSTMENT

After extensive use, the wheel brake band may wear to the point where the brake pedal goes all the way down to the foot rest. The brake adjustment is located inside the rear cover plate as shown in figure 15. To adjust, remove the rear cover plate. Move a loose ferrule to the rear of the brake pivot lever to increase braking. Test with the engine off by shifting the axle range selector to HI or LO. Attempt to roll the machine by depressing the clutch/brake pedal slowly. There should be a place where the clutch is

continued

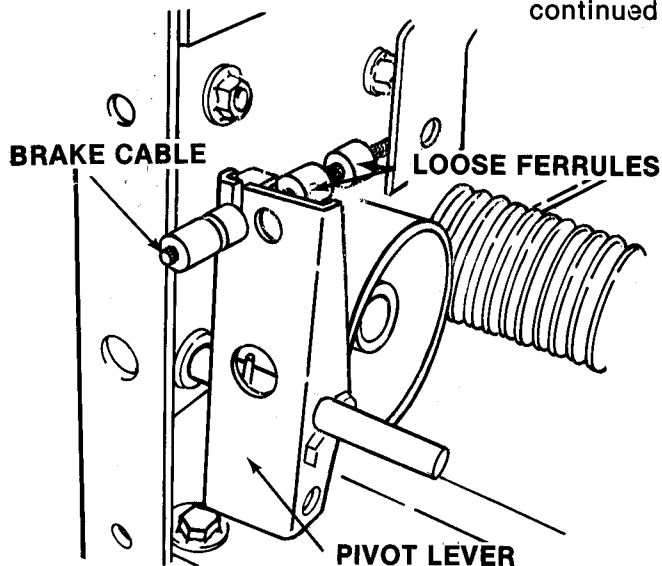

FIG. 15 - WHEEL BRAKE ADJUSTMENT

disengaged and the brakes are not yet applied allowing the machine to roll. This should occur in the first half of the pedal travel.

ELECTRIC CLUTCH ADJUSTMENT

Should the mower blade take more than five seconds to stop after the mower blade is switched off, the brake plate may need adjusting. When properly adjusted, a .010" feeler gauge will fit thru the opening on both sides and bottom of the clutch as shown in figure 16. To adjust, turn the 3 adjusting nuts in or out as needed to obtain the .010" clearance.

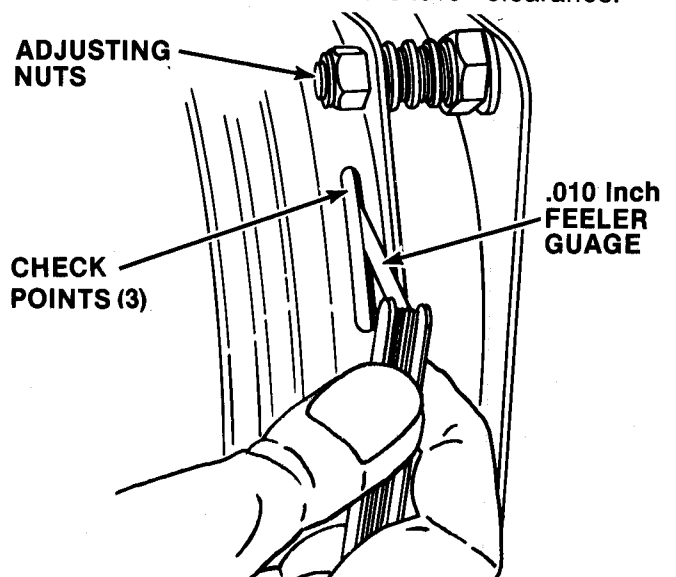

FIG. 16 - BELT DRIVE CLUTCH ADJ.

MOWER DRIVE BELT SERVICE

The drive belt arrangement for the each mower is shown on pages 12 through 14. To install or replace the belt, loosen the pulleys of the "mule" drive at front, loop the belt around the electric clutch pulley an engine, route it inside the mule drive pulley an engine, route it inside the mule drive pulley as shown and around the pulleys of mower. Note: To get the belt around the pulleys on the multi-blade mowers, the belt covers on the outside puleys must be removed. DO NOT operate the mower without these covers:

MOWER SERVICE & ADJUSTMENTS: Keep the top-side of the mower free of grass cuttings. Build-up of clippings could cause belt problems and also might present potential fire hazard especially when dry. If uneven cutting is noted, check the tire pressure first as this the most common cause. If tire pressure is correct and uneven cutting persists, move the tractor to a flat level surface, such as a garage floor, and check the deck level. This done with the tractor engine off as described on pages 12 through 14.

To prolong the life and efficiency of your mower, keep the underside the deck clean and free of accumulated grass clippings by washing it down with a hose and/or scraping with a wire brush and scraper. Make sure this is done at the end of the cutting season before placing the mower in storage.

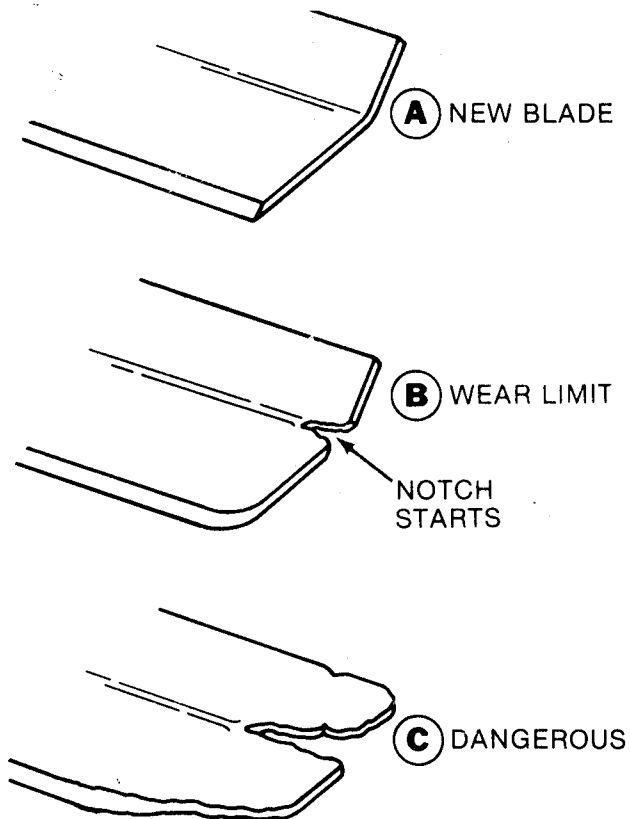
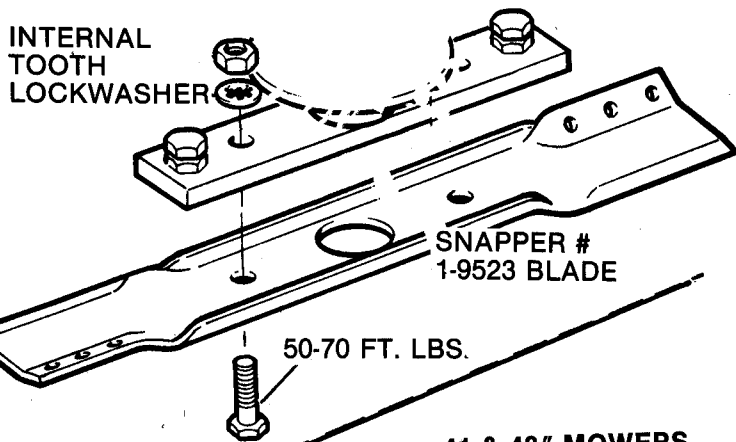

FIG. 18 - BLADE WEAR PATTERNS

33" MOWERS



41 & 48" MOWERS

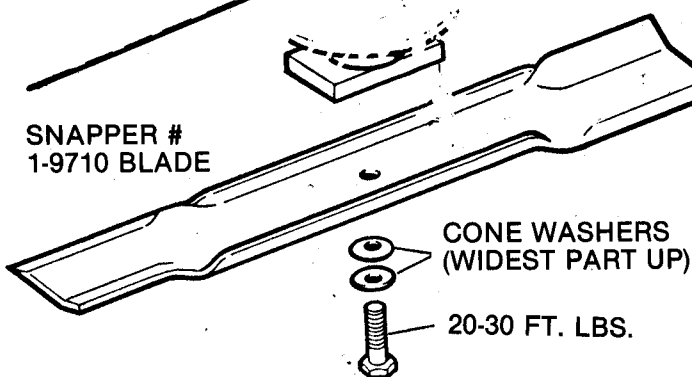

FIG. 19 - BLADE RETENTION DETAIL

CUTTING BLADE SERVICE

Check at frequent intervals to make sure the blade is securely tightened and that it is in good condition.

Replace blade is badly chipped, bent, out of balance or as soon as notch starts wearing in the tip between the flat surface and upturned lift as depicted in View B, Figure 18. This type wear pattern occurs more rapidly under sandy soil conditions. **CAUTION:** Never operate the mower with blade worn to the extent shown in View C as the tip could fly off causing personal injury or property damage.

Sharpen blade when the cutting edges become dull if the blade is in otherwise good condition. When dull the grass cut ends will be ragged and usually turn brown soon after mowing. For best results, remove the blade and sharpen it on a grinding wheel at an angle of 22 to 28 degrees. The cutting surface should extend in about 2½" from the tips. Check the blade after sharpening to determine that it is still balanced. It will cause excessive vibration if unbalanced. **BE CAREFUL-AVOID CUTTING YOURSELF ON SHARP BLADE!**

Install sharpened or replacement blade with components in same sequence as removed. Make sure that the turned-up rims in the center the blade fit over the edges of the blade drive hub when installing. Do not substitute any components here. Tighten the blade retaining capscrew to 20-30 foot-pounds torque valve on 41" and 48" mowers and to 50-70 foot-pounds on 33" mowers.

REMOVING & INSTALLING MOWER

The mower is attached to the tractor and levelled at the factory. If the mower is to be removed for cutting blade service, or to install another attachment, be sure that the mower settings remain unchanged. Simply pull clevis pins attaching the mower to the front and rear lift arms and lift bracket after removing the drive belt. Turn the front wheels to the left and slide the mower out from the right side. Use the following procedure to install the mower to the tractor.

1. Turn front wheels to left, slide mower in from right side until in position under tractor.
2. Unplug lights, remove hairpins in hood stop cables, remove hood, attach mule drive to front of tractor with two bolts.
3. Grasp deck belt above mule drive pulleys, pull upward and loop over and wrap around the engine pulley. Check belt routing. Reinstall hood on tractor, hook up lights and stop cables.

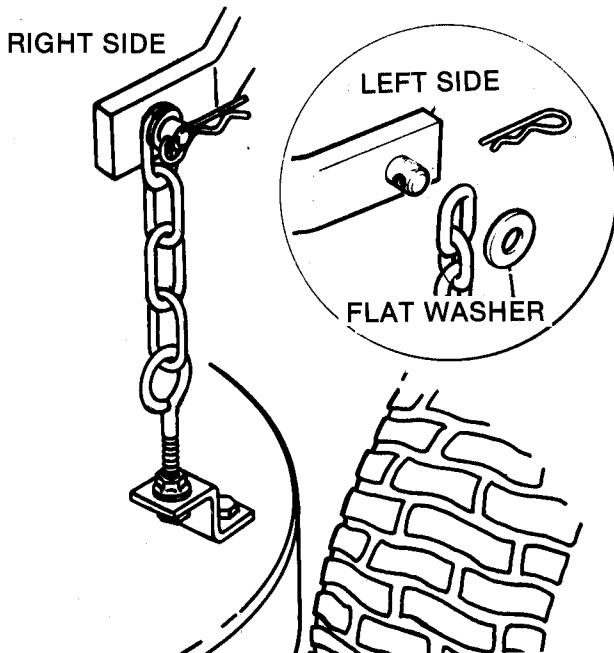

FIG. 20 - REAR LIFT ARM

4. Pull front lift arms up into position between the implement attaching brackets on back of front axle and secure at each side with a large clevis pin and large hairpin. (Fig. 22)
5. Place implement lift lever in lowest position (full forward), raise deck and secure to rear lift arm bracket with washer and small hairpin. (Fig. 20)
6. Slip ball end of cable attached to front lift arm into slot in the clevis then attach the clevis to the lift lever bracket with small clevis pin and small hairpin. (Fig. 21)

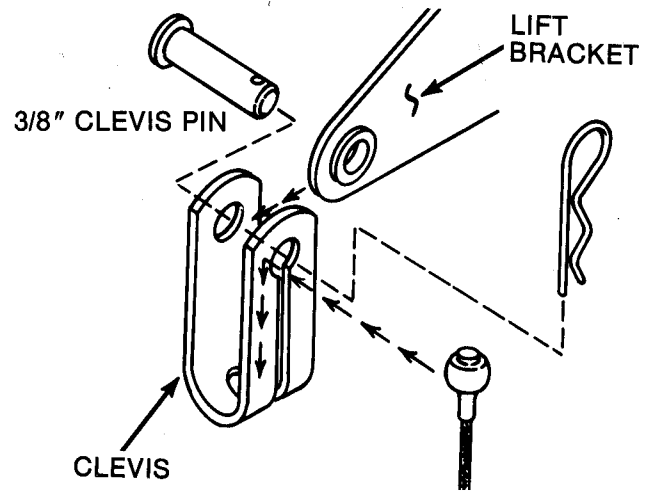

FIGURE 21 - FRONT LIFT BRACKET

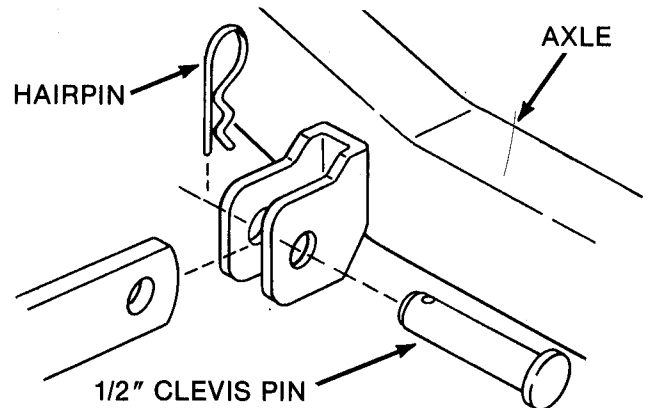

FIGURE 22 - FRONT LIFT ARM

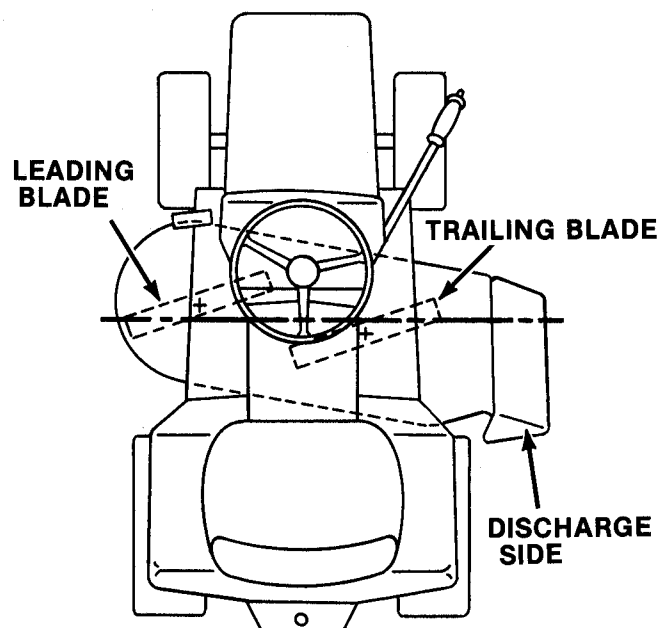

FIG. 23 - MULTI-BLADE LEVEL CHECK

LEVELING - 33" MOWER

With the blades sharpened and properly aligned, a level mower deck will insure a clean, even cut. The mower should be checked for level as follows:

1. Check the air pressure in the tires and correct pressure as needed. 12 psi front and 10 psi rear tires.
2. Move the tractor to a smooth, flat and level area such as garage floor.
3. Move the lift lever to #5 notch.
4. Place a 2 3/4" block on edge under the front lip of the deck in the exact center between the front lift arms.
5. Loosen the jam nut on the front lift cable and adjust until the front lip of the deck rests on the block and the cable is tight. Tighten the cable jam nut and remove the block.
6. Place a 2 3/4" high block under the exact center of the rear lip of the deck.
7. Pull the pins and remove the chains from the support pins on the rear lift arms.
8. Loosen nuts on eccentric bolt and pivot bolt and level the deck side to side by turning the eccentric adjusting bolt. The distance from the floor to the bottom of the deck on the left & right side should be within 1/8" of each other.

continued

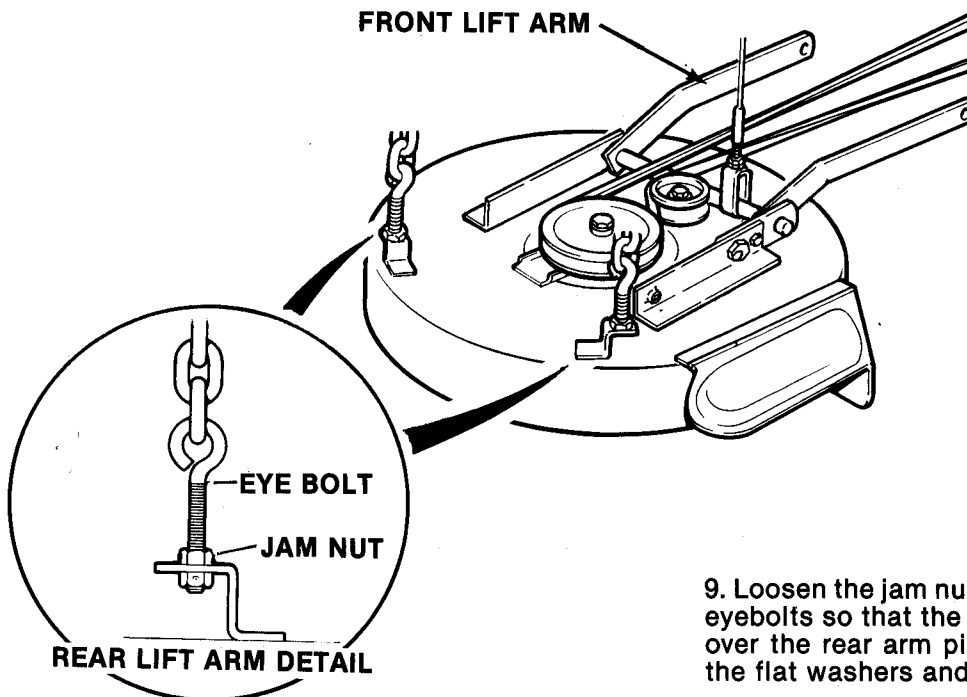
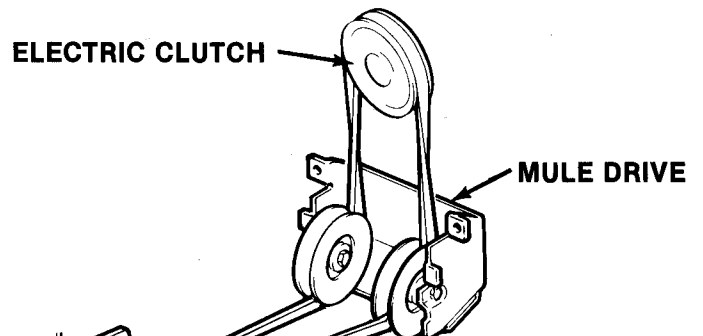
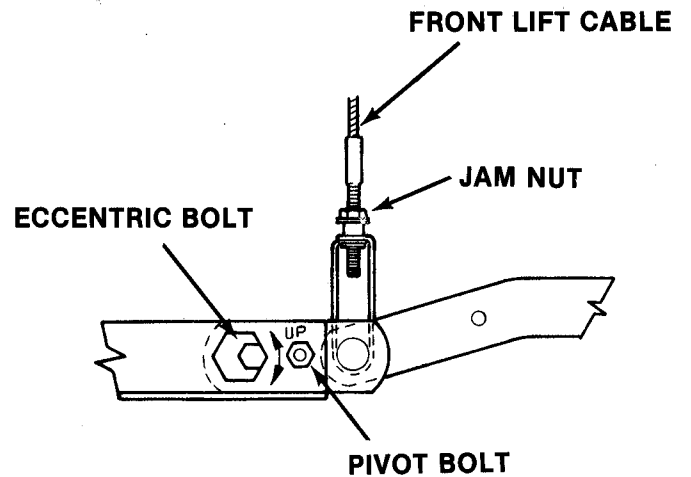

9. Loosen the jam nuts and adjust both rear lift chain eyebolts so that the top link of the chain just slides over the rear arm pins. Tighten jam nuts. Reinstall the flat washers and hairpins. Recheck level.

FIGURE 24 - 33" MOWER (SINGLE BLADE-HI-VAC)

LEVELING 41" MOWER

With the blades sharpened and properly aligned, a level mower deck will insure a clean, even cut. The mower should be checked for level as follows:

1. Check the air pressure in the tires and correct pressure as needed. 12 psi front and 10 psi rear tires.
2. Move the tractor to a smooth, flat and level area such as garage floor.
3. Move the lift lever to #5 notch.
4. Place a 2x4" block on edge under the front lip of the deck in the exact center between the front lift arms.
5. Loosen the jam nut on the front lift cable and adjust until the front lip of the deck rests on the 2x4 block and the cable is tight. Tighten the cable jam nut and remove the block.
6. Place a 3" high block under the exact center of the rear lip of the deck.
7. Pull the pins and remove the chains from the support pins on the rear lift arms.
8. Turn the outside blades perpendicular to the tractor frame.
9. Loosen nuts on eccentric bolt and pivot bolt and level the deck side to side by turning the eccentric adjusting bolt. The distance from floor to each blade tip should be within 1/8" of each other.
10. Loosen the jam nuts and adjust both rear lift lift chain eyebolts so that the top link of the chain just slides over the rear arm pins. Tighten jam nuts. Reinstall the flat washers and hairpins. Recheck level.

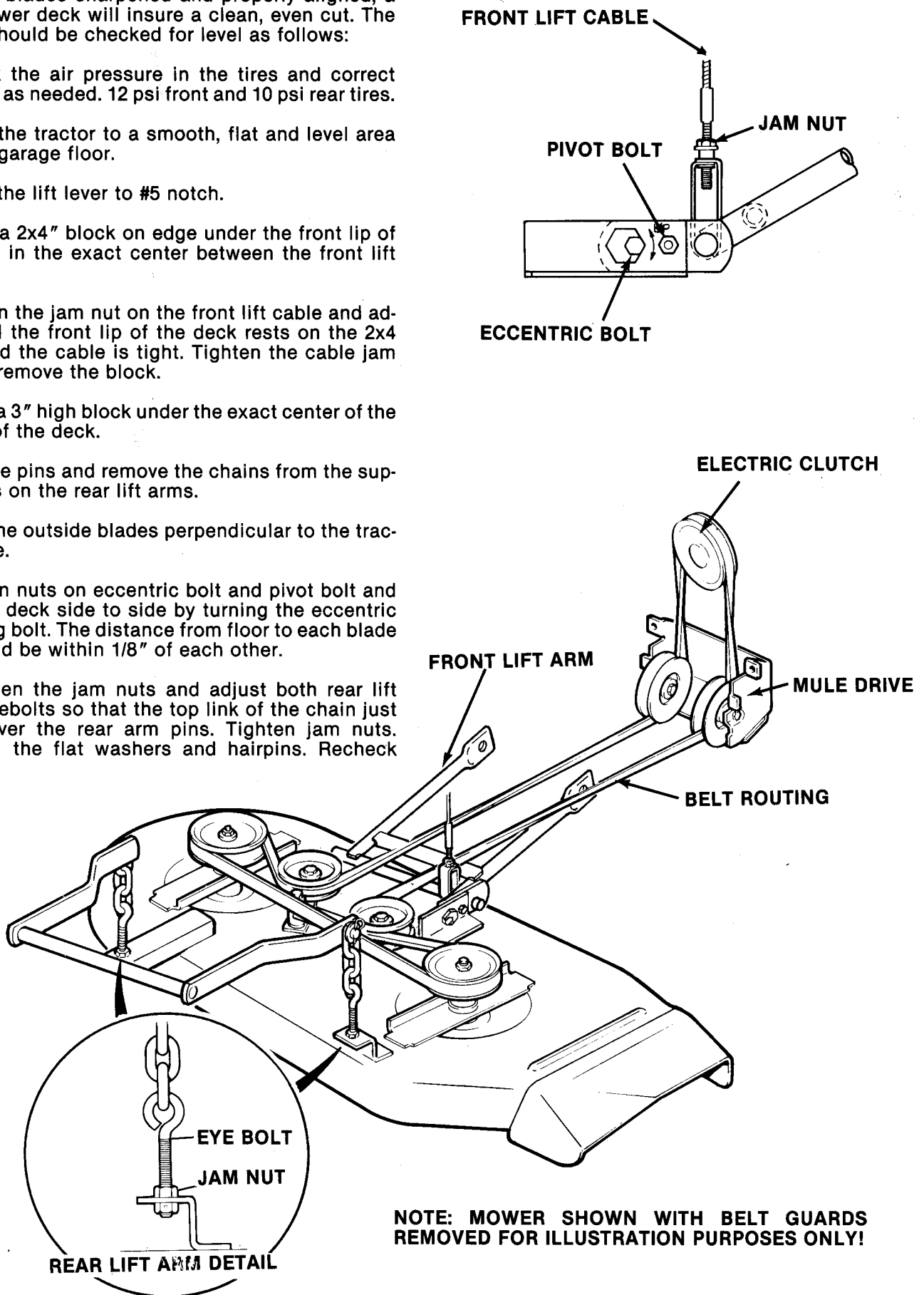

FIGURE 25 - 41" MOWER (TWO BLADE)

LEVELING 48" MOWER

With the blades sharpened and properly aligned, a level mower deck will insure a clean, even cut. The mower should be checked for level as follows:

1. Check the air pressure in the tires and correct pressure as needed. 12 psi front and 10 psi rear tires.
2. Move the tractor to a smooth, flat and level area such as garage floor.
3. Move the lift lever to #5 notch.
4. Place a 2x4" block on edge under the front lip of the deck in the exact center between the front lift arms.
5. Loosen the jam nut on the front lift cable and adjust until the front lip of the deck rests on the 2x4 block and the cable is tight. Tighten the cable jam nut and remove the block.
6. Place a 3" high block under the exact center of the rear lip of the deck.
7. Pull the pins and remove the chains from the support pins on the rear lift arms.
8. Turn the outside blades perpendicular to the tractor frame.
9. Loosen nuts on eccentric bolt and pivot bolt and level the deck side to side by turning the eccentric adjusting bolt. The distance from floor to each blade tip should be within 1/8" of each other.

continued

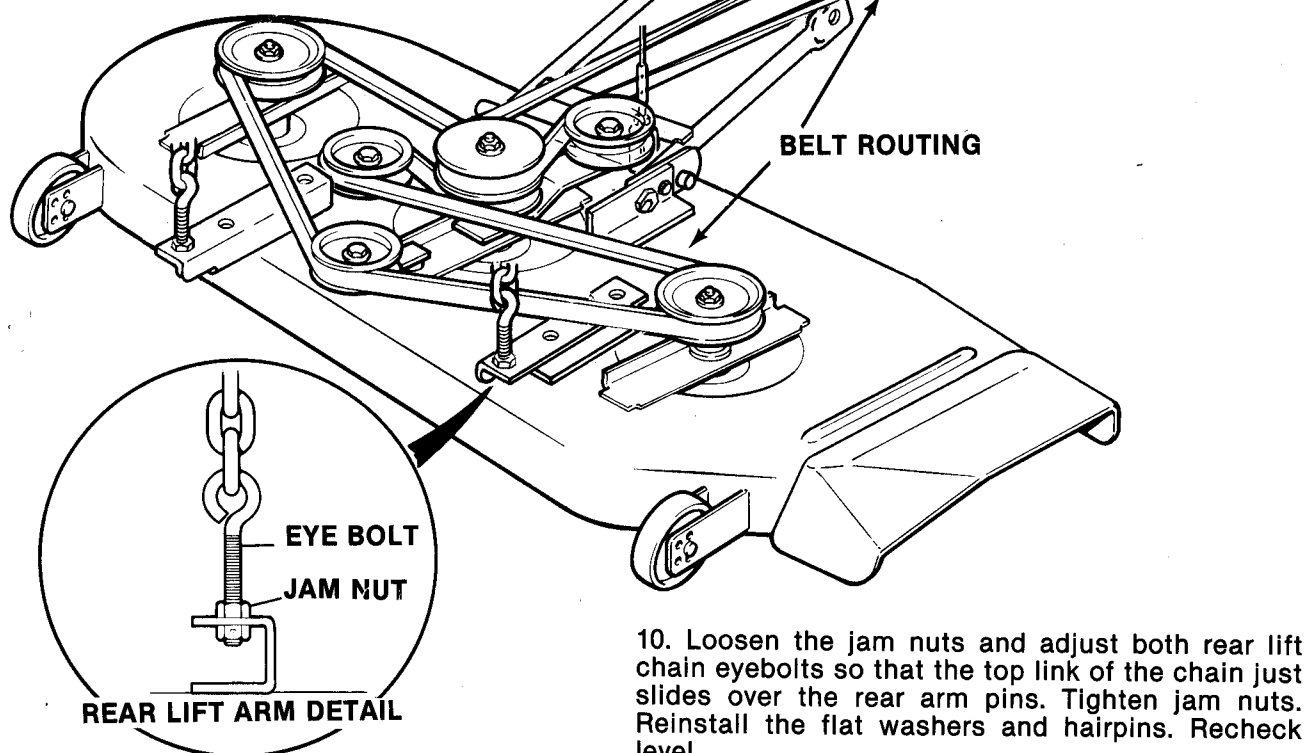

10. Loosen the jam nuts and adjust both rear lift chain eyebolts so that the top link of the chain just slides over the rear arm pins. Tighten jam nuts. Reinstall the flat washers and hairpins. Recheck level.

FIGURE 26 - 48" MOWER (3 BLADE)

SNAPPER

**LT12, LT16 SERIES 2
LAWN TRACTOR**

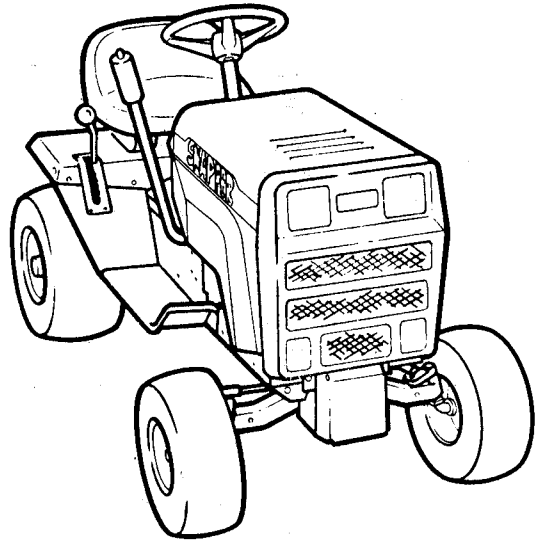

Safety Instruction & Operators Manual

MANUFACTURER'S 2 YEAR LIMITED WARRANTY

For two (2) Years from purchase date for the original purchaser's residential, non-commercial use [ninety (90) days from purchase date for the original purchaser's commercial, rental, or other non-residential use], SNAPPER POWER EQUIPMENT, through any SNAPPER dealer will replace, free of charge, any part or parts found upon examination by the factory at McDonough, Georgia, to be defective in material or workmanship or both.

All transportation cost incurred by the purchaser in submitting material to a SNAPPER dealer for replacement under this warranty must be borne by the purchaser.

This warranty does not apply to engines and their components, as these items are warranted separately by their manufacturers, and does not apply to batteries which are covered separately. This warranty does not apply to parts that have been damaged by accident, alteration, abuse, improper lubrication, normal wear, or other cause beyond our control.

There is no other express warranty.

Implied warranties, including those of merchantability and fitness for a particular purpose, are limited to two (2) years from purchase date for the original purchaser's residential, non-commercial use [ninety (90) days from purchase for the original purchaser's commercial, rental or other non-residential use], and to the extent permitted by law any and all implied warranties are excluded. This is the exclusive remedy. Liabilities for consequential damages, under any and all warranties are excluded.

Some states do not allow limitations on how long an implied warranty lasts, or do not allow the exclusion or limitation of incidental or consequential damages, so the above limitation or exclusion may not apply to you.

This warranty gives you specific legal rights, and you may also have other rights which vary from state to state.

WARNING: THE USE OF REPLACEMENT PARTS OTHER THAN GENUINE SNAPPER PARTS MAY IMPAIR THE SAFETY OF SNAPPER PRODUCTS AND WILL VOID ANY LIABILITY AND WARRANTY BY SNAPPER ASSOCIATED WITH THE USE OF SUCH PARTS.

IMPORTANT: Please fill out the attached SNAPPER Product Registration Card immediately and mail to: SNAPPER POWER EQUIPMENT, McDONOUGH, GEORGIA 30253



SNAPPER POWER EQUIPMENT
McDonough, GA • 30253

